

# RESOLUTION NO. 91-345

ADOPTED BY THE SACRAMENTO CITY COUNCIL

ON DATE OF **MAY 14 1991**

RESOLUTION AMENDING THE GENERAL PLAN FOR 9.57± ACRES FROM COMMUNITY/NEIGHBORHOOD COMMERCIAL AND OFFICES TO LOW DENSITY RESIDENTIAL (4-15 DU/NA) AND THE POCKET COMMUNITY PLAN FOR 9.57± ACRES FROM COMMERCIAL/SHOPPING TO LOW DENSITY RESIDENTIAL (7-15 DU/NA) FOR THE AREA DESCRIBED IN THE ATTACHED EXHIBIT

(P90-442) (APN: 031-0070-047)

**MAY 14 1991**

**WHEREAS**, the City Council conducted a public hearing on \_\_\_\_\_ concerning the above plan amendment and based on documentary and oral evidence submitted at the public hearing, the Council hereby finds:

1. The proposed plan amendment is compatible with surrounding uses;
2. The subject site is suitable for Residential uses;
3. The proposal is consistent with the policies of the City's General Plan and the Pocket Community Plan.

**NOW, THEREFORE, BE IT RESOLVED** by the City Council of the City of Sacramento that the area as described on the attached Exhibit in the City of Sacramento is hereby designated on the Pocket Community Plan for Low Density Residential (7-15 du/na) uses.

  
MAYOR

ATTEST:  
  
CITY CLERK

P90-226

---

FOR CITY CLERK USE ONLY

RESOLUTION NO.: **91-345**  
DATE ADOPTED: **MAY 14 1991**

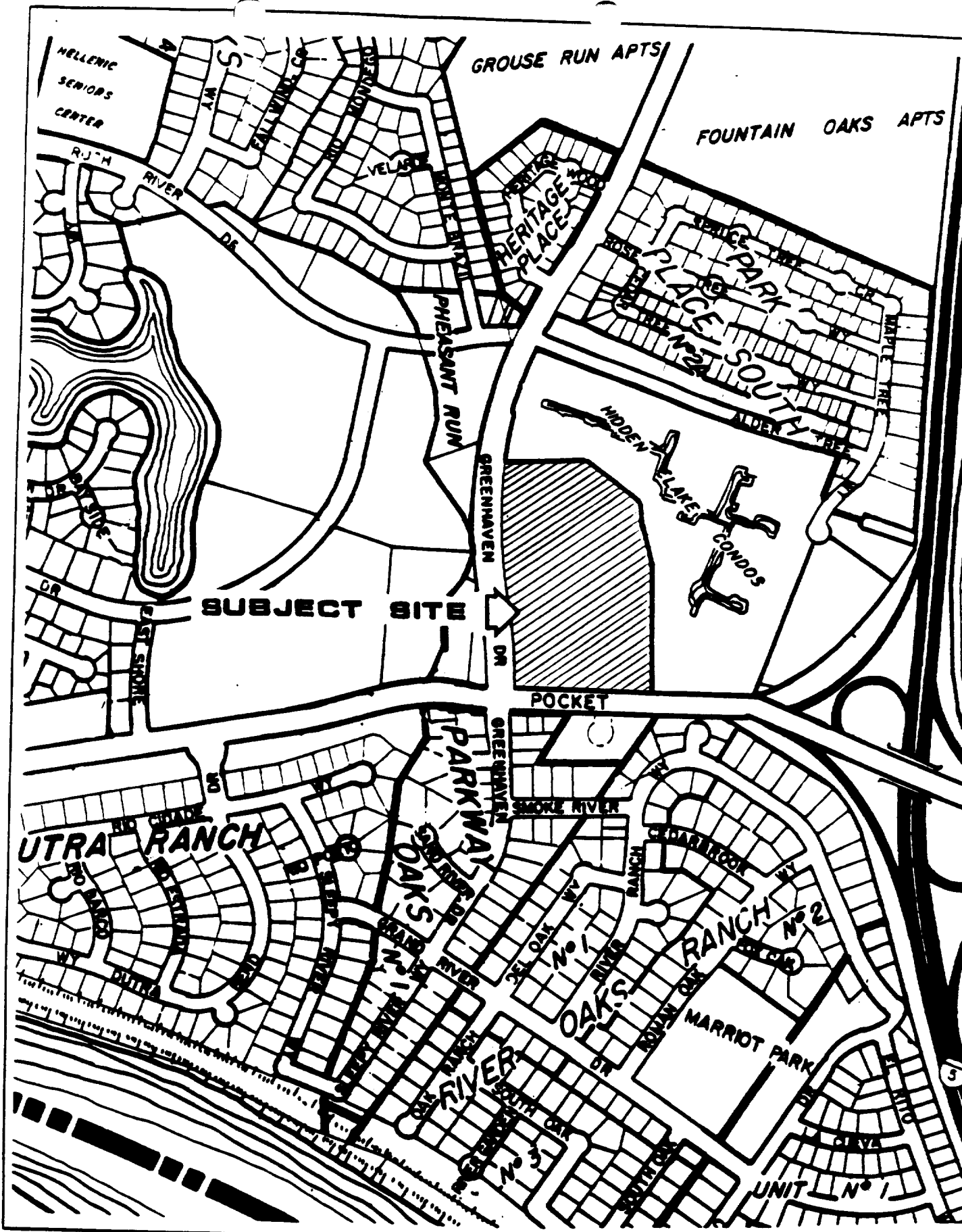

VICINITY MAP RESOLUTION 91-345

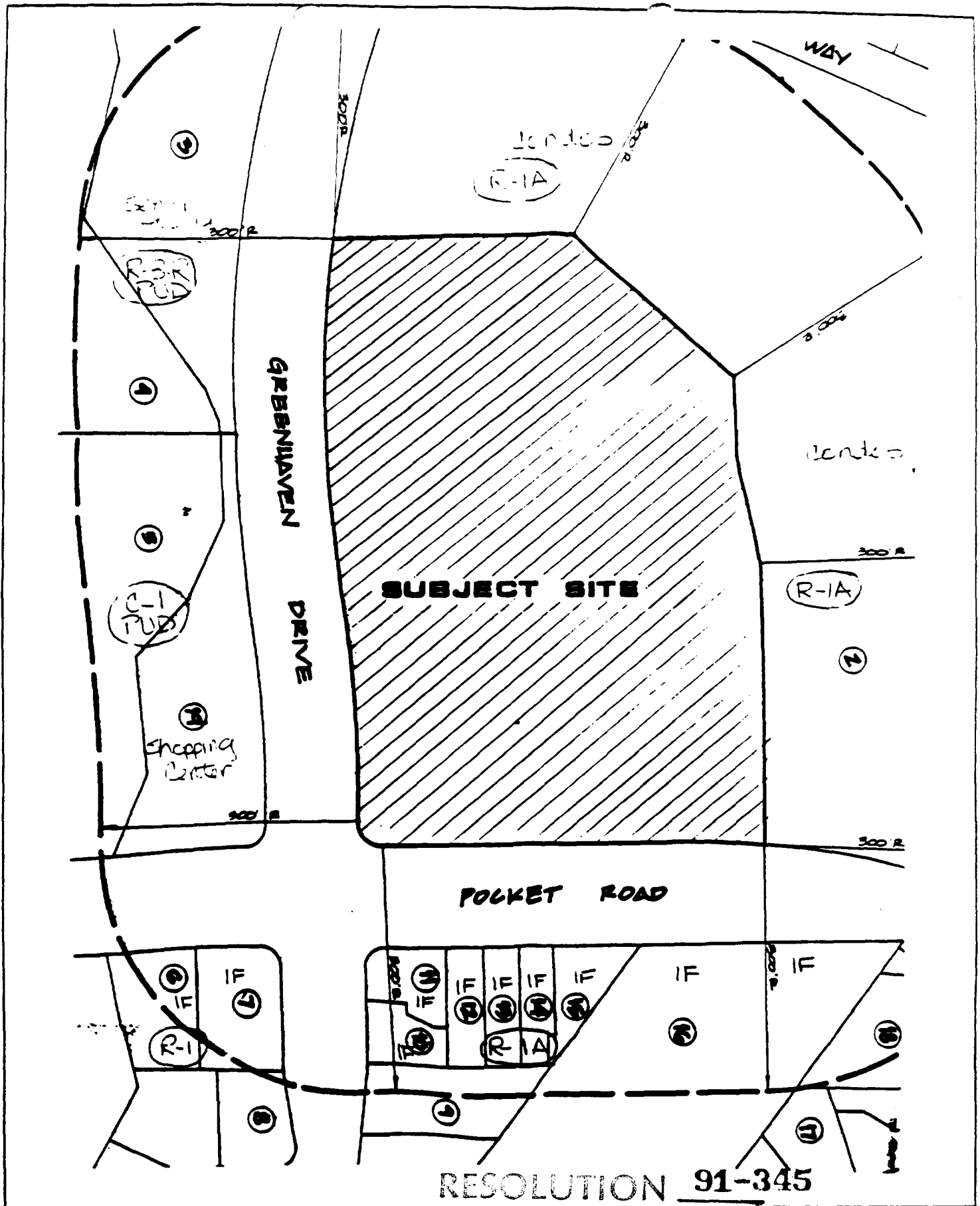

**LAND USE & ZONING MAP**

**MAY 14 1991**