

# RESOLUTION NO. 86-566

ADOPTED BY THE SACRAMENTO CITY COUNCIL ON DATE OF

**JUL 29 1986**

APPROVING FINAL PARCEL MAP FOR  
LOTS 119, 120, 121 AND LOT H OF UNIVERSITY PARK 114BM37  
(P-86123)

WHEREAS, THE COUNCIL OF THE CITY OF SACRAMENTO FINDS AND DETERMINES AS FOLLOWS:

A. The Final Parcel Map for Lots 119, 120, 121 and Lot H of University Park 114BM37, located on the east side of Howe Avenue, north of University Avenue, together with provisions for its design and improvement, is consistent with the 1974 General Plan.

B. The Final Parcel Map is in substantial compliance with the previously approved tentative map.

NOW, THEREFORE, BE IT RESOLVED BY THE COUNCIL OF THE CITY OF SACRAMENTO AS FOLLOWS:

1. The Final Parcel Map for Lots 119, 120, 121 and Lot H of University Park 114BM37, be, and the same is hereby approved subject to the execution by all parties for that subdivision.
2. All offers of dedication shown on said map are hereby accepted.

  
MAYOR

ATTEST:

  
CITY CLERK

RESOLUTION No. ~~86-566~~

**JUL 29 1986**



SCALE: 1"=40'

RE-SUBDIVISION OF LOTS 119, 120, 121, AND LOT H, AS SHOWN ON THE PLAT OF UNIVERSITY PARK-141 BM 37 CITY OF SACRAMENTO MARCH, 1986

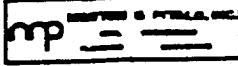

295-300-31

UNIVERSITY PARK HOMES OF SAC.

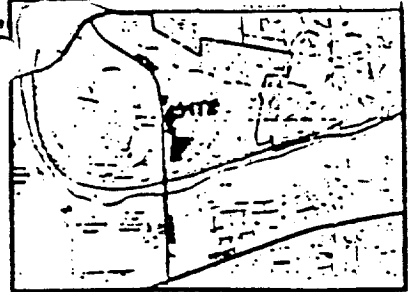

VICINITY MAP TO NEALS

P86 123

295-040-32

CARLYLE REAL ESTATE LTD. PART.

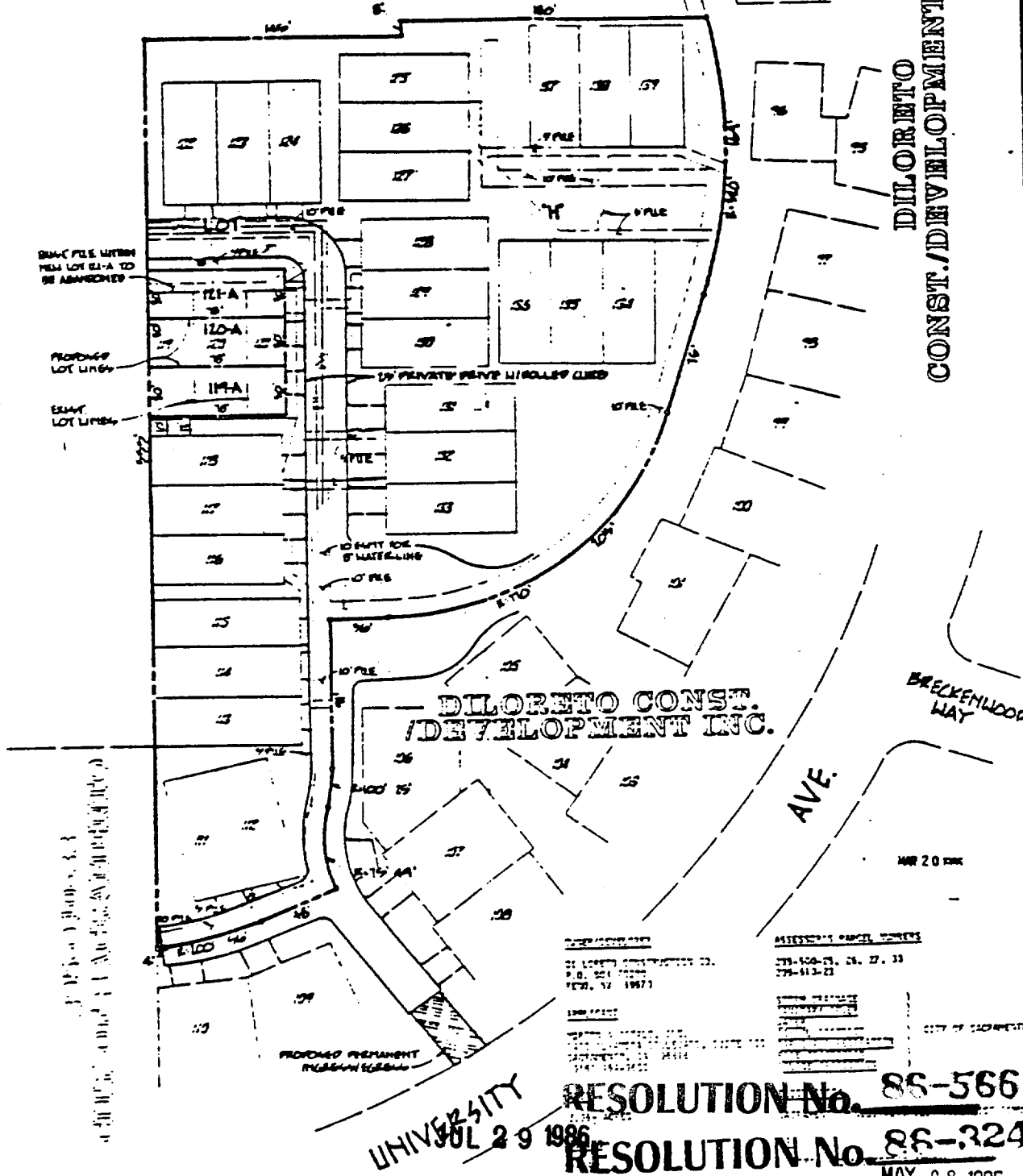

DIORETO DEVELOPMENT INC. CONST./DEVELOPMENT INC.

DIORETO CONST. /DEVELOPMENT INC.

COUNTY OF SACRAMENTO DEPARTMENT OF PUBLIC WORKS 2150 J STREET SACRAMENTO, CA 95811 916-441-2222	CITY OF SACRAMENTO 215 J STREET, 21, 27, 33 SACRAMENTO, CA 95811 916-441-2222
---	--

UNIVERSITY 29 1986

RESOLUTION No. 86-566  
RESOLUTION No. 86-324

MAY 28 1986 870016

P861 123

6