

**CITY OF SACRAMENTO**

1231 I Street, Sacramento, CA 95814

Permit No: 0009023

Insp Area: 4

Site Address: 3874 SAINTSBURY DR SAC

Parcel No: 225-1190-021

GATEWAY W 1 LOT 209

Sub-Type: NSFR

Housing (Y/N): N

CONTRACTOR

BLAZER HOMES  
3009 DOUGLAS BL #150  
ROSEVILLE CA 95661

OWNER

ARCHITECT

Nature of Work: NSFR MP1441 7 RMS

**CONSTRUCTION LENDING AGENCY:** I hereby affirm under penalty of perjury that there is a construction lending agency for the performance of the work for which this permit is issued (Sec. 3097, Civ. C.)

Lender's Name \_\_\_\_\_ Lender's Address \_\_\_\_\_

**LICENSED CONTRACTORS DECLARATION:** I hereby affirm under penalty of perjury that I am licensed under provisions of Chapter 9 (commencing with section 7000) of Division 3 of the Business and Professions Code and my license is in full force and effect.

License Class B License Number 724191 Date 8/9/00 Contractor Signature Sheyf VanMaen

**OWNER-BUILDER DECLARATION:** I hereby affirm under penalty of perjury that I am exempt from the contractors License Law for the following reason (Sec. 7031.5, Business and Professions Code, any city or county which requires a permit to construct, alter, improve, demolish, or repair any structure, prior to its issuance, also requires the applicant for such permit to file a signed statement that he or she is licensed pursuant to the provisions of the Contractors License Law (Chapter 9 (commencing with Section 7000) of Division 8 of the Business and Professions Code) or that he or she is exempt therefrom and the basis for the alleged exemption. Any violation of Section 7031.5 by any applicant for a permit subjects the applicant to a civil penalty of not more than five hundred dollars (\$500.00):

I, as a owner of the property, or my employees with wages as their sole compensation, will do the work, and the structure is not intended or offered for sale (Sec. 7044, Business and Professional Code: The Contractors License Law does not apply to an owner of property who builds or improves thereon, and who does such work himself or herself or through his/her own employees, provided that such improvements are not intended or offered for sale. If, however, the building or improvement is sold within one year of completion, the owner-builder will have the burden of proving that he/she did not build or improve for the purpose of sale.)

I, as owner of the property, am exclusively contracting with licensed contractors to construct the project (Sec. 7044, Business and Professions Code. The Contractors License Law does not apply to an owner of property who builds or improves thereon, and who contracts for such projects with a contractor(s) licensed pursuant to the Contractors License Law).

I am exempt under Sec. \_\_\_\_\_ B & PC for this reason: \_\_\_\_\_

Date \_\_\_\_\_ Owner Signature \_\_\_\_\_

**IN ISSUING THIS BUILDING PERMIT,** the applicant represents, and the city relies on the representation of the applicant, that the applicant verified all measurements and locations shown on the application or accompanying drawings and that the improvement to be constructed does not violate any law or private agreement relating to permissible or prohibited locations for such improvements. This building permit does not authorize any illegal location of any improvement or the violation of any private agreement relating to location of improvements.

I certify that I have read this application and state that all information is correct. I agree to comply with all city and county ordinances and state laws relating to building construction and hereby authorize representative(s) of this city to enter upon the above mentioned property for inspection purposes.

Date 8/9/00 Applicant Agent Signature Sheyf VanMaen

**WORKER'S COMPENSATION DECLARATION:** I hereby affirm under penalty of perjury one of the following declarations:

I have and will maintain a certificate of consent to self-insure for workers' compensation as provided for by Section 3700 of the Labor Code, for the performance of work for which the permit is issued

I have and will maintain workers' compensation insurance, as required by Section 3700 of the Labor Code, for the performance of the work for which this permit is issued. My workers' compensation insurance carrier and policy number are:

Carrier LIBERTY MUTUAL INS CO Policy Number WA2-651-004147-080 Exp Date 4/1/2001

(This section need not be completed if the permit is for \$100 or less) I certify that in the performance of the work for which this permit is issued, I shall not employ any person in any manner so as to become subject to the workers' compensation laws of California and agree that if I should become subject to the workers' compensation provisions of Section 3700 of the Labor Code, I shall forthwith comply with those provisions.

Date 8/9/00 Applicant Signature Sheyf VanMaen

**WARNING:** FAILURE TO SECURE WORKER'S COMPENSATION COVERAGE IS UNLAWFUL AND SHALL SUBJECT AN EMPLOYER TO CRIMINAL PENALTIES AND CIVIL FINES UP TO ONE HUNDRED THOUSAND DOLLARS (\$100,000) IN ADDITION TO THE COST OF COMPENSATION, DAMAGES AS PROVIDED FOR IN SECTION 3706 OF THE LABOR CODE, INTEREST AND ATTORNEY'S FEE.

**THIS PERMIT SHALL EXPIRE BY LIMITATION IF WORK IS NOT COMMENCED WITHIN 180 DAYS.**

### RESIDENTIAL BUILDING PERMIT APPLICATION

New Construction     Addition     Remodels     Other

Project Address: 38074 SULLY CIRCLE, IV

Assessor Parcel # 225-1190-021

#### OWNER INFORMATION:

Legal Property Owner: Beazer Homes Phone # 773-3888  
Owner Address: 3009 Douglas Blvd. 150 City Roseville State CA Zip 95661

#### CONTRACTOR INFORMATION:

Contractor: Beazer Homes Lic. # B724191 Phone # 773-3888 Fax# 773-0425

#### PROJECT INFORMATION:

Land Use Zone \_\_\_\_\_ Occupancy Group \_\_\_\_\_ Construction Type \_\_\_\_\_ Fed Code \_\_\_\_\_

No. of stories: \_\_\_\_\_ No. of rooms: \_\_\_\_\_ Street width: \_\_\_\_\_

1<sup>st</sup> Floor Area \_\_\_\_\_ 2<sup>nd</sup> Floor Area \_\_\_\_\_ Basement \_\_\_\_\_ Roof Material \_\_\_\_\_

AREA IN SQUARE FOOT OF:	EXISTING	NEW
Dwelling/Living	_____	<u>1441</u>
Garage/Storage	_____	<u>439</u>
Decks/Balconies	_____	_____
Carports	_____	_____

SCOPE OF WORK: SFO

#### FOR OFFICE USE ONLY

- Information above complete
- Violation files checked
- Standard setbacks
- County Sewer
- AR Flood Waiver required
- Flood Elevation Certificate Required
- Water Development Infill Area
- Planning Approval
- Design Review Approval
- Special Fee Districts Apply: \_\_\_\_\_

#### NEW STRUCTURES & ADDITIONS

❖ THE FOLLOWING MUST BE PROVIDED IN ORDER TO SUBMIT FOR PLAN REVIEW

- 2 COMPLETE PLANS, LEGIBLE & DRAWN TO SCALE
  - 3 SETS IF PROJECT IS IN A DESIGN REVIEW AREA
  - Title 24 Energy Compliance documentation
  - Grading and Erosion Control Questionnaire
  - 11" x 17" copy of floor plan for County Assessor
  - Plan Review Fees
- ❖ Plans to include: site plan, floor plan, elevations, roof/ceiling plan, foundation and structural framing details, and structural calculations for non-conforming structures.

Date: \_\_\_\_\_

Received by: (staff) \_\_\_\_\_

ACTIVITY/PERMIT # \_\_\_\_\_

# CERTIFICATION OF INSULATION

PART I GENERAL

RENZE  
 3874 Santsbury  
 OCF WEST

LOT # 209

- P.O. BOX 854, WEST SACRAMENTO, CA 95691 LIC. #202026
- 1309 MELODY ROAD, MARYSVILLE, CA 95901 LIC. #202026
- P.O. BOX 9651, FRESNO, CA 93793-9651 LIC. #202026
- P.O. BOX 1631, RENO, NV 89505 LIC. #10675
- 3326 A PONDEROSA WAY, LAS VEGAS, NV 89118 LIC. #10675

DATE INSULATION COMPLETED

PART II AREAS INSULATED

WALLS		CEILINGS		FLOORS	
SQUARE FEET)		SQUARE FEET)		SQUARE FEET)	
TYPE OF INSULATION		TYPE OF INSULATION		TYPE OF INSULATION	
MATERIAL <b>FIBERGLASS</b>		MATERIAL <b>FIBERGLASS</b>		MATERIAL <b>FIBERGLASS</b>	
FORM <b>BATTS</b>		FORM <b>BATTS &amp; BLOW</b>		FORM <b>BATTS</b>	
MANUFACTURER'S PRODUCT I.D.		MANUFACTURER'S PRODUCT I.D.		MANUFACTURER'S PRODUCT I.D.	
MANUFACTURER		MANUFACTURER		MANUFACTURER	
<b>OCF</b>		<b>OCF</b>		<b>OCF</b>	
<b>R-VALUE INSTALLED</b>		<b>R-VALUE INSTALLED</b>		<b>R-VALUE INSTALLED</b>	
<b>APPLIED THICKNESS</b>		<b>APPLIED THICKNESS</b>		<b>APPLIED THICKNESS</b>	
<b>MIN. INSTALLED WEIGHT PER SQUARE FOOT</b>		<b>MIN. INSTALLED WEIGHT PER SQUARE FOOT</b>		<b>MIN. INSTALLED WEIGHT PER SQUARE FOOT</b>	
<b>13</b>	<b>3 5/8</b>	<b>30</b> <b>30</b>	<b>9</b> <b>12</b>		

**KNEE WALLS IF R-VALUE IS OTHER THAN WALLS ABOVE**

MATERIAL <b>FIBERGLASS</b>	FORM <b>BATTS</b>	R VALUE	MANUFACTURER <b>OCF</b>
-------------------------------	----------------------	---------	----------------------------

**AIR INFILTRATION SEALANT**

MATERIAL <b>FOAM</b>	MANUFACTURER <b>W R GRACE</b>
-------------------------	----------------------------------

**THIS IS TO CERTIFY THAT INSULATION AND/OR SEALANT HAS BEEN INSTALLED IN CONFORMANCE WITH APPLICABLE CODES, MATERIAL STANDARDS AND REGULATIONS.**

SIGNATURE - INSULATION CONTRACTOR <i>[Signature]</i>	TITLE <b>MANAGER</b>	DATE <b>10-23-00</b>
SIGNATURE - GENERAL CONTRACTOR <i>[Signature]</i>	TITLE	DATE

REMARKS

20300

**KWIK KOTE**  
STUCCO SYSTEM  
**INSTALLATION CARD**

Job Address:

*Beazer Homes  
Reflector 101 309  
3874 Sawtooth Way, SHC*

Stucco System Trade Name: KWIK KOTE  
Name Stucco Manufacturer: KWIK KOTE CORP.

ICBO Evaluation Service, Inc.  
Report No. 3607  
Date of Job Completion

Kenyon Construction

Stucco Contractor  
Name John W. Kenyon, III  
Address P.O. Box 2077  
North Highlands, CA 95660  
(916) 349-8191  
Telephone Number  
Application Contractor Number as issued by the Stucco Manufacturer: 1

This is to certify that the stucco system on the building exterior at the above address has been installed in accordance with the installation report specified above and the manufacturer's instructions.

Signature of authorized representative of the contractor



Date

*11/20/00*

THIS PLAN IS PREPARED TO SHOW THE DIMENSIONAL RELATIONSHIP FROM BUILDING FOUNDATION TO PROPERTY LINE, DESIGN DRAINAGE CONTROL ELEVATIONS, AND DIRECTION OF DRAINAGE FLOW TO CONFORM WITH LOCAL ORDINANCES FOR THE PURPOSE OF BUILDING PERMIT ISSUANCE. INFORMATION SHOWN IS APPROXIMATE EXCEPT FOR THOSE SETBACKS WHICH ARE MINIMUMS REQUIRED BY ORDINANCE. THIS PLOT DOES NOT REFLECT AS BUILT CONDITIONS WHICH WILL LIKELY VARY FROM THIS PLAN.

SCALE: 1" = 20'

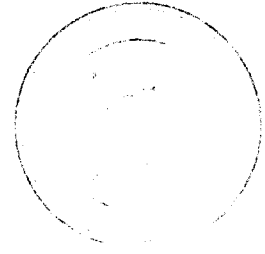
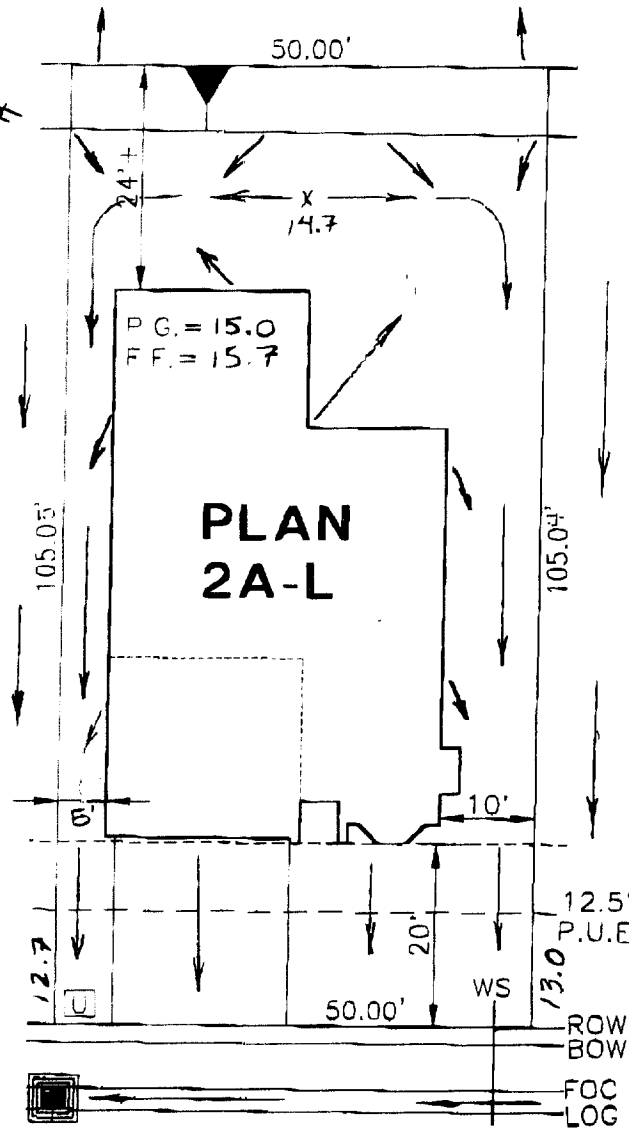

William Wood-Rodgers  
 Professional Engineer  
 State of California  
 No. 12345  
 My Commission Expires 12/31/05  
 I hereby certify that the above information is true and correct to the best of my knowledge and belief and that I am a duly licensed Professional Engineer in the State of California.

APPROVED	DATE
INITIALS	
<i>[Signature]</i>	

**SAINTSBURY WAY**

**U** UTILITY SERVICE BOX

PLOT PLAN  
**LOT 209**  
 GATEWAY WEST-VILLAGE NO. 1  
 FOR  
 BEAZER HOMES  
 SACRAMENTO CALIFORNIA

**WOOD-RODGERS INC.**

DATE: JULY 2000	DRAWN: HMB	CHECKED:	PROJECT NO: 98BEZ-009
--------------------	---------------	----------	--------------------------

LOT COVERAGE = 36%