



3.10

**DEPARTMENT OF
PUBLIC WORKS**

DEVELOPMENT SERVICES DIVISION

**CITY OF SACRAMENTO
CALIFORNIA**

Special Districts
1231 I Street, Room 300
SACRAMENTO, CA 95814
PH 916-264-7474
FAX 916-264-7480

April 11, 2003

City Council
Sacramento, California

Honorable Members in Session:

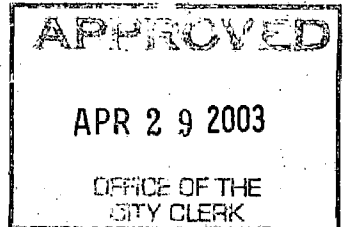

**SUBJECT: VILLAGE GARDEN MAINTENANCE DISTRICT - INITIATE ANNUAL
PROCEEDINGS (FY 2003/04)**

LOCATION AND COUNCIL DISTRICT:

The property is located in Council District #2 and includes Village Garden North Subdivision, Units 1 through 5. Village Garden North is located north of Main Avenue and west of Sully Street (see attachment A).

RECOMMENDATION:

This report recommends that the City Council adopt the following:

- Resolution Directing Filing of the Annual Report for FY2003/04 for the Village Garden Maintenance District.
- Resolution of Intention to Order Improvements for FY2003/04 for the Village Garden Maintenance District and set the public hearing date for May 20, 2003.

CONTACT PERSON:

Rita Goolkasian, Special Districts Analyst, 264-5236

FOR COUNCIL MEETING OF: April 29, 2003

SUMMARY:

The recommended Council action will initiate the annual proceedings for this year's annual report and set the public hearing date for May 20, 2003 (see attachment B). The annual assessment will increase from \$60 to \$70 per single-family residential unit. This amount is less than the original assessment approved by council at district formation.

COMMITTEE/COMMISSION ACTION:

None

BACKGROUND INFORMATION:

On December 8, 1987, the City Council adopted Resolution #87-1012 ordering the formation of the Village Garden North Landscaping and Lighting Assessment District. During the annual proceedings for FY 2001, Council changed the name of the District to Village Garden Maintenance District. The district provides funding to maintain landscaping for 208 residential lots.

Each year the City must adopt a new Engineer's Report and re-levy the assessments. This report presents the recommended Village Garden Maintenance District budget for FY 2003/04, the necessary assessments to perform the landscape maintenance and sets the public hearing for May 20, 2003 at the afternoon council meeting.

FINANCIAL CONSIDERATIONS:

The total cost to property owners in FY 2003/04 is projected at \$14,560. Maintenance costs will be assessed to the 208 residential lots within the district in the amount of \$70 per single-family residential lot. This amount is a 16.7% increase over the current assessment of \$60; however, it is still lower than the original assessment of \$100/residential unit or the maximum authorized annual assessment of \$20,800 approved by City Council at district formation. The increase is needed to cover increasing operating and administrative costs and to ensure the viability of a healthy fund balance for future needs.

The table below reflects the increased assessment to property owners and the offset needed from available surplus funds, which is projected to be \$23,670 at FY 2002/03 year-end.

FY 02/03 Assessed	FY03/04 Budget	Surplus Offset From Prior Year	FY03/04 Assessed
\$12,480	\$18,852	\$4,292	\$14,560

The costs are detailed in the Engineer's Report on file with the City Clerk. This maintenance district is self-supporting and has no impact on the general fund.

ENVIRONMENTAL CONSIDERATION:

Under California Environmental Quality Act (CEQA) Guidelines, administration and annual maintenance do not constitute a project and are therefore exempt from review.

POLICY CONSIDERATIONS:

These annual proceedings are being conducted in accordance with the Landscaping and Lighting Act of 1972, as set forth in Section 22500 of the Streets and Highways Code. Approving the annual district is consistent with the City's Strategic Plan in preserving and enhancing the City's neighborhood and quality of life.

ESBD CONSIDERATIONS:

Not applicable. No goods or services are being purchased.

Respectfully submitted,

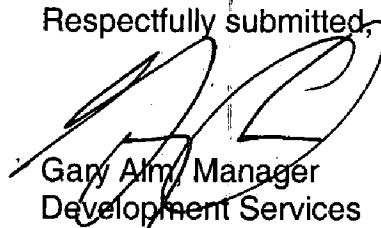

Gary Alm, Manager
Development Services

Recommendation Approved:



ROBERT P. THOMAS
City Manager

Approved:

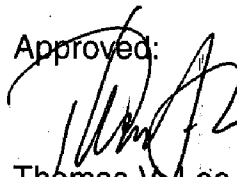

Thomas V. Lee
Deputy City Manager



TABLE OF CONTENTS:

1. Attachment A, map of Village Garden Maintenance District – pg.4
2. Attachment B, schedule of proceedings – pg.5
3. Resolution directing filing of Annual Report – pg.6
4. Resolution of intention, order of improvements – pg.7

ATTACHMENT A

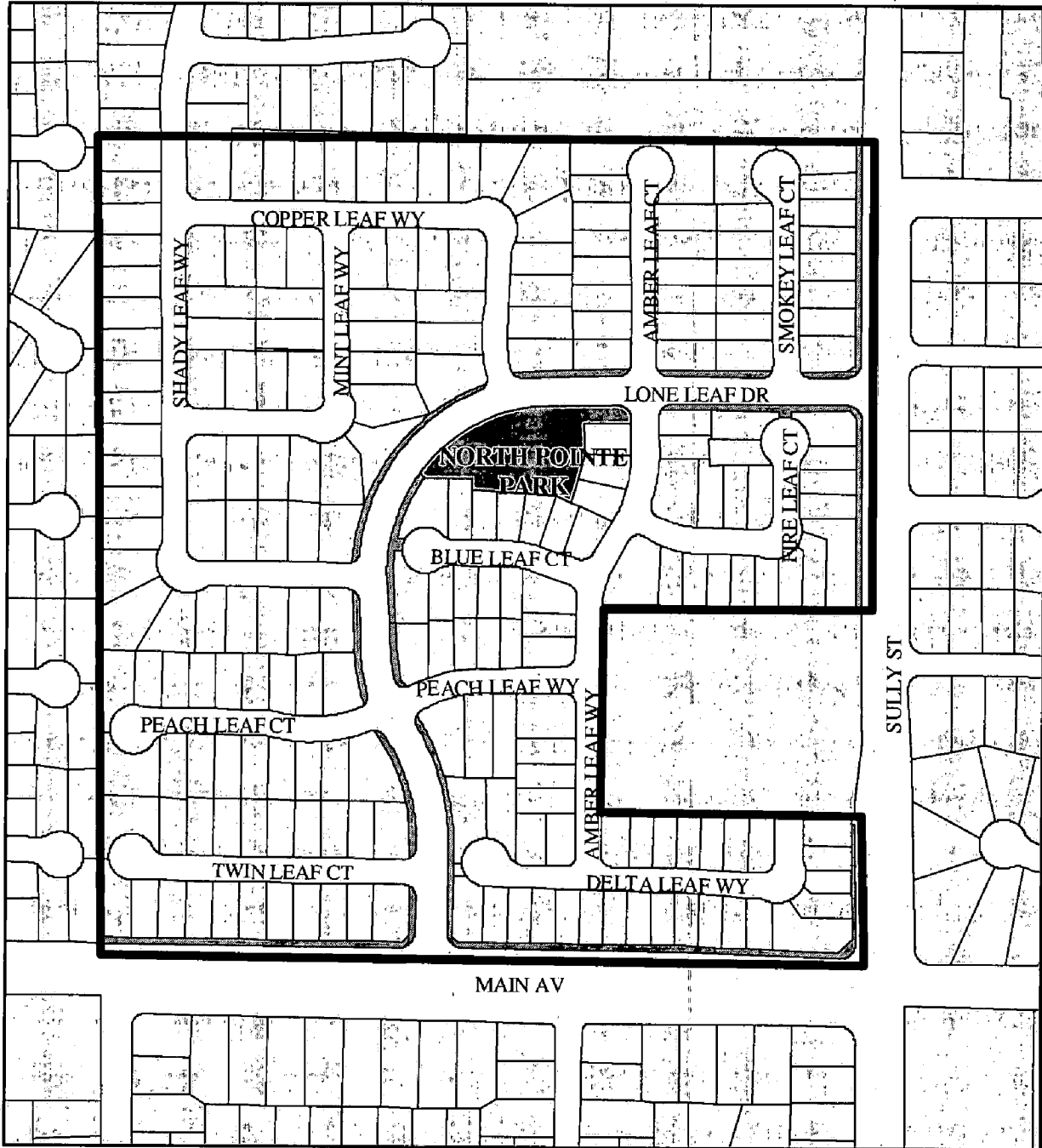
Village Garden Maintenance District Maintenance Area



-  Boundary
-  Maintenance Area

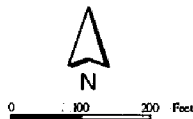

Department of
PUBLICWORKS
CITY OF SACRAMENTO
Development Services & Special Districts

S:\AGISnad83\SpecialDistrict\Maps\VillageGardnMaint.apr RLiu April03

ATTACHMENT B
VILLAGE GARDEN MAINTENANCE DISTRICT
FY 2003/04 SCHEDULE

April 29, 2003	Council Considers Resolution of Intention and Sets Date for Hearing
-----------------------	--

May 1, 2003 Publish Notice of Hearing

May 20, 2003 **Hold Hearing - Council Considers All Protests, Orders Annual Levy**

July, 2002 Assessments to County for Placement on Tax Roll

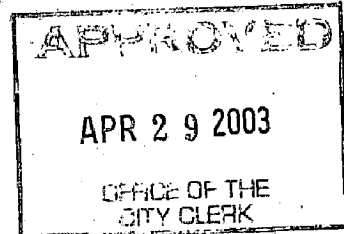

RESOLUTION NO. 2003-218

ADOPTED BY THE SACRAMENTO CITY COUNCIL

ON DATE OF _____

**RESOLUTION DIRECTING FILING OF ANNUAL REPORT FOR THE
VILLAGE GARDEN MAINTENANCE DISTRICT
(FY 2003/04)
(Pursuant to the Landscaping and Lighting Act of 1972)**

BE IT RESOLVED BY THE COUNCIL OF THE CITY OF SACRAMENTO:

- 1. The Director of Public Works, the person designated by this Council as the Engineer of Work for the Village Garden Maintenance District is hereby directed to file an annual report in accordance with the provisions of the Landscaping and Lighting Act of 1972.
- 2. This resolution is adopted pursuant to Section 22622 of the Streets and Highways Code.

MAYOR

ATTEST:

CITY CLERK

FOR CITY CLERK USE ONLY

RESOLUTION NO: _____
DATE ADOPTED: _____

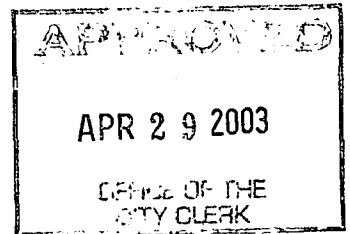

RESOLUTION NO. 2003-219

ADOPTED BY THE SACRAMENTO CITY COUNCIL

ON DATE OF _____

**RESOLUTION OF INTENTION TO ORDER IMPROVEMENTS
FOR THE VILLAGE GARDEN MAINTENANCE DISTRICT (FY 2003/04)
(Pursuant to the Landscaping and Lighting Act of 1972)**

1. The City Council intends to levy and collect assessments within the Village Garden Maintenance District during fiscal year 2003/04. The area of land to be assessed is located in the City of Sacramento, Sacramento County.
2. The maintenance of improvements to be made in this assessment district is generally described as follows:

The maintenance or servicing, or both, of any of the landscaping, water irrigation, and masonry wall, including (a) repair, removal, or replacement of all or part of any improvement, (b) the provision for the life, growth, health, and beauty of landscaping, including cultivation, irrigation, trimming, spraying, fertilizing, or treating for disease or injury, (c) the removal of trimmings, rubbish, debris, and other solid waste, and (d) the furnishing of water for the irrigation of any landscaping, the operation of any fountains, or the maintenance of any other improvements.

3. In accordance with this Council's resolution directing the filing of the annual report, the Engineer of Work has filed with the City Clerk the report required by the Landscaping and Lighting Act of 1972. All interested persons are referred to that report for a full and detailed description of the improvements, the boundaries of the assessment district, and the proposed assessments upon assessable lots and parcels of land with the assessment district.

FOR CITY CLERK USE ONLY

RESOLUTION NO: _____

DATE ADOPTED: _____

4. The City Council will conduct a public hearing on Tuesday, May 20, 2003 at 2:00 pm on the question of the levy of the proposed annual assessment. The hearing will be at the meeting place of the City Council located in the Interim City Hall, 730 I Street, 1st floor, Sacramento, California.
5. The City Clerk is authorized and directed to give notice of hearing as required by the Landscaping and Lighting Act of 1972.

MAYOR

ATTEST:

CITY CLERK

FOR CITY CLERK USE ONLY

RESOLUTION NO: _____

DATE ADOPTED: _____

From: "Barbara_Bennett" <Barbara_Bennett@dailyjournal.com>
To: "Laura Cuthbert" <LCuthbert@cityofsacramento.org>
Date: 5/8/03 7:42AM
Subject: ad no 9654

Hey Laura we will publish ad no 9654 on 5/9 as requested
Thanks

ENGINEER'S REPORT
FY 2003/04
VILLAGE GARDEN MAINTENANCE DISTRICT
(Pursuant to the Landscaping and Lighting Act of 1972)

The undersigned respectfully submits the enclosed report as directed by the City Council.

Dated: April 29, 2003

Director of Public Works
City of Sacramento, Engineer of Work

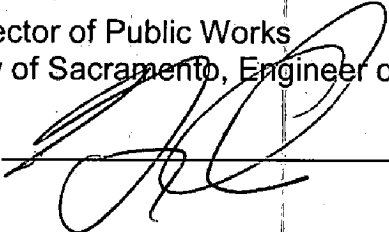
By: 

I HEREBY CERTIFY that the enclosed Engineer's Report together with Assessment and Assessment Diagram thereto attached, was filed with me on the 29th day of April, 2003.

for Valerie A. Burrowes, City Clerk
City of Sacramento, Sacramento County, California

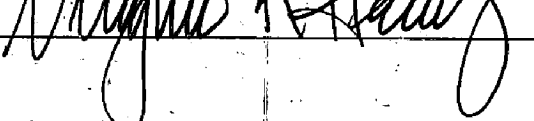
By: 

I HEREBY CERTIFY that the enclosed Engineer's Report, together with Assessment and Assessment Diagram thereto attached, was approved and confirmed by the City Council of the City of Sacramento, California, on the 20th day of May, 2003.

for Valerie A. Burrowes, City Clerk
City of Sacramento, Sacramento County, California

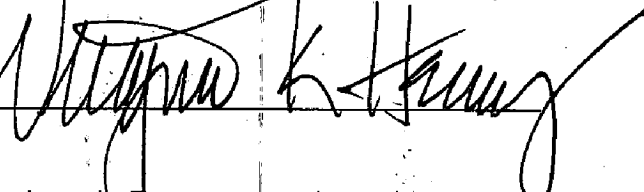
By: 

I HEREBY CERTIFY that the enclosed Engineer's Report, together with Assessment and Assessment Diagram thereto attached, was filed with the County Auditor of the County of Sacramento, California, on the 16th day of July, 2003.

for Valerie A. Burrowes, City Clerk
City of Sacramento, Sacramento County, California

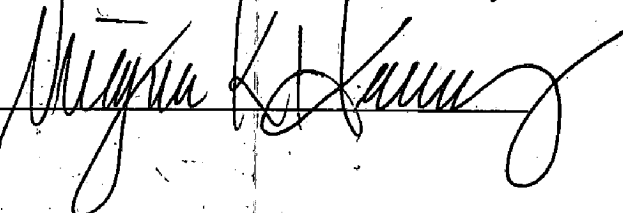
By: 

ENGINEER'S REPORT

VILLAGE GARDEN MAINTENANCE DISTRICT

Gary R. Alm, Engineer of Work for the Village Garden Maintenance District, City of Sacramento, Sacramento County, California, makes this report as directed by the City Council, pursuant to the Landscaping and Lighting Act of 1972 (Streets and Highways Code Section 22500, and following).

The maintenance, which is the subject of this report, is briefly described as follows:

Furnish all tools, equipment, apparatus, facilities, labor, material, supplies, and utilities necessary or desirable to maintain and service the landscape improvements as shown on Exhibit A, and more particularly described on plans and specifications approved by the City of Sacramento on file at the City of Sacramento, Department of Neighborhood Services, 1231 I Street, Room 400, Sacramento, California 95814.

The improvements generally consist of masonry walls; landscaping and irrigation systems for the landscape areas within or adjacent to the residential subdivisions identified on Exhibit A. Maintenance of said improvements will include, but not be limited to, periodic mowing of grass, trimming of trees and shrubs, and fertilizing, together with the regular furnishing of water for irrigation of all plant material, and the repair, maintenance, and replacement of the irrigation system, planted materials, and amenities. Maintenance of masonry walls includes periodic repair as required.

This report includes the following attached exhibits:

EXHIBIT A – Schematic diagram of the landscaping improvements.

EXHIBIT B – An estimate of the maintenance cost.

EXHIBIT C – An assessment roll showing the amount to be specifically assessed against each parcel of real property within this district. Each parcel is described by County Assessor's parcel number or other designation, and each parcel is also assigned a separate "assessment number" for the purposes of this report.



EXHIBIT D – A statement of the method by which the undersigned determined the amount of the proposed assessments to be assessed against each parcel, based on benefits to be derived by each parcel, from the maintenance of said improvements.

EXHIBIT E – A diagram showing all of the parcels of real property within this assessment district. The diagram is keyed to Exhibit C by assessment number.

Gary R. Alm
Engineer of Work

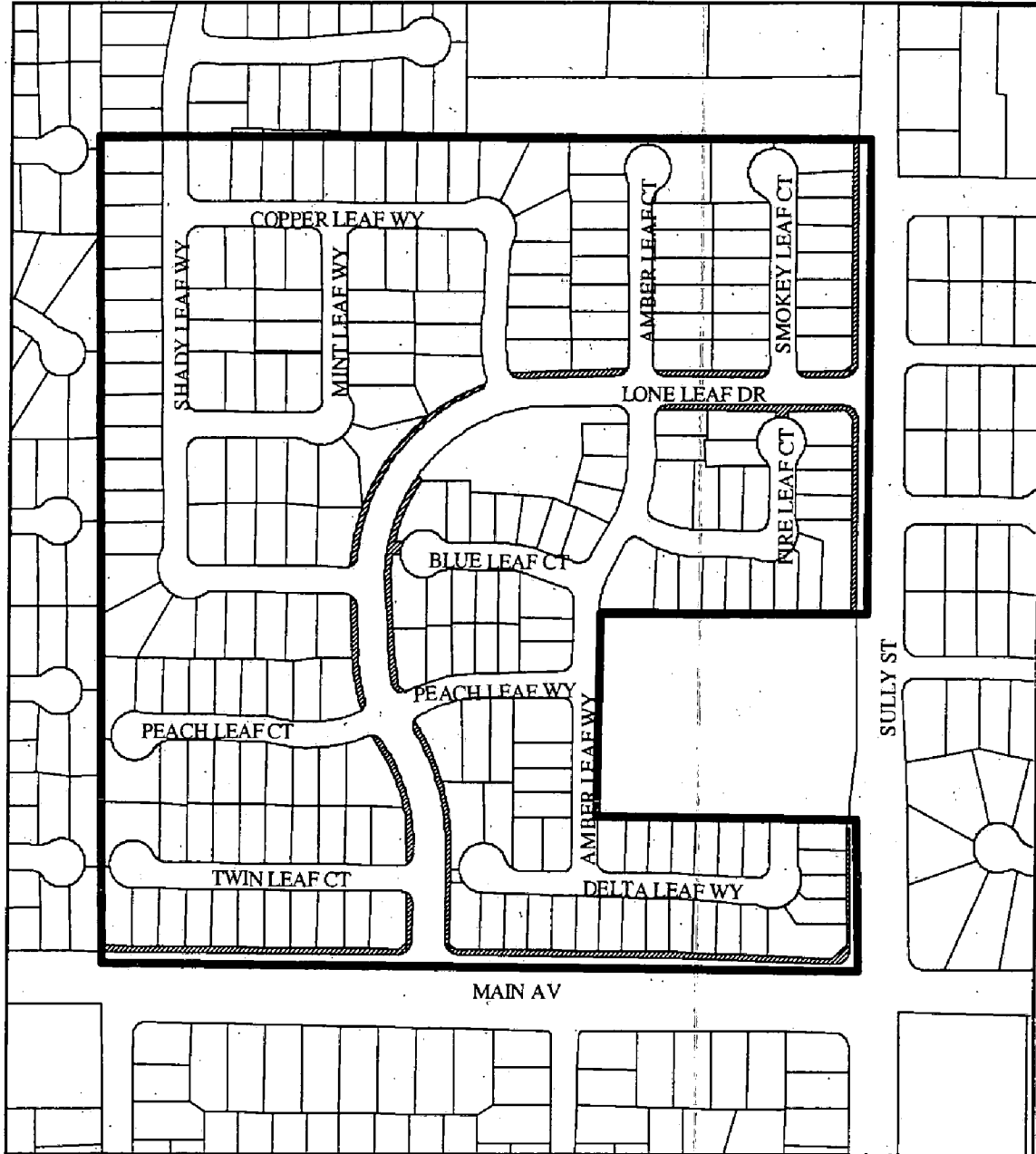
EXHIBIT A
Village Garden Maintenance District
Maintenance Area



-  Boundary
-  Maintenance Area

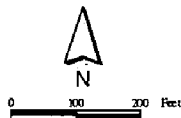

S:\GIS\Map83\Special Districts\Map83\Map83_VillageGardnMaint.apr RLin May 2002

EXHIBIT B
VILLAGE GARDEN MAINTENANCE DISTRICT
COST ESTIMATE FY 2003/04

<u>DESCRIPTION</u>	<u>ITEMIZED COST</u>
I. Maintenance Tasks	
Contract Maintenance	\$10,350
Unscheduled Maintenance	\$0
Utilities	\$0
Total Maintenance Tasks	\$10,350
II. Administration	
Contract (Streets)	\$4,780
Reporting (Special Districts)	\$2,500
Total Administration	\$7,280
III. Contingency	\$0
IV. Annual Billing & Administration	\$1,222
Total Budget	\$18,852
V. Fund Balance (Offset)	\$4,292
Total Assessment To Property Owners	\$14,560

EXHIBIT C
VILLAGE GARDEN NORTH LANDSCAPING
AND LIGHTING ASSESSMENT DISTRICT
ASSESSMENT ROLL FY 2003/2004

<u>Asmnt #</u>	<u>Assessor's Parcel No.</u>	<u>Assessment</u>
1	22603210240000	\$70.00
2	22603210280000	\$70.00
3	22603210290000	\$70.00
4	22603210310000	\$70.00
5	22603210320000	\$70.00
6	22603210330000	\$70.00
7	22603210340000	\$70.00
8	22603210350000	\$70.00
9	22603210360000	\$70.00
10	22603210370000	\$70.00
11	22603210390000	\$70.00
12	22603210400000	\$70.00
13	22603210410000	\$70.00
14	22603210420000	\$70.00
15	22603210430000	\$70.00
16	22603210440000	\$70.00
17	22603210450000	\$70.00
18	22603210460000	\$70.00
19	22603210470000	\$70.00
20	22603210480000	\$70.00
21	22603210490000	\$70.00
22	22603210500000	\$70.00
23	22603210510000	\$70.00
24	22603210520000	\$70.00
25	22603210530000	\$70.00
26	22603210550000	\$70.00
27	22603210560000	\$70.00
28	22603210570000	\$70.00
29	22603210580000	\$70.00
30	22603210590000	\$70.00
31	22603210600000	\$70.00
32	22603210610000	\$70.00
33	22603210620000	\$70.00
34	22603210630000	\$70.00
35	22603210640000	\$70.00
36	22603210650000	\$70.00
37	22603210660000	\$70.00
38	22603210670000	\$70.00
39	22603210680000	\$70.00
40	22603210690000	\$70.00
41	22603210770000	\$70.00
42	22603210780000	\$70.00
43	22603210790000	\$70.00
44	22603210800000	\$70.00

EXHIBIT C
VILLAGE GARDEN NORTH LANDSCAPING
AND LIGHTING ASSESSMENT DISTRICT
ASSESSMENT ROLL FY 2003/2004

<u>Asmnt #</u>	<u>Assessor's Parcel No.</u>	<u>Assessment</u>
45	22603210810000	\$70.00
46	22603220010000	\$70.00
47	22603220020000	\$70.00
48	22603220030000	\$70.00
49	22603220040000	\$70.00
50	22603220050000	\$70.00
51	22603220070000	\$70.00
52	22603220080000	\$70.00
53	22603220090000	\$70.00
54	22603220100000	\$70.00
55	22603220110000	\$70.00
56	22603220120000	\$70.00
57	22603220130000	\$70.00
58	22603230020000	\$70.00
59	22603230030000	\$70.00
60	22603230040000	\$70.00
61	22603230050000	\$70.00
62	22603230060000	\$70.00
63	22603230070000	\$70.00
64	22603230080000	\$70.00
65	22603230090000	\$70.00
66	22603230100000	\$70.00
67	22603230110000	\$70.00
68	22603230130000	\$70.00
69	22603230140000	\$70.00
70	22603230150000	\$70.00
71	22603230160000	\$70.00
72	22603230170000	\$70.00
73	22603230180000	\$70.00
74	22603230190000	\$70.00
75	22603230200000	\$70.00
76	22603230210000	\$70.00
77	22603230220000	\$70.00
78	22603230230000	\$70.00
79	22603240120000	\$70.00
80	22603240130000	\$70.00
81	22603240140000	\$70.00
82	22603240150000	\$70.00
83	22603240160000	\$70.00
84	22603240170000	\$70.00
85	22603250010000	\$70.00
86	22603250020000	\$70.00
87	22603250030000	\$70.00
88	22603250040000	\$70.00

EXHIBIT C

VILLAGE GARDEN NORTH LANDSCAPING
AND LIGHTING ASSESSMENT DISTRICT
FY 2003/2004

<u>Asmnt #</u>	<u>Assessor's Parcel No.</u>	<u>Assessment</u>
89	22603250050000	\$70.00
90	22603250060000	\$70.00
91	22603250070000	\$70.00
92	22603250080000	\$70.00
93	22603250090000	\$70.00
94	22603250100000	\$70.00
95	22603250110000	\$70.00
96	22603250120000	\$70.00
97	22603250130000	\$70.00
98	22603250190000	\$70.00
99	22603250230000	\$70.00
100	22603250240000	\$70.00
101	22603250250000	\$70.00
102	22603250260000	\$70.00
103	22603250270000	\$70.00
104	22603250280000	\$70.00
105	22603250290000	\$70.00
106	22603260010000	\$70.00
107	22603260020000	\$70.00
108	22603260030000	\$70.00
109	22603260040000	\$70.00
110	22603260050000	\$70.00
111	22603260060000	\$70.00
112	22603260070000	\$70.00
113	22603260080000	\$70.00
114	22603260090000	\$70.00
115	22603260100000	\$70.00
116	22603260110000	\$70.00
117	22603260120000	\$70.00
118	22603260130000	\$70.00
119	22603260140000	\$70.00
120	22603260150000	\$70.00
121	22603260160000	\$70.00
122	22603260170000	\$70.00
123	22603300010000	\$70.00
124	22603300020000	\$70.00
125	22603300030000	\$70.00
126	22603300040000	\$70.00
127	22603300050000	\$70.00
128	22603300060000	\$70.00
129	22603300070000	\$70.00
130	22603300090000	\$70.00
131	22603300100000	\$70.00
132	22603300110000	\$70.00

EXHIBIT C

VILLAGE GARDEN NORTH LANDSCAPING
AND LIGHTING ASSESSMENT DISTRICT
FY 2003/2004

<u>Asmnt #</u>	<u>Assessor's Parcel No.</u>	<u>Assessment</u>
133	22603300120000	\$70.00
134	22603300130000	\$70.00
135	22603300140000	\$70.00
136	22603300150000	\$70.00
137	22603300160000	\$70.00
138	22603300170000	\$70.00
139	22603300180000	\$70.00
140	22603300190000	\$70.00
141	22603300210000	\$70.00
142	22603300220000	\$70.00
143	22603300230000	\$70.00
144	22603300240000	\$70.00
145	22603300250000	\$70.00
146	22603300260000	\$70.00
147	22603300270000	\$70.00
148	22603300290000	\$70.00
149	22603300300000	\$70.00
150	22603300310000	\$70.00
151	22603300320000	\$70.00
152	22603300330000	\$70.00
153	22603300340000	\$70.00
154	22603300350000	\$70.00
155	22603300360000	\$70.00
156	22603300370000	\$70.00
157	22603300380000	\$70.00
158	22603300390000	\$70.00
159	22603300430000	\$70.00
160	22603300440000	\$70.00
161	22603300450000	\$70.00
162	22603300460000	\$70.00
163	22603300470000	\$70.00
164	22603300480000	\$70.00
165	22603300490000	\$70.00
166	22603300500000	\$70.00
167	22603300510000	\$70.00
168	22603300520000	\$70.00
169	22603300540000	\$70.00
170	22603300550000	\$70.00
171	22603300560000	\$70.00
172	22603300570000	\$70.00
173	22603300580000	\$70.00
174	22603300590000	\$70.00
175	22603300600000	\$70.00
176	22603300610000	\$70.00

EXHIBIT C

VILLAGE GARDEN NORTH LANDSCAPING
AND LIGHTING ASSESSMENT DISTRICT
FY 2003/2004

<u>Asmnt #</u>	<u>Assessor's Parcel No.</u>	<u>Assessment</u>
177	22603300620000	\$70.00
178	22603300630000	\$70.00
179	22603300650000	\$70.00
180	22603300660000	\$70.00
181	22603300670000	\$70.00
182	22603300680000	\$70.00
183	22603300690000	\$70.00
184	22603300700000	\$70.00
185	22603300710000	\$70.00
186	22603300720000	\$70.00
187	22603300730000	\$70.00
188	22603300740000	\$70.00
189	22603300750000	\$70.00
190	22603300760000	\$70.00
191	22603300770000	\$70.00
192	22603300780000	\$70.00
193	22603300790000	\$70.00
194	22603300800000	\$70.00
195	22603300810000	\$70.00
196	22603300820000	\$70.00
197	22603300850000	\$70.00
198	22603300860000	\$70.00
199	22603300870000	\$70.00
200	22603300880000	\$70.00
201	22603300890000	\$70.00
202	22603300900000	\$70.00
203	22603300910000	\$70.00
204	22603600120000	\$70.00
205	22603600130000	\$70.00
206	22603600140000	\$70.00
207	22603600150000	\$70.00
208	22603600160000	\$70.00
	208	\$14,560.00

EXHIBIT D

METHOD OF SPREADING ASSESSMENTS

Each benefited residential lot in the Village Garden Maintenance District is determined to have equal benefit from the landscaping improvements and maintenance thereof. Therefore, each parcel is assessed in proportion to the total number of parcels in the district.

EXHIBIT E

ASSESSMENT DIAGRAM

The assessment district boundary coincides with the boundaries of Village Garden North Subdivision Units one through five. The subdivision maps were recorded and are on file with the Sacramento County Recorder's Office.

The Sacramento County Assessor's maps are incorporated by reference into the attached Assessment Diagram. The lines and dimensions of lots or parcels for the diagram are those lines and dimensions shown on the assessor's maps, which are on file and open to public inspection at the Sacramento County Assessor's Office. The distinctive designation of each lot or parcel shall be its assessor's parcel number.

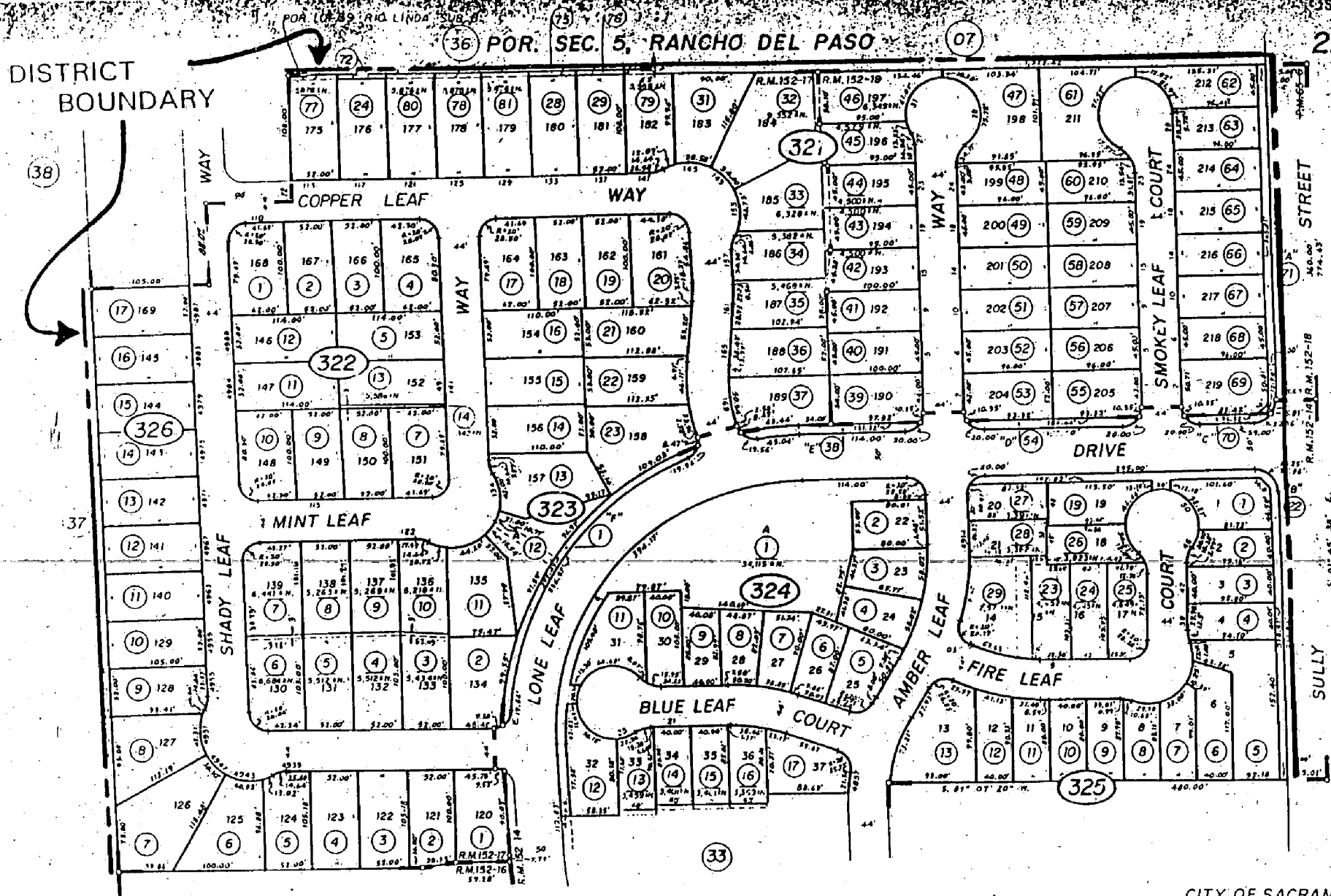

SANTA ANA AVENUE

EXHIBIT E

Por. Village Garden North Unit No. 1, R.M. Bk. 152, Pg. 14 (6-3-83)
 Village Garden North Unit No. 4, R.M. Bk. 152, Pg. 17 (6-3-83)
 Village Garden North Unit No. 5, R.M. Bk. 152, Pg. 18 (6-3-83)

CITY OF SACRAMENTO
 Assessor's Map Bk. 226, Pg. 32
 County of Sacramento, Calif.

POR. SEC. 5, RANCHO DEL PASO

226-33

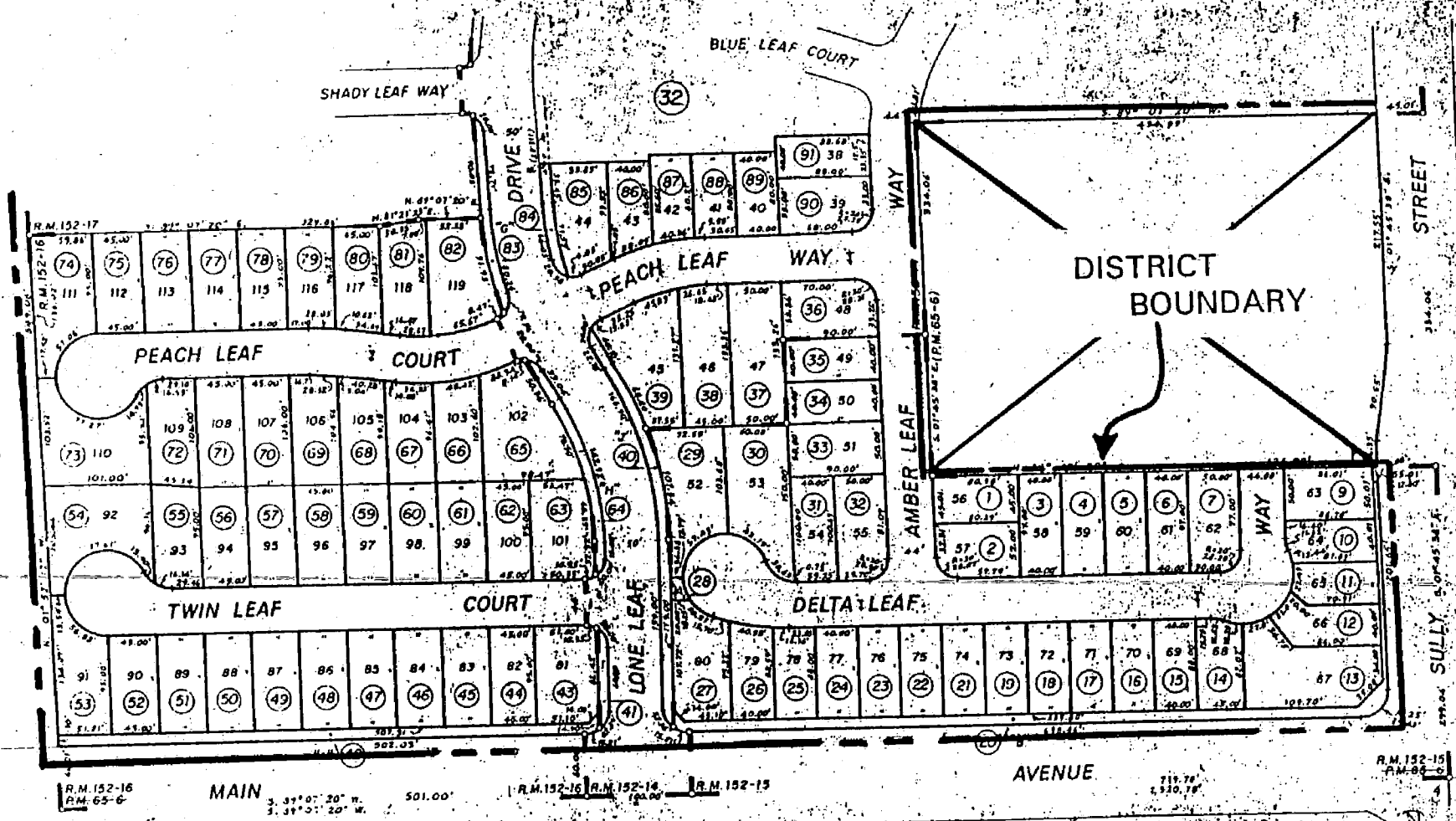

EXHIBIT E

Bk. 237

Por. Village Garden North Unit No. 1, R.M. Bk. 152, Pg. 14 (6-3-83)
 Village Garden North Unit No. 2, R.M. Bk. 152, Pg. 15 (6-3-83)
 Village Garden North Unit No. 3, R.M. Bk. 152, Pg. 16 (6-3-83)

CITY OF SACRAMENTO
 Assessor's Map Bk. 226, Pg. 33
 County of Sacramento, Calif.

POR. SE 1/4 SEC. 5, RANCHO DEL PASO

OCT 15 1980
226-36

07

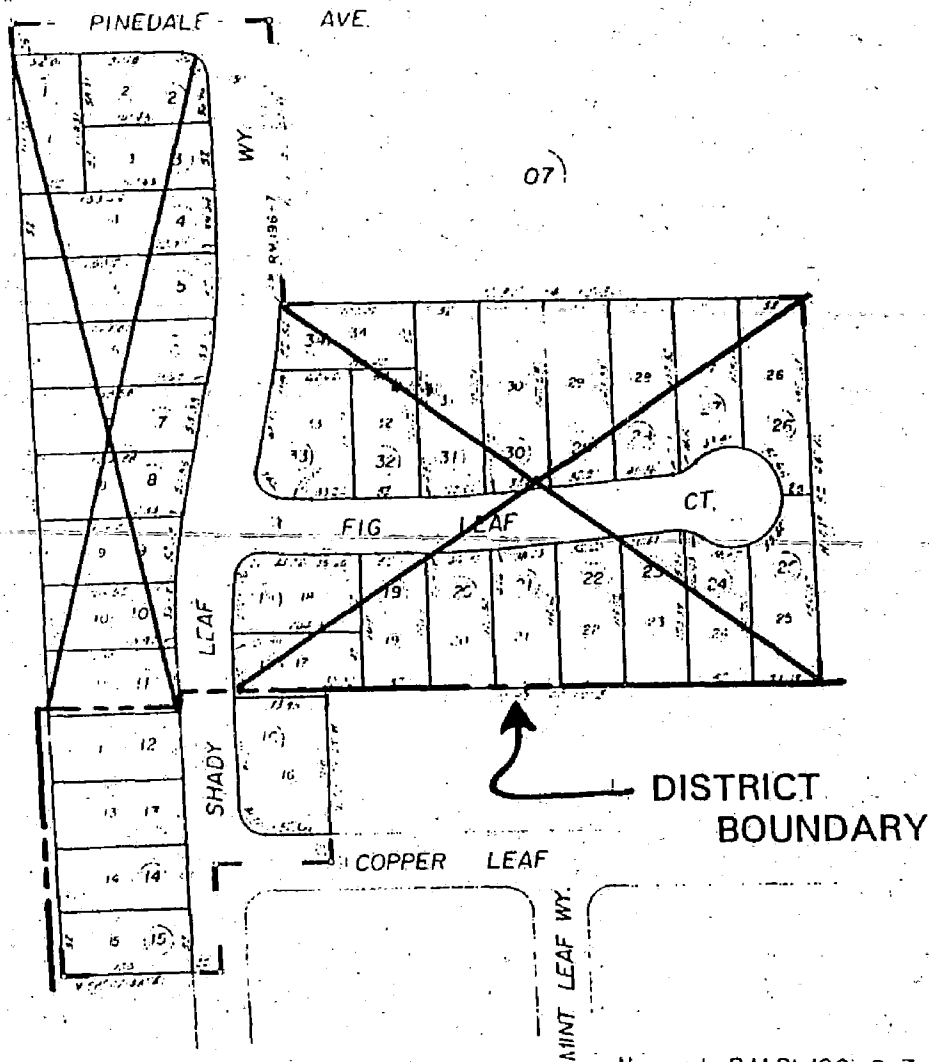

07

07

EXHIBIT E

Norwood, R.M.Bk. 196, Pg. 7 (A-10-89)

CITY OF SACRAMENTO
Assessor's Map Bk. 226 Pg. 3
County of Sacramento, Calif

THE DAILY RECORDER

~ SINCE 1911 ~

901 H Street, Suite 312, P.O. Box 1048, Sacramento, California 95812
Telephone (916) 444-2355 / Fax (916) 444-0636

SAC. CITY CLERK
730 I ST #211
SACRAMENTO, CA 95814

COPY OF NOTICE

Notice Type: GSR SAC CITY RESOLUTION-1 PUB

Ad Description: AD NO 9654

To the right is a copy of the notice you sent to us for publication in THE DAILY RECORDER. Thank you for using our newspaper. Please read this notice carefully and call us with any corrections. The Proof of Publication will be filed with the County Clerk, if required, and mailed to you after the last date below. Publication date(s) for this notice is (are):

05/09/03

The charge(s) for this order is as follows. An invoice will be sent after the last date of publication. If you prepaid this order in full, you will not receive an invoice.

Publication	\$ 35.16
NetTotal	\$ 35.16

SC#: 535624

RESOLUTION NO. 2003-219
ADOPTED BY THE SACRAMENTO
CITY COUNCIL
ON DATE OF APRIL 29, 2003
RESOLUTION OF INTENTION TO
ORDER IMPROVEMENTS FOR THE
VILLAGE GARDEN MAINTENANCE
DISTRICT (FY 2003/04)
(Pursuant to the Landscaping and
Lighting Act of 1972)

1. The City Council intends to Levy and collect assessments within the Village Garden Maintenance District during fiscal year 2003/04. The area of land to be assessed is located in the City of Sacramento, Sacramento County.
2. The maintenance of improvements to be made in this assessment district is generally described as follows:
The maintenance or servicing, or both, of any of the landscaping, water irrigation, and masonry wall, including (a) repair, removal, or replacement of all or part of any improvement, (b) the provision for the life, growth, health, and beauty of landscaping, including cultivation, irrigation, trimming, spraying, fertilizing, or treating for disease or injury, (c) the removal of trimmings, rubbish debris, and other solid waste, and (d) the furnishing of water for the irrigation of any landscaping, the operation of any fountains, or the maintenance of any other improvements.
3. In accordance with this Council's resolution directing the filing of the annual report, the Engineer of Work has filed with the City Clerk the report required by the Landscaping and Lighting Act of 1972. All interested persons are referred to that report for a full and detailed description of the improvements, the boundaries of the assessment district, and the proposed assessments upon assessable lots and parcels of land with the assessment district.
4. The City Council will conduct a public hearing on Tuesday, May 20, 2003 at 2:00 pm on the question of the levy of the proposed annual assessment. The hearing will be at the meeting place of the City Council located in the Interim City Hall, 730 I Street, 1st Floor, Sacramento, California.
5. The City Clerk is authorized and directed to give notice of hearing as required by the Landscaping and Lighting Act of 1972.

Mayor
ATTEST:

City Clerk
Ad No. 9654
05/09/03

SC- 535624#

Daily Journal Corporation

Serving your legal advertising needs throughout California. Call your local office.

(Sacramento) Daily Recorder	(916) 444-2355
Antelope Valley Journal	(661) 947-5009
Daily Commerce (Los Angeles) The	(213) 229-5300
Orange County Reporter	(714) 543-2027
Riverside Business Journal	(909) 784-0111
San Diego Commerce	(619) 232-3486
San Francisco Daily Journal	(415) 252-0500
San Jose Post-Record	(408) 287-4866
Sonoma County Herald-Recorder	(707) 545-1166
The Los Angeles Daily Journal	(213) 229-5300
The (Oakland) Inter-City Express	(510) 272-4747