

CITY OF SACRAMENTO

Permit No: 0309968

1231 I Street, Sacramento, CA 95814

Insp Area: I  
Thos Bros: 297 F4

Site Address: 2708 F ST SAC

Parcel No: 003-0201-005

DESIGN REVIEW

Sub-Type: REP  
Housing (Y/N): N

CONTRACTOR

OWNER

JURICH RICHARD A  
2708 F ST  
SACRAMENTO CA 95816

ARCHITECT

Nature of Work: REPAIR PORCH ROOF STRUCTURE LOCATED AT BACK OF HOUSE

CONSTRUCTION LENDING AGENCY : I hereby affirm under penalty of perjury that there is a construction lending agency for the performance of the work for which this permit is issued (Sec. 3097, Civ. C).

Lender's Name \_\_\_\_\_ Lender's Address \_\_\_\_\_

LICENSED CONTRACTORS DECLARATION: I hereby affirm under penalty of perjury that I am licensed under provisions of Chapter 9 (commencing with section 7000) of Division 3 of the Business and Professions Code and my license is in full force and effect.

License Class \_\_\_\_\_ License Number \_\_\_\_\_ Date \_\_\_\_\_ Contractor Signature \_\_\_\_\_

OWNER-BUILDER DECLARATION: I hereby affirm under penalty of perjury that I am exempt from the contractors License Law for the following reason (Sec. 7031.5, Business and Professions Code; any city or county which requires a permit to construct, alter, improve, demolish, or repair any structure, prior to its issuance, also requires the applicant for such permit to file a signed statement that he or she is licensed pursuant to the provisions of the Contractors License Law (Chapter 9 (commencing with Section 7000) of Division 8 of the Business and Professions Code) or that he or she is exempt therefrom and the basis for the alleged exemption. Any violation of Section 7031.5 by any applicant for a permit subjects the applicant to a civil penalty of not more than five hundred dollars (\$500.00);

*RJ* I, as a owner of the property, or my employees with wages as their sole compensation, will do the work, and the structure is not intended or offered for sale (Sec. 7044, Business and Professional Code: The Contractors License Law does not apply to an owner of property who builds or improves thereon, and who does such work himself or herself or through his/her own employees, provided that such improvements are not intended or offered for sale. If, however, the building or improvement is sold within one year of completion, the owner-builder will have the burden of proving that he/she did not build or improve for the purpose of sale.)

I, as owner of the property, am exclusively contracting with licensed contractors to construct the project (Sec. 7044, Business and Professions Code: The Contractors License Law does not apply to an owner of property who builds or improves thereon, and who contracts for such projects with a contractor(s) licensed pursuant to the Contractors License Law).

I am exempt under Sec. \_\_\_\_\_ B & PC for this reason: \_\_\_\_\_  
Date July 8<sup>th</sup>, 2003 Owner Signature Rich Jurich

IN ISSUING THIS BUILDING PERMIT, the applicant represents, and the city relies on the representation of the applicant, that the applicant verified all measurements and locations shown on the application or accompanying drawings and that the improvement to be constructed does not violate any law or private agreement relating to permissible or prohibited locations for such improvements. This building permit does not authorize any illegal location of any improvement or the violation of any private agreement relating to location of improvements.

I certify that I have read this application and state that all information is correct. I agree to comply with all city and county ordinances and state laws relating to building construction and hereby authorize representative(s) of this city to enter upon the abovementioned property for inspection purposes.

Date July 8<sup>th</sup>, 2003 Applicant/Agent Signature Rich Jurich

WORKER'S COMPENSATION DECLARATION: I hereby affirm under penalty of perjury one of the following declarations:

I have and will maintain a certificate of consent to self-insure for workers' compensation as provided for by Section 3700 of the Labor Code, for the performance of work for which the permit is issued.

I have and will maintain workers' compensation insurance, as required by Section 3700 of the Labor Code, for the performance of the work for which this permit is issued. My workers' compensation insurance carrier and policy number are:

Carrier \_\_\_\_\_ Policy Number \_\_\_\_\_ Exp Date \_\_\_\_\_

*RJ* (This section need not be completed if the permit is for \$100,000 or less). I certify that in the performance of the work for which this permit is issued, I shall not employ any person in any manner so as to become subject to the workers' compensation laws of California and agree that if I should become subject to the workers' compensation provisions of Section 3700 of the Labor Code, I shall forthwith comply with those provisions.

Date July 8<sup>th</sup>, 2003 Applicant Signature Rich Jurich

WARNING: FAILURE TO SECURE WORKER'S COMPENSATION COVERAGE IS UNLAWFUL AND SHALL SUBJECT AN EMPLOYER TO CRIMINAL PENALTIES AND CIVIL FINES UP TO ONE HUNDRED THOUSAND DOLLARS (\$100,000) IN ADDITION TO THE COST OF COMPENSATION, DAMAGES AS PROVIDED FOR IN SECTION 3706 OF THE LABOR CODE, INTEREST AND ATTORNEY'S FEE.

THIS PERMIT SHALL EXPIRE BY LIMITATION IF WORK IS NOT COMMENCED WITHIN 180 DAYS.

OWNER-BUILDER VERIFICATION

ATTENTION PROPERTY OWNERS

An owner-builder building permit has been applied for in your name and bearing your signature.

Please complete and return this information in the envelope provided at your earliest opportunity to avoid unnecessary delay in processing and issuing your building permit. No building permit will be issued until this verification is received.

1. I personally plan to provide the major labor and materials for construction of the proposed Improvement (yes or no) yes
2. I (have/have not) have signed an application for A building permit for the proposed work.

3. I have contracted with the following person (firm) to provide the proposed construction:

Name \_\_\_\_\_ Address \_\_\_\_\_

City \_\_\_\_\_ Telephone \_\_\_\_\_

Contractors License No. \_\_\_\_\_

4. I plan to provide portions of the work, but I have hired the following person to coordinate, Supervise, and provide the major work.

Name \_\_\_\_\_ Address \_\_\_\_\_

City \_\_\_\_\_ Telephone \_\_\_\_\_

Contractors License No. \_\_\_\_\_

I will provide some of the work but I have contracted (hired) the following to provide the Work indicated:

Name	Address	Phone	Type of work

Signed Rick Jaramila

Job Address 2798 F Street

Permit No: \_\_\_\_\_

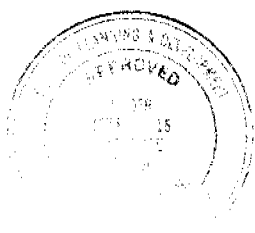

This set of plans and specifications must be kept on the job at all times and it is unlawful to make any changes or alterations to the same without written permission of the Building Department.

1/187 66L 30 YEAR  
1 AM IN AREA  
DIMENSIONAL COMP

2 X 4 RAFTERS @ 24" o.c.  
w/ 3/16" minimum CK ROOF  
DECK  
148"

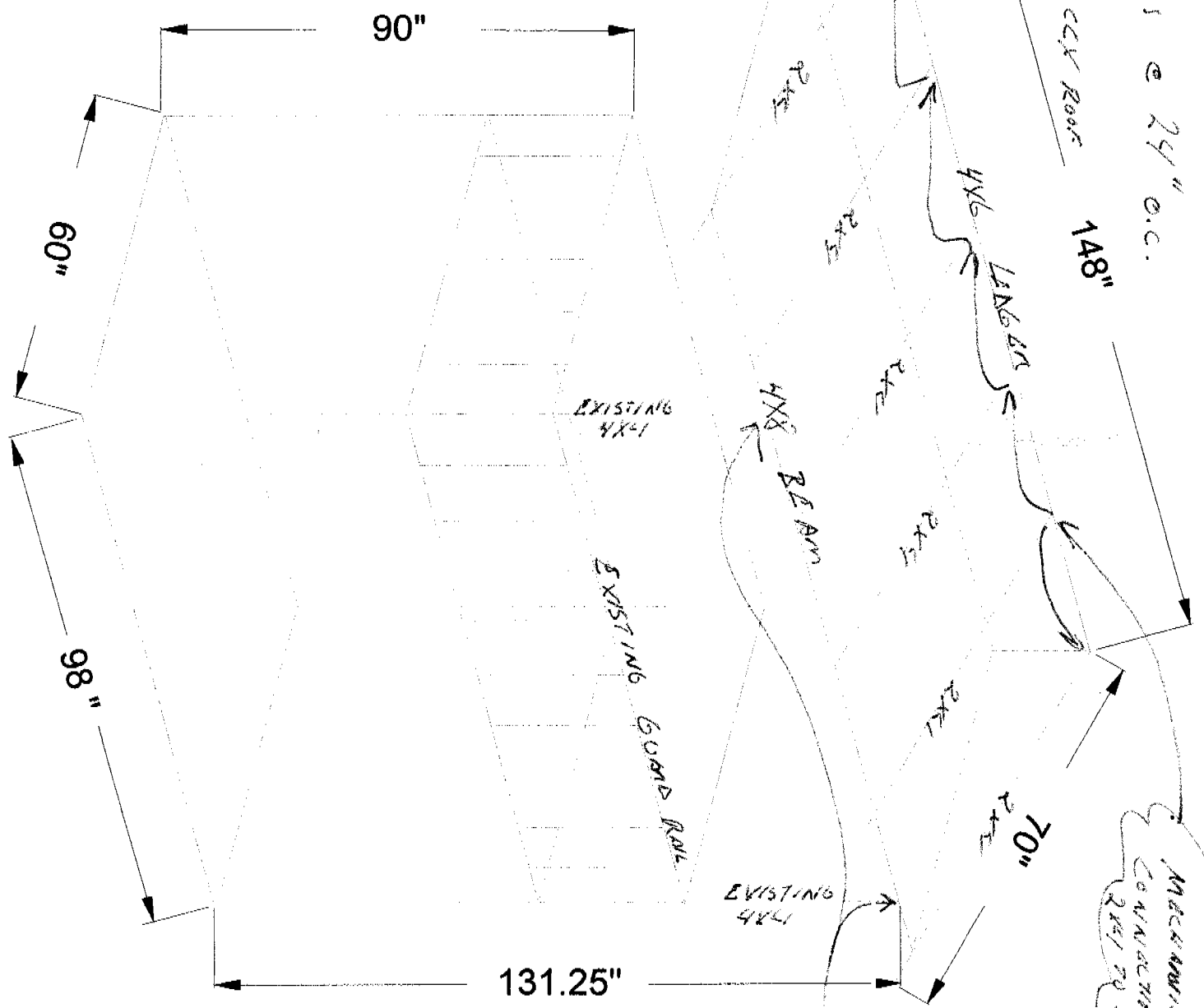

Mechanical  
CONNECTION  
2x4 TO JOIST

Positive  
JOIST TO  
BEAM  
CONNECTION

CITY COPY

ISSUED

JUL 0 8 2003

Sacramento Building Division

CITY OF SACRAMENTO  
PERMIT ASSISTANCE

JUL 07 2003

**RECEIVED**



CITY OF SACRAMENTO  
PLANNING AND BUILDING DEPARTMENT

BUILDING INSPECTIONS DIVISION

Phone: 916-808-5716  
Fax: 916-808-8370



Downtown Permit Center  
1231 I Street, #200  
Sacramento, CA 95814

North Permit Center  
2101 Arena Blvd., #200  
Sacramento, CA 95834

January 17, 2004

JURICH RICHARD A  
2708 F ST  
SACRAMENTO CA 95816

Subject: PERMIT EXPIRATION

Permit Due to Expire on: <sup>Feb-18</sup> ~~January 04, 2004~~  
Inspection Area: 1

Property at: 2708 F ST  
Activity #: 0309968  
Issued: July 08, 2003

Owner: JURICH RICHARD A  
Contractor:

Nature of Work: REPAIR PORCH ROOF STRUCTURE LOCATED AT BACK OF HOUSE

Your attention is directed to the current status of your permit: **ISSUED**

Each building permit issued by the Planning and Building Department shall expire by limitation and become null and void if the building or work authorized by such permit is not commenced within 180 days from the date of such permit, or if the building or work authorized by such permit is suspended or abandoned at any time after the work is commenced for a period of 180 days.

**Our files show no progress on your permit. You must call 916-264-7622 for a progress or final inspection BEFORE the above permit expiration date. If we do not hear from you, we will assume this project has been abandoned and therefore consider your permit expired.**

You are further notified that once this permit has expired, a **NEW PERMIT** must be obtained before any further work is done and you will be required to make any changes necessary to meet the requirements of the present Sacramento City Code.

By:     *Rm*      
Building Inspections Division

*OK to close  
RMB*