

CITY OF SACRAMENTO
1231 I Street, Sacramento, CA 95814

Permit No: 9713866
Insp Area: 2

Site Address: 6381 CHESTERBROOK DR SAC
Parcel No: 1171260052 L52/ARLINGTON PARK #2
N

Sub-Type: NSFR
Housing (Y/N):

CONTRACTOR

M J BROCK & SONS
3350 WATT AV #D
SACRAMENTO CA 95821
Phone: 916-488-4500

OWNER

M J BROCK/SONS INC
3350 WATT AV D
SACRAMENTO CA 95821
Phone: 916-488-4500

ARCHITECT

Phone:

Nature of Work: NEW HOME

CONSTRUCTION LENDING AGENCY : I hereby affirm under penalty of perjury that there is a construction lending agency for the performance of the work for which this permit is issued (Sec. 3097, Civ. C).

Lender's Name _____ Lender's Address _____

LICENSED CONTRACTORS DECLARATION: I hereby affirm under penalty of perjury that I am licensed under provisions of Chapter 9 (commencing with section 7000) of Division 3 of the Business and Professions Code and my license is in full force and effect.

License Class B License Number 054648 Date 10/14/97 Contractor Signature Deanna Collins

OWNER-BUILDER DECLARATION: I hereby affirm under penalty of perjury that I am exempt from the contractors License Law for the following reason (Sec. 7031.5, Business and Professions Code; any city or county which requires a permit to construct, alter, improve, demolish, or repair any structure, prior to its issuance, also requires the applicant for such permit to file a signed statement that he or she is licensed pursuant to the provisions of the Contractors License Law (Chapter 9 (commencing with Section 7000) of Division 8 of the Business and Professions Code) or that he or she is exempt therefrom and the basis for the alleged exemption. Any violation of Section 7031.5 by any applicant for a permit subjects the applicant to a civil penalty of not more than five hundred dollars (\$500.00);

____ I, as a owner of the property, or my employees with wages as their sole compensation, will do the work, and the structure is not intended or offered for sale (Sec. 7044, Business and Professional Code: The Contractors Law does not apply to an owner of property who builds or improves thereon, and who does such work himself or herself or through his or her own employees, provided that such improvements are not intended or offered for sale. If, however, the building or improvement is sold within one year of completion, the owner-builder will have the burden of proving that he or she did not build or improve for the purpose of sale.)

____ I, as owner of the property, am exclusively contracting with licensed contractors to construct the project (Sec. 7044, Business and Professions Code: The contractors License Law does not apply to an owner of property who builds or improves thereon, and who contracts for such projects with a contractor(s) licensed pursuant to the Contractors License Law).

____ I am exempt under Sec. _____ B & PC for this reason: _____

Date _____ Owner Signature _____

IN ISSUING THIS BUILDING PERMIT, the applicant represents, and the city relies on the representation of the applicant, that the applicant verified all measurements and locations shown on the application or accompanying drawings and that the improvement to be constructed does not violate any law or private agreement relating to permissible or prohibited locations for such improvements. This building permit does not authorize any illegal location of any improvement or the violation of any private agreement relating to location of improvements.

Date 10/14/97 Applicant/Agent Signature Deanna Collins

WORKER'S COMPENSATION DECLARATION: I hereby affirm under penalty of perjury one of the following declarations:

____ I have and will maintain a certificate of consent to self-insure for workers' compensation as provided for by Section 3700 of the Labor Code, for the performance of work for which the permit is issued.

____ I have and will maintain workers' compensation insurance, as required by Section 3700 of the Labor Code, for the performance of the work for which this permit is issued. My workers' compensation insurance carrier and policy number are:

Carrier Indemnity Ins Co Policy Number WLRC4233804-7

____ (This section need not be completed if the permit is for \$100 or less) I certify that in the performance of the work for which this permit is issued, I shall not employ any person in any manner so as to become subject to the workers' compensation laws of California and agree that if I should become subject to the workers' compensation provisions of Section 3700 of the Labor Code, I shall forthwith comply with those provisions.

Date 10/14/97 Applicant Signature Deanna Collins

WARNING: FAILURE TO SECURE WORKER'S COMPENSATION COVERAGE IS UNLAWFUL AND SHALL SUBJECT AN EMPLOYER TO CRIMINAL PENALTIES AND CIVIL FINES UP TO ONE HUNDRED THOUSAND DOLLARS (\$100,000) IN ADDITION TO THE COST OF COMPENSATION, DAMAGES AS PROVIDED FOR IN SECTION 3706 OF THE LABOR CODE, INTEREST AND ATTORNEY'S FEE.

THIS PERMIT SHALL EXPIRE BY LIMITATION IF WORK IS NOT COMMENCED WITHIN 180 DAYS.

INSTALLATION CARD

WESTERN ONE STUCCO SYSTEM

SACRAMENTO STUCCO PRODUCTS CO., INC.

Job Address:

LOT - 53 Arlington Park
Larchmont Homes

ICBO Evaluation Service, Inc.

Report No. 3899

Date of Job Completion 2-16-98

Plastering Contractor

TOLIVER PLASTERING
P.O. BOX 740
FAIR OAKS, CA 95628-0740
CA LIC. #523018
NV LIC. #042471

Name: _____

Address: _____

Telephone Number 916-631-9844

Approved Applicator's License Number as
Issued by Western Stucco Products 507

This is to certify that the plastering system on the building exterior at the above address has been installed in accordance with the evaluation report specified above and the manufacturer's instruction.

Lesley Toliver
Signature of authorized representative of plastering contractor

2-16-98
Date

Installation card must be presented to the building inspector after completion of work and before final inspection.

No. AP-66

SACRAMENTO REGIONAL COUNTY SANITATION DISTRICT
COUNTY SANITATION DISTRICT NO. 1
SEWER IMPACT FEE
PERMIT AND CALCULATION SHEET 18/17
SACRAMENTO CITY

EFF. CALCULATION

DATE

APPROVED

W.J. Smith & Sons

MAILING ADDRESS
3300 Walnut Ave., Suite D
Sacramento, Ca. 95821

CITY-STATE-ZIP
SACRAMENTO, CA 95821

APPLICANT SIGNATURE
W.J. Smith

INSPECTOR'S COPY

SEE REVERSE SIDE



CITY OF SACRAMENTO CASH RECEIPT

TRANSACTION CODE	CASH RECEIPT NUMBER	DATE OF DEPOSIT	M M D D Y Y	ACCOUNTING PERIOD	M M Y Y	BUDGET FY	V Y Y
CR	144885	03/20/98	032098		0398		98
ACTION	BANK ACCOUNT	OFFSET CASH ACCOUNT	COMMENTS: M. J. Brock				
<input checked="" type="checkbox"/> Original Entry (E) <input type="checkbox"/> Adjustment (M)	01		488-4500 CR# 39B				

REFERENCE INVOICE NUMBER	FUND	AGENCY	ORGANIZATION	SUB-ORIG	ACTIVITY	REVENUE SOURCE	SUB-REV	JOB NUMBER	REPT CAT	BL SHEET	OBJECT	SUB-ORIG	VENDOR/PROVIDER	AMOUNT	INC / DEC	P / F
--------------------------	------	--------	--------------	----------	----------	----------------	---------	------------	----------	----------	--------	----------	-----------------	--------	-----------	-------

DESCRIPTION: (30 SPACES) 413303350 3667 1,968.00
 Meter only FCC's 12-1" meter 107's = 49,45,46,47 51,52,53,60,61,62,63 + 64

DESCRIPTION: (30 SPACES)

DESCRIPTION: (30 SPACES)

DESCRIPTION: (30 SPACES)

CITY OF SACRAMENTO PAID
 MAR 20 1998

DESCRIPTION: (30 SPACES)

DESCRIPTION: (30 SPACES)

PREPARED BY: NAME Pat O'Neil PHONE 264-5371 TOTAL 1,968.00
 DEPARTMENT/DIVISION Utilities / Business Services SERVICE DATE 3-20-98

INSULATION CERTIFICATE

THIS IS TO CERTIFY THAT INSULATION HAS BEEN INSTALLED IN CONFORMANCE WITH THE CURRENT ENERGY REGULATIONS, CALIFORNIA ADMINISTRATION CODE, TITLE 24, STATE OF CALIFORNIA, IN THE BUILDING LOCATED AT:

SITE ADDRESS: LOT 62 ARLINGTON PARK ELK GROVE, CA
 NUMBER STREET CITY STATE

CEILINGS:

BLOW: Manufacturer GREENSTONE Thickness 10.3" R/Value 38

Square Feet 1095 # Bags/Lbs. per bags _____

BATTS: Manufacturer SCHUMER Thickness 13" R/Value 38

EXTERIOR WALLS:

Manufacturer SCHUMER Thickness 3.5' R/Value 21
SCHUMER Thickness 3.5' R/Value 13

FLOOR INSULATION:

Manufacturer SCHUMER Thickness 6.25" R/Value 19

AIR INFILTRATION: (TITLE 24)

Yes XX No _____

OTHER: _____

GENERAL CONTRACTOR: LARCHMONT HOMES LIC. # _____

BY: _____ TITLE _____ DATE _____

INSULATION CONTRACTOR: Western Insulation, Inc. LIC. # 481278

BY: CYNTHIA MINKE TITLE AUTH AGENT DATE 3/19/98



WALLACE - KUHL & ASSOCIATES INC.
 GEOTECHNICAL ENGINEERING • CONSTRUCTION TESTING

3050 Industrial Blvd.
 PO Box 1137
 West Sacramento
 California 95691
 916-372-1434

DATE	1-16-97	JOB NO.	2399.07	WEATHER	Rain	TEMP.	° at	AM
PROJECT	Arlington Park			Technician I	<input checked="" type="checkbox"/>	Staff E/G	<input type="checkbox"/>	
LOCATION	Lots 52, 53			Technician II	<input type="checkbox"/>	Project E/G	<input type="checkbox"/>	
TYPE OF WORK	Anchor Installation OB.			Technician III	<input type="checkbox"/>	Senior E/G	<input type="checkbox"/>	
Inside 50 mi. radius	<input checked="" type="checkbox"/>	Outside 50 mi. radius	<input type="checkbox"/>		Nuclear Densities	<input type="checkbox"/>		Principal E/G <input type="checkbox"/>
PERSONNEL	REG. HRS	OT MRS	TOTAL HRS	TRAVEL	ON JOB	VEHICLE	MILES	
David Crawford	5		5	1	4	42	40	

OBSERVATIONS:

Observed installation of 30-1/2" threaded rod H.D. bolts epoxied into concrete. 14 in lot 53, 16 in lot 52. Observed drilling of holes which were drilled 6 1/2' +/- 1" deep. Observed dust being blown out of holes with bicycle pump. Holes were blown until no dust was observed coming out of holes.

Epoxy was then applied into holes using Simpson epoxy tie adhesive two part system. 1/2" dia. threaded rods at 10" long were then pushed and twisted down into holes until they reached bottom. Observed epoxy oozing out of top of holes. Plenty of epoxy was used in each hole. Two of the threaded rods used were 5/8" dia. They ran out of 1/2" dia. bolts. Holes were drilled to fit 5/8" dia. rods in lot 52.

FIELD REPORT

Signed David G. Crawford

**Certification of Compliance
School District Development Fees**

(Print or Type) If Printing, press hard for four copies

PART I To be completed by Applicant

OWNER'S NAME M.I. Brock & Sons 488-4500
 OWNER'S ADDRESS 3350 Watt Ave., Suite D, Sacramento, Ca. 95621
 PROJECT ADDRESS 6381 Chesterbrook Drive
 PARCEL NUMBER 117-1280-062 LOT NO. 52
 SUBDIVISION NAME Arlington Park
 NUMBER OF UNITS 1

Upon payment of the fees listed below, a 90-day approval period commences upon which the applicant paying the fees may protest such fees. Any failure to file such protest within the 90-day period shall result in forfeiture of any rights to challenge such fees, through litigation or otherwise.

APPLICANT'S SIGNATURE *Heavenly Sullen*
 TITLE OF APPLICANT Operations
 DATE 10/3/97 PHONE NUMBER 991-1200

PART II To be completed by Applicant

PLAN IDENTIFICATION NUMBER 1975
 BUILDING TYPE
 RESIDENTIAL () APARTMENT/CONDOMINIUM () COMMERCIAL/INDUSTRIAL ()
 SQUARE FEET OF CHARGEABLE BUILDING AREA 1975
 SIGNATURE _____
 TITLE _____ DATE _____

PART III To be completed by School District

SCHOOL DISTRICT EE (165 D)
 DISTRICT CERTIFICATION NO. 2002

EXEMPT	COMMENTS
RESIDENTIAL/APT/CONDO (1)	1975 SQ FT X \$ 3.24 = \$ 6260.75
COMMERCIAL/INDUSTRIAL	SQ FT X \$ = \$
OTHER FEE TYPE (1)	1975 SQ FT X \$ 3.17 = \$ 6260.75
TOTAL FEES COLLECTED (1)	1975 3.17 = \$ 6260.75

This Certification covers only the amount of square footage indicated above. Any additions or corrections to the square footage for this project will require an amendment to the Certificate of Compliance.

As the authorized school district official, I hereby certify that the requirements of Government Code Section 65995 and any other authorized requirements have been complied with by the above signed applicant.

SCHOOL DISTRICT OFFICIAL

SIGNATURE *[Signature]* **PAID**
 TITLE 10/3/97 DATE OCT 10 1997

Original: School District 1st copy: School District 2ND copy: Building Department 3rd copy: Applicant
 Elk Grove Unified School District

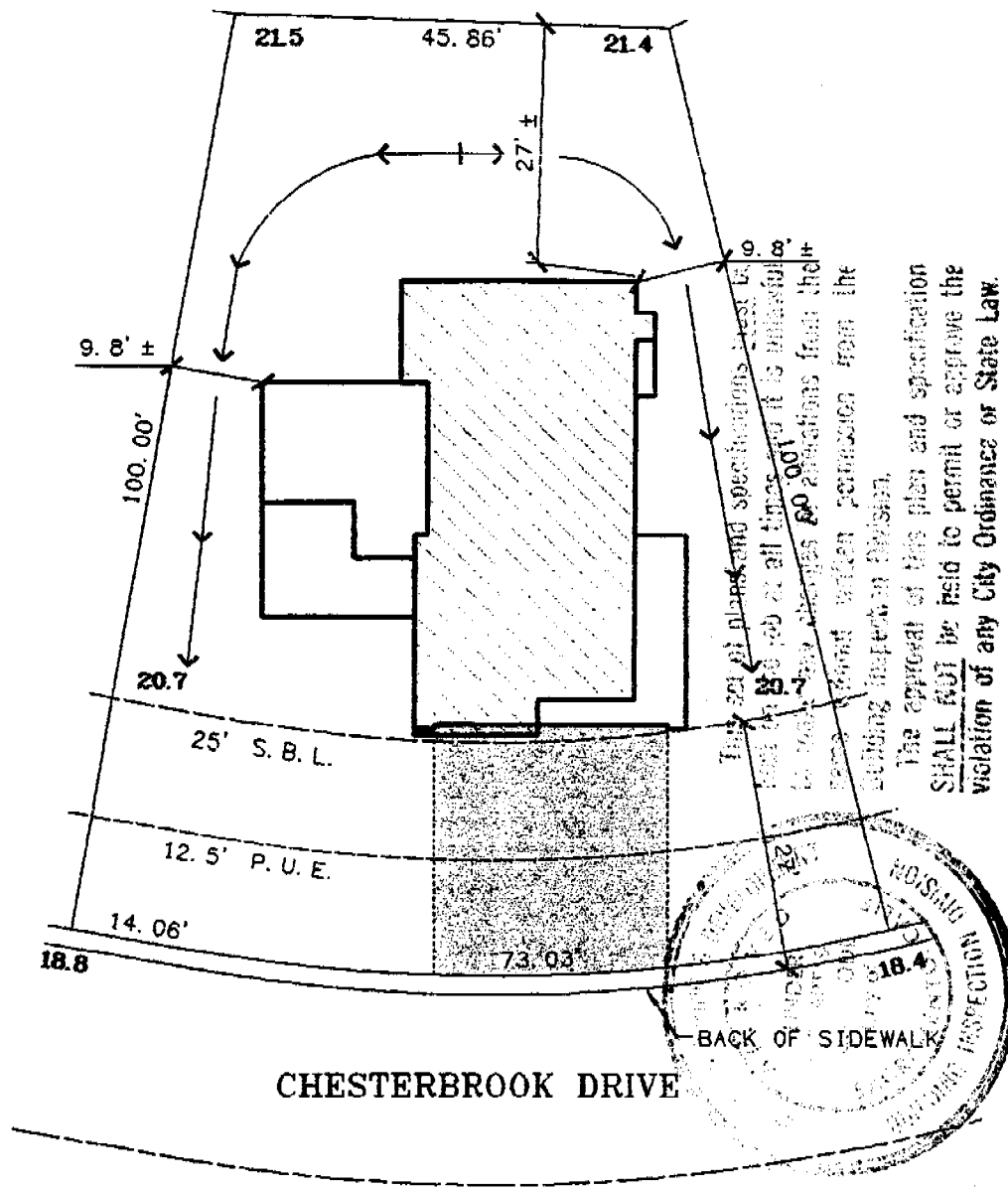

ISSUED

OCT 13 1997

Sacramento Building Division

OK 9-27-97
ML

LOT 52
PLAN 1975B RIGHT
A.P.N.: 117-126-052

ADDRESS: 6381 CHESTERBROOK DRIVE

THIS PLOT PLAN IS FOR THE PURPOSE OF SHOWING THE HOUSE TO BE CONSTRUCTED ON THE LOT AND MAY NOT REPRESENT THE FINAL AS-BUILT CONFIGURATION OF THE PROPERTY OR IMPROVEMENTS THEREON. SETBACKS, OTHER THAN MINIMUM ORDINANCE, ARE APPROXIMATE ONLY AND MUST NOT BE ASSUMED TO BE PRECISE.

<p>Spink Corporation 1000 VENTURE OAKS WAY SACRAMENTO, CA 95833 TEL: (916) 921-4550 FAX: (916) 921-9274</p>	<p>LARCHMONT HOMES 3850 Watt Avenue Suite D Sacramento, CA 95821-3670 office: (916) 488-4500 fax: (916) 488-7417</p>	<p>Larchmont Arlington Park Arlington Park Unit No. 5 Phase II City of Sacramento, California Scale: 1"=20' September, 1997</p>
---	--	---