



3.1

APPROVED
BY THE CITY COUNCIL
MAY 20 1997

OFFICE OF THE
CITY CLERK
CITY HALL
915 I STREET
ROOM 200
SACRAMENTO, CA
95814-2608

PH 916-264-7113
FAX 916-264-5573

DEPARTMENT OF
PUBLIC WORKS

SPECIAL DISTRICTS
DIVISION

CITY OF SACRAMENTO
CALIFORNIA

May 6, 1997

City Council
Sacramento, California

Honorable Members in Session:

SUBJECT: NORTHSIDE SUBDIVISION UNIT #1 AND #2 MAINTENANCE DISTRICT -
PUBLIC HEARING ON FY 1997/98 ANNUAL REPORT

LOCATION AND COUNCIL DISTRICT:

The district is located north of Main Avenue between Rio Linda Boulevard and Marysville Boulevard, Council District No. 2 (please see attached Exhibit A).

RECOMMENDATION:

This report recommends that City Council:

- Adopt Resolution Overruling Protests for Northside Subdivision Maintenance District for FY 1997/98.
- Adopt Resolution Confirming Report and Levying FY 1997/98 Annual Assessment for the Northside Subdivision Maintenance District.
- Adopt Resolution Amending FY 1997/98 Budget for Northside Subdivision Maintenance District.

CONTACT PERSON: Ronald Wicky, Special Districts Analyst, 264-5628

FOR COUNCIL MEETING OF: May 20, 1997

City Council
Northside Subdivision MD
May 6, 1997

SUMMARY:

The recommended Council action will levy the FY 1997/98 annual assessment for the Northside Subdivision Maintenance District. The district was established in 1992 to recover the annual costs of maintenance related to the Wetlands Mitigation program for Northside Subdivision. Assessments for FY 1997/98 have decreased from the previous years.

COMMITTEE/COMMISSION ACTION:

None.

BACKGROUND INFORMATION:

On January 7, 1992, City Council approved formation of the Northside Subdivision Maintenance District. The district provides funding for maintenance activities associated with the Northside Subdivision Wetlands Mitigation Program. The mitigation program is in compliance with the U.S. Army Corps of Engineer's Permit issued to the developer of Northside Subdivision on June 12, 1990. The activities include cleaning of the sand and grease trap separator for the storm drain system, disposal of the contents, and mowing and litter pick up. The district will also fund maintenance activities for the landscaped area along Marysville Boulevard. On April 29, 1997, City Council adopted a Resolution of Intention which set a hearing on this date for the Annual Report. As of May 6, 1997, no protests have been received.

FINANCIAL CONSIDERATIONS:

The cost of maintenance for the Northside Subdivision Wetlands Mitigation program, together with the landscaped area along Marysville Boulevard, will be funded through the maintenance district. The total cost for FY 1997/98 is projected at \$8,848. Maintenance costs will be assessed to the 112 single family lots within the district. The annual maintenance cost for a single family residential lot is projected at \$79 per unit.

FY 1996/97 Assessed	FY 1997/98 Budget	Surplus/From Prior Year	FY 1997/98 Assessed
\$9,968	\$43,471	\$34,623	\$8,848

The costs are detailed in the Engineer's Report on file with the City Clerk. This maintenance district is self supporting and has no impact on the General Fund.

City Council
Northside Subdivision MD
May 6, 1997

ENVIRONMENTAL CONSIDERATIONS:

Under CEQA Guidelines, administration and annual maintenance do not constitute a project and are therefore exempt from review.

POLICY CONSIDERATION:

These proceedings are being conducted in accordance with Chapter 81 of the Sacramento City Code.

MBE/WBE:

This annual budget and assessment levy process does not involve the contractor selection process. The contract to perform the maintenance will be let in July of this year.

Respectfully submitted,

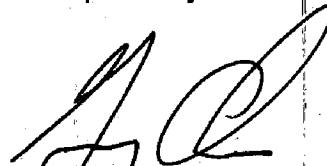

Gary Alm, Manager
Real Estate Services & Special Districts

Recommendation Approved:

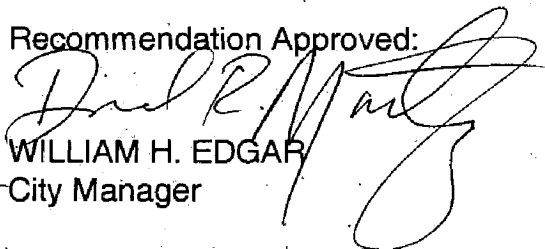
for 

WILLIAM H. EDGAR
City Manager

Approved:

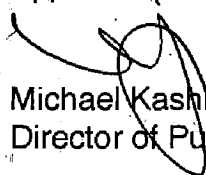

Michael Kashwagi
Director of Public Works

EXHIBIT B

NORTHSIDE SUBDIVISION MAINTENANCE DISTRICT

FY 1997/98 SCHEDULE

April 29, 1997 Council Adopted Resolution of Intention and Set Date for Hearing

May 1997 Publish Notice of Hearing

May 20, 1997 HOLD HEARING - COUNCIL CONSIDERS ALL PROTESTS, ORDERS ANNUAL LEVY

July 1997 Assessments to County for Placement on Tax Roll

APPROVED
BY THE CITY COUNCIL
MAY 20 1997
OFFICE OF THE
CITY CLERK

RESOLUTION NO. 97-247

ADOPTED BY THE SACRAMENTO CITY COUNCIL

ON DATE OF _____

**RESOLUTION OVERRULING PROTESTS FOR
NORTHSIDE SUBDIVISION MAINTENANCE DISTRICT
FOR FY 1997/98**

BE IT RESOLVED BY THE COUNCIL OF THE CITY OF SACRAMENTO:

On April 29, 1997, the City Council opened a public hearing on the Resolution of Intention and the Engineer's Annual Report for Northside Subdivision Maintenance District, City of Sacramento, County of Sacramento, State of California.

At or before the time set for the hearing, certain interested persons made protests or objections to the proposed maintenance, the extent of the assessment district, or the proposed assessment.

The City Council hereby overrules each of these protests, written or oral.

The City Council finds that the protest against the proposed maintenance (including all written protest not withdrawn in writing before the conclusion of the protest hearing) is made by the owners of less than one-half of the area of the land to be assessed for the improvement.

MAYOR

ATTEST:

CITY CLERK

FOR CITY CLERK USE ONLY

RESOLUTION NO.: _____

DATE ADOPTED: _____

APPROVED
BY THE CITY COUNCIL

MAY 20 1997

OFFICE OF THE
CITY CLERK

RESOLUTION NO. 97-248

ADOPTED BY THE SACRAMENTO CITY COUNCIL

ON DATE OF _____

RESOLUTION CONFIRMING REPORT, ORDERING MAINTENANCE OF IMPROVEMENTS AND LEVYING FY 1997/98 ANNUAL ASSESSMENTS FOR THE NORTHSIDE SUBDIVISION MAINTENANCE DISTRICT

BE IT RESOLVED BY THE COUNCIL OF THE CITY OF SACRAMENTO:

The City Council has taken a series of actions preliminary to ordering maintenance of improvements for the Northside Subdivision Maintenance District and now makes the following finds and orders:

1. The City Council adopted its Resolution of Intention for Maintenance of Improvements described therein under Chapter 81 of the Sacramento City Code and a Resolution Directing the Director of Public Works, as the Engineer of Work for the assessment district, to prepare the report required by Section 81.12, of Sacramento City Code.

The maintenance is generally described as follows:

Wetlands -- The work to be performed consists of the special monitoring, maintenance, and repair of the designated wetland areas as identified in the Corps of Engineers Nationwide Permit issued on June 12, 1990, for Northside Subdivision (hereafter referred to as "Corps Permit"). Specifically, the work may include, but is not limited to, monitoring and maintenance of seasonal wetlands, inspection and minor repairs to basin inlets and outlets, mowing fire breaks, litter control and patrolling, road maintenance, minor bank repairs, inspection and maintenance of oil/sand interceptors, keeping of contractor's records, and any related work necessary to comply with the conditions of said Corps Permit. Pumping, hauling, and disposal of collected wastes shall be in accordance with all appropriate state, federal, and local regulations. The work does not include general maintenance of the drainage channel as normally provided by the City of Sacramento.

FOR CITY CLERK USE ONLY

RESOLUTION NO.: _____

DATE ADOPTED: _____

Landscaping and Masonry Wall -- The work to be performed consists of furnishing all tools, equipment, apparatus, facilities, labor, material, supplies, and utilities necessary or desirable to maintain the masonry walls, landscaping and irrigation systems. Maintenance work may include, but not be limited to, periodic mowing of grass, trimming of trees and shrubs, and fertilizing, together with the regular furnishing of water for irrigation of all plant material, and the repair, maintenance, and replacement of the irrigation system, planted materials, and amenities.

Certain types of unscheduled maintenance may also be performed, but only when specifically authorized by the City of Sacramento. These tasks include plant replacement, turf and grassland seeding, insect, weed and rodent control, erosion control, maintaining/repairing masonry walls, channel repairs, hauling and dumping debris, maintaining floodway improvements, maintaining areas adjacent to the floodway right-of-way, and repair of damage due to vandalism, flood, or fire.

2. The Engineer of Work filed the report as directed, and the City Council adopted its Resolution of Intention calling a hearing on the report as required by Section 81.20 of the Sacramento City Code. Notice of the hearing was given by publication according to Chapter 81 of the Sacramento City Code. Affidavit of publication was filed with the City Clerk.
3. At the time and place for which notice was given, the City Council conducted a public hearing and gave every interested person an opportunity to object to the proposed maintenance, or the proposed assessment.
4. The City Clerk finds that written protests against the proposed Maintenance of Improvements have not been made by owners representing more than one-half of the area of the land to be assessed for the Maintenance of Improvements.
5. The documents and events described in paragraph 1 to 4, inclusive, are stated here in tabular form with their dates and, where appropriate, their numbers. All documents are now on file with the City Clerk.

<u>Document of Event</u>	<u>Date</u>	<u>Number</u>
a. Resolution Directing Filing of Report	April 29, 1997	97-193
b. Filing of Engineer's Report	April 29, 1997	
c. Resolution of Intention	April 29, 1997	97-194
d. Affidavit of Publication of Res. of Intention	May 2, 1997	
e. Public Hearing Conducted	May 20, 1997	
f. Resolution Overruling Protests	May 20, 1997	

FOR CITY CLERK USE ONLY

RESOLUTION NO.: _____

DATE ADOPTED: _____

6. The City Council approves the Engineer's Report and each component part of it, including each exhibit incorporated by reference in the report.
7. The City Council finds that the Engineer of Work, in the Engineer's Report, has fairly and properly apportioned the cost of the Maintenance of Improvements to each parcel of land in the assessment district in proportion to the estimated benefits to be received by each parcel, respectively, from the Maintenance of Improvements. The City Council hereby confirms and levies each individual assessment as stated in the Engineer's Report.
8. The City Council orders the Maintenance of Improvements described in paragraph 1 as detailed in the Engineer's Report.

MAYOR

ATTEST:

CITY CLERK

FOR CITY CLERK USE ONLY

RESOLUTION NO.: _____

DATE ADOPTED: _____

APPROVED
BY THE CITY COUNCIL
MAY 20 1997
OFFICE OF THE
CITY CLERK

RESOLUTION NO. 97-249

ADOPTED BY THE SACRAMENTO CITY COUNCIL

ON DATE OF _____

RESOLUTION AMENDING THE FY 1997/98 BUDGET FOR NORTHSIDE SUBDIVISION MAINTENANCE DISTRICT

BE IT RESOLVED BY THE COUNCIL OF THE CITY OF SACRAMENTO.

1. The Fiscal Year 1997/98 Revenue Budget for the Northside Subdivision Maintenance District is adopted as follows:

223-310-3212-3657	\$ 8,848
-------------------	----------

2. The Fiscal Year 1996/97 Expenditure Budget for the Northside Subdivision Maintenance District is adopted as follows:

Department

Environmental Services	\$ 5,000
Public Works	6,075
Finance	396
Contingency	<u>32,000</u>
	\$43,471

MAYOR

ATTEST:

CITY CLERK

FOR CITY CLERK USE ONLY

RESOLUTION NO.: _____

DATE ADOPTED: _____

ENGINEER'S REPORT

**NORTHSIDE SUBDIVISION (UNITS 1 AND 2) MAINTENANCE DISTRICT
FY 1997/98**

(Pursuant to the Landscaping and Lighting Act of 1972)

The undersigned respectfully submits the enclosed report as directed by the City Council:

Dated: April 29, 1997

Michael Kashiwagi, Director of Public Works
City of Sacramento, Engineer of Work

By  _____

I HEREBY CERTIFY that the enclosed Engineer's Report together with Assessment and Assessment Diagram thereto attached, was filed with me on the 29 day of April, 1997.

Valerie A. Burrowes, City Clerk
City of Sacramento, Sacramento County,
California

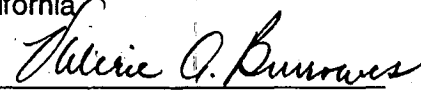
By  _____

I HEREBY CERTIFY that the enclosed Engineer's Report, together with Assessment and Assessment Diagram thereto attached, was approved and confirmed by the City Council of the City of Sacramento, California, on the 20th day of May, 1997.

Valerie A. Burrowes, City Clerk
City of Sacramento, Sacramento County
California

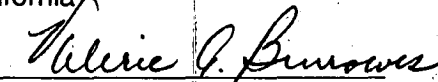
By  _____

ENGINEER'S REPORT

NORTHSIDE SUBDIVISION MAINTENANCE DISTRICT

MICHAEL KASHIWAGI, Engineer of Work for Northside Subdivision Maintenance District, City of Sacramento, County of Sacramento, State of California, makes this report, as directed by the City Council pursuant to Chapter 81 of the Sacramento City Code.

The improvement maintenance work, which is the subject of this report (hereafter referred to as the "work") is briefly described in two parts as follows:

Part 1 The work described herein is to be carried out in the lower Magpie Creek floodway corridor within the City limits between Rio Linda Boulevard and Marysville Boulevard. This includes the creek channel, wetlands, and adjacent areas.

The work to be performed consists of the special monitoring, maintenance, and repair of the designated wetland areas as identified in the Corps of Engineers Nationwide permit issue on June 12, 1990, for Northside Subdivision (hereafter referred to as "Corps Permit"). Specifically, the work may include, but is not limited to, monitoring and maintenance of seasonal wetlands, inspection and minor repairs to basin inlets and outlets, mowing fire breaks, litter control and patrolling, road maintenance, minor bank repairs, inspection and maintenance of oil/sand interceptors, keeping of contractor's records, and any related work necessary to comply with the conditions of said Corps Permit. Pumping, hauling, and disposal of collected wastes shall be in accordance with all appropriate state, federal, and local regulations. The work does not include general maintenance of the drainage channel as normally provided by the City of Sacramento.

Certain types of unscheduled maintenance may also be performed, but only when specifically authorized by the City of Sacramento. These tasks include plant replacement, seeding, insect, weed and rodent control, erosion control, channel repairs, basin renovation, maintaining floodway improvements, and repair of damage due to vandalism, flood, or fire.

Part 2 The work described herein is to be carried out when the improvements (masonry wall and landscaping) are built and dedicated to the City. The work will be performed in the landscaped area on Marysville Boulevard within the Northside Subdivision area, and more particularly described on plans and specifications approved by the City of Sacramento on file at the City of Sacramento, Department of Parks and Community Services, 1231 "I" Street, Room 400, Sacramento, California 95814.

The work to be performed consists of furnishing all tools, equipment, apparatus,

facilities, labor, material, supplies, and utilities necessary or desirable to maintain the masonry walls, landscaping and irrigation systems. Maintenance work may include, but not be limited to, periodic mowing of grass, trimming of trees and shrubs, and fertilizing, together with the regular furnishing of water for irrigation of all plant material, and the repair, maintenance, and replacement of the irrigation system, planted materials, and amenities. Maintenance of masonry walls includes periodic repair as required.

Funds raised for the above-described maintenance work shall be based on annual benefit assessment apportioned to land benefitting from the work and within the boundaries of the maintenance district. The Council sets the assessment each year after receiving and reviewing an Engineer's Report and holding a public hearing.

This report includes the following attached exhibits:

- EXHIBIT A -- An estimate of the cost of the work.
- EXHIBIT B -- Schematic diagram of area of work.
- EXHIBIT C -- A statement of the method by which the undersigned determined the amount proposed to be assessed against each parcel, based on benefits to be derived by each parcel, respectively, from the work.
- EXHIBIT D -- An assessment roll showing the amount proposed to be specially assessed against each parcel of real property within this maintenance district. Each parcel is described by County Assessor's parcel number, and each parcel is also assigned a separate "assessment number" for the purposes of this proceeding.
- EXHIBIT E -- A list of the names and addresses of the owners of real property within this maintenance district, as shown on the last equalized assessment roll for taxes, or as known to the Clerk. The list is keyed to Exhibit D by assessment number.
- EXHIBIT F -- A diagram showing all of the parcels of real property within this maintenance district. The diagram is keyed to Exhibit D by assessment number.

Respectfully submitted,

Michael Kashiwagi, Director of Public Works
City of Sacramento, Sacramento County
State of California

**EXHIBIT A
NORTHSIDE SUBDIVISION MAINTENANCE DISTRICT
SUMMARY OF THE COSTS IN THE DISTRICT
FISCAL YEAR 1997/98**

<u>DISTRICT ITEM</u>	<u>DISTRICT COST</u>
I. MONITORING PROGRAM	0
II. MAINTENANCE CONTRACTS	
a) Contracts	
Wetlands Maintenance Tasks	\$3,000
Landscape Maintenance Cost	975
b) Unscheduled Work	
Wetlands	\$1,000
Landscaping	500
c) Miscellaneous	
Utilities	<u>\$ 600</u>
SUBTOTAL, MAINTENANCE TASKS:	\$ 6,075
III. ADMINISTRATION	
Wetlands (Environmental Service)	\$1,000
Landscaping (Streets)	1,200
Special Districts	<u>2,800</u>
TOTAL ADMINISTRATION	5,000
IV. CONTINGENCY	32,000
V. ANNUAL BILLING AND ADMINISTRATION	<u>396</u>
TOTAL BUDGET	\$43,471
VII. SURPLUS/FROM PRIOR YEAR	34,623
1997/98 TOTAL ASSESSMENT	\$ 8,848



SCALE: 1" = 100'

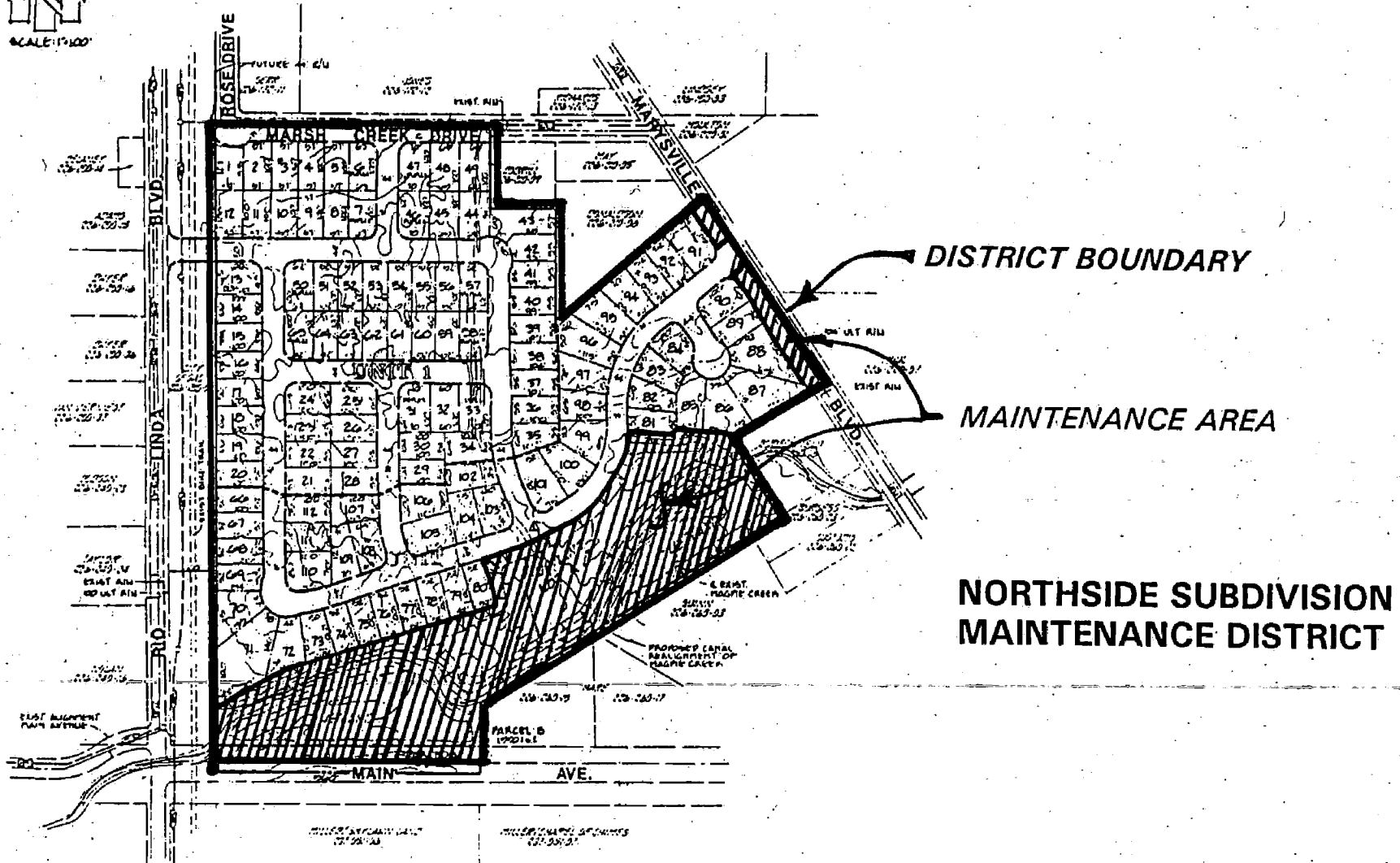

EXHIBIT B

EXHIBIT C

NORTHSIDE SUBDIVISION MAINTENANCE DISTRICT

METHOD OF SPREAD

The following action describes the proposed method of assessing the annual maintenance costs for the Northside Subdivision Maintenance District to each parcel in the district in relation to the amount of benefit received. Costs for this district are assessed to each parcel within the district boundary except for those parcels owned by public agencies or dedicated for public use.

The costs of maintenance of the work, more particularly described in Exhibit A to this report will be spread equally to all single-family parcels within this subdivision.

The cost of all incidental expenses, including preparation of Engineer's Report, annual proceedings, and district administration, will be spread equally to all single-family parcels within the district.

The "total" number of single-family parcels" in the district was determined from the actual number of recorded lots of Northside Unit #1 and Unit #2. The "single-family assessment" was calculated by taking the total cost of the district and dividing it equally by the "total number of single-family parcels" in the district. The "single-family assessment" was spread equally to each recorded single-family lot within the recorded subdivision of Northside Unit #1 and Unit #2.

EXHIBIT D
ASSESSMENT ROLL 1997/98
NORTHSIDE SUBDIVISION MAINTENANCE DISTRICT

<u>NO.</u>	<u>PARCEL DESCRIPTION</u> <u>APN #</u>	<u>AMOUNT</u>
1	22602100110000	\$79.00
2	22602100120000	\$79.00
3	22602100130000	\$79.00
4	22602100140000	\$79.00
5	22602100150000	\$79.00
6	22602100160000	\$79.00
7	22602100170000	\$79.00
8	22602100180000	\$79.00
9	22602100190000	\$79.00
10	22602100200000	\$79.00
11	22602100210000	\$79.00
12	22602100220000	\$79.00
13	22602100230000	\$79.00
14	22602100240000	\$79.00
15	22602100250000	\$79.00
16	22602100260000	\$79.00
17	22602100270000	\$79.00
18	22602100280000	\$79.00
19	22602100290000	\$79.00
20	22602100300000	\$79.00
21	22602100310000	\$79.00
22	22602100320000	\$79.00
23	22602100330000	\$79.00
24	22602100340000	\$79.00
25	22602100350000	\$79.00
26	22602100360000	\$79.00
27	22602100370000	\$79.00
28	22602100380000	\$79.00
29	22602100390000	\$79.00
30	22602100400000	\$79.00
31	22602100410000	\$79.00
32	22602100420000	\$79.00
33	22602100430000	\$79.00
34	22602100440000	\$79.00
35	22602100450000	\$79.00
36	22602100460000	\$79.00
37	22602100470000	\$79.00
38	22602100480000	\$79.00
39	22602100490000	\$79.00
40	22602100500000	\$79.00
41	22602100510000	\$79.00
42	22602100520000	\$79.00
43	22602100980000	\$79.00
44	22602100540000	\$79.00
45	22602100550000	\$79.00

EXHIBIT D
ASSESSMENT ROLL 1997/98
NORTHSIDE SUBDIVISION MAINTENANCE DISTRICT

<u>NO.</u>	<u>PARCEL DESCRIPTION</u> <u>APN #</u>	<u>AMOUNT</u>
46	22602100560000	\$79.00
47	22602100570000	\$79.00
48	22602100580000	\$79.00
49	22602100590000	\$79.00
50	22602100600000	\$79.00
51	22602100610000	\$79.00
52	22602100620000	\$79.00
53	22602100630000	\$79.00
54	22602100640000	\$79.00
55	22602100650000	\$79.00
56	22602100660000	\$79.00
57	22602100670000	\$79.00
58	22602100680000	\$79.00
59	22602100690000	\$79.00
60	22602100700000	\$79.00
61	22602100710000	\$79.00
62	22602100720000	\$79.00
63	22602100730000	\$79.00
64	22602100740000	\$79.00
65	22602100750000	\$79.00
66	22602500200000	\$79.00
67	22602500190000	\$79.00
68	22602500180000	\$79.00
69	22602500170000	\$79.00
70	22602500160000	\$79.00
71	22602500150000	\$79.00
72	22602500140000	\$79.00
73	22602500130000	\$79.00
74	22602500120000	\$79.00
75	22602500110000	\$79.00
76	22602500100000	\$79.00
77	22602500090000	\$79.00
78	22602500080000	\$79.00
79	22602500070000	\$79.00
80	22602500060000	\$79.00
81	22602100860000	\$79.00
82	22602100850000	\$79.00
83	22602100840000	\$79.00
84	22602100830000	\$79.00
85	22602100820000	\$79.00
86	22602100810000	\$79.00
87	22602100800000	\$79.00
88	22602100790000	\$79.00
89	22602100780000	\$79.00
90	22602100770000	\$79.00

EXHIBIT D
ASSESSMENT ROLL 1997/98
NORTHSIDE SUBDIVISION MAINTENANCE DISTRICT

<u>NO.</u>	<u>PARCEL DESCRIPTION</u> <u>APN #</u>	<u>AMOUNT</u>
91	22602100950000	\$79.00
92	22602100940000	\$79.00
93	22602100930000	\$79.00
94	22602100920000	\$79.00
95	22602100910000	\$79.00
96	22602100900000	\$79.00
97	22602100890000	\$79.00
98	22602100880000	\$79.00
99	22602100870000	\$79.00
100	22602500330000	\$79.00
101	22602500320000	\$79.00
102	22602500310000	\$79.00
103	22602500300000	\$79.00
104	22602500290000	\$79.00
105	22602500280000	\$79.00
106	22602500270000	\$79.00
107	22602500260000	\$79.00
108	22602500250000	\$79.00
109	22602500240000	\$79.00
110	22602500230000	\$79.00
111	22602500220000	\$79.00
112	22602500210000	\$79.00

**EXHIBIT E
MAILING LIST
NORTHSIDE SUBDIVISION MAINTENANCE DISTRICT**

NO.	OWNERS NAME	OWNERS ADDRESS	CITY	ST	ZIP
1	TEPNER R	800 MARSH CREEK DR	SACRAMENTO	CA	95838
2	KENNEDY G	804 MARSH CREEK DR	SACRAMENTO	CA	95838
3	PACE T	808 MARSH CREEK DR	SACRAMENTO	CA	95838
4	EASLEY R	812 MARSH CREEK DR	SACRAMENTO	CA	95838
5	GLANCE J	816 MARSH CREEK DR	SACRAMENTO	CA	95838
6	JONES S	820 MARSH CREEK DR	SACRAMENTO	CA	95838
7	BAILEY D	821 HUNTERS CREEK	Sacramento	CA	95838
8	Ponce De Leon	817 HUNTERS CREEK	Sacramento	CA	95838
9	BUSCH D	813 HUNTERS CREEK	Sacramento	CA	95838
10	BARNES J	809 HUNTERS CREEK	Sacramento	CA	95838
11	MERRITT S	805 HUNTERS CREEK	Sacramento	CA	95838
12	TAYLOR H	801 HUNTERS CREEK	Sacramento	CA	95838
13	TWOMEY H	4967 WIND CREEK DR	SACRAMENTO	CA	95838
14	WALTER R	4963 WIND CREED DR	SACRAMENTO	CA	95838
15	Banks C	4959 WIND CREED DR	SACRAMENTO	CA	95838
16	BRISBY S	4955 WIND CREEK DR	SACRAMENTO	CA	95838
17	MAMERTO F	4951 WIND CREEK DR	SACRAMENTO	CA	95838
18	Veterans Affairs	1301 CLAY ST N 1300	OAKLAND	CA	94612
19	ARRIAGA F	4943 WIND CREEK DR	SACRAMENTO	CA	95838
20	KEE D	4939 WIND CREEK DR	SACRAMENTO	CA	95838
21	Rakhuba, Lyubomir & Svetlana	4938 WIND CREEK DR	SACRAMENTO	CA	95838
22	VENABLE J	4942 WIND CREEK DR	SACRAMENTO	CA	95838
23	Rasmussen, Craig H & Nora L	4946 Wind Creek Drive	Sacramento	CA	95838
24	Croddy, Michael D	4950 WIND CREEK DR	SACRAMENTO	CA	95838
25	Worrell, Garry E & Angela	4951 Pine Nut Way	Sacramento	CA	95838
26	GOLDSMITH C	4947 PINE NUT WY	SACRAMENTO	CA	95838
27	Beeler, Nancy Sue	4943 Pine Nut Way	Sacramento	CA	95838
28	ROBINSON A	4939 PINE NUT WY	SACRAMENTO	CA	95838
29	POLVSEN M	4940 PINE NUT WY	SACRAMENTO	CA	95838
30	SUMMERFELT TED & JEAN	4944 Pine Nut Way	Sacramento	CA	95838
31	Brown, J.B. & Carolyn S.	832 North Hill Way	Sacramento	CA	95838
32	Fowler, Kenneth L. & Kirsten E.	836 North Hill Way	Sacramento	CA	95838
33	Canlas, Allen S. & Avelyn G.	840 North Hill Way	Sacramento	CA	95838
34	PORRAS, MIGUEL & JUDITH	876 HUNTERS CREEK DR	SACRAMENTO	CA	95838
35	MC BRIDE, TERRI	877 HUNTERS CREEK DR	SACRAMENTO	CA	95838
36	HENDON, ALISON	274 PROSPECT PKW #F-L	BROOKLYN	NY	11215
37	Immenschuh, William & Carolyn	869 Hunters Creek Drive	Sacramento	CA	95838
38	Veterans Affairs	1301 CLAY ST N 1300	OAKLAND	CA	94612
39	RODRIGUEZ, DANIEL & SUSAN	861 HUNTERS CREEK DR	SACRAMENTO	CA	95838
40	Ruiz, Kenneth R & Marcella	857 Hunters Creek Drive	Sacramento	CA	95838
41	TOBIN, DANIEL & CONNIE	853 HUNTERS CREEK DR	SACRAMENTO	CA	95838
42	Olszewski, Sandra & Riyad	849 Hunters Creek Drive	Sacramento	CA	95838
43	HEAD, OTIS & NANCY	845 HUNTERS CREEK	Sacramento	CA	95838
44	Gonzales, Tony & Jennifer	841 Hunters Creek Drive	Sacramento	CA	95838
45	Bartlett, Eric W. & Lucindaawn	837 Hunters Creek Drive	Sacramento	CA	95838

**EXHIBIT E
MAILING LIST
NORTHSIDE SUBDIVISION MAINTENANCE DISTRICT**

NO.	OWNERS NAME	OWNERS ADDRESS	CITY	ST	ZIP
46	Bennett, Christopher w & Kathleen	833 Hunters Creek Drive	Sacramento	CA	95838
47	RICKETT, ERNEST & PATRICIA	832 MARSH CREEK DR	SACRAMENTO	CA	95838
48	STURGEON, DAVID & KAREN	836 MARSH CREEK DR	SACRAMENTO	CA	95838
49	KAMMERER, ERIC	1475 AUSTIN DR	DIXON	CA	95620
50	VIRAY, PEDRO & GILDA	844 HUNTERS CREEK DR	SACRAMENTO	CA	95838
51	PARDILLO, ELEX & EMILIE	844 HUNTERS CREEK DR	SACRAMENTO	CA	95838
52	NIEBANK, SAMUEL & KAMI	820 HUNTERS CREEK DR	SACRAMENTO	CA	95838
53	CHASE, JEFFREY	824 HUNTERS CREEK DR	SACRAMENTO	CA	95838
54	KEUP, CHRISTOPHER	828 HUNTERS CREEK DR	SACRAMENTO	CA	95838
55	Cathcart, Edward A & Corinna Sue	832 Hunters Creek Drive	Sacramento	CA	95838
56	Barzelay, Mosheh A. & Lela J.	836 Hunters Creek Drive	Sacramento	CA	95838
57	Lewis, Terry E. & Heddy V.	840 Hunters Creek Drive	Sacramento	CA	95838
58	GILMAN, JOE	841 NORTH HILL WY	SACRAMENTO	CA	95838
59	GRANDOS, WILLIAM	837 NORTH HILL WY	SACRAMENTO	CA	95838
60	MIRCETICH, JON	833 NORTH HILL WY	SACRAMENTO	CA	95838
61	MORROW, LARRY & KATHLEEN	829 NORTH HILL WY	SACRAMENTO	CA	95838
62	BECKMAN, ROBERT & DEBRA	825 NORTH HILL WY	SACRAMENTO	CA	95838
63	ALSBURY, DAVID & SALL	821 NORTH HILL WY	SACRAMENTO	CA	95838
64	BITTANTE, SHIRLEY	817 NORTH HILL WY	SACRAMENTO	CA	95838
65	THOMAS D	813 NORTH HILL WY	SACRAMENTO	CA	95838
66	ELDER S	4935 WIND CREEK DR	SACRAMENTO	CA	95838
67	PADILLA, PASUAL & TERESA	4931 WIND CREEK DR	SACRAMENTO	CA	95838
68	DONZELLA E	4927 WIND CREEK DR	SACRAMENTO	CA	95838
69	BROGAN C	4923 WIND CREEK DR	SACRAMENTO	CA	95838
70	Needles, Mary Teresa	4919 WIND CREEK DR	SACRAMENTO	CA	95838
71	FARNSWORTH M	4915 WIND CREEK DR	SACRAMENTO	CA	95838
72	RISE E	4911 WIND CREEK DR	SACRAMENTO	CA	95838
73	MAVES M	4907 WIND CREEK DR	SACRAMENTO	CA	95838
74	Corrales, Feliciano & Consuelo	4903 WIND CREEK DR	SACRAMENTO	CA	95838
75	MALMQUIST H	4899 WIND CREEK DR	SACRAMENTO	CA	95838
76	THOMAS	4895 WIND CREEK DR	SACRAMENTO	CA	95838
77	FRANK R	4891 WIND CREEK DR	SACRAMENTO	CA	95838
78	SEYMOUR B	4887 WIND CREEK DR	SACRAMENTO	CA	95838
79	LA PORTE Q	4883 WIND CREEK DR	SACRAMENTO	CA	95838
80	SHALINE B	4879 WIND CREEK DR	SACRAMENTO	CA	95838
81	HARD, SHEILA	4857 WIND CREEK DR	SACRAMENTO	CA	95838
82	WILLSEY, LEDA	4853 WIND CREEK DR	SACRAMENTO	CA	95838
83	GAINS, MARIANNE	4849 WIND CREEK DR	SACRAMENTO	CA	95838
84	LARA, JOSE & YOLANDA	4845 WIND CREEK DR	SACRAMENTO	CA	95838
85	STANLEY J	8 Briar Creek Dr	SACRAMENTO	CA	95838
86	PETERSON S	12 Briar Creek Dr	SACRAMENTO	CA	95838
87	MORRISON J	15 Briar Creek Dr	SACRAMENTO	CA	95838
88	QUINTANILLA A	13 Briar Creek Dr	SACRAMENTO	CA	95838
89	WALKER S	9 Briar Creek Dr	SACRAMENTO	CA	95838
90	VINCENT W	5 Briar Creek Dr	SACRAMENTO	CA	95838

**EXHIBIT E
MAILING LIST
NORTHSIDE SUBDIVISION MAINTENANCE DISTRICT**

NO.	OWNERS NAME	OWNERS ADDRESS	CITY	ST	ZIP
91	MONTOYA V	4830 WIND CREEK DR	SACRAMENTO	CA	95838
92	DEAL G	4834 WIND CREEK DR	SACRAMENTO	CA	95838
93	BARANDAS W	4838 WIND CREEK DR	SACRAMENTO	CA	95838
94	ESBRI M	4842 WIND CREEK DR	SACRAMENTO	CA	95838
95	SEVERSON D	4846 WIND CREEK DR	SACRAMENTO	CA	95838
96	CURD P	4850 WIND CREEK DR	SACRAMENTO	CA	95838
97	PATE R	4854 WIND CREEK DR	SACRAMENTO	CA	95838
98	STANLEY T	4858 WIND CREEK DR	SACRAMENTO	CA	95838
99	OSTERHOUDT T	4862 WIND CREEK DR	SACRAMENTO	CA	95838
100	NISTERCHUK R	4866 WIND CREEK DR	SACRAMENTO	CA	95838
101	DAY G	4870 WIND CREEK DR	SACRAMENTO	CA	95838
102	Costa, Helen S	880 HUNTERS CREEK DR	SACRAMENTO	CA	95838
103	RIECKEN R	4874 WIND CREEK DR	SACRAMENTO	CA	95838
104	DEGEORGE R	4878 WIND CREEK DR	SACRAMENTO	CA	95838
105	GMAC Mortgage Co	PO BOX 780	WATERLOO	IA	50704
106	JONES E	4936 PINE NUT WY	SACRAMENTO	CA	95838
107	TEPNER S	4935 PINE NUT WY	SACRAMENTO	CA	95838
108	SUDDERBERG J	4894 WIND CREEK DR	SACRAMENTO	CA	95838
109	JONES, MICHAEL & JEANNIE	4898 WIND CREEK DR	SACRAMENTO	CA	95838
110	DUSCHKA T	4926 WIND CREEK DR	SACRAMENTO	CA	95838
111	GOMEZ G	4930 WIND CREEK DR	SACRAMENTO	CA	95838
112	FISCHER S	4934 WIND CREEK DR	SACRAMENTO	CA	95838

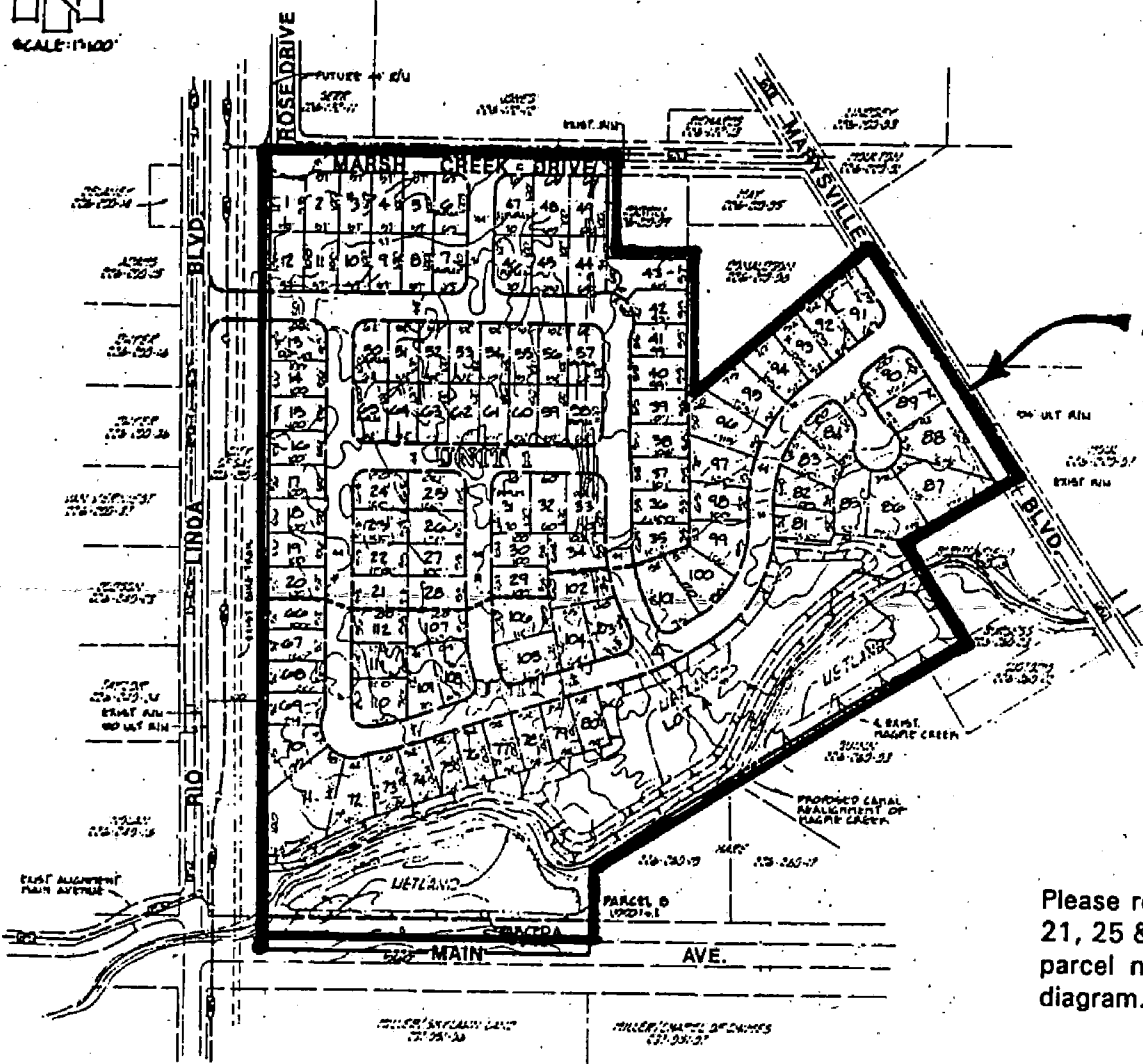

DISTRICT BOUNDARY

NORTHSIDE SUBDIVISION MAINTENANCE DISTRICT ASSESSMENT DIAGRAM

Please refer to Sacramento County Assessor's Map Book 226 Pag 21, 25 & 26 for a detailed description of the lines and demensions and parcel numbers of any parcel within the boundary shown on this diagram.