



1.7

DEPARTMENT OF  
PUBLIC WORKS

ENGINEERING DIVISION

CITY OF SACRAMENTO  
CALIFORNIA

927 TENTH STREET  
ROOM 200  
SACRAMENTO, CA  
95814-2700

PH 916-264-7120  
FAX 916-264-7903

CONSTRUCTION SECTION  
640 BERECUT DRIVE  
SUITE B  
SACRAMENTO, CA  
95814-0131

PH 916-264-5282  
FAX 916-264-7276

August 4, 1994

City Council  
Sacramento, California

Honorable Members in Session:

**SUBJECT:** EXPOSITION BOULEVARD EXTENSION/STATE ROUTE 160  
INTERCHANGE PROJECT (PN: TG61) - PROJECT AND AGREEMENT  
APPROVAL AND BID ADVERTISEMENT

**LOCATION/COUNCIL DISTRICT:** Exposition Boulevard  
District No. 2 and 3

**RECOMMENDATION:**

This report recommends that the City Council:

- Approve the plans and specifications for the Exposition Boulevard Extension/State Route 160 Interchange project.
- Approve the Construction and Maintenance Agreement with Southern Pacific Transportation Company.
- Authorize the City Clerk to advertise and receive bids.

**CONTACT PERSON:** Larry Wing, Senior Engineer, 264-7924

**FOR COUNCIL MEETING OF:** August 23, 1994



City Council  
Exposition Boulevard Extension/SR 160 Interchange (PN:TG61) Project Approval  
and Bid Advertisement  
August 4, 1994

**SUMMARY:**

This project will construct a roadway connection between the western terminus of Exposition Boulevard at Tribute Road and State Route 160 just east of the Radisson Hotel.

Plans and specifications for the Exposition Boulevard Extension/State Route 160 Interchange project have been prepared. Approval of the plans and specifications and authorization to advertise for bids is recommended. Approval of the Construction and Maintenance Agreement with Southern Pacific.

The subject project promotes the City Council priorities regarding neighborhood revitalization and enhancement and public safety.

**COMMITTEE/COMMISSION ACTION:**

None.

**BACKGROUND INFORMATION:**

The Exposition Boulevard Extension/SR160 Interchange project was included in the original one-half percent sales tax ballot measure (Measure A) for transportation projects. This Measure A ballot measure was approved by County voters in November, 1988.

On July 2, 1991, the Council authorized the retention of a consultant to prepare the Project Study Report (PSR), which is an engineering feasibility and alternatives investigation report. In October, 1991, work began on the preparation of a PSR for the complete extension interchange project. The complete project had an estimate of over \$25 million and was proposed to be funded with State Flexible Congestion Relief (50%) and Measure A funds (50%). However, when the City did not receive State Flexible Congestion Relief Funds in the 1992 cycle, staff developed a separate scaled down project that could be funded primarily from City Sales Tax revenue.



**City Council**

**Exposition Boulevard Extension/SR 160 Interchange (PN:TG61) Project Approval  
and Bid Advertisement**

**August 4, 1994**

A revised PSR was prepared and recommended that the project be implemented in two segments. The first segment, which is the subject of this report, will consist of a roadway connection between the western terminus of Exposition Boulevard at Tribute Road and SR160 just east of the Radisson Hotel.

The second segment, which will be designed and constructed at a later date, includes a split diamond interchange at Royal Oaks Drive and Canterbury Road. Timing for the second segment is dependent upon future travel demand in the project vicinity.

In May, 1993, Council authorized the retention of a consultant to prepare the final design and construction documents. The plans and construction documents are now complete, and staff recommends that the project be advertised for construction bids.

If Council approves staff recommendation, bids will be opened on or about September 21, 1994, with project award to the successful bidder scheduled on or about October 4, 1994. Construction would begin shortly thereafter with an expected delivery date of October, 1995. Because we are late in the construction year, any delay to the advertisement or project award dates could seriously affect the anticipated October, 1995 delivery date.

A Negative Declaration for the Exposition Boulevard Extension/State Route 160 Interchange project was filed as approved by the City Council in May 1994.

**FINANCIAL CONSIDERATIONS:**

The engineer's estimated construction cost is \$4,900,000.

The estimated total project cost, including all planning, design and construction costs, is \$8,000,000. The current budget is \$6,750,322, which was approved in the 1994/95 Capital Improvement Program from the Sacramento Transportation Authority Sales Tax - CIP fund (201). The funds available for this project amount



**City Council  
Exposition Boulevard Extension/SR 160 Interchange (PN:TG61) Project Approval  
and Bid Advertisement  
August 4, 1994**

to \$5,594,943, as of August 4, 1994.

There is a current fund shortfall of approximately \$1,250,000. The following sources have been identified for additional necessary funding:

1. State Local Transportation Partnership Program (SLTPP) - This project is in cycle 5 of the (SLTPP), which is a state sponsored program to assist with funding of local streets and roads. Current estimates indicate that this program will fund approximately 19% of the construction cost of this project, or approximately \$931,000.
2. The remaining \$319,000 estimated shortfall will be made up from the Measure A Contingency account, which had an approximate balance of \$415,000 as of July 1, 1994.

Additional funding recommendations will be made after receipt of bids.

A non-refundable fee of \$40 will be charged for each set of plans and specifications to cover reproduction costs.

**POLICY CONSIDERATIONS:**

This action is consistent with Title 58, of the Sacramento City Code concerning advertisement for bids and Resolution No. 93-619 relating to MBE/WBE participation goals and policies.

**MBE/WBE:**

To encourage minority participation, plans and specifications will be sent to 7 (seven) plan rooms and construction service organizations for publication. Four are directly involved with MBE/WBE construction firms. Staff will actively recruit available MBE/WBE firms to participate in the bid process. The project will also be announced on the Architecture and Engineering Management Project Information



City Council  
Exposition Boulevard Extension/SR 160 Interchange (PN:TG61) Project Approval  
and Bid Advertisement  
August 4, 1994

Line which contains information on Public Works and Utility Department projects.  
Project notices will be sent to 11 organizations involved in MBE/WBE recruitment.

Respectfully submitted,

*Larry M. Wing*  
for

TERENCE W. MOORE  
Transportation and Engineering  
Planning Manager

RECOMMENDATION APPROVED:

*William H. Edgar*  
WILLIAM H. EDGAR  
City Manager

APPROVED:

*Michael Kashiwagi*  
MICHAEL KASHIWAGI  
Deputy Director of Public Works

FB:dt  
EA8-30.1  
08.0494.1



# RESOLUTION NO.

ADOPTED BY THE SACRAMENTO CITY COUNCIL

ON DATE OF \_\_\_\_\_

RESOLUTION APPROVING A CONSTRUCTION AND  
MAINTENANCE AGREEMENT BY AND BETWEEN THE  
SOUTHERN PACIFIC TRANSPORTATION COMPANY

BE IT RESOLVED BY THE COUNCIL OF THE CITY OF SACRAMENTO:

- That the Construction and Maintenance Agreement By and Between the City of Sacramento and the Southern Pacific Transportation Company relative to construction and or near the railway tracks is hereby approved;

\_\_\_\_\_  
MAYOR

ATTEST:

\_\_\_\_\_  
CITY CLERK

EA8-30.1

6

\_\_\_\_\_  
FOR CITY CLERK USE ONLY

RESOLUTION NO.: \_\_\_\_\_

DATE ADOPTED: \_\_\_\_\_



S R 160

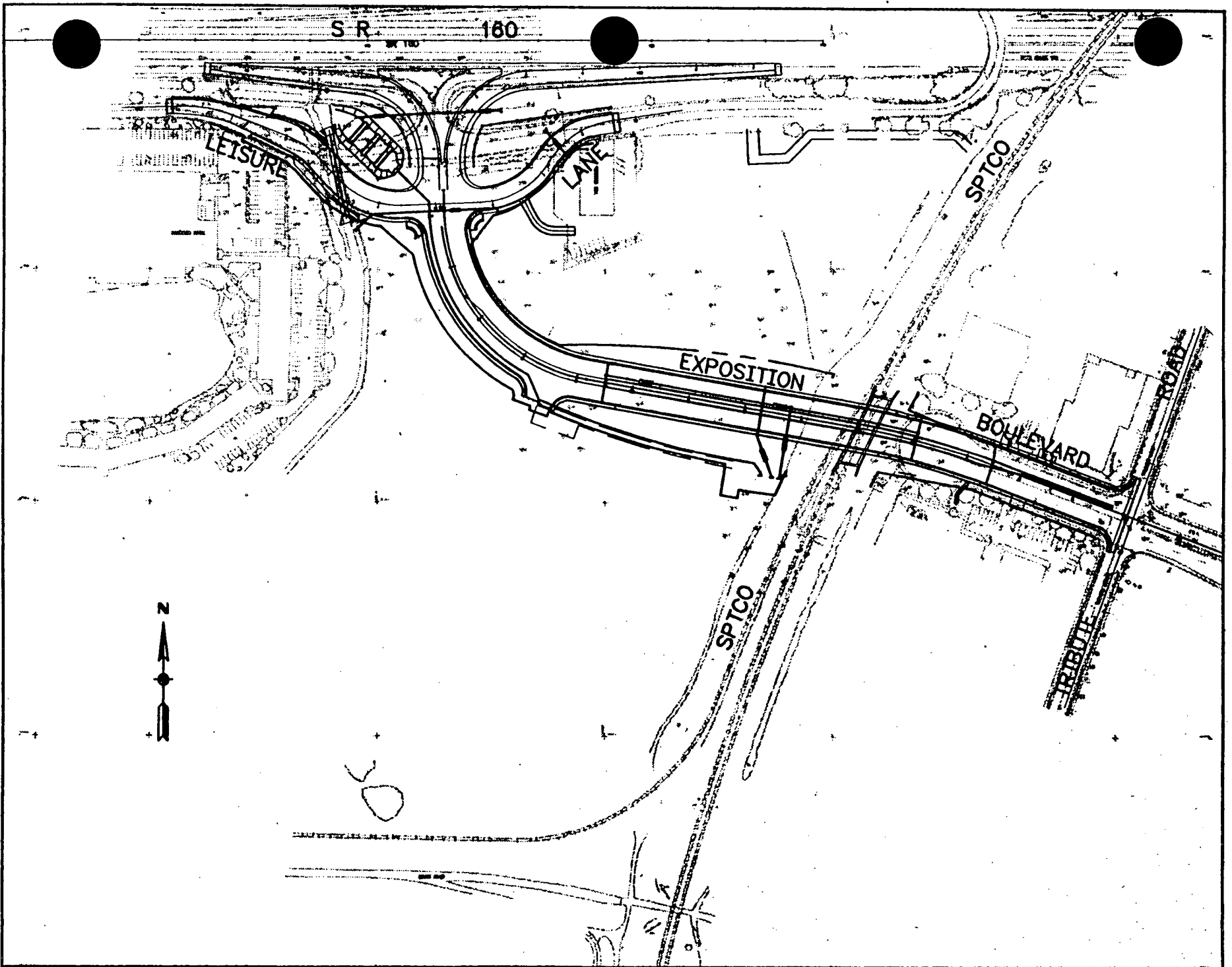

LOCATION MAP

SITE PLAN

