

CITY OF SACRAMENTO
1231 I Street, Sacramento, CA 95814

Permit No: 9907444
Insp Area: 4

Site Address: 2991 WEST RIVER DR SAC
Parcel No: 274-0530-054
N

UNITY PARKSIDE VILLAGE LOT 54

Sub-Type: NSFR
Housing (Y/N):

CONTRACTOR
GIANNONI DEVELOPMENT
1500 W. EL CAMINO AV. # 192
SACRAMENTO CA. 95833-1945

OWNER

ARCHITECT

Nature of Work: MP 2005 2 STORY 7 ROOM SFR

CONSTRUCTION LENDING AGENCY: I hereby affirm under penalty of perjury that there is a construction lending agency for the performance of the work for which this permit is issued (Sec. 3097, Civ. C).

Lender's Name _____ Lender's Address _____

LICENSED CONTRACTORS DECLARATION: I hereby affirm under penalty of perjury that I am licensed under provisions of Chapter 9 (commencing with section 7000) of Division 3 of the Business and Professions Code and my license is in full force and effect.

License Class B License Number 596952 Date 8-23 Contractor Signature Kelly A. Kishwica

OWNER-BUILDER DECLARATION: I hereby affirm under penalty of perjury that I am exempt from the contractors License Law for the following reason (Sec. 7031.5, Business and Professions Code; any city or county which requires a permit to construct, alter, improve, demolish, or repair any structure, prior to its issuance, also requires the applicant for such permit to file a signed statement that he or she is licensed pursuant to the provisions of the Contractors License Law (Chapter 9 (commencing with Section 7000) of Division 8 of the Business and Professions Code) or that he or she is exempt therefrom and the basis for the alleged exemption. Any violation of Section 7031.5 by any applicant for a permit subjects the applicant to a civil penalty of not more than five hundred dollars (\$500.00):

_____ as a owner of the property, or my employees with wages as their sole compensation, will do the work, and the structure is not intended or offered for sale (Sec. 7044, Business and Professional Code: The Contractors License Law does not apply to an owner of property who builds or improves thereon, and who does such work himself or herself or through his/her own employees, provided that such improvements are not intended or offered for sale. If, however, the building or improvement is sold within one year of completion, the owner-builder will have the burden of proving that he/she did not build or improve for the purpose of sale.)

_____ I, as owner of the property, am exclusively contracting with licensed contractors to construct the project (Sec. 7044, Business and Professions Code: The Contractors License Law does not apply to an owner of property who builds or improves thereon, and who contracts for such projects with a contractor(s) licensed pursuant to the Contractors License Law).

I am exempt under Sec. _____ B & PC for this reason: _____

Date _____ Owner Signature _____

IN ISSUING THIS BUILDING PERMIT, the applicant represents, and the city relies on the representation of the applicant, that the applicant verified all measurements and locations shown on the application or accompanying drawings and that the improvement to be constructed does not violate any law or private agreement relating to permissible or prohibited locations for such improvements. This building permit does not authorize any illegal location of any improvement or the violation of any private agreement relating to location of improvements.

I certify that I have read this application and state that all information is correct. I agree to comply with all city and county ordinances and state laws relating to building construction and hereby authorize representative(s) of this city to enter upon the abovementioned property for inspection purposes.

Date X 8-23-99 Applicant/Agent Signature Kelly A. Kishwica

WORKER'S COMPENSATION DECLARATION: I hereby affirm under penalty of perjury one of the following declarations:

_____ I have and will maintain a certificate of consent to self-insure for workers' compensation as provided for by Section 3700 of the Labor Code, for the performance of work for which the permit is issued.

_____ I have and will maintain workers' compensation insurance, as required by Section 3700 of the Labor Code, for the performance of the work for which this permit is issued. My workers' compensation insurance carrier and policy number are:

Carrier STATE FUND Policy Number WC1558309 Exp Date 06/04/2000

_____ (This section need not be completed if the permit is for \$100 or less) I certify that in the performance of the work for which this permit is issued, I shall not employ any person in any manner so as to become subject to the workers' compensation laws of California and agree that if I should become subject to the workers' compensation provisions of Section 3700 of the Labor Code, I shall forthwith comply with those provisions.

Date X 8-23-99 Applicant Signature Kelly A. Kishwica

WARNING - FAILURE TO SECURE WORKER'S COMPENSATION COVERAGE IS UNLAWFUL AND SHALL SUBJECT AN EMPLOYER TO CRIMINAL PENALTIES AND CIVIL FINES UP TO ONE HUNDRED THOUSAND DOLLARS (\$100,000) IN ADDITION TO THE COST OF COMPENSATION, DAMAGES AS PROVIDED FOR IN SECTION 3706 OF THE LABOR CODE, INTEREST AND ATTORNEY'S FEE.

THIS PERMIT SHALL EXPIRE BY LIMITATION IF WORK IS NOT COMMENCED WITHIN 180 DAYS.

PERMITS, ENTITLEMENTS & CONTRIBUTIONS CASH RECEIPT FORM

Category 0056

Item #	Description	Quantity	Agency	Code	Rate	Amount	Category	Code	Amount
320	Transportation Permit	790	DEV	P123	3218		PI		\$
321	Traffic Study	790	DEV	P	3628		ES		\$
322	Tentative Map (from Planning)	790	DEV	P	3234		MR		\$
323	Abandonment's	790	DEV	P	3709		AAB		\$
324	Driveway Permits (Issuance)	101	310	3131	3210	1991	PI		\$
325	Driveway Permits (Inspection)	101	310	3131	3210	1992	FD		\$
326	Unimp. Driveway Permits (St. Div.)	101	310	3192	3210	2291	FD		\$
327	Driveway Variance	101	310	3131	3210	1992	ED		\$
328	Revocable Permit (Staff Issued)	101	310	3131	3299	1988	PI		\$
329	Revocable Permit (Council Action)	101	310	3131	3299	1987	PI		\$
330	Misc. Excavation Permit (Issuance)	101	310	3131	3227	1993	PI		\$
331	Misc. Excavation Permit (Inspection)	101	310	3131	3227	1993	FD		\$
332	Trench Cut Permit (Issuance)	101	310	3191	3227	5405	PI		\$
333	Trench Cut Permit (Inspection)	211	310	3191	3227	5405	FD		\$
334	Certificate of Correction	101	310	3131	3639	1919	MC		\$
335	Pocket Area Bridge Dist Fee	249	310	3131	3629				\$
336	Developer Contribution/ Future Project	790						2464	\$
337	Alternate Transportation Modes	790	DEV	P052	3608		TDM		\$
338	Habitat Conservation Plan (HCP)**	580						2022	\$
Received From:									Total \$ 440.00

I understand that fees may be required if the cost to process the application is greater than the minimum fee. Also, on some applications, additional processing charges may be required after the requested entitlements are approved.

(SIGNATURE) _____ PERMIT *Rev. 00-06*
 FILE # _____ (NEW PROCEDURES)
 Applicant Address for mailing Receipt _____

Name GRANVILLE DEVELOPMENT
 Address 1300 W. L. CAMINO AVE #112
 City, State, Zip MC 95833-1945

Dev Svc Fee Form # 2 Rev 1/5/00

TOTAL AMOUNT PAID \$ 440.00
 Prepared by / Date WPA / 1-16-00
 Check # 2103-6104 or CASH
 Amount Collected for Staff \$ _____
 Amount Collected for Consultant \$ _____

Write - Cashier _____ Yellow - Dev Svc, Gold - Applicant, Pink - file

CERTIFICATION OF INSULATION

ADDRESS OR TRACT <p style="font-size: 2em; font-family: cursive;">GIANNONI</p> <p style="font-size: 1.5em;">2991 W RIVER DR</p> <p style="font-size: 1.5em;">UNITY PARKSIDE</p>	SACRAMENTO INSULATION CONTRACTORS <input checked="" type="checkbox"/> P.O. BOX 854, WEST SACRAMENTO, CA 95691 LIC. #202026 <input type="checkbox"/> 1309 MELODY ROAD, MARYSVILLE, CA 95901 LIC. #202026 <input type="checkbox"/> P.O. BOX 9651, FRESNO, CA 93793-9651 LIC. #202026 <input type="checkbox"/> P.O. BOX 1631, RENO, NV 89505 LIC. #10675 <input type="checkbox"/> 3326 A PONDEROSA WAY, LAS VEGAS, NV 89118 LIC. #10675 DATE INSULATION COMPLETED <p style="font-size: 1.5em; font-family: cursive;">12-16-99</p>
---	--

WALLS	CEILINGS	FLOORS
(SQUARE FEET)	(SQUARE FEET)	(SQUARE FEET)
TYPE OF INSULATION	TYPE OF INSULATION	TYPE OF INSULATION
MATERIAL FIBERGLASS	MATERIAL FIBERGLASS	MATERIAL FIBERGLASS
FORM BATTS	FORM BATTS & BLOW	FORM BATTS
MANUFACTURER'S PRODUCT I D	MANUFACTURER'S PRODUCT I D	MANUFACTURER'S PRODUCT I D
MANUFACTURER	MANUFACTURER	MANUFACTURER
OCF	OCF	OCF
APPLIED THICKNESS	R - VALUE INSTALLED	APPLIED THICKNESS
APPLIED 11 13 19	38 38	3 1/2" 3 5/8" 5 1/2"
APPLIED THICKNESS	R - VALUE INSTALLED	APPLIED THICKNESS
12 1/4" 14 3/4"	38 38	12 1/4" 14 3/4"
KNEE WALLS IF R-VALUE IS OTHER THAN WALLS ABOVE		
MATERIAL FIBERGLASS	FORM BATTS	R VALUE
		MANUFACTURER OCF
AIR INFILTRATION SEALANT		
MATERIAL FOAM	MANUFACTURER W R GRACE	

THIS IS TO CERTIFY THAT INSULATION AND/OR SEALANT HAS BEEN INSTALLED IN CONFORMANCE WITH APPLICABLE CODES, MATERIAL STANDARDS AND REGULATIONS.

SIGNATURE - INSULATION CONTRACTOR 	TITLE MANAGER	DATE 11-17-99
SIGNATURE - GENERAL CONTRACTOR	TITLE	DATE

REMARKS

City of Sacramento
Building Department

To Whom It May Concern

Re: Unity Parkside Village Model Homes.

<u>Permit Number</u>	<u>Address</u>	<u>Lot Number</u>
9907446	2975 West River Dr.	52
9907445	2983 West River Dr.	53
9907744	2991 West River Dr.	54
9907447	2500 Marta Bella Wy.	55

The following items shall be made to comply with Uniform Building Code and local ordinance requirements when the model homes are sold, and prior to final inspection:

1. Separate all wiring running between houses(alarm and speaker wires).
2. Remove exterior flood lights.
3. Remove trap fence.
4. Remove all signs and flags.
5. For lots 52 and 55, convert sales office and design center back to garages.
6. For lots 52-55, relocate fireplace spark arrestors.
7. Remove timers from electric wiring .
8. Install fencing between houses.

Yours truly,

Kenneth Shanks

Kenneth Shanks
Superintendent

DEPARTMENT OF PUBLIC WORKS
TECHNICAL SERVICES DIVISION
DEVELOPMENT SERVICES

12311 STREET, SUITE 200 • SACRAMENTO, CA 95814 • 264-7995 FAX 448-8450

REVOCABLE ENCROACHMENT
APPLICATION AND PERMIT FORM

Please print or type

Site Address West River Drive Cross Street Marta Bella Way
Name of Applicant Giannon Development Phone (916) 646-4506
Address 1500 W. El Camino Ave. #192 City Sacramento State CA Zip 95833

It is hereby requested that revocable permit be granted to:
Name of Record Owner Unity Parkside Village LLC Phone (916) 646-4506
Address Same as above City - State - Zip -

Purpose of Permit:
 Monitoring Well (Quantity _____) Bus Shelter Bicycle Rack
 Other (describe in detail) Temporary Fence for Model Home Complex
 See Attachment for Legal Description

Legal Description:
See Attached Exhibit

In the event the permit for which application is made is granted, it shall be subject to conditions including but not limited to the general conditions set forth in resolution 81-845 adopted by the City Council on November 17, 1981. The undersigned agrees to comply with all such conditions imposed on the permit. (must be signed by owner)

[Signature] Date 1-7-2000

- THIS APPLICATION MUST BE ACCOMPANIED BY THE FOLLOWING:
- 2 COPIES OF EXHIBIT, 8 1/2"x11"; SHOWING STREET CENTERLINE, R.O.W. LINE, CURB, SIDEWALK, BUILDING (IF APPLICABLE) DIMENSION OF ENCROACHMENT & TIE TO STREET CENTERLINE AND NEAREST STREET INTERSECTION & ANY OTHER PERTINENT INFORMATION.
 - REVOCABLE PERMIT CLEARANCE LETTERS IF REQUIRED, CONTACT CITY STAFF REGARDING REQUIREMENTS.
 - PROCESSING FEE, INSURANCE CERTIFICATE AND ANY OTHER ITEMS AS REQUIRED (CONTACT CITY STAFF).
- please do not write below this line

GRANT OF PERMIT

This permit is granted subject to attached "General Provisions - Revocable Encroachment Permit", which were adopted by the City Council in Resolution No. 81-845, dated November 17, 1981, and the hereinafter specified special conditions. This permit shall be effective only after the applicant files with the Risk Management Division of the City of Sacramento, the insurance certificates required by the General Provisions, unless specifically excepted in the special conditions.

For Bus Shelters Only: (check if applicable)
 Reference is made to Revocable Encroachment Permit, City Council Resolution No 86-862, dated November 12, 1986.
 Reference is made to City Managers Agreement No. 95-073 dated March 17, 1995, "Agreement for providing Electrical Service to Bus Shelters".

SPECIAL CONDITIONS

1. Section 21 of Resolution 81-845, "Liability Insurance", is is not required.
- PROVIDE GATE LOCK AS SPECIFIED BY THE SACRAMENTO FIRE DEPARTMENT.
- DEVELOPER RESPONSIBLE FOR ANY DAMAGE TO EXISTING SIDEWALK: STREET MAINTENANCE..

APPROVED FOR THE DIRECTOR OF PUBLIC WORKS:

[Signature] Date 1-25-00
Authorized Signature

UNITY PARKSIDE MODEL HOMES

Temporary Encroachment Exhibit For

City of Sacramento,

California

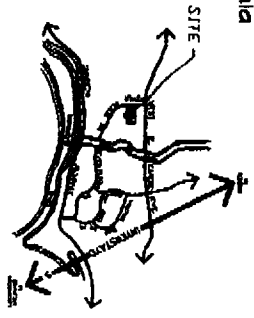
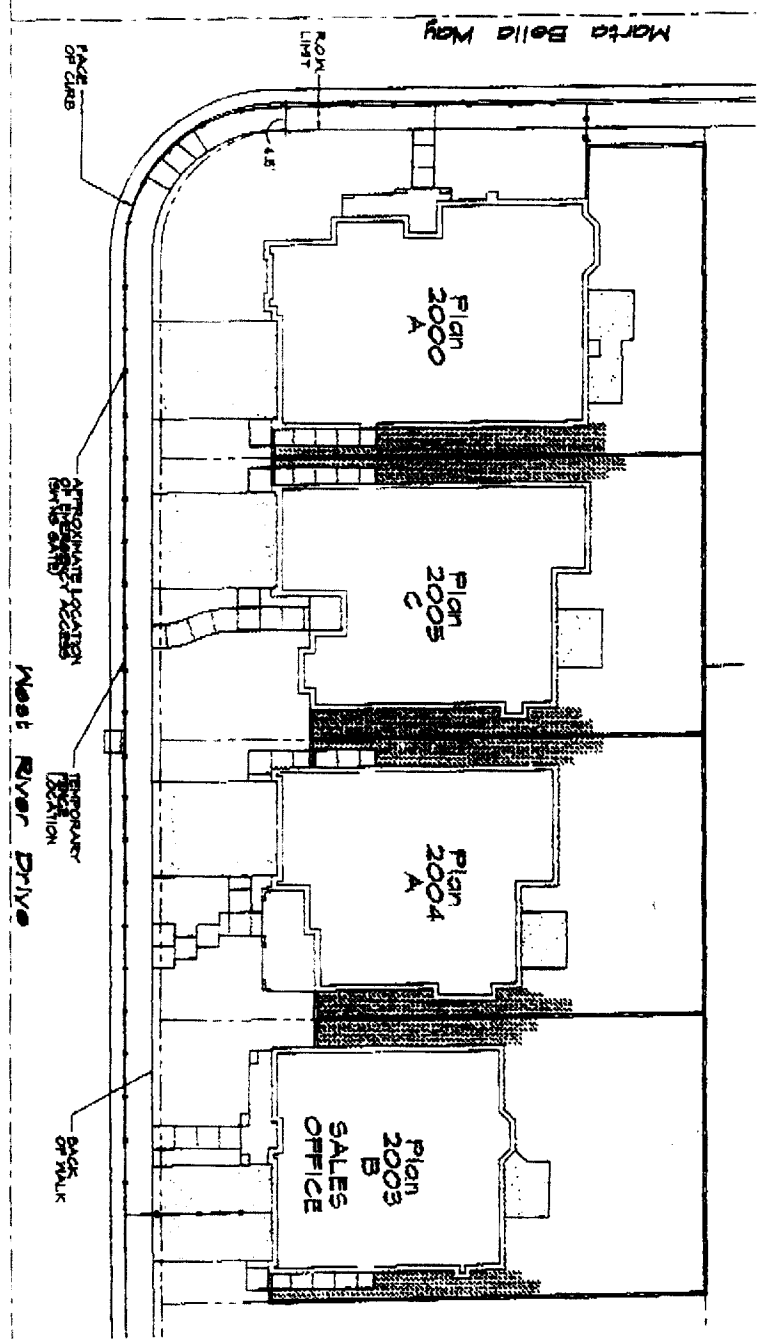

VICINITY MAP

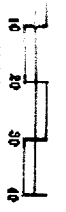

Notes: Grades in temporary road will be required when the model home complex is closed.

January 1, 2000

The Spink Corporation
 1000 North Street, Suite 100
 Sacramento, California 95811
 Phone: (916) 441-1234