



9

APPROVED  
BY THE CITY COUNCIL

AUG 18 1987

OFFICE OF THE  
CITY CLERK

AG87046

DEPARTMENT OF  
PUBLIC WORKS

ENGINEERING DIVISION

THOMAS M. FINLEY  
ENGINEERING DIVISION MANAGER

CITY OF SACRAMENTO  
CALIFORNIA

927 TENTH STREET  
ROOM 200  
SACRAMENTO, CA  
95814-2705

916-449-8220

CONSTRUCTION SECTION  
640 BERGUT DRIVE  
SUITE B  
SACRAMENTO, CA  
95814-0131

916-449-5282

CITY MANAGER'S OFFICE

RECEIVED

AUG 12 1987

August 18, 1987

City Council  
Sacramento, California

Honorable Members In Session:

SUBJECT: Glenwood Park Unit No. 6 (P83-315) - Approval of Final  
Subdivision Map and Agreement

SUMMARY

Adoption of a resolution approving a Final Subdivision Map and Agreement for Glenwood Park Unit No. 6, located at the southwest corner of Main Avenue and Norwood Avenue, is recommended.

BACKGROUND

On February 11, 1986, the City Council approved a Tentative Subdivision Map by adopting Resolution No. 86-115.

All conditions in the staff subdivision report have been met and the Final Subdivision Map is presented for approval.

FINANCIAL

All subdivision costs are being paid by the subdivider, John Mourier Construction, Inc., a California corporation.

City Council  
Glenwood Park Unit No. 6 (P83-315)  
August 18, 1987  
Page 2

RECOMMENDATION

It is recommended that the attached resolution approving the Final Subdivision Map and Agreement be adopted.

Respectfully submitted,



THOMAS M. FINLEY  
Engineering Division Manager

Recommendation Approved:



WALTER J. SLIPE  
City Manager

Approved:



MELVIN H. JOHNSON  
Director of Public Works

JL:vr  
D2-21.F  
08.0587.1

August 18, 1987  
District No. 2

Attachment

# RESOLUTION NO. 87-046

ADOPTED BY THE SACRAMENTO CITY COUNCIL ON DATE OF

APPROVED  
BY THE CITY COUNCIL

AUG 18 1987

APPROVING FINAL SUBDIVISION MAP AND AGREEMENT  
FOR GLENWOOD PARK UNIT NO. 6 (P83-315)

OFFICE OF THE  
CITY CLERK

WHEREAS, THE COUNCIL OF THE CITY OF SACRAMENTO FINDS AND DETERMINES AS  
FOLLOWS:

- A. The Final Subdivision Map for Glenwood Park Unit No. 6, located at the southwest corner of Main Avenue and Norwood Avenue, with provisions for its design and improvement, is consistent with the City General Plan and the 1965 North Norwood Community Plan.
- B. The Final Subdivision Map is in substantial compliance with the previously approved tentative map.

NOW, THEREFORE, BE IT RESOLVED BY THE COUNCIL OF THE CITY OF SACRAMENTO AS  
FOLLOWS:

- 1. The Final Subdivision Map for Glenwood Park Unit No. 6, located at the southwest corner of Main Avenue and Norwood Avenue, be, and the same is hereby approved subject to the execution by all parties of the Subdivision Improvement Agreement for that subdivision.
- 2. All offers of dedication shown on said map are hereby accepted subject to the improvement thereof required by the Subdivision Agreement.
- 3. The City Manager and City Clerk be authorized and directed to execute on behalf of the City of Sacramento that certain Subdivision Improvement Agreement, and abstract thereof, between the City and John Mourier Construction, Inc., a California corporation, to provide for the subdivision improvements required by the Subdivision Map Act and Chapter 40 (Subdivision Regulations) of the Sacramento City Code.

4. The Real Estate Supervisor is authorized and directed to record the above-mentioned agreement in the official records of Sacramento County.

---

MAYOR

ATTEST:

---

CITY CLERK

9

TENTATIVE MAP OF  
**GLENWOOD PARK UNIT NO 6**  
 CITY OF SACRAMENTO  
 JAN. 1984

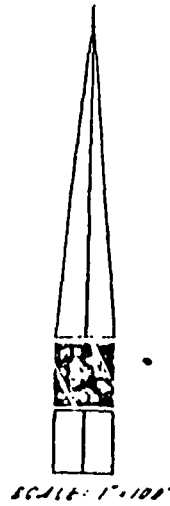
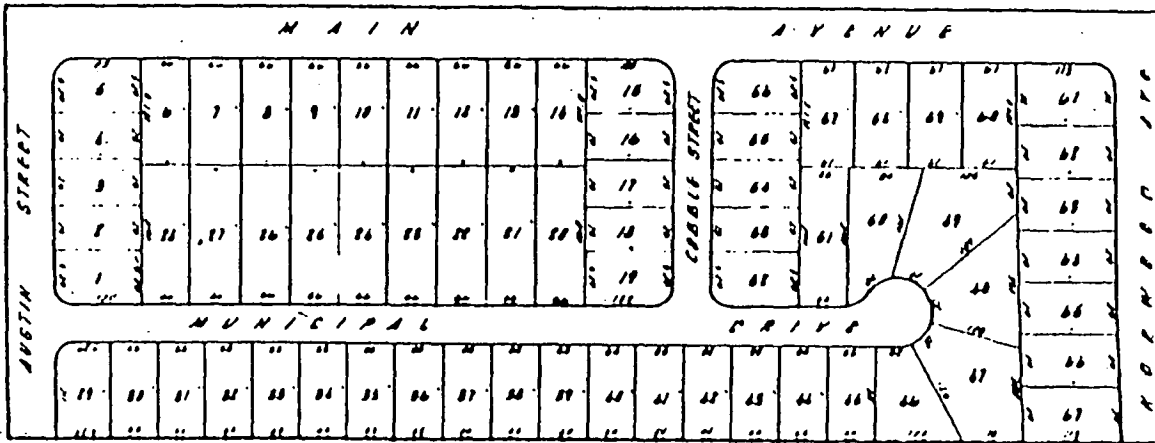

**EXHIBIT**

22

August 31, 1987

John Mourier Construction, Inc.  
1830 Vernon Street, Suite 8  
Roseville, CA 95678

Dear Gentlemen:

On August 18, 1987, the Sacramento City Council adopted Res. 87-666 authorizing the execution of City Agreement #87046, approving Final Subdivision Map for Glenwood Park Unit No. 6 (P83-315).

Enclosed, for your records, is one fully certified copy of said agreement and authorizing resolution.

Sincerely,

LORRAINE MAGANA, CITY CLERK

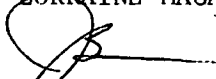

JANICE BEAMAN  
Deputy City Clerk

JB/cc/#9

Enclosure

cc: Public Works  
Risk Management