



APPROVED
BY THE CITY COUNCIL

3.1

JUN 21 1994

OFFICE OF THE
CITY CLERK

DEPARTMENT OF
PUBLIC WORKS

OFFICE OF THE DIRECTOR

CITY OF SACRAMENTO
CALIFORNIA

CITY HALL,
ROOM 200
915 I STREET
SACRAMENTO, CA
95814

May 20, 1994

916-264-7110

ADMINISTRATION
916-264-7100

FAX 916-264-5573

City Council
Sacramento, California

Honorable Members in Session

**SUBJECT: TIMBERLAKE WAY ASSESSMENT DISTRICT 94-01, PUBLIC HEARING
NO. 1**

LOCATION AND COUNCIL DISTRICT

The Timberlake Way Assessment District is located in Council District No. 8. The district includes ten parcels of land located east of Bruceville Road, west of State Route 99 and north of Cosumnes River College Boulevard (please see attached Exhibit "A").

STAFF RECOMMENDATION:

This report recommends that the City Council open the public hearing to present the Timberlake Way Assessment District, take public testimony, and close the hearing. No Council action is requested at this time. A second public hearing will be held on June 14, 1994 (please see attached Exhibit "B") at which time Council may take action on the district.

CONTACT PERSON Edward Williams, Assistant Engineer, 264-5440

FOR COUNCIL MEETING OF: June 8, 1994

SUMMARY

The purpose of this hearing is to receive public testimony for the Timberlake Way Assessment District. On April 19, 1994, Council initiated the district and authorized staff to mail and publish notices. Construction plans and specifications have been prepared and the project has been bid.

COMMITTEE/COMMISSION ACTION

None

CONTINUED
FROM 6-8-94
TO 6-21-94

BACKGROUND INFORMATION

The formation of this district has been requested by the Methodist Hospital of Sacramento. The district is being formed to provide funding for the re-alignment and construction of a portion of Timberlake Way.

The district includes ten parcels, eight are owned by Methodist Hospital of Sacramento, one by Timberlake Partnership which is controlled by Methodist Hospital and one by Community Psychiatric Centers. Petitions in support of the district have been signed by a representative for the nine parcels (87.6% of the 48.6 total district acreage) owned or controlled by the Methodist Hospital of Sacramento.

Based on landowner support for the district, staff recommended on April 19, 1994 that Council initiate proceedings for the district. Bids are being reviewed that were received on May 18, 1994 and will be reported to Council at the June 14, 1994 hearing. The owners of all ten parcels have signed petitions electing to waive the cash collection period and will pay the assessments over a fifteen (15) year period. As of May 20, 1994 no protests have been received by the City Clerk's office.

FINANCIAL CONSIDERATIONS

The project will be funded by property owners within the district. The Methodist Hospital of Sacramento, Timberlake Partnership and Community Psychiatric Centers. The total cost of the project based on the current Engineer's estimate and the amount to be assessed to property owners is \$ 1,487,800 and is itemized as follows:

Construction Cost	\$ 905,600
Contingency	135,800
Engineering & Project Management	126,300
Purchase Bruceville Bonds	101,100
Bond Incidentals	70,300
Reserve Account	104,100
Bond Discount	<u>44,600</u>
Total Project Cost	1,487,800

City Council
Timberlake Way A. D.
May 20, 1994
Page 3

The above expenditures are detailed in the Engineer's Report currently on file with the City Clerk.

POLICY CONSIDERATIONS

The procedures under which this district is being formed are set forth in the California Streets and Highways Code, specifically Division 12 entitled "*Municipal Improvement Act of 1913*" and Division 10 entitled, "*Improvement Bond Act of 1915.*"

MBE/WBE

This project included MBE/WBE participation goals of 10.57% MBE and 9.5% WBE as required by Resolution No. 93-619 relating to MBE/WBE participation goals and policies adopted by the City Council of November 2, 1993. Award of contract is contingent upon the responsive low bidder either meeting this project MBE/WBE participation goals or making adequate Good Faith Efforts towards meeting the project goals. Bids submitted which meet or exceed the MBE/WBE goals may be eligible for bid price preferences up to a maximum of 7% or \$25,000, whichever is less. MBE/WBE information relating to the bids that were received on May 18, 1994 will be reported to Council at the June 14, 1994 hearing.

Respectfully Submitted,

GARY ALM
Supervising Engineer

Recommendation Approved:

WILLIAM H. EDGAR
City Manager

Approved:

MICHAEL KASHIWAGI
Deputy Director of Public Works

EW:94006.CCR

EXHIBIT "A"
TIMBERLAKE WAY
ASSESSMENT DISTRICT NO. 94-01

LOCATION MAP

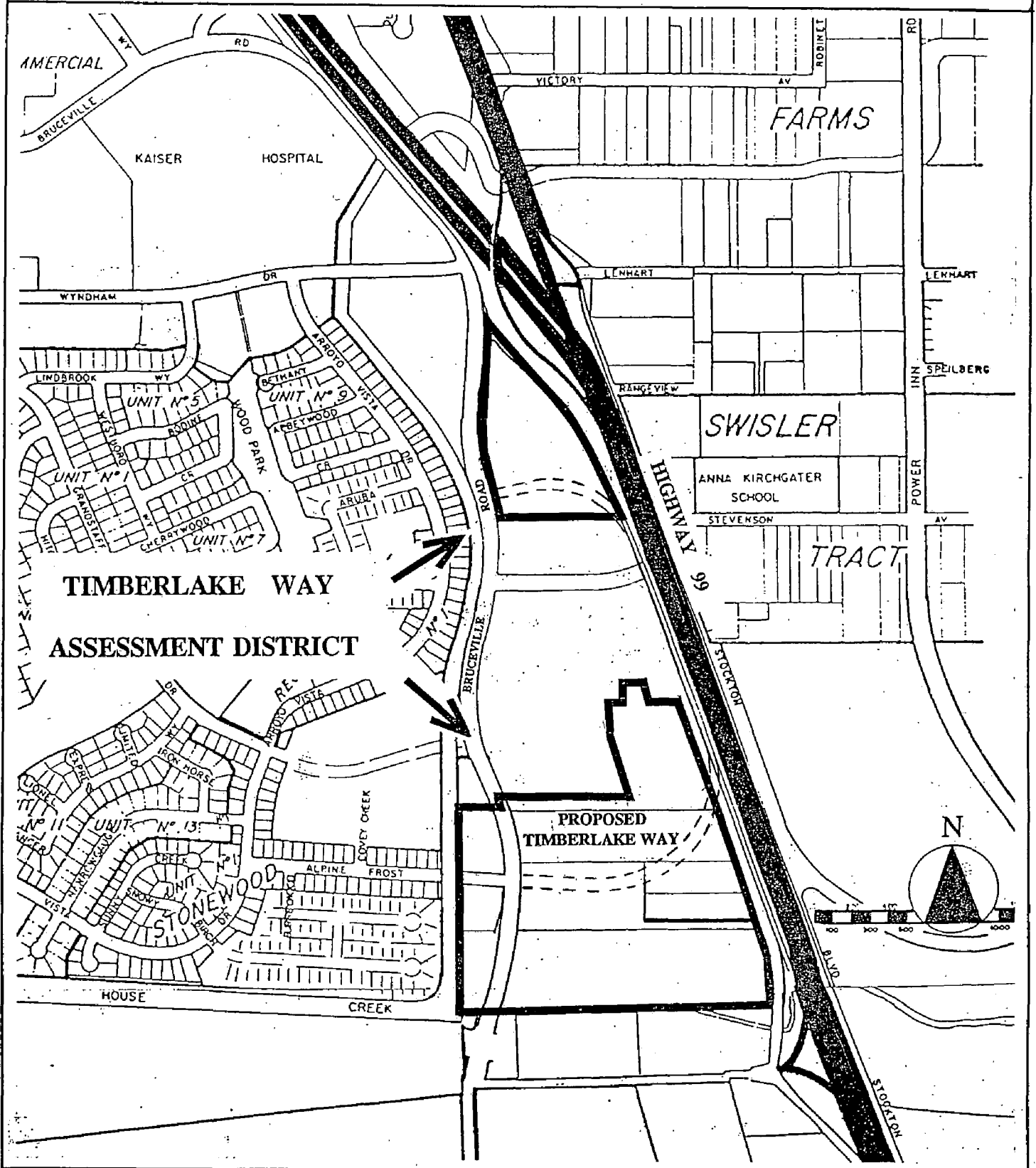

EXHIBIT "B"

TIMBERLAKE WAY ASSESSMENT DISTRICT 94-01

April 19, 1994 **COUNCIL ADOPTS RESOLUTION OF INTENTION AND SETS HEARING DATES**

April 1994 Record Boundary Map with County Recorder

April 1994 Mail, Publish Notice of Hearing

May 18, 1994 Receive Bids

JUNE 8, 1994	COUNCIL HOLDS PUBLIC HEARING NO. 1
---------------------	---

June 14, 1994 Council Holds Public Hearing No. 2

COUNCIL CONSIDERS RESOLUTIONS TO OVERRULE PROTESTS AND LEVY THE ASSESSMENTS

June 1994 Record Assessment Diagram and Notice of Assessment with County

July 26, 1994 **COUNCIL CONSIDERS RESOLUTION AUTHORIZING SALE OF BONDS, APPROPRIATION OF FUNDS - AWARD OF CONTRACT**

August 8, 1994 Bond Closing

August 1994 City Receives Proceeds from Bonds

August 1994 Contractor Notice to Proceed

August 1995 Estimated Completion Date for Improvements

NOTICE OF CONTINUANCE OF HEARING

TO WHOM IT MAY CONCERN:

NOTICE IS HEREBY GIVEN that the public hearing in the Timberlake Way Assessment District No. 94-01, City of Sacramento, Sacramento County, California, being held by the City Council of the City of Sacramento, California, and regularly scheduled for Wednesday, the 8th day of June, 1994, at the hour of 2:00 P.M., in the regular meeting place of said City Council, 915 I Street, Sacramento, California, was continued by order of the City Council of said City of Sacramento to the 21st day of June, 1994, at 2:00 P.M., in the regular meeting place of said City Council, 915 I Street, Sacramento, California.

This Notice is posted in compliance with Section 54955.1 of the Government code of the State of California

Dated: June 8, 1994

VALERIE BURROWES, City Clerk,
City of Sacramento, Sacramento
County, California

By: Valerie A. Burrowes

Do not remove

Mary Lou in
City Clerk's Office
will remove on 6/22/94

CERTIFICATE OF POSTING
NOTICE OF CONTINUANCE OF HEARING

TIMBERLAKE WAY ASSESSMENT DISTRICT NO. 94-01

The undersigned declares:

On June 9th, 1994, the undersigned posted a copy of Notice of Continuance of Hearing for Timberlake Way Assessment District No. 94-01, City of Sacramento, County of Sacramento, State of California, on or near the Chamber Door of the City Council of the City of Sacramento, within 24 hours after the time of continuance of the public hearing. A copy of the notice is attached hereto as Exhibit A.

Executed at Sacramento, California, this 10th day of June, 1994.

I declare the foregoing to be true under penalty of perjury.

VALERIE A. BURROWES, City Clerk,
City of Sacramento,
Sacramento County, California

By Valerie A. Burrowes

ORIGINAL

EXHIBIT A

NOTICE OF CONTINUANCE OF HEARING

TO WHOM IT MAY CONCERN:

NOTICE IS HEREBY GIVEN that the public hearing in the Timberlake Way Assessment District No. 94-01, City of Sacramento, Sacramento County, California, being held by the City Council of the City of Sacramento, California, and regularly scheduled for Wednesday, the 8th day of June, 1994, at the hour of 2:00 P.M., in the regular meeting place of said City Council, 915 I Street, Sacramento, California, was continued by order of the City Council of said City of Sacramento to the 21st day of June, 1994, at 2:00 P.M., in the regular meeting place of said City Council, 915 I Street, Sacramento, California.

This Notice is posted in compliance with Section 54955.1 of the Government code of the State of California

Dated: June 8, 1994

VALERIE BURROWES, City Clerk,
City of Sacramento, Sacramento
County, California

By: _____