

CITY OF SACRAMENTO

1231 I Street, Sacramento, CA 95814

Permit No: 9903581

Insp Area: 4

Site Address: 5148 GORHAM WY SAC

Parcel No: 201-0350-003

NORTHBOROUGH VIL# 5 LOT 3

Sub-Type: NSFR

Housing (Y/N):

N

CONTRACTOR

CENTEX HOMES
3300 DOUGLAS BLVD
STE. 210 95661

OWNER

ARCHITECT

Nature of Work: MP 2512 2 STORY 9 RM SFR

CONSTRUCTION LENDING AGENCY : I hereby affirm under penalty of perjury that there is a construction lending agency for the performance of the work for which this permit is issued (Sec. 3097, Civ. C).

Lender's Name N/A Lender's Address _____

LICENSED CONTRACTORS DECLARATION: I hereby affirm under penalty of perjury that I am licensed under provisions of Chapter 9 (commencing with section 7000) of Division 3 of the Business and Professions Code and my license is in full force and effect.

License Class CS License Number 734094 Date 4-16-99 Contractor Signature Debbie Stawes

OWNER-BUILDER DECLARATION: I hereby affirm under penalty of perjury that I am exempt from the contractors License Law for the following reason (Sec. 7031.5, Business and Professions Code; any city or county which requires a permit to construct, alter, improve, demolish, or repair any structure, prior to its issuance, also requires the applicant for such permit to file a signed statement that he or she is licensed pursuant to the provisions of the Contractors License Law (Chapter 9 (commencing with Section 7000) of Division 8 of the Business and Professions Code) or that he or she is exempt therefrom and the basis for the alleged exemption. Any violation of Section 7031.5 by any applicant for a permit subjects the applicant to a civil penalty of not more than five hundred dollars (\$500.00);

____ I, as a owner of the property, or my employees with wages as their sole compensation, will do the work, and the structure is not intended or offered for sale (Sec. 7044, Business and Professional Code: The Contractors License Law does not apply to an owner of property who builds or improves thereon, and who does such work himself or herself or through his/her own employees, provided that such improvements are not intended or offered for sale. If, however, the building or improvement is sold within one year of completion, the owner-builder will have the burden of proving that he/she did not build or improve for the purpose of sale.)

____ I, as owner of the property, am exclusively contracting with licensed contractors to construct the project (Sec. 7044, Business and Professions Code: The Contractors License Law does not apply to an owner of property who builds or improves thereon, and who contracts for such projects with a contractor(s) licensed pursuant to the Contractors License Law).

____ I am exempt under Sec. _____ B & PC for this reason: _____

Date _____ Owner Signature _____

IN ISSUING THIS BUILDING PERMIT, the applicant represents, and the city relies on the representation of the applicant, that the applicant verified all measurements and locations shown on the application or accompanying drawings and that the improvement to be constructed does not violate any law or private agreement relating to permissible or prohibited locations for such improvements. This building permit does not authorize any illegal location of any improvement or the violation of any private agreement relating to location of improvements.

I certify that I have read this application and state that all information is correct. I agree to comply with all city and county ordinances and state laws relating to building construction and hereby authorize representative(s) of this city to enter upon the abovementioned property for inspection purposes.

Date 4-16-99 Applicant/Agent Signature Debbie Stawes

WORKER'S COMPENSATION DECLARATION: I hereby affirm under penalty of perjury one of the following declarations:

____ I have and will maintain a certificate of consent to self-insure for workers' compensation as provided for by Section 3700 of the Labor Code, for the performance of work for which the permit is issued.

I have and will maintain workers' compensation insurance, as required by Section 3700 of the Labor Code, for the performance of the work for which this permit is issued. My workers' compensation insurance carrier and policy number are:

Carrier AMER. GUAR. & LIAB. INS. Policy Number WC8322096-02 Exp Date 10/01/1999

____ (This section need not be completed if the permit is for \$100 or less) I certify that in the performance of the work for which this permit is issued, I shall not employ any person in any manner so as to become subject to the workers' compensation laws of California and agree that if I should become subject to the workers' compensation provisions of Section 3700 of the Labor Code, I shall forthwith comply with those provisions.

Date 4-16-99 Applicant Signature Debbie Stawes

WARNING: FAILURE TO SECURE WORKER'S COMPENSATION COVERAGE IS UNLAWFUL AND SHALL SUBJECT AN EMPLOYER TO CRIMINAL PENALTIES AND CIVIL FINES UP TO ONE HUNDRED THOUSAND DOLLARS (\$100,000) IN ADDITION TO THE COST OF COMPENSATION, DAMAGES AS PROVIDED FOR IN SECTION 3706 OF THE LABOR CODE, INTEREST AND ATTORNEY'S FEE.

THIS PERMIT SHALL EXPIRE BY LIMITATION IF WORK IS NOT COMMENCED WITHIN 180 DAYS.

COUNTY SANITATION DISTRICT NO. 1
 SACRAMENTO REGIONAL COUNTY SANITATION DISTRICT
SEWER IMPACT FEE
 PERMIT AND CALCULATION SHEET

APPLICATION NO:

BLDG PERMIT NO:

GENERAL INFORMATION

THIS PERMIT GOOD ONLY WHEN
VALIDATED BY THE CASHIER

THIS PERMIT TO CONNECT EXPIRES
ONE YEAR FROM DATE OF ISSUANCE

FEE CALCULATION

BUILDING USE

INSPECTION	RESIDENTIAL	SF	MF	UNITS
CSD-1				
SRCSO				
CONSTRUCTION				
IN-LEU				
TOTAL FEE				

APN

DESCRIPTION/
SUBDIVISION

PROPERTY ADDRESS

OWNER

MAILING ADDRESS

APPROVED BY:

DATE:

APPROVED BY:

DATE:

APPROVED BY:

CONSOLIDATED BLDG PERMIT SYSTEM

ACCT

APPLIC

START

CERTIFICATION OF COMPLIANCE

SCHOOL DISTRICT DEVELOPMENT FEES

PART I: TO BE COMPLETED BY APPLICANT

Property Owner's Name _____
 Owner's Address _____
 Project Address _____
 Parcel Number _____
 Subdivision Name _____
 Number of Units _____
 Print Applicant's Name _____ Applicant's Signature _____
 Title of Applicant _____ Telephone Number _____
 Date _____

PART II: TO BE COMPLETED BY BUILDING DEPARTMENT

Plan Identification Number _____
 Building Type (Check One)
 Residential Apartment/Condominium Commercial/Industrial
 Square Feet of Chargeable Building Area _____
 Signature _____ Date 4-12-07
 Title _____

PART III: TO BE COMPLETED BY NATOMAS UNIFIED SCHOOL DISTRICT

District Certification Number _____
 Fees Collected
 Residential Sq. Ft. X \$ _____ = \$ 11,077.81
 Apartment/Condominium: Sq. Ft. X \$ _____ = \$ _____
 Commercial/Industrial: Sq. Ft. X \$ _____ = \$ _____

NOTICE TO APPLICANT: Pursuant to government code section 66020 (d), this will serve to notify you that the 90-day approval period in which you may protest the fees, or other payment identified above, will begin to run on the date in which the building or installation permit for this project is issued, or on which they are paid to the District or to another public entity authorized to collect them on behalf of the District, whichever is earlier.

Applicant Signature: _____ **Date:** _____

This certification covers only the amount of square footage indicated above. Any additions or corrections to the square footage for this project will require an amendment to the Certificate of Compliance.

As the authorize Natomas Unified School District official, I hereby certify that the requirements of Government Code Section 95995 have been complied with by the above signed applicant.

SIGNATURE: _____ **DATE:** _____
TITLE: _____

Lot Area = 6,595 sf
 Building Footprint = 1,981 sf
 Gross Coverage = 30.0%
 Porch Allowance = 58 sf
 Net Coverage = 29.2%

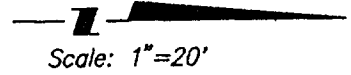

5148 GORHAM WAY

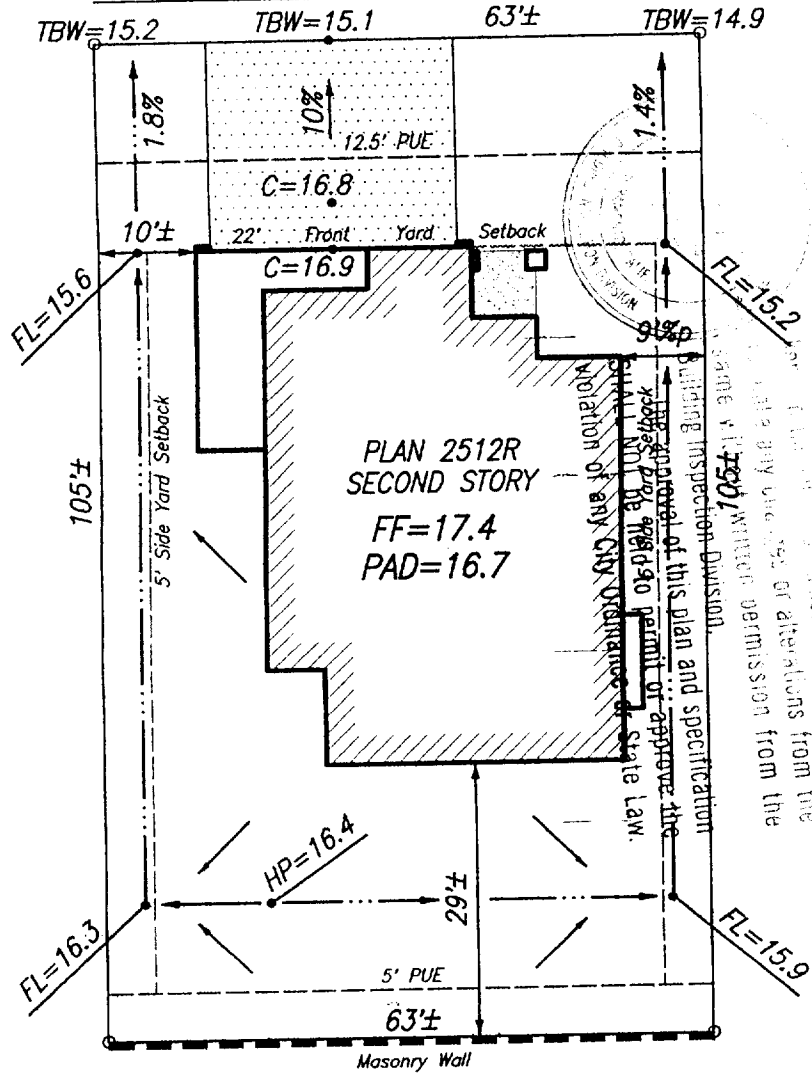

NORTHBOROUGH DRIVE

Plot Plan for Lot 3
 Northborough Village 5-1
 City of Sacramento

Centex Homes
 3300 Douglas Blvd., Suite 210
 Roseville, CA 95661
 Ph.: (916) 786-8693

Plan 2512
 Centex Review & Approval:
 By: [Signature] Date: 3/24/99

Note:
 This plot plan has been prepared for the purpose of showing the building foundation relationship to the property line, proposed drainage elevations and direction of flow to conform to local ordinances and for the purpose of building permit issuance. Information shown is approximate except for those setbacks which are minimums required by ordinance. This plot does not reflect as-built conditions which will likely vary from this plan.

Murray Smith & Associates Engineering, Inc.
 3110 Gold Canal Drive
 Rancho Cordova, CA 95670
 Ph.: (916) 635-1511

March 4, 1999 PN: 99008

Natomas Unified School District
1515 Sports Drive, #1 • Sacramento, CA 95834-1905
Phone 916/641-3300 • Fax 916/928-1629

CERTIFICATION OF COMPLIANCE
SCHOOL DISTRICT DEVELOPMENT FEES

Property Owner's Name	Center Homes
Owner's Address	3300 Douglas Blvd. # 210, Roseville CA 95661
Project Address	5148 Gorcham Way, Sacramento
Parcel Number	201-0350-003
Subdivision Name	Northborough Village S-1
Number of Units	1
Print Applicant's Name	Dhbir Stowers
Applicant's Signature	Dhbir Stowers
Title of Applicant	Permit Coordinator
Date	4.12.99
Telephone Number	786 8693
PLAN IDENTIFICATION DEPARTMENT	
Plan Identification Number	
Building Type (Check One)	<input checked="" type="checkbox"/> Residential <input type="checkbox"/> Apartment/Condominium <input type="checkbox"/> Commercial/Industrial
Square Feet of Chargeable Building Area	2512
Signature	[Signature]
Title	RE-IT
Date	4-12-99
NATOMAS UNIFIED SCHOOL DISTRICT	
District Certification Number	258
Fees Collected:	
Residential:	2512 Sq. Ft. X \$ 4.57 = \$ 11477.84
Apartment/Condominium:	Sq. Ft. X \$
Commercial/Industrial:	Sq. Ft. X \$
NOTICE TO APPLICANT: Pursuant to government code section 66020 (d), this will serve to notify you that the 90-day approval period in which you may protest the fees, or other payment identified above, will begin to run on the date in which the building or installation permit for this project is issued, or on which they are paid to the District, or to another public entity authorized to collect them on behalf of the District, whichever is earlier.	
Applicant Signature:	Date:

This certification covers only the amount of square footage indicated above. Any additions or corrections to the square footage for this project will require an amendment to the Certificate of Compliance.

As the authorize Natomas Unified School District official, I hereby certify that the requirements of Government Code Section 95995 have been complied with by the above signed applicant.

SIGNATURE: [Signature] DATE: 4/15/99
TITLE: [Signature]

COUNTY SANITATION DISTRICT NO
SACRAMENTO REGIONAL COUNTY SANITATION DISTRICT

SEWER IMPACT FEE
PERMIT AND CALCULATION SHEET

APPLICATION NO:	BLDG PERMIT NO: CTN
GENERAL INFORMATION	THIS PERMIT GOOD ONLY WHEN VALIDATED BY THE CASHIER 251062 4-15-99
	- DEPT 26 \$2,855.00 - TR 387299 04/15/99 - RECEIPT 693970 C#4 \$2,855.00
	THIS PERMIT TO CONNECT EXPIRES ONE YEAR FROM DATE OF ISSUANCE

FEE CALCULATION		BUILDING USE	
INSPECTION	0	RESIDENTIAL SF <input type="checkbox"/>	MF <input type="checkbox"/>
CSD-1	470.-	COMMERCIAL USE	UNITS
SRCSD	2385.-		
CONSTRUCTION			
IN-LIEU			
TOTAL FEE	2855.-		

APN: **201-0350-003**
 DESCRIPTION/SUBDIVISION: **Northborough Village S-1 LOT: 3**

PROPERTY ADDRESS
 OWNER: **Center Homes**
 MAILING ADDRESS: **3300 Douglas Blvd #210**
 CITY-STATE-ZIP: **Roseville CA 95661** PHONE: **786-8693**

ADDITIONAL FEES MAY BE DUE IF CHANGES IN USE INCREASE SEWER IMPACT.
 APPLICANT SIGNATURE: **Debi Stowers**

CONSOLIDATED UTILITY BILLING USE ONLY
 ACCT _____ INPUT _____ START _____
BILLING COPY