

CITY OF SACRAMENTO
1231 I Street, Sacramento, CA 95814

Permit No: 9908717
Insp Area: 4

Site Address: 2507 MAYBROOK DR SAC
Parcel No: 201-0370-002 NORTHBOROUGH 3-1 LOT 2

Sub-Type: NSFR
Housing (Y/N): N

CONTRACTOR

US HOME
2366 GOLD MEADOW DR
STE # 100 95671

OWNER

ARCHITECT

Nature of Work: MP 2301 2 STORY 8 ROOM SFR

CONSTRUCTION LENDING AGENCY: I hereby affirm under penalty of perjury that there is a construction lending agency for the performance of the work for which this permit is issued (Sec. 3097, Civ. C).

Lender's Name _____ Lender's Address _____

LICENSED CONTRACTORS DECLARATION: I hereby affirm under penalty of perjury that I am licensed under provisions of Chapter 9 (commencing with section 7000) of Division 3 of the Business and Professions Code and my license is in full force and effect.

License Class 2 License Number 457831 Date 3/13/99 Contractor Signature N. Collins

OWNER-BUILDER DECLARATION: I hereby affirm under penalty of perjury that I am exempt from the contractors License Law for the following reason (Sec. 7031.5, Business and Professions Code: any city or county which requires a permit to construct, alter, improve, demolish, or repair any structure, prior to its issuance, also requires the applicant for such permit to file a signed statement that he or she is licensed pursuant to the provisions of the Contractors License Law (Chapter 9 (commencing with Section 7000) of Division 8 of the Business and Professions Code) or that he or she is exempt therefrom and the basis for the alleged exemption. Any violation of Section 7031.5 by any applicant for a permit subjects the applicant to a civil penalty of not more than five hundred dollars (\$500.00):

I, as a owner of the property, or my employees with wages as their sole compensation, will do the work, and the structure is not intended or offered for sale (Sec. 7044, Business and Professional Code: The Contractors License Law does not apply to an owner of property who builds or improves thereon, and who does such work himself or herself or through his/her own employees, provided that such improvements are not intended or offered for sale. If, however, the building or improvement is sold within one year of completion, the owner-builder will have the burden of proving that he/she did not build or improve for the purpose of sale.)

I, as owner of the property, am exclusively contracting with licensed contractors to construct the project (Sec. 7044, Business and Professions Code: The Contractors License Law does not apply to an owner of property who builds or improves thereon, and who contracts for such projects with a contractor(s) licensed pursuant to the Contractors License Law).

I am exempt under Sec. _____ B & PC for this reason: _____

Date _____ Owner Signature _____

IN ISSUING THIS BUILDING PERMIT, the applicant represents, and the city relies on the representation of the applicant, that the applicant verified all measurements and locations shown on the application or accompanying drawings and that the improvement to be constructed does not violate any law or private agreement relating to permissible or prohibited locations for such improvements. This building permit does not authorize any illegal location of any improvement or the violation of any private agreement relating to location of improvements.

I certify that I have read this application and state that all information is correct. I agree to comply with all city and county ordinances and state laws relating to building construction and hereby authorize representative(s) of this city to enter upon the abovementioned property for inspection purposes.

Date 3/13/99 Applicant/Agent Signature N. Collins

WORKER'S COMPENSATION DECLARATION: I hereby affirm under penalty of perjury one of the following declarations:

I have and will maintain a certificate of consent to self-insure for workers' compensation as provided for by Section 3700 of the Labor Code, for the performance of work for which the permit is issued.

I have and will maintain workers' compensation insurance, as required by Section 3700 of the Labor Code, for the performance of the work for which this permit is issued. My workers' compensation insurance carrier and policy number are:

Carrier OLD REPUBLIC INS. CO. Policy Number OMWC107186 Exp Date 11/01/1999

(This section need not be completed if the permit is for \$100 or less) I certify that in the performance of the work for which this permit is issued, I shall not employ any person in any manner so as to become subject to the workers' compensation laws of California and agree that if I should become subject to the workers' compensation provisions of Section 3700 of the Labor Code, I shall forthwith comply with those provisions.

Date 3/13/99 Applicant Signature N. Collins

WARNING: FAILURE TO SECURE WORKER'S COMPENSATION COVERAGE IS UNLAWFUL AND SHALL SUBJECT AN EMPLOYER TO CRIMINAL PENALTIES AND CIVIL FINES UP TO ONE HUNDRED THOUSAND DOLLARS (\$100,000) IN ADDITION TO THE COST OF COMPENSATION, DAMAGES AS PROVIDED FOR IN SECTION 3706 OF THE LABOR CODE, INTEREST AND ATTORNEY'S FEE.

THIS PERMIT SHALL EXPIRE BY LIMITATION IF WORK IS NOT COMMENCED WITHIN 180 DAYS.

Models

RESIDENTIAL BUILDING PERMIT APPLICATION

- New Construction
- Addition
- Remodels
- Other

Project Address: Maybrook Drive Assessor Parcel # _____

OWNER INFORMATION: Lot 4

Legal Property Owner: U.S. Home Corp. Phone # (916) 858-3900
 Owner Address: 2366 Gold Meadow Way, #20 City Gold River State Ca Zip 95670

CONTRACTOR INFORMATION:

Contractor: U.S. Home Corp. Lic. # 451839 Phone # 858-3900 Fax# 858-3925

PROJECT INFORMATION: U.S. Home 2546

Land Use Zone _____ Occupancy Group _____ Construction Type _____ Fed Code _____
 No. of stories: 2 No. of rooms: 9 Street width: _____
 1st Floor Area 1329 2nd Floor Area _____ Basement _____ *Roof Material _____

AREA IN SQUARE FOOT OF:	EXISTING	NEW
Dwelling/Living	_____	<u>2546</u>
Garage/Storage	_____	<u>445</u>
Decks/Balconies	_____	<u>33</u>
Carports	_____	_____

SCOPE OF WORK: _____

FOR OFFICE USE ONLY

- Information above complete
- Violation files checked
- Standard setbacks
- County Sewer
- AR Flood Waiver required
- Flood Elevation Certificate Required
- Water Development Infill Area
- Planning Approval
- Design Review Approval
- Special Fee Districts Apply : _____

NEW STRUCTURES & ADDITIONS

◆ THE FOLLOWING MUST BE PROVIDED IN ORDER TO SUBMIT FOR PLAN REVIEW

- 2 COMPLETE PLANS, LEGIBLE & DRAWN TO SCALE
 - 3 SETS IF PROJECT IS IN A DESIGN REVIEW AREA
 - Title 24 Energy Compliance documentation
 - Grading and Erosion Control Questionnaire
 - 11" x 17" copy of floor plan for County Assessor
 - Plan Review Fees
- ◆ Plans to include: site plan, floor plan, elevations, roof/ceiling plan, foundation and structural framing details, and structural calculations for non-conforming structures.

Date: _____ Received by: (staff) _____

ACTIVITY/PERMIT # _____

WES PAC

INSULATION, INC.



THIS IS TO CERTIFY THAT INSULATION HAS BEEN INSTALLED IN CONFORMANCE WITH CURRENT ENERGY REGULATIONS, CALIFORNIA ADMINISTRATIVE CODE, TITLE 24, STATE OF CALIFORNIA, IN THE BUILDING LOCATED AT:

LOT 2 PLAN 2301

LOT #

TRACT #

STREET

NANTONA TRADITIONS

CITY

EXTERIOR WALLS:

MANUFACTURER _____ OR _____ THICKNESS/TYPE _____ R-
VALUE _____

CEILING:

BATT: _____ THICKNESS/TYPE _____ R-
VALUE _____

BLOWN IN:

MANUFACTURER _____ GREENSTONE THICKNESS/TYPE _____ R-
VALUE _____

SQUARE FOOTAGE COVERED _____ 1014 NUMBER OF BAGS USED _____ 38

FLOORS:

MANUFACTURER _____ THICKNESS/TYPE _____ R-
VALUE _____

SLAB ON GRADE:

MANUFACTURER _____ THICKNESS/TYPE _____ R-
VALUE _____

WIDTH OF INSULATION _____ INCHES

FOUNDATION WALLS:

MANUFACTURER _____ THICKNESS/TYPE _____ R-
VALUE _____

GENERAL CONTRACTOR _____

CALIFORNIA CONTRACTORS LICENSE # _____

DATE _____

SIGNATURE

TITLE

INSULATION CONTRACTOR WES PAC INSULATION, INC.

CALIFORNIA CONTRACTORS LICENSE #

#487478

DATE

10/21/08

SIGNATURE

TITLE

Wes Pac Insulation

Wes Pac Insulation

COUNTY SANITATION DISTRICT NO. 1
 SACRAMENTO REGIONAL COUNTY SANITATION DISTRICT

SEWER IMPACT FEE 01/24/99
 PERMIT AND CALCULATION SHEET BOB

APPLICATION NO:

BLDG PERMIT NO: *City*

GENERAL INFORMATION

THIS PERMIT GOOD ONLY WHEN
 VALIDATED BY THE CASHIER/
 253049 8/12/99

- DEPT 26 \$2,855.00
 - TRN 395621 08/12/99
 - RECEIPT 714023 C*2 \$2,855.00
 THIS PERMIT TO CONNECT EXPIRES
 ONE YEAR FROM DATE OF ISSUANCE

FEE CALCULATION

BUILDING USE

INSPECTION	RESIDENTIAL	SF	MF
	COMMERCIAL USE		<input type="checkbox"/>
CSD-1		<i>470-</i>	
SRCSD		<i>2305-</i>	
CONSTRUCTION			
IN-LIEU			
TOTAL FEE		2,855-	

APN: *201-0370-002*

DESCRIPTION / *Northbrook V3-Unit #1* LOT: *2*

PROPERTY ADDRESS *2507 Maplewood Drive*

OWNER *U.S. Home Corp*

MAILING ADDRESS *2344 Gold Meadow Way #200*

CITY-STATE-ZIP *Salt Lake City, UT 84119* PHONE *858-3900*

ADDITIONAL FEES MAY BE DUE IF CHANGES IN USE INCREASE SEWER IMPACT.

APPLICANT SIGNATURE

W. D. Perkins

CONSOLIDATED UTILITY BILLING USE ONLY

ACCT _____ INPUT _____ START _____

INSPECTOR'S COPY

Worth Coming Home To



LISTED ON THE NEW YORK STOCK EXCHANGE

*Recognized 3 Times As
National Builder of the Year*

DATE: November 23, 1999

TO: City of Sacramento, Building Department
FROM: Sally S Sanderson, Vice President of Construction

A handwritten signature in black ink, appearing to be "MS", located to the right of the TO and FROM fields.

RE: Model home conversion - 2511 Maybrook Way
Northborough Unit 3-1 - lot 2

The above address will be used temporary as a model home till the completion of the Natomas Park Traditions.

At the completion, US Home will convert model home to a single family residence by doing the following:

1. Remove connecting walk between lots 2 and 3.
2. Remove trap fence .
3. Install side property line fence and side fence with gate
4. Remove connecting low volt wiring between lots 2 and 3 that is being used for a alarm system.
5. Convert sales office back to two car garage, remove all duct work in temp sales office, and install door into house from garage.

cc: Mitch Young
sales staff

NORMAN SCHEEL STRUCTURAL ENGINEER

SACRAMENTO
6939 SUNRISE BLVD., SUITE 123
CITRUS HEIGHTS, CA 95610
PHONE (916) 726-0612
FAX (916) 726-5185

DAVIS
1623 57th STREET SUITE F.
DAVIS, CA 95616
PHONE (530) 753-3300
FAX (530) 753-5300

PROJECT: NATOMAS LEGENDS/TRAD CLIENT: USH
JOB NO: US270 DATE: 10-6-99
CALCULATED BY: TH SHEET NO: 1 OF 1

USHOME 3051/2345 NATOMAS LEGENDS/TRADITIONS

TOP PLATE SPICES REQ'D AT BEARING & SHEARWALLS

ALL PLATES MUST BE LAPPED W/ MIN. 48" LAP
AND 24-16d EACH LAP, 12-16d EACH SIDE OF LAP.

WHERE 48" LAPS CANNOT BE MADE (DUE TO
INTERSECTING WALLS, ETC) PROVIDE A SIMPSON
MISC40 OR (2) CS16 STRAPS ACROSS PLATE BREAKS.



NORMAN SCHEEL STRUCTURAL ENGINEER

SACRAMENTO
 6937 SUNNYSIDE BLVD., SUITE 123
 CITRUS HEIGHTS, CA 95610
 PHONE (916) 726-0612
 FAX (916) 726-3189

DAVIS
 1621 5TH STREET, SUITE F
 DAVIS, CA 95616
 PHONE (916) 782-8800
 FAX (916) 753-5380

PROJECT: **NATOMAS LEGENDS**

CLIENT: **VSHOMES**

JOB NO: **V5279**

DATE: **10-21-99**

CALCULATED BY: **JH**

SHEET NO: **1** OF **1**

2301 NATOMAS -

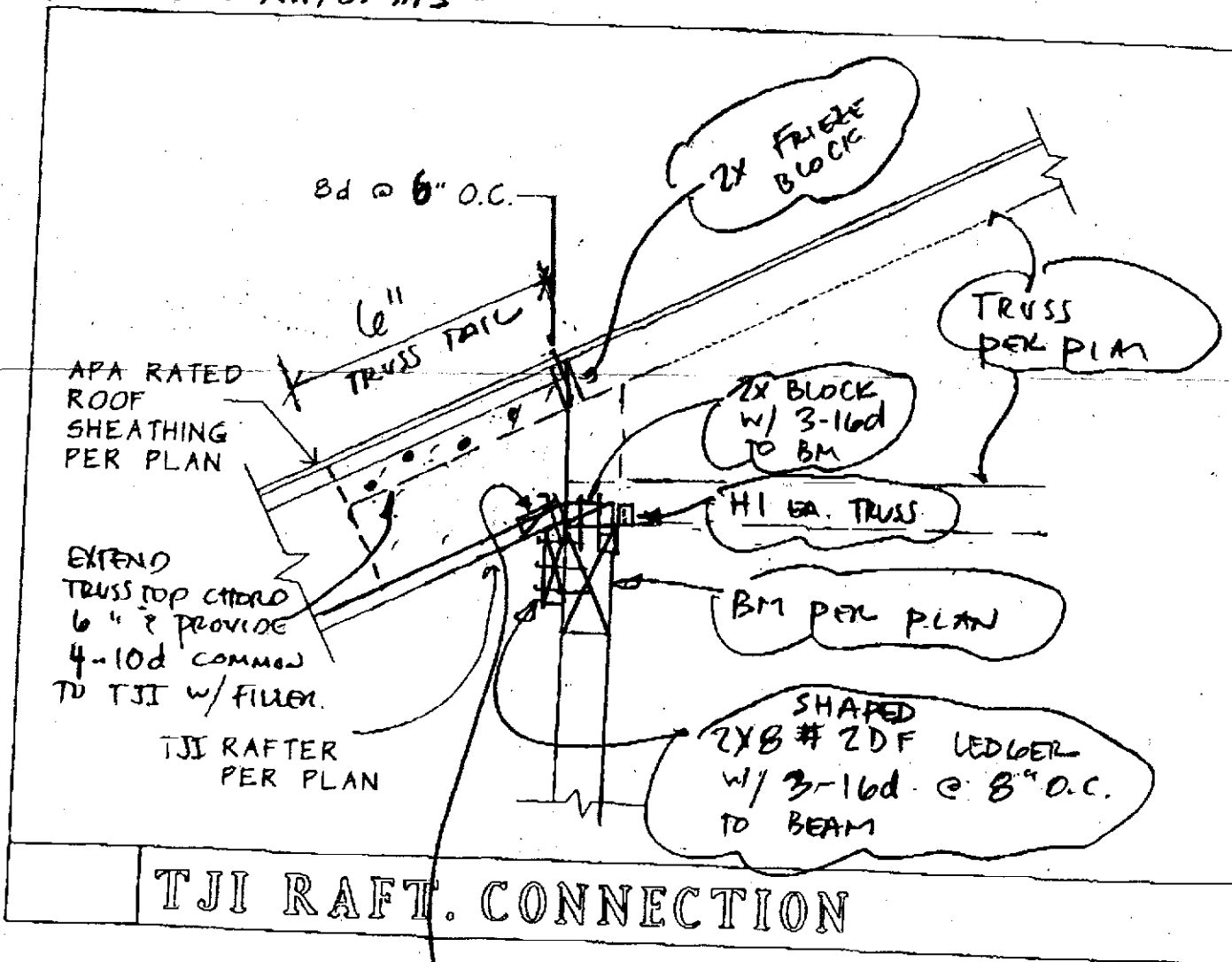

TJI RAFT. CONNECTION

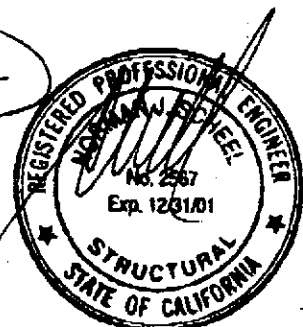

Lot Area = 5,265 sf
 Building Footprint = 2,021 sf
 Gross Coverage = 38.4%
 Porch Allowance = 54 sf
 Net Coverage = 37.4%

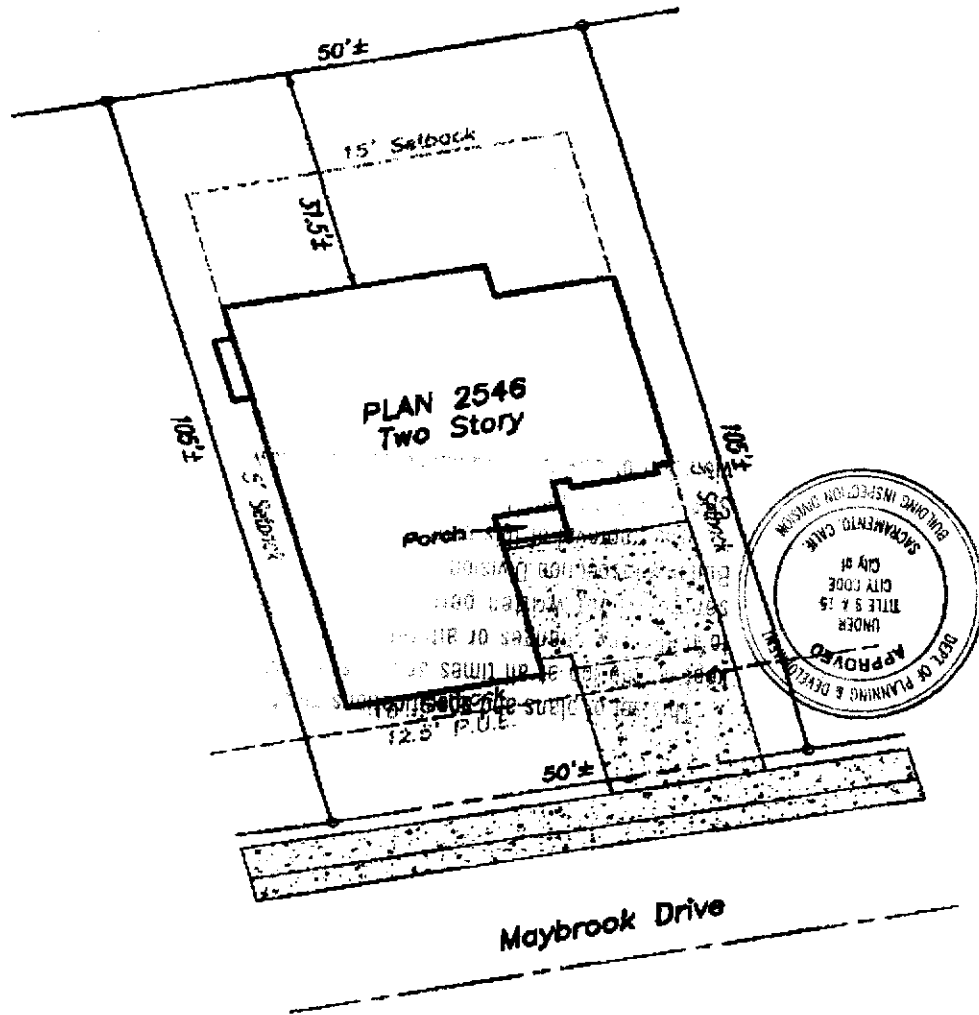

SCALE: 1" = 20'
 1

Plot Plan for Lot 4
U.S.Home - Northborough - Inaugural Series
City of Sacramento

Note:
 This plot plan has been prepared for the purpose of showing the building foundation relationship to the property line, proposed drainage elevations and direction of flow to conform to local ordinances and for the purpose of building permit issuance. Information shown is approximate except for those setbacks which are minimums required by ordinance. This plot does not reflect as-built conditions which will likely vary from this plan.

Murray Smith & Associates
Engineering, Inc.
 3110 Gold Canal Drive
 Rancho Cordova, CA 95670
 Ph.: (916) 635-1511

June 23, 1999

PN: 99003