

CITY OF SACRAMENTO
1231 I Street, Sacramento, CA 95814

Permit No: 0409860
Insp Area: 4
Thos Bros: 256-H7

Site Address: 3321 MARRISSEY LN SAC Sub-Type: NSFR
Parcel No: 225-2010-039 CAMBAY WEST UNIT 4 LOT 39 Housing (Y/N): N

CONTRACTOR
GRIFFIN INDUSTRIES
24005 VENTURA BL.
CALABASAS CA. 91302

OWNER

ARCHITECT

Nature of Work: MP 1823 2 STORY 7 ROOM SFR

CONSTRUCTION LENDING AGENCY : I hereby affirm under penalty of perjury that there is a construction lending agency for the performance of the work for which this permit is issued (Sec. 3097, Civ. C).

Lender's Name _____ Lender's Address _____

LICENSED CONTRACTORS DECLARATION: I hereby affirm under penalty of perjury that I am licensed under provisions of Chapter 9 (commencing with section 7000) of Division 3 of the Business and Professions Code and my license is in full force and effect.

License Class B License Number 684448 Date 7/15/04 Contractor Signature Jerry Peterson

OWNER-BUILDER DECLARATION: I hereby affirm under penalty of perjury that I am exempt from the contractors License Law for the following reason (Sec. 7031.5, Business and Professions Code; any city or county which requires a permit to construct, alter, improve, demolish, or repair any structure, prior to its issuance, also requires the applicant for such permit to file a signed statement that he or she is licensed pursuant to the provisions of the Contractors License Law (Chapter 9 (commencing with Section 7000) of Division 8 of the Business and Professions Code) or that he or she is exempt therefrom and the basis for the alleged exemption. Any violation of Section 7031.5 by any applicant for a permit subjects the applicant to a civil penalty of not more than five hundred dollars (\$500.00);

____ I, as a owner of the property, or my employees with wages as their sole compensation, will do the work, and the structure is not intended or offered for sale (Sec. 7044, Business and Professional Code: The Contractors License Law does not apply to an owner of property who builds or improves thereon, and who does such work himself or herself or through his/her own employees, provided that such improvements are not intended or offered for sale. If, however, the building or improvement is sold within one year of completion, the owner-builder will have the burden of proving that he/she did not build or improve for the purpose of sale.)

____ I, as owner of the property, am exclusively contracting with licensed contractors to construct the project (Sec. 7044 Business and Professions Code: The Contractors License Law does not apply to an owner of property who builds or improves thereon, and who contracts for such projects with a contractor(s) licensed pursuant to the Contractors License Law).

____ I am exempt under Sec. _____ B & PC for this reason: _____

Date _____ Owner Signature _____

PAID
CITY OF SACRAMENTO
JUL 15 2004
NORTH PERMIT CENTER

IN ISSUING THIS BUILDING PERMIT, the applicant represents, and the city relies on the representation of the applicant, that the applicant verified all measurements and locations shown on the application or accompanying drawings and that the improvement to be constructed does not violate any law or private agreement relating to permissible or prohibited locations for such improvements. This building permit does not authorize any illegal location of any improvement or the violation of any private agreement relating to location of improvements.

I certify that I have read this application and state that all information is correct. I agree to comply with all city and county ordinances and state laws relating to building construction and hereby authorize representative(s) of this city to enter upon the abovementioned property for inspection purposes.

Date 7/15/04 Applicant/Agent Signature Jerry Peterson

WORKER'S COMPENSATION DECLARATION: I hereby affirm under penalty of perjury one of the following declarations:

____ I have and will maintain a certificate of consent to self-insure for workers' compensation as provided for by Section 3700 of the Labor Code, for the performance of work for which the permit is issued.

____ I have and will maintain workers' compensation insurance, as required by Section 3700 of the Labor Code, for the performance of the work for which this permit is issued. My workers' compensation insurance carrier and policy number are:

Carrier STATE COMP. INS. FUND Policy Number WC 1673452-2003 Exp Date 01/01/2005

____ (This section need not be completed if the permit is for \$100 or less) I certify that in the performance of the work for which this permit is issued, I shall not employ any person in any manner so as to become subject to the workers' compensation laws of California and agree that if I should become subject to the workers' compensation provisions of Section 3700 of the Labor Code, I shall forthwith comply with those provisions.

Date 7/15/04 Applicant Signature Jerry Peterson

WARNING: FAILURE TO SECURE WORKER'S COMPENSATION COVERAGE IS UNLAWFUL AND SHALL SUBJECT AN EMPLOYER TO CRIMINAL PENALTIES AND CIVIL FINES UP TO ONE HUNDRED THOUSAND DOLLARS (\$100,000) IN ADDITION TO THE COST OF COMPENSATION, DAMAGES AS PROVIDED FOR IN SECTION 3706 OF THE LABOR CODE, INTEREST AND ATTORNEY'S FEE.

THIS PERMIT SHALL EXPIRE BY LIMITATION IF WORK IS NOT COMMENCED WITHIN 180 DAYS.

THIS PLOT PLAN IS PROVIDED AS A GENERAL LAYOUT OF THE PROPERTY. ALL INFORMATION ON THIS PLAN INCLUDING: SETBACK DIMENSIONS, DRIVEWAY GRADES, SLOPE AND WALL HEIGHTS AND LOCATIONS, ARE APPROXIMATE AND MAY VARY OR CHANGE WITHOUT PRIOR NOTICE.

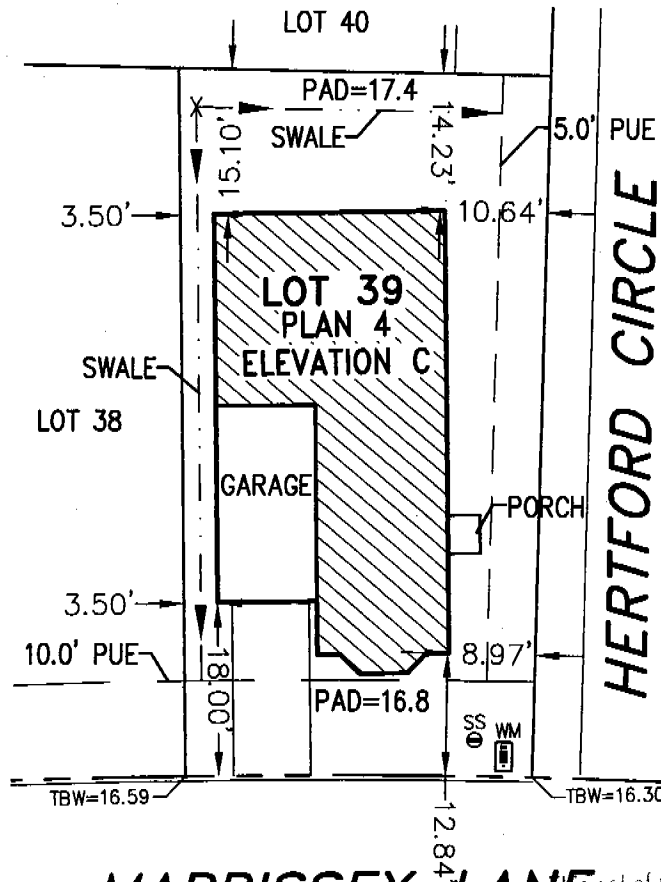
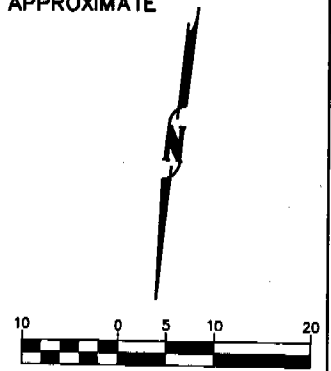

MARRISSEY LANE

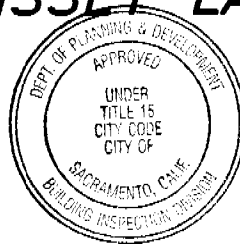

This set of plans and specifications must be kept on the job at all times and it is unauthorized to make any changes or alterations from the same without written permission from the Building Inspection Division.

The approval of this plan and specifications SHALL NOT be held to permit or excuse violation of any City Ordinance or State Law.

0409860

LEGEND

- SBL - SET BACK LINE
- PUE - PUBLIC UTILITY ESMT.
- TBC - TOP BACK OF CURB
- WM - WATER METER
- SS - SANITARY SEWER
- TBW - TOP BACK OF WALK

GRIFFIN INDUSTRIES
 4200 DUCKHORN DR.
 SACRAMENTO, CA 95834
 (916) 515-0171

LOT SIZE = 2735 SF
 BLDG. FOOTPRINT = 1061 SF
 FRONT SETBACK = 10.0'
 LEFT SETBACK = 3.5'
 RIGHT SETBACK = 5.0'
 REAR SETBACK = 0

CAMBAY WEST UNIT 4

3321 MARRISSEY LANE

SACRAMENTO

CALIFORNIA

Carter & Burgess

Carter & Burgess Inc.

DRAWN BY: AJL

CHECKED BY: RJT

W.O. NO.: 333251

DWG.: Phase 2

SCALE: 1"=20'

DATE: 06-04-04



Planning and Building Department
Building Division

CITY OF SACRAMENTO
CALIFORNIA

November 7, 2003

Downtown Permits Center
1231 I Street, #200
Sacramento, CA 95814-2998

North Permits Center
2101 Arena Blvd., Suite 200
Sacramento, CA 95834

ADDRESS 3321 MARRISSEY PERMIT NO. 0409860

INSPECTION COMMENTS	PERMIT DOCUMENTS
8-19-04 B70 Setback RLB	
9-1-04 B10-12 CN CRB	
9/2/04 B10, E11, B12 AP MA	
10-6-04 P42, 43 AP RLB	
12-22-04 E6B AP CDG	
3/25/05 B17 AP CR	
4-14-05 B26 NOT READY CN BRB	
4-18-05 B26 CANC RLB	
4-19-05 B26 CANC RLB	
5/10/05 B18 AP JBB	
5/10/05 B, 71, CN JBB	OK TO INS
5-12-05 B26/81/14 AP JBB	
7/1/05 E-67 AP MA	
5-6-05 P47 AP MTRAL	
9-12-05 Final CANC MTR	
9-19-05 Final CN MK	
9-20-05 Final Canal MK	

FINAL APPROVALS	
BUILDING	
ELECTRICAL	
PLUMBING	
MECHANICAL	
FIRE	
SITE	

INSTALLATION CERTIFICATE

Page 2 of 4

CF-6R

Maplewood Plan 3

Site Address

Permit Number

FENESTRATION/GLAZING:

321 Murray

3321 Murray

Item #	Manufacturer Name (OR) P LINE PRODUCTS	Operator Type (Name)	Manufacturer Product Labelled (U-value for CF-1R value)	Min. R-Value Product # of Panels	Default U-Value	Quantity (Ordered)	Total Square Feet	Comments/ Special Features
1.	1118	SH	.62					
2.	1518	SH	.62					
3.	215/DIC	SH	.62					
4.	450	SH	.62					
5.								
6.								
7.								
8.								
9.								
10.								
11.								
12.								
13.								
14.								
15.								

* The listed U-value must be less than or equal to value from CF-1R. Alternatively, installed weighted average U-value for the total fenestration area is less than or equal to value from CF-1R.

I, the undersigned, verify that the fenestration/glazing listed above my signature (1) is the actual fenestration product installed; (2) is equivalent to or more efficient than that specified in the certificate of compliance (Form CF-1R) as required for compliance with the Energy Efficiency Standards for residential buildings; and (3) the product meets or exceeds the appropriate requirements for manufactured devices (from Part 6), where applicable.

4
 Item # (if applicable) Signature, Date
 Signature, Date
 Signature, Date
 Signature, Date
 Installing Subcontractor (Co. Name) OR General Contractor (Co. Name) OR Owner
 Installing Subcontractor (Co. Name) OR General Contractor (Co. Name) OR Owner
 Installing Subcontractor (Co. Name) OR General Contractor (Co. Name) OR Owner

COPIES TO: Building Department
 Building Owner at Occupancy

Compliance Forms

July 1, 2005



Walldesign Incorporated

DRYWALL * INSULATION * PAINT * PLASTER * CONTRACTOR

3321
Marrisey Lane
 Address Sacramento
 City Sacramento
 County Griffin Industries MapleWood 38
Builder Project Lot

Description of Insulation :	Thickness	R-Value
Exterior Walls		
Insulation Type: <u>Batts</u>	<u>3 1/2</u>	<u>13</u>
Flat Ceilings		
Insulation Type: <u>Batts</u>	<u>10</u>	<u>30</u>
Cathedral Ceilings		
Insulation Type: <u>Batts</u>		<u>0</u>
Garage Ceilings		
Insulation Type: <u>Batts</u>	<u>6 1/4</u>	<u>19</u>
Interior Walls		
Insulation Type: <u>Batts</u>		<u>0</u>
Interm Ceilings		
Insulation Type: <u>Batts</u>	<u>3 1/2</u>	<u>11</u>
Garage Walls		
Insulation Type: <u>Batts</u>		<u>0</u>
Slab on Grade		
Insulation Type: <u>Batts</u>		<u>0</u>
Blown Ceilings		
Insulation Type: <u>Cellulose</u>		<u>0</u>
Blown Ceilings		
Insulation Type: <u>Insulsafe</u>		<u>0</u>

Declaration

I hereby certify that the above insulation was installed in the building at the above location in conformance with the current Energy Efficient Standards for residential buildings (Title 24, Part 6, California Code of Regulations) as indicated on the Certificate of Compliance, where applicable.

449739
 License Number Walldesign, Inc.
 Signature Insulation
 Date Subcontractor

3321 MARISSA

INSTALLATION CERTIFICATE

CF-6R

Site Address Mansfield Plan 4 lot 61 Permit Number _____

An installation certificate is required to be posted at the building site or made available for all appropriate inspections. (The information provided on this form is required; however, use of this form to provide the information is optional.) After completion of final inspection, a copy must be provided to the building department (upon request) and the building owner at occupancy, per Section 10-103(b).

HVAC SYSTEMS:

Heating Equipment

Equip. Type (pkg. heat pump)	CBC Certified Mfr Name and Model Number	# of Identical Systems	Efficiency (AFUE, etc.) (to CF-1R value)	Duct Location (attic, etc.)	Duct or Piping R-value	Heating Load (Btu/hr)	Heating Capacity (Btu/hr)
------------------------------	---	------------------------	--	-----------------------------	------------------------	-----------------------	---------------------------

Furnace	Lennox #GNW60C110X	1	80%	Attic	R6	110,000	
---------	--------------------	---	-----	-------	----	---------	--

Cooling Equipment

Equip. Type (pkg. heat pump)	CBC Certified Compressor Unit Mfr Name and Model Number	# of Identical Systems	Efficiency (SEER, etc.) (to CF-1R value)	Duct Location (attic, etc.)	Duct R-value	Cooling Load (Btu/hr)	Cooling Capacity (Btu/hr)
------------------------------	---	------------------------	--	-----------------------------	--------------	-----------------------	---------------------------

Condenser	Lennox #13ACC060	1	13.3 SEER	Attic	R6	60,000	
-----------	------------------	---	-----------	-------	----	--------	--

1. > reads greater than or equal to.
I, the undersigned, verify that equipment listed above is: 1) the actual equipment installed, 2) equivalent to or more efficient than that specified in the certificate of compliance (Form CF-1R) submitted for compliance with the Energy Efficiency Standards for residential buildings; and 3) equipment that meets or exceeds the appropriate requirements for manufactured devices (from the Appliance Efficiency Regulations or Part 6), where applicable.
Blue Mountains Air, Inc

Signature, Date _____
Installing Subcontractor (Co. Name) _____
OR General Contractor (Co. Name) OR Owner _____

WATER HEATING SYSTEMS:

Heater Type	CBC Certified Mfr Name & Model Number	Distribution Type (Std. Point-of-Use)	Water-Calculation Control Type	# of Identical Systems	Rated Input (kW or Btu/hr)	Tank Volume (gallons)	Efficiency (EF, RE)	Standby Loss (%)	Internal Insulation (R-value)
-------------	---------------------------------------	---------------------------------------	--------------------------------	------------------------	----------------------------	-----------------------	---------------------	------------------	-------------------------------

gas Pan

50 700

2. For small gas storage (rated input of less than or equal to 75,000 Btu/hr), electric resistance and heat pump water heaters, list Energy Factor.
For large gas storage water heaters (rated input of greater than 75,000 Btu/hr), list Recovery Efficiency, Standby Loss and Rated Input.
For instantaneous gas water heaters, list Recovery Efficiency and Rated Input.
3. R-12 external insulation is mandatory for storage water heaters with an energy factor of less than 0.58.

Faucets & Shower Heads:

All faucets and showerheads installed are certified to the Commission, pursuant to Title 24, Part 6, Section 111.
I, the undersigned, verify that equipment listed above my signature is: 1) the actual equipment installed; 2) equivalent to or more efficient than that specified in the certificate of compliance (Form CF-1R) submitted for compliance with the Energy Efficiency Standards for residential buildings; and 3) equipment that meets or exceeds the appropriate requirements for manufactured devices (from the Appliance Efficiency Regulations or Part 6), where applicable.

Signature, Date _____
Installing Subcontractor (Co. Name) OR
General Contractor (Co. Name) OR Owner _____

**COPY TO: Building Department
HERS Provider (if applicable)
Building Owner at Occupancy**