

RESIDENTIAL SUBDIVISION BUILDING PERMIT APPLICATION **0008145**

Project Address: 1918 DeLafield
 Lot Number: 33

Assessor Parcel # 225-132-33
 Subdivision NORTHPOINTE Park Vil. 11

OWNER INFORMATION:

Legal Property Owner: JTS Communities, Inc. Phone# 487-3434
 Owner Address: 3434 Marconi AVE City Sacto State CA Zip 95821

CONTRACTOR INFORMATION:

Contractor: JTS Communities Lic. # 767107 Phone # 487-3434 Fax 487-3815

PROJECT INFORMATION:

Land Use Zone R1A Occupancy Group R3 Construction Type VN Fed Code 1A
 No. of Stories: 1 No. of Rooms: 3 Street Width: _____
 1st Floor Area 4,777 2nd Floor Area _____ Basement _____ Roof Material _____

AREA IN SQUARE FOOT OF:

Dwelling/Living 1777
 Garage/Storage 400
 Decks/Balconies _____
 Carports _____

SCOPE OF WORK: New SFD Plan: 104-NN

FOR OFFICE USE ONLY

- Information Above Complete
 - Violation Files Checked
 - Standard Setbacks
 - County Sewer
 - AR Flood Waiver Required
 - Flood Elevation Certificate Required
 - Water Development Infill Area
 - Planning Approval
 - Design Review Approval
 - Special Fee Districts Apply:
- ~THE FOLLOWING MUST BE PROVIDED IN ORDER TO SUBMIT FOR PERMIT~**
- 2 COMPLETE PLOT PLANS, LEGIBLE & DRAWN TO SCALE
 - 11 X 17 COPY OF FLOOR PLAN WITH FOLLOWING INFORMATION
 - a) Assessor's Parcel Number
 - b) New Floor Area
 - c) Owners Name
 - d) Project Address

Date: _____ Received by: (staff) _____ Permit # _____

OMEGA PRODUCTS CORP.

DIAMOND WALL INSULATING STUCCO SYSTEM

Job Address

1918 Delafield Wy
Lot 33

ICBO Evaluation Service, Inc.

Report No. ER-4004

Date of Job Completion 10-5-00

Plastering Contractor

Name: J+L PROPERTIES STUCCO DIVISION

Address: 3434 MARCONI AVE.

Telephone No. (916) 487 3434

Approved contractor number as issued by the coating manufacturer 660088

This is to certify that the exterior coating system on the building exterior at the above address has been installed in accordance with the evaluation report specified above and the manufacturer's instructions.

Ray Ricketts
Signature of authorized representative
of plastering contractor

Date

This installation card must be presented to the building inspector after completion of work and before final inspection.

J-L
INSULATION
CERTIFICATE

WES PAC INSULATION, INC.

THIS IS TO CERTIFY THAT INSULATION HAS BEEN INSTALLED IN CONFORMANCE WITH
CURRENT ENERGY REGULATIONS, CALIFORNIA ADMINISTRATIVE CODE, TITLE 24, STATE OF
CALIFORNIA, IN THE BUILDING LOCATED AT:

LOT # 33 TRACT # 1
STREET 1918 Delefield CITY _____

EXTERIOR WALLS:

MANUFACTURER _____ THICKNESS/TYPE _____ R-VALUE 13

CEILINGS:

BATTS:
MANUFACTURER _____ THICKNESS/TYPE _____ R-VALUE 30

BLOWN IN:
MANUFACTURER _____ THICKNESS/TYPE _____ R-VALUE 30

SQUARE FOOTAGE COVERED 1200 NUMBER OF BAGS USED 114

FLOORS:

MANUFACTURER _____ THICKNESS/TYPE _____ R-VALUE _____

SLAB ON GRADE:

MANUFACTURER _____ THICKNESS/TYPE _____ R-VALUE _____

WIDTH OF INSULATION _____ INCHES

FOUNDATION WALLS:

MANUFACTURER _____ THICKNESS/TYPE _____ R-VALUE _____

GENERAL CONTRACTOR _____
CALIFORNIA CONTRACTORS LICENSE # _____ DATE _____

SIGNATURE TITLE

INSULATION CONTRACTOR WES PAC INSULATION, INC.
CALIFORNIA CONTRACTORS LICENSE # #487478 DATE 1/11

SIGNATURE TITLE

- 1 STORY HOUSE
- 2 - CAR GARAGE
- 5115 SQ. FT. OF LOT

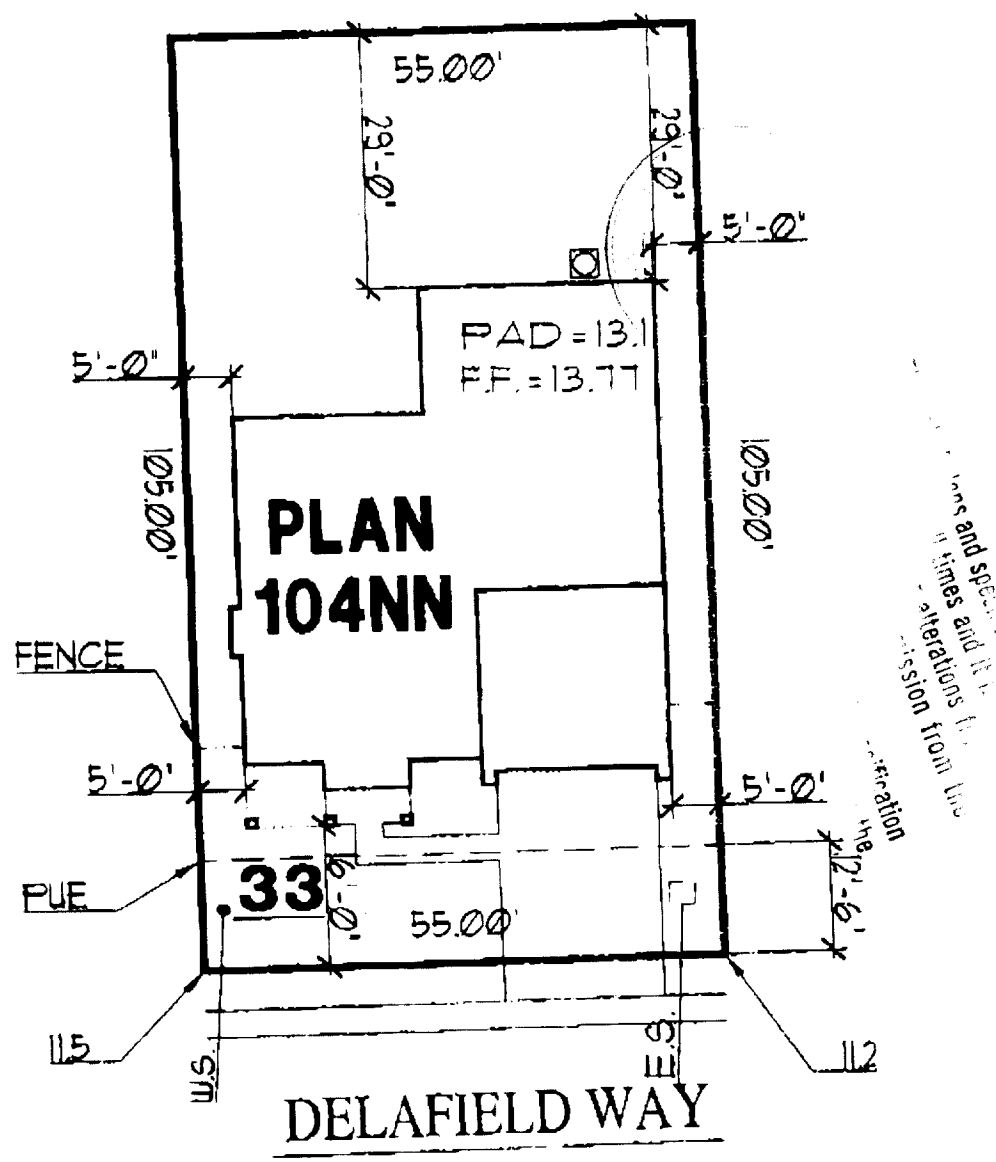

This plan and specifications are subject to change without notice and alterations from the original plan without the written permission from the architect.

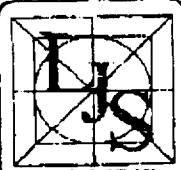

Larry J. Schelling
 Architect
 J & L Properties
 Architectural Division

REVISIONS

ORIGINAL
 JUL 7 2000
 Cindy Moore

JTS Communities
 Suite A
 3434 Marconi Avenue
 Sacramento, CA 95831 (916) 487-3434

PROPOSED SITE PLAN
 NORTHPOINTE PARK
 VILLAGE II - NATOMAS PARK

VERANDA

Date JUL 1, 2000
 Drawn By CD
 Job
 Scale 1"=20'-0"
 Sheet

of Sheets

APPROVED FOR RELEASE	DATE	APPROVED BY BUYER	DATE
----------------------	------	-------------------	------

NP-LOT-33-104 7-7-00 10:47 PM