



DEPARTMENT OF
PLANNING AND DEVELOPMENT

CITY OF SACRAMENTO
CALIFORNIA

**Special Permit Modification
(P91-296)**

1231 I STREET
ROOM 200
SACRAMENTO, CA
95814-2998

BUILDING INSPECTIONS
916-449-5716

PLANNING
916-449-5604

Application: Modification of a Special Permit to replace an existing detached sign and add a new sign for Sutter Memorial Hospital.

Location: 5275 F Street

Applicant: Ron Baxter, Ellis & Ellis Signs

Background Information:

On February 9, 1984, the Planning Commission granted a Special Permit to allow on-site directional and informational signage for Sutter Memorial Hospital on 20+ developed acres in the Hospital (H) zone (P83-438). A sign program was approved which included a total of 44 signs installed either as attached or detached signs on the subject site (see Exhibit A).

Project Evaluation:

On October 24, 1991, the applicant applied for a Planning Director's Special Permit Modification to replace one of the existing signs and add a new sign for Sutter Memorial Hospital. The two proposed sign locations are indicated on the attached Exhibit A. The applicant is requesting to replace the existing monument sign due to the existing Diagnostic Treatment Center being converted to the Sutter Cancer Center. Currently, the monument sign reads "Diagnostic Treatment Center". Because the existing Diagnostic Treatment Center is being replaced with the Sutter Cancer Center, the applicant wishes to replace the existing sign with a new identification sign identifying the new Sutter Cancer Center facility. The existing 21.6 square foot sign will be replaced with a 20.4 square foot non-illuminated interior monument sign identifying the Sutter Cancer Center (6'6" wide by 3'6" high). The applicant is also proposing to locate a new detached monument sign at the designated location specified in the attached Exhibit A. The purpose of the new sign is to identify the new location of the Sutter Cancer Center from F Street. The applicant indicated that hospital patients are complaining about not being able to locate the building. Currently, those patients traveling on F

Street are unaware of the center's new location due to no visible identification signs fronting on F Street. Additionally, the address for the new Sutter Cancer Center is given as F Street. The applicant is, therefore, requesting that a new sign, with the same identification as the replacement sign, be provided on the hospital site. The additional sign will be located approximately 80 feet back of the sidewalk facing F Street and will be the same dimensions and type as the replacement sign.

The sign materials and color will consist of sheet metal with a silk rose color to match Sutter Hospital. The proposed signage will be compatible with the existing hospital building and the existing hospital signage. The applicant has informed staff that both signs will be lit by ground spot lights.

Staff is not opposed to the applicant's request. The replacement sign and the new sign will be appropriate since the Sutter Cancer Center will occupy the building and patients traveling on F Street will be able to locate the use. Lastly, the new sign will be located far enough back to not obstruct vehicles vision.

Staff Recommendations:

Staff finds the proposed signage to be a minor modification and a less than significant impact to the surrounding area. Staff, therefore, recommends approval subject to the following conditions.

Condition:

1. The signage proposed shall comply with the submitted site plan attached as Exhibit B.
2. Any new signage or replacement of existing signs shall be reviewed and approved by the Planning Director prior to issuance of sign permits.

Report Prepared By:

Bridgette Williams
Bridgette Williams, Associate Planner

11-25-91
Date

RECOMMENDATION APPROVED:

Gary Stonehouse
Gary Stonehouse, Planning Director

12-5-91
Date

P91-296

LEGEND

PLANT SET AND QTY
PLANT QUANTITY

PALA WAY

COLOMA WAY

STREET

50th STREET

001614

51st STREET

52nd STREET

51st STREET

STREET

STREET

LAUNDRY

NEW GENERATOR BLDG.

NEW MECHANICAL ROOM

SHOP

SUTTER MEMORIAL HOSPITAL

NEW ADDITION

NEW ADDITION

RADIATION ONCOLOGY

DIAGNOSTIC TREATMENT CENTER

New Sutter Cancer Center Location

SHADE DATA

NEW PAVED SURFACE	297,000 S.F.
EXISTING SHADE (NEW ORDNANCE)	
EXISTING TREES (EAST SIDE)	1,944 S.F.
NEW TREES	
24 7'0" S.F. x 14'0" x 13'0"	288 S.F.
24 6'0" S.F. x 12'0" x 12'0"	288 S.F.
24 5'0" S.F. x 10'0" x 10'0"	240 S.F.
24 4'0" S.F. x 8'0" x 8'0"	192 S.F.
24 3'0" S.F. x 6'0" x 6'0"	144 S.F.
24 2'0" S.F. x 4'0" x 4'0"	96 S.F.
24 1'0" S.F. x 2'0" x 2'0"	48 S.F.
TOTAL	1,944 S.F.
PERCENT SHADE	1,944 S.F. x 100,000 S.F. = 0.001944%

Existing sign to be Replaced

New sign location

LOCATE SIGNS OUTSIDE OF CLEAR VISION ZONE

SCALE 1" = 80'



Dreyfus & Associates
Architectural Group

HDR HENNINGSEN,
DURHAM & RICHARDSON
OMAHA, NEBRASKA

MBRO
CONSTRUCTION MANAGER
ST. LOUIS, MISSOURI

4/4/85
5/4/85

Exhibit A

7-6-88 REVISED LANDSCAPE PLAN

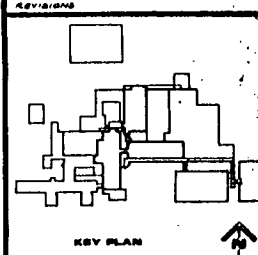

SUTTER COMMUNITY HOSPITAL
SACRAMENTO, CALIFORNIA
PHASE 1
SITE WORK
SUTTER MEMORIAL

SIGN LOCATIONS

AD-51-00000
MAY 1985

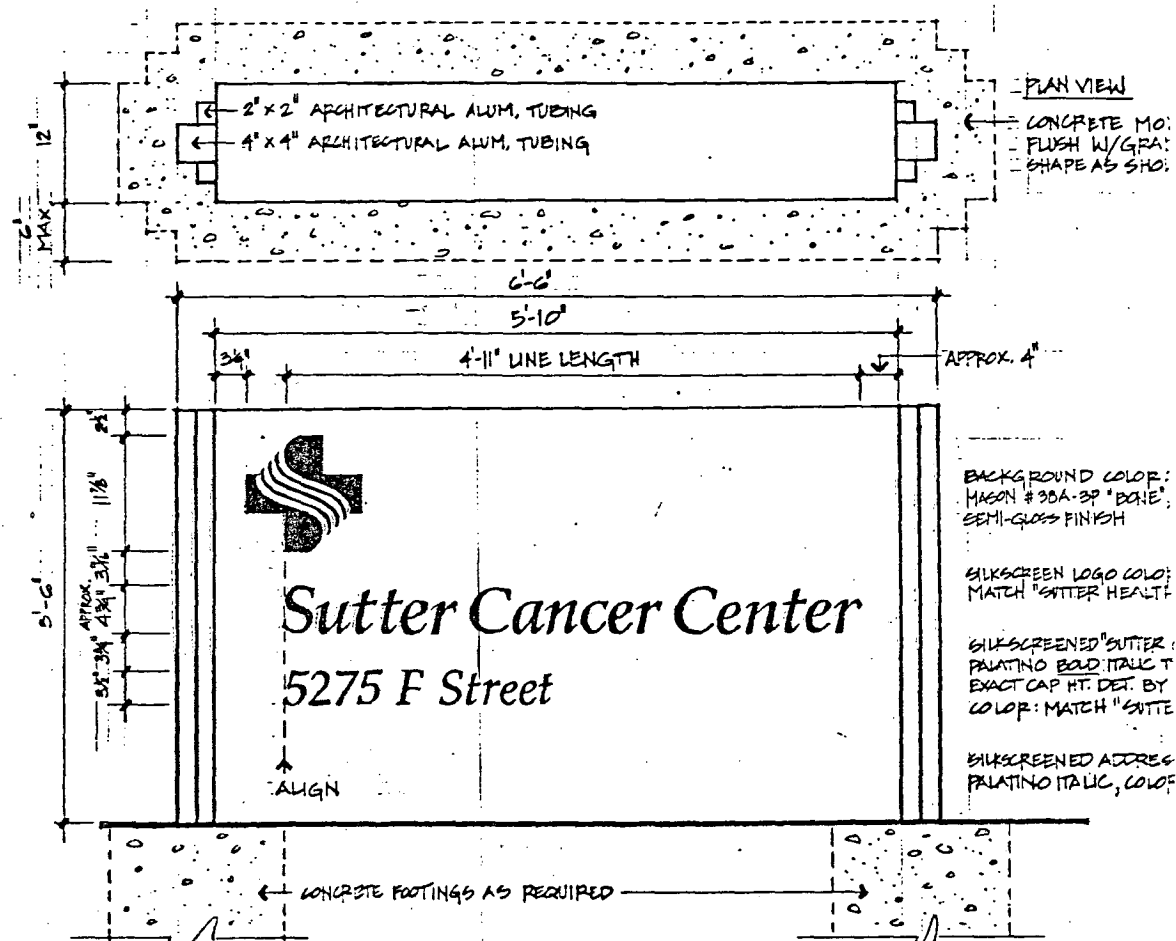

NOTES:

1. SIGNS TO BE TIGHTLY ATTACHED SO ENTIRE SIGN APPEARS AS "ONE PIECE."
2. DESIGN DEPT. TO APPROVE ALL COLOR SAMPLES & GRAPHIC PATTERNS.
3. ALL PAINT SEMI-GLOSS FINISH

QUANTITY: 2 SIGNS, D/F