

AMENDED

ORDINANCE NO. 925043

ADOPTED BY THE SACRAMENTO CITY COUNCIL

ON DATE OF AUG 25 1992

ORDINANCE AMENDING THE DISTRICTS ESTABLISHED BY THE COMPREHENSIVE ZONING ORDINANCE NO. 2550, FOURTH SERIES, AS AMENDED, BY REMOVING PROPERTY LOCATED AT THE NORTHEAST CORNER OF SOUTH LAND PARK DRIVE AND GREENHAVEN DRIVE FOR 0.98± ACRES OF R-1(EA-3) AND PLACING THE SAME IN THE OB(EA-3) ZONE(S)

(P91-340) (APN:031-0070-063)

BE IT ENACTED BY THE COUNCIL OF THE CITY OF SACRAMENTO:

SECTION 1

The territory described in the attached exhibit(s) which is in the R-1(EA-3) zone(s) established by Ordinance No. 2550, Fourth Series, as amended, is hereby removed from said zone and placed in the OB(EA-3A) zone.

This action rezoning the property described in the attached exhibit(s) is adopted subject to the following conditions and stipulations:

- a. A material consideration in the decision of the Planning Commission to recommend and the City Council to approve rezoning of the applicant's property is the development plans and representations submitted by the applicant in support of this request. It is believed said plans and representations are an integral part of such proposal and should continue to be the development program for the property.

FOR CITY CLERK USE ONLY

ORDINANCE NO.: 925043

DATE ADOPTED: AUG 25 1992 4

b. If an application for a building permit or other construction permit is filed for said parcel which is not in conformity with the proposed development plans and representations submitted by the applicant and as approved by the Planning Commission on June 25, 1992, on file in the office of the Planning Division, or any provision or modification thereof as subsequently reviewed and approved by the Planning Commission, no such permit shall be issued, and the Planning Division shall report the matter to the Planning Commission as provided for in Ordinance No. 3201, Fourth Series.

* c. The applicant shall participate in the cost of traffic signals located at Windbridge Drive and Greenhaven Drive and at South Land Park and Greenhaven Drive. Applicant's responsibility for these signals is \$4,870 based on a total cost of \$300,000, distributed on an average basis over the project areas. Fees for the traffic signals shall be paid prior to approval of the Building Permit. Payment of fees shall satisfy the applicant's responsibility for these signals on this parcel only.

SECTION 2

The City Clerk of the City of Sacramento is hereby directed to amend the maps which are a part of said Ordinance No. 2550, Fourth Series, to conform to the provisions of this Ordinance.

SECTION 3

Rezoning of the property described in the attached exhibit(s) by the adoption of this Ordinance shall be deemed to be in compliance with the procedures for the rezoning of property prescribed in Ordinance No. 2550, Fourth Series, as said procedures have been affected by recent court decisions.

PASSED FOR PUBLICATION: AUG 1 8 1992

PASSED: AUG 2 5 1992

EFFECTIVE: SEP 2 4 1992

MAYOR

ATTEST:



CITY CLERK

FOR CITY CLERK USE ONLY

* amended cc8-25-92

P91-340

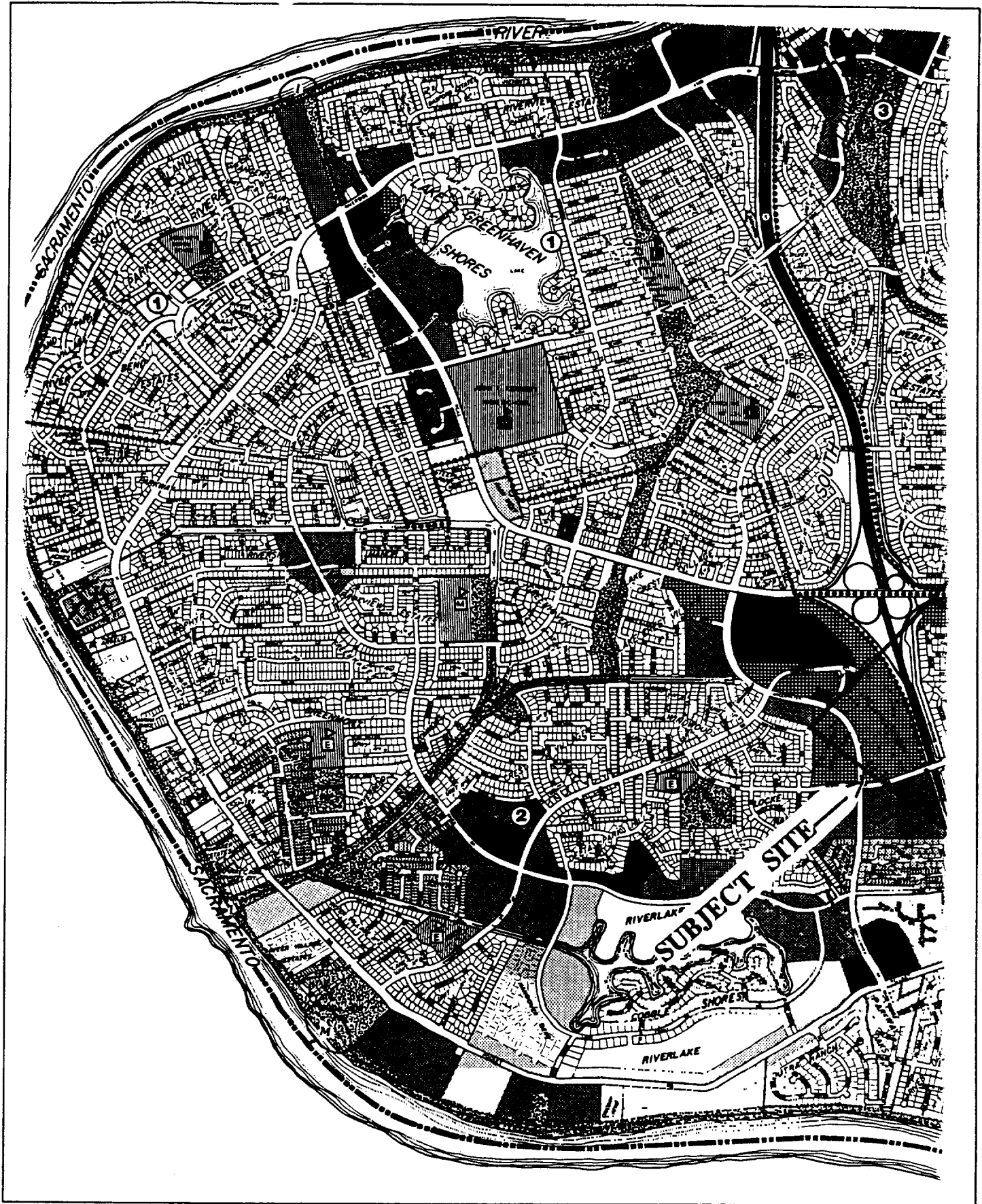
ORDINANCE NO.: 92-043
DATE ADOPTED: AUG 2 5 1992



VICINITY MAP

P91-340

June 25, 1992
AUG 25 1992 ORDINANCE No.

92-049 No. 9

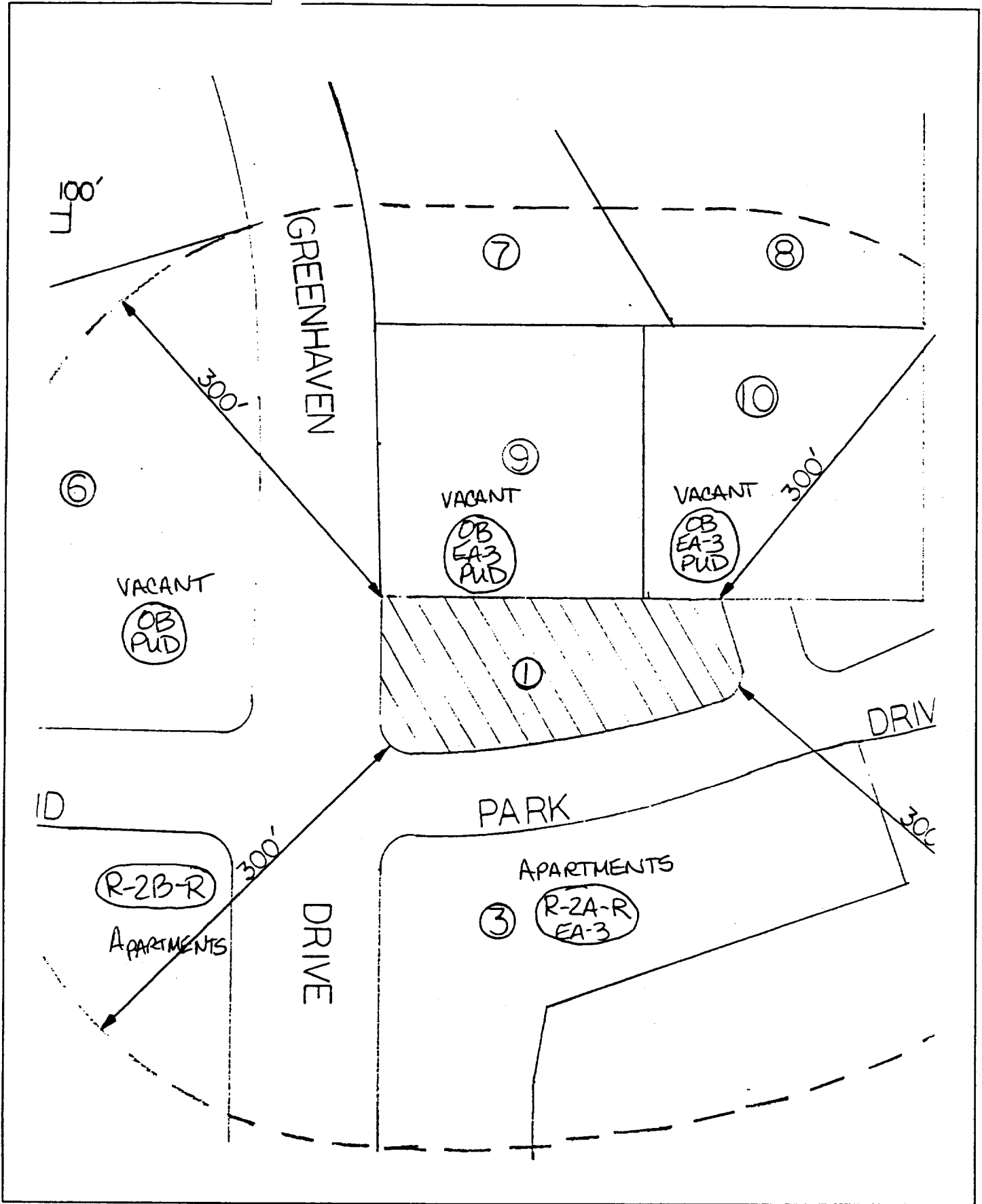

LAND USE & ZONING MAP

P91-340

June 25, 1992
AUG 25 1992

ORDINANCE No. 92-043

Item No. 9

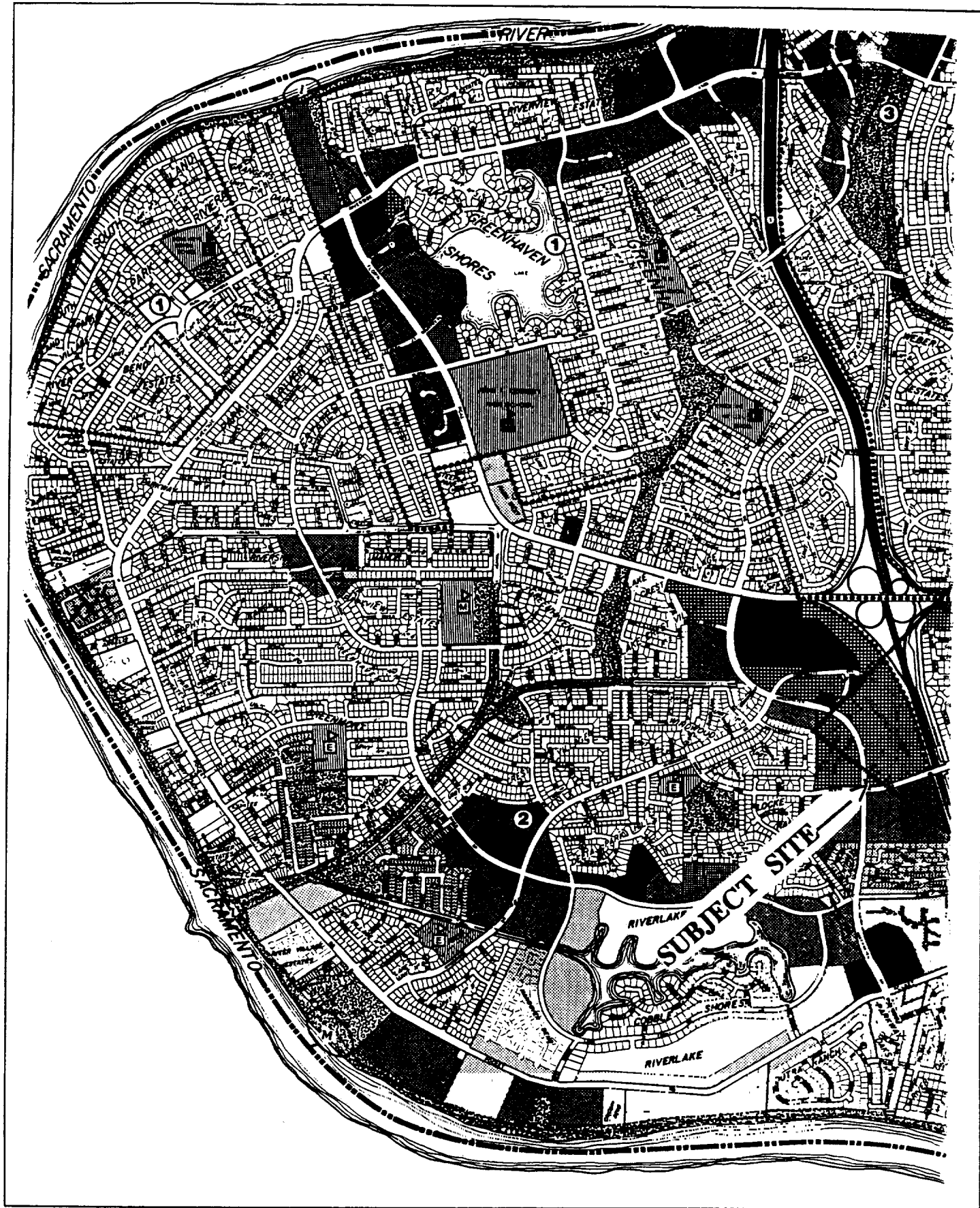

VICINITY MAP

P91-340

June 25, 1992
AUG 25 1992 ORDINANCE NO. 92-043

Item No. 9

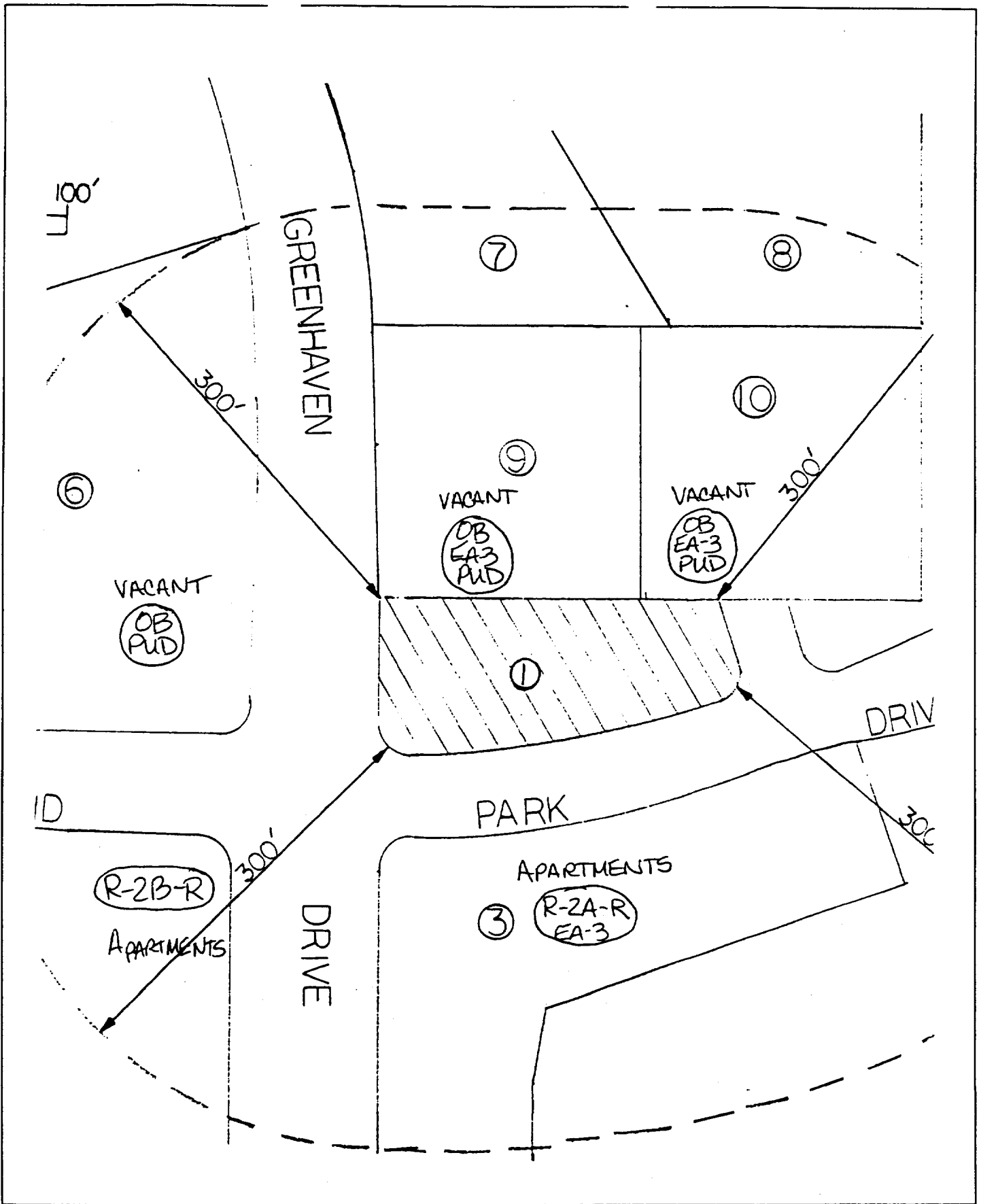

LAND USE & ZONING MAP

