



CITY OF SACRAMENTO

19

October 30, 1984

DEPARTMENT OF PUBLIC WORKS

Engineering and Transportation Division
915 I Street - Room 300
Sacramento, California 95814

CITY MANAGER'S OFFICE
RECEIVED
OCT 23 1984

Telephones (916)
Civil Engineering 449-5281
Electrical Engineering 449-5287
Architecture 449-5144
Construction 449-5281
Real Estate 449-5626
Traffic Engineering 449-5307
Parking 449-5354
Street Maintenance 449-5236

City Council
Sacramento, California

Honorable Members In Session:

SUBJECT: Revocable Encroachment Permit - 32nd Street Between Montgomery Way
and 6th Avenue

SUMMARY

Anheuser-Busch has applied for a revocable encroachment permit to close 32nd Street between Montgomery Way and 6th Avenue to provide a construction staging area and a construction worker parking area. The company plans to remodel, enlarge and modernize the adjacent Rainbo Bakery.

BACKGROUND

It is typically the position of the Public Works Department that public right of way shall not be reserved for the purpose of providing private parking for employees associated with adjacent construction activity. Those workers must secure separate parking on private property or compete with other users of the road for the available on street parking supply. The proposed remodeling of the Rainbo Bakery does present a special case, however.

Thirty Second Street between Montgomery Way and 6th Avenue is bordered on the west by State Route 99 and on the east by the Rainbo Bakery site. Closing this street will not result in the creation of dead-end streets or streets with no outlet and will not significantly impact local traffic circulation. In addition Anheuser-Busch is currently negotiating with Caltrans regarding relinquishment of the State's rights and interests to this street. Upon completion of these negotiations Anheuser-Busch will request the City to abandon the subject street.

FINANCIAL DATA

None.

APPROVED
BY THE CITY COUNCIL

OCT 30 1984

OFFICE OF THE
CITY CLERK

The first part of the document discusses the importance of maintaining accurate records of all transactions. It emphasizes that every entry should be supported by a valid receipt or invoice. This not only helps in tracking expenses but also ensures compliance with tax regulations.

In the second section, the author outlines the various methods used for data collection and analysis. These include surveys, interviews, and focus groups. Each method has its own strengths and limitations, and the choice depends on the specific research objectives.

The third section delves into the statistical analysis of the collected data. It covers topics such as descriptive statistics, inferential statistics, and regression analysis. The goal is to identify patterns and trends in the data that can inform decision-making.

Finally, the document concludes with a summary of the findings and recommendations. It highlights the key insights gained from the research and provides practical advice for implementing these findings in a business context.

RECOMMENDATION

It is recommended that the attached Resolution be approved granting a revocable encroachment permit valid through December 31, 1985 to Anheuser-Busch in the area and for the purposes outlined above.

Respectfully submitted,

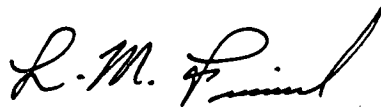

L. M. Frink
Deputy Director of Public Works

APPROVED

Melvin H. Johnson
Director of Public Works

Recommendation Approved

Walter J. Slips, City Manager

LMF:JHB:bb

October 30, 1984
DISTRICT NO. 5

SECRET

CONFIDENTIAL - SECURITY INFORMATION

CONFIDENTIAL - SECURITY INFORMATION

CONFIDENTIAL - SECURITY INFORMATION

CONFIDENTIAL - SECURITY INFORMATION

CONFIDENTIAL - SECURITY INFORMATION

CONFIDENTIAL - SECURITY INFORMATION

CONFIDENTIAL - SECURITY INFORMATION

CONFIDENTIAL - SECURITY INFORMATION

RESOLUTION No. 84-924

Adopted by The Sacramento City Council on date of

OCTOBER 30, 1984

RESOLUTION GRANTING REVOCABLE ENCROACHMENT TO:

ANHEUSER-BUSCH COMPANIES

BE IT RESOLVED BY THE COUNCIL OF THE CITY OF SACRAMENTO:

That a revocable encroachment permit for the purpose of construction staging and parking

is hereby granted to Anheuser-Busch Companies, whose address is as follows: One Busch Place, St. Louis, MO. 63118.

The encroachment area is described as follows:

An area adjacent to permittee's property. An area 50' x 300' on 32nd Street between Montgomery Way and 6th Avenue. (APN 13-244-1, 24)

This permit is granted subject to the "General Provisions - Revocable Encroachment Permit", which were adopted by the City Council in Resolution No. 81-845 dated November 17, 1981, and the hereinafter specified special conditions, if any. This permit shall be effective only after the applicant files with the Risk Management & Insurance Division of the City of Sacramento, the insurance certificates required by the General Provisions.

APPROVED
BY THE CITY COUNCIL

OCT 30 1984

OFFICE OF THE
CITY CLERK

SPECIAL CONDITIONS

1. Access to public utilities shall be maintained throughout duration of permit including but not limited to water, street lighting, SMUD, telephone, PG & E.
2. 32nd Street shall be returned to its existing condition to the satisfaction of the Street Maintenance Division upon completion of project.
3. Physical protection and maintenance access shall be provided around all fixtures such as (but not limited to) street lights, pull box covers, fire hydrants, trees, etc.
4. Signs shall be placed at each end stating this Resolution No. and date as the authority for closure of the street.
5. This permit shall be valid through December 31, 1985.

MAYOR

ATTEST:

CITY CLERK

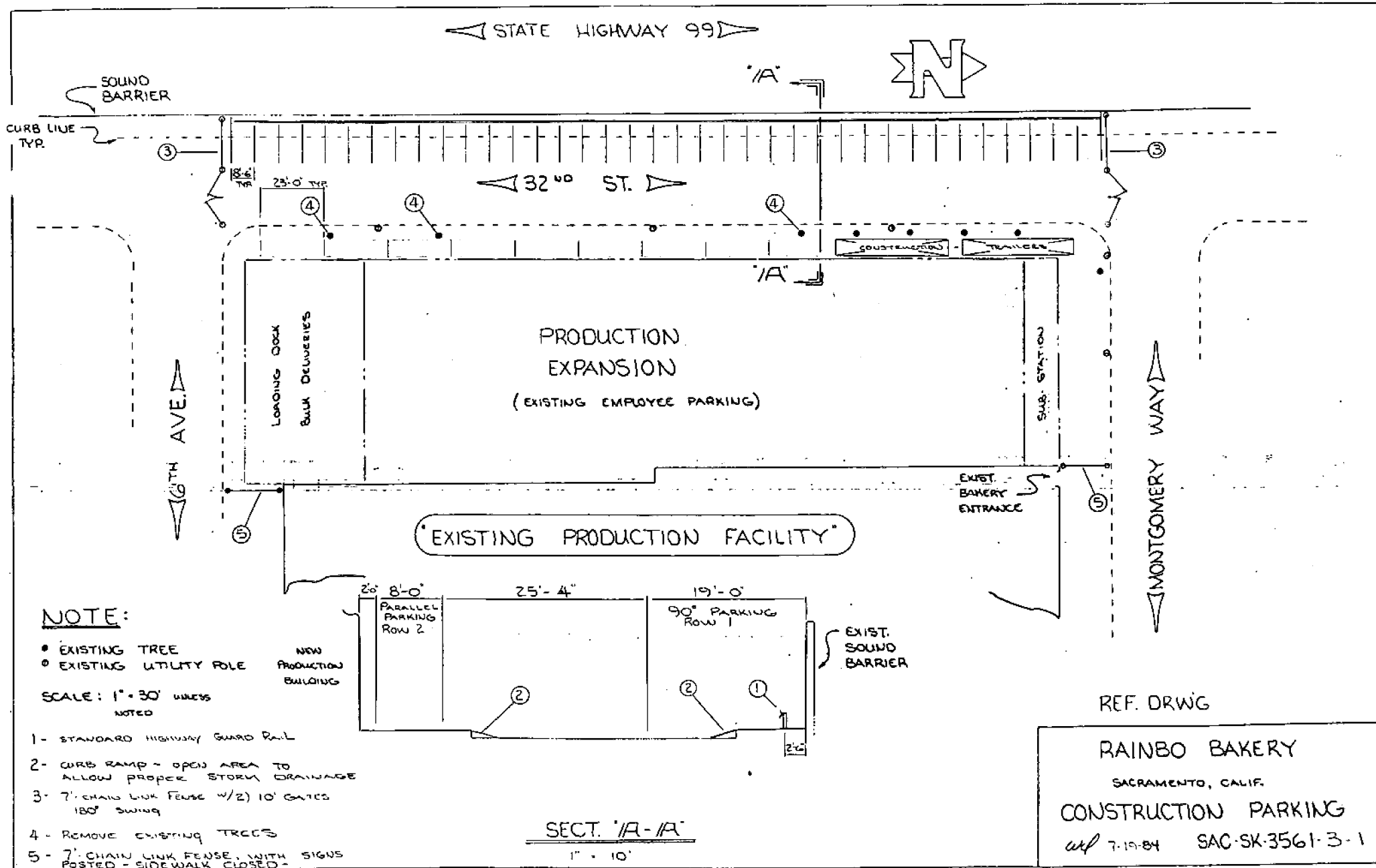

NOTE:

- EXISTING TREE
- EXISTING UTILITY POLE

SCALE: 1" = 30' UNLESS NOTED

- 1 - STANDARD HIGHWAY GUARD RAIL
- 2 - CURB RAMP - OPEN AREA TO ALLOW PROPER STORM DRAINAGE
- 3 - 7' CHAIN LINK FENCE W/ 2) 10' GATES 180° SWING
- 4 - REMOVE EXISTING TREES
- 5 - 7' CHAIN LINK FENCE WITH SIGNS POSTED - SIDEWALK CLOSED

SECT. 'A-A'
1" = 10'

REF. DRWG
RAINBO BAKERY
 SACRAMENTO, CALIF.
CONSTRUCTION PARKING
 w/ 7-19-84 SAC-SK-3561-3-1

6

November 2, 1984

Anheuser-Busch Companies
One Busch Place
St. Louis, MO 63118

Dear Gentlemen:

On October 30, 1984, the Sacramento City Council adopted Resolution No. 84-924 granting the following Revocable Encroachment Permit in accordance with "General Provisions - Revocable Encroachment Permit," adopted by Council Resolution 81-845 as amended.

The permit is for the purpose of constructing staging and parking located at an area adjacent to permittee's property which is 50' x 300' on 32nd Street between Montgomery Way and 6th Avenue. (APN 13-244-1, 24)

This permit is now in full force and effect.

Enclosed, for your records, is a copy of the resolution granting the permit, and Council Resolution 81-845, as amended.

Sincerely,

Lorraine Magana
City Clerk

LM/dbp/19

Enclosures: **RESOLUTION 81-845 and RESOLUTION 84-924**.

cc: Risk Management

[Faint, illegible text covering the majority of the page, possibly bleed-through from the reverse side.]

ATTEST: _____

Notary Public