

**CITY OF SACRAMENTO**

**1231 I Street, Sacramento, CA 95814**

**Permit No: 0319301**

**Insp Area: 4**

**Thos Bros: 277 C6**

**Site Address: 1560 WATERWHEEL DR SAC**

**Parcel No: 274-0350-008**

**Sub-Type: COM**

**Housing (Y/N): N**

**CONTRACTOR**

DONE RIGHT CONSTRUCTION  
160 SOUTHWOOD CT  
VACAVILLE CA 95687

**OWNER**

DELTA POINT WEST  
10960 WILSHIRE BL #1800  
LOS ANGELES CA 90024

**ARCHITECT**

**Nature of Work: REPAIR DRY ROT TO DECK, UPPER FLOOR. BUILDING 2374, APT 6.**

**CONSTRUCTION LENDING AGENCY :** I hereby affirm under penalty of perjury that there is a construction lending agency for the performance of the work for which this permit is issued (Sec. 3097, Civ. C).

Lender's Name \_\_\_\_\_ Lender's Address \_\_\_\_\_

**LICENSED CONTRACTORS DECLARATION:** I hereby affirm under penalty of perjury that I am licensed under provisions of Chapter 9 (commencing with section 7000) of Division 3 of the Business and Professions Code and my license is in full force and effect.

License Class \_\_\_\_\_ License Number 793723 Date \_\_\_\_\_ Contractor Signature \_\_\_\_\_

**OWNER-BUILDER DECLARATION:** I hereby affirm under penalty of perjury that I am exempt from the contractors License Law for the following reason (Sec. 7031.5, Business and Professions Code; any city or county which requires a permit to construct, alter, improve, demolish, or repair any structure, prior to its issuance, also requires the applicant for such permit to file a signed statement that he or she is licensed pursuant to the provisions of the Contractors License Law (Chapter 9 (commencing with Section 7000) of Division 8 of the Business and Professions Code) or that he or she is exempt therefrom and the basis for the alleged exemption. Any violation of Section 7031.5 by any applicant for a permit subjects the applicant to a civil penalty of not more than five hundred dollars (\$500.00);

\_\_\_\_ I, as a owner of the property, or my employees with wages as their sole compensation, will do the work, and the structure is not intended or offered for sale (Sec. 7044, Business and Professional Code: The Contractors License Law does not apply to an owner of property who builds or improves thereon, and who does such work himself or herself or through his/her own employees, provided that such improvements are not intended or offered for sale. If, however, the building or improvement is sold within one year of completion, the owner-builder will have the burden of proving that he/she did not build or improve for the purpose of sale.)

\_\_\_\_ I, as owner of the property, am exclusively contracting with licensed contractors to construct the project (Sec. 7044, Business and Professions Code: The Contractors License Law does not apply to an owner of property who builds or improves thereon, and who contracts for projects with a contractor(s) licensed pursuant to the Contractors License Law).

\_\_\_\_ I am exempt under Sec. \_\_\_\_\_ B & PC for this reason: \_\_\_\_\_

Date \_\_\_\_\_ Owner Signature \_\_\_\_\_

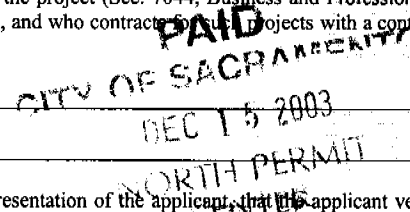

**IN ISSUING THIS BUILDING PERMIT,** the applicant represents, and the city relies on the representation of the applicant, that the applicant verified all measurements and locations shown on the application or accompanying drawings and that the improvement to be constructed does not violate any law or private agreement relating to permissible or prohibited locations for such improvements. This building permit does not authorize any illegal location of any improvement or the violation of any private agreement relating to location of improvements.

I certify that I have read this application and state that all information is correct. I agree to comply with all city and county ordinances and state laws relating to building construction and hereby authorize representative(s) of this city to enter upon the abovementioned property for inspection purposes.

Date \_\_\_\_\_ Applicant/Agent Signature \_\_\_\_\_

**WORKER'S COMPENSATION DECLARATION:** I hereby affirm under penalty of perjury one of the following declarations:

\_\_\_\_ I have and will maintain a certificate of consent to self-insure for workers' compensation as provided for by Section 3700 of the Labor Code, for the performance of work for which the permit is issued.

\_\_\_\_ I have and will maintain workers' compensation insurance, as required by Section 3700 of the Labor Code, for the performance of the work for which this permit is issued. My workers' compensation insurance carrier and policy number are:

Carrier EXEMPT Policy Number \_\_\_\_\_ Exp Date \_\_\_\_\_

\_\_\_\_ (This section need not be completed if the permit is for \$100 or less) I certify that in the performance of the work for which this permit is issued, I shall not employ any person in any manner so as to become subject to the workers' compensation laws of California and agree that if I should become subject to the workers' compensation provisions of Section 3700 of the Labor Code, I shall forthwith comply with those provisions.

Date \_\_\_\_\_ Applicant Signature \_\_\_\_\_

**WARNING: FAILURE TO SECURE WORKER'S COMPENSATION COVERAGE IS UNLAWFUL AND SHALL SUBJECT AN EMPLOYER TO CRIMINAL PENALTIES AND CIVIL FINES UP TO ONE HUNDRED THOUSAND DOLLARS (\$100,000) IN ADDITION TO THE COST OF COMPENSATION, DAMAGES AS PROVIDED FOR IN SECTION 3706 OF THE LABOR CODE, INTEREST AND ATTORNEY'S FEE.**

**THIS PERMIT SHALL EXPIRE BY LIMITATION IF WORK IS NOT COMMENCED WITHIN 180 DAYS.**

# APPLICATION FOR COMMERCIAL BUILDING PERMIT

**CITY OF SACRAMENTO**  
**PLANNING & BUILDING DEPARTMENT**  
 1231 I Street, Suite 200 or 2101 Arena Bl., 200  
 Sacramento, CA 95814 Sacramento, CA 95834  
 (916) 264-5656, 1-866 EZ PERMIT or www.cityofsacramento.org

<b>ACTIVITY #</b>	<b>Insp. Area</b>
-------------------	-------------------

*Applicant to complete all areas down to valuation*

**ADDRESS** 1560 Waterwheel Dr. S4L Suite Building 374  
**PARCEL #** B106 2324 Apt 10 Apt 6

<p style="text-align: center;"><b>CONTACT</b></p> <p>Name <u>Garry Bland</u>                  Street Address <u>160 Southwood Ct</u>                  City/State/Zip <u>Vacaville CA</u>                  Phone <u>707 365-3432</u> FAX <u>707 446 8840</u>                  E-mail: _____</p>	<p style="text-align: center;"><b>LICENSED CONTRACTOR</b> Lic No. # <u>793723</u></p> <p>Name <u>Done Right Construction</u>                  Address <u>160 Southwood Ct</u>                  City/State/Zip <u>Vacaville CA</u>                  Phone <u>707-365-3432</u> FAX <u>707 446 8840</u>                  E-mail: _____</p>
<p style="text-align: center;"><b>ARCHITECT/ENGINEER</b></p> <p>Name _____                  Address _____                  City/State/Zip _____                  Phone _____ FAX _____                  E-mail: _____</p>	<p style="text-align: center;"><b>OWNER</b></p> <p>Name <u>Ben Roberts</u>                  Address <u>10960 Wilshire Bl 1800</u>                  City/State/Zip <u>Los Angeles CA</u>                  Phone <u>(916) 838-2929</u> FAX _____                  E-mail: _____</p>

→ Will permittee have any employees on the jobsite?  No  Yes → **INSURANCE CO:** \_\_\_\_\_  
 → **WORKER'S COMPENSATION POLICY #** \_\_\_\_\_ **EXPIRATION DATE:** \_\_\_\_\_

**NATURE OF WORK IN DETAIL:** Repair Dry rot to Deck, upper Floor.  
Building 374 Apt 6

**OCCUPANT/TENANT:** \_\_\_\_\_ **VALUATION: \$** 1000.00

<b>FLOOD STATUS</b>						<b>S.C.A.T.</b>					
JOB DESCRIPTION BLDG <input type="checkbox"/> SHELL <input type="checkbox"/> APT <input type="checkbox"/> TI ( ) <input type="checkbox"/> REM ( ) <input type="checkbox"/> SW <input type="checkbox"/> FIRE <input type="checkbox"/> ADD <input type="checkbox"/> OTHER <input type="checkbox"/>						ELEC		SITE		FIRE	
<b>INSPECTION DISCIPLINES</b>						MECH		PLUMB		FIRE	
# Stories	1 <sup>st</sup> flr Area.	Total Area	Use Zone	Occp Group	Const type	Fire Req. Y/N		Fed Code		Vio. File	
						SPR	ALARM			PW	UTIL
B	L	P	M	E	F	S		D			

**COMMENTS:**  
 \_\_\_\_\_  
 \_\_\_\_\_  
 \_\_\_\_\_

**REGIONAL SANITATION FEES?**  Yes  No **HEALTH DEPARTMENT?**  Yes  No  
**WATER FLOW TEST FOR NEW BUILDINGS OR ADDITIONS?**  Yes  No

Building ~~1512 Apt~~ 2374-Apt 6  
 1560 Waterwheel Dr Sacramento CA.

Delta Pointe

Front

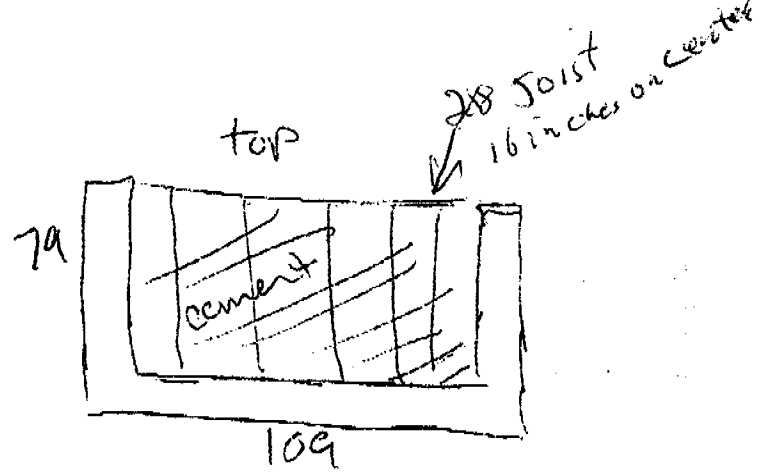
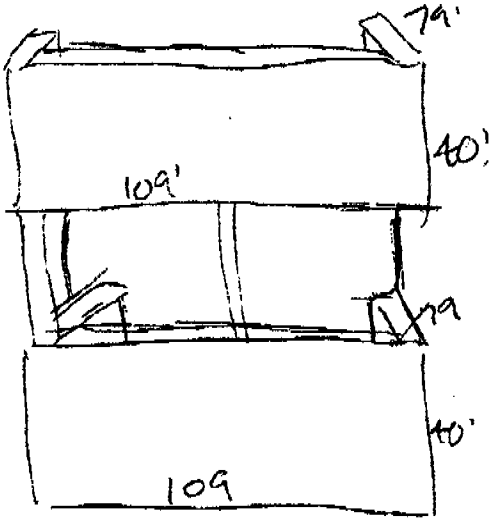

side

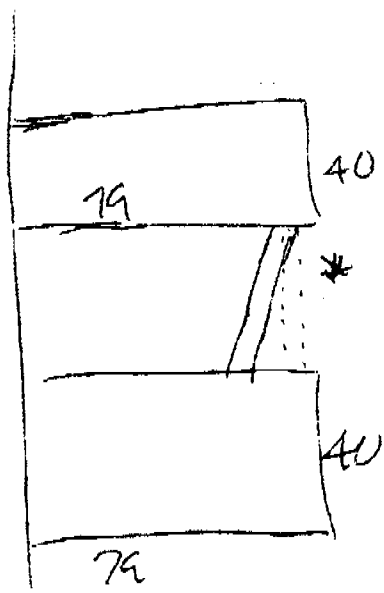

**ISSUED**  
 City of Sacramento  
 DEC 15 2003  
 NORTH PERMIT  
 CENTER

top deck needs to be repaired due to dry rot on main support beam. the structure is a hazard to both upstairs & downstairs occupants. The main support is bent, due to dry rot.\*

Materials

- 4x10 Beam Support
- 2x8 Joist 16 inches on center
- 2x8 Joist Hangers
- 2x8 cap rail
- Water proofing
- Flashing
- Cement Deck

**CITY COPY**



This set of plans and specifications must be kept on the job at all times and it is not to be made any changes or alterations from the same without written permission from the Building Inspection Division. The approval of this plan and specification SHALL NOT be held to permit or approve the violation of any City Ordinance or State Law.

JH 12/15/03

#0319301

This set of plans and specifications must be kept on the job at all times and it is unlawful to make any changes or alterations from the original without written permission from the City of Sacramento, Department of Planning and Inspection Division.

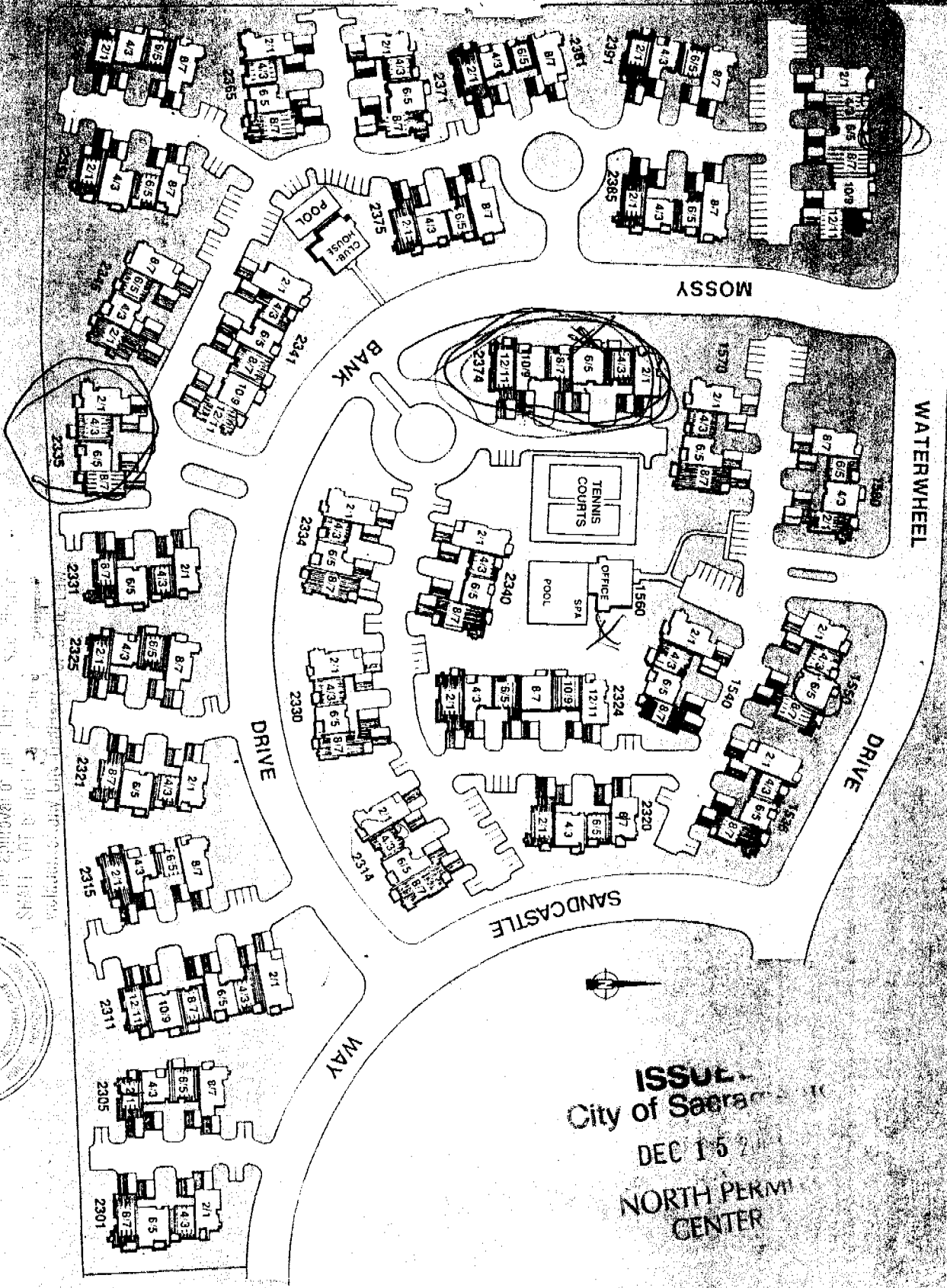
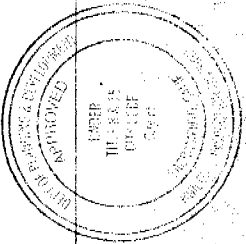

**ISSUED**  
 City of Sacramento  
 DEC 15 2011  
 NORTH PERIMETER  
 CENTER