

**CITY OF SACRAMENTO**  
1231 I Street, Sacramento, CA 95814

**Permit No: 9911915**  
**Insp Area: 4**

**Site Address: 3636 SAINTSBURY DR SAC**  
Parcel No: LOT 7 GATEWAY WEST 4

Sub-Type: NSFR  
Housing (Y/N): N

CONTRACTOR OWNER  
BLAZER HOMES  
3000 DOUGLAS BL #150  
ROSEVILLE CA 95661

ARCHITECT  
BLOODGOOD SHARP BUSTER  
2356 GOLD MEADOW WY #201  
GOLD RIVER CA 95670

**Nature of Work: NEW HOME, MP1232, 5 ROOMS**

**CONSTRUCTION LENDING AGENCY:** I hereby affirm under penalty of perjury that there is a construction lending agency for the performance of the work for which this permit is issued (Sec. 3097, Civ. C).

Lender's Name \_\_\_\_\_ Lender's Address \_\_\_\_\_

**LICENSED CONTRACTORS DECLARATION:** I hereby affirm under penalty of perjury that I am licensed under provisions of Chapter 9 (commencing with section 7000) of Division 3 of the Business and Professions Code and my license is in full force and effect.

License Class B License Number 724191 Date 10-20-99 Contractor Signature [Signature]

**OWNER-BUILDER DECLARATION:** I hereby affirm under penalty of perjury that I am exempt from the contractors License Law for the following reason (Sec. 7031.5, Business and Professions Code; any city or county which requires a permit to construct, alter, improve, demolish, or repair any structure, prior to its issuance, also requires the applicant for such permit to file a signed statement that he or she is licensed pursuant to the provisions of the Contractors License Law (Chapter 9 (commencing with Section 7000) of Division 8 of the Business and Professions Code) or that he or she is exempt therefrom and the basis for the alleged exemption. Any violation of Section 7031.5 by any applicant for a permit subjects the applicant to a civil penalty of no more than five hundred dollars (\$500.00).

I, as a owner of the property, or my employees with wages as their sole compensation, will do the work, and the structure is not intended or offered for sale (Sec. 7044, Business and Professional Code: The Contractors License Law does not apply to an owner of property who builds or improves thereon, and who does such work himself or herself or through his/her own employees, provided that such improvements are not intended or offered for sale. If, however, the building or improvement is sold within one year of completion, the owner-builder will have the burden of proving that he/she did not build or improve for the purpose of sale.)

I, as owner of the property, am exclusively contracting with licensed contractors to construct the project (Sec. 7044, Business and Professions Code: The Contractors License Law does not apply to an owner of property who builds or improves thereon, and who contracts for such projects with a contractor(s) licensed pursuant to the Contractors License Law).

I am exempt under Sec. \_\_\_\_\_ B & PC for this reason: \_\_\_\_\_

Date \_\_\_\_\_ Owner Signature \_\_\_\_\_

**IN ISSUING THIS BUILDING PERMIT,** the applicant represents, and the city relies on the representation of the applicant, that the applicant verified all measurements and locations shown on the application or accompanying drawings and that the improvement to be constructed does not violate any law or private agreement relating to permissible or prohibited locations for such improvements. This building permit does not authorize any illegal location of any improvement or the violation of any private agreement relating to location of improvements.

I certify that I have read this application and state that all information is correct. I agree to comply with all city and county ordinances and state laws relating to building construction and hereby authorize representative(s) of this city to enter upon the abovementioned property for inspection purposes.

Date 10-20-99 Applicant/Agent Signature [Signature]

**WORKER'S COMPENSATION DECLARATION:** I hereby affirm under penalty of perjury one of the following declarations:  
I have and will maintain a certificate of consent to self-insure for workers' compensation as provided for by Section 3700 of the Labor Code, for the performance of work for which the permit is issued.

I have and will maintain workers' compensation insurance, as required by Section 3700 of the Labor Code, for the performance of the work for which this permit is issued. My workers' compensation insurance carrier and policy number are:

Carrier Liberty Mutual Policy Number \_\_\_\_\_ Exp Date \_\_\_\_\_

(This section need not be completed if the permit is for \$100 or less) I certify that in the performance of the work for which this permit is issued, I shall not employ any person in any manner so as to become subject to the workers' compensation laws of California and agree that if I should become subject to the workers' compensation provisions of Section 3700 of the Labor Code, I shall forthwith comply with those provisions.

Date 10-20-99 Applicant Signature [Signature]

**WARNING - FAILURE TO SECURE WORKER'S COMPENSATION COVERAGE IS UNLAWFUL AND SHALL SUBJECT AN EMPLOYER TO CRIMINAL PENALTIES AND CIVIL FINES UP TO ONE HUNDRED THOUSAND DOLLARS (\$100,000) IN ADDITION TO THE COST OF COMPENSATION, DAMAGES AS PROVIDED FOR IN SECTION 3706 OF THE LABOR CODE, INTEREST AND ATTORNEY'S FEE.**

**THIS PERMIT SHALL EXPIRE BY LIMITATION IF WORK IS NOT COMMENCED WITHIN 180 DAYS.**

RESIDENTIAL BUILDING PERMIT APPLICATION

Lot 7

- New Construction
- Addition
- Remodels
- Other

Project Address: 3636 Sainbury Drive Assessor Parcel # \_\_\_\_\_

OWNER INFORMATION:

Legal Property Owner: BEAZER Homes Phone # (916) 773-3888  
 Owner Address: 3009 Douglas Blvd. #150, City ROSEVILLE, State Ca. Zip 95661

CONTRACTOR INFORMATION:

Contractor: BEAZER Homes Lic. # 724191 Phone # 773-3888 Fax# 773-0425

PROJECT INFORMATION:

Land Use Zone R14 Occupancy Group R3 Construction Type VN Fed Code 14

No. of stories: 1 No. of rooms: 5 Street width: \_\_\_\_\_

1<sup>st</sup> Floor Area 1232 2<sup>nd</sup> Floor Area N/A Basement N/A Roof Material \_\_\_\_\_

AREA IN SQUARE FOOT OF:	EXISTING	NEW
Dwelling/Living	_____	<u>1232</u>
Garage/Storage	_____	<u>426</u>
Decks/Balconies	_____	<u>106</u>
Carports	_____	_____

SCOPE OF WORK: \_\_\_\_\_

FOR OFFICE USE ONLY:

- Information above complete
- Violation files checked
- Standard setbacks
- County Sewer
- AR Flood Waiver required
- Flood Elevation Certificate Required
- Water Development Infill Area
- Planning Approval
- Design Review Approval
- Special Fee Districts Apply : \_\_\_\_\_

NEW STRUCTURES & ADDITIONS

THE FOLLOWING MUST BE PROVIDED IN ORDER TO SUBMIT FOR PLAN REVIEW

- 2 COMPLETE PLANS, LEGIBLE & DRAWN TO SCALE
  - 3 SETS IF PROJECT IS IN A DESIGN REVIEW AREA
  - Title 24 Energy Compliance documentation
  - Grading and Erosion Control Questionnaire
  - 11" x 17" copy of floor plan for County Assessor
  - Plan Review Fees
- Plans to include: site plan, floor plan, elevations, roof/ceiling plan, foundation and structural framing details, and structural calculations for non-conforming structures.*

Date: \_\_\_\_\_

Received by: (staff) \_\_\_\_\_

ACTIVITY/PERMIT # \_\_\_\_\_

№ 18823



INSTALLATION CARD

Job Address:

10230 RefLECTIONS  
LOT 7 SACTO

Stucco System Trade Name: KWIK KOTE

Name Stucco Manufacturer: KWIK KOTE CORP.

ICBO Evaluation Service, Inc.

Report No. 3607

Date of Job Completion

Stucco Contractor Kenyon Construction

Name John W. Kenyon, III

Address P.O. Box 2077

North Highlands, CA 95660

Telephone Number (916) 349-8191

Approved Contractor Number as issued by the Stucco Manufacturer: 1

This is to certify that the stucco system on the building exterior at the above address had been installed in accordance with the evaluation report specified above and the manufacturer's instructions.

Signature of authorized representative of stucco contractor

Date

10/10/85

# CERTIFICATION OF INSULATION

<p><b>ADDRESS OR TRACT</b></p> <p style="font-size: 2em; font-family: cursive;">BEZER</p> <p style="text-align: right;">LOT # 7</p> <p style="font-size: 1.5em; font-family: cursive;">GATEWAY WEST</p>	<p style="text-align: center;"><b>SACRAMENTO INSULATION CONTRACTORS</b></p> <p><input checked="" type="checkbox"/> P.O. BOX 854, WEST SACRAMENTO, CA 95691 LIC. #202026</p> <p><input type="checkbox"/> 1309 MELODY ROAD, MARYSVILLE, CA 95901 LIC. #202026</p> <p><input type="checkbox"/> P.O. BOX 9651, FRESNO, CA 93793-9651 LIC. #202026</p> <p><input type="checkbox"/> P.O. BOX 1631, RENO, NV 89505 LIC. #10675</p> <p><input type="checkbox"/> 3326 A PONDEROSA WAY, LAS VEGAS, NV 89118 LIC. #10675</p> <p>DATE INSULATION COMPLETED</p>
---	--

WALLS	CEILINGS	FLOORS
( SQUARE FEET)	( SQUARE FEET)	( SQUARE FEET)
TYPE OF INSULATION	TYPE OF INSULATION	TYPE OF INSULATION
MATERIAL <b>FIBERGLASS</b>	MATERIAL <b>FIBERGLASS</b>	MATERIAL <b>FIBERGLASS</b>
FORM <b>BATTS</b>	FORM <b>BATTS &amp; BLOW</b>	FORM <b>BATTS</b>
MANUFACTURER'S PRODUCT I.D.	MANUFACTURER'S PRODUCT I.D.	MANUFACTURER'S PRODUCT I.D.
<b>OCF</b>	<b>OCF</b>	<b>OCF</b>
	BAGS	
13	30 30	9" 12"
MATERIAL <b>FIBERGLASS</b>	FORM <b>BATTS</b>	R VALUE
		<b>OCF</b>
<b>AIR INFILTRATION SEALANT</b>		
MATERIAL <b>FOAM</b>		MANUFACTURER <b>W R GRACE</b>
<b>THIS IS TO CERTIFY THAT INSULATION AND/OR SEALANT HAS BEEN INSTALLED IN CONFORMANCE WITH APPLICABLE CODES, MATERIAL STANDARDS AND REGULATIONS.</b>		
SIGNATURE - INSULATION CONTRACTOR 	TITLE <b>MANAGER</b>	DATE <b>11-29-99</b>
SIGNATURE - GENERAL CONTRACTOR	TITLE	DATE
REMARKS		

THIS PLAN IS PREPARED TO SHOW THE DIMENSIONAL RELATIONSHIP FROM BUILDING FOUNDATION TO PROPERTY LINE, DESIGN DRAINAGE CONTROL ELEVATIONS, AND DIRECTION OF DRAINAGE FLOW TO CONFORM WITH LOCAL ORDINANCES FOR THE PURPOSE OF BUILDING PERMIT ISSUANCE. INFORMATION SHOWN IS APPROXIMATE EXCEPT FOR THOSE SETBACKS WHICH ARE MINIMUMS REQUIRED BY ORDINANCE. THIS PLOT DOES NOT REFLECT AS BUILT CONDITIONS WHICH WILL LIKELY VARY FROM THIS PLAN.

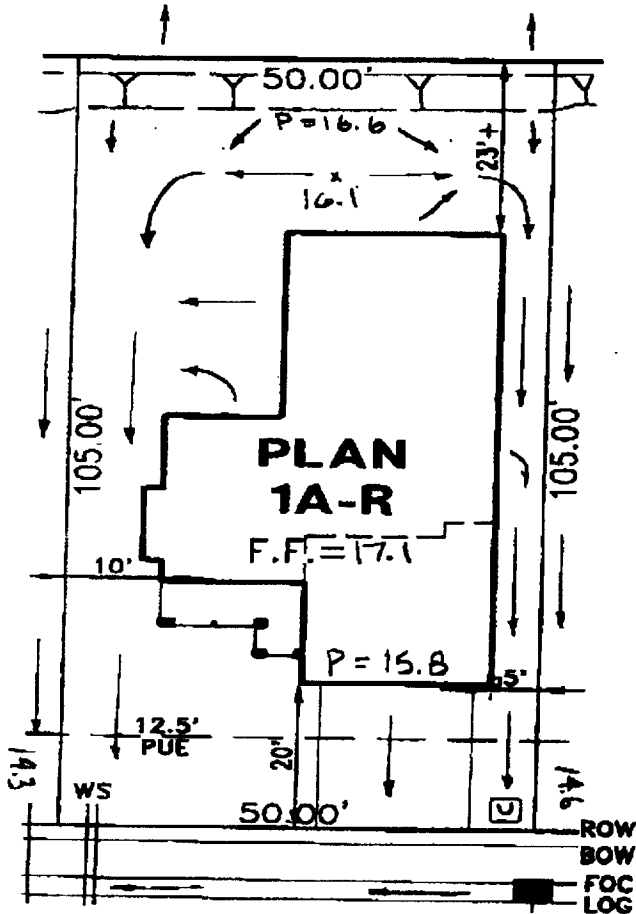
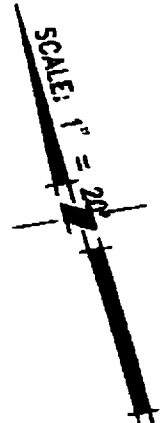

ROUTING/APPROVAL		
	✓	INITIALS
President		
Project Development		
Construction	✓	<i>[Signature]</i>
Marketing	✓	<i>[Signature]</i>
...		
...		

### SAINTSBURY DRIVE

**U** = UTILITY SERVICE BOX

LOT COVERAGE = 32%

**PLOT PLAN**  
**LOT 7**  
 GATEWAY WEST-VILLAGE NO.4  
 FOR  
 BEAZER HOMES  
 SACRAMENTO CALIFORNIA

**WOOD-RODGER INC.**

DATE: SEPT. 1999	DRAWN: D.P.B.	CHECKED: [Signature]	PROJECT NO: BEZ-026
---------------------	------------------	-------------------------	------------------------