



1

DEPARTMENT OF
PUBLIC WORKS

TRANSPORTATION DIVISION

CITY OF SACRAMENTO
CALIFORNIA

October 25, 1990

1023 J STREET
SUITE 200
SACRAMENTO, CA
95814-2819

916-449-5307
FAX 916-448-8450

Transportation and Community Development Committee
Sacramento, California

Honorable Members In Session:

SUBJECT: ELDER CREEK ROAD IMPROVEMENTS - ADOPTION OF A RESOLUTION TO PROHIBIT PARKING ON BOTH THE NORTH AND SOUTH SIDES OF ELDER CREEK ROAD BETWEEN STOCKTON BOULEVARD AND THE 65TH STREET EXPRESSWAY

SUMMARY

This report recommends that the Transportation and Community Development Committee approve this report and refer it to the full City Council. Further, it is recommended that City Council adopt a resolution to eliminate parking, pursuant to City Code Section 25.101, on both the north and south sides of Elder Creek Road between Stockton Boulevard and the 65th Street Expressway, (Exhibit A), in order to accommodate revised roadway striping.

No additional City funds are requested.

BACKGROUND INFORMATION

Elder Creek Road is currently an arterial roadway which consists of two through travel lanes in the eastbound and westbound directions while accommodating parking on both the north and south sides of the street. Elder Creek Road is being restriped to include the installation of the two-way left turn lane from Stockton Boulevard to the 65th Street Expressway. This will require the removal of on-street parking on both the north and south sides of the roadway. The parking prohibition will also accommodate the installation of bike lanes which are identified on the proposed City Bikeway Master Plan.

A parking study was carried out to determine how many cars currently use on-street parking along Elder Creek Road. Morning, mid-day, and evening studies were conducted. The study found that an average of four cars per day are parking on the segment between Stockton Boulevard and the 65th Street Expressway, all on the south side. A total of 15 homes front Elder Creek Road, eight homes fronting the north side and seven fronting the south, all of which have off-street parking accommodations. The removal of parking in this area will not have significant impacts on the residents and commercial entities.

All residents and businesses were notified prior to this Transportation and Community Development Committee meeting.

1

FINANCIAL DATA

There are sufficient funds in the FY 1990-91 operating budget of the Transportation Division to cover the cost of installing "No Parking" signs and the restriping of the roadway.

No additional City funds are requested.

MBE/WBE

There is no MBE/WBE impact related to this matter.

POLICY CONSIDERATIONS

The recommended resolution to eliminate parking is required by City Code Section 25.101, which prohibits stopping, standing or parking vehicles on streets described in resolutions adopted by City Council.

RECOMMENDATION

It is recommended that the Transportation and Community Development Committee approve this report and refer it to the full City Council. Further, it is recommended that City Council adopt the resolution to prohibit parking on the north and south sides of Elder Creek Road between Stockton Boulevard and the 65th Street Expressway.

RECOMMENDATION APPROVED:

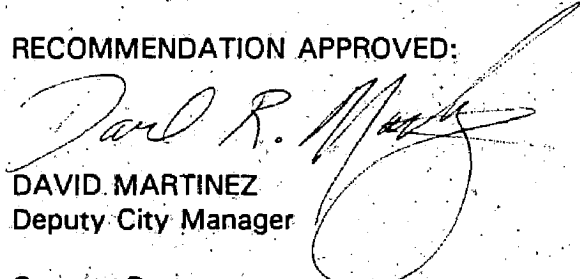
DAVID MARTINEZ
Deputy City Manager

Contact Person

JERRY WAY, Traffic Investigator
Transportation Division, 449-5307

JW:lm
CA3-27.L
10.1090

Attachment

Respectfully submitted,

MARILYN KUNTEMEYER
Supervising Engineer

APPROVED:

MELVIN H. JOHNSON
Director of Public Works

October 25, 1990
District No. 6

RESOLUTION NO.

ADOPTED BY THE SACRAMENTO CITY COUNCIL

ON DATE OF _____

RESOLUTION TO PROHIBIT PARKING AT ALL TIMES ON THE
NORTH AND SOUTH SIDES OF ELDER CREEK ROAD BETWEEN
STOCKTON BOULEVARD AND THE 65TH STREET EXPRESSWAY

NOW, THEREFORE, BE IT RESOLVED BY THE COUNCIL OF THE CITY OF SACRAMENTO:

Pursuant to Section 25.101 of the Sacramento City Code, when signs are erected giving notice thereof, no person shall, at any time, park a vehicle upon the following described street or parts of the street:

The north and south sides of Elder Creek Road between Stockton Boulevard and the 65th Street Expressway.

MAYOR

ATTEST:

CITY CLERK

CA3-27.L

FOR CITY CLERK USE ONLY

RESOLUTION NO.: _____

DATE ADOPTED: _____

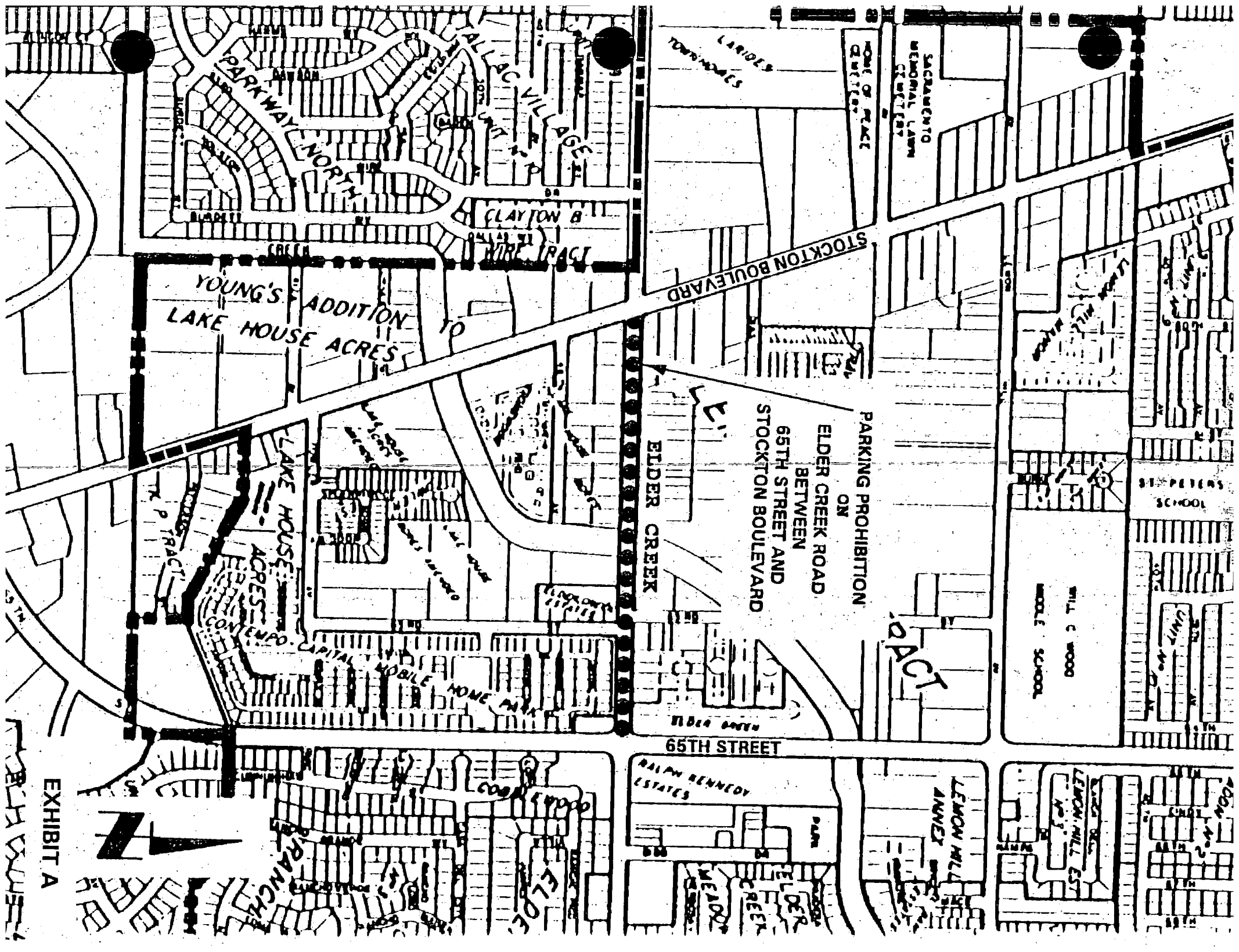

YOUNG'S ADDITION TO LAKE HOUSE ACRES

CLAYTON B WIRE TRACT

STOCKTON BOULEVARD

ELDER CREEK

PARKING PROHIBITION ON ELDER CREEK ROAD BETWEEN 65TH STREET AND STOCKTON BOULEVARD

65TH STREET

LAKE HOUSE ACRES

CAPITAL MOBILE HOME PARK

TRACT

MILL C WOOD MOBILE SCHOOL

ST. PETERS SCHOOL

RALPH BENEDY ESTATES

LEMON HILL ANNEX

LEMON HILL EST

EXHIBIT A