

CITY OF SACRAMENTO
1231 I Street, Sacramento, CA 95814

Permit No: 0309924
Insp Area: 4
Thos Bros:
Sub-Type: NSFR
Housing (Y/N):

Site Address: 2180 PEAKVIEW AV SAC
Parcel No: 201-0700-036
N

NORTH NATOMAS ESTATES 1-1 LOT 36

CONTRACTOR
MOURIER JOHN CONSTRUCTION INC.
1830 VERNON ST
SUITE 9 95687

OWNER

ARCHITECT

Nature of Work: NSFR MP2587 10 RMS 2 STORY

CONSTRUCTION LENDING AGENCY : I hereby affirm under penalty of perjury that there is a construction lending agency for the performance of the work for which this permit is issued (Sec. 3097, Civ. C).

Lender's Name _____ Lender's Address _____

LICENSED CONTRACTORS DECLARATION: I hereby affirm under penalty of perjury that I am licensed under provisions of Chapter 9 (commencing with section 7000) of Division 3 of the Business and Professions Code and my license is in full force and effect.

License Class B License Number 613004 Date 7/9/03 Contractor Signature N. Collins

OWNER-BUILDER DECLARATION: I hereby affirm under penalty of perjury that I am exempt from the contractors License Law for the following reason (Sec. 7031.5, Business and Professions Code; any city or county which requires a permit to construct, alter, improve, demolish, or repair any structure, prior to its issuance, also requires the applicant for such permit to file a signed statement that he or she is licensed pursuant to the provisions of the Contractors License Law (Chapter 9 (commencing with Section 7000) of Division 8 of the Business and Professions Code) or that he or she is exempt therefrom and the basis for the alleged exemption. Any violation of Section 7031.5 by any applicant for a permit subjects the applicant to a civil penalty of not more than five hundred dollars (\$500.00);

____ I, as a owner of the property, or my employees with wages as their sole compensation, will do the work, and the structure is not intended or offered for sale (Sec. 7044, Business and Professional Code: The Contractors License Law does not apply to an owner of property who builds or improves thereon, and who does such work himself or herself or through his/her own employees, provided that such improvements are not intended or offered for sale. If, however, the building or improvement is sold within one year of completion, the owner-builder will have the burden of proving that he/she did not build or improve for the purpose of sale.)

____ I, as owner of the property, am exclusively contracting with licensed contractors to construct the project (Sec. 7044, Business and Professions Code: The Contractors License Law does not apply to an owner of property who builds or improves thereon, and who contracts for such work with a contractor(s) licensed pursuant to the Contractors License Law).

____ I am exempt under Sec. _____ B & PC for this reason: _____
Date _____ Owner Signature _____

PAID
CITY OF SACRAMENTO
JUL 10 2003
NORTH PERMIT CENTER

IN ISSUING THIS BUILDING PERMIT, the applicant represents, and the city relies on the representation of the applicant, that the applicant verified all measurements and locations shown on the application or accompanying drawings and that the improvement to be constructed does not violate any law or private agreement relating to permissible or prohibited locations for such improvements. This building permit does not authorize any illegal location of any improvement or the violation of any private agreement relating to location of improvements.

I certify that I have read this application and state that all information is correct. I agree to comply with all city and county ordinances and state laws relating to building construction and herby authorize representative(s) of this city to enter upon the abovementioned property for inspection purposes.

Date 7/9/03 Applicant/Agent Signature N. Collins

WORKER'S COMPENSATION DECLARATION: I hereby affirm under penalty of perjury one of the following declarations:

____ I have and will maintain a certificate of consent to self-insure for workers' compensation as provided for by Section 3700 of the Labor Code, for the performance of work for which the permit is issued.

I have and will maintain workers' compensation insurance, as required by Section 3700 of the Labor Code, for the performance of the work for which this permit is issued. My workers' compensation insurance carrier and policy number are:

Carrier STATE COMPENSATION INS FUND Policy Number 713000860402 Exp Date 10/01/2003

____ (This section need not be completed if the permit is for \$100 or less) I certify that in the performance of the work for which this permit is issued, I shall not employ any person in any manner so as to become subject to the workers' compensation laws of California and agree that if I should become subject to the workers' compensation provisions of Section 3700 of the Labor Code, I shall forthwith comply with those provisions.

Date 7/9/03 Applicant Signature N. Collins

WARNING: FAILURE TO SECURE WORKER'S COMPENSATION COVERAGE IS UNLAWFUL AND SHALL SUBJECT AN EMPLOYER TO CRIMINAL PENALTIES AND CIVIL FINES UP TO ONE HUNDRED THOUSAND DOLLARS (\$100,000) IN ADDITION TO THE COST OF COMPENSATION, DAMAGES AS PROVIDED FOR IN SECTION 3706 OF THE LABOR CODE, INTEREST AND ATTORNEY'S FEE.

THIS PERMIT SHALL EXPIRE BY LIMITATION IF WORK IS NOT COMMENCED WITHIN 180 DAYS.

RESIDENTIAL SUBDIVISION BUILDING PERMIT APPLICATION

Project Address: 2180 PEAKVIEW AVE Assessor Parcel # 201-0700-036
Lot Number: 36 Subdivision NORTH NATOMAS ESTATES VILLAGE 1
Phase #1

OWNER INFORMATION:

Legal Property Owner: J.M.C. Homes Phone# (916) 969-2842 ext 233
Owner Address: 1830 VERNON ST. #9, City ROSEVILLE, State Ca. Zip 95678

CONTRACTOR INFORMATION:

Contractor: J.M.C. Homes Lic. # 613004 Phone# 969-2842 Fax 782-8903

PROJECT INFORMATION:

0309924

Land Use Zone RIA Occupancy Group R3 Construction Type VN Fed Code 1A

No. of Stories: 2 No. of Rooms: _____ Street Width: _____

1st Floor Area 1177 2nd Floor Area 1410 Basement _____ Roof Material _____

AREA IN SQUARE FOOT OF:

Dwelling/Living 2587

Garage/Storage 402

Decks/Balconies 26

Carports _____

SCOPE OF WORK: NEW S.F.D.

<input type="checkbox"/> Information Above Complete	<input type="checkbox"/> AR Flood Waiver Required	<input type="checkbox"/> Planning Approval
<input type="checkbox"/> Violation Files Checked	<input type="checkbox"/> Flood Elevation Certificate Required	<input type="checkbox"/> Design Review Approval
<input type="checkbox"/> Standard Setbacks	<input type="checkbox"/> Water Development Infill Area	<input type="checkbox"/> Special Fee Districts Apply:
<input type="checkbox"/> County Sewer		

--THE FOLLOWING MUST BE PROVIDED IN ORDER TO SUBMIT FOR PERMIT--

2 COMPLETE PLOT PLANS, LEGIBLE & DRAWN TO SCALE

11 X 17 COPY OF FLOOR PLAN WITH FOLLOWING INFORMATION

a) Assessors Parcel Number	c) Owners Name
b) New Floor Area	d) Project Address

OMEGA PRODUCTS INTERNATIONAL, INC.

DIAMOND WALL INSULATING STUCCO SYSTEM

JOB ADDRESS:

2180 Peakview
Natomas

ICBO Report #4004

Date of Job Completion 11-1-03

PLASTERING CONTRACTOR:

Name: Stucco Works, Inc.

Address: 5900 Warehouse Way Sacramento, CA. 95826

Telephone No: (916) 383-6699

Contractor Number of Diamond Wall System 2175

This is to certify that the exterior coating system on the building exterior at the above address has been installed in accordance with the evaluation report specified above and the manufacturer's instructions.

Date 12-03-03

[Signature]
Signature of authorized representative of
Plastering Contractor

This installation card must be presented to the building inspector after completion of work and before final inspection.

INSULATION CERTIFICATE

THIS IS TO CERTIFY THAT INSULATION HAS BEEN INSTALLED IN CONFORMANCE WITH THE CURRENT ENERGY REGULATIONS, CALIFORNIA ADMINISTRATION CODE, TITLE 24, STATE OF CALIFORNIA, IN THE BUILDING LOCATED AT:

SITE ADDRESS _____ NATOMAS PARK _____ SACRAMENTO _____ CA 2180 Peaview
 NUMBER _____ CITY _____ STATE _____

CEILINGS:

BLOW: MANUFACTURER GREEN FIBER THICKNESS 8.1" RVALUE 30
 SQUARE FEET 1379 #BAGS/LBS PER BAGS 42

BATTS: MANUFACTURER JOHNS MANVILLE THICKNESS 10.25" RVALUE 30
JOHNS MANVILLE _____

EXTERIOR WALLS:

MANUFACTURER JOHNS MANVILLE THICKNESS 3.5" RVALUE 13
JOHNS MANVILLE 6.5" 19

FLOOR INSULATION:

MANUFACTURER JOHNS MANVILLE THICKNESS 6.5" RVALUE 19
JOHNS MANVILLE _____

AIR INFILTRATION: (TITLE 24)

YES XXX NO _____

OTHER: _____

GENERAL CONTRACTOR: JOHN MOURIER CONSTRUCTION LICENSE # _____

BY: _____ TITLE _____ DATE _____

INSULATION CONTRACTOR: WESTERN INSULATION LP LICENSE # 784484

BY: Becky Guthery TITLE AUTH. AGENT DATE 10/1/03
 BECKY GUTHERY



NORTH NATOMAS ESTATES (PHASE 1)

PEAKVIEW AVENUE

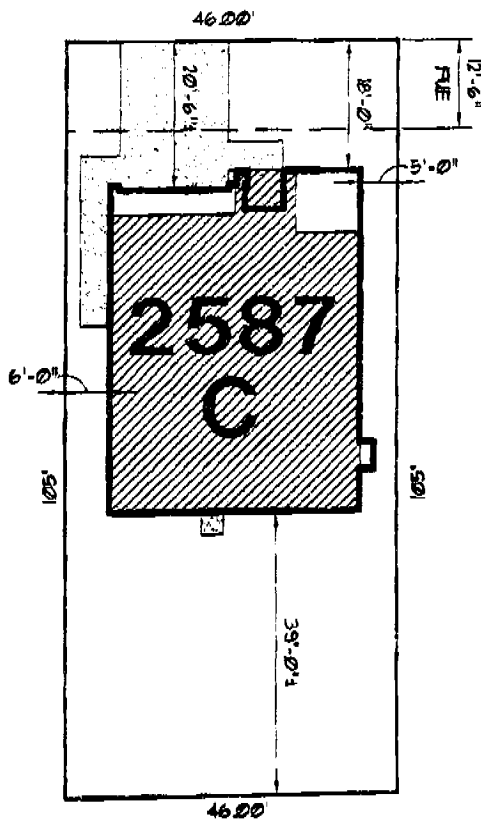

ARCHITECTURE PROGRAMMING, PLS. DRKS. 8202001.12.16.24.5.P14. JAMES

LOT: 36 SITE ADDRESS: 2180 PEAKVIEW AVENUE

WHEN USED FOR SALES OR CONTRACT PURPOSES THIS DOCUMENT DOES NOT GUARANTEE ANY DIMENSIONS, DISTANCES, BEARINGS OR SETBACKS. JMC RESERVES THE RIGHT TO MAKE CHANGES AT ANY TIME WITHOUT PRIOR NOTICE AND IS NOT RESPONSIBLE FOR IRREGULARITIES OR DIFFERENCES IN ACTUAL OR "AS-BUILT" LOT CHARACTERISTICS.

SCALE: 1"=20'
LOT SIZE: 48300 +/-
FLAT WORK: 474 +/-
DATE: 06/18/03

COVERAGE: 3323%
APN: 201-070-026
1280 VERNON ST. #100
ROCKVILLE, CA 94778
916-788-8978
CA. LIC. 078004

2-CAR R
JMC HOMES

N13-P36