



3.20

DEPARTMENT OF
PUBLIC WORKS

CITY OF SACRAMENTO
CALIFORNIA

927 10th STREET, STE. 100
SACRAMENTO, CA
95814-2700

PROJECT DELIVERY DIVISION

PH. (916) 808-8300
FAX (916) 264-8281

November 24, 2003

AG 2003-231

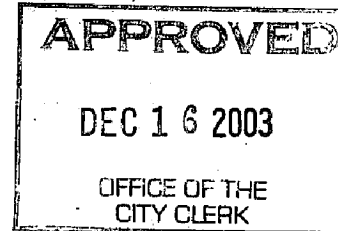

City Council
Sacramento, California

Honorable Members in Session:

**SUBJECT: TAHOE PARK 5 STREET LIGHTING ASSESSMENT DISTRICT #2003-07 -
RESOLUTION OF INTENTION**

LOCATION AND COUNCIL DISTRICT:

Midtown - Council District 6 (See location map, Attachment "A").

RECOMMENDATION:

This report recommends that City Council adopt the attached resolutions:

- Undertaking proceedings for the formation and sale of bonds for the proposed Tahoe Park Street Lighting Assessment District #2003-07;
- Preliminarily approving the Engineer's Report for the Proposed Tahoe Park 5 Street Lighting Assessment District and setting a public hearing for February 3, 2004; and
- Approving an agreement for Legal Services for the Proposed Tahoe Park 5 Street Lighting Assessment District #2003-07.

CONTACT PERSONS:

Eric S. Yap, Senior Engineer, 808-5641
Rita Goolkasian, Program Specialist, 808-5236

FOR COUNCIL MEETING OF: December 16, 2003

City Council

Tahoe Park 5 Street Lighting Assessment District #2003-07

November 24, 2003

SUMMARY:

This report presents a proposal to form an Assessment District to fund neighborhood streetlights in the Tahoe Park 5 neighborhood consisting of 227 parcels whose boundary is shown on attachment "A". The district is being formed under the Municipal Improvement Act of 1913 and the Improvement Bond Act of 1915.

The recommended Council action will set the public hearing and majority protest (through assessment ballots) for the district for the afternoon of February 3, 2004. The district formation schedule is shown on attachment "B".

COMMITTEE/COMMISSION ACTION:

None.

BACKGROUND INFORMATION:

On September 25, 2001, the City Council approved the scored and ranked project list for the Street Lighting Match Program. Funding was approved for the eight highest ranked projects with each receiving \$125,000 of City match money to provide assistance for installing streetlights. Four of the projects required Assessment District formation to offset the balance of costs. One of those projects was the Tahoe Park 5 neighborhood (PN:SM70).

On November 4, 2003, staff recommended that the City Council approve an additional contribution to reduce the property owners' costs to a more acceptable level, after reviewing construction bids for the Tahoe Park 5 Streetlight project. Council approved an additional \$181,400 for the project, which reduced the annual estimated assessment to \$199 for a 15-year term.

This district is being formed under the Municipal Improvement Act of 1913. Using the bid cost and identifying all bond issuance costs, staff has generated the Engineer's Report allocating all costs equitably to all 227 parcels benefiting from the lights. Since a City neighborhood park is included within the proposed district boundary, the City will be required to pay its fair share of costs. The description of Street Lighting Improvements and Boundary Map of the Assessment District are shown in exhibits A, and B-1 through B-4 of the Resolution of Intention.

Methodology for Spreading the Assessment

The lots in this district are nearly all the same size, and therefore will share the total cost equally. However, there are a few lots that are significantly larger and will be assessed accordingly. A complete description of the methodology is described in the Engineers Report (on file in the Clerk's Office).

Following Council approval of the attached resolutions, staff in accordance with the Assessment District proceedings will mail the assessment ballot with description and cost of the district to all affected property owners. Following the mandated 45-day noticing period, a public hearing to

City Council

Tahoe Park 5 Street Lighting Assessment District #2003-07

November 24, 2003

February 3, 2004 and the outcome of the majority protest will be announced before the conclusion of that meeting or during the Council's evening meeting on the same date.

FINANCIAL CONSIDERATIONS:

The total cost of the project for the Tahoe Park 5 is estimated to be \$710,367. The General Fund will contribute \$125,000 toward the cost of this project. An additional contribution of \$181,400 will be funded through the State Jobs-Housing Balance Incentive Grant (M03-185) as approved by the City Council on November 4, 2003 and the balance will be borne by property owners. A summary is provided below in Table 1.

The assessment for the majority of lots in this district will be a total of \$1,780. Based on a not-to-exceed interest rate of 6.5%, the annual payment will be approximately \$199/year for 15 years. The City of Sacramento's share of costs for the neighborhood park is determined to be \$13,706. The full cost of the project and assessment to property owners is described in the Engineer's Report (on file with the City Clerk).

Table 1

| Total Cost | Streetlight Match – General Fund | Additional Contribution - State Job-Housing Balance Incentive Grant | Property Owners |
|-------------------|---|--|------------------------|
| \$710,367 | \$125,000 | \$181,400 | \$403,967 |

ENVIRONMENTAL CONSIDERATIONS:

Under the California Environmental Quality Act (CEQA) Guidelines, formation of an Assessment District does not constitute a project, and is therefore, exempt from review.

POLICY CONSIDERATIONS:

The proceedings for this district are pursuant to the provisions of the Municipal Improvement Act of 1913 and Improvement Bond Act of 1915. This process is consistent with the City's Strategic Plan goal to preserve and enhance the City's neighborhoods and quality of life.

ESBD CONSIDERATIONS:

City Council approval of these proceedings is not affected by City policy related to the ESBD Program.

Respectfully submitted:

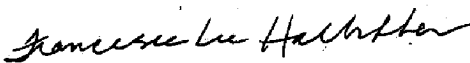

Francesca Lee Halbakken
Project Delivery Manager

RECOMMENDATION APPROVED:

Approved:



ROBERT P. THOMAS
City Manager

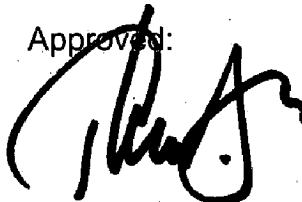

Thomas V. Lee
Deputy City Manager

TABLE OF CONTENTS:

- 1) Attachment A, location map, pg. 5
- 2) Attachment B, schedule of proceedings for Tahoe Park 5 Street Lighting, pg. 6
- 3) Resolution undertaking proceedings for the formation and sale of bonds for the proposed Tahoe Park 5 Street Lighting Assessment District #2003-07, pg. 7
- 4) Exhibit A, description of street lighting improvements, pg. 11
- 5) Exhibit B-1 through B-4, boundary map for Tahoe Park 5 Street Lighting, pg. 12
- 6) Resolution preliminarily approving the Engineer's Report for the Proposed Tahoe Park 5 Street Lighting Assessment District and setting a public hearing, pg. 16
- 7) Exhibit A, description of street lighting improvements, pg. 20
- 8) Resolution approving an agreement for Legal Services for the Proposed Tahoe Park 5 Street Lighting Assessment District #2003-07, pg. 21

ATTACHMENT A

Tahoe Park 5 Street Lighting Assessment
District (#2003-07)

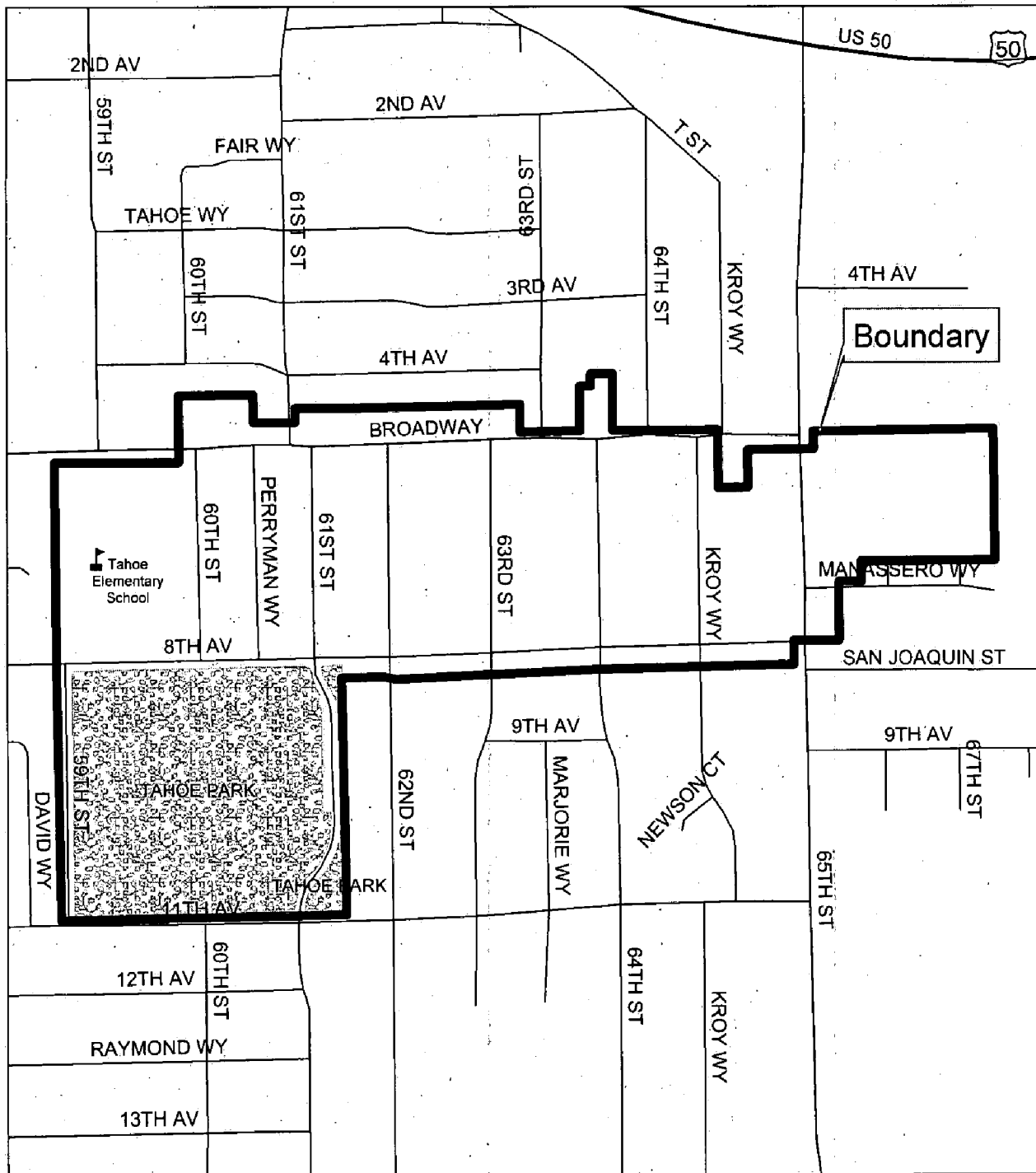

BMueller 11/19/03

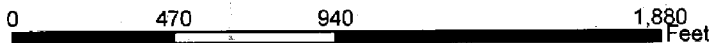

ATTACHMENT B

SCHEDULE FOR TAHOE PARK #5 STREET LIGHTING ASSESSMENT DISTRICT #2003-07

November 4, 2003 City Council Approves Additional Funding for the Street Light Match Program

| | |
|--------------------------|--|
| December 16, 2003 | City Council Action – Resolution of Intention |
|--------------------------|--|

- | |
|--|
| <ul style="list-style-type: none">▪ ROI to undertake proceedings for the formation and sale of bonds with mail ballot election▪ Preliminarily Approving the Engineer's Report and Set Public Hearing Date▪ Approving Agreement for Legal Services |
|--|

December 17, 2003 Begin the 45 day public noticing period
Mail Ballot to Property Owners

February 3, 2004 City Council Meeting

- Conduct the Public Hearing – afternoon session
- Declare Results of Election – evening session
- Approve Formation of District
- Confirm Assessments
- Approve Engineers Report

February 4, 2004 Initiate 30-day Cash Collection Period

- Mail Letter to Property Owners

February 24, 2004 City Council Meeting (End of 30-day Cash Collection Period)

- Declare Unpaid Amount
- Authorize Issuance of Sale of Bonds
- Establish the Budget
- Approve Legal Documents & POS

March 9, 2004 City Council Meeting
Award Bid

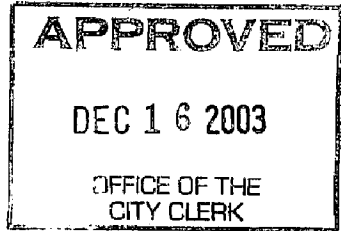

RESOLUTION NO. 2003-894

ADOPTED BY THE SACRAMENTO CITY COUNCIL

ON DATE OF DECEMBER 16, 2003

A RESOLUTION OF INTENTION OF THE COUNCIL OF THE CITY OF SACRAMENTO TO UNDERTAKE PROCEEDINGS PURSUANT TO THE PROVISIONS OF THE MUNICIPAL IMPROVEMENT ACT OF 1913 AND TO ISSUE BONDS IN SUCH PROCEEDINGS UNDER THE PROVISIONS OF THE IMPROVEMENT BOND ACT OF 1915 FOR THE PROPOSED TAHOE PARK 5 STREET LIGHTING ASSESSMENT DISTRICT NO. 2003-07

WHEREAS, the City Council (the "City Council") of the City of Sacramento (the "City") has determined that it is necessary, convenient and desirable to undertake proceedings pursuant to the provisions of the Municipal Improvement Act of 1913 and to issue bonds in such proceedings under the provisions of the Improvement Bond Act of 1915 for the acquisition and construction of those certain street lighting improvements more particularly described in Exhibit A, attached hereto and incorporated herein and made a part hereof, in and for a proposed street lighting assessment district in the City designated the "Tahoe Park 5 Street Lighting Assessment District No. 2003-07;"

NOW, THEREFORE, BE IT RESOLVED BY THE COUNCIL OF THE

CITY OF SACRAMENTO, as follows:

Section 1. The foregoing recital is true and correct, and the City Council so finds and determines.

Section 2. The City Council hereby declares its intention to order such street lighting improvements to be acquired and constructed by the City in and for such assessment district pursuant to the provisions of the Municipal Improvement Act of 1913 and to issue bonds in such proceedings under the provisions of the Improvement Bond Act of 1915, and the City Council hereby further states that it intends to comply with the requirements of the Special Assessment Investigation, Limitation and Majority Protest Act of 1931 applicable to such assessment district by proceeding under Part 7.5 thereof.

Section 3. The City Council hereby further declares its intention to levy a special assessment based upon the special benefits to be received by each parcel of land in such assessment district, respectively, from such street lighting improvements;

FOR CITY CLERK USE ONLY

RESOLUTION NO.: _____

DATE ADOPTED: _____

provided; that where any disparity occurs in the level between such street lighting improvements and private property and the City Council determines that it is in the public interest and more economical to eliminate the disparity by doing work on such private property instead of adjusting the work on public property, then such work may be done on private property for this purpose with the written consent of the landowner; and provided further, that \$306,400 of the cost of such street lighting improvements shall be contributed by the City and that the balance of the cost thereof shall be specially assessed upon the land in such assessment district.

Section 4. The City Council hereby declares that the territory shown on that certain boundary map entitled "Boundary Map Tahoe Park 5 Street Lighting Assessment District No. 2003-07, City of Sacramento, County of Sacramento, State of California" indicating the boundaries of such assessment district, a copy of which boundary map, labeled Exhibit B, is attached hereto and incorporated herein and made a part hereof, is hereby approved and adopted by the City Council as the boundary map of such assessment district that describes the extent of the territory included therein, and the Interim City Clerk is hereby authorized and directed to endorse the certificates on such boundary map evidencing the filing of such boundary map with her and the adoption of this resolution approving such boundary map, and to record a copy of such boundary map with the County Recorder of Sacramento County as required by law within fifteen (15) days after the adoption of this resolution; and such map shall govern for all details as to the extent of such assessment district and shall constitute the boundaries of such assessment district to be benefited by the acquisition and construction of such street lighting improvements and to be assessed to pay the costs and expenses of the acquisition and construction thereof, and that the costs and expenses of the acquisition and construction of such street lighting improvements (less the foregoing contribution) shall be made chargeable upon such assessment district pursuant to the provisions of the Municipal Improvement Act of 1913.

Section 5. The City Council hereby determines and notice is hereby given that limited obligation serial bonds, term bonds, or both, to represent the costs and expenses of such street lighting improvements and to be secured by unpaid assessments to be levied in such assessment district and to bear interest at the rate of not to exceed six and one-half per cent (6.5%) per annum, will be issued in such proceedings in the manner provided by the Improvement Bond Act of 1915, and that the last installment of such bonds shall mature a maximum of fifteen (15) years from the 2nd day of September next succeeding twelve (12) months from their date. The City Council hereby further determines and notice is hereby further given that the principal amount of such bonds maturing or becoming subject to mandatory prior redemption in each year shall be other than an amount equal to an even annual proportion of the aggregate principal amount of such bonds. The City Council hereby further determines and notice is hereby further given that, except for any mandatory obligation to refund such bonds under the Improvement Bond Act of 1915, such bonds shall not be optionally refunded pursuant to the provisions of Division 11 or Division 11.5 of the Improvement Bond Act of 1915 prior to September 2, 2013, and any such

FOR CITY CLERK USE ONLY

RESOLUTION NO.: _____

DATE ADOPTED: _____

optional refunding pursuant to the provisions of Division 11 of the Improvement Bond Act of 1915 must result in a reduction in the interest cost to maturity by reason of the refunding of such bonds, and such refunding bonds may bear interest at a rate not to exceed the maximum rate permitted by law and must have a maximum number of years to maturity not in excess of the term of such bonds, and any adjustment to assessments resulting from the issuance of such refunding bonds must be done on a pro rata basis. The City Council hereby further determines and notice is hereby further given that it proposes to proceed under the alternative procedure authorized in Part 11.1 of the Improvement Bond Act of 1915 relative to collecting assessments and the advance retirement of such bonds, and that it proposes to include, as an additional expense of the proceedings, an amount not in excess of six per cent (6%) of the total amount of the assessments as a special reserve fund for such bonds, as authorized in the Improvement Bond Act of 1915, and that it proposes to sell such bonds at a discount not in excess of nine per cent (9%) of the principal amount thereof. The City Council hereby further determines and notice is hereby further given that the City will not obligate itself to advance available funds from the City treasury to cure any deficiency which may occur at any time in the bond redemption fund for such bonds.

Section 6. The City Council hereby determines and notice is hereby given that a maximum annual assessment of sixteen dollars (\$16.00) upon each of the several parcels of land in such assessment district is proposed to be levied to pay costs incurred by the City and not otherwise reimbursed for the administration and collection of such assessments or for the administration of the reserve fund or other related funds or for the registration of the bonds issued to represent unpaid assessments.

Section 7. After the completion of the acquisition and construction of such street lighting improvements and the payment of all claims from the improvement fund to be provided in the proceedings hereafter taken pursuant to this resolution, the City Council shall determine the amount of the surplus, if any, remaining in such improvement fund by reason of the assessment (and any supplemental assessment) levied for the acquisition and construction of such street lighting improvements, and any such surplus shall be used as a credit on the assessment (as provided in Section 10427(b) of the Streets and Highways Code) or to maintain such street lighting improvements (as provided in Section 10427(c) of the Streets and Highway Code), as determined by the City Council.

Section 8. The City Council hereby determines and notice is hereby given that it is the intention of the City Council that a penalty of two per cent (2%) per month of the total amount of any delinquent assessment installment shall be added to such delinquent assessment installment after the close of business on the delinquency date, and that an additional penalty of two per cent (2%) of the amount of such delinquency shall be added thereto at the beginning of business on the tenth (10th) day of each succeeding month until such delinquent assessment installment and all penalties are fully paid, which penalties shall be in lieu of all other penalties assessed by other provisions of law, and that the County of Sacramento shall collect such penalties with

FOR CITY CLERK USE ONLY

RESOLUTION NO.: _____

DATE ADOPTED: _____

and as a part of such delinquent assessment installments, and all penalties collected shall be deposited into the bond redemption fund for such bonds.

Section 9. The City Council hereby appoints the City Interim Director of Public Works (who is a registered professional engineer) as the Engineer of Work (the "Engineer of Work") for such proceedings, and such Engineer of Work is authorized and directed (consistent with the conditions and terms of this resolution) to do and perform all engineering work necessary in and for such proceedings, and such Engineer of Work is hereby directed to prepare a report in compliance with Section 10204 of the Streets and Highways Code containing plans and specifications for such street lighting improvements, together with a general description of the works to be acquired as part of such street lighting improvements and an estimate of the costs and expenses thereof (including authorized funded interest on such bonds), together with an assessment diagram and a proposed assessment of the portion of the costs and expenses of such street lighting improvements to be levied in such assessment district upon the several parcels of land in such assessment district in proportion to the estimated benefits to be received by each such parcel, respectively, from such street lighting improvements, and is hereby further directed to include in such report the information required by Part 7.5 of the Special Assessment Investigation, Limitation and Majority Protest Act of 1931, and thereafter to file such report with the Interim City Clerk of the City, who shall present such report to the City Council.

APPROVED:

Mayor

ATTEST:

City Clerk

10

FOR CITY CLERK USE ONLY

RESOLUTION NO.: _____

DATE ADOPTED: _____

EXHIBIT A

DESCRIPTION OF STREET LIGHTING IMPROVEMENTS

The improvements, which are subject of this report, are briefly described as follows:

The construction and installation of a complete high pressure sodium ornamental street lighting system together with all necessary appurtenances thereto on Broadway Boulevard and 8th Avenue from 60th Street to 65th Street; on 60th Street, Perkyman Way, 61st Street, 62nd Street, 63rd Street, 64th Street, Kroy Way, and 65th Street, from 8th Avenue to Broadway Boulevard.

FOR CITY CLERK USE ONLY

RESOLUTION NO.: _____

DATE ADOPTED: _____

BOUNDARY MAP
TAHOE PARK 5 STREET LIGHTING ASSESSMENT DISTRICT
No. 2003-07
 CITY OF SACRAMENTO
 COUNTY OF SACRAMENTO - STATE OF CALIFORNIA
 SHEET 1 OF 4

LEGEND:
 - - - - - ASSESSMENT DISTRICT BOUNDARY
 - - - - - DISTRICT CONTINUATION LINE TO NEXT PAGE

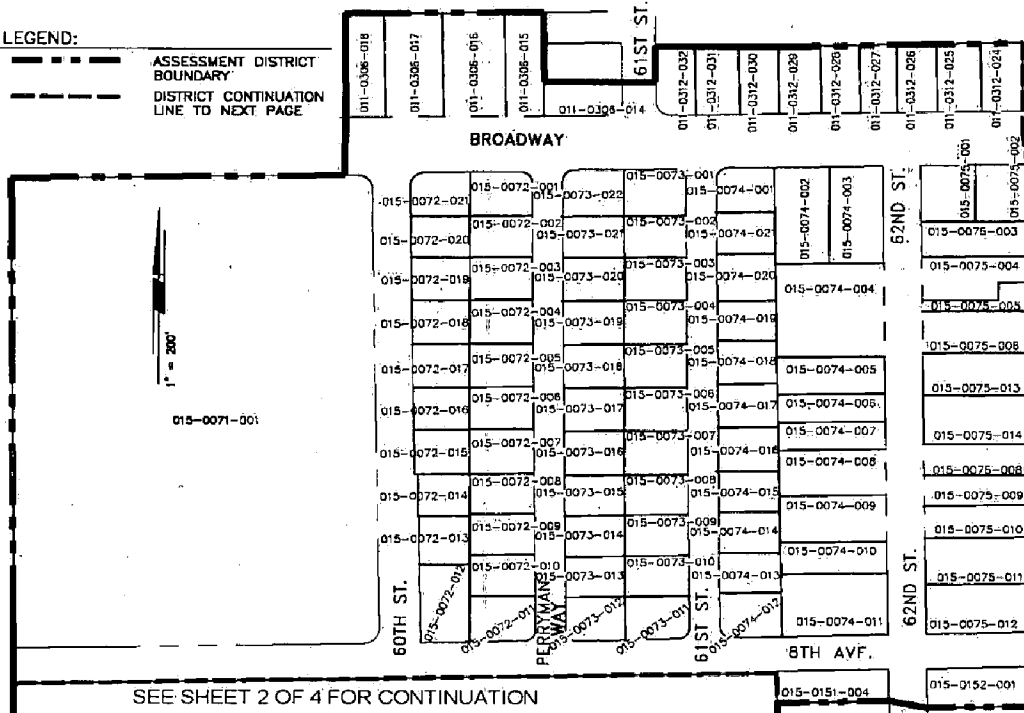

SEE SHEET 2 OF 4 FOR CONTINUATION

SEE SHEET 3 OF 4 FOR CONTINUATION

CLERK'S MAP FILING STATEMENT
 FILED IN THE OFFICE OF THE CITY CLERK OF THE CITY OF SACRAMENTO, STATE OF CALIFORNIA, THIS ____ DAY OF _____, 2003.

 CITY CLERK

CLERK'S MAP CERTIFICATE
 AN ASSESSMENT WAS LEVIED BY THE CITY OF SACRAMENTO OF THE COUNTY OF SACRAMENTO, STATE OF CALIFORNIA, ON THE LOTS, PIECES AND PARCELS OF LAND SHOWN ON THIS ASSESSMENT DIAGRAM. SAID ASSESSMENT WAS LEVIED ON THE ____ DAY OF _____, 2003.

 CITY CLERK

SUPERINTENDANT OF STREETS RECORDING STATEMENT:
 ASSESSMENT WAS LEVIED BY THE CITY OF SACRAMENTO OF THE COUNTY OF SACRAMENTO ON THE LOTS SHOWN ON THIS ____ DAY OF _____, 2003. SAID ASSESSMENT DIAGRAM AND THE ASSESSMENT ROLL WERE RECORDED IN THE OFFICE OF THE SUPERINTENDENT OF STREETS OF SAID CITY OF SACRAMENTO ON THE ____ DAY OF _____, 2003. REFERENCE IS MADE TO THE ASSESSMENT ROLL RECORDED IN THE OFFICE OF THE COUNTY SURVEYOR FOR THE EXACT AMOUNT OF EACH ASSESSMENT LEVIED AGAINST EACH PARCEL OF LAND SHOWN ON THIS ASSESSMENT DIAGRAM.

 SUPERINTENDENT OF STREETS
 CITY OF SACRAMENTO

COUNTY RECORDER'S FILING STATEMENT
 FILED THIS ____ DAY OF _____, 20____, AT THE HOUR OF ____ O'CLOCK ____ M., IN BOOK ____ OF MAPS OF THE ASSESSMENT AND COMMUNITY FACILITIES DISTRICTS AT THE PAGE ____ IN THE OFFICE OF THE COUNTY RECORDER OF THE COUNTY OF SACRAMENTO, STATE OF CALIFORNIA.

 COUNTY RECORDER OF THE COUNTY OF SACRAMENTO, CALIFORNIA
 DEPUTY

THE SACRAMENTO COUNTY ASSESSOR'S MAPS ARE INCORPORATED BY REFERENCE INTO THIS ASSESSMENT DIAGRAM. THE PARCELS FOR THIS DIAGRAM ARE THOSE LINES AND DIMENSIONS SHOWN ON THE ASSESSOR'S MAPS, WHICH ARE ON FILE AND OPEN TO PUBLIC INSPECTION AT THE ASSESSOR'S OFFICE.

FOR CITY CLERK USE ONLY



RESOLUTION NO.: _____

DATE ADOPTED: _____

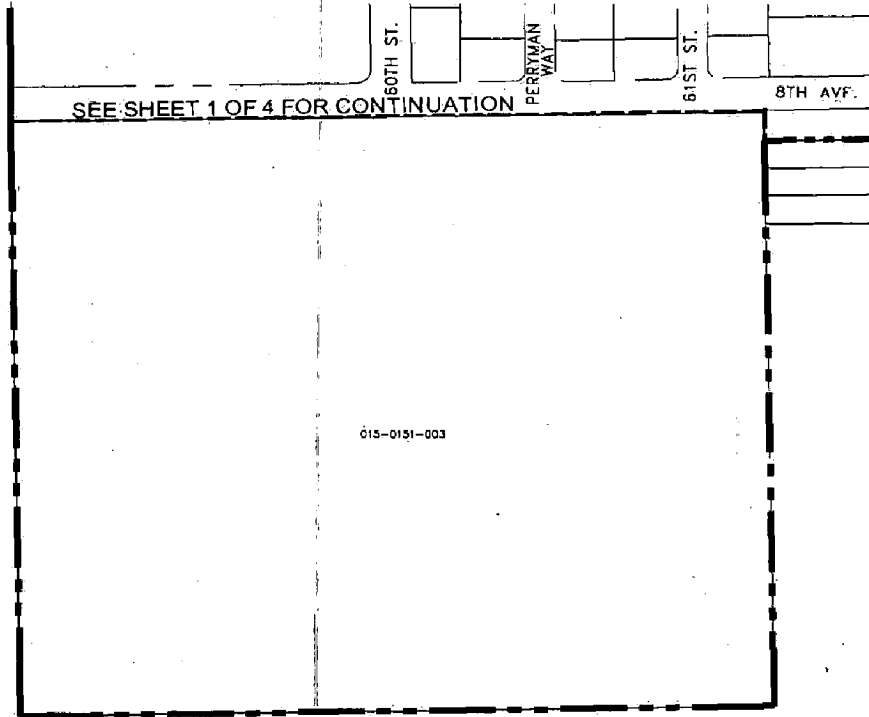
BOUNDARY MAP
TAHOE PARK 5 STREET LIGHTING ASSESSMENT DISTRICT
No. 2003-07
CITY OF SACRAMENTO
COUNTY OF SACRAMENTO - STATE OF CALIFORNIA
SHEET 2 OF 4



LEGEND:

-  ASSESSMENT DISTRICT BOUNDARY
-  DISTRICT CONTINUATION LINE TO NEXT PAGE
-  TAHOE SCHOOL
3110 60TH STREET

THE SACRAMENTO COUNTY ASSESSOR'S MAPS ARE INCORPORATED BY REFERENCE INTO THIS ASSESSMENT DIAGRAM. THE PARCELS FOR THIS DIAGRAM ARE THOSE LINES AND DIMENSIONS SHOWN ON THE ASSESSOR'S MAPS, WHICH ARE ON FILE AND OPEN TO PUBLIC INSPECTION AT THE ASSESSOR'S OFFICE.

FOR CITY CLERK USE ONLY

RESOLUTION NO.: _____

DATE ADOPTED: _____

BOUNDARY MAP
TAHOE PARK 5 STREET LIGHTING ASSESSMENT DISTRICT
No. 2003-07
 CITY OF SACRAMENTO
 COUNTY OF SACRAMENTO - STATE OF CALIFORNIA
 SHEET 3 OF 4

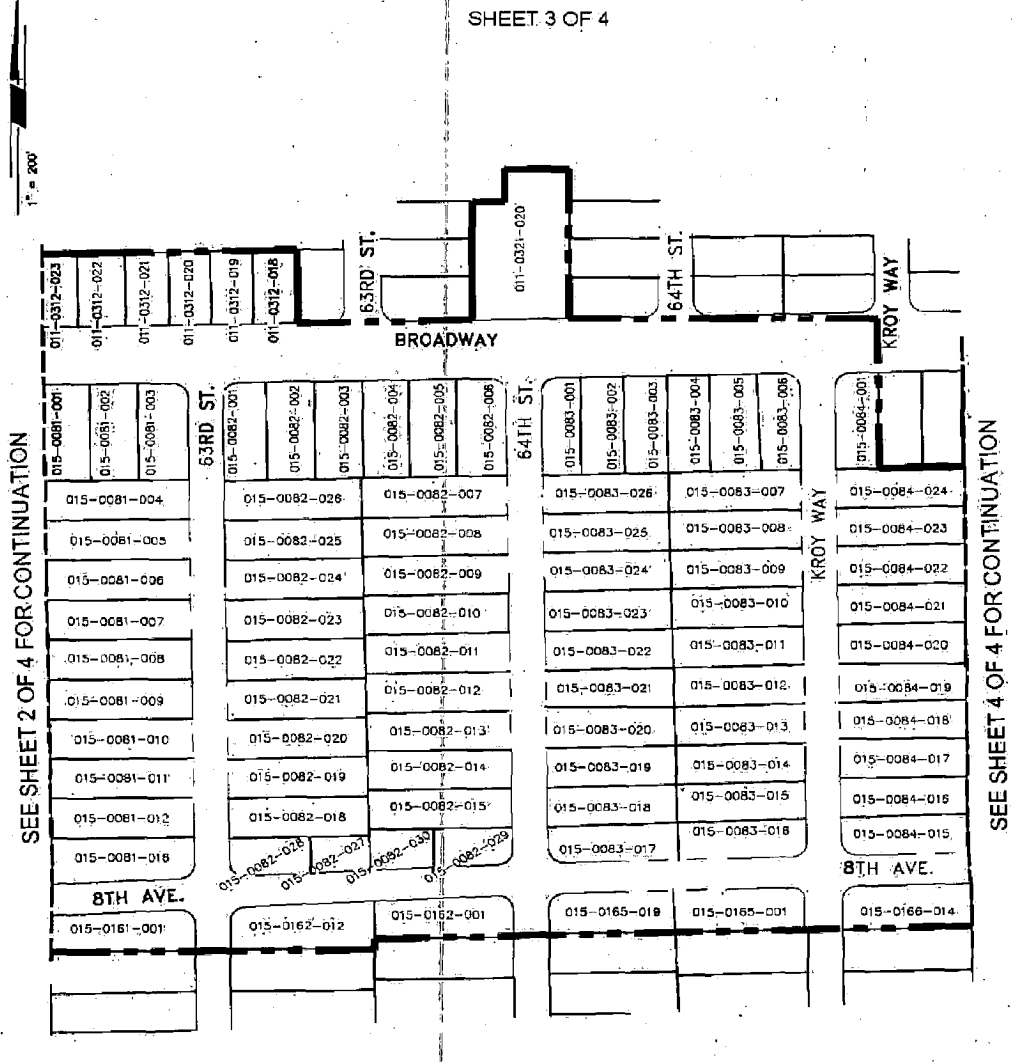

SEE SHEET 2 OF 4 FOR CONTINUATION

SEE SHEET 4 OF 4 FOR CONTINUATION

LEGEND:

- ASSESSMENT DISTRICT BOUNDARY
- DISTRICT CONTINUATION LINE TO NEXT PAGE

THE SACRAMENTO COUNTY ASSESSOR'S MAPS ARE INCORPORATED BY REFERENCE INTO THIS ASSESSMENT DIAGRAM. THE PARCELS SHOWN ON THIS DIAGRAM ARE THOSE LINES AND DIMENSIONS SHOWN ON THE ASSESSOR'S MAPS, WHICH ARE ON FILE AND OPEN TO PUBLIC INSPECTION AT THE ASSESSOR'S OFFICE.

FOR CITY CLERK USE ONLY

RESOLUTION NO.: _____

DATE ADOPTED: _____

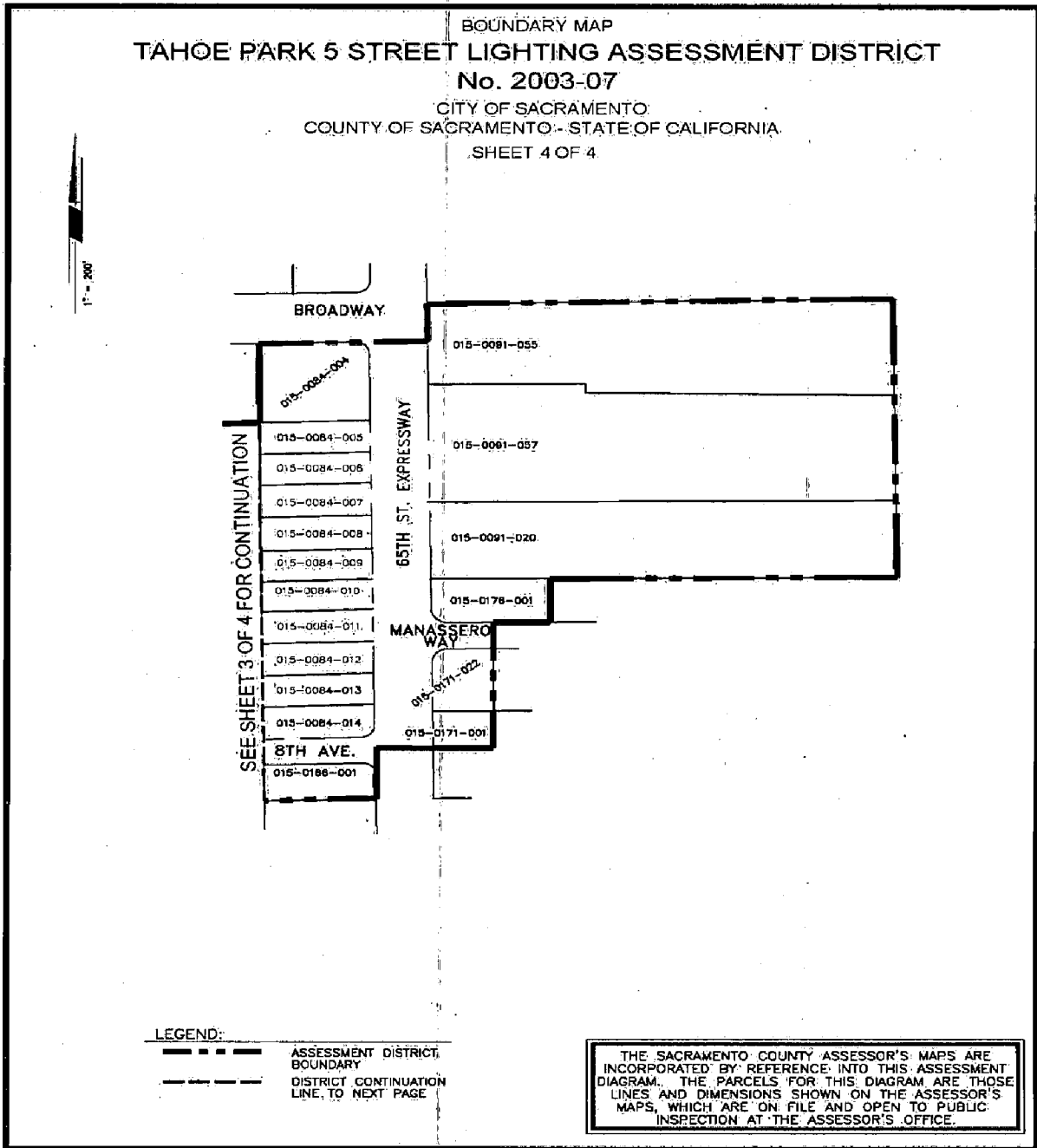

FOR CITY CLERK USE ONLY

RESOLUTION NO.: _____

DATE ADOPTED: _____

RESOLUTION NO. 2003-895

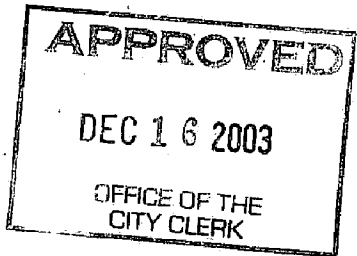

ADOPTED BY THE SACRAMENTO CITY COUNCIL

ON DATE OF DECEMBER 16, 2003

A RESOLUTION OF THE COUNCIL OF THE CITY OF SACRAMENTO PRELIMINARILY APPROVING THE ENGINEER'S REPORT FOR THE PROPOSED TAHOE PARK 5 STREET LIGHTING ASSESSMENT DISTRICT NO. 2003-07 AND FIXING THE DATE, TIME AND PLACE FOR A PUBLIC HEARING TO CONSIDER THE LEVY OF AN ASSESSMENT THEREIN, AND PROVIDING FOR AN ASSESSMENT BALLOT ELECTION ON THE LEVY OF SUCH ASSESSMENT

WHEREAS, the City Council (the "City Council") of the City of Sacramento (the "City") has determined that it is necessary, convenient and desirable to undertake proceedings pursuant to the provisions of the Municipal Improvement Act of 1913 and to issue bonds in such proceedings under the provisions of the Improvement Bond Act of 1915 for the acquisition and construction of those certain street lighting improvements more particularly described in Exhibit A, attached hereto and incorporated herein and made a part hereof, in and for a street lighting assessment district in the City designated the "Tahoe Park 5 Street Lighting Assessment District No. 2003-07;" and

WHEREAS, the City Council, by Resolution of Intention No. 2003-___ (the "Resolution of Intention") adopted on December 16, 2003, declared its intention to order such street lighting improvements to be acquired and constructed by the City in and for such assessment district pursuant to the provisions of the Municipal Improvement Act of 1913 and to issue bonds in such proceedings under the provisions of the Improvement Bond Act of 1915, and the City Council further stated that it intended to comply with the requirements of the Special Assessment Investigation, Limitation and Majority Protest Act of 1931 applicable to such assessment district by proceeding under Part 7.5 thereof; and

WHEREAS, the City Council appointed the City Interim Director of Public Works as the Engineer of Work (the "Engineer of Work") for such proceedings, and such Engineer of Work was authorized and directed to do and perform all engineering work necessary in and for such proceedings; and

WHEREAS, the City Council directed the Engineer of Work to do and perform all engineering work in and for such proceedings, and to prepare a report in

FOR CITY CLERK USE ONLY

RESOLUTION NO.: _____

DATE ADOPTED: _____

compliance with Section 10204 of the Streets and Highways Code containing plans and specifications for such street lighting improvements, together with a general description of the works to be acquired as part of such street lighting improvements and an estimate of the costs and expenses thereof (including authorized funded interest on such bonds), and together with an assessment diagram and a proposed assessment of the portion of the costs and expenses of such street lighting improvements to be levied in such assessment district upon the several parcels of land in such assessment district in proportion to the estimated benefits to be received by each such parcel, respectively, from such street lighting improvements, which assessment was directed to take cognizance of a contribution of \$306,400 from the City from other available funds of the City for the payment of all other costs and expenses of such street lighting improvements, and further directed the Engineer of Work to include in such report the information required by Part 7.5 of the Special Assessment Investigation, Limitation and Majority Protest Act of 1931, and thereafter to file such report with the Interim City Clerk of the City, who was directed to present such report to the City Council; and

WHEREAS, the Engineer of Work prepared and filed with the Interim City Clerk a report (the "Engineer's Report") containing the matters required by the Resolution of Intention, which Engineer's Report was duly presented by the Interim City Clerk of the City to the City Council for consideration; and

WHEREAS, the Engineer of Work has determined the assessed valuation of all parcels of land within the assessment district for the 2003-2004 Fiscal Year is not less than \$20,135,111, and that there are no existing unpaid assessments against any of such parcels of land proposed to be assessed; and accordingly that the limitations set forth in Section 2961(d) of the Streets and Highways Code (the "Code") have been satisfied in that the principal sum of all unpaid special assessments levied against the parcels proposed to be assessed, as computed by the Code, plus the proposed amount of the special assessments proposed to be levied in the assessment proceedings do not exceed one-half of the total value of the parcels proposed to be assessed in the assessment proceeding; as computed by the Code; and

WHEREAS, the Engineer's Report has been carefully and fully considered by the City Council;

NOW, THEREFORE, BE IT RESOLVED by the City Council of the City of Sacramento, as follows:

Section 1. The foregoing recitals are true and correct, and the City Council so finds and determines.

Section 2. The Engineer's Report is hereby preliminarily approved by the City Council.

Section 3. Tuesday, February 3, 2004, at 2:00 o'clock P.M., at the Council Chambers at the Interim City Hall, 730 I Street, 1st Floor, Sacramento, California

17

FOR CITY CLERK USE ONLY

RESOLUTION NO.: _____

DATE ADOPTED: _____

95814, is hereby fixed by the City Council as the date, time and place for a public hearing of protests to the levy of such proposed assessment and to proceeding under Part 7.5 of the Special Assessment Investigation, Limitation and Majority Protest Act of 1931 with respect to such assessment district. At such public hearing (which may be continued from time to time) the City Council shall consider all objections or protests, if any, to the levy of such proposed assessment, and any interested person will be permitted to present written or oral testimony relating to the levy of such proposed assessment, and to proceeding under Part 7.5 of the Special Assessment Investigation, Limitation and Majority Protest Act of 1931, and at the time appointed for such public hearing the Interim City Clerk of the City shall present all written protests filed with her to the City Council, and any person filing a written protest may withdraw such protest at any time prior to the conclusion of public testimony at such public hearing.

Section 4. The Interim City Clerk of the City is hereby directed to cause a notice of the public hearing of protests to the levy of such proposed assessment in such assessment district and to proceeding under Part 7.5 of the Special Assessment Investigation, Limitation and Majority Protest Act of 1931 with respect to such assessment district to be given by mailing notices thereof, postage prepaid, deposited in the United States Postal Service at least forty-five (45) days prior to the date of such public hearing, to the owners of all parcels proposed to be assessed in such proceedings whose name and address appear on the last equalized secured property assessment roll of the County of Sacramento, or, in the case of any public entity, to the representative of such public entity at the address known to the City. Each of such notices shall contain and include the total amount of the proposed assessment chargeable to the entire assessment district, the amount of the proposed assessment to be chargeable to such owner's parcel, the duration of the payments of the proposed assessments (which shall be fifteen (15) fiscal years), the reason for the proposed assessment and the basis upon which the amount of the proposed assessment was calculated, and shall also contain and include the date, time and place of the public hearing herein called, and shall also include, in a conspicuous place thereon, a summary of the procedures for the completion, return and tabulation of the assessment ballots required pursuant to law, including a statement that the assessment shall not be imposed if the ballots submitted in opposition to the assessment exceed the ballots submitted in favor of the assessment, with the ballots weighted according to the proportional financial obligation of each affected parcel. Additionally, there shall be mailed together with each notice an assessment ballot that includes the Interim City Clerk's address for receipt of such ballot and a place where the person returning the assessment ballot may indicate his or her name, together with a reasonable identification of the parcel, and his or her support for or opposition to the proposed assessment. Upon the completion of the mailing of such notices and assessment ballots, the Interim City Clerk of the City is hereby directed to file with the City Council an affidavit setting forth the time and manner of the compliance with mailing such notices and assessment ballots.

FOR CITY CLERK USE ONLY

RESOLUTION NO.: _____

DATE ADOPTED: _____

Section 5. Each assessment ballot must be signed and either mailed or otherwise delivered to the address indicated on the assessment ballot prior to the conclusion of public testimony at the public hearing on the proposed assessment; but regardless of the method of delivery, all assessment ballots must have a mark next to "support" or "oppose" and must be properly signed in the place provided and must be received at the address indicated, or the location of the public hearing, prior to the conclusion of public testimony at such public hearing in order to be included in the tabulation of a majority protest to the proposed assessment, and any assessment ballot that has been submitted may be changed or withdrawn by the person who submitted the ballot prior to the conclusion of public testimony on such proposed assessment at such public hearing. At the conclusion of public testimony at such public hearing, the Engineer of Work shall tabulate the assessment ballots submitted, and not withdrawn, in support of and in opposition to such proposed assessment, and if on the basis of such tabulation the City Council determines that a majority protest existed, in that the assessment ballots submitted (and not withdrawn) in opposition to such proposed assessment exceeded the assessment ballots submitted (and not withdrawn) in favor of such proposed assessment (weighting each assessment ballot by the amount of the final proposed assessment to be levied upon the parcel for which such assessment ballot was submitted), such proposed assessment shall not be imposed.

Section 6. Ron Wicky or Rita Goolkasian, Office of the Department of Public Works, Special Districts, City of Sacramento, 1231 I Street, Room 300, Sacramento, California 95814, telephone (916) 808-7113, is hereby designated to answer inquiries regarding the protest proceedings.

APPROVED:

Mayor

ATTEST:

City Clerk

19

FOR CITY CLERK USE ONLY

RESOLUTION NO.: _____

DATE ADOPTED: _____

EXHIBIT A

DESCRIPTION OF STREET LIGHTING IMPROVEMENTS

The improvements, which are subject of this report, are briefly described as follows:

The construction and installation of a complete high pressure sodium ornamental street lighting system together with all necessary appurtenances thereto on Broadway Boulevard and 8th Avenue from 60th Street to 65th Street; on 60th Street, Perkyman Way, 61st Street, 62nd Street, 63rd Street, 64th Street, Kroy Way, and 65th Street, from 8th Avenue to Broadway Boulevard.

FOR CITY CLERK USE ONLY

RESOLUTION NO.: _____

DATE ADOPTED: _____

RESOLUTION NO. 2003-896

ADOPTED BY THE SACRAMENTO CITY COUNCIL

ON DATE OF DECEMBER 16, 2003

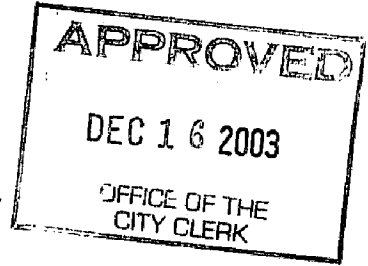

A RESOLUTION OF THE COUNCIL OF THE CITY OF SACRAMENTO APPROVING AN AGREEMENT FOR LEGAL SERVICES FOR THE PROPOSED TAHOE PARK 5 STREET LIGHTING ASSESSMENT DISTRICT NO. 2003-07

BE IT RESOLVED BY THE COUNCIL OF THE CITY OF SACRAMENTO that this Council approves that certain Agreement for Legal Services dated December 16, 2003, between the City of Sacramento (the "City") and Orrick, Herrington & Sutcliffe LLP, marked Exhibit A and attached hereto and incorporated herein, for services of that firm as Special Bond Counsel to the City for the proposed Tahoe Park 5 Street Lighting Assessment District No. 2003-07, and the City Treasurer of the City is authorized to sign the agreement and the Interim City Clerk of the City is authorized to attest such execution.

APPROVED:

Mayor

ATTEST:

City Clerk

FOR CITY CLERK USE ONLY

RESOLUTION NO.: _____

DATE ADOPTED: _____

**ENGINEERS REPORT
TAHOE PARK 5 STREET LIGHTING ASSESSMENT DISTRICT NO. 2003-07**

The undersigned respectfully submits the enclosed report as directed by the City Council.

Dated: December 16, 2003

Public Works Director
City of Sacramento

By: _____

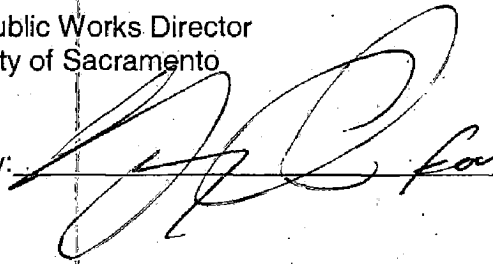

I HEREBY CERTIFY that the enclosed Engineers Report together with Assessment and Assessment Diagram thereto attached, was filed with me on the 16th day of December, 2003.

Virginia K. Henry, Interim City Clerk
City of Sacramento, Sacramento County, California

By: _____

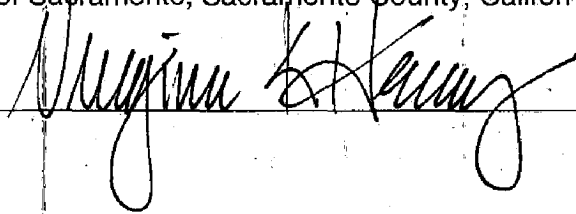

I HEREBY CERTIFY that the enclosed Engineers Report, together with Assessment and Assessment Diagram thereto attached, was approved and confirmed by the City Council of the City of Sacramento, California, on the _____ day of _____, 2004.

City Clerk
City of Sacramento, Sacramento County, California

By: _____

I HEREBY CERTIFY that the enclosed Engineers Report, together with Assessment and Assessment Diagram thereto attached, was recorded in my office on the _____ day of _____, 2004.

Superintendent of Streets
City of Sacramento

By: _____

**ENGINEERS REPORT
TAHOE PARK 5 STREET LIGHTING ASSESSMENT DISTRICT NO. 2003-07**

Gary R. Alm, Engineer of Work for the Tahoe Park 5 Street Lighting Assessment District No. 2003-07, City of Sacramento, County of Sacramento, State of California, makes this report, as directed by the City Council pursuant to Section 10204 of the California Streets and Highways Code (Municipal Improvement Act of 1913).

The improvements which are subject of this report are briefly described as follows:

The construction and installation of a complete high pressure sodium ornamental street lighting system together with all necessary appurtenances thereto on Broadway Boulevard and 8th Avenue from 60th Street to 65th Street; on 60th Street, Perkyman Way, 61st Street, 62nd Street, 63rd Street, 64th Street, Kroy Way, and 65th Street, from 8th Avenue to Broadway Boulevard.

Serial bonds representing unpaid assessments, and bearing interest at a rate not to exceed six and one half percent (6.5%) per annum, shall be issued in the manner provided by the Improvement Bond Act of 1915 (Division 10, California Streets and Highways Code), and the last installment of the bonds shall mature fourteen (15) years from the second day of September next succeeding twelve (12) months from their date.

This report includes the following attached exhibits:

- EXHIBIT A: Plans and specifications are a part of this report whether or not separately bound.
- EXHIBIT B: An estimate of the cost of improvements.
-
- EXHIBIT C: An assessment roll showing the amount proposed to be specially assessed against each parcel of real property within this assessment district. Each parcel is described by County Assessors parcel number and each parcel is also assigned a separate "assessment number" for the purposes of this proceeding.
- EXHIBIT D: A statement of the method by which the undersigned determined the amount proposed to be assessed against each parcel, based on benefits to be derived by each parcel, respectively, from the improvements.
- EXHIBIT E: A list of the names and addresses of the owners of real property within this assessment district, as shown on the last equalized assessment roll for taxes, or as known to the Clerk. The list is keyed to Exhibit C by assessment number.
- EXHIBIT F: A diagram showing all of the parcels of real property within this maintenance district. The diagram is keyed to Exhibit C by assessment number.

Respectfully submitted,
Gary R. Alm, Engineer of Work
City of Sacramento, Sacramento County, State of California

EXHIBIT A

PLANS AND SPECIFICATIONS

PART OF THIS REPORT ARE ON FILE WITH

PROJECT DELIVERY DIVISION

PUBLIC WORKS DEPARTMENT

CITY OF SACRAMENTO

EXHIBIT B

**Tahoe Park 5 Street Lighting Assessment District
Estimate of Cost**

| | | |
|-----------------------------|-------------------|---------------------------|
| Construction Costs | | \$430,050.00 |
| Engineering | | \$75,500.00 |
| Contingencies | | <u>\$30,000.00</u> |
| Subtotal Construction | | \$535,550.00 |
| Incidentals | | |
| Official Statement | \$0.00 | |
| City Attorney | \$7,000.00 | |
| Special Districts | \$25,000.00 | |
| City Treasurer | \$10,000.00 | |
| Bond Printng | \$10,000.00 | |
| Bond Reg & Admin | \$14,000.00 | |
| CDIAC | \$0.00 | |
| Bond Counsel | \$30,000.00 | |
| Bond Counsel out of Pocket | \$2,500.00 | |
| SDIRS | <u>\$6,920.11</u> | |
| Sub Total | | \$105,420.11 |
| Contributions | | |
| Match Program | | <u>306,400.00</u> |
| Project Costs | | \$334,570.11 |
| Reserve Acct. | 6.00% | <u>\$23,520.65</u> |
| Total Expenditures | | \$358,090.76 |
| Bond Discount (\$30,000+1%) | | <u><u>\$33,920.11</u></u> |
| Total Bond Cost | | \$392,010.87 |

EXHIBIT C

**Tahoe Park West Street Lighting Assessment District No. 2003-06
Assessment Roll**

| Assessment Number | Amount | Parcel Description |
|----------------------|------------|-----------------------|
| 1 | \$1,726.93 | 011-0306-018 |
| 2 | \$1,726.93 | 011-0306-017 |
| 3 | \$1,726.93 | 011-0306-016 |
| 4 | \$1,726.92 | 011-0306-015 |
| 5 | \$1,726.92 | 011-0306-014 |
| 6 | \$1,726.92 | 011-0312-032 |
| 7 | \$1,726.92 | 011-0312-031 |
| 8 | \$1,726.92 | 011-0312-030 |
| 9 | \$1,726.92 | 011-0312-029 |
| 10 | \$1,726.92 | 011-0312-028 |
| 11 | \$1,726.92 | 011-0312-027 |
| 12 | \$1,726.92 | 011-0312-026 |
| 13 | \$1,726.92 | 011-0312-025 |
| 14 | \$1,726.92 | 011-0312-024 |
| 15 | \$1,726.92 | 011-0312-023 |
| 16 | \$1,726.92 | 011-0312-022 |
| 17 | \$1,726.92 | 011-0312-021 |
| 18 | \$1,726.92 | 011-0312-020 |
| 19 | \$1,726.92 | 011-0312-019 |
| 20 | \$1,726.92 | 011-0312-018 |
| 21 | \$3,453.84 | 011-0321-020 |
| 22 | \$1,726.92 | 015-0091-055 |
| 23 | \$1,726.92 | 015-0084-004 |
| 24 | \$1,726.92 | 015-0084-001 |
| 25 | \$1,726.92 | 015-0083-006 |
| 26 | \$1,726.92 | 015-0083-005 |
| 27 | \$1,726.92 | 015-0083-004 |
| 28 | \$1,726.92 | 015-0083-003 |
| 29 | \$1,726.92 | 015-0083-002 |
| 30 | \$1,726.92 | 015-0083-001 |
| 31 | \$1,726.92 | 015-0082-006 |
| 32 | \$1,726.92 | 015-0082-005 |
| 33 | \$1,726.92 | 015-0082-004 |
| 34 | \$1,726.92 | 015-0082-003 |
| 35 | \$1,726.92 | 015-0082-002 |
| 36 | \$1,726.92 | 015-0082-001 |
| 37 | \$1,726.92 | 015-0081-003 |
| 38 | \$1,726.92 | 015-0081-002 |
| 39 | \$1,726.92 | 015-0081-001 |
| 40 | \$1,726.92 | 015-0075-002 |
| 41 | \$1,726.92 | 015-0075-001 |
| 42 | \$1,726.92 | 015-0075-003 |
| 43 | \$1,726.92 | 015-0074-003 |
| 44 | \$1,726.92 | 015-0074-002 |
| 45 | \$1,726.92 | 015-0074-001 |
| 46 | \$1,726.92 | 015-0073-001 |
| 47 | \$1,726.92 | 015-0073-022 |
| 48 | \$1,726.92 | 015-0072-001 |
| 49 | \$1,726.92 | 015-0072-021 |
| 50 | \$1,726.92 | 015-0072-020 |
| 51 | \$1,726.92 | 015-0072-002 |
| 52 | \$1,726.92 | 015-0073-021 |

EXHIBIT C
Tahoe Park West Street Lighting Assessment District No. 2003-06
Assessment Roll

| Assessment Number | Amount | Parcel Description |
|----------------------|------------|-----------------------|
| 53 | \$1,726.92 | 015-0073-002 |
| 54 | \$1,726.92 | 015-0074-021 |
| 55 | \$5,180.76 | 015-0091-057 |
| 56 | \$1,726.92 | 015-0084-005 |
| 57 | \$1,726.92 | 015-0084-024 |
| 58 | \$1,726.92 | 015-0083-007 |
| 59 | \$1,726.92 | 015-0083-026 |
| 60 | \$1,726.92 | 015-0082-007 |
| 61 | \$1,726.92 | 015-0082-026 |
| 62 | \$1,726.92 | 015-0081-004 |
| 63 | \$1,726.92 | 015-0075-004 |
| 64 | \$1,726.92 | 015-0075-005 |
| 65 | \$3,453.84 | 015-0074-004 |
| 66 | \$1,726.92 | 015-0074-020 |
| 67 | \$1,726.92 | 015-0073-003 |
| 68 | \$1,726.92 | 015-0073-020 |
| 69 | \$1,726.92 | 015-0072-003 |
| 70 | \$1,726.92 | 015-0072-019 |
| 71 | \$1,726.92 | 015-0072-018 |
| 72 | \$1,726.92 | 015-0072-004 |
| 73 | \$1,726.92 | 015-0073-019 |
| 74 | \$1,726.92 | 015-0073-004 |
| 75 | \$1,726.92 | 015-0074-019 |
| 76 | \$1,726.92 | 015-0075-006 |
| 77 | \$1,726.92 | 015-0081-005 |
| 78 | \$1,726.92 | 015-0082-025 |
| 79 | \$1,726.92 | 015-0082-008 |
| 80 | \$1,726.92 | 015-0083-025 |
| 81 | \$1,726.92 | 015-0083-008 |
| 82 | \$1,726.92 | 015-0084-023 |
| 83 | \$1,726.92 | 015-0084-006 |
| 84 | \$1,726.92 | 015-0084-007 |
| 85 | \$1,726.92 | 015-0084-022 |
| 86 | \$1,726.92 | 015-0083-009 |
| 87 | \$1,726.92 | 015-0083-024 |
| 88 | \$1,726.92 | 015-0082-009 |
| 89 | \$1,726.92 | 015-0082-024 |
| 90 | \$1,726.92 | 015-0081-006 |
| 91 | \$1,726.92 | 015-0075-013 |
| 92 | \$1,726.92 | 015-0074-005 |
| 93 | \$1,726.92 | 015-0074-018 |
| 94 | \$1,726.92 | 015-0073-005 |
| 95 | \$1,726.92 | 015-0073-018 |
| 96 | \$1,726.92 | 015-0072-005 |
| 97 | \$1,726.92 | 015-0072-017 |
| 98 | \$1,726.92 | 015-0072-016 |
| 99 | \$1,726.92 | 015-0072-006 |
| 100 | \$1,726.92 | 015-0073-017 |
| 101 | \$1,726.92 | 015-0073-006 |
| 102 | \$1,726.92 | 015-0074-017 |
| 103 | \$1,726.92 | 015-0074-006 |
| 104 | \$1,726.92 | 015-0075-014 |

EXHIBIT C
Tahoe Park West Street Lighting Assessment District No. 2003-06
Assessment Roll

| Assessment Number | Amount | Parcel Description |
|----------------------|------------|-----------------------|
| 105 | \$1,726.92 | 015-0081-007 |
| 106 | \$1,726.92 | 015-0082-023 |
| 107 | \$1,726.92 | 015-0082-010 |
| 108 | \$1,726.92 | 015-0083-023 |
| 109 | \$1,726.92 | 015-0083-010 |
| 110 | \$1,726.92 | 015-0084-021 |
| 111 | \$1,726.92 | 015-0084-008 |
| 112 | \$3,453.84 | 015-0091-020 |
| 113 | \$1,726.92 | 015-0084-009 |
| 114 | \$1,726.92 | 015-0084-020 |
| 116 | \$1,726.92 | 015-0083-011 |
| 117 | \$1,726.92 | 015-0083-022 |
| 118 | \$1,726.92 | 015-0082-011 |
| 119 | \$1,726.92 | 015-0082-022 |
| 120 | \$1,726.92 | 015-0081-008 |
| 121 | \$1,726.92 | 015-0074-007 |
| 122 | \$1,726.92 | 015-0074-016 |
| 123 | \$1,726.92 | 015-0073-007 |
| 124 | \$1,726.92 | 015-0073-016 |
| 125 | \$1,726.92 | 015-0072-007 |
| 126 | \$1,726.92 | 015-0072-015 |
| 127 | \$1,726.92 | 015-0072-014 |
| 128 | \$1,726.92 | 015-0072-008 |
| 129 | \$1,726.92 | 015-0073-015 |
| 130 | \$1,726.92 | 015-0073-008 |
| 131 | \$1,726.92 | 015-0074-015 |
| 132 | \$1,726.92 | 015-0074-008 |
| 133 | \$1,726.92 | 015-0075-008 |
| 134 | \$1,726.92 | 015-0075-009 |
| 135 | \$1,726.92 | 015-0081-009 |
| 136 | \$1,726.92 | 015-0081-010 |
| 137 | \$1,726.92 | 015-0082-021 |
| 138 | \$1,726.92 | 015-0082-020 |
| 139 | \$1,726.92 | 015-0082-012 |
| 140 | \$1,726.92 | 015-0082-013 |
| 141 | \$1,726.92 | 015-0083-021 |
| 142 | \$1,726.92 | 015-0083-020 |
| 143 | \$1,726.92 | 015-0083-012 |
| 144 | \$1,726.92 | 015-0083-013 |
| 145 | \$1,726.92 | 015-0084-019 |
| 146 | \$1,726.92 | 015-0084-018 |
| 147 | \$1,726.92 | 015-0084-010 |
| 148 | \$1,726.92 | 015-0084-011 |
| 149 | \$1,726.92 | 015-0176-001 |
| 150 | \$1,726.92 | 015-0171-022 |
| 151 | \$1,726.92 | 015-0084-012 |
| 152 | \$1,726.92 | 015-0084-017 |
| 153 | \$1,726.92 | 015-0083-014 |
| 154 | \$1,726.92 | 015-0083-019 |
| 155 | \$1,726.92 | 015-0082-014 |
| 156 | \$1,726.92 | 015-0082-019 |
| 157 | \$1,726.92 | 015-0081-011 |

EXHIBIT C
Tahoe Park West Street Lighting Assessment District No. 2003-06
Assessment Roll

| Assessment Number | Amount | Parcel Description |
|----------------------|-------------|-----------------------|
| 158 | \$1,726.92 | 015-0075-010 |
| 159 | \$1,726.92 | 015-0074-009 |
| 160 | \$1,726.92 | 015-0074-014 |
| 161 | \$1,726.92 | 015-0073-009 |
| 162 | \$1,726.92 | 015-0073-014 |
| 163 | \$1,726.92 | 015-0072-009 |
| 164 | \$1,726.92 | 015-0072-013 |
| 165 | \$1,726.92 | 015-0072-010 |
| 166 | \$1,726.92 | 015-0073-013 |
| 167 | \$1,726.92 | 015-0073-010 |
| 168 | \$1,726.92 | 015-0074-013 |
| 169 | \$1,726.92 | 015-0074-010 |
| 170 | \$1,726.92 | 015-0075-011 |
| 171 | \$1,726.92 | 015-0081-012 |
| 172 | \$1,726.92 | 015-0082-018 |
| 173 | \$1,726.92 | 015-0082-015 |
| 174 | \$1,726.92 | 015-0083-018 |
| 175 | \$1,726.92 | 015-0083-015 |
| 176 | \$1,726.92 | 015-0084-016 |
| 177 | \$1,726.92 | 015-0084-013 |
| 178 | \$1,726.92 | 015-0171-001 |
| 179 | \$1,726.92 | 015-0084-014 |
| 180 | \$1,726.92 | 015-0084-015 |
| 181 | \$1,726.92 | 015-0083-016 |
| 182 | \$1,726.92 | 015-0083-017 |
| 183 | \$1,726.92 | 015-0082-029 |
| 184 | \$1,726.92 | 015-0082-030 |
| 185 | \$1,726.92 | 015-0082-027 |
| 186 | \$1,726.92 | 015-0082-028 |
| 187 | \$1,726.92 | 015-0081-016 |
| 188 | \$1,726.92 | 015-0075-012 |
| 189 | \$1,726.92 | 015-0074-011 |
| 190 | \$1,726.92 | 015-0074-012 |
| 191 | \$1,726.92 | 015-0073-011 |
| 192 | \$1,726.92 | 015-0073-012 |
| 193 | \$1,726.92 | 015-0151-004 |
| 194 | \$1,726.92 | 015-0152-001 |
| 195 | \$1,726.92 | 015-0161-001 |
| 196 | \$1,726.92 | 015-0162-012 |
| 197 | \$1,726.92 | 015-0162-001 |
| 198 | \$1,726.92 | 015-0165-019 |
| 199 | \$1,726.92 | 015-0165-001 |
| 200 | \$1,726.92 | 015-0166-014 |
| 201 | \$1,726.92 | 015-0166-001 |
| 202 | \$1,726.92 | 015-0072-011 |
| 203 | \$1,726.92 | 015-0072-012 |
| 204 | \$15,542.28 | 015-0151-003 |
| 205 | \$18,996.12 | 015-0071-001 |

EXHIBIT D

TAHOE PARK 5 STREET LIGHTING ASSESSMENT DISTRICT NO. 2003-07 METHOD OF SPREAD

The following describes the proposed method of spreading assessments for the Tahoe Park 5 Street Lighting Assessment District No. 2003-07, City of Sacramento, County of Sacramento, State of California.

Typically, a residential street lighting district has lots nearly all the same size and each parcel within that district is assessed the same amount whether they are a corner lot or an interior lot. This district has a small number of lots that are significantly larger than most lots. For this district it has been determined that the average lot size is 60 feet wide.

The cost of improvements is assessed to each "benefiting unit" in proportion to the total number of "benefiting units" in the district.

A "benefiting unit" is defined as follows:

A "benefiting unit" is determined to be a lot that is 60 feet wide or any lot less than 90 feet wide. To determine how many "benefiting units" a lot has that is 90 feet or over the following formula is applied: Lot width divided by 60 feet equals number of "benefited units" rounded to the nearest whole number.

EXHIBIT E
Tahoe Park West Street Lighting Assessment District No. 2003-06
Mailing List

| Assessment Number | Owners Name | Address | | | |
|-------------------|--------------------------------------|--------------------|-----------------|----|-------|
| 1 | Sanders Jr., Bobby & Janice A | 5931 Broadway | Sacramento | CA | 95820 |
| 2 | Jagelka, Kimberly A | 6001 Broadway | Sacramento | CA | 95820 |
| 3 | Bacchi, Steven P & Sandra L | 6011 Broadway | Sacramento | CA | 95820 |
| 4 | Petrali, Michael R & Evelyn D | 6017 Broadway | Sacramento | CA | 95820 |
| 5 | Farmer, Anthony J | 2147 Larchmont Cir | Fairfield | CA | 94534 |
| 6 | Davis, Alice L | 2911 61st St | Sacramento | CA | 95817 |
| 7 | Mihalus, Robert W & Nitza | 4912 Knights Way | Rocklin | CA | 95765 |
| 8 | Wolfe, Jacque D & Sheena | 6131 Broadway | Sacramento | CA | 95820 |
| 9 | Gomez, Joseph A & Josephine | 6143 Broadway | Sacramento | CA | 95820 |
| 10 | Hale, Judith | 6163 Broadway | Sacramento | CA | 95820 |
| 11 | Maynes, Sonya M | 6183 Broadway | Sacramento | CA | 95820 |
| 12 | Bratager, Ruby L | 6203 Broadway | Sacramento | CA | 95820 |
| 13 | RAMUS WANDA A & RAMUS | 6211 Broadway | Sacramento | CA | 95820 |
| 14 | BARNES INELL M & BARNES | 1393 Donna St | Novato | CA | 94947 |
| 15 | Alford, Patricia H | 6229 Broadway | Sacramento | CA | 95820 |
| 16 | Doyle, Joy Marie | 1310 Noonan Dr | Sacramento | CA | 95822 |
| 17 | Bonnifield, Lucinda L E & Mark | 6247 Broadway | Sacramento | CA | 95820 |
| 18 | Borowski, Paul M & Angela K | 6255 Broadway | Sacramento | CA | 95820 |
| 19 | Epps, Elysyne | 6261 Broadway | Sacramento | CA | 95820 |
| 20 | Jacobs, Jan M | 6269 Broadway | Sacramento | CA | 95820 |
| 21 | FRANK E GONZALES BROADWAY | 6341 Broadway | Sacramento | CA | 95820 |
| 22 | FONG PAUL E & MAE & KCMKC PROP | 3009 65th St | Sacramento | CA | 95820 |
| 23 | GARCIA | 8350 Stevenson Ave | Sacramento | CA | 95828 |
| 24 | Verdolino, Lucille C | 6460 Broadway | Sacramento | CA | 95820 |
| 25 | Donnelly, John | 9473 Mainline Dr | Elk Grove | CA | 95624 |
| 26 | Costa, John P & Linda S | 6446 Broadway | Sacramento | CA | 95820 |
| 27 | Rombaoa, Robert Craig | 6432 Broadway | Sacramento | CA | 95820 |
| 28 | Howes, William L & Loretta L | 6424 Broadway | Sacramento | CA | 95820 |
| 29 | West, Heidi J & D Wilkinson Christop | 6418 Broadway | Sacramento | CA | 95820 |
| 30 | Montez, Christine & Richard D | 6400 Broadway | Sacramento | CA | 95820 |
| 31 | Dahl, Jeffrey R & Nancy J | 6390 Broadway | Sacramento | CA | 95820 |
| 32 | PLATTOR | 3563 Santos Cir | Cameron Park | CA | 95682 |
| 33 | HUIZAR | 6352 Broadway | Sacramento | CA | 95820 |
| 34 | Villagran, Julie | 6330 Broadway | Sacramento | CA | 95820 |
| 35 | Harris, Cordia N | 6318 Broadway | Sacramento | CA | 95820 |
| 36 | Seymour, Kevin Eugene | PO Box 3321 | Santa Rosa | CA | 95402 |
| 37 | Ortiz-Hutson, John | 6292 Broadway | Sacramento | CA | 95820 |
| 38 | Hernandez, Juan M & Vangie Guajardo | 6280 Broadway | Sacramento | CA | 95820 |
| 39 | CARVALHO-LEHMANN | 6274 Broadway | Sacramento | CA | 95820 |
| 40 | Dubois, Gary John & Connie | 6206 Broadway | Sacramento | CA | 95820 |
| 41 | Moore, Ellis F & Carol R | 3001 62nd St | Sacramento | CA | 95820 |
| 42 | McLean, Shu Ying & Ying Lee Tsien | 3027 62nd St | Sacramento | CA | 95820 |
| 43 | Alley, Joel C | 1701 53rd St | Sacramento | CA | 95819 |
| 44 | Eisner, Lawrence Kenneth & Karen S | PO Box 576 | Shingle Springs | CA | 95682 |
| 45 | MARIE ANNA LAMANNO | 3001 61st St | Sacramento | CA | 95820 |
| 46 | Guidaboni, Cheri A | 3000 61st St | Sacramento | CA | 95820 |
| 47 | BARBARA JEAN BAKER | 3001 Perryman Way | Sacramento | CA | 95820 |
| 48 | Fleming, Michael | 3000 Perryman Way | Sacramento | CA | 95820 |
| 49 | Mailhot, Henry & Cheri | 3001 60th St | Sacramento | CA | 95820 |
| 50 | Vuletich, Ann Teresa & Ralph Clark | 3418 N St | Sacramento | CA | 95816 |
| 51 | Rios, Russell C & Ruth D | 3008 Perryman Way | Sacramento | CA | 95820 |
| 52 | Kenneth, A & I Mongeau 2000 Revoc | 3007 Perryman Way | Sacramento | CA | 95820 |

EXHIBIT E
Tahoe Park West Street Lighting Assessment District No. 2003-06
Mailing List

| Assessment Number | Owners Name | Address | | |
|----------------------|---|-----------------------|-------------|----------|
| 53 | MARIAN G CONWAY | 3008 61st St | Sacramento | CA 95820 |
| 54 | Oetting, Carol A | 3007 61st St | Sacramento | CA 95820 |
| 55 | FONG PAUL E & MAE & KCMKC PROP | 3009 65th St | Sacramento | CA 95820 |
| 56 | GARCIA | 8350 Stevenson Ave | Sacramento | CA 95828 |
| 57 | LYALL L DOLL | 3021 Kroy Way | Sacramento | CA 95820 |
| 58 | MICHAEL THOMAS MULCAHY | 307 Fitchburg Sq | Folsom | CA 95630 |
| 59 | WASHINGTON MUTUAL BANK | 9451 Corbin Ave | Northridge | CA 91324 |
| 60 | Thomas, Cheri | 3020 64th St | Sacramento | CA 95820 |
| 61 | Ferguson, Wes & Cindy | 821 La Goleta Way | Sacramento | CA 95864 |
| 62 | Carol, A Simpson & H Williams Tru Dougl | 485 Summit Springs Rd | Woodside | CA 94062 |
| 63 | Eggleston, Christopher | 3029 62nd St | Sacramento | CA 95820 |
| 64 | Vasquez, Charlie C & Patricia M | 3101 62nd St | Sacramento | CA 95820 |
| 65 | Pritchard, Gary & Carol | 3886 12th St | Sacramento | CA 95822 |
| 66 | Solomon, Alison R & J Farrell Carol | 3019 61st St | Sacramento | CA 95820 |
| 67 | Tansey, Richard L & Muriel H & Tr | 6325 Reservoir Dr | Granite Bay | CA 95746 |
| 68 | Scott, Farrell | 3019 Perryman Way | Sacramento | CA 95820 |
| 69 | Harrington, Kimberley C | 3020 Perryman Way | Sacramento | CA 95820 |
| 70 | Bird, Carol A | PO Box 1251 | Carmichael | CA 95609 |
| 71 | Smith, Phillip A & Shasta A | 3033 60th St | Sacramento | CA 95820 |
| 72 | Martin, Josephine | 3034 Perryman Way | Sacramento | CA 95820 |
| 73 | Jacobson, Joann Leah | 3033 Perryman Way | Sacramento | CA 95820 |
| 74 | Wynn, Susan K | 3034 61st St | Sacramento | CA 95820 |
| 75 | Neumann, Diane L | 3033 61st St | Sacramento | CA 95820 |
| 76 | Vasquez, Charlie C & Patricia M | 3101 62nd St | Sacramento | CA 95820 |
| 77 | Lloyd, Douglas R & Twila M | 3040 63rd St | Sacramento | CA 95820 |
| 78 | Gillock, Coby & Laura | 3041 63rd St | Sacramento | CA 95820 |
| 79 | Cole, Marcy | 3040 64th St | Sacramento | CA 95820 |
| 80 | Perez, Graciela & Jesus | 3041 64th St | Sacramento | CA 95820 |
| 81 | Greenberg, Max M | 3040 Kroy Way | Sacramento | CA 95820 |
| 82 | Roina, Don P & Robert A | 3041 Kroy Way | Sacramento | CA 95820 |
| 83 | FRANK R PIAGGI | 3201 Walnut Ave | Carmichael | CA 95608 |
| 84 | Ong, Kanman & Waltman | 7448 Mooncrest Way | Sacramento | CA 95831 |
| 85 | Wyatt, June L | 3061 Kroy Way | Sacramento | CA 95820 |
| 86 | Williams Sr., Richard Y & Sandra K | 3060 Kroy Way | Sacramento | CA 95820 |
| 87 | Gilleran, Thelma E | 3061 64th St | Sacramento | CA 95820 |
| 88 | Matulich, Daniel & Claudine | 1240 Boot Hill Ln | Newcastle | CA 95658 |
| 89 | Herman, Marcie A | 3061 63rd St | Sacramento | CA 95820 |
| 90 | Thompson, Jerome A & Patricia A | 3048 63rd St | Sacramento | CA 95820 |
| 91 | Flores, Rachel M | 3109 62nd St | Sacramento | CA 95820 |
| 92 | Clarkson, Elizabeth | 3108 62nd St | Sacramento | CA 95820 |
| 93 | Webster, Maurice C & Marjorie | 3101 61st St | Sacramento | CA 95820 |
| 94 | Massello, Martin N & Annette A | 3100 61st St | Sacramento | CA 95820 |
| 95 | COZZBERG MERLE | 3940 K St | Sacramento | CA 95816 |
| 96 | Mahoney, Howard S & Kimberly C | 3100 Perryman Way | Sacramento | CA 95820 |
| 97 | Colla, Wade C | 3101 60th St | Sacramento | CA 95820 |
| 98 | THOMAS A & MONICA L FLOOD | 3111 60th St | Sacramento | CA 95820 |
| 99 | Lochridge, Kaye | 3112 Perryman Way | Sacramento | CA 95820 |
| 100 | Jonas, Christine | 3111 Perryman Way | Sacramento | CA 95820 |
| 101 | Norton, Debra M | 3112 61st St | Sacramento | CA 95820 |
| 102 | Soderberg, Janice | 3111 61st St | Sacramento | CA 95820 |
| 103 | Lotze, Julia | 3120 62nd St | Sacramento | CA 95820 |
| 104 | Vasquez, Hope | 3127 62nd St | Sacramento | CA 95820 |

EXHIBIT E
Tahoe Park West Street Lighting Assessment District No. 2003-06
Mailing List

| Assessment Number | Owners Name | Address | | | |
|-------------------|---|----------------------|------------|----|-------|
| 105 | Hurley, Robert Michael & Mc Nall Margaret | 3530 El Ricon Way | Sacramento | CA | 95864 |
| 106 | Freitag, Russell A & Susan C | 3101 63rd St | Sacramento | CA | 95820 |
| 107 | Brooks, Jeffery L | 3100 64th St | Sacramento | CA | 95820 |
| 108 | Febbo, John F | 3101 64th St | Sacramento | CA | 95820 |
| 109 | Dauenhauer, Daniel T | 3301 Watt Ave #600 | Sacramento | CA | 95821 |
| 110 | Clamurro, Lori E | 3101 Kroy Way | Sacramento | CA | 95820 |
| 111 | Herrmann, Eric | 3100 65th St | Sacramento | CA | 95820 |
| 112 | HORTON MARIE E | 1965 Casterbridge Dr | Roseville | CA | 95747 |
| 113 | Bradbury, Verne J | 4410 73rd St | Sacramento | CA | 95820 |
| 114 | Hooper, Betty S & Eugene J Gordon | 3119 Kroy Way | Sacramento | CA | 95820 |
| 116 | MacBride, Ronald Charles & Gail M | 3120 Kroy Way | Sacramento | CA | 95820 |
| 117 | Stearns, Terri L | 320 N 10th St #100 | Sacramento | CA | 95814 |
| 118 | Monahan, Monica K | 3120 64th St | Sacramento | CA | 95820 |
| 119 | Hasiuk, Michelle E | 3119 63rd St | Sacramento | CA | 95820 |
| 120 | Torres, Joel | 3120 63rd St | Sacramento | CA | 95820 |
| 121 | Cox, Della L | 3309 64th St | Sacramento | CA | 95820 |
| 122 | Andrews, Gary W & Pamela J | 3119 61st St | Sacramento | CA | 95820 |
| 123 | Kessell, Ferol K | 3894 Terra Vista Way | Sacramento | CA | 95821 |
| 124 | Cervantes, Christina Ann | 3119 Perryman Way | Sacramento | CA | 95820 |
| 125 | THERESA C KRAMER | 2801 Mission Ave | Carmichael | CA | 95608 |
| 126 | Peterson, John A & Lila J | 22 Cadillac Dr | Sacramento | CA | 95825 |
| 127 | STURGES JAY & LINDA | 8795 Ash Hill Ct | Orangevale | CA | 95662 |
| 128 | Alexander, Laurie D | 3200 Perryman Way | Sacramento | CA | 95820 |
| 129 | Mahoney, Howard S & Kimberly C | 3201 Perryman Way | Sacramento | CA | 95820 |
| 130 | Munoz, Robert & Jennifer | 3200 61st St | Sacramento | CA | 95820 |
| 131 | Baumgardner, Ralph E & Pauline V | 3201 61st St | Sacramento | CA | 95820 |
| 132 | Sotolongo, Neva M | 3136 62nd St | Sacramento | CA | 95820 |
| 133 | Meixner, Michael & Margaret | 4371 Myrtle Ave | Sacramento | CA | 95841 |
| 134 | Painter, Steven C | 3814 61st St | Sacramento | CA | 95820 |
| 135 | WILLIAM & EMILIE FRANKS | 3140 63rd St | Sacramento | CA | 95820 |
| 136 | Ramsey, Diana Hesse | 3156 63rd St | Sacramento | CA | 95820 |
| 137 | Brienza, Gary L | 3141 63rd St | Sacramento | CA | 95820 |
| 138 | Taylor, Samuel G | 3157 63rd St | Sacramento | CA | 95820 |
| 139 | RIENHART | 3140 64th St | Sacramento | CA | 95820 |
| 140 | Clements, Cheryl | 3156 64th St | Sacramento | CA | 95820 |
| 141 | Jurin, Sandra L | 5404 O St | Sacramento | CA | 95819 |
| 142 | Patterson, Irene L | 3157 64th St | Sacramento | CA | 95820 |
| 143 | Garcia, Jesse M & Angela G | 3140 Kroy Way | Sacramento | CA | 95820 |
| 144 | BERTHA M MULLENIX HOUSE | 3156 Kroy Way | Sacramento | CA | 95820 |
| 145 | Ferguson, Wes & Cindy | 810 San Ramon Way | Sacramento | CA | 95864 |
| 146 | Scott, Lucinda June | PO Box 246686 | Sacramento | CA | 95824 |
| 147 | Salgado, Rebecca K | 3140 65th St | Sacramento | CA | 95820 |
| 148 | Schuetz, Judith C | 3156 65th St | Sacramento | CA | 95820 |
| 149 | Luscutoff, James A | 2264 Moorbrook Way | Sacramento | CA | 95826 |
| 150 | Williams, James & Roberta V | 8210 Lake Forest Dr | Sacramento | CA | 95826 |
| 151 | Chervanev, Aleksandr & Irina | 3200 65th St | Sacramento | CA | 95820 |
| 152 | Pieri, Erik K | 4590 Roblar Rd | Petaluma | CA | 94952 |
| 153 | Plummer, Ross A | 3200 Kroy Way | Sacramento | CA | 95820 |
| 154 | MILEUSNICH MANOJLO & SAVKA | 3201 64th St | Sacramento | CA | 95820 |
| 155 | Pitzner, Joseph & Shannon | 3200 64th St | Sacramento | CA | 95820 |
| 156 | Turner, Karl L & Dolores R | 3201 63rd St | Sacramento | CA | 95820 |
| 157 | Gentry, Todd L & Elizabeth Cates | 3200 63rd St | Sacramento | CA | 95820 |

EXHIBIT E
Tahoe Park West Street Lighting Assessment District No. 2003-06
Mailing List

| Assessment Number | Owners Name | Address | | |
|----------------------|---|-----------------------|------------|----------|
| 158 | MARJORIE M WALLACE | 1595 Kilaga | Lincoln | CA 95648 |
| 159 | Evans, Brenda L | 3240 62nd St | Sacramento | CA 95820 |
| 160 | MICHAEL THOMAS MULCAHY | 307 Fitchburg Sq | Folsom | CA 95630 |
| 161 | Welch, Philip C | 3208 61st St | Sacramento | CA 95820 |
| 162 | Lao, Juan | 3209 Perryman Way | Sacramento | CA 95820 |
| 163 | Oneal, Lisa & Sean Patrick | 3208 Perryman Way | Sacramento | CA 95820 |
| 164 | FRED H & PATRICIA I RAINEY | 3289 60th St | Sacramento | CA 95820 |
| 165 | Sidhu, Barbara A | 5732 Lonsdale Dr | Sacramento | CA 95822 |
| 166 | Lambert, Brian P & Kathleen A Reynolds | 3217 Perryman Way | Sacramento | CA 95820 |
| 167 | BEN & GERALDINE LOMBARDO | 3216 61st St | Sacramento | CA 95820 |
| 168 | Dillard, Amy A | 1518 Wilton Way | Sacramento | CA 95864 |
| 169 | Lorusso, Robert S | 3232 62nd St | Sacramento | CA 95820 |
| 170 | Spagnolo, August | 3285 62nd St | Sacramento | CA 95820 |
| 171 | LeBlanc, Thomas A & Ruth | 3224 63rd St | Sacramento | CA 95820 |
| 172 | Vercruyssen, Patricia | 3223 63rd St | Sacramento | CA 95820 |
| 173 | Moreno, Esther | 3224 64th St | Sacramento | CA 95820 |
| 174 | Smith, Gene C & Judy C | 6338 Everest Way | Sacramento | CA 95842 |
| 175 | OLIVE R COX | 3224 Kroy Way | Sacramento | CA 95820 |
| 176 | MICHAEL THOMAS MULCAHY | 307 Fitchburg Sq | Folsom | CA 95630 |
| 177 | Blithe, Richard J & Peggy S | 3224 65th St | Sacramento | CA 95820 |
| 178 | Acosta, Florinda & Javier Lopez Francis | 3301 65th St | Sacramento | CA 95820 |
| 179 | Hopkins, Tim | 3246 65th St | Sacramento | CA 95820 |
| 180 | Kelley, Anne L | 3247 Kroy Way | Sacramento | CA 95820 |
| 181 | CECILIA RICHMOND | 3246 Kroy Way | Sacramento | CA 95820 |
| 182 | James, Mark & J Dilley Lynette | 3247 64th St | Sacramento | CA 95820 |
| 183 | Dauenhauer, Daniel T | 3301 Watt Ave #600 | Sacramento | CA 95821 |
| 184 | Dauenhauer, Daniel T | 3301 Watt Ave #600 | Sacramento | CA 95821 |
| 185 | Harris, Jason & Robert J | 3247 63rd St | Sacramento | CA 95820 |
| 186 | Harris, Jason & Robert J | 3247 63rd St | Sacramento | CA 95820 |
| 187 | Camacho, Blanca E & Juventino C | 3248 63rd St | Sacramento | CA 95820 |
| 188 | Weston, Brad & Nancy Weagly | 3293 62nd St | Sacramento | CA 95820 |
| 189 | Adams, Beatrice Lynn Affaint | 2165 Del Norte St | Los Osos | CA 93402 |
| 190 | Elek-Abe, Laura A | 6101 8th Ave | Sacramento | CA 95820 |
| 191 | BERNADETTE T PAULSEN | 5114 Walnut Pointe Ln | Carmichael | CA 95608 |
| 192 | DORIS BERTOLOTTI | 6019 8th Ave | Sacramento | CA 95820 |
| 193 | Koenig, Robert Mark | 6184 8th Ave | Sacramento | CA 95820 |
| 194 | Rowland, Carolynl | 3303 62nd St | Sacramento | CA 95820 |
| 195 | Montiero, Michael D | 3300 63rd St | Sacramento | CA 95820 |
| 196 | Evans, Charles H & Ida Mae & Tr | 3410 Kroy Way | Sacramento | CA 95820 |
| 197 | Crestetto, Alan J & Carol J | 29 Taft Court | Novato | CA 94947 |
| 198 | Franco, Lisa Marie | 3301 64th St | Sacramento | CA 95820 |
| 199 | CHARLES & IDA MAE EVANS | 3410 Kroy Way | Sacramento | CA 95820 |
| 200 | RUPERT & ANNA M CORREA | 3301 Kroy Way | Sacramento | CA 95820 |
| 201 | Estrada, Jose Hernandez & Juanita Herna | 3300 65th St | Sacramento | CA 95820 |
| 202 | Gentry, James William & Kathleen Louis | 6015 8th Ave | Sacramento | CA 95820 |
| 203 | Heikkila, Christine | 6001 8th Ave | Sacramento | CA 95820 |
| 204 | CITY OF SACRAMENTO | 915 I St #200 | Sacramento | CA 95814 |
| 205 | SACTO CITY UNIFIED SCHOOL DIST | 425 1st Ave | Sacramento | CA 95818 |

EXHIBIT F

ASSESSMENT DIAGRAM.
 TAHOE PARK 5 STREET LIGHTING ASSESSMENT DISTRICT
 No. 2003-07
 CITY OF SACRAMENTO
 COUNTY OF SACRAMENTO - STATE OF CALIFORNIA
 SHEET 1 OF 4

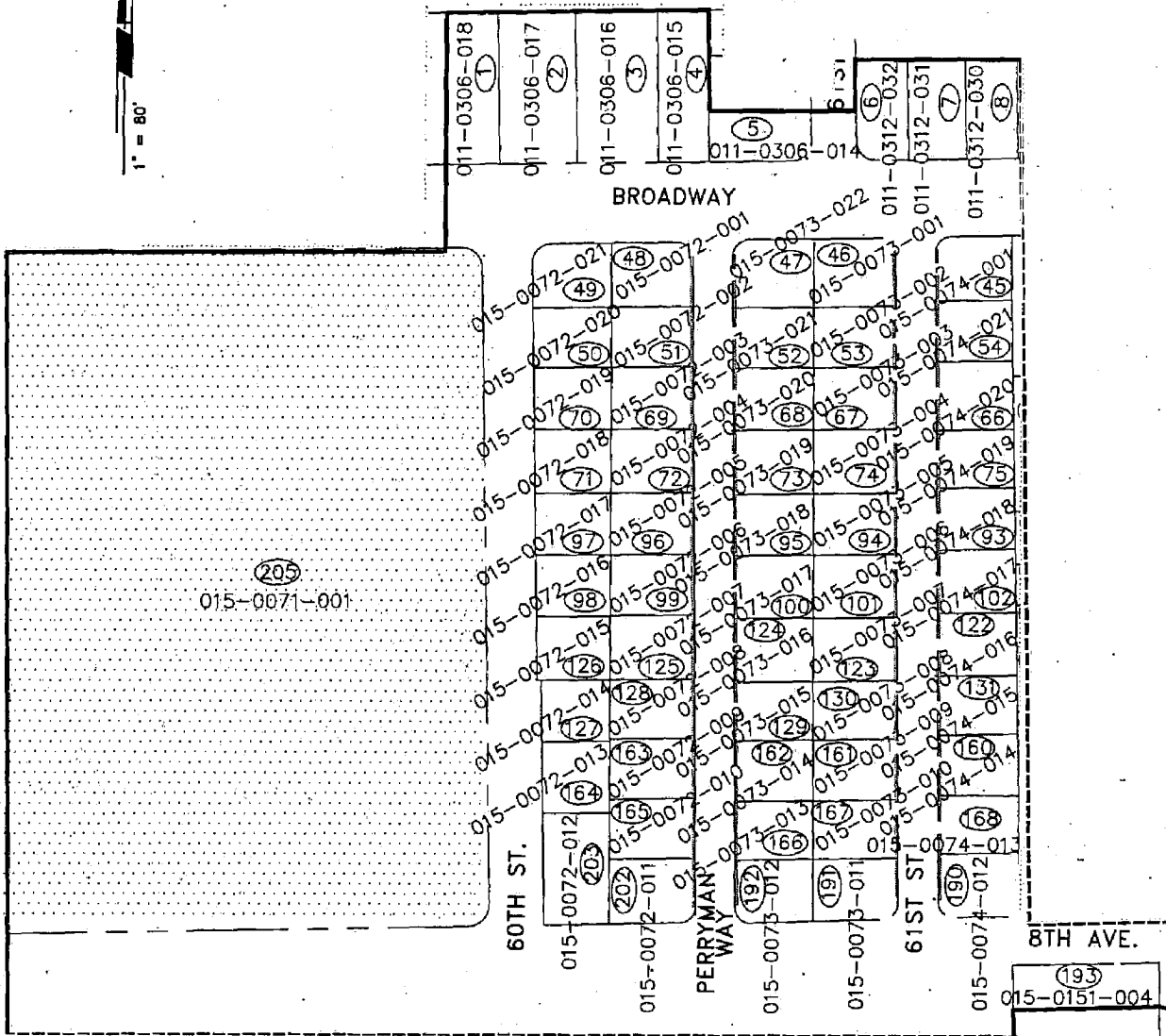

CLERK'S MAP FILING STATEMENT

FILED IN THE OFFICE OF THE CITY CLERK OF THE CITY OF SACRAMENTO, STATE OF CALIFORNIA, THIS _____ DAY OF _____, 2004.

CITY CLERK

SUPERINTENDENT OF STREETS RECORDING STATEMENT:

RECORDED IN THE OFFICE OF THE SUPERINTENDENT OF STREETS OF THE CITY OF SACRAMENTO, COUNTY OF SACRAMENTO, STATE OF CALIFORNIA, THIS _____ DAY OF _____, 2004.

SUPERINTENDENT OF STREET

CLERK MAP CERTIFICATE

ASSESSMENT WAS LEVIED BY THE CITY OF SACRAMENTO OF THE COUNTY OF SACRAMENTO ON THE LOTS SHOWN ON THIS _____ DAY OF _____, 2004. SAID ASSESSMENT DIAGRAM AND THE ASSESSMENT ROLL WERE RECORDED IN THE OFFICE OF THE SUPERINTENDENT OF STREETS OF SAID CITY OF SACRAMENTO ON THE _____ DAY OF _____, 2004. REFERENCE IS MADE TO THE ASSESSMENT ROLL RECORDED IN THE OFFICE OF THE COUNTY SURVEYOR FOR THE EXACT AMOUNT OF EACH ASSESSMENT LEVIED AGAINST EACH PARCEL OF LAND SHOWN ON THIS ASSESSMENT DIAGRAM.

CITY CLERK

COUNTY RECORDER'S FILING STATEMENT

FILED THIS _____ DAY OF _____, 2004, AT THE HOUR OF _____ O'CLOCK _____ M., IN BOOK _____ OF MAPS OF THE ASSESSMENT AND COMMUNITY FACILITIES DISTRICTS AT THE PAGE _____ IN THE OFFICE OF THE COUNTY RECORDER OF THE COUNTY OF SACRAMENTO, STATE OF CALIFORNIA.

COUNTY RECORDER OF THE COUNTY OF SACRAMENTO, CALIFORNIA

DEPUTY

LEGEND:



- ASSESSMENT DISTRICT BOUNDARY
- DISTRICT CONTINUATION LINE TO NEXT PAGE
- [Shaded Box] TAHOE SCHOOL 3110 60TH STREET
- (5) ASSESSMENT NUMBER

THE SACRAMENTO COUNTY ASSESSOR'S MAPS ARE INCORPORATED BY REFERENCE INTO THIS ASSESSMENT DIAGRAM. THE PARCELS FOR THIS DIAGRAM ARE THOSE LINES AND DIMENSIONS SHOWN ON THE ASSESSOR'S MAPS, WHICH ARE ON FILE AND OPEN TO PUBLIC INSPECTION AT THE ASSESSOR'S OFFICE. THE DISTINCTIVE DESIGNATION OF EACH LOT OR PARCEL SHALL BE ITS ASSESSOR'S PARCEL NUMBER.

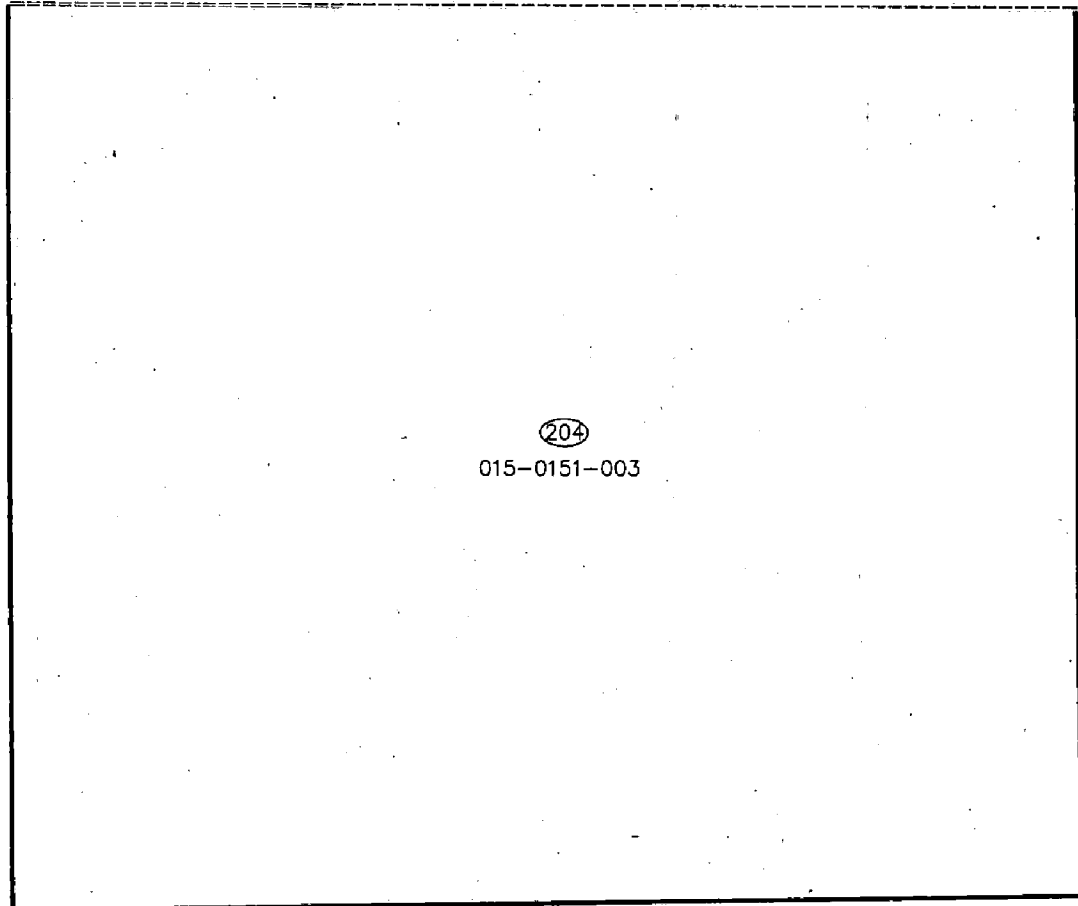
EXHIBIT F
ASSESSMENT DIAGRAM
TAHOE PARK 5 STREET LIGHTING ASSESSMENT DISTRICT
No. 2003-07
CITY OF SACRAMENTO
COUNTY OF SACRAMENTO - STATE OF CALIFORNIA
SHEET 2 OF 4



LEGEND:

-  ASSESSMENT DISTRICT BOUNDARY
-  DISTRICT CONTINUATION LINE TO NEXT PAGE
-  ASSESSMENT NUMBER

THE SACRAMENTO COUNTY ASSESSOR'S MAPS ARE INCORPORATED BY REFERENCE INTO THIS ASSESSMENT DIAGRAM. THE PARCELS FOR THIS DIAGRAM ARE THOSE LINES AND DIMENSIONS SHOWN ON THE ASSESSOR'S MAPS, WHICH ARE ON FILE AND OPEN TO PUBLIC INSPECTION AT THE ASSESSOR'S OFFICE. THE DISTINCTIVE DESIGNATION OF EACH LOT OR PARCEL SHALL BE ITS ASSESSOR'S PARCEL NUMBER.

EXHIBIT F

ASSESSMENT DIAGRAM

TAHOE PARK 5 STREET LIGHTING ASSESSMENT DISTRICT

No. 2003-07



CITY OF SACRAMENTO

COUNTY OF SACRAMENTO - STATE OF CALIFORNIA

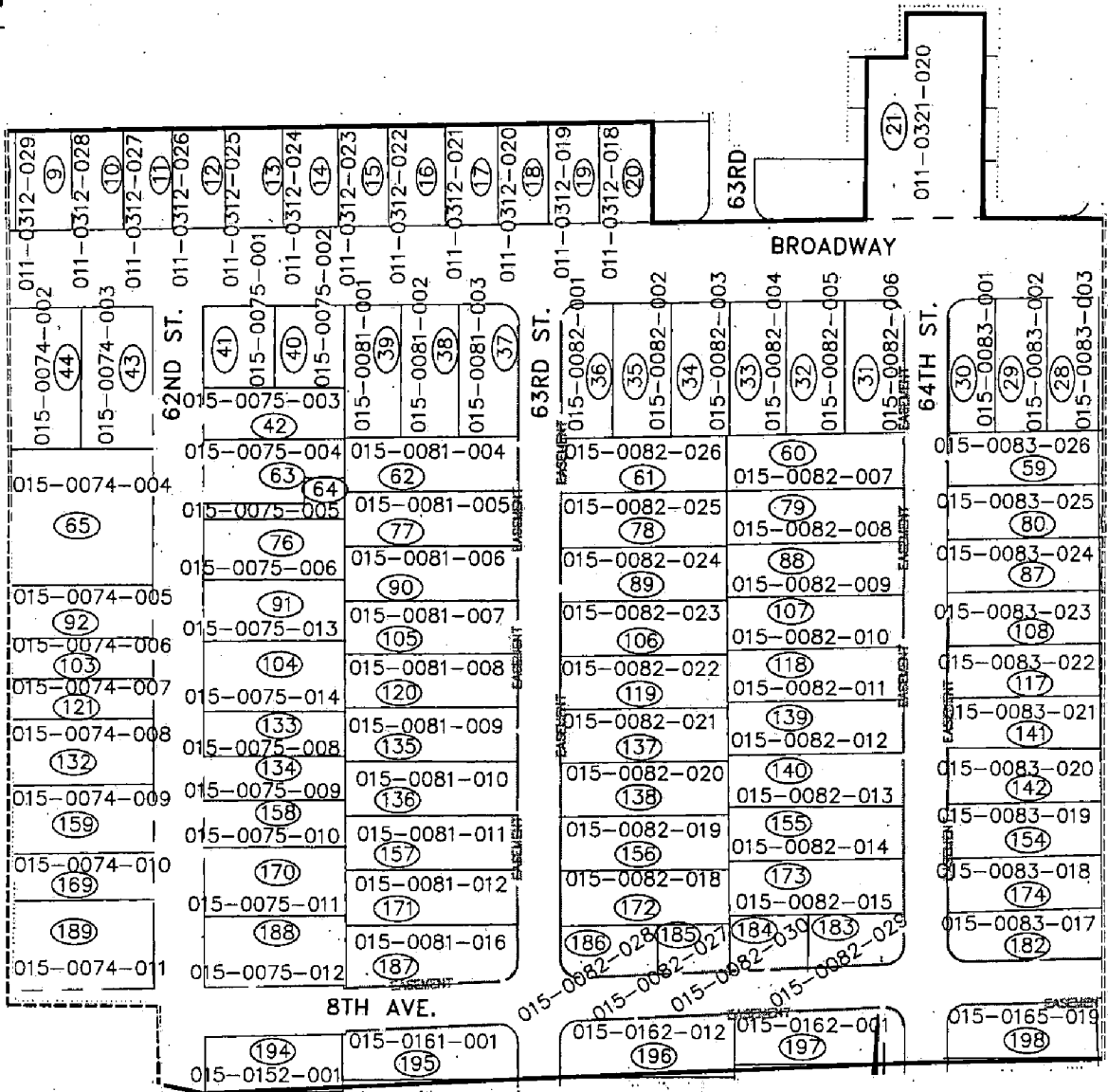
SHEET 3 OF 4



LEGEND:

-  ASSESSMENT DISTRICT BOUNDARY
-  DISTRICT CONTINUATION LINE TO NEXT PAGE
-  ASSESSMENT NUMBER

THE SACRAMENTO COUNTY ASSESSOR'S MAPS ARE INCORPORATED BY REFERENCE INTO THIS ASSESSMENT DIAGRAM. THE PARCELS FOR THIS DIAGRAM ARE THOSE LINES AND DIMENSIONS SHOWN ON THE ASSESSOR'S MAPS, WHICH ARE ON FILE AND OPEN TO PUBLIC INSPECTION AT THE ASSESSOR'S OFFICE. THE DISTINCTIVE DESIGNATION OF EACH LOT OR PARCEL SHALL BE ITS ASSESSOR'S PARCEL NUMBER.

EXHIBIT F

ASSESSMENT DIAGRAM

TAHOE PARK 5 STREET LIGHTING ASSESSMENT DISTRICT

No. 2003-07



CITY OF SACRAMENTO

COUNTY OF SACRAMENTO - STATE OF CALIFORNIA

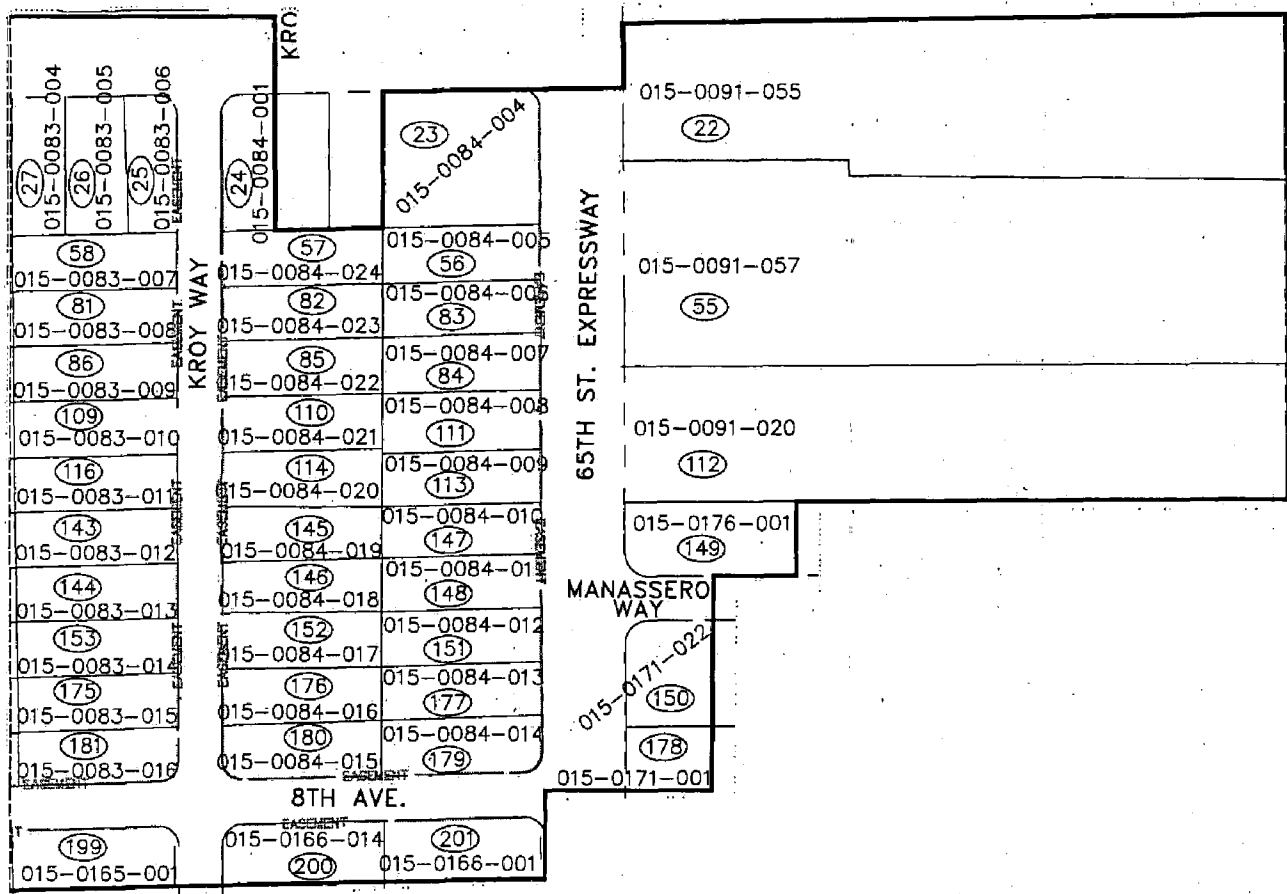
SHEET 4 OF 4



LEGEND:

-  ASSESSMENT DISTRICT BOUNDARY
-  DISTRICT CONTINUATION LINE TO NEXT PAGE
-  ASSESSMENT NUMBER

THE SACRAMENTO COUNTY ASSESSOR'S MAPS ARE INCORPORATED BY REFERENCE INTO THIS ASSESSMENT DIAGRAM. THE PARCELS FOR THIS DIAGRAM ARE THOSE LINES AND DIMENSIONS SHOWN ON THE ASSESSOR'S MAPS, WHICH ARE ON FILE AND OPEN TO PUBLIC INSPECTION AT THE ASSESSOR'S OFFICE. THE DISTINCTIVE DESIGNATION OF EACH LOT OR PARCEL SHALL BE ITS ASSESSOR'S PARCEL NUMBER.

assessment ballot in the form attached hereto, marked "Exhibit B" and by reference incorporated herein and made a part hereof.

Virginia K. Henry
Interim City Clerk of the
City of Sacramento

Subscribed and sworn to before me
this 19th day of December, 2003.
Carolyn E. Hoover

NOTARY PUBLIC
State of California

[Notarial Seal]

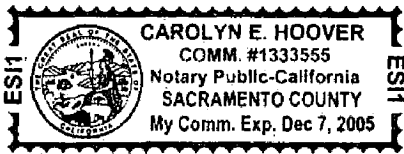

CITY OF SACRAMENTO
TAHOE PARK 5 STREET LIGHTING ASSESSMENT DISTRICT NO. 2003-07

NOTICE OF A PUBLIC HEARING OF PROTESTS TO THE
LEVY OF AN ASSESSMENT AND NOTICE OF THE
ASSESSMENT BALLOT PROCEDURE FOR SUCH
PROPOSED ASSESSMENT

NOTICE IS HEREBY GIVEN that on December 16, 2003, the City Council (the "City Council") of the City of Sacramento (the "City") duly adopted its Resolution of Intention No. 2003-875 (the "Resolution of Intention") wherein it declared its intention to order certain street lighting improvements more particularly described in Exhibit A attached hereto and incorporated herein and made a part hereof to be acquired and constructed by the City for a street lighting assessment district in the City (therein provided for) designated the "Tahoe Park 5 Street Lighting Assessment District No. 2003-07" pursuant to the provisions of the Municipal Improvement Act of 1913 and to issue bonds in such proceedings under the provisions of the Improvement Bond Act of 1915, and further stated that it intended to comply with the requirements of the Special Assessment Investigation, Limitation and Majority Protest Act of 1931 applicable to such proposed assessment district by proceeding under Part 7.5 of such Act.

NOTICE IS HEREBY FURTHER GIVEN that the City Council by the Resolution of Intention referred such street lighting improvements to the City Interim Director of Public Works, as the Engineer of Work (the "Engineer of Work") in such proceedings, and directed the Engineer of Work to prepare a report in compliance with Section 10204 of the Streets and Highways Code containing plans and specifications for such street lighting improvements, together with a general description of the works to be acquired as part of such street lighting improvements and an estimate of the costs and expenses thereof (including authorized funded interest on such bonds), and containing an assessment diagram and a proposed assessment of the portion of the costs and expenses of such street lighting improvements to be levied in such assessment district upon the several parcels of land in such assessment district in proportion to the estimated benefits to be received by each such parcel, respectively, from such street lighting improvements, which assessment was directed to take cognizance of a contribution of \$306,400 from the City from available funds of the City for the payment of the costs and expenses of such street lighting improvements, and further directed the Engineer of Work to include in such report the information required by subsections (b)(1) and (b)(2) of Section 2961 of the Streets and Highways Code, and that the Engineer of Work has determined the assessed valuation of all parcels of land within the assessment district for the 2003-2004 Fiscal Year is not less than \$20,135,111, and that there are no existing unpaid assessments against any of such parcels of land proposed to be assessed; and accordingly that the limitations set forth in Section 2961(d) of the Streets and Highways Code (the "Code") have been satisfied in that the principal sum of all unpaid special assessments levied against the parcels proposed to be assessed, as computed by the Code, plus the proposed amount of the special assessments proposed to be levied in the assessment proceedings, do not exceed one-half of the total value of the parcels proposed to be assessed in the assessment proceedings, as computed by the Code, and has duly prepared and filed his report (the "Engineer's Report") with the Interim City Clerk of

the City, which Engineer's Report was presented to and was preliminarily approved by the City Council by resolution adopted on December 16, 2003.

NOTICE IS HEREBY FURTHER GIVEN that Tuesday, February 3, 2004, at 2:00 o'clock P.M., at the Council Chambers at the Interim City Hall, 730 I Street, 1st Floor, Sacramento, California 95814, has been fixed by the City Council as the date, time and place for a public hearing of protests to the levy of such proposed assessment and to proceeding under Part 7.5 of the Special Assessment Investigation, Limitation and Majority Protest Act of 1931 with respect to such assessment district, and at such public hearing (which may be continued from time to time) the City shall consider all objections or protests, if any, to the levy of such proposed assessment, and any interested person will be permitted to present written or oral testimony relating to the levy of such proposed assessment with respect to such assessment district, and at the time appointed for such public hearing the Interim City Clerk of the City shall present all written protests filed with her to the City Council, and any person filing a written protest may withdraw such protest at any time prior to the conclusion of public testimony at such public hearing.

NOTICE IS HEREBY FURTHER GIVEN that the total amount of the proposed assessment chargeable to the entire assessment district is \$392,010.87, the amount of the proposed assessment to be chargeable to the parcel for which this notice is given is set forth at the end hereof, the duration of the payments of the proposed assessments shall be fifteen (15) fiscal years, the reason for the proposed assessment is the bond funding of certain projects costs and the basis upon which the amount of the proposed assessment was calculated is the benefit accruing to properties in proportion to the anticipated use of the street lighting improvements.

NOTICE IS HEREBY FURTHER GIVEN that assessment ballots are being forwarded together with this notice to all property owners in such assessment district, and each assessment ballot must be signed and either mailed or otherwise delivered to the address indicated on the assessment ballot prior to the conclusion of public testimony at the public hearing on the proposed assessment; but regardless of the method of delivery, all assessment ballots must have a mark next to "support" or "oppose" and must be properly signed in the place provided and must be received at the address indicated, or at the location of the public hearing, prior to the conclusion of public testimony at such public hearing in order to be included in the tabulation of a majority protest to the proposed assessment, and any assessment ballot that has been submitted may be changed or withdrawn by the person who submitted the ballot prior to the conclusion of public testimony on such proposed assessment at such public hearing. At the conclusion of public testimony at such public hearing, the Engineer of Work shall tabulate the assessment ballots submitted, and not withdrawn, in support of and in opposition to such proposed assessment, and if on the basis of such tabulation the City Council determines that a majority protest existed, in that the assessment ballots submitted (and not withdrawn) in opposition to such proposed assessment exceeded the assessment ballots submitted (and not withdrawn) in favor of such proposed assessment (weighting each assessment ballot by the amount of the final proposed assessment to be levied upon the parcel for which such assessment ballot was submitted), such proposed assessment shall not be imposed.

NOTICE IS HEREBY FURTHER GIVEN that a maximum annual assessment of sixteen dollars (\$16.00) upon each of the parcels of land in such assessment district is proposed

to be levied to pay costs incurred by the City and not otherwise reimbursed for the administration and collection of the assessments or for the administration of the reserve fund or other related funds or for the registration of the bonds issued to represent unpaid assessments.

NOTICE IS HEREBY FURTHER GIVEN that it is the intention of the City Council that a penalty of two per cent (2%) per month of the total amount of any delinquent assessment installment shall be added to such delinquent assessment installment after the close of business on the delinquency date, and that an additional penalty of two per cent (2%) of the amount of such delinquency shall be added thereto at the beginning of business on the tenth (10th) day of each succeeding month until such delinquent assessment installment and all penalties are fully paid, which penalties shall be in lieu of all other penalties assessed by other provisions of law, and that the Treasurer of the County of Sacramento shall collect such penalties with and as a part of such delinquent assessment installments, and all penalties collected shall be deposited into the bond redemption fund for the bonds issued to represent unpaid assessments.

NOTICE IS HEREBY FURTHER GIVEN that Ron Wicky or Rita Goolkasian, Office of the Department of Public Works, Special Districts, City of Sacramento, 1231 I Street, Room 300, Sacramento, California 95814, telephone (916) 808-7113, has been designated to answer inquiries regarding the protest proceedings.

NOTICE IS HEREBY FURTHER GIVEN that the legal records of Sacramento County indicate that you own that certain real property constituting the Sacramento County Assessor's Parcel Number set forth below, and that the amount of the proposed assessment to be chargeable to such parcel, as shown by the Engineer's Report, is set forth below, and is also set forth on the enclosed assessment ballot.

For all further particulars concerning said proceedings, reference is hereby made to the Resolution of Intention and to the Engineer's Report, both of which are on file in the office of the Interim City Clerk, City of Sacramento, Interim City Hall, 730 I Street, Sacramento, California 95814, and may be examined at said office by any interested persons.

Dated: December 16, 2003.

Virginia Henry,
Interim City Clerk of the
City of Sacramento

Sacramento County Assessor's
Parcel Number

Proposed
Assessment

EXHIBIT A

DESCRIPTION OF STREET LIGHTING IMPROVEMENTS

The construction and installation of a complete high pressure sodium ornamental street lighting system together with all necessary appurtenances thereto on Broadway Boulevard and 8th Avenue from 60th Street to 65th Street; on 60th Street, Perkyman Way, 61st Street, 62nd Street, 63rd Street, 64th Street, Kroy Way, and 65th Street, from 8th Avenue to Broadway Boulevard.

EXHIBIT B**ASSESSMENT BALLOT****FOR THE PROPOSED
TAHOE PARK 5 STREET LIGHTING ASSESSMENT DISTRICT 2003-07**

Assessment Amount: \$ _____

Owner's Name: _____
 Street Address: _____
 City, State, Zip: _____
 Assessor's Parcel Number: _____
 Parcel Address: _____

This assessment ballot is for the use of the owner(s) of the parcel identified herein to support or oppose the levy of a proposed assessment for the Tahoe Park 5 Street Lighting Assessment District No. 2003-07.

This assessment ballot must be signed and either mailed or otherwise delivered to the Interim City Clerk of the City of Sacramento, Interim City Hall, 730 I Street, Sacramento, California 95814, prior to the conclusion of public testimony at the public hearing on the above assessment (which hearing is scheduled to be held on Tuesday, February 3, 2004, at 2:00 o'clock P.M., at the City of Sacramento, Interim City Hall, 730 I Street, Sacramento, California 95814); but regardless of the method of delivery, all assessment ballots must have a mark next to "support" or "oppose" and must be properly signed in the place provided and must be received at such address, or at the location of such public hearing, prior to the conclusion of public testimony at such public hearing in order to be included in the tabulation of a majority protest to the proposed assessment, and any assessment ballot that has been submitted may be changed or withdrawn by the person who submitted the ballot prior to the conclusion of public testimony on such proposed assessment at such public hearing. At the conclusion of public testimony at such public hearing, the City Interim Director of Public Works (as the Engineer of Work for the assessment proceedings) shall tabulate the assessment ballots submitted, and not withdrawn, in support of and in opposition to such proposed assessment, and if on the basis of such tabulation the City Council determines that a majority protest existed, in that the assessment ballots submitted (and not withdrawn) in opposition to such proposed assessment exceeded the assessment ballots submitted (and not withdrawn) in favor of such proposed assessment (weighting each assessment ballot by the amount of the final proposed assessment to be levied upon the parcel for which such assessment ballot was submitted), such assessment shall not be imposed.

In order to have your ballot tabulated please:

1. Check the appropriate box;
2. Print and sign your name in the space provided; and
3. Return your ballot to the Interim City Clerk of the City of Sacramento prior to the conclusion of public testimony at such public hearing.

I am an owner of this property or authorized to vote on behalf of the ownership, and

- Yes, I SUPPORT the proposed assessment as described above.
- No, I OPPOSE the proposed assessment as described above.

 Print Owner's Name

 Owner's Signature

**TAHOE PARK 5 STREET LIGHTING
ASSESSMENT DISTRICT NO. 2003-07
Property Value/Assessment Amount**

The attached list includes the assessment amount and the property value for each parcel in the Tahoe Park 5 Street Lighting Assessment District No. 2003-07.

The values included are from the Sacramento County 2003-2004 tax roll.

This document was filed with the City Clerk, City of Sacramento, County of Sacramento, State of California on December 16, 2003.

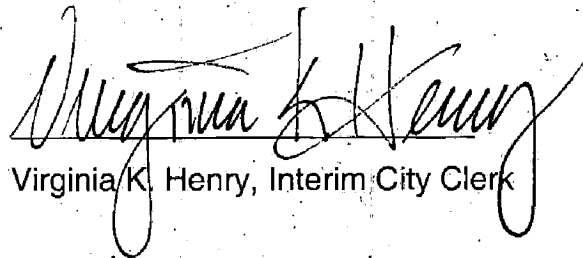

Virginia K. Henry, Interim City Clerk

Tahoe Park West Street Lighting Assessment District No. 2003-06

Property Value/Assessment Lein

| Assessment Number | Parcel Description | Parcel Assessment | Property Value |
|----------------------|-----------------------|----------------------|-------------------|
| 1 | 011-0306-018 | 1,726.93 | 60,649 |
| 2 | 011-0306-017 | 1,726.93 | 62,180 |
| 3 | 011-0306-016 | 1,726.93 | 138,336 |
| 4 | 011-0306-015 | 1,726.92 | 33,996 |
| 5 | 011-0306-014 | 1,726.92 | 118,301 |
| 6 | 011-0312-032 | 1,726.92 | 30,868 |
| 7 | 011-0312-031 | 1,726.92 | 94,809 |
| 8 | 011-0312-030 | 1,726.92 | 149,436 |
| 9 | 011-0312-029 | 1,726.92 | 27,055 |
| 10 | 011-0312-028 | 1,726.92 | 97,491 |
| 11 | 011-0312-027 | 1,726.92 | 111,426 |
| 12 | 011-0312-026 | 1,726.92 | 30,020 |
| 13 | 011-0312-025 | 1,726.92 | 28,753 |
| 14 | 011-0312-024 | 1,726.92 | 33,829 |
| 15 | 011-0312-023 | 1,726.92 | 64,094 |
| 16 | 011-0312-022 | 1,726.92 | 139,413 |
| 17 | 011-0312-021 | 1,726.92 | 30,868 |
| 18 | 011-0312-020 | 1,726.92 | 109,242 |
| 19 | 011-0312-019 | 1,726.92 | 89,299 |
| 20 | 011-0312-018 | 1,726.92 | 94,444 |
| 21 | 011-0321-020 | 3,453.84 | 95,614 |
| 22 | 015-0091-055 | 1,726.92 | 1,637,982 |
| 23 | 015-0084-004 | 1,726.92 | 476,267 |
| 24 | 015-0084-001 | 1,726.92 | 26,636 |
| 25 | 015-0083-006 | 1,726.92 | 105,424 |
| 26 | 015-0083-005 | 1,726.92 | 137,500 |
| 27 | 015-0083-004 | 1,726.92 | 60,475 |
| 28 | 015-0083-003 | 1,726.92 | 29,995 |
| 29 | 015-0083-002 | 1,726.92 | 224,400 |
| 30 | 015-0083-001 | 1,726.92 | 22,829 |
| 31 | 015-0082-006 | 1,726.92 | 26,631 |
| 32 | 015-0082-005 | 1,726.92 | 103,980 |
| 33 | 015-0082-004 | 1,726.92 | 31,577 |
| 34 | 015-0082-003 | 1,726.92 | 139,740 |
| 35 | 015-0082-002 | 1,726.92 | 25,367 |
| 36 | 015-0082-001 | 1,726.92 | 58,349 |
| 37 | 015-0081-003 | 1,726.92 | 133,459 |
| 38 | 015-0081-002 | 1,726.92 | 146,509 |
| 39 | 015-0081-001 | 1,726.92 | 33,394 |
| 40 | 015-0075-002 | 1,726.92 | 39,966 |
| 41 | 015-0075-001 | 1,726.92 | 85,249 |
| 42 | 015-0075-003 | 1,726.92 | 38,212 |
| 43 | 015-0074-003 | 1,726.92 | 102,434 |
| 44 | 015-0074-002 | 1,726.92 | 41,781 |
| 45 | 015-0074-001 | 1,726.92 | 36,152 |
| 46 | 015-0073-001 | 1,726.92 | 78,658 |
| 47 | 015-0073-022 | 1,726.92 | 55,725 |
| 48 | 015-0072-001 | 1,726.92 | 78,823 |
| 49 | 015-0072-021 | 1,726.92 | 96,518 |
| 50 | 015-0072-020 | 1,726.92 | 138,451 |
| 51 | 015-0072-002 | 1,726.92 | 177,480 |
| 52 | 015-0073-021 | 1,726.92 | 43,503 |
| 53 | 015-0073-002 | 1,726.92 | 34,549 |

Tahoe Park West Street Lighting Assessment District No. 2003-06

Property Value/Assessment Lein

| Assessment Number | Parcel Description | Parcel Assessment | Property Value |
|-------------------|--------------------|-------------------|----------------|
| 54 | 015-0074-021 | 1,726.92 | 161,825 |
| 55 | 015-0091-057 | 5,180.76 | 1,732,500 |
| 56 | 015-0084-005 | 1,726.92 | 64,944 |
| 57 | 015-0084-024 | 1,726.92 | 23,673 |
| 58 | 015-0083-007 | 1,726.92 | 61,845 |
| 59 | 015-0083-026 | 1,726.92 | 71,099 |
| 60 | 015-0082-007 | 1,726.92 | 86,973 |
| 61 | 015-0082-026 | 1,726.92 | 87,435 |
| 62 | 015-0081-004 | 1,726.92 | 62,837 |
| 63 | 015-0075-004 | 1,726.92 | 195,000 |
| 64 | 015-0075-005 | 1,726.92 | 8,710 |
| 65 | 015-0074-004 | 3,453.84 | 83,834 |
| 66 | 015-0074-020 | 1,726.92 | 101,151 |
| 67 | 015-0073-003 | 1,726.92 | 66,953 |
| 68 | 015-0073-020 | 1,726.92 | 107,100 |
| 69 | 015-0072-003 | 1,726.92 | 174,266 |
| 70 | 015-0072-019 | 1,726.92 | 82,142 |
| 71 | 015-0072-018 | 1,726.92 | 39,375 |
| 72 | 015-0072-004 | 1,726.92 | 38,569 |
| 73 | 015-0073-019 | 1,726.92 | 161,000 |
| 74 | 015-0073-004 | 1,726.92 | 160,000 |
| 75 | 015-0074-019 | 1,726.92 | 95,021 |
| 76 | 015-0075-006 | 1,726.92 | 36,963 |
| 77 | 015-0081-005 | 1,726.92 | 30,446 |
| 78 | 015-0082-025 | 1,726.92 | 122,037 |
| 79 | 015-0082-008 | 1,726.92 | 81,924 |
| 80 | 015-0083-025 | 1,726.92 | 81,924 |
| 81 | 015-0083-008 | 1,726.92 | 83,784 |
| 82 | 015-0084-023 | 1,726.92 | 27,060 |
| 83 | 015-0084-006 | 1,726.92 | 22,824 |
| 84 | 015-0084-007 | 1,726.92 | 60,485 |
| 85 | 015-0084-022 | 1,726.92 | 101,875 |
| 86 | 015-0083-009 | 1,726.92 | 28,756 |
| 87 | 015-0083-024 | 1,726.92 | 22,829 |
| 88 | 015-0082-009 | 1,726.92 | 26,310 |
| 89 | 015-0082-024 | 1,726.92 | 127,655 |
| 90 | 015-0081-006 | 1,726.92 | 37,673 |
| 91 | 015-0075-013 | 1,726.92 | 119,646 |
| 92 | 015-0074-005 | 1,726.92 | 168,300 |
| 93 | 015-0074-018 | 1,726.92 | 36,959 |
| 94 | 015-0073-005 | 1,726.92 | 88,139 |
| 95 | 015-0073-018 | 1,726.92 | 49,894 |
| 96 | 015-0072-005 | 1,726.92 | 150,857 |
| 97 | 015-0072-017 | 1,726.92 | 110,404 |
| 98 | 015-0072-016 | 1,726.92 | 127,947 |
| 99 | 015-0072-006 | 1,726.92 | 91,646 |
| 100 | 015-0073-017 | 1,726.92 | 165,527 |
| 101 | 015-0073-006 | 1,726.92 | 95,580 |
| 102 | 015-0074-017 | 1,726.92 | 87,449 |
| 103 | 015-0074-006 | 1,726.92 | 93,708 |
| 104 | 015-0075-014 | 1,726.92 | 44,198 |
| 105 | 015-0081-007 | 1,726.92 | 79,924 |
| 106 | 015-0082-023 | 1,726.92 | 95,582 |

Tahoe Park West Street Lighting Assessment District No. 2003-06

Property Value/Assessment Lein

| Assessment Number | Parcel Description | Parcel Assessment | Property Value |
|-------------------|--------------------|-------------------|----------------|
| 107 | 015-0082-010 | 1,726.92 | 79,590 |
| 108 | 015-0083-023 | 1,726.92 | 146,031 |
| 109 | 015-0083-010 | 1,726.92 | 24,942 |
| 110 | 015-0084-021 | 1,726.92 | 78,714 |
| 111 | 015-0084-008 | 1,726.92 | 142,749 |
| 112 | 015-0091-020 | 3,453.84 | 152,391 |
| 113 | 015-0084-009 | 1,726.92 | 37,142 |
| 114 | 015-0084-020 | 1,726.92 | 70,375 |
| 116 | 015-0083-011 | 1,726.92 | 30,866 |
| 117 | 015-0083-022 | 1,726.92 | 26,684 |
| 118 | 015-0082-011 | 1,726.92 | 147,900 |
| 119 | 015-0082-022 | 1,726.92 | 81,180 |
| 120 | 015-0081-008 | 1,726.92 | 62,264 |
| 121 | 015-0074-007 | 1,726.92 | 48,223 |
| 122 | 015-0074-016 | 1,726.92 | 104,439 |
| 123 | 015-0073-007 | 1,726.92 | 115,911 |
| 124 | 015-0073-016 | 1,726.92 | 72,036 |
| 125 | 015-0072-007 | 1,726.92 | 38,569 |
| 126 | 015-0072-015 | 1,726.92 | 36,158 |
| 127 | 015-0072-014 | 1,726.92 | 158,660 |
| 128 | 015-0072-008 | 1,726.92 | 126,282 |
| 129 | 015-0073-015 | 1,726.92 | 124,950 |
| 130 | 015-0073-008 | 1,726.92 | 30,529 |
| 131 | 015-0074-015 | 1,726.92 | 90,984 |
| 132 | 015-0074-008 | 1,726.92 | 137,700 |
| 133 | 015-0075-008 | 1,726.92 | 28,117 |
| 134 | 015-0075-009 | 1,726.92 | 63,861 |
| 135 | 015-0081-009 | 1,726.92 | 35,418 |
| 136 | 015-0081-010 | 1,726.92 | 134,640 |
| 137 | 015-0082-021 | 1,726.92 | 147,900 |
| 138 | 015-0082-020 | 1,726.92 | 35,472 |
| 139 | 015-0082-012 | 1,726.92 | 69,460 |
| 140 | 015-0082-013 | 1,726.92 | 106,618 |
| 141 | 015-0083-021 | 1,726.92 | 57,058 |
| 142 | 015-0083-020 | 1,726.92 | 124,042 |
| 143 | 015-0083-012 | 1,726.92 | 22,406 |
| 144 | 015-0083-013 | 1,726.92 | 27,060 |
| 145 | 015-0084-019 | 1,726.92 | 84,210 |
| 146 | 015-0084-018 | 1,726.92 | 56,222 |
| 147 | 015-0084-010 | 1,726.92 | 58,619 |
| 148 | 015-0084-011 | 1,726.92 | 79,693 |
| 149 | 015-0176-001 | 1,726.92 | 41,835 |
| 150 | 015-0171-022 | 1,726.92 | 140,234 |
| 151 | 015-0084-012 | 1,726.92 | 69,634 |
| 152 | 015-0084-017 | 1,726.92 | 72,425 |
| 153 | 015-0083-014 | 1,726.92 | 88,193 |
| 154 | 015-0083-019 | 1,726.92 | 32,140 |
| 155 | 015-0082-014 | 1,726.92 | 57,058 |
| 156 | 015-0082-019 | 1,726.92 | 56,710 |
| 157 | 015-0081-011 | 1,726.92 | 103,912 |
| 158 | 015-0075-010 | 1,726.92 | 31,736 |
| 159 | 015-0074-009 | 1,726.92 | 99,751 |
| 160 | 015-0074-014 | 1,726.92 | 67,136 |

Tahoe Park West Street Lighting Assessment District No. 2003-06

Property Value/Assessment Lein

| Assessment Number | Parcel Description | Parcel Assessment | Property Value |
|----------------------|-----------------------|----------------------|-------------------|
| 161 | 015-0073-009 | 1,726.92 | 130,049 |
| 162 | 015-0073-014 | 1,726.92 | 193,800 |
| 163 | 015-0072-009 | 1,726.92 | 35,353 |
| 164 | 015-0072-013 | 1,726.92 | 39,375 |
| 165 | 015-0072-010 | 1,726.92 | 68,407 |
| 166 | 015-0073-013 | 1,726.92 | 115,757 |
| 167 | 015-0073-010 | 1,726.92 | 34,549 |
| 168 | 015-0074-013 | 1,726.92 | 98,159 |
| 169 | 015-0074-010 | 1,726.92 | 108,241 |
| 170 | 015-0075-011 | 1,726.92 | 94,364 |
| 171 | 015-0081-012 | 1,726.92 | 142,749 |
| 172 | 015-0082-018 | 1,726.92 | 81,180 |
| 173 | 015-0082-015 | 1,726.92 | 127,969 |
| 174 | 015-0083-018 | 1,726.92 | 23,253 |
| 175 | 015-0083-015 | 1,726.92 | 23,673 |
| 176 | 015-0084-016 | 1,726.92 | 66,907 |
| 177 | 015-0084-013 | 1,726.92 | 99,743 |
| 178 | 015-0171-001 | 1,726.92 | 61,693 |
| 179 | 015-0084-014 | 1,726.92 | 39,760 |
| 180 | 015-0084-015 | 1,726.92 | 24,095 |
| 181 | 015-0083-016 | 1,726.92 | 30,017 |
| 182 | 015-0083-017 | 1,726.92 | 123,217 |
| 183 | 015-0082-029 | 1,726.92 | 62,703 |
| 184 | 015-0082-030 | 1,726.92 | 68,235 |
| 185 | 015-0082-027 | 1,726.92 | 5,509 |
| 186 | 015-0082-028 | 1,726.92 | 65,042 |
| 187 | 015-0081-016 | 1,726.92 | 95,508 |
| 188 | 015-0075-012 | 1,726.92 | 96,933 |
| 189 | 015-0074-011 | 1,726.92 | 134,523 |
| 190 | 015-0074-012 | 1,726.92 | 84,238 |
| 191 | 015-0073-011 | 1,726.92 | 38,568 |
| 192 | 015-0073-012 | 1,726.92 | 43,111 |
| 193 | 015-0151-004 | 1,726.92 | 196,860 |
| 194 | 015-0152-001 | 1,726.92 | 153,829 |
| 195 | 015-0161-001 | 1,726.92 | 160,000 |
| 196 | 015-0162-012 | 1,726.92 | 93,466 |
| 197 | 015-0162-001 | 1,726.92 | 27,151 |
| 198 | 015-0165-019 | 1,726.92 | 130,429 |
| 199 | 015-0165-001 | 1,726.92 | 74,414 |
| 200 | 015-0166-014 | 1,726.92 | 31,709 |
| 201 | 015-0166-001 | 1,726.92 | 116,175 |
| 202 | 015-0072-011 | 1,726.92 | 151,925 |
| 203 | 015-0072-012 | 1,726.92 | 112,949 |
| 204 | 015-0151-003 | 15,542.28 | - |
| 205 | 015-0071-001 | 18,996.12 | - |
| | | 392,011 | 20,135,111 |