

APPLICATION FOR PERMIT TO BUILD

PERMIT **1441**
 DATE **11/21/16**
 DISTRICT **3**
1442

Street No. **725 - P.** Lot **5. W30, S 1/2** Block **O.P. - 7. 8.**

Owner **George A. Capen** Address **State St. East**

Architect Address **or 725 - P.**

Contractor **Owner** Address

Kind of Building **One story fr. Dwelling, 5cm + bath.**

Foundation

	Girder		Span		Mud Sills	
	1ST FLOOR	2ND FLOOR	3RD FLOOR	4TH FLOOR	5TH FLOOR	6TH FLOOR
Joists	Restriping entire Roof and new bracing to under- pinning					
Max. Span						
Bearing Partitions						
Non-bearing Partitions						
Story Height						
Outside Walls						
Ceiling Joists	Span					

Roof Rafters

Water Heater Chimney

Size of Building—Length Width Height

It is hereby agreed that this building will be constructed in conformity with the Ordinances of the City of Sacramento and the Laws of the State of California.

Estimated cost, \$ **100**
 Plans must be submitted.

Hellie B Capen
 Owner or Owner's Representative.

9

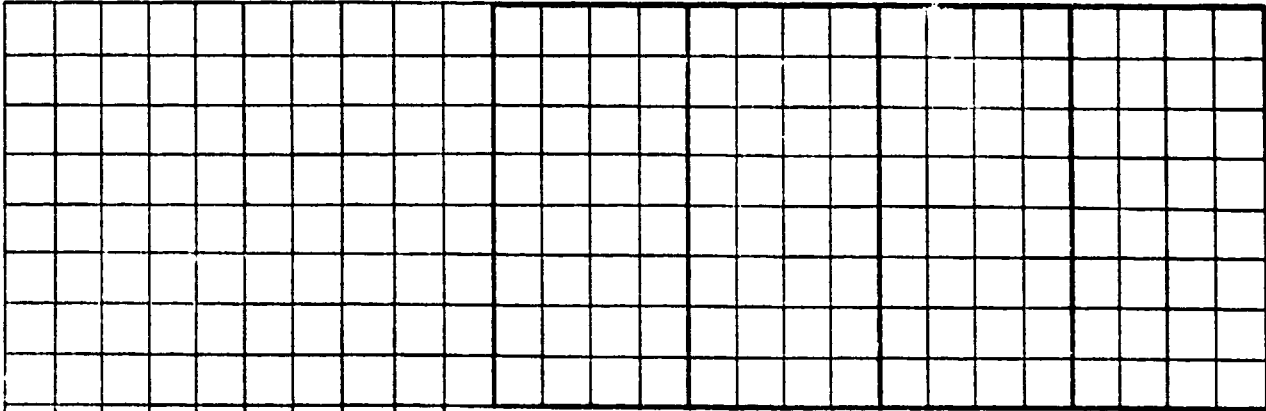

4

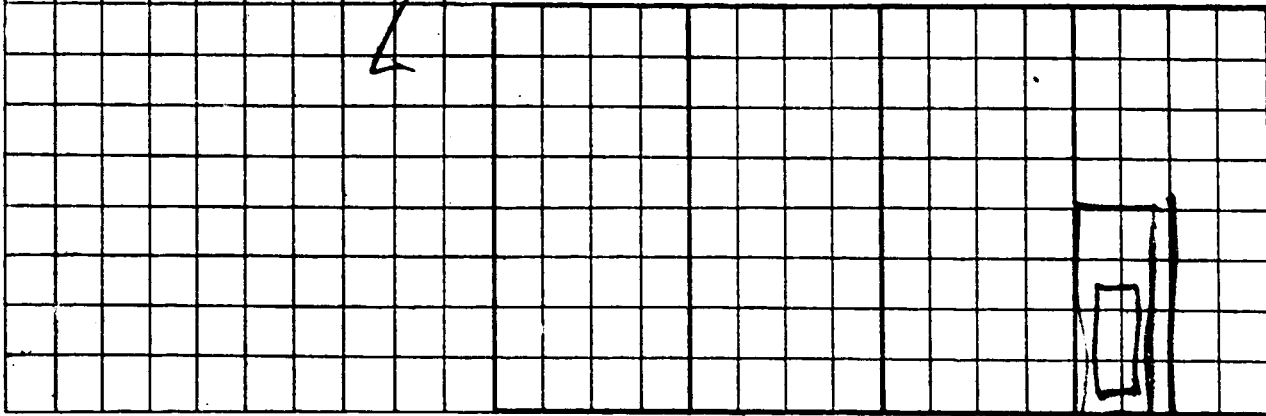

4