

17



CITY OF SACRAMENTO

DEPARTMENT OF ENGINEERING
915 I STREET SACRAMENTO, CALIFORNIA 95814
CITY HALL ROOM 207 TELEPHONE (916) 449-5281

CITY MANAGER'S OFFICE
RECEIVED
APR 30 1980

R. H. PARKER
CITY ENGINEER
J. F. VAROZZA
ASSISTANT CITY ENGINEER

April 29, 1980

City Council
Sacramento, California

Honorable Members in Session:

SUBJECT: Revocable Encroachment Permit - Reed and Graham, Inc.

SUMMARY:

Reed and Graham, Inc. has applied for a revocable encroachment permit for the purpose of installing storm drain from 14th Avenue northerly to abandoned gravel pit owned by City and operated by Granite Construction. The City Engineer recommends that the permit be granted.

BACKGROUND:

The area for which this request is being made consists of a 10' strip of land located in the gravel pit being used by Granite Construction north of 14th Avenue. This property is being leased to Granite and their consent to its use is attached. The permittee's address is 8280 14th Avenue.

RECOMMENDATION:

The City Engineer recommends that the attached resolution be passed granting a revocable encroachment permit to Reed and Graham, Inc. in the area and for the purpose outlined above.

Respectfully submitted,

R. H. PARKER
City Engineer

Recommendation Approved:

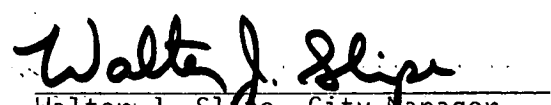
Walter J. Slips, City Manager

APPROVED
BY THE CITY COUNCIL

MAY - 8 1980

OFFICE OF THE
CITY CLERK

RHP/hma

APPROVED
BY THE CITY COUNCIL

MAY - 8 1980

OFFICE OF THE
CITY CLERK

cc: R. H. Blaser

May 8, 1980
District #6

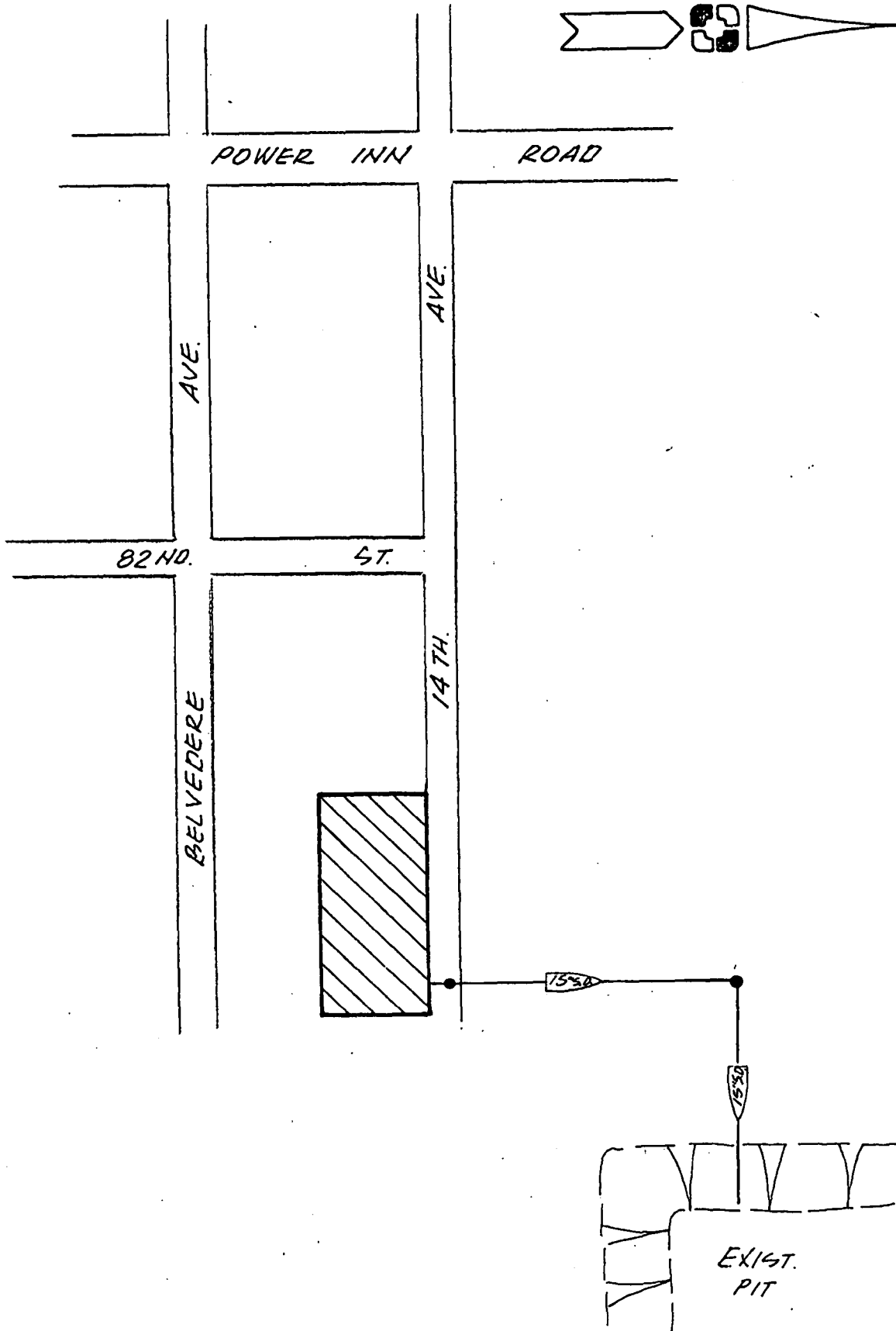

m & m consultants, inc.

ENGINEERING · SURVEYING · PLANNING
 NOVATO OAKLAND SACRAMENTO SAN FRANCISCO

RCE

DRAWN BY W.L.M.
DESIGNED BY
CHECKED BY
DATE MAR. '80
SCALE N.T.S.

PROPOSED STORM DRAIN
 OUTFALL FROM 14TH. AVE.
 FOR
REED & GRAHAM

File No.

MEMORANDUM

TO: Granite Construction Company
M. J. Reading

FROM: Reed & Graham, Inc.

DATED: April 23, 1980

Reed and Graham, Inc. hereby agrees and covenants that it will assume full responsibility for the maintenance and operation of the proposed storm drain shown schematically on the attached sketch and more particularly shown on that certain drawing entitled Reed and Graham, 8280 14th Avenue, offsite storm drain, sheet four (4), prepared by M & M Consultants.

Reed and Graham, Inc. also agrees to hold Granite Construction Company harmless from any liability in connection with installation, operation and maintenance of said storm drain and from the effects of the effluent storm waters on the existing gravel pit and to immediately, at Reed & Graham, Inc.'s expense, perform any required repair and/or corrective measures to eliminate any adverse conditions which may occur.

APPROVED AS ABOVE

REED & GRAHAM, INC.

By: Norman R. Cagure

Date: 4-24-80

GRANITE CONSTRUCTION COMPANY

By: Michael J. Reading

Date: 4/24/80

MICHAEL J. READING
ASSISTANT BRANCH MANAGER

RESOLUTION No. 80-276

Adopted by The Sacramento City Council on date of

May 8, 1980

RESOLUTION GRANTING REVOCABLE ENCROACHMENT TO:

Reed and Graham, Inc.

BE IT RESOLVED BY THE COUNCIL OF THE CITY OF SACRAMENTO:

That a revocable encroachment permit for the purpose of installing storm drain from 14th Avenue northerly to abandoned gravel pit owned by City and operated by Granite Construction.

is hereby granted to Reed and Graham, Inc., whose address is as follows: P.O. Box 5940 (690 Sunol Court) San Jose, CA 95150.

The encroachment area is described as follows:

See Attached

This permit is granted subject to the "General Provisions - Revocable Encroachment Permit", which were adopted by the City Council in Resolution No. 77-611 dated October 4, 1977, and the hereinafter specified special conditions, if any. This permit shall be effective only after the applicant files with the Department of Finance of the City of Sacramento, the insurance certificates required by the General Provisions.

SPECIAL CONDITIONS

See Attached

ATTEST:

MAYOR

CITY CLERK

APPROVED
BY THE CITY COUNCIL

MAY - 8 1980

OFFICE OF THE
CITY CLERK

Faint, illegible text at the top of the page.

Faint, illegible text in the upper middle section.

Faint, illegible text in the middle section.

Faint, illegible text in the lower middle section.

Faint, illegible text in the lower section.

Faint, illegible text in the lower section.

A large, dense block of faint, illegible text in the lower section.

Faint, illegible text in the lower section.

Faint, illegible text in the lower section.

Faint, illegible text in the lower section.

Faint, illegible text in the lower section.

Faint, illegible text in the lower section.

Faint, illegible text in the lower section.

Faint, illegible text in the lower section.

Description

A 10 foot strip of land, the centerline of which is described as follows:

Beginning at a point in the south one-half of Section 14, Township 8 north, Range 5 east, M.D.B.M., said point of beginning being located south $89^{\circ} 40' 25''$ west 68.00 feet along the south line of said Section 14 and north $00^{\circ} 19' 35''$ west 20.00 feet from the south one-quarter corner of said Section 14, said point of beginning also being a point in the northerly line of that certain right-of-way parcel to the County of Sacramento, recorded in Book 4272 of Official Records, at Page 508; thence, from said point of beginning, north $00^{\circ} 19' 35''$ west 151.00 feet; thence, north $89^{\circ} 40' 25''$ east 175.00 feet parallel with said south line of Section 14, to the terminus of this description.

The meridian of this description is identified with that certain Record of Survey entitled "Portion of Section 14, T. 8N, R.S.E., M.D.B.M., City of Sacramento, California," recorded in Book 29 of Surveys, at Page 30, Records of Sacramento County.

SPECIAL CONDITIONS

1. Permittee, by applying for this permit, represents that the lessee of property from the City (Granite Construction Company) which includes the above-described encroachment area, has consented to the granting of this encroachment permit and the proposed use thereunder. Permittee understands and agrees that this permit is not intended in any way to operate in derogation of the rights of Granite Construction Company under its lease from the City and that this permit may be revoked by the City Council at its will and may be revoked if Granite Construction Company, at any time, objects to the use under this permit.
2. The permittee shall comply with all requirements of the City Planning Department and the Building Inspections Department.
3. All construction shall comply with the details as shown on the attached drawing.