

CITY OF SACRAMENTO
1231 I Street, Sacramento, CA 95814

Permit No: 9906111
Insp Area: 4

Site Address: 3820 SAINTSBURY DR SAC
Parcel No: 225-1190-012 LOT 200 GATEWAY WEST

Sub-Type: NSFR
Housing (Y/N): N

CONTRACTOR
BEAZER HOMES
3009 DOUGLAS BL #150
ROSEVILLE CA 95661

OWNER

ARCHITECT
BLOODGOOD SHARP BUSTER
2356 GOLD MEADOW WY #201
GOLD RIVER CA 95670

Nature of Work: NEW HOME, MP1659, 8 ROOMS

CONSTRUCTION LENDING AGENCY : I hereby affirm under penalty of perjury that there is a construction lending agency for the performance of the work for which this permit is issued (Sec. 3097, Civ. C).

Lender's Name _____ Lender's Address _____

LICENSED CONTRACTORS DECLARATION: I hereby affirm under penalty of perjury that I am licensed under provisions of Chapter 9 (commencing with section 7000) of Division 3 of the Business and Professions Code and my license is in full force and effect.

License Class B License Number 24191 Date 6/18/99 Contractor Signature Sheryl VanMaran

OWNER-BUILDER DECLARATION: I hereby affirm under penalty of perjury that I am exempt from the contractors License Law for the following reason (Sec. 7031.5, Business and Professions Code: any city or county which requires a permit to construct, alter, improve, demolish, or repair any structure, prior to its issuance, also requires the applicant for such permit to file a signed statement that he or she is licensed pursuant to the provisions of the Contractors License Law (Chapter 9 (commencing with Section 7000) of Division 8 of the Business and Professions Code) or that he or she is exempt therefrom and the basis for the alleged exemption. Any violation of Section 7031.5 by any applicant for a permit subjects the applicant to a civil penalty of not more than five hundred dollars (\$500.00);

____ I, as a owner of the property, or my employees with wages as their sole compensation, will do the work, and the structure is not intended or offered for sale (Sec. 7044, Business and Professional Code: The Contractors License Law does not apply to an owner of property who builds or improves thereon, and who does such work himself or herself or through his/her own employees, provided that such improvements are not intended or offered for sale. If, however, the building or improvement is sold within one year of completion, the owner-builder will have the burden of proving that he/she did not build or improve for the purpose of sale.)

____ I, as owner of the property, am exclusively contracting with licensed contractors to construct the project (Sec. 7044, Business and Professions Code: The Contractors License Law does not apply to an owner of property who builds or improves thereon, and who contracts for such projects with a contractor(s) licensed pursuant to the Contractors License Law).

____ I am exempt under Sec. _____ B & PC for this reason: _____

Date _____ Owner Signature _____

IN ISSUING THIS BUILDING PERMIT, the applicant represents, and the city relies on the representation of the applicant, that the applicant verified all measurements and locations shown on the application or accompanying drawings and that the improvement to be constructed does not violate any law or private agreement relating to permissible or prohibited locations for such improvements. This building permit does not authorize any illegal location of any improvement or the violation of any private agreement relating to location of improvements.

I certify that I have read this application and state that all information is correct. I agree to comply with all city and county ordinances and state laws relating to building construction and hereby authorize representative(s) of this city to enter upon the abovementioned property for inspection purposes.

Date 6/18/99 Applicant/Agent Signature Sheryl VanMaran

WORKER'S COMPENSATION DECLARATION: I hereby affirm under penalty of perjury one of the following declarations:

____ I have and will maintain a certificate of consent to self-insure for workers' compensation as provided for by Section 3700 of the Labor Code, for the performance of work for which the permit is issued.

I have and will maintain workers' compensation insurance, as required by Section 3700 of the Labor Code, for the performance of the work for which this permit is issued. My workers' compensation insurance carrier and policy number are:

Carrier LIBERTY MUTUAL INS CO. Policy Number WA2-65D-004147-059 Exp Date 04/01/2000

____ (This section need not be completed if the permit is for \$100 or less) I certify that in the performance of the work for which this permit is issued, I shall not employ any person in any manner so as to become subject to the workers' compensation laws of California and agree that if I should become subject to the workers' compensation provisions of Section 3700 of the Labor Code, I shall forthwith comply with those provisions.

Date 6/18/99 Applicant Signature Sheryl VanMaran

WARNING - FAILURE TO SECURE WORKER'S COMPENSATION COVERAGE IS UNLAWFUL AND SHALL SUBJECT AN EMPLOYER TO CRIMINAL PENALTIES AND CIVIL FINES UP TO ONE HUNDRED THOUSAND DOLLARS (\$100,000) IN ADDITION TO THE COST OF COMPENSATION, DAMAGES AS PROVIDED FOR IN SECTION 3706 OF THE LABOR CODE, INTEREST AND ATTORNEY'S FEE.

THIS PERMIT SHALL EXPIRE BY LIMITATION IF WORK IS NOT COMMENCED WITHIN 180 DAYS.

Natomas Unified School District
 1515 Sports Drive, #1 • Sacramento, CA 95834-1905
 Phone 916/641-3300 • Fax 916/928-1629

CERTIFICATION OF COMPLIANCE
SCHOOL DISTRICT DEVELOPMENT FEES

Property Owner's Name <u>BEAZER HOMES</u>	
Owner's Address <u>3009 Douglas Blvd #150, Roseville, Ca 95661</u>	
Project Address <u>3820 SAITSBURY DRIVE</u>	
Parcel Number <u>225-1190-012</u>	<u>LOT 200</u>
Subdivision Name <u>Gateway West Village #1</u>	
Number of Units <u>1</u>	
Print Applicant's Name <u>DEANNA COLLINS</u>	Applicant's Signature <u>D. Collins</u>
Title of Applicant <u>OPERATIONS</u>	
Date <u>6/1/99</u>	Telephone Number <u>773-3888</u>
PART I TO BE COMPLETED BY BUILDING DEPARTMENT	
Plan Identification Number <u>1659</u>	
Building Type (Check One)	
<input checked="" type="checkbox"/> Residential	<input type="checkbox"/> Apartment/Condominium
	<input type="checkbox"/> Commercial/Industrial
Square Feet of Chargeable Building Area <u>1659</u>	
Signature <u>[Signature]</u>	Date <u>6-10-99</u>
PART II TO BE COMPLETED BY NATOMAS UNIFIED SCHOOL DISTRICT	
District Certification Number <u>99-380</u>	
Fees Collected:	
Residential: <u>1659</u> Sq. Ft. X \$ <u>4.57</u>	= \$ <u>7581.63</u>
Apartment/Condominium: _____ Sq. Ft. X \$ _____	= \$ _____
Commercial/Industrial: _____ Sq. Ft. X \$ _____	= \$ _____
NOTICE TO APPLICANT: Pursuant to government code section 66020 (d), this will serve to notify you that the 90-day approval period in which you may protest the fees, or other payment identified above, will begin to run on the date in which the building or installation permit for this project is issued, or on which they are paid to the District, or to another public entity authorized to collect them on behalf of the District, whichever is earlier.	
Applicant Signature: <u>D. Collins</u>	Date: <u>6/1/99</u>

This certification covers only the amount of square footage indicated above. Any additions or corrections to the square footage for this project will require an amendment to the Certificate of Compliance.

As the authorize Natomas Unified School District official, I hereby certify that the requirements of Government Code Section 95995 have been complied with by the above signed applicant.

SIGNATURE: [Signature] DATE: 6/11/99
 TITLE: FP Dir

CERTIFICATION OF INSULATION

PART I
GENERAL

BLAZER

LOT # **700**

- P.O. BOX 854, WEST SACRAMENTO, CA 95691 LIC. #202026
- 1309 MELODY ROAD, MARYSVILLE, CA 95901 LIC. #202026
- P.O. BOX 9651, FRESNO, CA 93793-9651 LIC. #202026
- P.O. BOX 1831, RENO, NV 89505 LIC. #10675
- 3326 A PONDEROSA WAY, LAS VEGAS, NV 89118 LIC. #10675

Gateway West

DATE INSULATION COMPLETED

9-14-99

PART II
AREAS
INSULATED

WALLS	CEILINGS	FLOORS
(SQUARE FEET)	(SQUARE FEET)	(SQUARE FEET)
MATERIAL FIBERGLASS	MATERIAL FIBERGLASS	MATERIAL FIBERGLASS
FORM BATTS	FORM BATTS & BLOW	FORM BATTS
MANUFACTURER'S PRODUCT I.D.	MANUFACTURER'S PRODUCT I.D.	MANUFACTURER'S PRODUCT I.D.

OCF	OCF	OCF
	BAGS	

13	3 5/8"	30	9"	30	12"
-----------	---------------	-----------	-----------	-----------	------------

MATERIAL FIBERGLASS	FORM BATTS	R VALUE	MANUFACTURER OCF
----------------------------	-------------------	---------	-------------------------

MATERIAL FOAM	MANUFACTURER W R GRACE
----------------------	-------------------------------

SIGNATURE - INSULATION CONTRACTOR <i>[Signature]</i>	TITLE MANAGER	DATE 8-30-99
SIGNATURE - GENERAL CONTRACTOR	TITLE	DATE

REMARKS



No 18566

INSTALLATION CARD

Job Address: Beazer Reflections Lot 200
3820 Santsbury Dr
2040

Stucco System Trade Name: KWIK KOTE
Name Stucco Manufacturer: KWIK KOTE CORP.

ICBO Evaluation Service, Inc.
Report No. 3607
Date of Job Completion _____

Stucco Contractor Kenyon Construction
Name John W. Kenyon, III
Address P.O. Box 2077
North Highlands, CA 95660
Telephone Number (916) 349-8191
Approved Contractor Number as issued by the Stucco Manufacturer: 1

This is to certify that the stucco system on the building exterior at the above address had been installed in accordance with the evaluation report specified above and the manufacturer's instructions.

[Signature]
Signature of authorized representative of stucco contractor

8/24/99
Date

COUNTY SANITATION DISTRICT NO. 1
SACRAMENTO REGIONAL COUNTY SANITATION DISTRICT
SEWER IMPACT FEE
PERMIT AND CALCULATION SHEET

APPLICATION NO.:	BLDG PERMIT NO.:	<u>City</u>
GENERAL INFORMATION	THIS PERMIT GOOD ONLY WHEN VALIDATED BY THE CASHIER	
	DEPT 26	\$2,414.00
	TRAN 391072 06/11/99	
	RECEIPT 703622 C#2 6-11-99	\$2,414.00
THIS PERMIT TO CONNECT EXPIRES ONE YEAR FROM DATE OF ISSUANCE		

FEE CALCULATION	BUILDING USE
INSPECTION	RESIDENTIAL <input type="checkbox"/> SF <input type="checkbox"/> MF <input type="checkbox"/>
CSD-1	COMMERCIAL USE
SRCSD	UNITS
CONSTRUCTION	
IN-LIEU	
TOTAL FEE	

APN: 225-1190-012

DESCRIPTION / SUBDIVISION: Gateway West Village #1 LOT: 200

PROPERTY ADDRESS: 3620 Santsbury Drive

OWNER: Beazer Homes

MAILING ADDRESS: 3009 Douglas Blvd, Suite #150,

CITY-STATE-ZIP: Roseville, Ca 95661 PHONE: (916) 773-3888

ADDITIONAL FEES MAY BE DUE IF CHANGES IN USE INCREASE SEWER IMPACT.

APPLICANT SIGNATURE: [Signature]

CONSOLIDATED UTILITY BILLING USE ONLY

ACCT _____ INPUT _____ START _____

THIS PLAN IS PREPARED TO SHOW THE DIMENSIONAL RELATIONSHIP FROM BUILDING FOUNDATION TO PROPERTY LINE, DESIGN DRAINAGE CONTROL ELEVATIONS, AND DIRECTION OF DRAINAGE FLOW TO CONFORM WITH LOCAL ORDINANCES FOR THE PURPOSE OF BUILDING PERMIT ISSUANCE. INFORMATION SHOWN IS APPROXIMATE EXCEPT FOR THOSE SETBACKS WHICH ARE MINIMUMS REQUIRED BY ORDINANCE. THIS PLAN DOES NOT REFLECT AS BUILT CONDITIONS WHICH WILL LIKELY VARY FROM THIS PLAN.

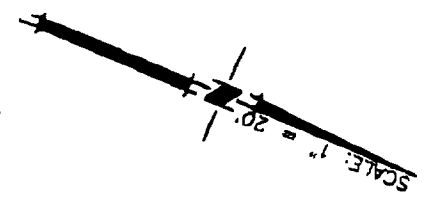

SAINTSBURY DRIVE

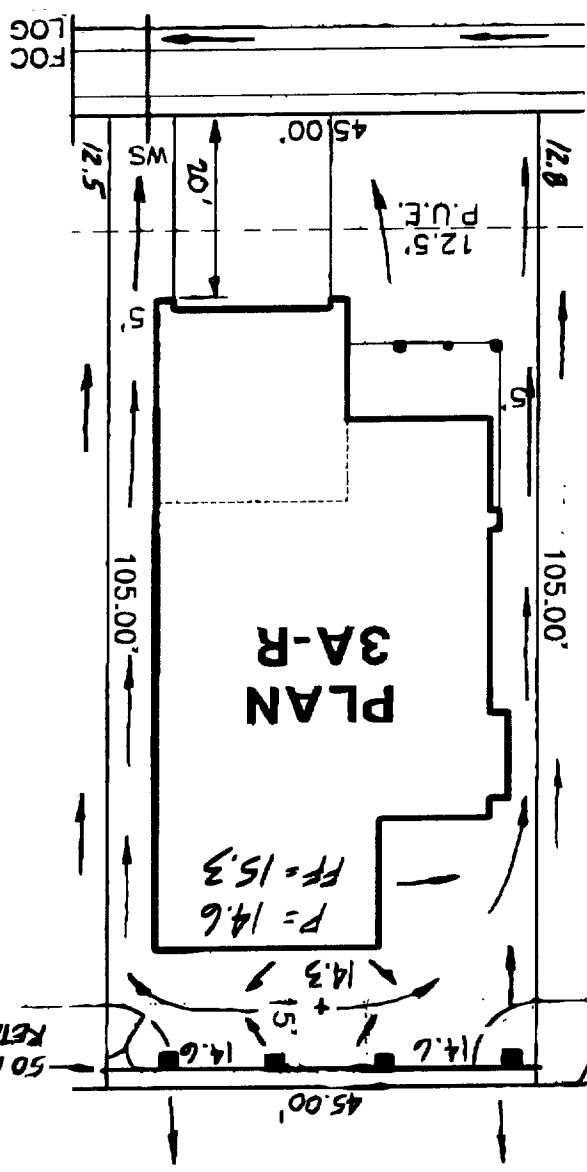

This set of plans and specifications shall be kept on the job at all times and it is the responsibility of the contractor to make any changes or alterations from the same without written permission from the Building Inspection Division.
 The approval of this plan and specification SHALL NOT be held to permit or approve the violation of any City Ordinance or State Law

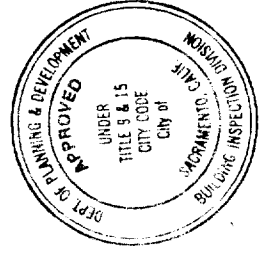

LOT 200
PLOT PLAN
 GATEWAY WEST-VILLAGE NO. 1
 FOR
 BEAZER HOMES
 SACRAMENTO
 CALIFORNIA

WOOD-RODGERS INC.

DATE: MAY, 1999
 DRAWN: PDM
 CHECKED: JCH
 PROJECT NO: 98BEZ-009

ROUTINE APPROVAL

INITIALS	✓	President
		Project Development
		Construction
		Marketing
		Accounting

LOT COVERAGE = 45.1%
 3820 SAINTSBURY DRIVE