



APPROVED
BY THE CITY COUNCIL

SEP 25 1987

OFFICE OF THE
CITY CLERK

4

DEPARTMENT OF
PUBLIC WORKS

ENGINEERING DIVISION

THOMAS M. FINLEY
ENGINEERING DIVISION MANAGER

City Council
Sacramento, California

CITY OF SACRAMENTO
CALIFORNIA

September 23, 1987

927 TENTH STREET
ROOM 200
SACRAMENTO, CA
95814-2705

916-449-8220

CONSTRUCTION SECTION
640 BERKUT DRIVE
SUITE B
SACRAMENTO, CA
95814-0131

916-449-5282

Honorable Members In Session:

SUBJECT: 712 - 714 K Street Mall - Revocable Encroachment Permit

SUMMARY

The Director of Public Works recommends that a Revocable Encroachment Permit be granted to Mohammed H. Mohanna for the purpose of installing a canvas canopy.

BACKGROUND

Mohammed H. Mohanna has applied for a Revocable Encroachment Permit for the purpose of installing a canvas canopy along the southside of the property located at 712 K Street Mall.

The encroachment area is a 40'7" x 7" area along the southside of the property located at 712 K Street Mall.

RECOMMENDATION

The Director of Public Works recommends that the attached resolution be passed granting a Revocable Encroachment Permit to Mohammed H. Mohanna for the area and for the purpose outlined above.

Respectfully submitted,

THOMAS M. FINLEY
Engineering Division Manager

Recommendation Approved:

WALTER J. SLIPE
City Manager

Approved:

MELVIN H. JOHNSON
Director of Public Works

PM:dk
D2-26.G
09.1187

September 23, 1987
District No. 1

RESOLUTION NO. 87-773

ADOPTED BY THE SACRAMENTO CITY COUNCIL ON DATE OF

APPROVED
BY THE CITY COUNCIL

SEP 23 1987

RESOLUTION GRANTING REVOCABLE ENCROACHMENT PERMIT TO:

OFFICE OF THE
CITY CLERK

MOHAMMED H. MOHANNA

BE IT RESOLVED BY THE COUNCIL OF THE CITY OF SACRAMENTO:

That a Revocable Encroachment Permit be granted to Mohammed H. Mohanna, whose address is 811 J Street, Sacramento, California, for the purpose of installing a canvas canopy along the southside of the property at 712 K Street. Said Revocable Permit shall pass on to any successor in title of the adjoining property.

This encroachment is described as follows:

A canopy along the southside of the property at 712 K Street measuring 40'7" x 7' and at the height of 9'6".

This permit is granted subject to the "General Provisions - Revocable Encroachment Permit", which were adopted by the City Council in Resolution No. 81-845 dated November 17, 1981. This permit shall be effective only after the applicant files the insurance certificates, required by the General Provisions, with the Risk Management and Insurance Division of the City of Sacramento.

SPECIAL CONDITIONS

1. Fire retardant material is to be used.

MAYOR

ATTEST:

CITY CLERK

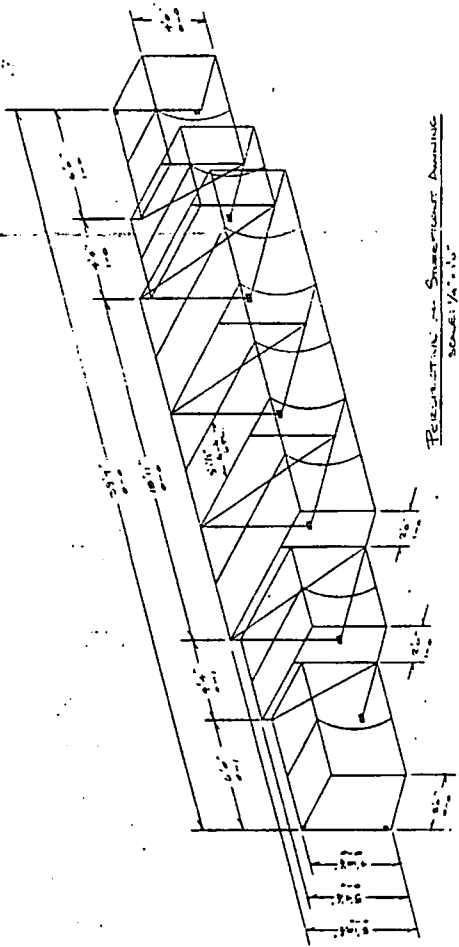

PERMISSION TO SUBMIT DRAWING
SCALE: 1/4" = 1'-0"

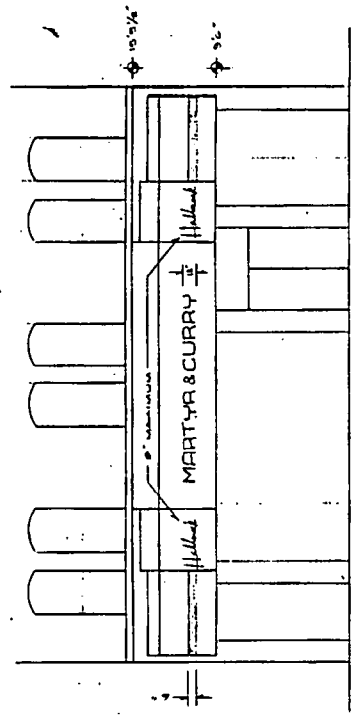

ELEVATION
SCALE: 1/4" = 1'-0"

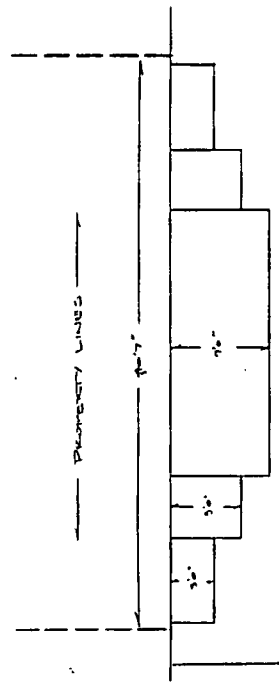

PERMISSION TO SUBMIT DRAWING
SCALE: 1/4" = 1'-0"

- SCHEDULE:**
- 1) ALL MEMBERS TO BE 10541" GRADE STEEL TUBING
 - 2) ALL JOINTS IN FRAMEWORK TO BE PULLED WELDED CONNECTIONS THROUGHOUT AND MOUNTING ANY MOUNTING PLATES
 - 3) ALL MOUNTING PLATES SHOWN IN PERSPECTIVE ABOVE TO BE 3/16" x 1/2" x 1/2" W/16" HOLES EXCEPT FOR THE TWO LEGS 6" x 6" EACH EACH END, THESE ARE TO BE 3/16" x 1/2" x 3/4" W/4 3/8" HOLES.
 - 4) ALL MEMBERS TO BE GALVANIZED WITH REINFORCED, AND PAINTED FINISH OF SUPERHUMINUS "ASTRO" ACRYLIC ENAMEL GLOSS WHITE.
- 5) PARTNERS:**
- a) TOP: WHERE BEAMS TO PERMIT USE 3/16" SQUARE ANCHORS THROUGH 2" x 4" PART 2" STRUCCS AND EXISTING BEAMS. USE 3/8" x 1/2" x 16" SCANS THROUGH 2" x 4" PART 2" STRUCCS INTO NEW 2" x 4" STRUCCS WITH 16" O.C. WHEN THE STRUCCS IS UNAVAILABLE USE 2" x 4" BLOCKS END-TO-END TO CONNECT STRUCCS. "E-CUPS" ARE AT EVERY CORNER OR FRAMEWORK
 - b) BOTTOM: USE 3/8" x 1/2" x 16" SCANS THROUGH MOUNTING WARE POST 2" STRUCCS AND WOOD WINDOW HENCKEL
 - c) CORNER: MASONRY FRAME THROUGHOUT (CHURCH STATE FIRE MARSHAL REGISTRATION NO. F-102.4) LIGHT GRAY CONCRETE WITH QUARRY AND TRANSMISSION SLOPE
- 7) MEMBERS:** CORNER TO CORNER BRACKET ON TRANSITIONAL SIDES. LETTERS & STRIKE TO BE "SUMMIT", STRIKE PER SUPPLIER DRAWING

POST PAID
SCALE: 3/4" = 1'-0"

HOUSE / MARINE & CURRY		712 K ST. SACRAMENTO, CA 95814
SCALE: 1/4" = 1'-0"	DATE: 12-1-87	DESIGNED BY: JAC
CARRA TAYLOR CO.		1990 STREETON BLVD. SACRAMENTO, CA 95820
DRAWN FOR: MOUNTAIN DEVELOPMENT		PROJECT NUMBER:

4.

Engineering
Civil & Elec

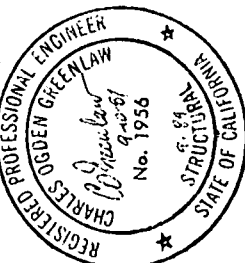

September 25, 1987

Mohammed H. Mohanna
811 "J" Street
Sacramento, CA 95814

Dear Mr. Mohanna:

On September 23, 1987, the Sacramento City Council adopted resolution CC87-773 granting the following Revocable Encroachment Permit in accordance with "General Provisions - Revocable Encroachment Permit," adopted by Council Resolution 81-845 as amended.

The permit is for the purpose of installing a canvas canopy along the south side of the property located at 712 "K" Street.

This permit shall be effective only after you file with the Risk Management and Insurance Division of the City of Sacramento, 5730 24th Street, Bldg. 3A, Sacramento, CA 95822, the insurance certificates required by the General Provisions.

Enclosed, for your records, is a copy of the resolution granting the permit, and Council Resolution 81-845, as amended.

Sincerely,

Lorraine Magana
City Clerk

LM/cc/#4

Enclosures (2)

cc: Risk Management