

PRESERVATION BOARD

PROJECT LOCATION	1510 D Street		
APPLICANT	City Building Department		
OWNER	Mary Elizabeth Sinkey, 6781 Frates Way, Sacramento, CA		
PLANS BY	N/A		
FILING DATE	2-2-81	ACTION DATE	N/A
		REPORT BY:	RBH:kk
NEG. DEC and Initial Study:	1/30/81	ASSESSOR'S PCL. NO.	002-131-23

PROPOSAL: City Building Department initiated demolition.

LOCATION: 1510 D Street

BACKGROUND INFORMATION: The City Building Department has initiated demolition of a fire damaged, two story supportive residential structure. The subject building is a supportive structure in a Preservation Area.

STAFF EVALUATION: Staff finds that the structure is a supportive structure in a Preservation Area and is capable of being rehabilitated on site or relocated and rehabilitated on another site.

STAFF RECOMMENDATION: Staff recommends that the issuance of a demolition permit be suspended for 90 days in order for the owner of the building to develop a rehabilitation process acceptable to both the Building Department and the Preservation Board or for the Board to assist, through advertising and locating a developer who will relocate the building for rehabilitation on a new site, based on the following findings of fact:

1. The building is a supportive structure in a Preservation Area.
2. The building is capable of being rehabilitated on site or of being relocated and rehabilitated on a new site.

If the board adopts staff recommendations, the appropriate action will be to ratify the Negative Declaration and adopt the staff recommendations.



# CITY OF SACRAMENTO

## NEGATIVE DECLARATION

The Environmental Coordinator of the City of Sacramento, California, a municipal corporation, does prepare, make, declare, and publish this Negative Declaration for the following described project:

City initiated demolition of a fire damaged, two story, two unit, 2200± sq. ft., supportive residential structure in a Preservation Area. Loc: 1510 & 1510½ D Street  
APN: 002-131-23

The Sacramento City Planning Department has reviewed the proposed project and has determined that the project, with the following mitigation measures, as resolved, will not have a significant effect on the environment. This conclusion is based on information contained in the attached Initial Study. The mitigation measures are:

90 day demolition suspension to allow owner to rehabilitate structure on site or advertise for relocation.

An Environmental Impact Report is not required pursuant to the Environmental Quality Act of 1970 (Division 13 of the Public Resources Code of the State of California).

This environmental review process and Negative Declaration filing is pursuant to Division 6, Title 14, Chapter 3, Article 7, Section 15083 of the California Administrative Code and pursuant to the Sacramento Local Environmental Regulations (Resolution 78-172) adopted by the City of Sacramento and pursuant to Sacramento City Code, Chapter 63.

A copy of this document may be reviewed/obtained at the Sacramento City Planning Department, 725 "J" Street, Sacramento, CA 95814.

Marty Van Duyn  
Environmental Coordinator of the  
City of Sacramento, California,  
a municipal corporation

By: \_\_\_\_\_

18 JAN 30 3 32 PM '81  
CITY OF SACRAMENTO  
CITY CLERK'S OFFICE  
RECEIVED

Rev. 1/81

DP

CASE SHEET

PROPERTY RECORD

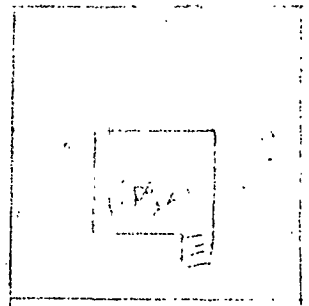

D ST  
PLOT PLAN

PROPERTY ADDRESS 1510 E 1510 1/2 B St.

DESCRIPTION W. 1/2 Lot 2, Exc. NW 10' Blk D, E, 15, 16,

PARCEL No. 002-131-23

OWNER Mary Elizabeth Sinkey

Res. Phone: 422-6968

OWNER'S ADDRESS 6781 Frates Way

Bus. Phone: \_\_\_\_\_

Sacramento, Ca.

PERSON CONTACTED AT INSPECTION None RELATIONSHIP \_\_\_\_\_

RENTAL Yes OWNER OCCUPIED No VACANT Yes

NO. UNITS Two NO. OF BLDGS. One TOTAL OCCUPANTS None

STRUCTURE: Bdrms. Two ea. Dwelling Two flat Multi Unit \_\_\_\_\_ Commercial \_\_\_\_\_

INSPECTION RECORD

CONSTRUCTION: Foundation Brick Ext. Walls Rustic Roof Composition

ACCESSORY BUILDING: House in rear but not included in C.I. case.

Routine Fire Report Complaint \_\_\_\_\_

Building Interior Fire Damaged/poor Building Exterior Fire Damaged/Poor Yard Poor

CONDITION Over 50% Dilapidated \_\_\_\_\_ Poor X Fair \_\_\_\_\_ Good \_\_\_\_\_ New \_\_\_\_\_

DATE OF PICTURE \_\_\_\_\_ 12/5/80 ROLL NO. Polaroid

PROGRESSIVE CASE HISTORY: Staff Estimate To: Repair Incomplete Inspection

This is a two story two flat dwelling approximately 1100sq.ft. ea. unit with the second story flat severely fire damaged and not secured. This dwelling is in Preservation Area #3 which requires clearance from Blanning to obtain a demolition permit.

PG: E -- # 125633  
SPG+E -- # 116655 } REMOVE METER

SMUN # ALREADY REMOVED

DATE 12/5/80 CT. # \_\_\_\_\_ CASE NO. 4455 EXEX R/S/D



MEMO

TO: Preservation Board  
FROM: Cynthia St. Louis, Assistant Planner  
SUBJECT: Non-Residential Building Survey

Attached is a list of all the buildings that were originally identified as being potentially eligible for inclusion on the inventory. Buildings that were subsequently deleted because they dated after 1941 have not been shown on the list. Buildings that were subsequently deleted because of major alterations and/or lack of architectural distinction are indicated as being deleted.

Please review.

NON-RESIDENTIAL BUILDING SURVEY.

LIST OF BUILDINGS CONSIDERED FOR POTENTIAL INCLUSION ON THE INVENTORY

C Street

1100  
 1131  
 1201-1217  
 1206  
 1218-1222  
 1236  
 1721  
 1800  
 1809 (R)  
 1828-1830  
 2600 (deleted) minimal

D Street

831  
 1013 (R)  
 1530

E Street

800  
 1001  
 1917

F Street

1220 rear (R)  
 1730  
 2010 rear (R)  
 2301

G Street

1210 (deleted) altered  
 contemporary  
 1211-1215  
 1400  
 2718

H Street

1115-1123  
 2030  
 3020

I Street

800  
 801  
 814  
 828  
 Plaza Park  
 915  
 1112  
 1201  
 1301 (deleted) minimal  
 1311 (deleted) altered  
 contemporary  
 1330  
 1411  
 1517  
 1616  
 1700  
 1717 (deleted) altered  
 contemporary  
 1912-1914 (deleted) altered  
 contemporary  
 1915 rear (R)  
 2020 (deleted) very  
 altered  
 2329-2331  
 2415 rear (R)

J Street

428  
 600  
 631  
 700  
 709-711 (deleted) very  
 altered  
 (R)  
 723  
 727  
 800  
 801 (R)



K Street

1106-1112  
 1214-1214½  
 1216-1218 (R) (deleted) too altered  
 1217-1219  
 1225-1227 (R)  
 1414  
 1700  
 1701  
 1714 (deleted) altered, minimal  
 2001 (R)  
 2114 (deleted) altered, minimal  
 2131  
 2301 (deleted) minimal  
 2323 rear (R)  
 2330-2330½  
 2631 (deleted) minimal  
 2719

L Street

701-723  
 729  
 805  
 812  
 815 (deleted) altered, minimal  
 824  
 830  
 1531  
 1616  
 1700  
 1701  
 1726 (deleted) altered  
 distinctively  
 1800-1804  
 1830  
 2101  
 2208 rear  
 2324  
 2700  
 2701  
 2820 (R)  
 3020

N Street

1020  
 1300  
 1614 (deleted) residential  
 building  
 1619  
 2022 (deleted) altered  
 distinctively  
 2400

N Street

2812 (deleted) too altered,  
 minimal

O Street

806  
 1000 (deleted) altered  
 1020  
 1021  
 1100 (deleted) altered  
 1108 (deleted) too recent  
 1215 (deleted) minimal values  
 2019  
 2300 (deleted) altered  
 2400 (deleted) altered, minimal  
 2630  
 3001 (deleted) address change

P Street

418  
 1025  
 1212 (deleted) residential  
 1531  
 1829-1831 (deleted) altered minimal  
 1928 (deleted) altered  
 distinctively  
 2001  
 2104 (deleted) minimal with some  
 alterations  
 2114  
 2500

Q Street

530  
 1500  
 1910  
 3030

R Street

800  
 SMUD (8th & R)  
 1001  
 1015 (R)  
 1021 (R)  
 1108  
 1119  
 1409-1413  
 1423-1425 (R)

R Street

1430 (deleted) minimal and altered

S Street

300 (R)

723

730

1201

2333

2809 (deleted) altered

2830 (deleted) minimal

3001 (R)

T Street

400 (deleted) altered minimal

401

601

1100 (deleted) altered minimal

1101 (deleted) altered

2620

2800

2801 (deleted) altered minimal

3030

U Street

1300 (deleted) altered minimal

1400 (R)

V Street

411 (R)

1017½ (R)

1700

2600

Second Street

1801 (R)

Fourth Street

S.P. Depot (4th & I)

1006

1700

1906-1908

Fifth Street

2117 (deleted) minimal and too recent?

2200 (R)

Sixth Street

SMUD Substation A (6th & H)

813

1915 (R)

Southside Park (6th-8th, T-W)

Seventh Street

814

923

1009-1011

1013 (R)

1015

1109 (R)

1118-1120 (deleted) altered minimal

1121 (R)

1122-1126

1801

1909

Eighth Street

918-926

919

1109

1117-1123

1200 (deleted) minimal

1225 (R)

1720 (R)

2115 (R)

Ninth Street

916-920 (R)

922

1009-1011

1015

1019-1025

1107

1121-1125

1220

1802 (R)

2014 (R)

Tenth Street

500  
 921  
 1011  
 1012  
 1014 (R)  
 1016-1020  
 1017 (R)  
 1019  
 State Capitol  
 Capitol Park  
 1116 (deleted) altered minimal  
 1400  
 1713-1715½  
 1724  
 1801  
 1901 (R)  
 2200 block (deleted) not culturally significant

Eleventh Street

323 (deleted) altered  
 414  
 908 (deleted) altered minimal  
 921  
 1012-1014 (R)  
 1017-1025  
 1106  
 1110  
 1112 (deleted) altered minimal  
 1117-1131  
 1800  
 1801  
 2005-2009 (R)

Twelfth Street

318  
 404-408  
 410-412 (deleted) altered minimal  
 511 (deleted) related to  
 513 (deleted) 517 substation?  
 516-520  
 517  
 519-531 (deleted) altered minimal  
 528-530  
 601 (deleted) altered minimal  
 707-715  
 710-714  
 728 (deleted) listed with  
 1115-1123 H blockface group  
 816  
 904-906 (R)  
 907-909 (deleted) minimal

Twelfth Street

908-910 (deleted) minimal altered  
 912-914  
 1011-1013  
 Weinstock's  
 1123-1131  
 Senator Hotel  
 1407 (deleted) minimal

Thirteenth Street

604 (deleted) altered, very  
 1221 (deleted) minimal  
 1927 (deleted) minimal  
 2203-2207 (deleted) minimal

Fourteenth Street

1009 (deleted)  
 1900 (deleted) minimal, altered  
 1903-1909 (deleted) minimal, altered

Fifteenth Street

318-326 (R)  
 615 (deleted) very minimal  
 1012  
 1015

Sixteenth Street

500  
 614  
 1412-1414  
 1417-1421 (deleted) altered minimal  
 1512-1514  
 1516-1520 (deleted) altered  
 1721 (R)  
 1804  
 1819-1821 (deleted) altered, minimal  
 1825-1829 (deleted) altered, minimal  
 1926-1930  
 2030 (deleted) altered, minimal  
 2114 (deleted) minimal  
 2116 (deleted) residential  
 2200-2212 (deleted) minimal  
 block face  
 2201-2205 (deleted) minimal  
 block face  
 2215 (deleted) residential

Seventeenth Street

1122  
1731 (R)  
1812 (R)

Eighteenth Street

1630  
1707  
1906-1908½

Nineteenth Street

214 (listed)  
1215 (listed)

Twentieth Street

417  
911-915  
920  
923  
1721

1500

Twenty First Street

814  
1800 (R)  
1801 (R)  
2504

Twenty Second Street

1430 (deleted) minimal

Twenty Fourth Street

920 (deleted) minimal  
1730 (deleted) minimal (very)  
1821

Twenty Fifth Street

617-617½ (deleted) very minimal  
1220 (deleted) too recent  
1731

Twenty Sixth Street

1112  
1802 (R)

Twenty Seventh Street

1400  
1730 (deleted) very minimal

Twenty Eighth Street

1601 (deleted) altered minimal  
1616

Alhambra

601  
800-806  
1025 Theater fountain  
1125  
1201 (deleted) minimal  
1221

Broadway

1517  
1518  
1710-1716  
1730  
2020  
2201  
2300  
2417

Capitol

Tower Bridge  
111 (deleted) altered  
River Lines Building  
914  
915  
1800  
1801  
1806  
1926  
2015 (R)  
2231  
2726-2728  
2727 (deleted) altered  
2801

Front Street

1920 (R)  
2000 complex  
City of Sacramento  
Storage Building (Front & U)

Merchant Street

724--726

Stockton Blvd.

1724