

**CITY OF SACRAMENTO**

**1231 I Street, Sacramento, CA 95814**

**Permit No: 0007326**

**Insp Area: 4**

**Site Address: 391 LYMAN CR SAC**

Parcel No: 225-1290-012  
N

**NORTHPOINTE PARK 13-1 LOT 12**

**Sub-Type:**

**NSFR**

**Housing (Y/N):**

**CONTRACTOR**

WESTERN PACIFIC HOUSING  
1210 CENTRAL BLVD  
BRENTWOOD CA. 94513

**OWNER**

**ARCHITECT**

**Nature of Work: NSFR MP3582 2 STORY 10 RMS WITH BONUS OPTION**

**CONSTRUCTION LENDING AGENCY :** I hereby affirm under penalty of perjury that there is a construction lending agency for the performance of the work for which this permit is issued (Sec. 3097, Civ. C).

Lender's Name \_\_\_\_\_ Lender's Address \_\_\_\_\_

**LICENSED CONTRACTORS DECLARATION:** I hereby affirm under penalty of perjury that I am licensed under provisions of Chapter 9 (commencing with section 7000) of Division 3 of the Business and Professions Code and my license is in full force and effect.

License Class D License Number 675109 Date 9/7/00 Contractor Signature N. Collins

**OWNER-BUILDER DECLARATION:** I hereby affirm under penalty of perjury that I am exempt from the contractors License Law for the following reason (Sec. 7031.5, Business and Professions Code; any city or county which requires a permit to construct, alter, improve, demolish, or repair any structure, prior to its issuance, also requires the applicant for such permit to file a signed statement that he or she is licensed pursuant to the provisions of the Contractors License Law (Chapter 9 (commencing with Section 7000) of Division 8 of the Business and Professions Code) or that he or she is exempt therefrom and the basis for the alleged exemption. Any violation of Section 7031.5 by any applicant for a permit subjects the applicant to a civil penalty of not more than five hundred dollars (\$500.00);

\_\_\_\_\_, I, as a owner of the property, or my employees with wages as their sole compensation, will do the work, and the structure is not intended or offered for sale (Sec. 7044, Business and Professional Code: The Contractors License Law does not apply to an owner of property who builds or improves thereon, and who does such work himself or herself or through his/her own employees, provided that such improvements are not intended or offered for sale. If, however, the building or improvement is sold within one year of completion, the owner-builder will have the burden of proving that he/she did not build or improve for the purpose of sale.)

\_\_\_\_\_, I, as owner of the property, am exclusively contracting with licensed contractors to construct the project (Sec. 7044, Business and Professions Code: The Contractors License Law does not apply to an owner of property who builds or improves thereon, and who contracts for such projects with a contractor(s) licensed pursuant to the Contractors License Law).

\_\_\_\_\_, I am exempt under Sec. \_\_\_\_\_ B & PC for this reason: \_\_\_\_\_

Date \_\_\_\_\_ Owner Signature \_\_\_\_\_

**IN ISSUING THIS BUILDING PERMIT,** the applicant represents, and the city relies on the representation of the applicant, that the applicant verified all measurements and locations shown on the application or accompanying drawings and that the improvement to be constructed does not violate any law or private agreement relating to permissible or prohibited locations for such improvements. This building permit does not authorize any illegal location of any improvement or the violation of any private agreement relating to location of improvements.

I certify that I have read this application and state that all information is correct. I agree to comply with all city and county ordinances and state laws relating to building construction and hereby authorize representative(s) of this city to enter upon the abovementioned property for inspection purposes.

Date 9/7/00 Applicant/Agent Signature N. Collins

**WORKER'S COMPENSATION DECLARATION:** I hereby affirm under penalty of perjury one of the following declarations:

\_\_\_\_\_, I have and will maintain a certificate of consent to self-insure for workers' compensation as provided for by Section 3700 of the Labor Code, for the performance of work for which the permit is issued.

I have and will maintain workers' compensation insurance, as required by Section 3700 of the Labor Code, for the performance of the work for which this permit is issued. My workers' compensation insurance carrier and policy number are:

Carrier EAGLE INS. CO. Policy Number 48-0000273 Exp Date 03/19/2001

\_\_\_\_\_, (This section need not be completed if the permit is for \$100 or less) I certify that in the performance of the work for which this permit is issued, I shall not employ any person in any manner so as to become subject to the workers' compensation laws of California and agree that if I should become subject to the workers' compensation provisions of Section 3700 of the Labor Code, I shall forthwith comply with those provisions.

Date 9/7/00 Applicant Signature N. Collins

**WARNING:** FAILURE TO SECURE WORKER'S COMPENSATION COVERAGE IS UNLAWFUL AND SHALL SUBJECT AN EMPLOYER TO CRIMINAL PENALTIES AND CIVIL FINES UP TO ONE HUNDRED THOUSAND DOLLARS (\$100,000) IN ADDITION TO THE COST OF COMPENSATION, DAMAGES AS PROVIDED FOR IN SECTION 3706 OF THE LABOR CODE, INTEREST AND ATTORNEY'S FEE.

**THIS PERMIT SHALL EXPIRE BY LIMITATION IF WORK IS NOT COMMENCED WITHIN 180 DAYS.**

4

# RESIDENTIAL SUBDIVISION BUILDING PERMIT APPLICATION 0007326

Project Address: 391 Lyman Circle Assessor Parcel # 225-1290-012  
Lot Number: 12 Subdivision Northpointe Park Unit #13 Ph1

### OWNER INFORMATION:

Legal Property Owner: Western Pacific Housing Phone# (925) 634-6023  
Owner Address: 1210 Central Boulevard, City Brentwood, State Ca. Zip 94513

### CONTRACTOR INFORMATION:

Contractor: Western Pacific Lic# 675709/B Phone # (925) 634-6023 Fax 634-6166

### PROJECT INFORMATION:

Land Use Zone R1A Occupancy Group R3 Construction Type VN Fed Code 1A  
No. of Stories: 2 No. of Rooms: \_\_\_\_\_ Street Width: \_\_\_\_\_  
1<sup>st</sup> Floor Area 1815 2<sup>nd</sup> Floor Area 1844 Basement \_\_\_\_\_ Roof Material \_\_\_\_\_  
AREA IN SQUARE FOOT OF:  
Dwelling/Living 3659  
Garage/Storage 636  
Decks/Balconies 143  
Carpets \_\_\_\_\_

SCOPE OF WORK: \_\_\_\_\_

FOR OFFICE USE ONLY

- Information Above Complete
- Violation Files Checked
- Standard Setbacks
- County Sewer
- AR Flood Waiver Required
- Flood Elevation Certificate Required
- Water Development Infill Area
- Planning Approval
- Design Review Approval
- Special Fee Districts Apply:

**—THE FOLLOWING MUST BE PROVIDED IN ORDER TO SUBMIT FOR PERMIT—**

- 2 COMPLETE PLOT PLANS, LEGIBLE & DRAWN TO SCALE
- 11 X 17 COPY OF FLOOR PLAN WITH FOLLOWING INFORMATION:
  - a) Assessor's Parcel Number
  - b) New Floor Area
  - c) Owners Name
  - d) Project Address

# CERTIFICATION OF INSULATION

WESTERN PACIFIC  391 Lyman BELLAGIO	LOT # 12	<input checked="" type="checkbox"/> P.O. BOX 854, WEST SACRAMENTO, CA 95691 LIC. #202026 <input type="checkbox"/> 1309 MELODY ROAD, MARYSVILLE, CA 95901 LIC. #202026 <input type="checkbox"/> P.O. BOX 9651, FRESNO, CA 93793-9651 LIC. #202026 <input type="checkbox"/> P.O. BOX 1631, RENO, NV 89505 LIC. #10675 <input type="checkbox"/> 3326 A PONDEROSA WAY, LAS VEGAS, NV 89118 LIC. #10675
DATE INSULATION COMPLETED		

WALLS		CEILING			FLOORS	
( SQUARE FEET )		( SQUARE FEET )			( SQUARE FEET )	
TYPE OF INSULATION		TYPE OF INSULATION			TYPE OF INSULATION	
MATERIAL <b>FIBERGLASS</b>	MATERIAL <b>FIBERGLASS</b>	MATERIAL <b>FIBERGLASS</b>			MATERIAL <b>FIBERGLASS</b>	
FORM <b>BATTS</b>	FORM <b>BATTS &amp; BLOW</b>	FORM <b>BATTS</b>			FORM <b>BATTS</b>	
MANUFACTURER'S PRODUCT I D		MANUFACTURER'S PRODUCT I D			MANUFACTURER'S PRODUCT I D	
MANUFACTURER		MANUFACTURER			MANUFACTURER	
OCF		OCF			OCF	
R-VALUE INSTALLED	APPLIED THICKNESS	R-VALUE INSTALLED	APPLIED THICKNESS	MIN. INSTALLED WEIGHT PER SQUARE FOOT	R-VALUE INSTALLED	APPLIED THICKNESS
13	3 5/8	30 30	9" 12"			

**KNEE WALLS IF R-VALUE IS OTHER THAN WALLS ABOVE**

MATERIAL <b>FIBERGLASS</b>	FORM <b>BATTS</b>	R VALUE	MANUFACTURER <b>OCF</b>
-------------------------------	----------------------	---------	----------------------------

**AIR INFILTRATION SEALANT**

MATERIAL <b>FOAM</b>	MANUFACTURER <b>W R GRACE</b>
-------------------------	----------------------------------

**VERIFY THAT INSTALLATION AND/OR SEALANT HAS BEEN INSTALLED IN CONFORMANCE WITH APPLICABLE CODES, STANDARDS AND REGULATIONS.**

SIGNATURE—INSULATION CONTRACTOR <i>Bill Grogan</i>	TITLE MANAGER	DATE 2-1-01
SIGNATURE—GENERAL CONTRACTOR	TITLE	DATE

REMARKS

**KWIKKOTE**  
STUCCO SYSTEM  
INSTALLATION CARD

# 20679  
Western Pacific Housing  
Bellagio Lot 12  
391 Lyman Circle Sacramento

Stucco System Trade Name: KWIK KOTE  
Name Stucco Manufacturer: KWIK KOTE CORP  
ICBO Evaluation Service, Inc. Report No. 3607  
Date of Job Completion \_\_\_\_\_

Stucco Contractor Kenyon Plastering, Inc.  
Name John W. Kenyon, III  
Address P.O. Box 2077  
North Highlands, CA 95660  
Telephone # (916) 349-8191

Approved Contractor Number as issued by the Stucco Manufacturer: 1

This is to certify that the stucco system on the building exterior at the above address had been installed in accordance with the evaluation report specified above and the manufacturer's instructions.

Signature of authorized representative of stucco contractor:

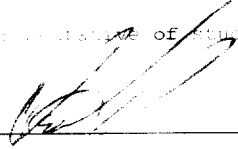

Date: 2/2/00

Builder Copy

**KWIKKOTE**  
STUCCO SYSTEM  
INSTALLATION CARD

# 20679  
Western Pacific Housing  
Bellagio Lot 12  
391 Lyman Circle Sacramento

Stucco System Trade Name: KWIK KOTE  
Name Stucco Manufacturer: KWIK KOTE CORP  
ICBO Evaluation Service, Inc. Report No. 3607  
Date of Job Completion \_\_\_\_\_

Stucco Contractor Kenyon Plastering, Inc.  
Name John W. Kenyon, III  
Address P.O. Box 2077  
North Highlands, CA 95660  
Telephone # (916) 349-8191

Approved Contractor Number as issued by the Stucco Manufacturer: 1

This is to certify that the stucco system on the building exterior at the above address had been installed in accordance with the evaluation report specified above and the manufacturer's instructions.

Signature of authorized representative of stucco contractor:

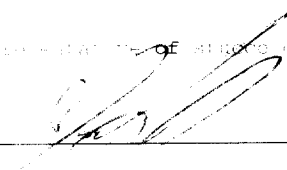

Date: 2/2/00

Subcontractor Copy

JUN-07-00 WED 08:57

FAX NO. 9219274

P. 03/11

LEGEND

→ SWALE  
□ MAILBOX

✶ WOOD FENCE  
○ SIDEYARD GATE

SS SEWER SERVICE  
WS WATER SERVICE

□ UTILITY SERVICE  
F.F. FINISH FLOOR

Vertical text on the left side of the plan, possibly a title or reference note, partially obscured and difficult to read.

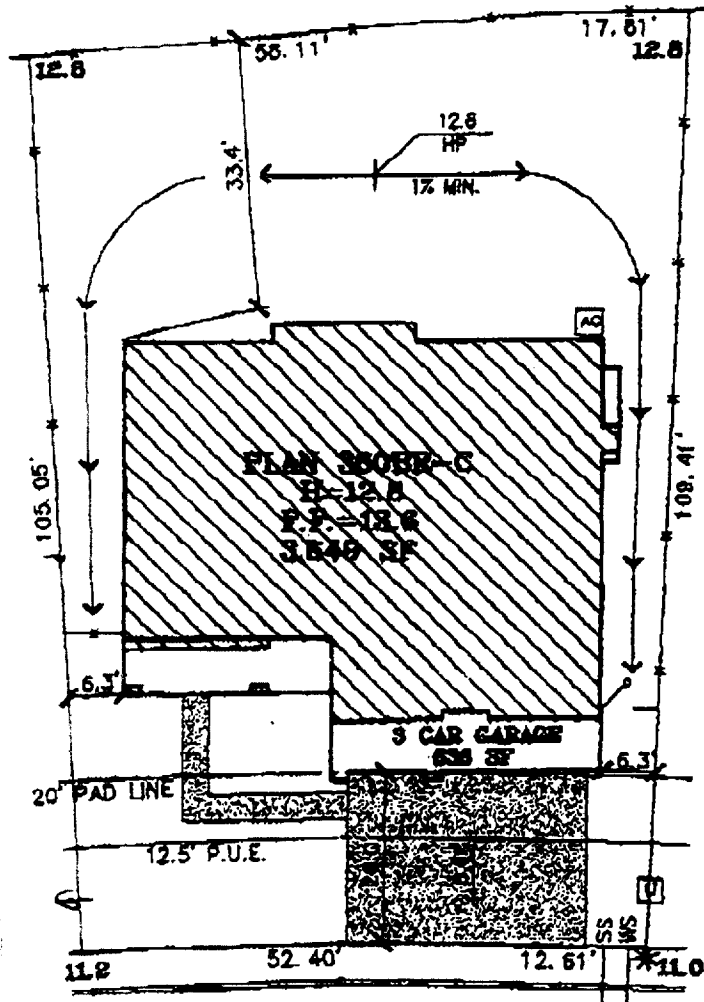

LYMAN CIRCLE

LOT 12  
PLAN 3608R-C  
A.P.N.:  
ADDRESS: 501 LYMAN CIRCLE  
LOT AREA: 7,582 SF

DUE TO THE UNIQUE CONDITIONS OF THIS LOT, THE BUYER HAS REVIEWED AND APPROVED THE SITE FINAL GRADING CONDITIONS. THESE MAY VARY. THE INFORMATION ON THIS PLOT PLAN IS PROVIDED FOR YOUR CONVICTION AS A GUIDE TO THE GENERAL LOCATION OF THE SUBJECT PROPERTY. THE ACCURACY OF THIS PLOT PLAN IS NOT GUARANTEED NOR IS IT A PART OF ANY POLICY, REPORT OR GUARANTEE TO WHICH IT MAY BE ATTACHED. ACTUAL DIMENSIONS MAY VARY OR CHANGE WITHOUT PRIOR NOTICE DUE TO ACTUAL SITE CONDITIONS.

PLAN: \_\_\_\_\_ SIGNED (BUYER) \_\_\_\_\_ DATE \_\_\_\_\_  
ELEVATION: \_\_\_\_\_  
ORIENTATION: \_\_\_\_\_ PROJECT SUPERINTENDENT APPROVAL \_\_\_\_\_ DATE \_\_\_\_\_  
COLOR: \_\_\_\_\_ SITE SUPERINTENDENT APPROVAL \_\_\_\_\_ DATE \_\_\_\_\_  
ESTIMATING APPROVAL \_\_\_\_\_ DATE \_\_\_\_\_  
SALES APPROVAL \_\_\_\_\_ DATE \_\_\_\_\_  
CONSTRUCTION APPROVAL \_\_\_\_\_ DATE \_\_\_\_\_

The **Spink** Corporation  
2500 VENTURE OAKS WAY  
SACRAMENTO, CA 95833

**Western Pacific Housing**  
1210 Central Boulevard  
Brentwood, CA 94513  
office: (925) 834-6023  
fax: (925) 834-6068

**BELLAGIO**  
NORTHPOINTE PARK VILLAGE 1S PHASE 1  
City of Sacramento, California

Scale: 1"=20'

June 7, 2000