



DEPARTMENT OF  
PARKS AND RECREATION  
  
PARK PLANNING, DESIGN &  
DEVELOPMENT DIVISION

**CITY OF SACRAMENTO  
CALIFORNIA**

1231 I STREET, #400  
SACRAMENTO, CA  
95814-2702

PH 916-264-8529  
FAX 916-264-8266

**March 16, 2005**

City Council  
Sacramento, California

Honorable Members in Session:

**SUBJECT: AWARD A CONSTRUCTION CONTRACT TO NAVARRETE  
LANDSCAPING IN THE AMOUNT OF \$400,950 FOR THE PHASE 2  
IMPROVEMENTS AT MCKINLEY PARK CIP (PN: LT87)**

**LOCATION AND COUNCIL DISTRICT:** 3330 McKinley Blvd., Council District 3

**RECOMMENDATION:**

This report recommends that Council, by resolution (page 4):

- Approves the awarding of the construction contract to Navarrete Landscaping in the amount of \$400,950 for the development of Phase 2 improvements for McKinley Park CIP (PN: LT87)

**CONTACT PERSON:** Janet Baker, Park Development Manager, 808-8234

**FOR COUNCIL MEETING OF:** April 5, 2005

**SUMMARY:**

McKinley Park is an existing 36-acre community park located at 3330 McKinley Blvd. in East Sacramento. The proposed action would award a construction contract to Navarrete Landscaping for the Phase 2 park improvements.



*Optimize the Experience of Living!*



**COMMITTEE/COMMISSION ACTION:**

The Citizen's Advisory Committee for Parks and Recreation (CAC) approved the McKinley Park Master Plan Amendment for Phase 2 improvements, on December 4, 2003. The Master Plan Amendment was approved by CAC on January 13, 2004 (see Exhibit A, page 5).

**BACKGROUND INFORMATION:**

McKinley Park is an existing 36-acre community park located at 3330 McKinley Boulevard in East Sacramento (see Exhibit B, page 7). The Phase 2 improvements for McKinley Park would include pool improvements that place a seat wall, an 18 inch high wall designed for sitting, between the wading pool and the swimming pool; placement of walkways, the development of additional landscaping and a picnic area. Current McKinley Park amenities include eight tennis courts; a wading pool; a swimming pool; a rose garden; an adventure play area; a tot lot; and a community center.

This project was advertised and bids were received on March 9, 2005, and the bids are summarized as follows:

BIDDER	BASE BID	ADD ALTERNATE	TOTAL	SBE/ EBE % TOTAL
JMS & ASSOCIATES	\$98,639.15	\$331,153.00	\$429,792.15	65.4
OLYMPIC LAND CONSTRUCTION	\$122,844.28	\$279,833.90	\$402,678.18	85.5
AD LAND VENTURE	\$136,917.61	\$320,580.00	\$457,497.61	56.5
NAVARETTE LANDSCAPING	\$175,216.00	\$225,734.00	\$400,950.00	80.1
PAGNI CONSTRUCTION	\$189,211.00	\$308,506.00	\$497,717.00	64.8

Staff recommends that Council award the base bid of \$175,216 and the additive alternative item of constructing the picnic area for \$225,734 for a total construction award of \$400,950. Navarrete Landscaping was low bidder for the base bid and additive alternate with a bid of \$400,950.

**FINANCIAL CONSIDERATIONS:**

There are funds available in CIP (PN: LT87) to perform the Phase 2 McKinley Park Improvements. The additive alternate could be awarded due to a grant from the Land and Water Conservation Program grant of \$128,415.

**ENVIRONMENTAL CONSIDERATIONS:**

The Environmental Services Manager has determined that the proposed project is exempt from CEQA under Section Numbers: 15301(c) Existing park site and facilities; 15301 (l) Removal of small structures; 15302 (c) Replacement or reconstruction of an existing structure involving no expansion of capacity; 15303 (e) Installation of accessory structures; 15304(b) Planting of drought tolerant vegetation.

**POLICY CONSIDERATIONS:**

The Phase 2 Improvements for McKinley Park are consistent with the City Council's goals to preserve and expand arts and culture, open space, the urban forest, parks and recreational opportunities, and establish and strengthen community and regional partnerships to enhance the quality of life.

**ESBD EFFORTS:**

The selection of Landscape Architect consultants and contractors for this project followed City established guidelines for inclusion of ESBD firms.

Respectfully submitted,



---

ROBERT G. OVERSTREET,  
Director, Parks and Recreation

**RECOMMENDATION APPROVED:**

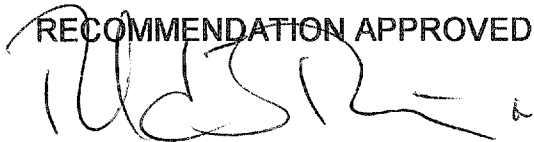

---

ROBERT P. THOMAS  
City Manager

**TABLE OF CONTENTS**

1. Resolution: Page 4
2. Exhibit A: McKinley Park Master Plan – Page 5
3. Exhibit B: McKinley Park Area Map –Page 7

**RESOLUTION NO.**

**ADOPTED BY THE CITY OF SACRAMENTO  
ON DATE: \_\_\_\_\_**

**AWARD A CONSTRUCTION CONTRACT TO NAVARRETE LANDSCAPING IN THE  
AMOUNT OF \$400,950 FOR THE PHASE 2 IMPROVMENTS AT MCKINLEY  
PARK CIP (PN: LT87)**

WHEREAS, CITY COUNCIL, ON MARCH 3, 2004, ESTABLISHED A NEW CAPITAL  
IMPROVEMENT PROJECT, APPROVED THE MASTER PLAN AMENDMENT, AND  
ASSOCIATED FUND TRANSFERS FOR PHASE 2 MCKINLEY PARK IMPROVEMENTS CIP  
(PN: LT87);

**NOW, THEREFORE, BE IT RESOLVED BY THE COUNCIL OF THE CITY OF  
SACRAMENTO THAT:**

The City Council hereby:

- Approves the awarding of a construction contract to Navarrete Landscaping in the amount of \$400,950 for the development of Phase 2 improvements for McKinley Park CIP (PN: LT87)

\_\_\_\_\_  
**MAYOR**

**ATTEST:**

\_\_\_\_\_  
**CITY CLERK**

\_\_\_\_\_  
**FOR CITY COUNCIL USE ONLY**

RESOLUTION NO.: \_\_\_\_\_

DATE ADOPTED: \_\_\_\_\_

# MCKINLEY PARK

## IMPROVEMENTS - PHASE 2

### PARK MASTER PLAN

MCKINLEY BOULEVARD

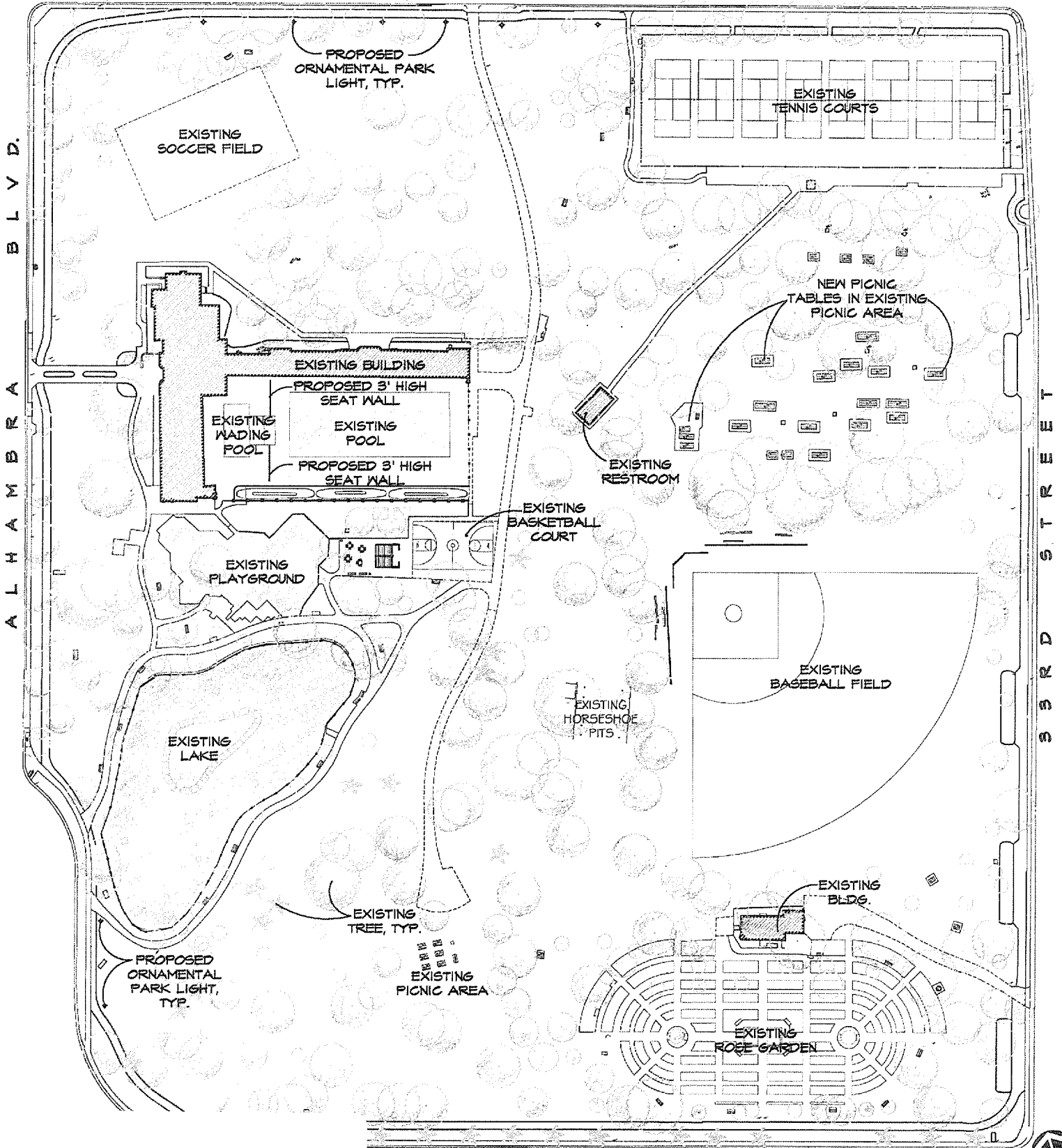
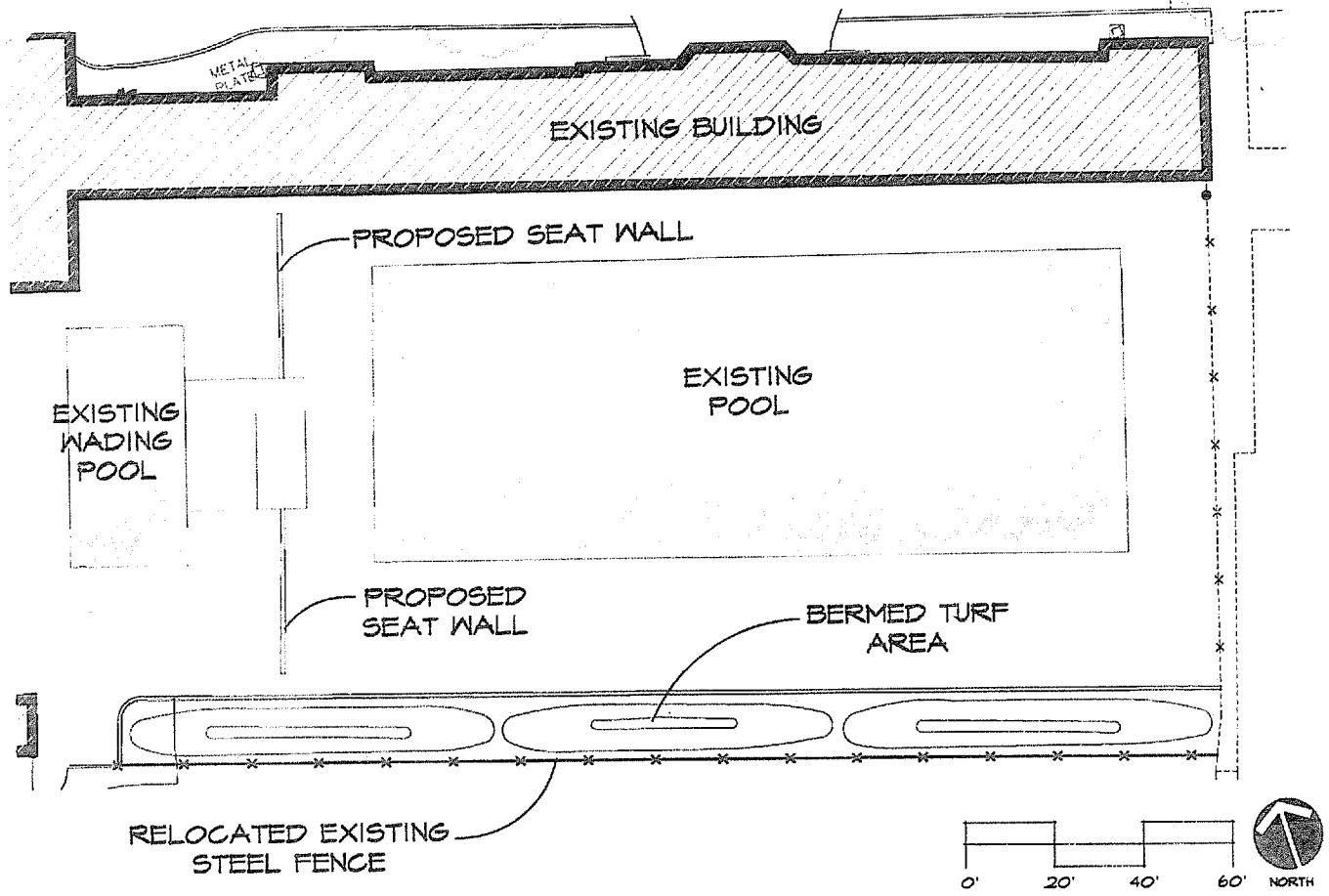

EXHIBIT A

H STREET



# MCKINLEY PARK IMPROVEMENTS - PHASE 2 PARK MASTER PLAN



## ENLARGED POOL FACILITY IMPROVEMENT PLAN

EXHIBIT A

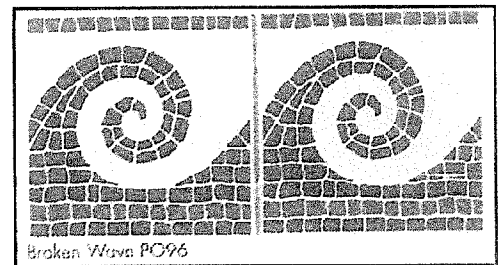

**\*6"X6" TILE BAND**

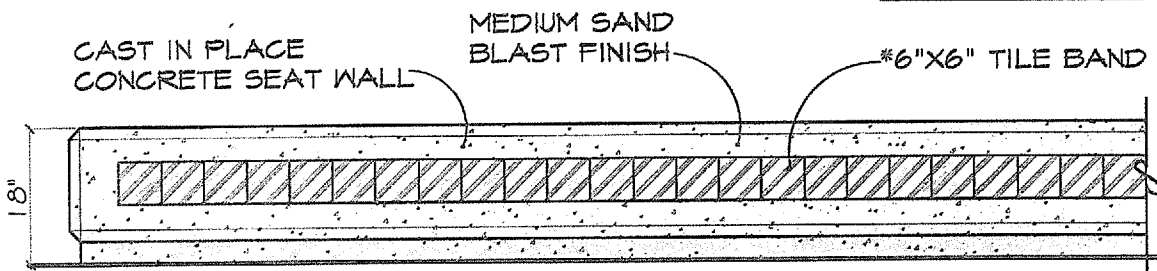

NOT TO SCALE

## SEAT WALL ELEVATION (CONCRETE W. TILES)

**EXHIBIT B**

**City of Sacramento  
Department of Parks and Recreation  
McKinley Park**

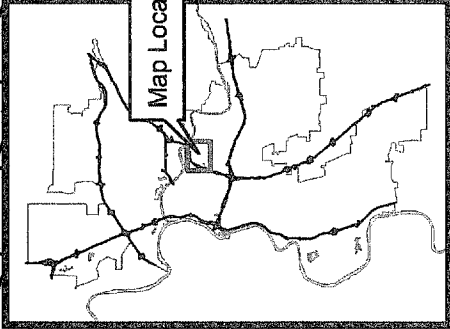
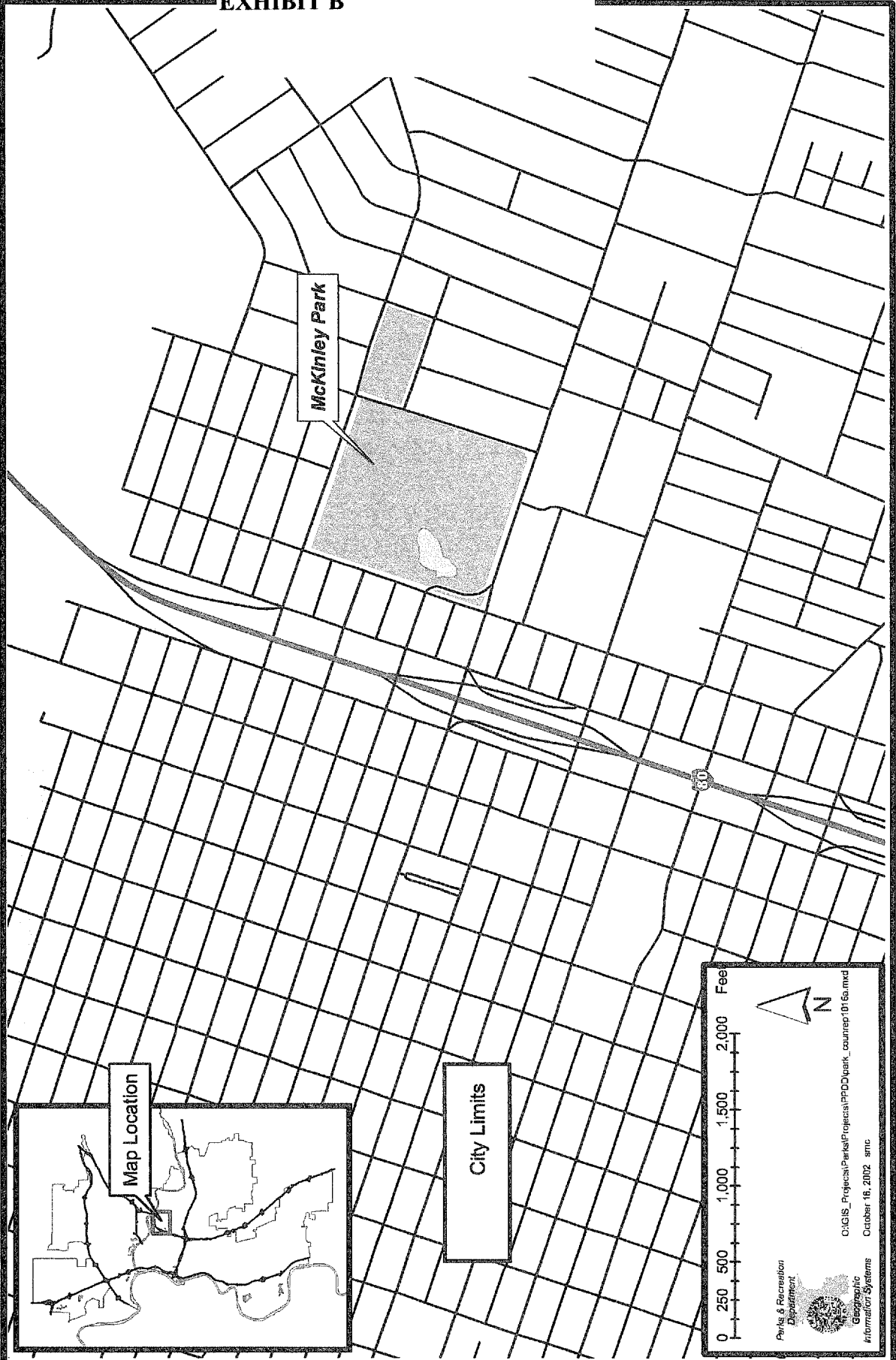

0 250 500 1,000 1,500 2,000 Feet

Parks & Recreation Department

Geographic Information Systems

C:\GIS\_Projects\Parks\Projects\PPDD\park\_courtnet\016a.mxd  
October 18, 2002 smc