

APPLICATION FOR PERMIT TO BUILD

Street No. 700 - 30th Lot 4 ~~W 1/2~~ N 1/4 Block G. H. - 29.30

Owner J. M. Imman Address 700 - 30th

Architect \_\_\_\_\_ Address \_\_\_\_\_

Contractor J. W. Johnston Address 2000 - I.

Kind of Building \_\_\_\_\_

Foundation \_\_\_\_\_

Posts Girder Span Mud Sills

1ST FLOOR 2ND FLOOR 3RD FLOOR 4TH FLOOR 5TH FLOOR 6TH FLOOR

Joists \_\_\_\_\_

Max. Span Build one story for Private Garage

Bearing Partitions 12' x 18' - 12' high 2 x 4 studs

Non-bearing Partitions Partition 2 sh. sections Roofing

Story Height Cement floor

Outside Walls \_\_\_\_\_

Ceiling Joists \_\_\_\_\_ Span \_\_\_\_\_

Roof \_\_\_\_\_ Rafters \_\_\_\_\_

Water Heater \_\_\_\_\_ Chimney \_\_\_\_\_

Size of Building—Length \_\_\_\_\_ Width \_\_\_\_\_ Height \_\_\_\_\_

It is hereby agreed that this building will be constructed in conformity with the Ordinances of the City of Sacramento and the Laws of the State of California.

Estimated cost, \$ 150<sup>00</sup>

Plans must be submitted.

J. W. Johnston  
Owner or Owner's Representative.

PERMIT  
1889  
DATE  
6/24/16.  
DISTRICT  
4.

H

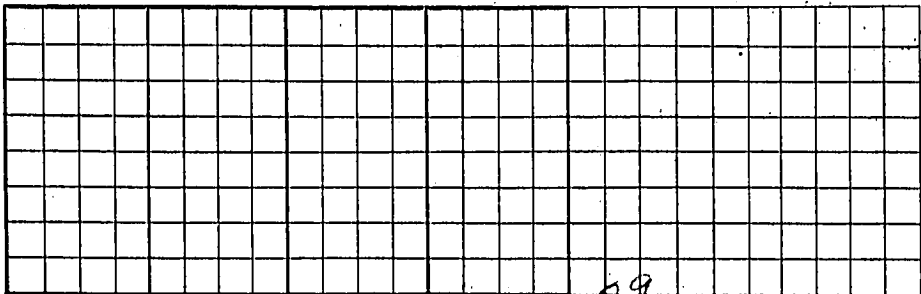

29

30

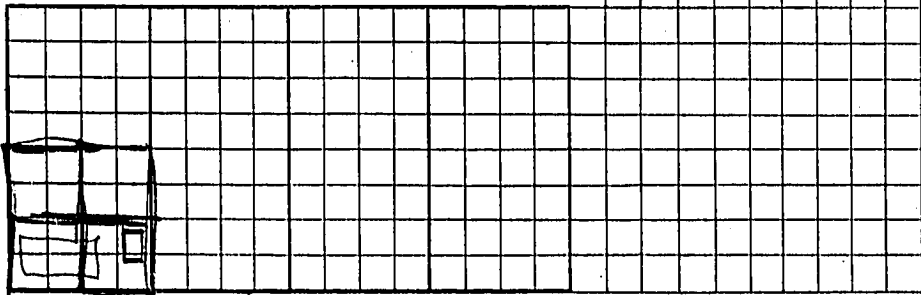

9.