



- c. Obtain a revocable encroachment permit pursuant to the Sacramento City Code.
- d. No parking shall be required for sidewalk cafes on the public right-of-way. Outdoor cafes located on private property shall provide off-street parking in accordance with the provisions of Section 6 of the Zoning Ordinance based on total indoor and outdoor seating.
- e. Sidewalk cafes shall be used only as seating areas. Storage, kitchen, or restroom uses are not allowed. Tables and/or chairs must be movable unless otherwise approved by the Zoning Administrator upon concurrence with other City Agencies/Departments.
- f. Placement of tables and/or chairs shall be limited to the sidewalk area frontage adjacent to the use.
- g. Tables and/or chairs shall be placed on sidewalks only in conjunction with a use that serves food and/or beverages. Service of alcoholic beverages on any sidewalk shall be pursuant to Sacramento City Code Chapter 26.
- h. A decorative element separating outdoor cafe seating area from adjacent pedestrian traffic must be provided. The design and materials of such element must complement and be compatible to the architectural design of the restaurant building facade or of a design that adds visual interest to the streetscape.
- i. Sidewalk cafes may be uncovered, partially covered or fully covered by means of umbrellas, awnings or canopies.
  - 1) Awning or canopy material covering a sidewalk cafe shall be temporary or retractable and may extend into the public right of way from the face of the building up to the maximum clear zone dimension of six feet. Width and height of awnings and canopies shall meet U.B.C. requirements. Awnings, canopies, umbrellas must be made of fire-treated or non-flammable materials.
- j. Decorative/accent lighting may be incorporated into the outdoor cafe awning or canopy and shall meet all City Code requirements.

- k. Upon approval by Zoning Administrator the applicant shall obtain all required building/electrical permits prior to construction.
- l. A City permit approving the sidewalk cafe and the allowed number of tables and/or chairs shall be displayed in a prominent location easily accessible to the public.

Section 3. Section 2-E-56 is hereby added to the Comprehensive Zoning Ordinance, No. 2550, Fourth Series, as amended, to read as follows:

56. See Section 2.98, Central Business District - Special Planning District (CBD-SPD) of this ordinance for sidewalk cafe regulations

Section 4. Section 22-A-125 is hereby added to the Comprehensive Zoning Ordinance, No. 2550, Fourth Series, as amended, to read as follows:

125. Sidewalk: In reference to sidewalk cafes, a sidewalk shall include all of the space between the property line and the outside curb line, whether used for pedestrian purposes, park purposes or otherwise.

**Date Passed for Publication:** June 22, 1993

**Date Enacted:** July 20, 1993

**Date Effective:** August 19, 1993

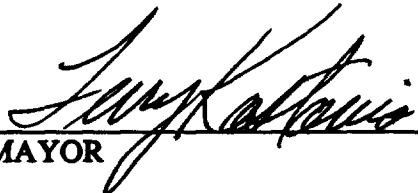
  
MAYOR

ATTEST:

  
CITY CLERK

---

FOR CITY CLERK USE ONLY

ORDINANCE NO.: 93-042  
DATE ADOPTED: JUL 20 1993

# TYPICAL CENTRAL CITY SIDEWALK CONFIGURATIONS OUTSIDE CBD

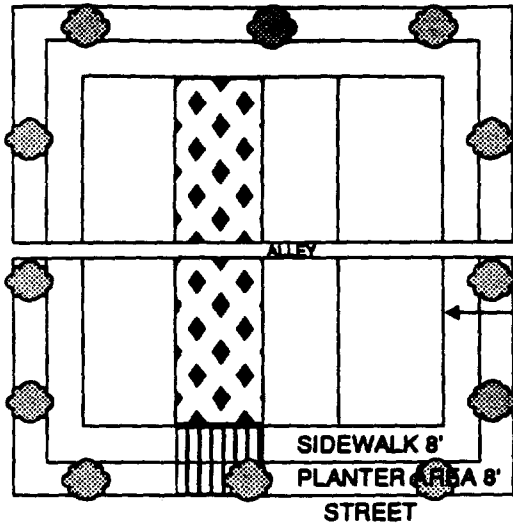

**MID BLOCK  
BUSINESS FRONTAGE**

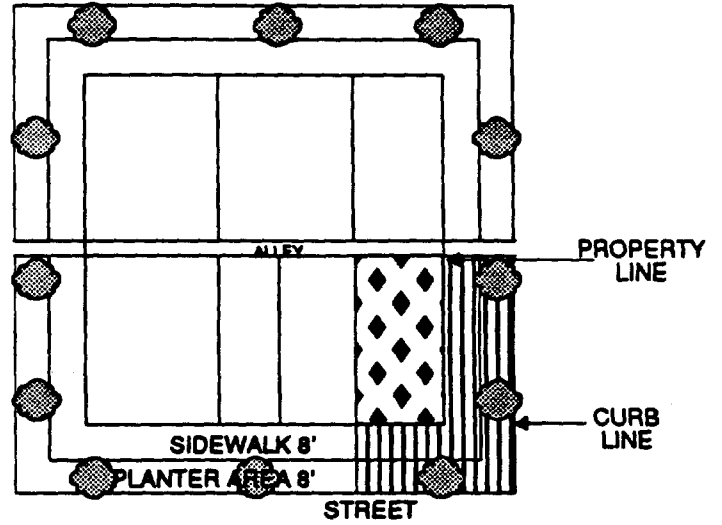

**CORNER  
BUSINESS FRONTAGE**

# TYPICAL SIDEWALK CONFIGURATIONS OUTSIDE CENTRAL CITY

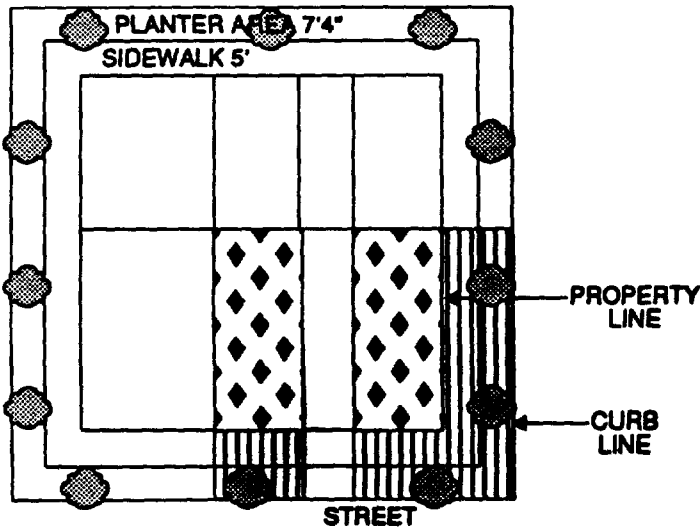

**MID BLOCK & CORNER  
BUSINESS FRONTAGE**

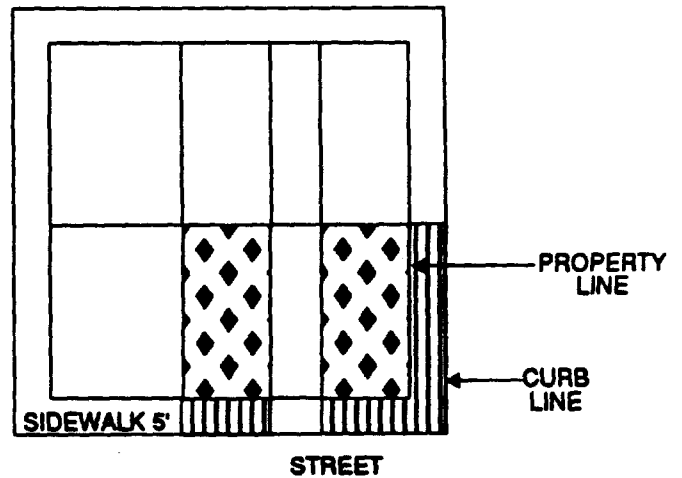

**MID BLOCK & CORNER  
BUSINESS FRONTAGE  
WITHOUT PLANTER AREA**

