



# CITY OF SACRAMENTO

13

## DIVISION OF WATER AND SEWERS

927 - 10TH ST.  
SUITE #201

SACRAMENTO, CALIFORNIA 95814  
TELEPHONE (916) 449-5271

CITY MANAGER'S OFFICE  
**RECEIVED**  
AUG 26 1981

HARRISON JOHNSON  
MANAGER  
ROBERT W. JOHNSTON  
ASSISTANT MANAGER

August 26, 1981

City Council  
Sacramento, CA

Honorable Members in Session:

SUBJECT: Request for Water Service Outside the City Limits

### SUMMARY

An application for water service outside the City limits has been received by the Division of Water & Sewers. City Code Section 47.41 requires that applications for water service outside the City limits be approved by the City Council. This report recommends approval of the application.

### BACKGROUND

By letter dated August 25, 1981, copy attached, water service has been requested to serve a residence at 4900 Siskiyou Avenue. The existing building is approximately 400 feet east of the City limits but near the City's water service area as acquired from the Southern California Water Service Company thru purchase of their system. Because of the emergency nature of this request and the single, detached parcel factor, annexation is not recommended. The applicant was advised to apply to the City Council in accordance with provisions of City Code Section 47.41, copy attached.

A City-owned 6" water main is approximately 73 lineal feet north of the parcel requesting service. Parcels to the north are also outside the City limits but are receiving City water through services installed by Southern California Water Service Company.

No other parcel on Siskiyou Avenue will require water service. If this application is denied, the property owner will be required to purchase a new pump which she states is beyond her financial capability.

### FINANCIAL DATA

The City will not realize any direct expense if the application is approved. Domestic service will be installed at the applicant's cost.

**APPROVED**  
BY THE CITY COUNCIL

SEP 1 1981

OFFICE OF THE  
CITY CLERK

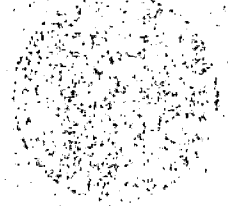

RECEIVED  
DATE  
TIME

COMMUNICATIONS SECTION  
RECEIVED  
DATE  
TIME

TO: [Illegible]

FROM: [Illegible]

SUBJECT: [Illegible]

[Illegible text block]

[Illegible text block]

[Illegible text block]

[Illegible text block]

[Illegible text block]

[Illegible text at bottom]

# 13

9-1-81

RECOMMENDATION

It is recommended the applicant's request for service be approved under the conditions set forth in the City Code.

Respectfully submitted,

  
Robert W. Johnston  
Acting Manager

Approval recommended:

  
R. H. Parker  
City Engineer

Recommendation approved:

  
Walter J. Slupe  
City Manager

Attachment

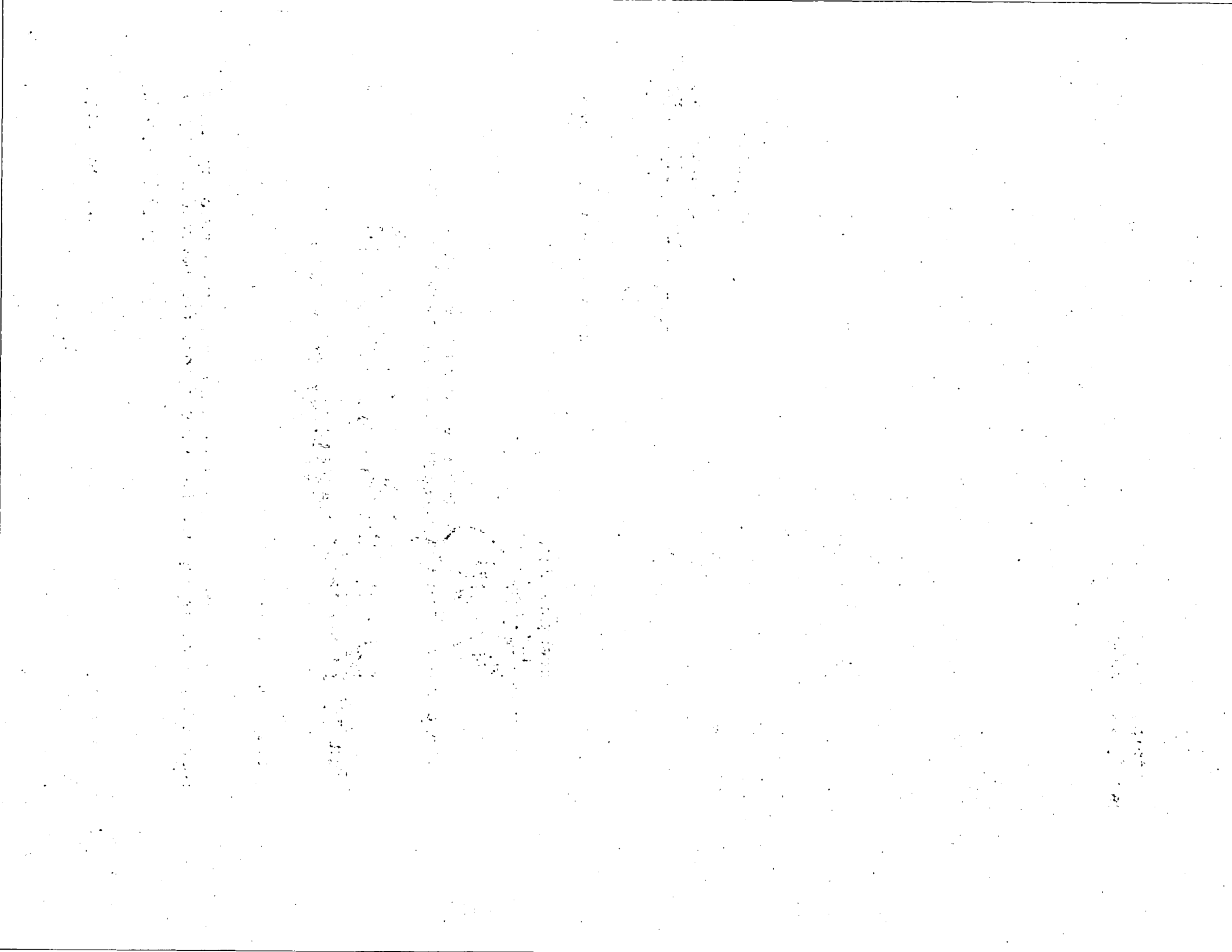

#13  
9/8/81

CITY OF SACRAMENTO  
DIVISION OF WATER

Application for Special Permit for Connection to Water  
Mains Extension Outside the City

Date: 8-26-81

Owner's Name Opal M. Tindle  
Property Location 4900 Siskiyou Avenue  
Lot Number 022-034-0500 Lot Size 78 x 103  
Building Existing? Single Family  
To be Constructed: ---  
Water Service Size 1"  
Number of Plumbing Fixtures 4

In order to protect the water system of the City of Sacramento from possible contamination from the use of defective or improper materials or appliances and to prevent backflow, it is hereby agreed by the undersigned that all plumbing for potable water distribution on the above property shall be in accordance with the requirements of this code or other ordinances of the City.

I also understand that I am purchasing surplus water only, that any agreement to purchase such surplus water does not guarantee quality (or pressure), and that neither the City Council of Sacramento nor the City of Sacramento assumes liability or obligation should surplus water not be available.

Signed: Opal M. Tindle  
Owner

4900 Siskiyou Avenue  
Address

ing Others  
p Themselves



**FRUITRIDGE**  
**NEIGHBORHOOD CENTER**  
4445 FRUITRIDGE ROAD  
sacramento, ca 95820

#13  
9/1/81

(916) 456-4701  
739-8208 KEN SANDERS

Executive Director,  
Thomas R. Stratton

August 25, 1981

Mr. Robert W. Johnston  
City of Sacramento  
Water and Sewers Division  
927 10th Street, Suite 201  
Sacramento, California

Dear Mr. Johnston:

I Opal Tindle would like to request the City of Sacramento to move the main water line on my street, Siskiyou Avenue, down approximately One-hundred (100) feet so that I will be able to tap into the city water lines. My pump has just broken down, and it would not be financially feasible for me to have it repaired at this time. I contacted the Odell Water Pump Company, and they suggested that the best alternative for me would be to tap into the city water lines. I have not had any running water for a month, and it is very inconvenient to continue to borrow water from my neighbors. If you could do something to resolve this problem, it would be greatly appreciated.

Sincerely yours,

Bill Spooner

Sincerely yours,

Opal Tindle

OT/ad

**A Community-Based, Multi-Service Agency**  
HOME INSULATION/Weatherization • EMERGENCY HOME REPAIRS  
YOUTH TRAINING • SENIOR CITIZENS SERVICES • CHILDREN'S SERVICES

187-190 #

14th

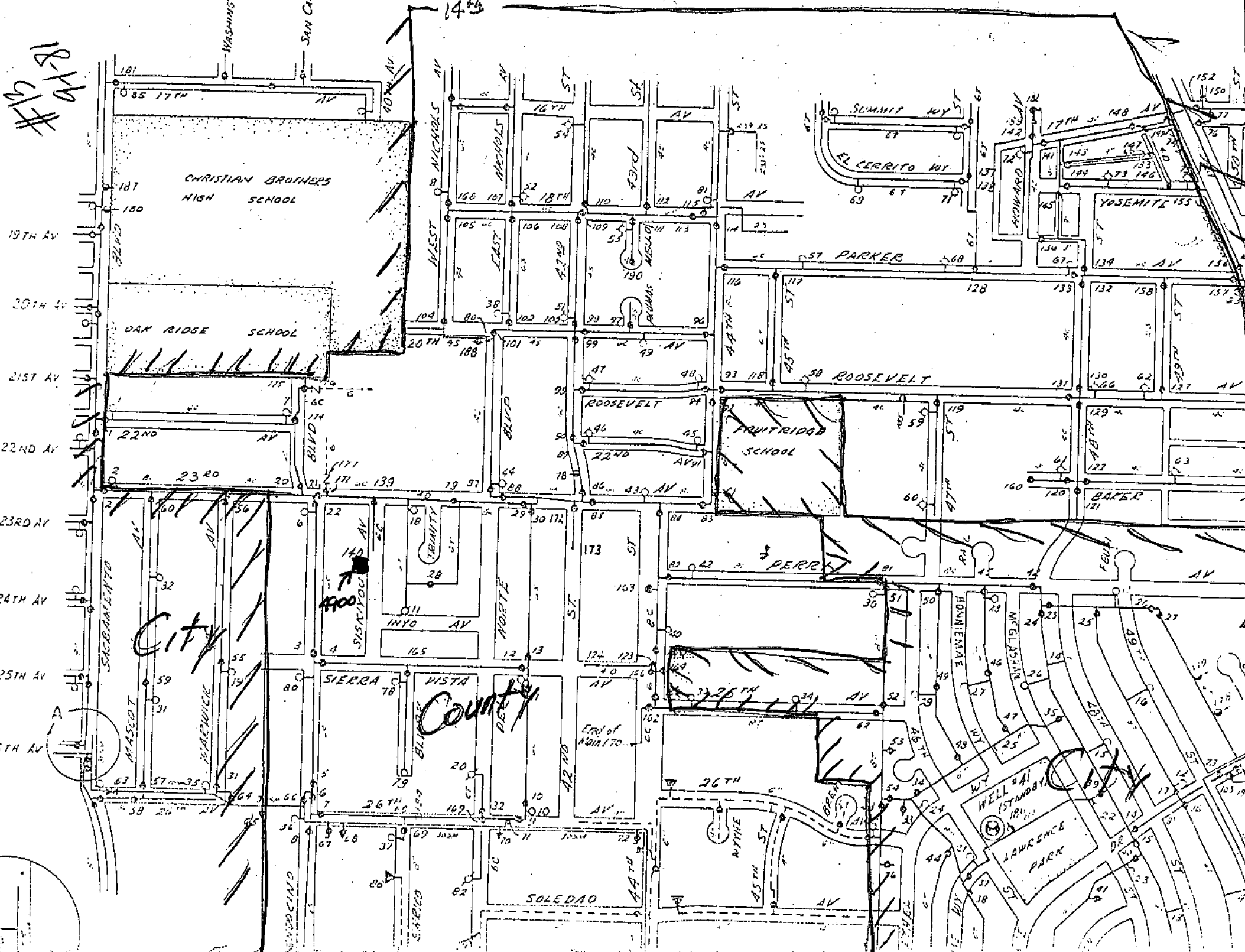

City

County

CHRISTIAN BROTHERS  
HIGH SCHOOL

OAK RIDGE SCHOOL

FRUITRIDGE  
SCHOOL

LAWRENCE  
PARK



# 13  
9-18-81  
C

as to size, type and quality of materials and location of mains. (Ord. No. 1202, § 1)

Sec. 47.38 Certification of approval of installation.

If the superintendent of the division of water certifies in writing that the plans and specifications submitted conform to the requirements of the division of water, the applicant may cause the water distribution to be installed either by private contract or by the procedure prescribed by the Streets and Highways Code for special assessment proceedings. (Ord. No. 1202, § 1)

Sec. 47.39 Inspection of installation.

The superintendent of the division of water shall have the right to inspect all work performed and all work must be approved by the superintendent after inspection before the distribution system shall be connected to the water system of the city. (Ord. No. 1202, § 1)

Sec. 47.40 Distribution system to become property of the city.

Upon connection of the distribution system to the water system of the city, the distribution system shall become the property of the city. (Ord. No. 1202, § 1)

Division 2. Subdivisions Outside the City Limits

Sec. 47.41 Approval of city council.

No application for water service to any subdivision located outside the city limits shall be granted without approval by the city council. (Ord. No. 1202, § 1)

Sec. 47.42 Application for certification.

Applications to the superintendent of the division of water for water service to subdivisions and users located outside of the city limits may be granted only in areas where surplus water is available in excess of the adequate needs for abundant use by the consumers within the city limits, and where the granting of such service is not deemed detrimental to existing services or inimical to the interests and operations of the division of water. (Ord. No. 1202, § 1)

Sec. 47.43 Special permit--Required.

All applicants for city water service to users outside of the city limits shall secure a permit from the health department. The permit shall not be issued unless it is found that the