

CITY OF SACRAMENTO
1231 I Street, Sacramento, CA 95814

Permit No: 9910525
Insp Area: 2

Site Address: 695 STILL BREEZE WY SAC
Parcel No 031-1340-100

Sub-Type: AOTHR
Housing (Y/N): N

CONTRACTOR
PACIFIC BUILDERS
5421 87TH ST
SACRAMENTO CA 95826

OWNER
JACK EVANS

ARCHITECT

Nature of Work: 2 PATIO COVERS 9X16 & 12X12

CONSTRUCTION LENDING AGENCY : I hereby affirm under penalty of perjury that there is a construction lending agency for the performance of the work for which this permit is issued (Sec. 3097, Civ. C).

Lender's Name _____ Lender's Address _____

LICENSED CONTRACTORS DECLARATION: I hereby affirm under penalty of perjury that I am licensed under provisions of Chapter 9 (commencing with section 7000) of Division 3 of the Business and Professions Code and my license is in full force and effect.

License Class B-1 License Number 217904 Date 9-17-99 Contractor Signature [Signature]

OWNER-BUILDER DECLARATION: I hereby affirm under penalty of perjury that I am exempt from the contractors License Law for the following reason (Sec. 7031.5, Business and Professions Code; any city or county which requires a permit to construct, alter, improve, demolish, or repair any structure, prior to its issuance, also requires the applicant for such permit to file a signed statement that he or she is licensed pursuant to the provisions of the Contractors License Law (Chapter 9 (commencing with Section 7000) of Division 8 of the Business and Professions Code) or that he or she is exempt therefrom and the basis for the alleged exemption. Any violation of Section 7031.5 by any applicant for a permit subjects the applicant to a civil penalty of not more than five hundred dollars (\$500.00).

I, as a owner of the property, or my employees with wages as their sole compensation, will do the work, and the structure is not intended or offered for sale (Sec. 7044, Business and Professional Code: The Contractors License Law does not apply to an owner of property who builds or improves thereon, and who does such work himself or herself or through his/her own employees, provided that such improvements are not intended or offered for sale. If, however, the building or improvement is sold within one year of completion, the owner-builder will have the burden of proving that he/she did not build or improve for the purpose of sale.)

I, as owner of the property, am exclusively contracting with licensed contractors to construct the project (Sec. 7044, Business and Professions Code: The Contractors License Law does not apply to an owner of property who builds or improves thereon, and who contracts for such projects with a contractor(s) licensed pursuant to the Contractors License Law).

I am exempt under Sec. _____ B & PC for this reason: _____

Date 9-17 Owner Signature _____

IN ISSUING THIS BUILDING PERMIT, the applicant represents, and the city relies on the representation of the applicant, that the applicant verified all measurements and locations shown on the application or accompanying drawings and that the improvement to be constructed does not violate any law or private agreement relating to permissible or prohibited locations for such improvements. This building permit does not authorize any illegal location of any improvement or the violation of any private agreement relating to location of improvements.

I certify that I have read this application and state that all information is correct. I agree to comply with all city and county ordinances and state laws relating to building construction and hereby authorize representative(s) of this city to enter upon the abovementioned property for inspection purposes.

Date 9-17-99 Applicant/Agent Signature [Signature]

WORKER'S COMPENSATION DECLARATION: I hereby affirm under penalty of perjury one of the following declarations:

I have and will maintain a certificate of consent to self-insure for workers' compensation as provided for by Section 3700 of the Labor Code, for the performance of work for which the permit is issued.

I have and will maintain workers' compensation insurance, as required by Section 3700 of the Labor Code, for the performance of the work for which this permit is issued. My workers' compensation insurance carrier and policy number are:

Carrier STATE FUND Policy Number 692-98 UNIT 0002300 Exp Date 10/01/1999

This section need not be completed if the permit is for \$100 or less) I certify that in the performance of the work for which this permit is issued, I shall not employ any person in any manner so as to become subject to the workers' compensation laws of California and agree that if I should become subject to the workers' compensation provisions of Section 3700 of the Labor Code, I shall forthwith comply with those provisions.

Date 9-17-99 Applicant Signature [Signature]

WARNING - FAILURE TO SECURE WORKER'S COMPENSATION COVERAGE IS UNLAWFUL AND SHALL SUBJECT AN EMPLOYER TO CRIMINAL PENALTIES AND CIVIL FINES UP TO ONE HUNDRED THOUSAND DOLLARS (\$100,000) IN ADDITION TO THE COST OF COMPENSATION, DAMAGES AS PROVIDED FOR IN SECTION 3706 OF THE LABOR CODE, INTEREST AND ATTORNEY'S FEE.

THIS PERMIT SHALL EXPIRE BY LIMITATION IF WORK IS NOT COMMENCED WITHIN 180 DAYS.

Date of Request: _____

By: _____

**CITY OF SACRAMENTO DEVELOPMENT SERVICES DIVISION
PLANNING AND ZONING INFORMATION REQUEST**

Project Address: 6⁰¹ N/E corner of Surf Water Ct + Still Brook

Assessor's Parcel Number: 031-0134-00

Previous Use: SF Retail

Description of Request/Proposed Use: patio cover

Is This a Change of Use? NO

Zoning Designation: RIA

Prior Applications for Project Site(P#, Z#, DRPB#): _____

Comments: Checked setback + lot coverage (OK)

64.7'
x 95'

6146'
245'8"

Are There Any Planning Issues?: (circle one) YES NO

* Staff Site Plan Check Required? (Circle one) YES NO

* Field Inspection Required? (Circle one) YES NO

* Design Review/Preservation Required?: (Circle one) YES NO

Planning Review by/Date: [Signature] 9-17-99

A list of items that must be reviewed by Planning is provided on the reverse side of this form.

MICROFILM AFTER FINAL

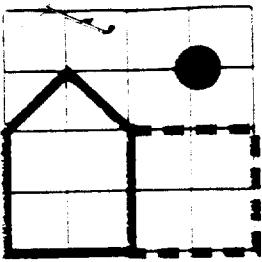

PACIFIC BUILDERS

5421 84th Street
Sacramento, CA 95826
(916) 383-3168

Work Sheet



This set of plans and specifications must be kept on the job at all times and it is unlawful to make any changes or alterations from the same without written permission from the Building Inspection Division.

The approval of this plan and specification SHALL NOT be held to permit or approve the violation of any City Ordinance or State Law.

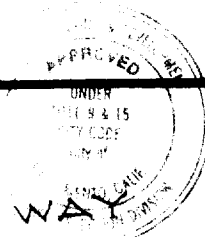

STILL BREEZE WAY

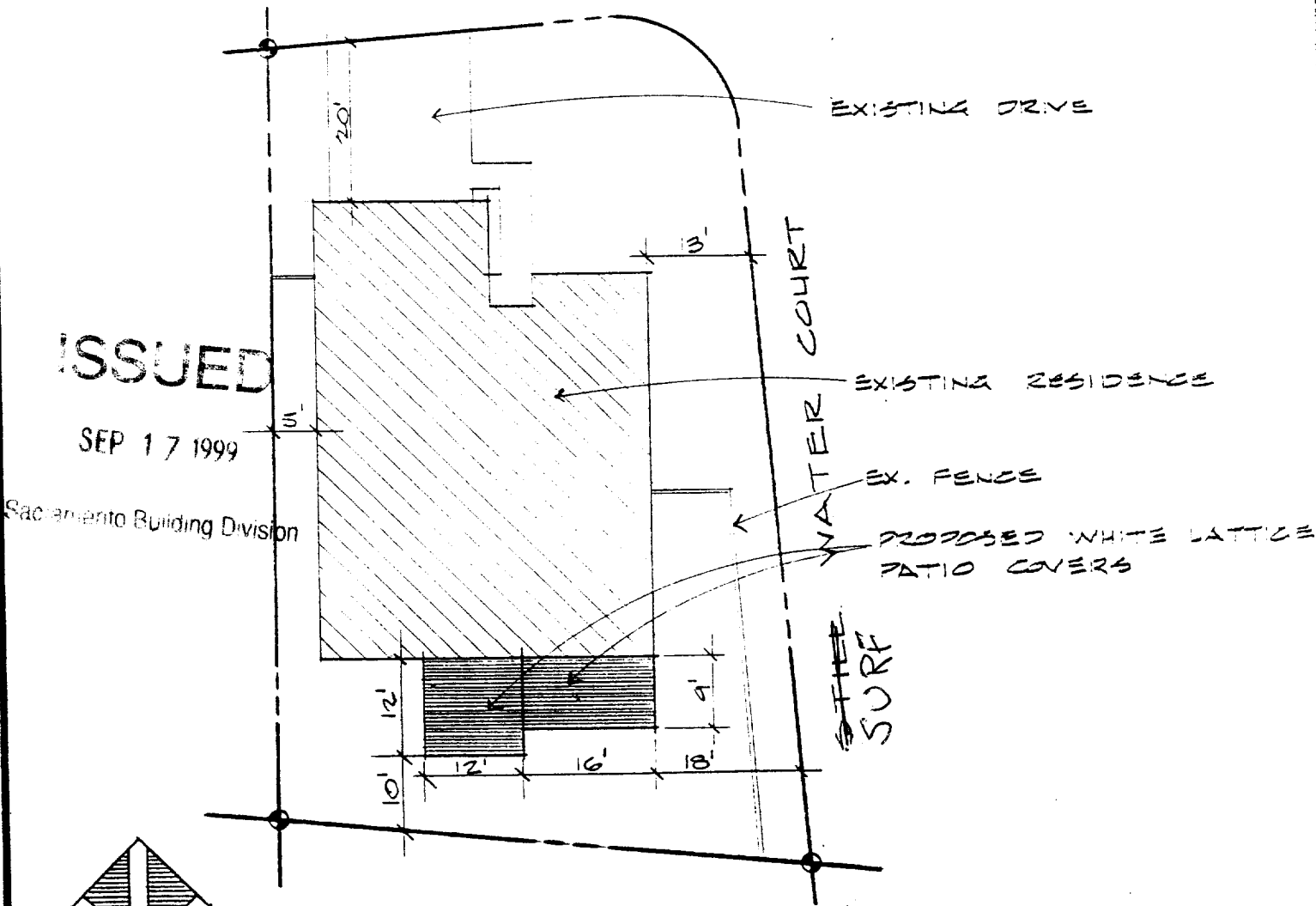

ISSUED

SEP 17 1999

Sacramento Building Division

SITE PLAN

SCALE: 1" = 20'-0"

Name: MR. JACK EVANS
 Address: 695 STILL BREEZE WY.
 City: SACRAMENTO, CA 95831
 Phone: 9/3/99 G.P.N.

Diagram and Size approved by customer

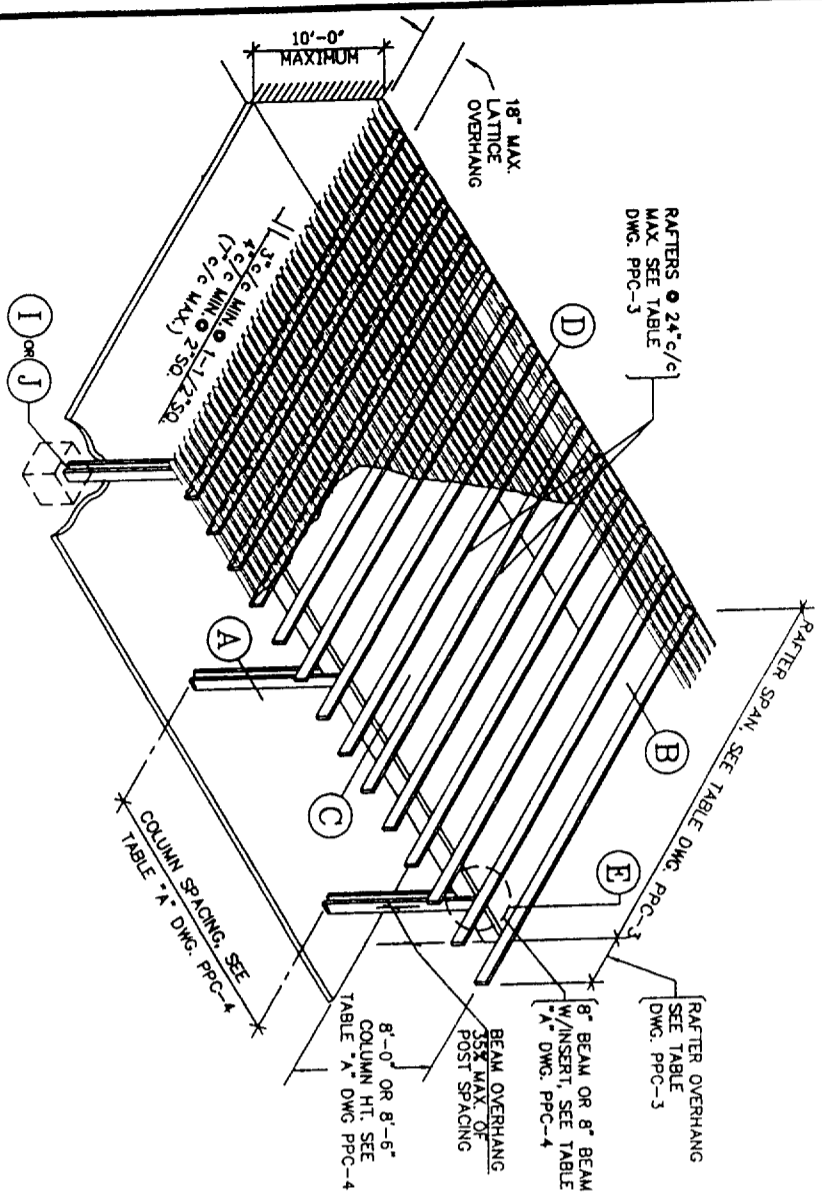

**ATTACHED PERGOLA PATIO COVER
(WITH LATTICE COVERING)**

GENERAL NOTES & SPECIFICATIONS

1. ALUMINUM DESIGN STRESSES ARE PER THE LATEST EDITION OF THE UNIFORM BUILDING CODE AND THE ALUMINUM CONSTRUCTION MANUAL.
2. ALTERNATE ALUMINUM ALLOYS MAY BE SUBSTITUTED FOR THOSE SHOWN, PROVIDED THEY ARE REGISTERED WITH THE ALUMINUM ASSOCIATION AND HAVE EQUAL OR GREATER YIELD AND ULTIMATE STRENGTHS.
3. ALL CONCRETE SHALL HAVE A MINIMUM 28 DAY COMPRESSIVE STRENGTH OF 2000 PSI. CONCRETE SLAB SHALL HAVE 3 1/2" MINIMUM THICKNESS AND SHALL BE IN GOOD CONDITION.
4. ALL FOOTINGS SHALL BEAR ON FIRM, NATURAL, UNDISTURBED SOIL OR CERTIFIED FILL. DESIGN VERTICAL SOIL BEARING PRESSURE = 1000 PSF.
5. ALL STEEL MEMBERS SHALL BE HOT DIP GALVANIZED OR ELECTROPLATED AND CONFORM TO ASTM SPEC. A-446 GRADE "C" UNLESS NOTED OTHERWISE.
6. ALUMINUM FASTENERS SHALL BE 2024-T4. ALL OTHER FASTENERS SHALL BE GALVANIZED, STAINLESS STEEL OR CADMIUM PLATED. ALL BOLTS SHALL CONFORM TO ASTM SPEC. A-307 AND HAVE STANDARD CUT PLATE WASHERS. HOLES FOR BOLTS SHALL BE BOLT DIAMETER PLUS 1/16 IN. MAXIMUM.
7. EXPANSION ANCHORS INTO CONCRETE SHALL BE ICBO EVALUATION SERVICE, INC., RECOGNIZED AND SHALL HAVE THE MINIMUM VALUES INDICATED IN TABLE "C". MINIMUM CONCRETE EDGE DISTANCE IS SIX (6) INCHES.
8. EACH INSTALLATION SHALL BEAR AN IDENTIFYING TAG GIVING THE NAME AND ADDRESS OF THE MANUFACTURER, DESIGN LOADS AND ENCLOSIBILITY.
9. ALL ITEMS PERTAINING TO EACH PARTICULAR INSTALLATION SHALL BE CIRCLED (I) & PROTECTION, POST SPACING, FOOTING DETAIL, ETC.).
10. LATTICE TYPE COVERS SHALL NOT BE ENCLOSED. FREESTANDING COVERS OF ALL TYPES SHALL NOT BE ENCLOSED.
11. THE LATTICE TYPE STRUCTURES SHALL NOT BE COVERED WITH ANY TYPE OF SOLID MATERIAL AS THE DESIGN LOADS HAVE ONLY BEEN APPLIED TO THE HORIZONTAL PROJECTED AREA OF THE LATTICE. RAFTERS, BEAMS, ETC., PER I.C.B.O. CRITERIA.

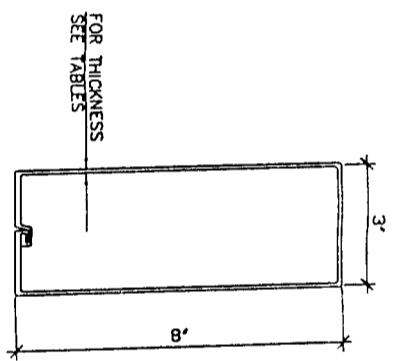

1 BEAM/RAFTER

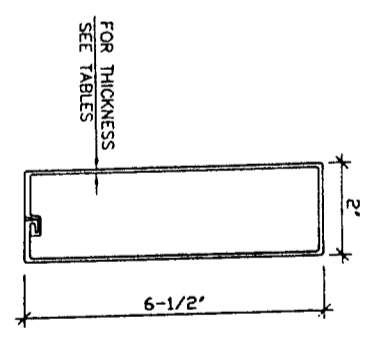

2 RAFTER/SIDEPLATE

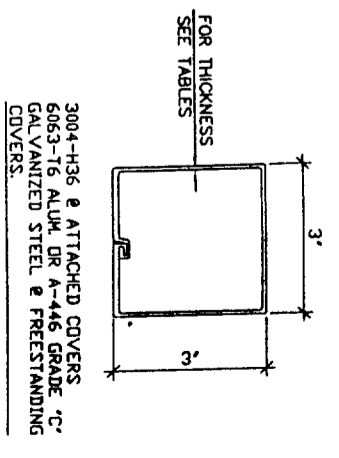

3 COLUMN/POST

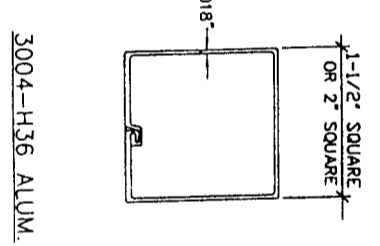

4 LATTICE

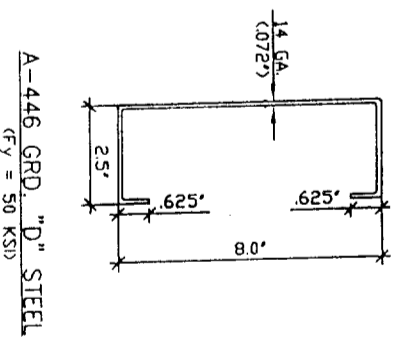

5 BEAM INSERT

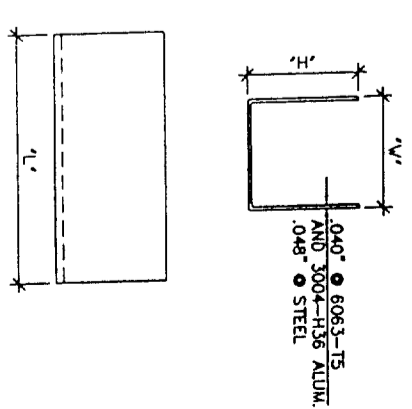

6 TYPICAL "U" BRACKET

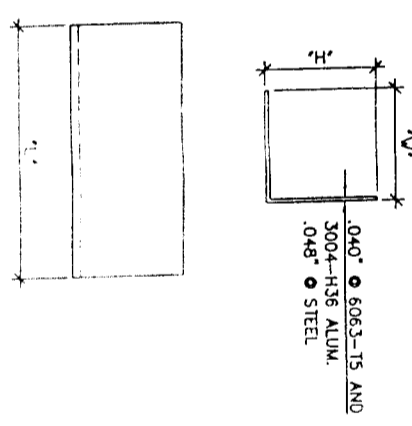

7 TYPICAL "A" BRACKET

Registered Professional Engineer
MICHAEL M. VANCE
 No. 26854
 Date signed 5/1/98
 ARIZONA

Registered Professional Engineer
MICHAEL M. VANCE
 No. 12558
 Date signed 5/1/98
 NEW MEXICO

Registered Professional Engineer
MICHAEL M. VANCE
 No. 25756
 Exp. 12/31/01
 CALIFORNIA

Manufactured by
TEXAS ALUMINUM INDUSTRIES, INC.
 2900 PATIO DRIVE HOUSTON, TEXAS 77017 (713)946-9000

Sun Country™ Deluxe Lattice System
 Distributed by **VIKING BUILDERS, INC.** - Las Vegas, Nevada

ADDENDUM TO ICBO EVALUATION SERVICE INC. REPORT 1841P

SCALE: NONE
 DATE: MAR. 31, 1998

ASHTON VANCE & ASSOC., INC.

DESCRIPTION: GENERAL NOTES, ISOMETRIC AND PART DETAILS (STEEL INSERT)

DRAWING NUMBER: **PPC-1**

RAFTER SPAN TABLE

DESIGN LOAD	RAFTER TYPE: 2" X 6 1/2" X .024" THICK					
	24" SPACING	22" SPACING	20" SPACING	18" SPACING		
	SPAN	O'HANG	SPAN	O'HANG	SPAN	O'HANG
10 PSF L.L.	12'-5"	4'-6"	13'-0"	4'-6"	13'-0"	4'-6"
20 PSF L.L./S.L.	9'-3"	3'-6"	9'-8"	3'-8"	10'-2"	4'-0"
30 PSF S.L.	7'-8"	3'-0"	8'-0"	3'-0"	8'-5"	3'-3"
70 MPH THRU * 110 MPH WIND *	12'-5"	4'-6"	13'-0"	4'-6"	13'-0"	4'-6"
RAFTER TYPE: 2" X 6 1/2" X .032" THICK						
10 PSF L.L.	16'-7"	4'-6"	17'-4"	4'-6"	17'-4"	4'-6"
20 PSF L.L./S.L.	12'-4"	4'-6"	12'-10"	4'-6"	13'-6"	4'-6"
30 PSF S.L.	10'-3"	4'-0"	10'-8"	4'-0"	11'-3"	4'-0"
70 MPH THRU * 110 MPH WIND *	16'-7"	4'-6"	17'-4"	4'-6"	17'-4"	4'-6"
RAFTER TYPE: 2" X 6 1/2" X .040" THICK						
10 PSF L.L.	20'-9"	4'-6"	21'-8"	4'-6"	21'-8"	4'-6"
20 PSF L.L./S.L.	15'-5"	4'-6"	16'-1"	4'-6"	16'-11"	4'-6"
30 PSF S.L.	12'-10"	4'-0"	13'-4"	4'-0"	14'-0"	4'-0"
70 MPH THRU * 110 MPH WIND *	16'-7"	4'-6"	21'-8"	4'-6"	21'-8"	4'-6"
RAFTER TYPE: 3" X 8" X .030" THICK						
10 PSF L.L.	17'-1"	4'-6"	17'-10"	4'-6"	17'-10"	4'-6"
20 PSF L.L./S.L.	12'-8"	4'-6"	13'-3"	4'-6"	13'-10"	4'-6"
30 PSF S.L.	10'-6"	4'-0"	11'-0"	4'-0"	11'-6"	4'-0"
70 MPH THRU * 110 MPH WIND *	17'-1"	4'-6"	17'-10"	4'-6"	17'-10"	4'-6"
RAFTER TYPE: 3" X 8" X .036" THICK						
10 PSF L.L.	20'-8"	4'-6"	21'-7"	4'-6"	21'-7"	4'-6"
20 PSF L.L./S.L.	15'-4"	4'-6"	16'-0"	4'-6"	16'-10"	4'-6"
30 PSF S.L.	12'-9"	4'-0"	13'-4"	4'-0"	14'-0"	4'-0"
70 MPH THRU * 110 MPH WIND *	20'-8"	4'-6"	21'-7"	4'-6"	21'-7"	4'-6"
RAFTER TYPE: 3" X 8" X .042" THICK						
10 PSF L.L.	23'-10"	4'-6"	25'-0"	4'-6"	25'-0"	4'-6"
20 PSF L.L./S.L.	17'-9"	4'-6"	18'-6"	4'-6"	19'-5"	4'-6"
30 PSF S.L.	14'-9"	4'-0"	15'-5"	4'-0"	16'-2"	4'-0"
70 MPH THRU * 110 MPH WIND *	23'-10"	4'-6"	25'-0"	4'-6"	25'-0"	4'-6"

* FOR PATIO COVERS THAT ARE 10'-0" OR LESS IN HEIGHT

TRIBUTARY WIDTH TABLE

MAXIMUM RAFTER OR ROOF PANEL SPAN	MAXIMUM RAFTER OR ROOF PANEL OVERHANG					
	1'-0"	1'-6"	2'-0"	2'-6"	3'-0"	3'-6"
6'-0"	3'-6"	4'-0"	5'-0"	5'-6"	6'-0"	6'-6"
7'-0"	4'-0"	4'-6"	5'-6"	6'-0"	6'-6"	7'-0"
8'-0"	4'-6"	5'-0"	6'-0"	6'-6"	7'-0"	7'-6"
9'-0"	5'-0"	5'-6"	6'-6"	7'-0"	7'-6"	8'-0"
10'-0"	5'-6"	6'-0"	7'-0"	7'-6"	8'-0"	8'-6"
11'-0"	6'-0"	6'-6"	7'-6"	8'-0"	8'-6"	9'-0"
12'-0"	6'-6"	7'-0"	8'-0"	8'-6"	9'-0"	9'-6"
13'-0"	7'-0"	7'-6"	8'-6"	9'-0"	9'-6"	10'-0"
14'-0"	7'-6"	8'-0"	8'-6"	9'-6"	10'-0"	10'-6"
15'-0"	8'-0"	8'-6"	9'-0"	10'-0"	10'-6"	11'-0"
16'-0"	8'-6"	9'-0"	9'-6"	10'-6"	11'-0"	11'-6"
17'-0"	9'-0"	9'-6"	10'-0"	11'-0"	11'-6"	12'-0"
18'-0"	9'-6"	10'-0"	10'-6"	11'-6"	12'-0"	12'-6"
19'-0"	10'-0"	10'-6"	11'-0"	12'-0"	12'-6"	13'-0"
20'-0"	10'-6"	11'-0"	11'-6"	12'-0"	12'-6"	13'-6"
21'-0"	11'-0"	11'-6"	12'-0"	12'-6"	13'-0"	14'-0"
22'-0"	11'-6"	12'-0"	12'-6"	13'-0"	13'-6"	14'-6"
23'-0"	12'-0"	12'-6"	13'-0"	13'-6"	14'-0"	15'-0"

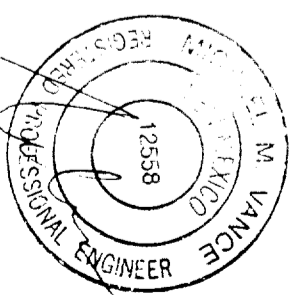
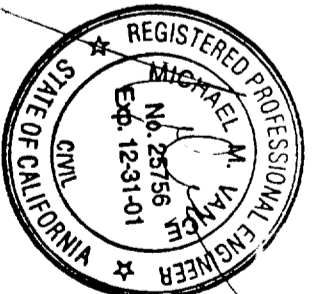
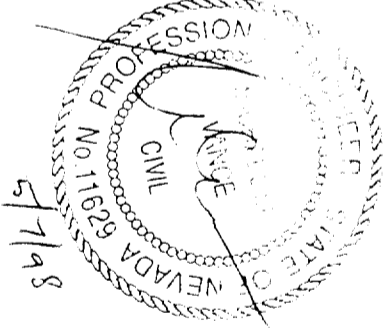
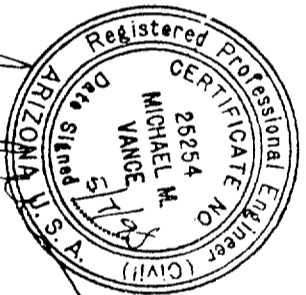

Sun Country™ Deluxe Lattice System

Distributed by **VIKING BUILDERS, INC.** Las Vegas, Nevada

ADDENDUM TO ICBO EVALUATION SERVICE INC REPORT 1841P

Manufactured by **TEXAS ALUMINUM INDUSTRIES, INC.**
2900 PATIO DRIVE HOUSTON TEXAS 77017 (713)948-9000

DRAWN BY: CMV	SCALE: NONE	DRAWING DESCRIPTION: RAFTER SPANS AND TRIBUTARY WIDTH TABLES	DRAWING NUMBER: PPC-3
DATE: MAR. 31, 1998	ASHTON, VANCE & ASSOC. INC.		

GENERAL NOTES FOR DRAWING PPC-7

SOLID ROOF PANEL SPANS

- INSULATED ROOF PANELS
 - THE PANEL FACINGS CONSIST OF .025" OR .032" THICK ALUMINUM SKINS OF 3004-H164 ALLOY.
 - THE ADHESIVE SHALL BE MOR AD M-434, A PROPRIETARY ADHESIVE MANUFACTURED BY MORTON CHEMICAL AND CONFORMING TO THE REQUIREMENTS OF A TYPE II, CLASS 2 ADHESIVE.
 - CORE SHALL BE PRE-FORMED 1.5#/FT³ DENSITY EXPANDED POLYSTYRENE FOAM BY HOUSTON FOAM PLASTICS HAVING A FLAME SPREAD INDEX OF 5 WITH A SMOKE DENSITY OF 50-130 FOR THICKNESSES BETWEEN 2" AND 4".
 - THE MANUFACTURER OF ANY COMPONENT CITED IN ITEMS A) THROUGH C) ABOVE, SHALL CERTIFY TO THE COMPLIANCE OF EACH SHIPMENT OF THAT COMPONENT WITH APPLICABLE SPECIFICATION(S).
 - PANELS SHALL BE CONTINUOUS IN THE DIRECTION OF SLOPE WITH NO TRANSVERSE JOINTS.
 - MAXIMUM ALLOWABLE SPANS ARE AS SHOWN IN TABLE DWG. PPC-7.
- WALL FASTENERS:
 - AT 10 PSF LIVE LOAD USE 1- #12 WOOD SCREW AT 16" c/c EMBEDDED 1 1/2" MINIMUM INTO GROUP 2 OR BETTER LUMBER.
 - AT 20 PSF AND 30 PSF LIVE/SNOW LOAD USE 2- #12 WOOD SCREWS AT 16" c/c EMBEDDED 1 1/2" MINIMUM INTO GROUP 2 OR BETTER LUMBER.
- ENCLOSABILITY THESE UNITS MAY BE ENCLOSED WITH CURRENTLY RECOGNIZED ICBO EVALUATION SERVICE, INC. PATIO COVER ENCLOSURE WALLS.
- SEE DRAWING PPC-1 FOR ADDITIONAL NOTES.

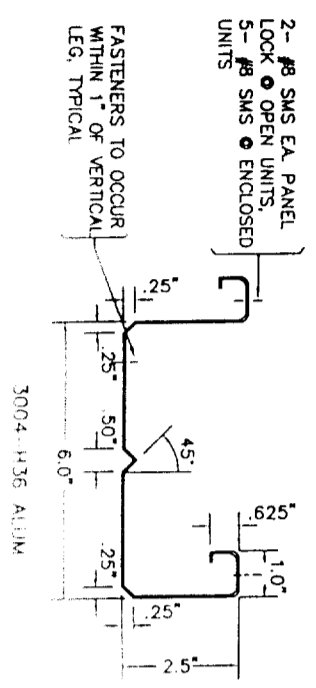
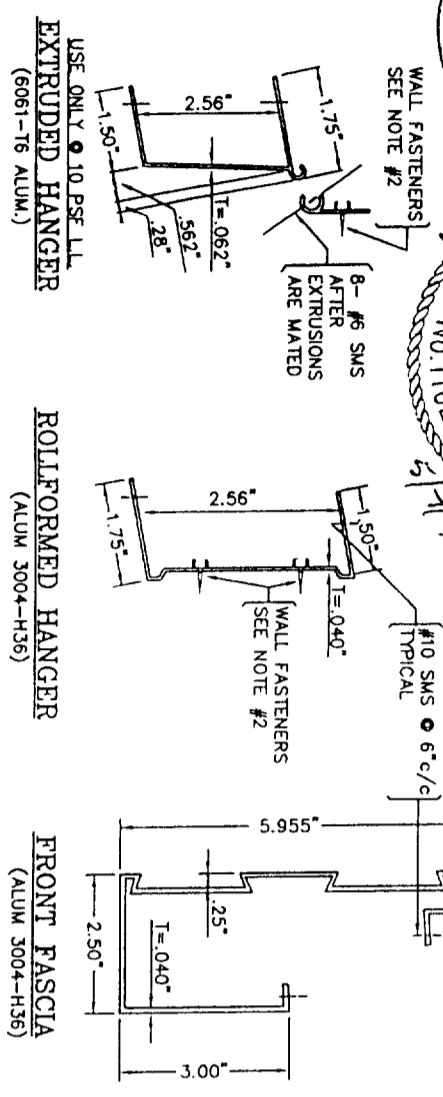
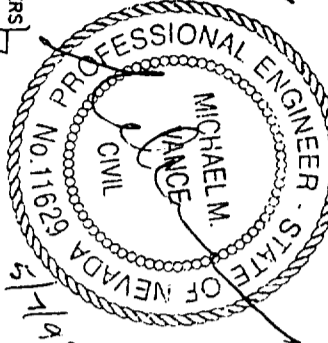
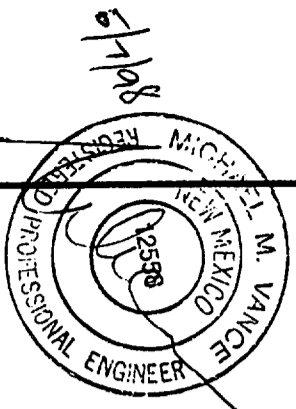

PANEL TYPE	PANEL THICKNESS	DESIGN LOADS						
		10 PSF LL	20 PSF LL/SL	30 PSF S.L.	70 MPH WIND ****	90 MPH WIND ****	100 MPH WIND	110 MPH WIND
MAXIMUM PANEL SPAN (MINIMUM SLOPE)								
2 3/8" x 6" ROLLFORM	.020"	12'-6" (.4"/FT.)	8'-11" (.4"/FT.)	7'-4" (.4"/FT.)	12'-6" (.4"/FT.)	11'-8" (.4"/FT.)	—	—
	.025"	14'-8" (.4"/FT.)	10'-7" (.4"/FT.)	8'-8" (.4"/FT.)	14'-8" (.4"/FT.)	14'-8" (.4"/FT.)	—	—
	.032"	17'-5" (.4"/FT.)	12'-7" (.4"/FT.)	10'-4" (.4"/FT.)	17'-5" (.4"/FT.)	17'-5" (.4"/FT.)	—	—
2 1/2" x 6" ROLLFORM	.024"	18'-3" (.4"/FT.)	12'-3" (.4"/FT.)	8'-3" (.4"/FT.)	18'-3" (.4"/FT.)	14'-9" (.4"/FT.)	—	—
	.032"	20'-0" (.4"/FT.)	16'-0" (.4"/FT.)	14'-0" (.4"/FT.)	20'-0" (.4"/FT.)	19'-4" (.4"/FT.)	—	—
	.040"	21'-5" (.4"/FT.)	17'-2" (.4"/FT.)	15'-1" (.4"/FT.)	21'-5" (.4"/FT.)	21'-5" (.4"/FT.)	—	—
3" INSULATED	.025"	16'-8" (.5"/FT.)	10'-10" (.5"/FT.)	8'-11" (.5"/FT.)	16'-8" (.5"/FT.)	16'-8" (.5"/FT.)	—	—
	.032"	18'-0" (.5"/FT.)	12'-3" (.5"/FT.)	10'-1" (.5"/FT.)	18'-0" (.5"/FT.)	18'-0" (.5"/FT.)	—	—

* OR SKIN THICKNESS AT 3" INSULATED PANEL.
 ** FROM ICBO ER 4244P. BRUCE CHALLMAN ENGINEER OF RECORD.
 *** FROM TEST DATA PROVIDED BY C.I. PROFESSIONAL SERVICES. WARREN CAVANAUGH ENGINEER OF RECORD.
 **** HEIGHT LESS THAN 10'-0"

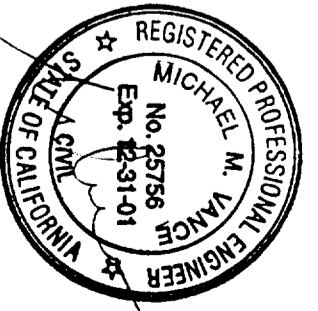
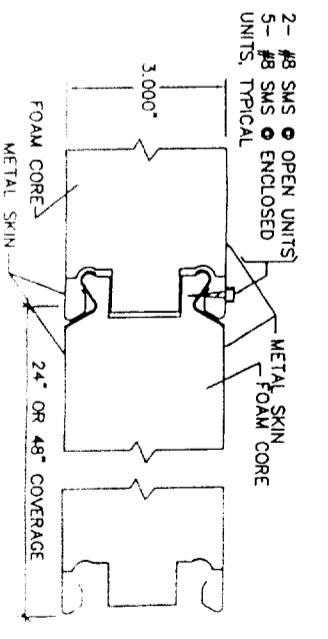
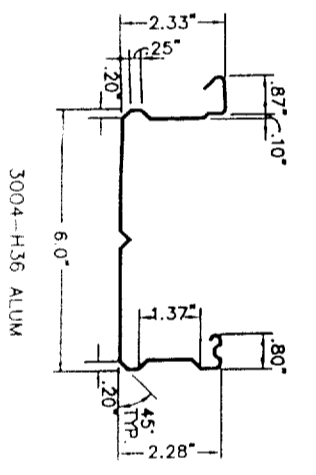
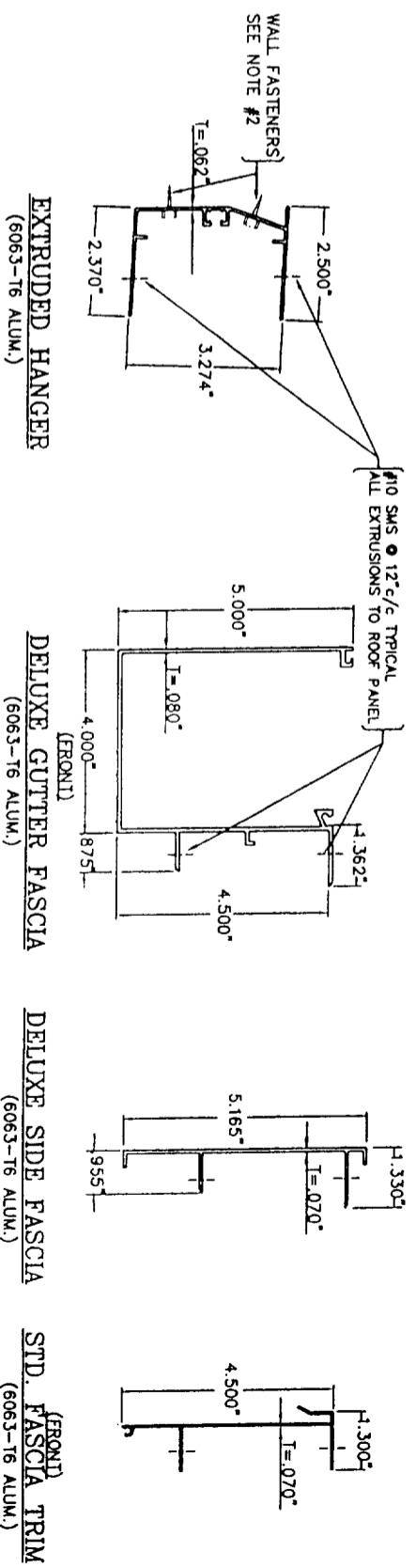

2-1/2" x 6" FLAT PANEL & ACCESSORIES

2-3/8" x 6" FLAT PANEL

3" INSULATED PANEL & ACCESSORIES

red by

Sun Country™ Deluxe Lattice System
 Distributed by VIKING BUILDERS, INC., Las Vegas, Nevada

ADDENDUM TO ICBO EVALUATION SERVICE INC. REPORT 1841P

TEXAS ALUMINUM INDUSTRIES, INC.
 2900 PATIO DRIVE HOUSTON, TEXAS 77017 (713)946-9000

ASHTON VANCE & ASSOC., INC.

DRAWING DESCRIPTION: SOLID ROOF PANELS

DRAWING NUMBER: PPC-7

TABLE "A" MAXIMUM COLUMN SPACING

MAXIMUM TRIBUTARY WIDTH*	3" x 8" x 0.42" BEAM		5" x 8" BEAM W/INSERT	
	MAX. COL. SPACING**	NO. SLAB	MAX. COL. SPACING**	NO. SLAB
4'-0"	16'-9" (1)	18" SQ. x 36"	26'-6" (2)	24" SQ. x 30"
5'-0"	15'-0" (1)	18" SQ. x 36"	23'-9" (2)	24" SQ. x 30"
6'-0"	13'-7" (1)	18" SQ. x 36"	21'-8" (2)	24" SQ. x 30"
7'-0"	12'-7" (1)	18" SQ. x 36"	20'-0" (2)	24" SQ. x 30"
8'-0"	11'-10" (1)	18" SQ. x 36"	18'-9" (2)	24" SQ. x 30"
10'-0"	10'-7" (1)	18" SQ. x 36"	16'-9" (2)	24" SQ. x 30"
11'-0"	10'-1" (1)	18" SQ. x 36"	16'-0" (2)	24" SQ. x 30"
12'-0"	9'-8" (1)	18" SQ. x 36"	15'-4" (2)	24" SQ. x 30"

10 PSF LIVE LOAD, 70 MPH WIND LOAD				
MAXIMUM TRIBUTARY WIDTH*	3" x 8" x 0.42" BEAM		5" x 8" BEAM W/INSERT	
	MAX. COL. SPACING**	NO. SLAB	MAX. COL. SPACING**	NO. SLAB
4'-0"	16'-9" (1)	18" SQ. x 36"	26'-6" (2)	24" SQ. x 30"
5'-0"	15'-0" (1)	18" SQ. x 36"	23'-9" (2)	24" SQ. x 30"
6'-0"	13'-7" (1)	18" SQ. x 36"	21'-8" (2)	24" SQ. x 30"
7'-0"	12'-7" (1)	18" SQ. x 36"	20'-0" (2)	24" SQ. x 30"
8'-0"	11'-10" (1)	18" SQ. x 36"	18'-9" (2)	24" SQ. x 30"
10'-0"	10'-7" (1)	18" SQ. x 36"	16'-9" (2)	24" SQ. x 30"
11'-0"	10'-1" (1)	18" SQ. x 36"	16'-0" (2)	24" SQ. x 30"
12'-0"	9'-8" (1)	18" SQ. x 36"	15'-4" (2)	24" SQ. x 30"

10 PSF LIVE LOAD, 100 MPH WIND LOAD				
MAXIMUM TRIBUTARY WIDTH*	3" x 8" x 0.42" BEAM		5" x 8" BEAM W/INSERT	
	MAX. COL. SPACING**	NO. SLAB	MAX. COL. SPACING**	NO. SLAB
4'-0"	16'-9" (1)	18" SQ. x 36"	26'-6" (2)	24" SQ. x 30"
5'-0"	15'-0" (1)	18" SQ. x 36"	23'-9" (2)	24" SQ. x 30"
6'-0"	13'-7" (1)	18" SQ. x 36"	21'-8" (2)	24" SQ. x 30"
7'-0"	12'-7" (1)	18" SQ. x 36"	20'-0" (2)	24" SQ. x 30"
8'-0"	11'-10" (1)	18" SQ. x 36"	18'-9" (2)	24" SQ. x 30"
10'-0"	10'-7" (1)	18" SQ. x 36"	16'-9" (2)	24" SQ. x 30"
11'-0"	10'-1" (1)	18" SQ. x 36"	16'-0" (2)	24" SQ. x 30"
12'-0"	9'-8" (1)	18" SQ. x 36"	15'-4" (2)	24" SQ. x 30"

SEE TRIBUTARY WIDTH TABLE, DRAWING PPC-3.
 ** NUMBER IN PARENTHESES IS THE COLUMN TYPE PER TABLE "B" BELOW.
 *** A 3 1/2 INCH THICK (MIN.) CONCRETE SLAB SHALL OCCUR UNDER THE ENTIRE COVER AND EXTEND 1'-8" MINIMUM BEYOND EXTERIOR FACE(S) OF COLUMNS.

TABLE "B" COLUMN SCHEDULE

COLUMN TYPE	COLUMN DESCRIPTION
(1)	3" SQ. X 120" ALUM. CENTER COLUMN
(2)	W/ 2" X 6 1/2" X 0.24" SIDEPILATES
(3)	3" SQ. X 0.95" STEEL CENTER COLUMN
(4)	W/ 2" X 6 1/2" X 0.24" SIDEPILATES
(5)	3" SQ. X 120" STEEL CENTER COLUMN
(6)	W/ 2" X 6 1/2" X 0.24" SIDEPILATES
(7)	3" SQ. X 188" STEEL CENTER COLUMN
(8)	W/ 2" X 6 1/2" X 0.24" SIDEPILATES

* MAY BE SUBSTITUTED FOR COLUMN (1) & (2).
 ** MAY BE SUBSTITUTED FOR COLUMN (3) & (4).
 *** MAY BE SUBSTITUTED FOR COLUMN (5) & (6).

Sum Country™ Deluxe Lattice System
 Distributed by VIKING BUILDERS, INC. Los Angeles, Nevada

TABLE "A" MAXIMUM COLUMN SPACING

MAXIMUM TRIBUTARY WIDTH*	3" x 8" x 0.42" BEAM		5" x 8" BEAM W/INSERT	
	MAX. COL. SPACING**	NO. SLAB	MAX. COL. SPACING**	NO. SLAB
4'-0"	16'-9" (1)	18" SQ. x 36"	26'-6" (2)	24" SQ. x 30"
5'-0"	15'-0" (1)	18" SQ. x 36"	23'-9" (2)	24" SQ. x 30"
6'-0"	13'-7" (1)	18" SQ. x 36"	21'-8" (2)	24" SQ. x 30"
7'-0"	12'-7" (1)	18" SQ. x 36"	20'-0" (2)	24" SQ. x 30"
8'-0"	11'-10" (1)	18" SQ. x 36"	18'-9" (2)	24" SQ. x 30"
10'-0"	10'-7" (1)	18" SQ. x 36"	16'-9" (2)	24" SQ. x 30"
11'-0"	10'-1" (1)	18" SQ. x 36"	16'-0" (2)	24" SQ. x 30"
12'-0"	9'-8" (1)	18" SQ. x 36"	15'-4" (2)	24" SQ. x 30"

20 PSF LIVE/SNOW LOAD, 70 MPH WIND LOAD				
MAXIMUM TRIBUTARY WIDTH*	3" x 8" x 0.42" BEAM		5" x 8" BEAM W/INSERT	
	MAX. COL. SPACING**	NO. SLAB	MAX. COL. SPACING**	NO. SLAB
4'-0"	16'-9" (1)	18" SQ. x 36"	26'-6" (2)	24" SQ. x 30"
5'-0"	15'-0" (1)	18" SQ. x 36"	23'-9" (2)	24" SQ. x 30"
6'-0"	13'-7" (1)	18" SQ. x 36"	21'-8" (2)	24" SQ. x 30"
7'-0"	12'-7" (1)	18" SQ. x 36"	20'-0" (2)	24" SQ. x 30"
8'-0"	11'-10" (1)	18" SQ. x 36"	18'-9" (2)	24" SQ. x 30"
10'-0"	10'-7" (1)	18" SQ. x 36"	16'-9" (2)	24" SQ. x 30"
11'-0"	10'-1" (1)	18" SQ. x 36"	16'-0" (2)	24" SQ. x 30"
12'-0"	9'-8" (1)	18" SQ. x 36"	15'-4" (2)	24" SQ. x 30"

20 PSF LIVE/SNOW LOAD, 100 MPH WIND LOAD				
MAXIMUM TRIBUTARY WIDTH*	3" x 8" x 0.42" BEAM		5" x 8" BEAM W/INSERT	
	MAX. COL. SPACING**	NO. SLAB	MAX. COL. SPACING**	NO. SLAB
4'-0"	16'-9" (1)	18" SQ. x 36"	26'-6" (2)	24" SQ. x 30"
5'-0"	15'-0" (1)	18" SQ. x 36"	23'-9" (2)	24" SQ. x 30"
6'-0"	13'-7" (1)	18" SQ. x 36"	21'-8" (2)	24" SQ. x 30"
7'-0"	12'-7" (1)	18" SQ. x 36"	20'-0" (2)	24" SQ. x 30"
8'-0"	11'-10" (1)	18" SQ. x 36"	18'-9" (2)	24" SQ. x 30"
10'-0"	10'-7" (1)	18" SQ. x 36"	16'-9" (2)	24" SQ. x 30"
11'-0"	10'-1" (1)	18" SQ. x 36"	16'-0" (2)	24" SQ. x 30"
12'-0"	9'-8" (1)	18" SQ. x 36"	15'-4" (2)	24" SQ. x 30"

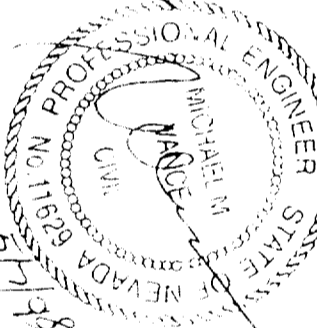
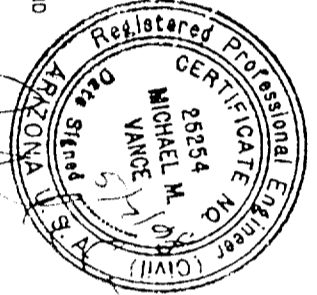

30 PSF SNOW LOAD, 70 MPH WIND LOAD				
MAXIMUM TRIBUTARY WIDTH*	3" x 8" x 0.42" BEAM		5" x 8" BEAM W/INSERT	
	MAX. COL. SPACING**	NO. SLAB	MAX. COL. SPACING**	NO. SLAB
4'-0"	10'-5" (1)	24" SQ. x 33"	16'-5" (2)	26" SQ. x 39"
5'-0"	9'-4" (1)	24" SQ. x 30"	14'-8" (2)	26" SQ. x 36"
6'-0"	8'-6" (1)	24" SQ. x 30"	13'-5" (2)	26" SQ. x 36"
7'-0"	7'-11" (1)	24" SQ. x 30"	12'-5" (2)	26" SQ. x 36"
8'-0"	7'-4" (1)	24" SQ. x 30"	11'-7" (2)	26" SQ. x 36"
9'-0"	6'-11" (1)	24" SQ. x 30"	10'-11" (2)	26" SQ. x 36"

30 PSF SNOW LOAD, 100 MPH WIND LOAD				
MAXIMUM TRIBUTARY WIDTH*	3" x 8" x 0.42" BEAM		5" x 8" BEAM W/INSERT	
	MAX. COL. SPACING**	NO. SLAB	MAX. COL. SPACING**	NO. SLAB
4'-0"	10'-5" (1)	24" SQ. x 33"	16'-5" (2)	26" SQ. x 39"
5'-0"	9'-4" (1)	24" SQ. x 30"	14'-8" (2)	26" SQ. x 36"
6'-0"	8'-6" (1)	24" SQ. x 30"	13'-5" (2)	26" SQ. x 36"
7'-0"	7'-11" (1)	24" SQ. x 30"	12'-5" (2)	26" SQ. x 36"
8'-0"	7'-4" (1)	24" SQ. x 30"	11'-7" (2)	26" SQ. x 36"
9'-0"	6'-11" (1)	24" SQ. x 30"	10'-11" (2)	26" SQ. x 36"

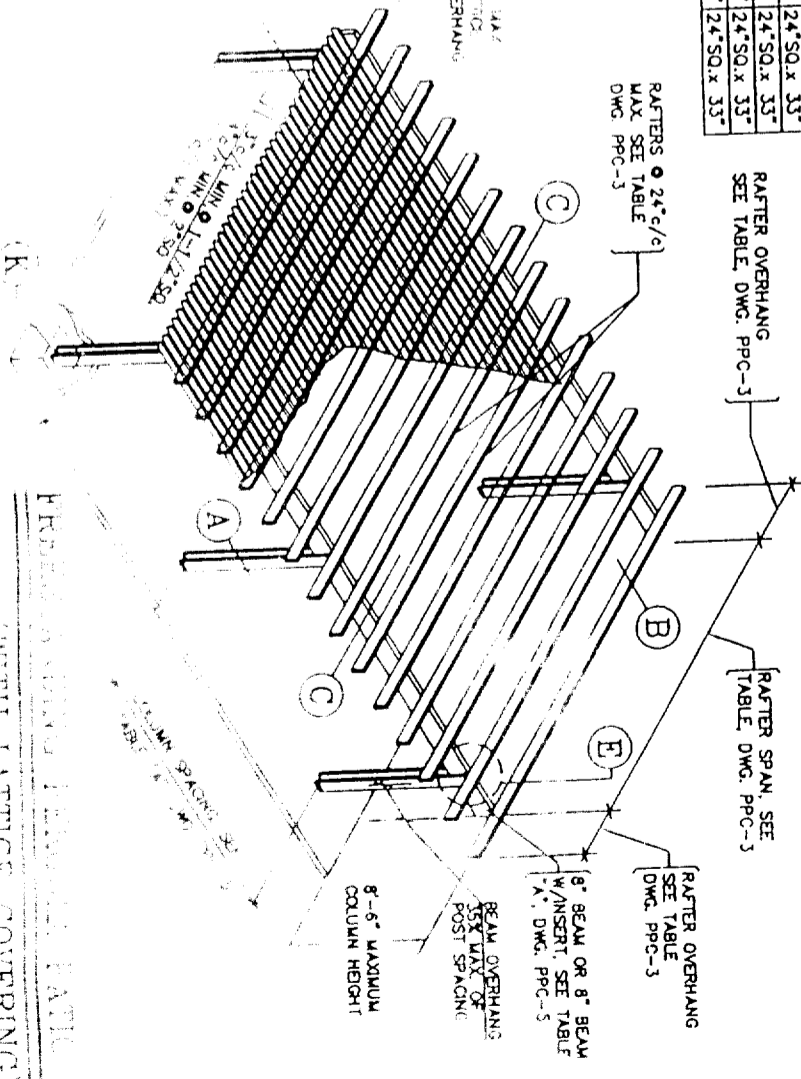

RETURNED BY
 TEXAS ALUMINUM INDUSTRIES, INC.
 2800 PALTO DRIVE HOUSTON, TEXAS 77012 (713)946 9000

ADDENDUM TO LATTICE SYSTEM DRAWING NO. 1841P
 DRAWING DESCRIPTION: FREESTANDING COVER TABLES WITH LATTICE COVERING
 DRAWING NUMBER: PPC-5

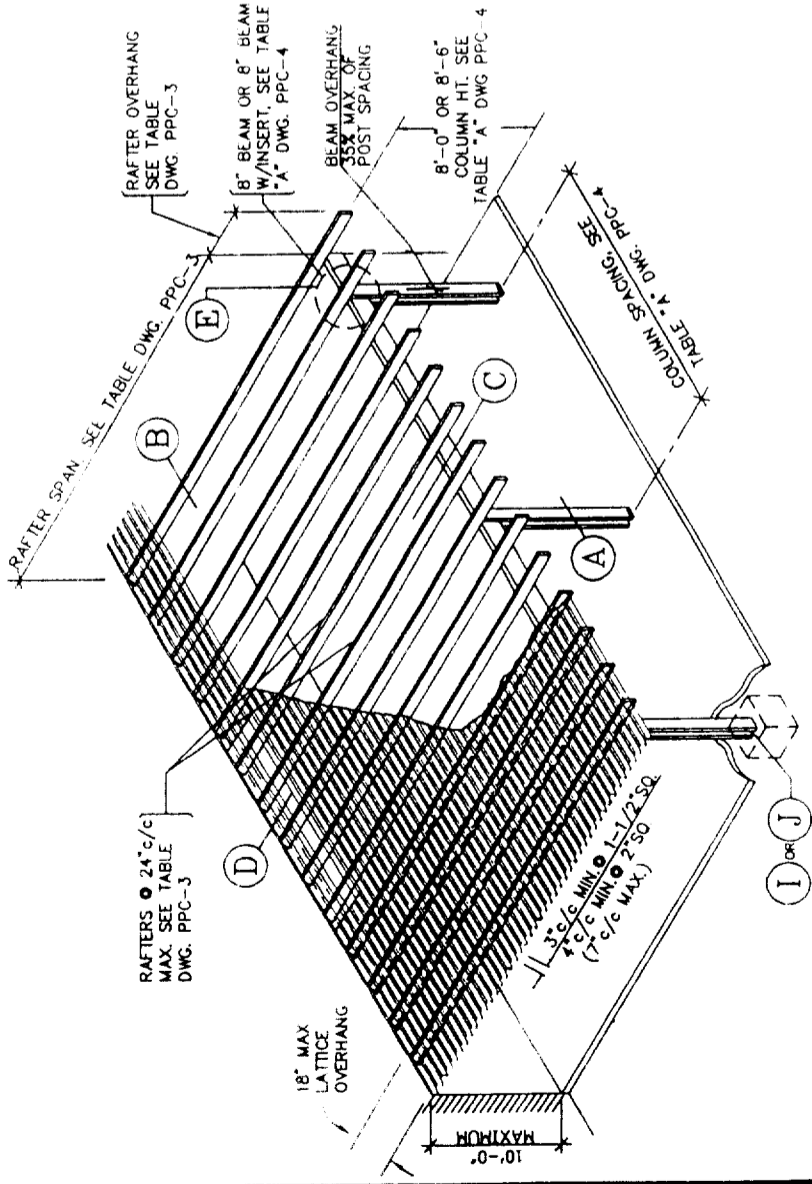

**ATTACHED PERGOLA PATIO COVER
(WITH LATTICE COVERING)**

GENERAL NOTES & SPECIFICATIONS

1. ALUMINUM DESIGN STRESSES ARE PER THE LATEST EDITION OF THE UNIFORM BUILDING CODE AND THE ALUMINUM CONSTRUCTION MANUAL.
2. ALTERNATE ALUMINUM ALLOYS MAY BE SUBSTITUTED FOR THOSE SHOWN, PROVIDED THEY ARE REGISTERED WITH THE ALUMINUM ASSOCIATION AND HAVE EQUAL OR GREATER YIELD AND ULTIMATE STRENGTHS.
3. ALL CONCRETE SHALL HAVE A MINIMUM 28 DAY COMPRESSIVE STRENGTH OF 2000 PSI. CONCRETE SLAB SHALL HAVE 3 1/2" MINIMUM THICKNESS AND SHALL BE IN GOOD CONDITION.
4. ALL FOOTINGS SHALL BEAR ON FIRM, NATURAL, UNDISTURBED SOIL OR CERTIFIED FILL. DESIGN VERTICAL SOIL BEARING PRESSURE = 1000 PSF.
5. ALL STEEL MEMBERS SHALL BE HOT DIP GALVANIZED OR ELECTROPLATED AND CONFORM TO ASTM SPEC. A-446 GRADE "C" UNLESS NOTED OTHERWISE.
6. ALUMINUM FASTENERS SHALL BE 2024-T4. ALL OTHER FASTENERS SHALL BE GALVANIZED, STAINLESS STEEL OR CADMIUM PLATED. ALL BOLTS SHALL CONFORM TO ASTM SPEC. A-307 AND HAVE STANDARD CUT PLATE WASHERS. HOLES FOR BOLTS SHALL BE BOLT DIAMETER PLUS 1/16 IN. MAXIMUM.
7. EXPANSION ANCHORS INTO CONCRETE SHALL BE ICBO EVALUATION SERVICE, INC., RECOGNIZED AND SHALL HAVE THE MINIMUM VALUES INDICATED IN TABLE "C". MINIMUM CONCRETE EDGE DISTANCE IS SIX (6) INCHES.
8. EACH INSTALLATION SHALL BEAR AN IDENTIFYING TAG GIVING THE NAME AND ADDRESS OF THE MANUFACTURER, DESIGN LOADS AND ENCLOSIBILITY.
9. ALL ITEMS PERTAINING TO EACH PARTICULAR INSTALLATION SHALL BE CIRCLED (i.e. PROJECTION, POST SPACING, FOOTING DETAIL, ETC.).
10. LATTICE TYPE COVERS SHALL NOT BE ENCLOSED. FREESTANDING COVERS OF ALL TYPES SHALL NOT BE ENCLOSED.
11. THE LATTICE TYPE STRUCTURES SHALL NOT BE COVERED WITH ANY TYPE OF SOLID MATERIAL AS THE DESIGN LOADS HAVE ONLY BEEN APPLIED TO THE HORIZONTAL PROJECTED AREA OF THE LATTICE, RAFTERS, BEAMS, ETC., PER I.C.B.O. CRITERIA.

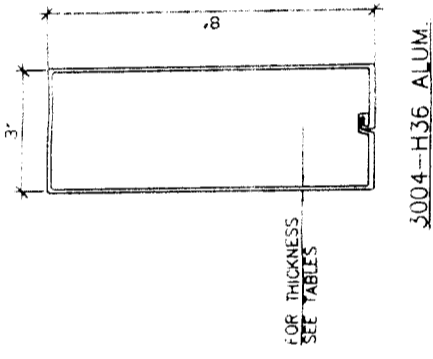

BEAM/RAFTER ①
3004-H36 ALUM.

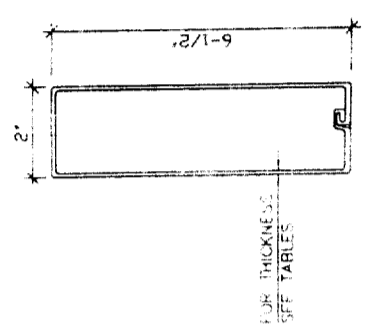

RAFTER/SIDEPLATE ②
3004-H36 ALUM.

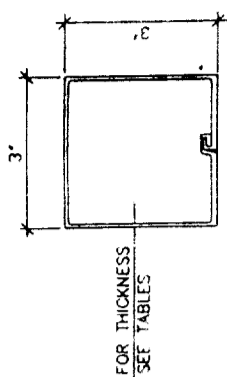

COLUMN/POST ③
3004-H36 & ATTACHED COVERS
6063-T6 ALUM. OR A-446 GRADE 'C'
GALVANIZED STEEL & FREESTANDING
COVERS.

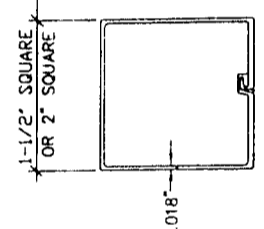

LATTICE ④
3004-H36 ALUM.

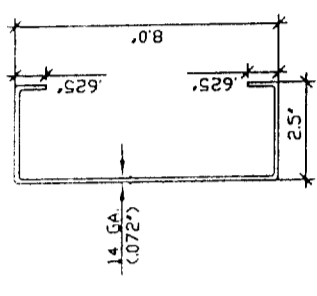

BEAM INSERT ⑤
A-446 GRD. "D" STEEL
(Fy = 50 KSI)

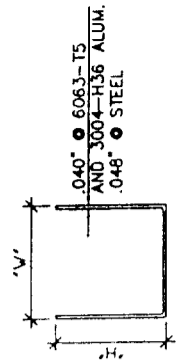

TYPICAL "U" BRACKET ⑥
.040" 6063-T5
AND 3004-H36 ALUM.
.048" STEEL

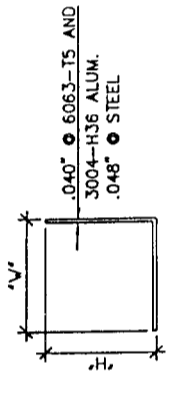

TYPICAL "Z" BRACKET ⑦
.040" 6063-T5 AND
3004-H36 ALUM.
.048" STEEL

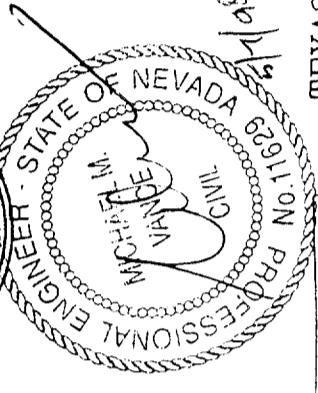
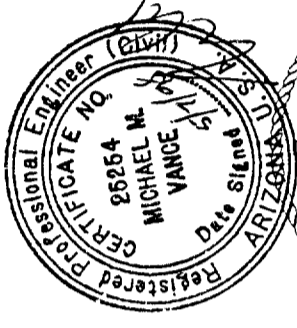
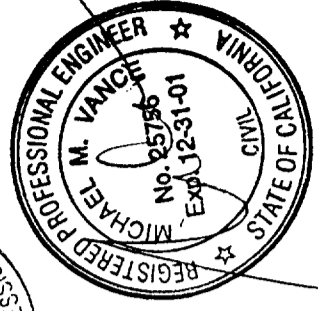
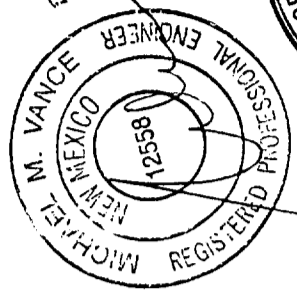

Manufactured by

TEXAS ALUMINUM INDUSTRIES, INC.
2900 PATIO DRIVE HOUSTON, TEXAS 77017 (713)948-9000

ADDENDUM TO ICBO EVALUATION SERVICE INC. REPORT 1841P

DRAWN BY: cmv	SCALE: NONE	ASHTON, VANCE & ASSOC., INC.	DRAWING DESCRIPTION: GENERAL NOTES, ISOMETRIC AND PART DETAILS (STEEL INSERT)	DRAWING NUMBER: PPC-1
	DATE: MAR. 31, 1998			

Sun Country™ Deluxe Lattice System
Distributed by **VIKING BUILDERS, INC. - Las Vegas, Nevada**

RAFTER SPAN TABLE

DESIGN LOAD	RAFTER TYPE: 2" X 6 1/2" X 024" THICK			
	24" SPACING	22" SPACING	20" SPACING	18" SPACING
	SPAN	CHANG. SPAN	CHANG. SPAN	CHANG. SPAN
10 PSF L.L.	12'-5"	13'-0"	13'-0"	13'-0"
20 PSF L.L./S.L.	9'-3"	9'-8"	10'-2"	10'-8"
30 PSF S.L.	7'-8"	8'-0"	8'-5"	8'-10"
70 MPH THRU 110 MPH WIND *	12'-5"	13'-0"	13'-0"	13'-0"
RAFTER TYPE: 2" X 6 1/2" X .032" THICK				
10 PSF L.L.	16'-7"	17'-4"	17'-4"	17'-4"
20 PSF L.L./S.L.	12'-4"	12'-10"	13'-6"	14'-3"
30 PSF S.L.	10'-3"	10'-8"	11'-3"	11'-10"
70 MPH THRU 110 MPH WIND *	16'-7"	17'-4"	17'-4"	17'-4"
RAFTER TYPE: 2" X 6 1/2" X .040" THICK				
10 PSF L.L.	20'-9"	21'-8"	21'-8"	21'-8"
20 PSF L.L./S.L.	15'-5"	16'-1"	16'-11"	17'-10"
30 PSF S.L.	12'-10"	13'-4"	14'-0"	14'-9"
70 MPH THRU 110 MPH WIND *	16'-7"	17'-4"	17'-4"	17'-4"
RAFTER TYPE: 3" X 8" X .030" THICK				
10 PSF L.L.	17'-1"	17'-10"	17'-10"	17'-10"
20 PSF L.L./S.L.	12'-8"	13'-3"	13'-10"	14'-7"
30 PSF S.L.	10'-6"	11'-0"	11'-6"	12'-2"
70 MPH THRU 110 MPH WIND *	17'-1"	17'-10"	17'-10"	17'-10"
RAFTER TYPE: 3" X 8" X .036" THICK				
10 PSF L.L.	20'-8"	21'-7"	21'-7"	21'-7"
20 PSF L.L./S.L.	15'-4"	16'-0"	16'-10"	17'-9"
30 PSF S.L.	12'-9"	13'-4"	14'-0"	14'-8"
70 MPH THRU 110 MPH WIND *	20'-8"	21'-7"	21'-7"	21'-7"
RAFTER TYPE: 3" X 8" X .042" THICK				
10 PSF L.L.	23'-10"	25'-0"	25'-0"	25'-0"
20 PSF L.L./S.L.	17'-9"	18'-6"	19'-5"	20'-6"
30 PSF S.L.	14'-9"	15'-5"	16'-2"	17'-0"
70 MPH THRU 110 MPH WIND *	23'-10"	25'-0"	25'-0"	25'-0"

* FOR PATIO COVERS THAT ARE 10'-0" OR LESS IN HEIGHT.

TRIBUTARY WIDTH TABLE

MAXIMUM RAFTER OR ROOF PANEL SPAN	MAXIMUM RAFTER OR ROOF PANEL OVERHANG			
	0'-6"	1'-0"	1'-6"	2'-0"
	SUPPORT BEAM TRIBUTARY WIDTH (FEET)			
5'-0"	3'-6"	4'-0"	5'-0"	5'-6"
7'-0"	4'-0"	4'-6"	5'-6"	6'-6"
8'-0"	4'-6"	5'-0"	6'-0"	7'-6"
9'-0"	5'-0"	5'-6"	6'-6"	7'-6"
10'-0"	5'-6"	6'-0"	7'-0"	8'-0"
11'-0"	6'-0"	6'-6"	7'-6"	8'-0"
12'-0"	6'-6"	7'-0"	8'-0"	9'-0"
13'-0"	7'-0"	7'-6"	8'-6"	9'-0"
14'-0"	7'-6"	8'-0"	9'-0"	10'-0"
15'-0"	8'-0"	8'-6"	9'-6"	10'-0"
16'-0"	8'-6"	9'-0"	10'-6"	11'-0"
17'-0"	9'-0"	9'-6"	10'-6"	11'-6"
18'-0"	9'-6"	10'-0"	11'-6"	12'-0"
19'-0"	10'-0"	10'-6"	11'-6"	12'-0"
20'-0"	10'-6"	11'-0"	12'-0"	12'-0"
21'-0"	11'-0"	11'-6"	12'-0"	12'-0"
22'-0"	11'-6"	12'-0"	12'-0"	12'-0"
23'-0"	12'-0"	12'-0"	12'-0"	12'-0"

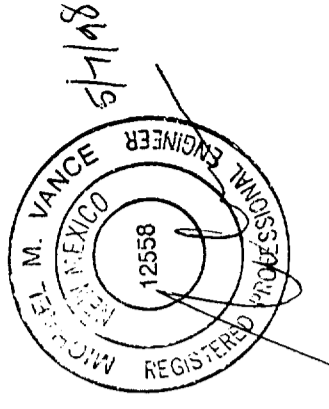
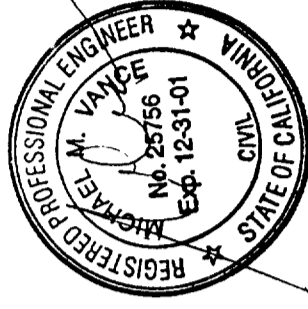
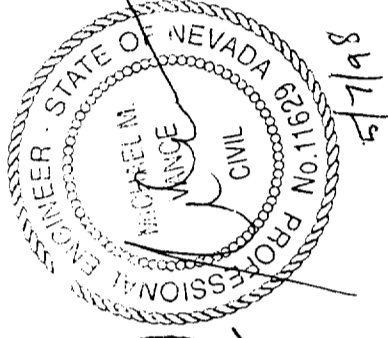
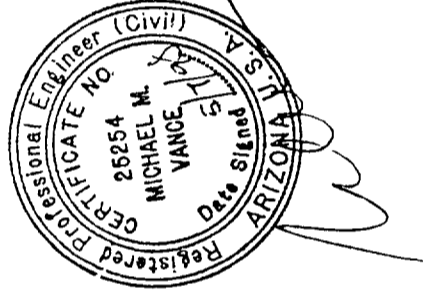

Sun Country™ Deluxe Lattice System

Distributed by VIKING BUILDERS, INC. - Las Vegas, Nevada

Manufactured by

ADDENDUM TO ICBO EVALUATION SERVICE INC. REPORT 1841P

TEXAS ALUMINUM INDUSTRIES, INC.
2900 PATIO DRIVE HOUSTON, TEXAS 77017 (713)946-9000

DRAWN BY: cmv
SCALE: NONE
DATE: MAR. 31, 1998

ASHTON, VANCE & ASSOC., INC.

DRAWING DESCRIPTION
RAFTER SPANS AND TRIBUTARY WIDTH TABLES

DRAWING NUMBER
PPC-3

GENERAL NOTES FOR DRAWING PPC 7

- INSULATED ROOF PANELS
 - THE PANEL FACINGS CONSIST OF .025" OR .032" THICK ALUMINUM SKINS OF 3004-H164 ALLOY. THE ADHESIVE SHALL BE MOR AD M-434, A PROPRIETARY ADHESIVE MANUFACTURED BY MORTON CHEMICAL AND CONFORMING TO THE REQUIREMENTS OF A TYPE II, CLASS 2 ADHESIVE.
 - CORE SHALL BE PRE-FORMED 1.5#/FT³ DENSITY EXPANDED POLYSTYRENE FOAM BY HOUSTON FOAM PLASTICS HAVING A FLAME SPREAD INDEX OF 5 WITH A SMOKE DENSITY OF 50-130 FOR THICKNESSES BETWEEN 2" AND 4".
 - THE MANUFACTURER OF ANY COMPONENT CITED IN ITEMS A.) THROUGH C.) ABOVE, SHALL CERTIFY TO THE COMPLIANCE OF EACH SHIPMENT OF THAT COMPONENT WITH APPLICABLE SPECIFICATION(S).
 - PANELS SHALL BE CONTINUOUS IN THE DIRECTION OF SLOPE WITH NO TRANSVERSE JOINTS.
 - MAXIMUM ALLOWABLE SPANS ARE AS SHOWN IN TABLE, DWG. PPC-7.
- WALL FASTENERS:
 - AT 10 PSF LIVE LOAD USE 1- #12 WOOD SCREW AT 16" c/c EMBEDDED 1 1/2" MINIMUM INTO GROUP 2 OR BETTER LUMBER.
 - AT 20 PSF AND 30 PSF LIVE/SNOW LOAD USE 2- #12 WOOD SCREWS AT 16" c/c EMBEDDED 1 1/2" MINIMUM INTO GROUP 2 OR BETTER LUMBER.
- ENCLOSABILITY THESE UNITS MAY BE ENCLOSED WITH CURRENTLY RECOGNIZED ICBO EVALUATION SERVICE, INC. PATIO COVER ENCLOSURE WALLS.
- SEE DRAWING PPC-1 FOR ADDITIONAL NOTES.

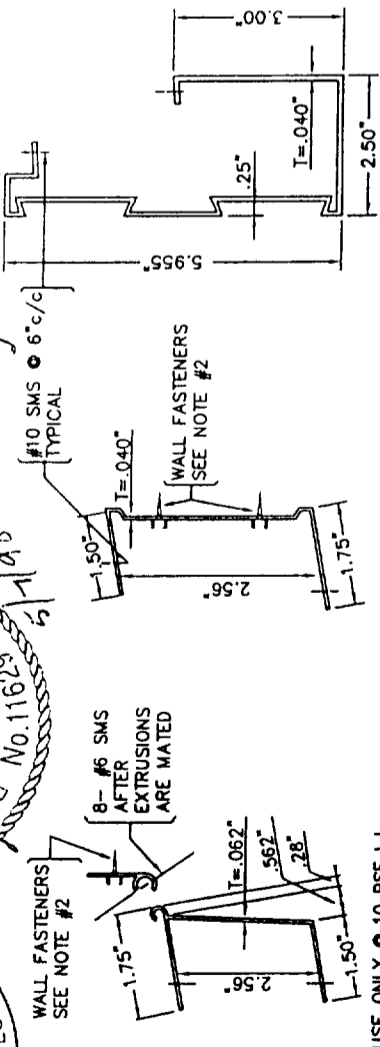
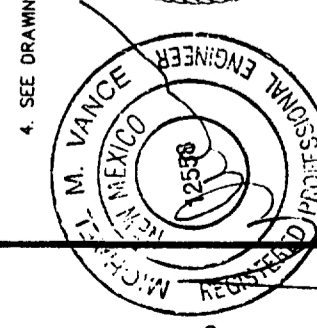
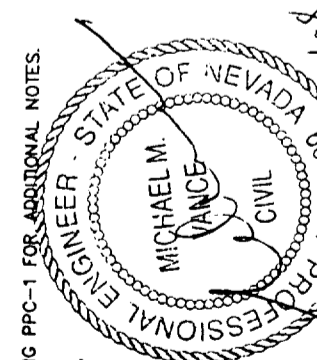
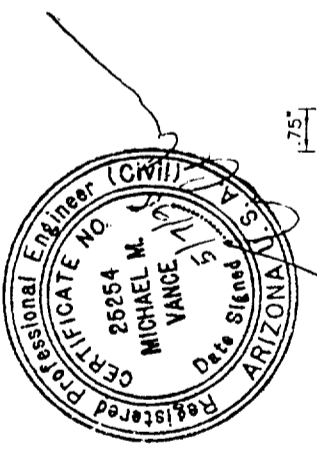

ROLLFORMED HANGER (ALUM 3004-H36)
FRONT FASCIA (ALUM 3004-H36)

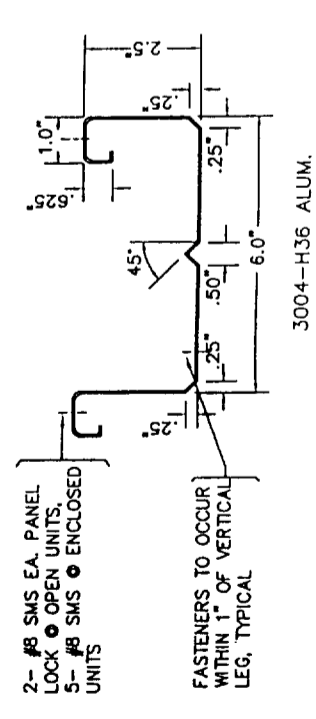

EXTRUDED HANGER (6061-T6 ALUM.)

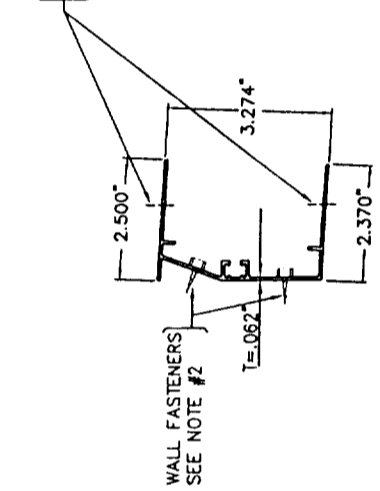

EXTRUDED HANGER (6063-T6 ALUM.)

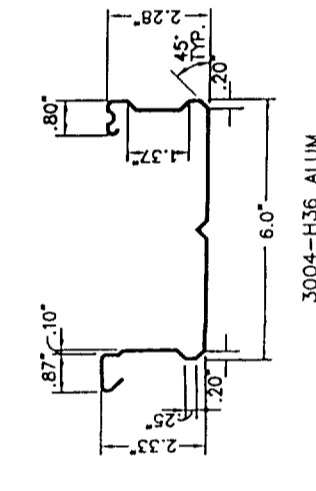

2-3/8" x 6" FLAT PANEL

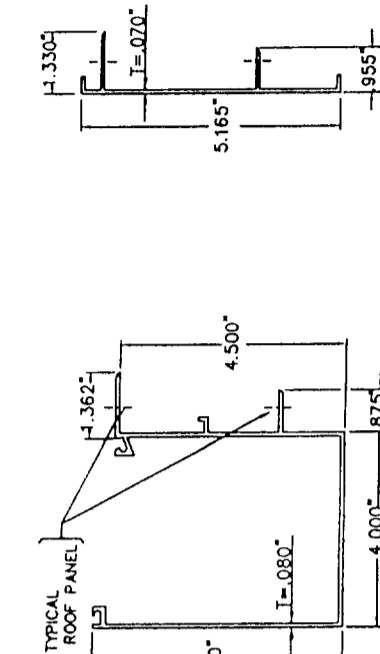

DELUXE GUTTER FASCIA (6063-T6 ALUM.)

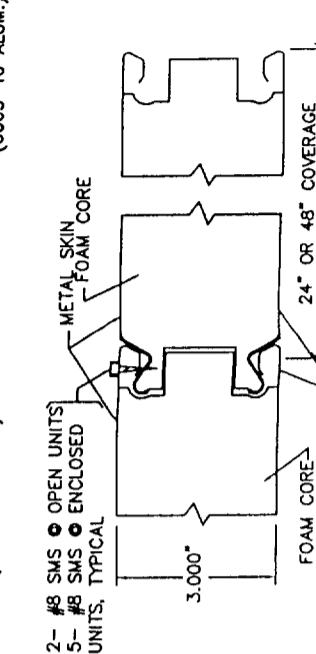

DELUXE SIDE FASCIA (6063-T6 ALUM.)

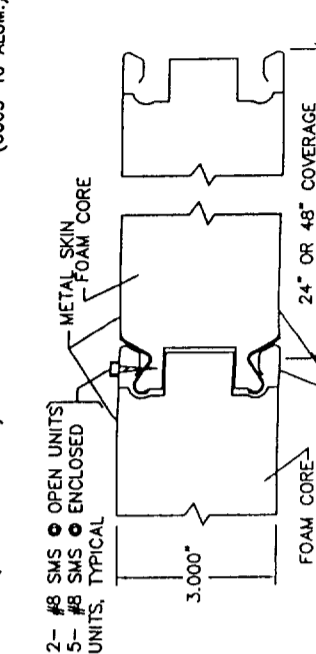

DELUXE GUTTER FASCIA (6063-T6 ALUM.)

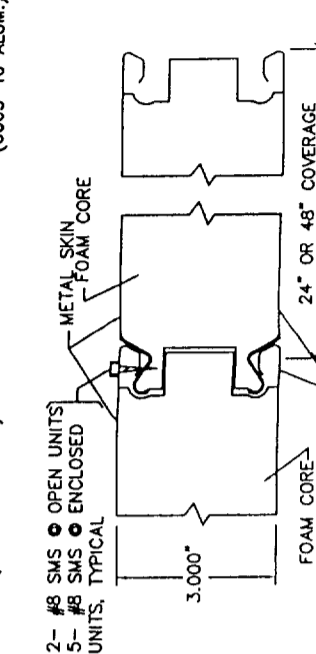

DELUXE SIDE FASCIA (6063-T6 ALUM.)

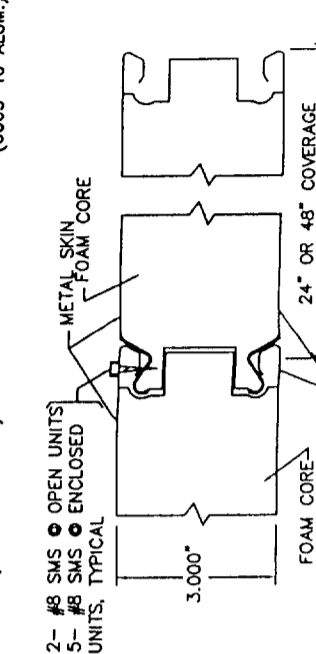

DELUXE GUTTER FASCIA (6063-T6 ALUM.)

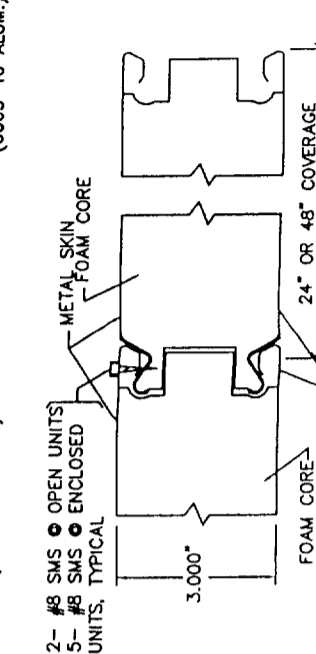

DELUXE SIDE FASCIA (6063-T6 ALUM.)

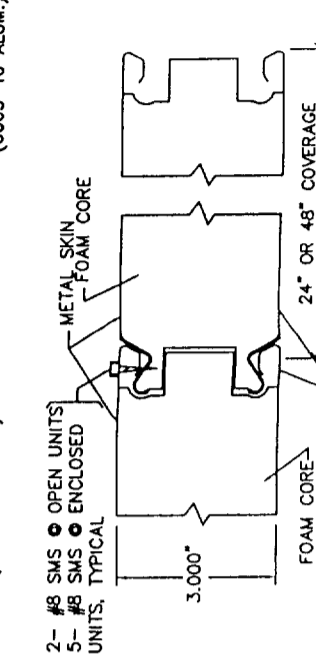

DELUXE GUTTER FASCIA (6063-T6 ALUM.)

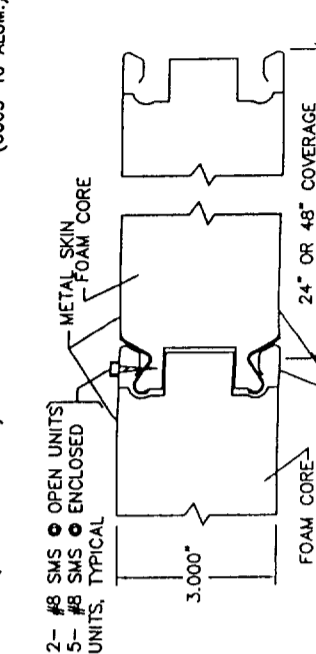

DELUXE SIDE FASCIA (6063-T6 ALUM.)

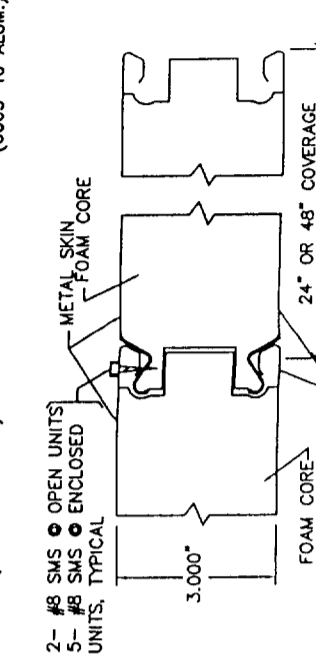

DELUXE GUTTER FASCIA (6063-T6 ALUM.)

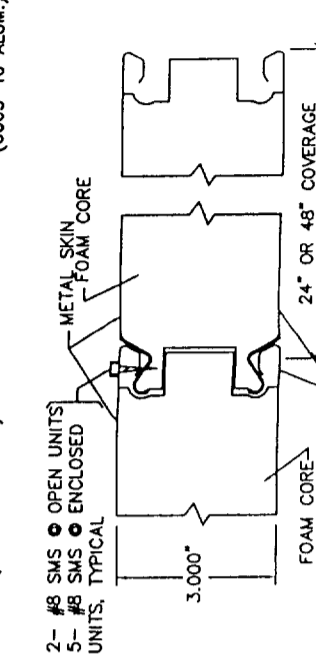

DELUXE SIDE FASCIA (6063-T6 ALUM.)

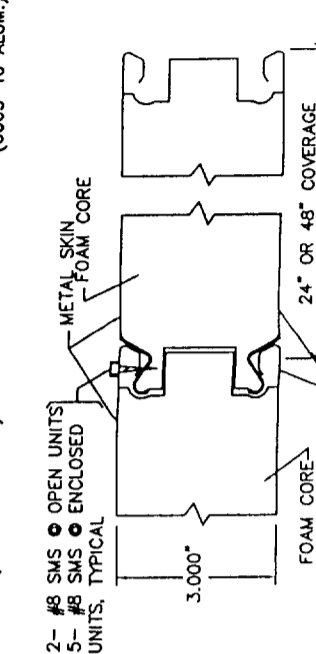

DELUXE GUTTER FASCIA (6063-T6 ALUM.)

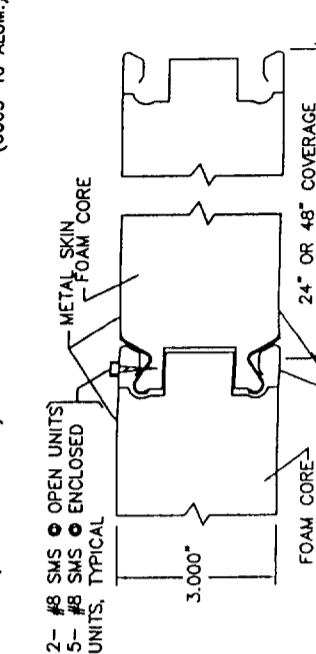

DELUXE SIDE FASCIA (6063-T6 ALUM.)

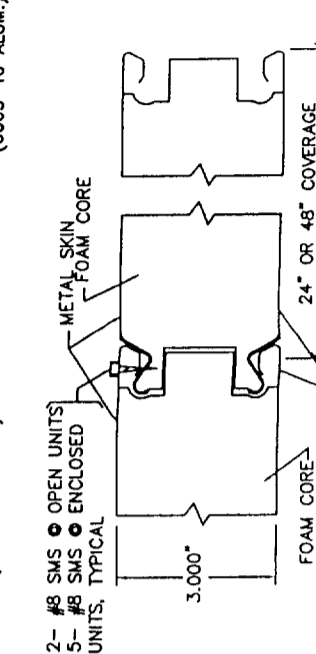

DELUXE GUTTER FASCIA (6063-T6 ALUM.)

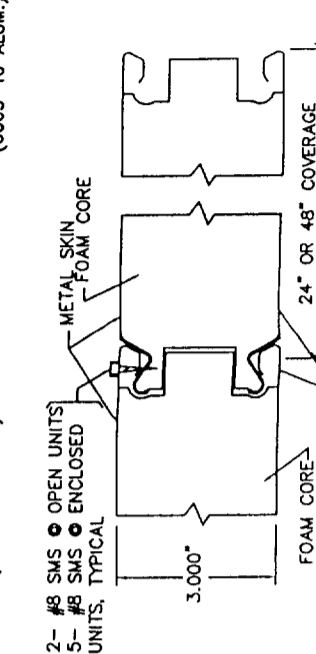

DELUXE SIDE FASCIA (6063-T6 ALUM.)

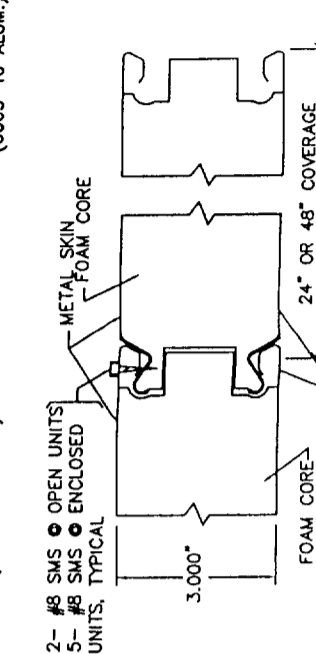

DELUXE GUTTER FASCIA (6063-T6 ALUM.)

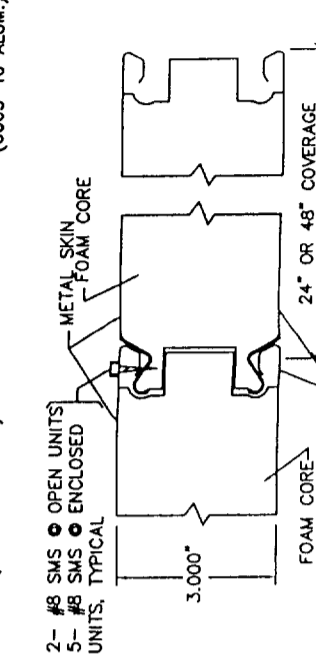

DELUXE SIDE FASCIA (6063-T6 ALUM.)

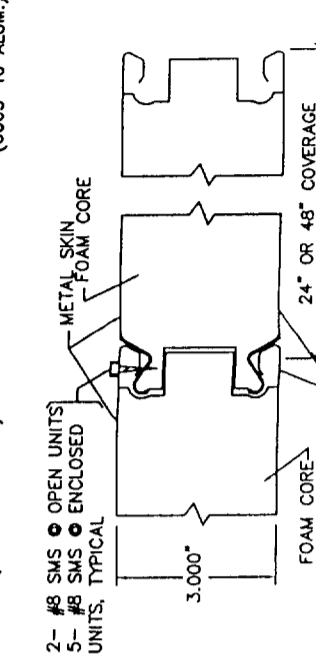

DELUXE GUTTER FASCIA (6063-T6 ALUM.)

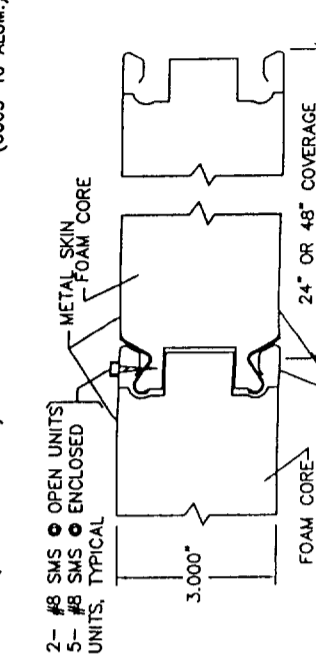

DELUXE SIDE FASCIA (6063-T6 ALUM.)

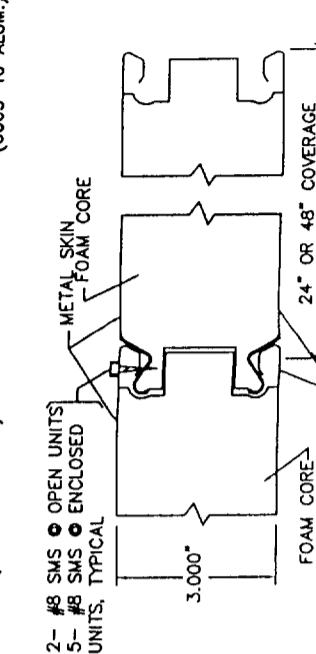

DELUXE GUTTER FASCIA (6063-T6 ALUM.)

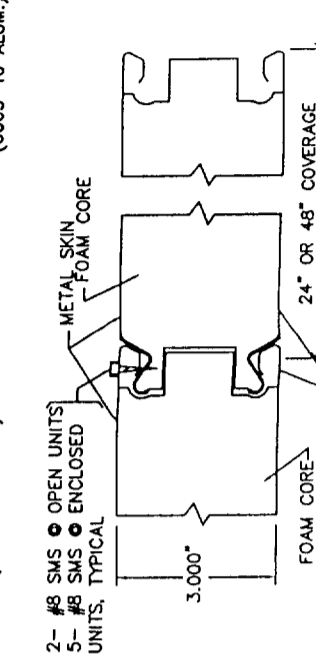

DELUXE SIDE FASCIA (6063-T6 ALUM.)

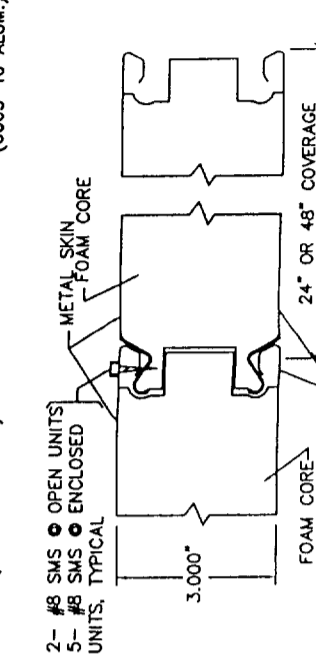

DELUXE GUTTER FASCIA (6063-T6 ALUM.)

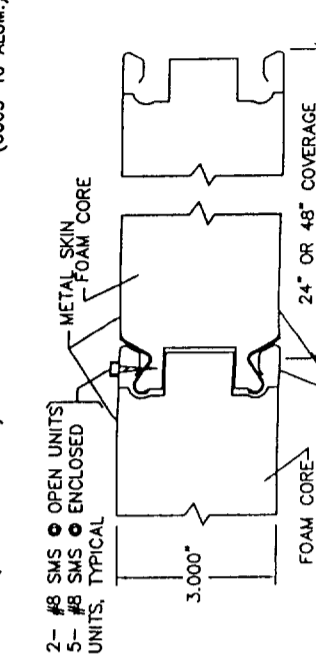

DELUXE SIDE FASCIA (6063-T6 ALUM.)

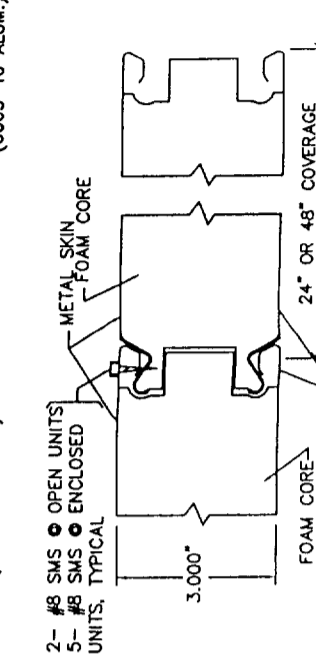

DELUXE GUTTER FASCIA (6063-T6 ALUM.)

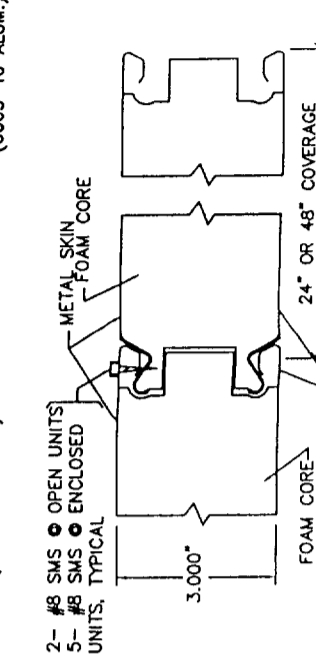

DELUXE SIDE FASCIA (6063-T6 ALUM.)

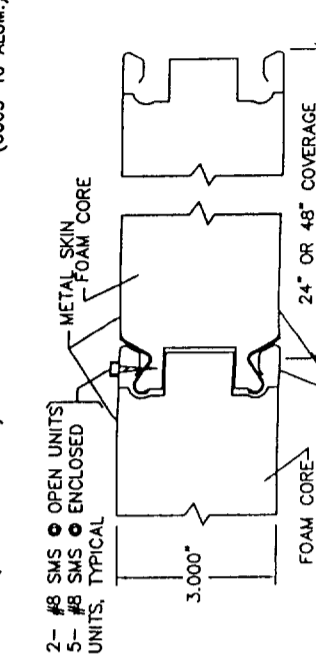

DELUXE GUTTER FASCIA (6063-T6 ALUM.)

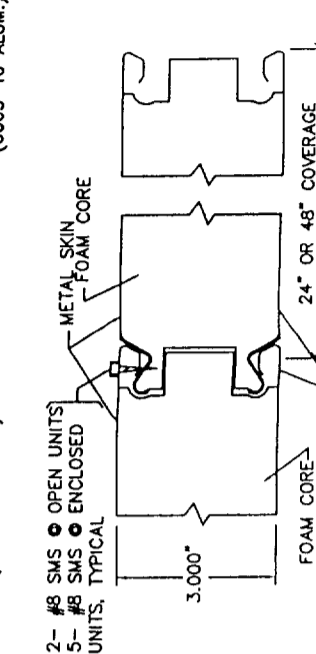

DELUXE SIDE FASCIA (6063-T6 ALUM.)

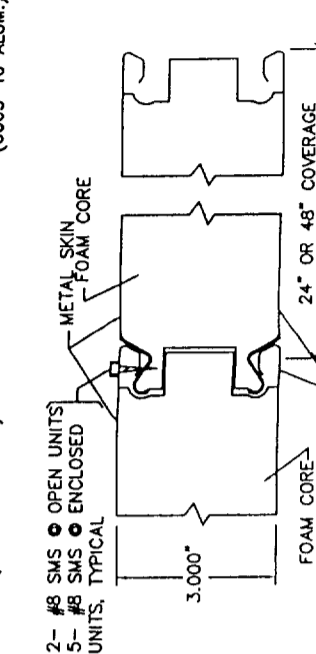

DELUXE GUTTER FASCIA (6063-T6 ALUM.)

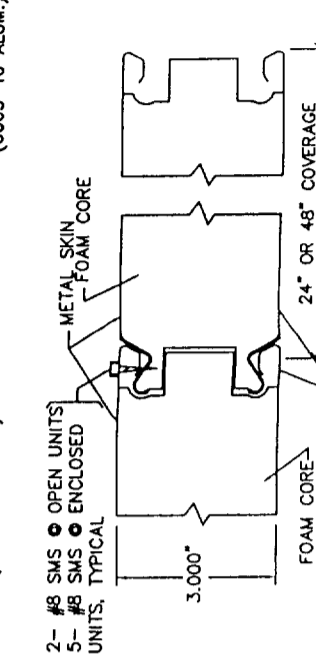

DELUXE SIDE FASCIA (6063-T6 ALUM.)

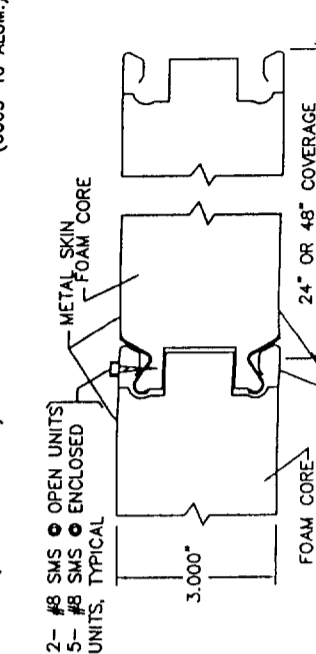

DELUXE GUTTER FASCIA (6063-T6 ALUM.)

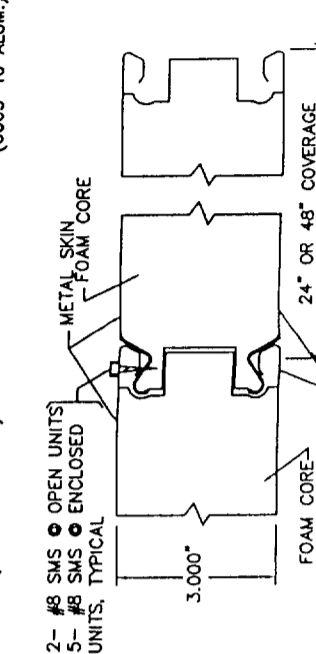

DELUXE SIDE FASCIA (6063-T6 ALUM.)

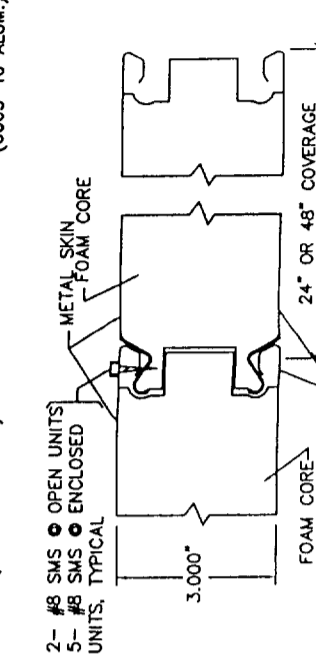

DELUXE GUTTER FASCIA (6063-T6 ALUM.)

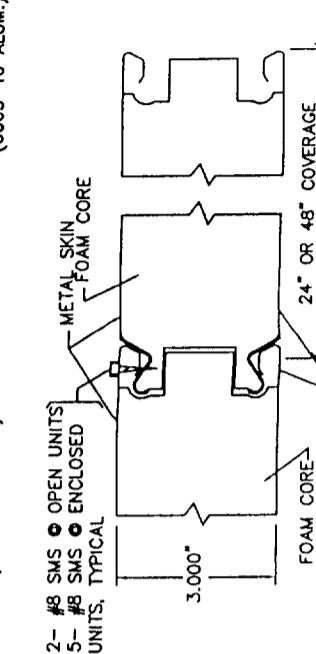

DELUXE SIDE FASCIA (6063-T6 ALUM.)

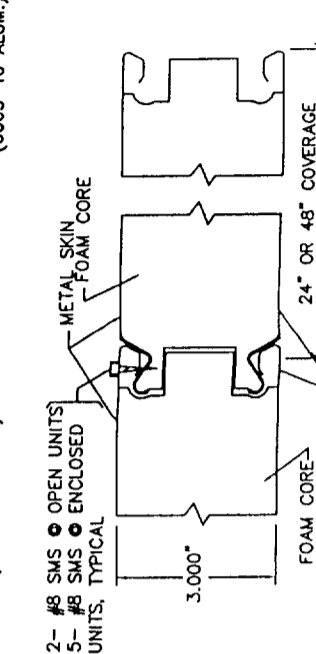

DELUXE GUTTER FASCIA (6063-T6 ALUM.)

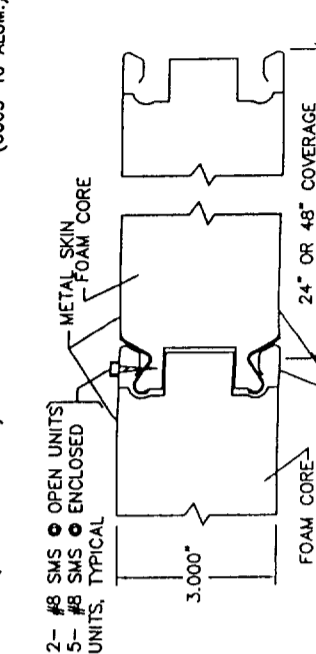

DELUXE SIDE FASCIA (6063-T6 ALUM.)

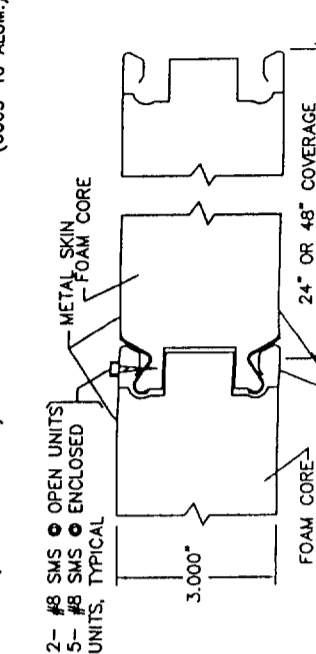

DELUXE GUTTER FASCIA (6063-T6 ALUM.)

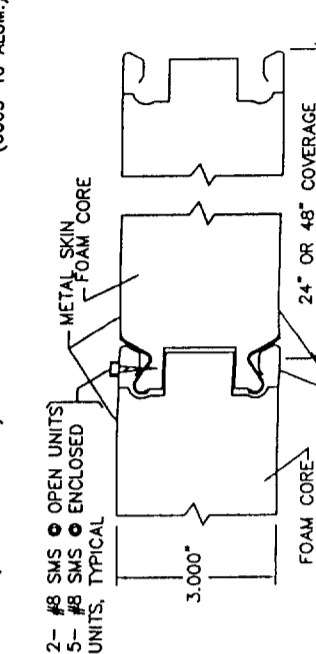

DELUXE SIDE FASCIA (6063-T6 ALUM.)

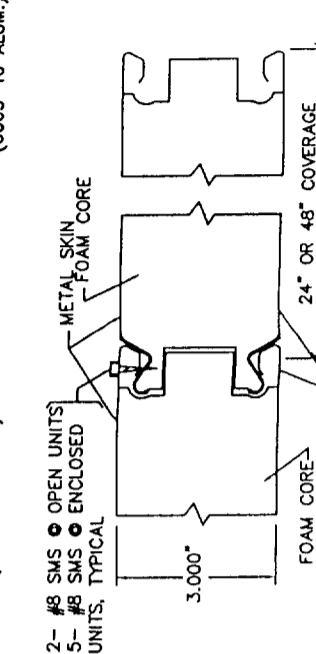

DELUXE GUTTER FASCIA (6063-T6 ALUM.)

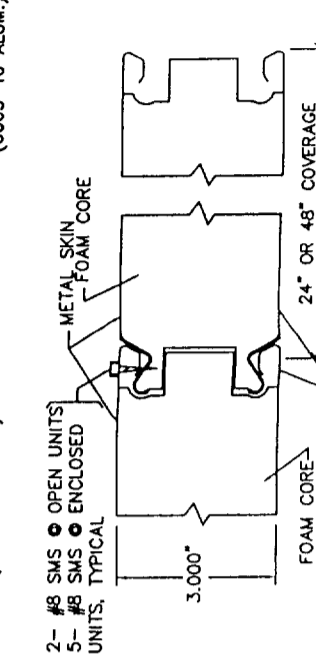

DELUXE SIDE FASCIA (6063-T6 ALUM.)

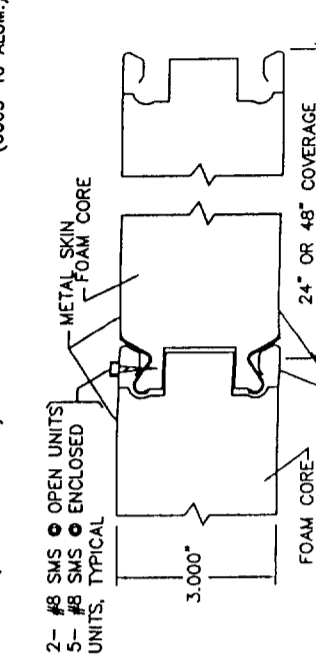

DELUXE GUTTER FASCIA (6063-T6 ALUM.)

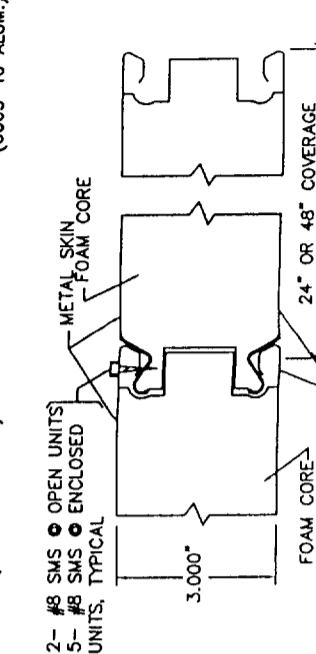

DELUXE SIDE FASCIA (6063-T6 ALUM.)

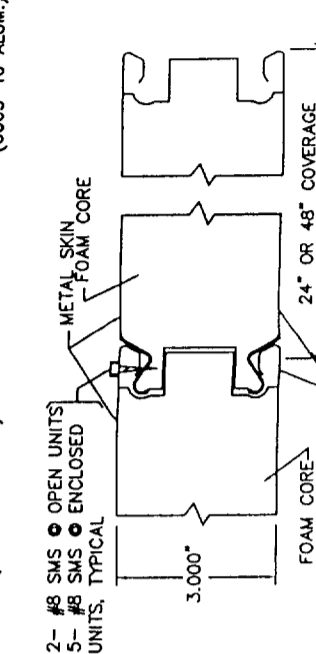

DELUXE GUTTER FASCIA (6063-T6 ALUM.)

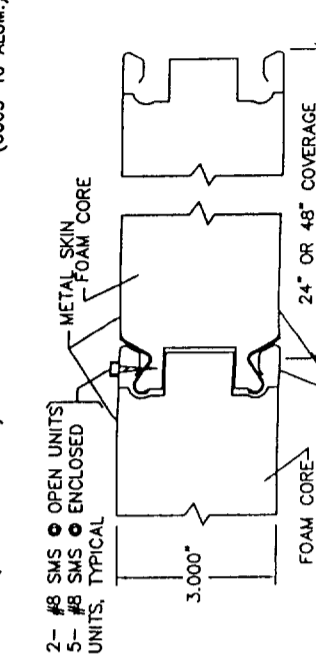

DELUXE SIDE FASCIA (6063-T6 ALUM.)

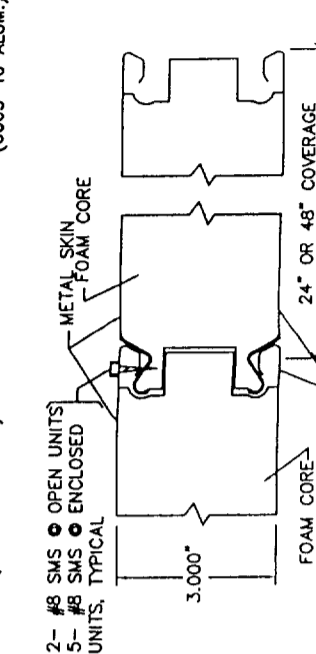

DELUXE GUTTER FASCIA (6063-T6 ALUM.)

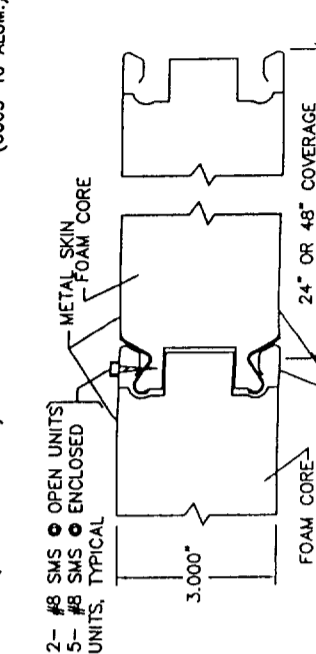

DELUXE SIDE FASCIA (6063-T6 ALUM.)

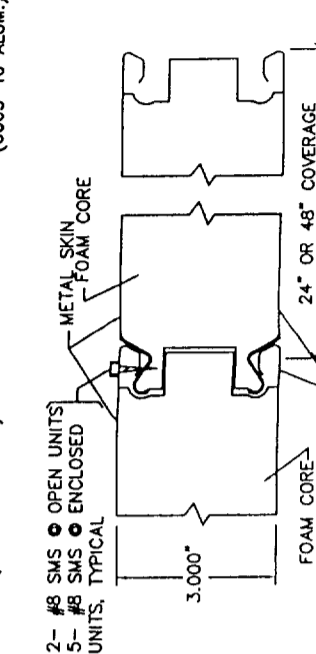

DELUXE GUTTER FASCIA (6063-T6 ALUM.)

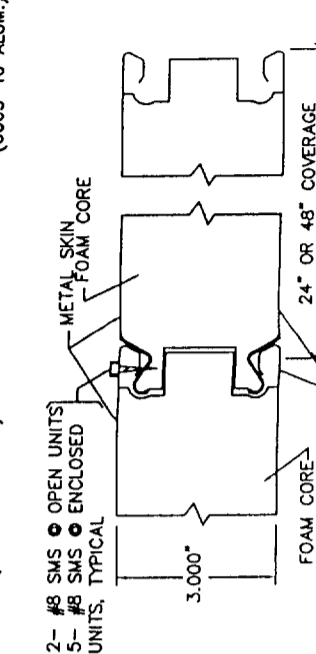

DELUXE SIDE FASCIA (6063-T6 ALUM.)

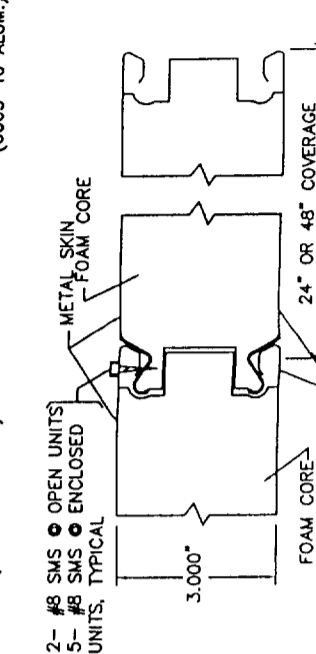

DELUXE GUTTER FASCIA (6063-T6 ALUM.)

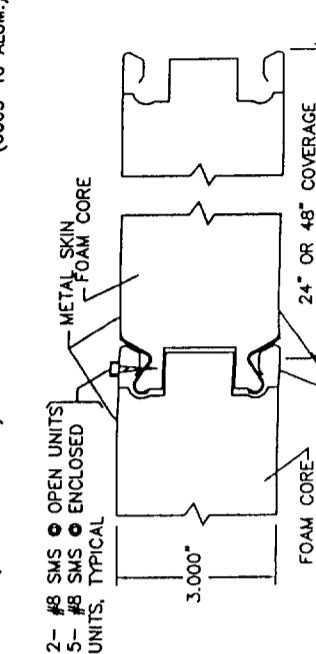

DELUXE SIDE FASCIA (6063-T6 ALUM.)

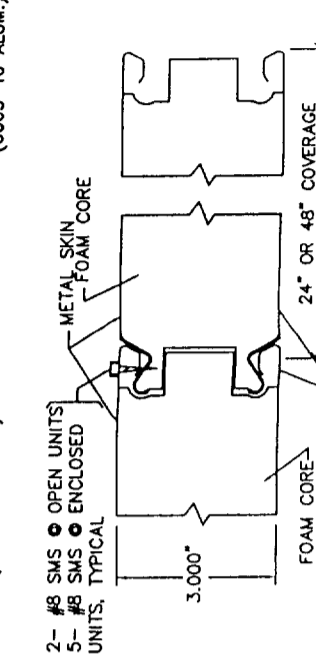

DELUXE GUTTER FASCIA (6063-T6 ALUM.)

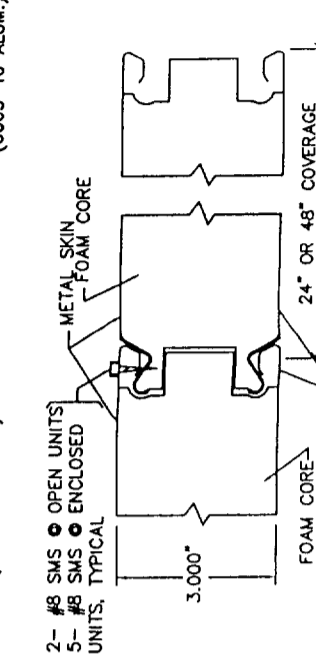

DELUXE SIDE FASCIA (6063-T6 ALUM.)

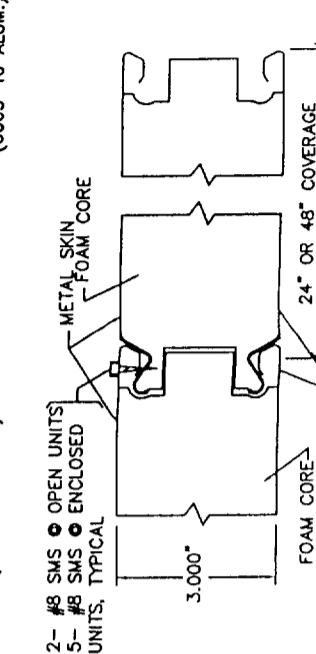

DELUXE GUTTER FASCIA (6063-T6 ALUM.)

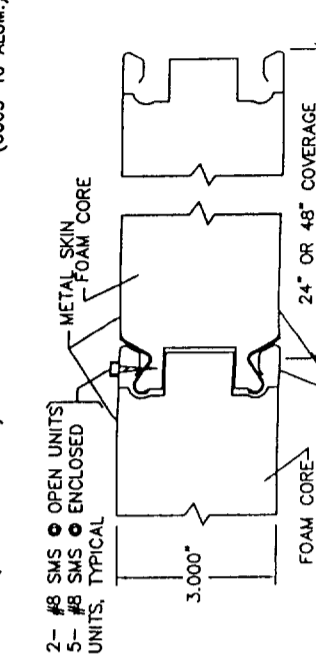

DELUXE SIDE FASCIA (6063-T6 ALUM.)

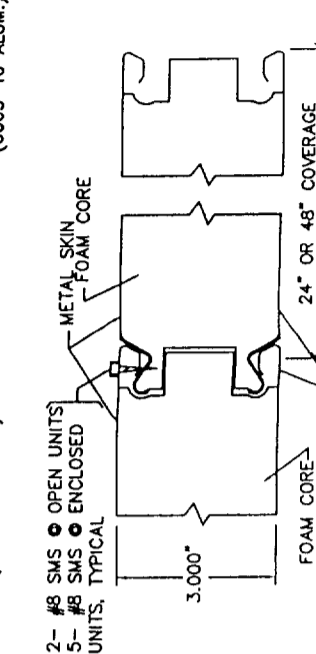

DELUXE GUTTER FASCIA (6063-T6 ALUM.)

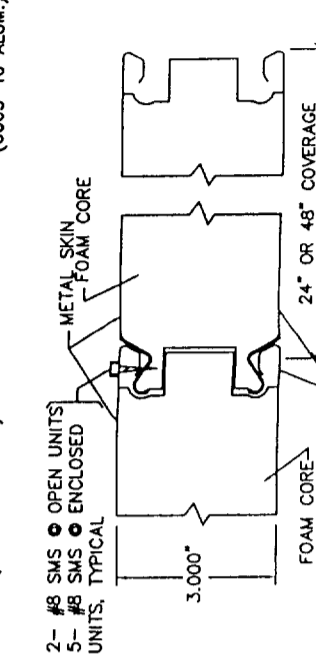

DELUXE SIDE FASCIA (6063-T6 ALUM.)

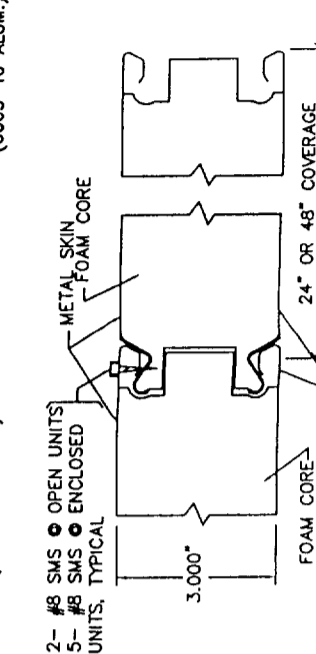

DELUXE GUTTER FASCIA (6063-T6 ALUM.)

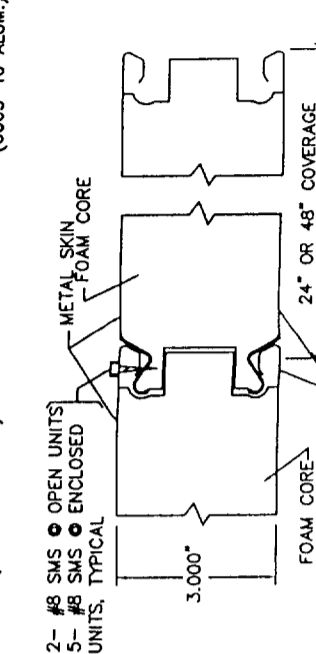

DELUXE SIDE FASCIA (6063-T6 ALUM.)

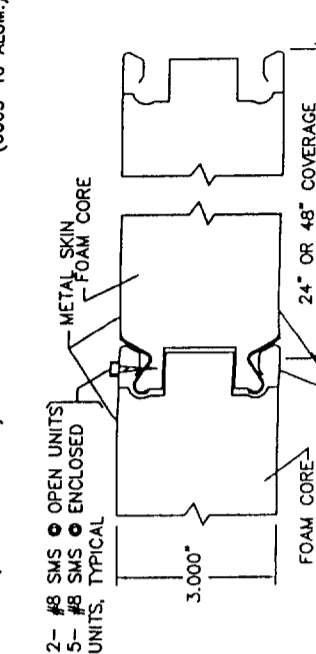

DELUXE GUTTER FASCIA (6063-T6 ALUM.)

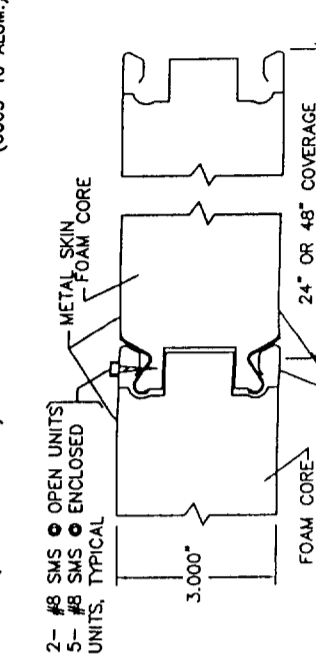

DELUXE SIDE FASCIA (6063-T6 ALUM.)

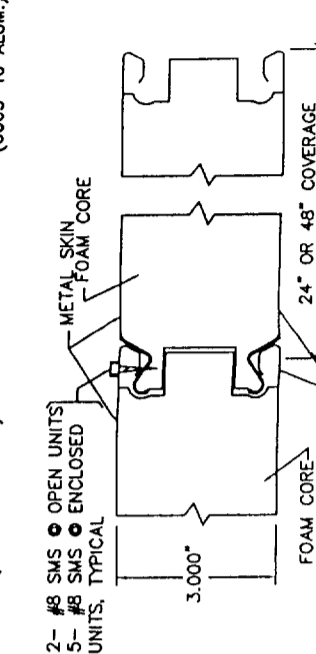

DELUXE GUTTER FASCIA (6063-T6 ALUM.)

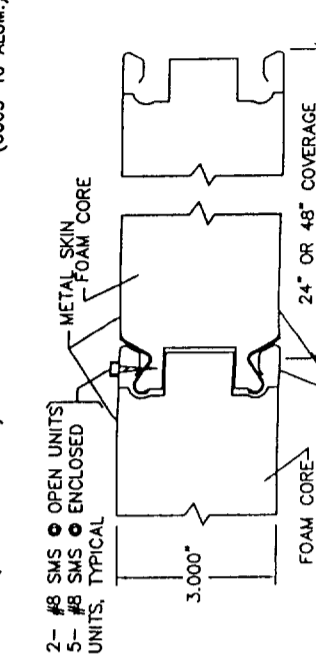

DELUXE SIDE FASCIA (6063-T6 ALUM.)

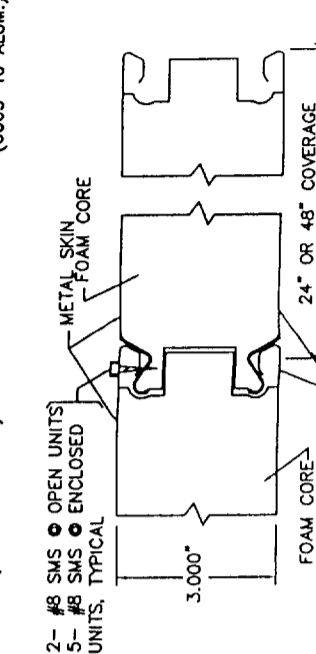

DELUXE GUTTER FASCIA (6063-T6 ALUM.)

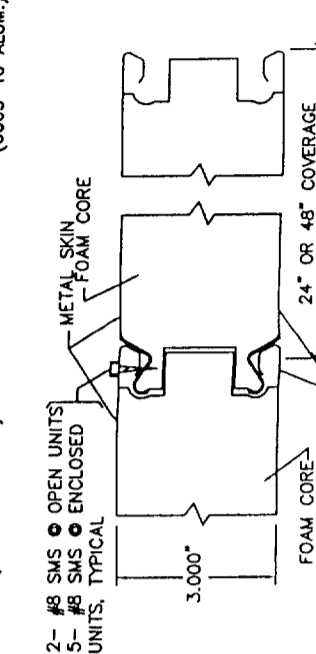

DELUXE SIDE FASCIA (6063-T6 ALUM.)

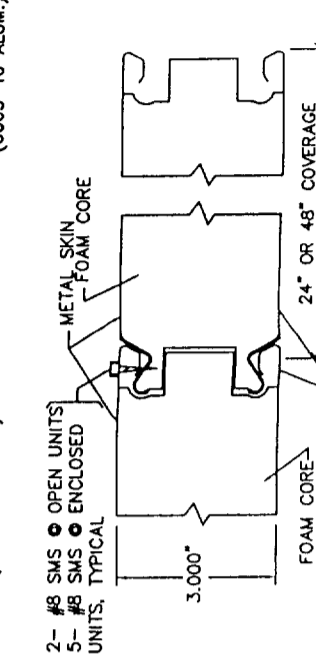

DELUXE GUTTER FASCIA (6063-T6 ALUM.)

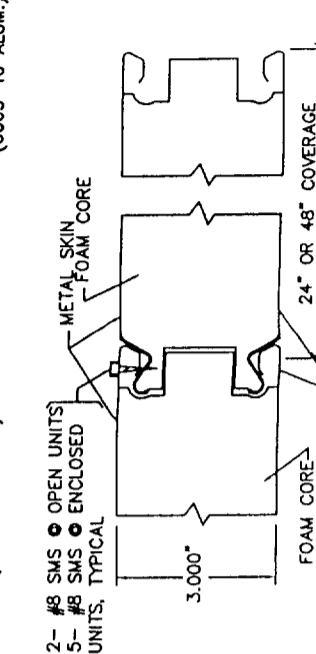

DELUXE SIDE FASCIA (6063-T6 ALUM.)

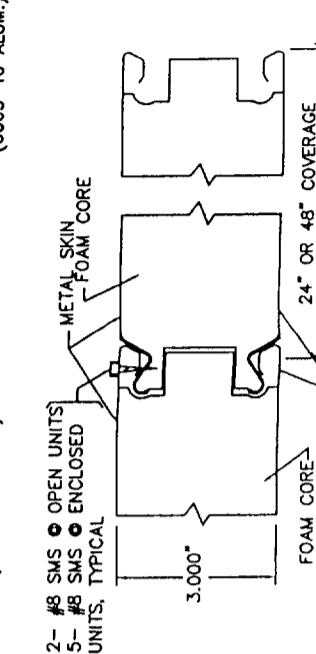

DELUXE GUTTER FASCIA (6063-T6 ALUM.)

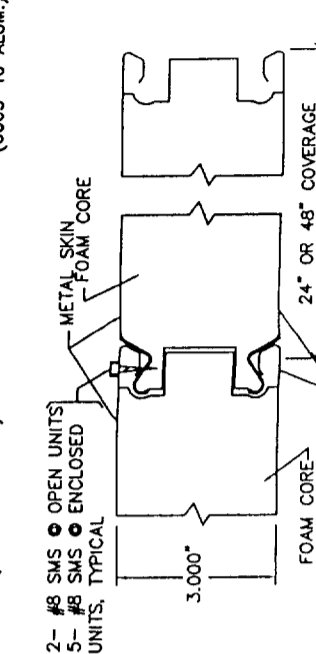

DELUXE SIDE FASCIA (6063-T6 ALUM.)

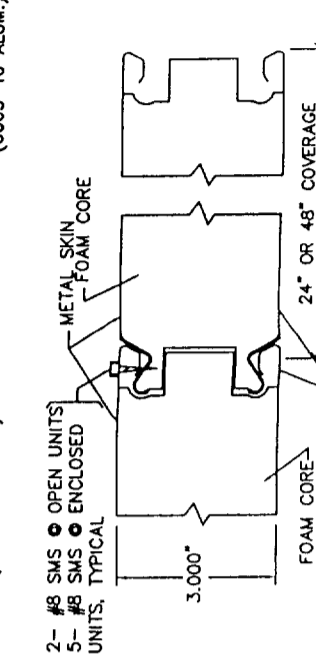

DELUXE GUTTER FASCIA (6063-T6 ALUM.)

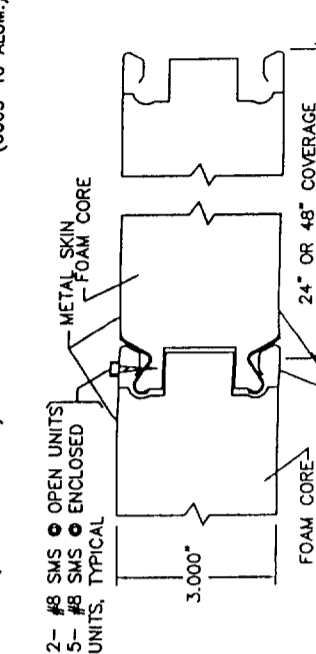

DELUXE SIDE FASCIA (6063-T6 ALUM.)

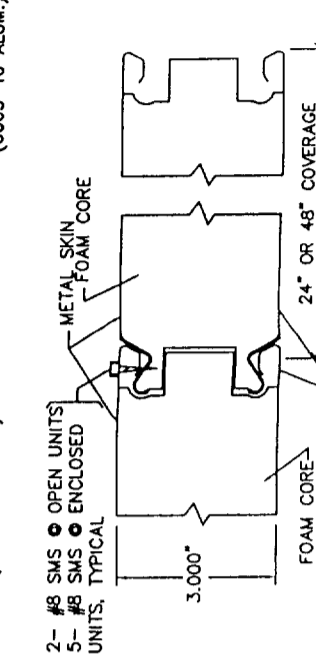

DELUXE GUTTER FASCIA (6063-T6 ALUM.)

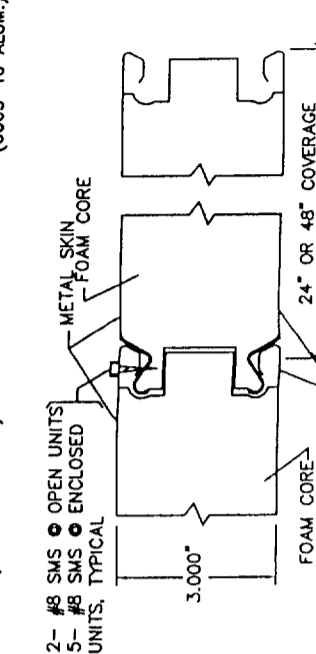

DELUXE SIDE FASCIA (6063-T6 ALUM.)

