

CITY OF SACRAMENTO
1231 I Street, Sacramento, CA 95814

Permit No: 0013455

Insp Area: 4

Site Address: 1848 NORTH BEND DR SAC

Parcel No: 225-1100-004

Sub-Type: NOTHR

Housing (Y/N): N

CONTRACTOR

PACIFIC BUILDERS
5421 84TH ST
SAC, CA 95826

OWNER

BAUMANN M/M
1848 NORTH BEND DR
SACRAMENTO CA 95835

ARCHITECT

Nature of Work: 24'x14' PATIO ENCLOSURE AND 10'x8' PAVIO COVER

CONSTRUCTION LENDING AGENCY: I hereby affirm under penalty of perjury that there is a construction lending agency for the performance of the work for which this permit is issued (Sec. 3097, Civ. C).

Lender's Name _____ Lender's Address _____

LICENSED CONTRACTORS DECLARATION: I hereby affirm under penalty of perjury that I am licensed under provisions of Chapter 9 (commencing with section 7000) of Division 3 of the Business and Professions Code and my license is in full force and effect.

License Class B License Number 214409 Date 11-07-00 Contractor Signature [Signature]

OWNER-BUILDER DECLARATION: I hereby affirm under penalty of perjury that I am exempt from the contractors License Law for the following reason (Sec. 7031.5, Business and Professions Code: any city or county which requires a permit to construct, alter, improve, demolish, or repair any structure, prior to its issuance, also requires the applicant for such permit to file a signed statement that he or she is licensed pursuant to the provisions of the Contractors License Law (Chapter 9 (commencing with Section 7000) of Division 8 of the Business and Professions Code) or that he or she is exempt therefrom and the basis for the alleged exemption. Any violation of Section 7031.5 by any applicant for a permit subjects the applicant to a civil penalty of not more than five hundred dollars (\$500.00);

____ I, as a owner of the property, or my employees with wages as their sole compensation, will do the work, and the structure is not intended or offered for sale (Sec. 7044, Business and Professional Code: The Contractors License Law does not apply to an owner of property who builds or improves thereon, and who does such work himself or herself or through his/her own employees, provided that such improvements are not intended or offered for sale. If, however, the building or improvement is sold within one year of completion, the owner-builder will have the burden of proving that he/she did not build or improve for the purpose of sale.)

____ I, as owner of the property, am exclusively contracting with licensed contractors to construct the project (Sec. 7044, Business and Professions Code: The Contractors License Law does not apply to an owner of property who builds or improves thereon, and who contracts for such projects with a contractor(s) licensed pursuant to the Contractors License Law).

____ I am exempt under Sec _____ B & PC for this reason: _____

Date _____ Owner Signature _____

IN ISSUING THIS BUILDING PERMIT, the applicant represents, and the city relies on the representation of the applicant, that the applicant verified all measurements and locations shown on the application or accompanying drawings and that the improvement to be constructed does not violate any law or private agreement relating to permissible or prohibited locations for such improvements. This building permit does not authorize any illegal location of any improvement or the violation of any private agreement relating to location of improvements.

I certify that I have read this application and state that all information is correct. I agree to comply with all city and county ordinances and state laws relating to building construction and hereby authorize representative(s) of this city to enter upon the abovementioned property for inspection purposes.

Date 11-07-00 Applicant/Agent Signature [Signature]

WORKER'S COMPENSATION DECLARATION: I hereby affirm under penalty of perjury one of the following declarations:

____ I have and will maintain a certificate of consent to self-insure for workers' compensation as provided for by Section 3700 of the Labor Code, for the performance of work for which the permit is issued.

[Signature] I have and will maintain workers' compensation insurance, as required by Section 3700 of the Labor Code, for the performance of the work for which this permit is issued. My workers' compensation insurance carrier and policy number are:

Carrier STATE FUND Policy Number 159683600 Exp Date 10/01/2001

____ (This section need not be completed if the permit is for \$100 or less) I certify that in the performance of the work for which this permit is issued, I shall not employ any person in any manner so as to become subject to the workers' compensation laws of California and agree that if I should become subject to the workers' compensation provisions of Section 3700 of the Labor Code, I shall forthwith comply with those provisions.

Date 11-07-00 Applicant Signature [Signature]

WARNING: FAILURE TO SECURE WORKER'S COMPENSATION COVERAGE IS UNLAWFUL AND SHALL SUBJECT AN EMPLOYER TO CRIMINAL PENALTIES AND CIVIL FINES UP TO ONE HUNDRED THOUSAND DOLLARS (\$100,000) IN ADDITION TO THE COST OF COMPENSATION, DAMAGES AS PROVIDED FOR IN SECTION 3706 OF THE LABOR CODE, INTEREST AND ATTORNEY'S FEE.

THIS PERMIT SHALL EXPIRE BY LIMITATION IF WORK IS NOT COMMENCED WITHIN 180 DAYS.

Date of Request: _____

By: _____

CITY OF SACRAMENTO DEVELOPMENT SERVICES DIVISION
PLANNING AND ZONING INFORMATION REQUEST

Project Address: 848 NORTH BEND DR, SAC. 95835

Assessor's Parcel Number: 225 - 1100 - 004

Previous Use: SFP

Description of Request/Proposed Use: PAIK ENCLOSURE 24' x 14'
PAIK COVER 8' x 10'

Is This a Change of Use? _____

Zoning Designation: R1

Prior Applications for Project Site(P#, Z#, DRPB#): _____

Comments: _____

Are There Any Planning Issues?: (circle one) YES NO

- * Staff Site Plan Check Required? (Circle one) YES NO
- * Field Inspection Required? (Circle one) YES NO
- * Design Review/Preservation Required?: (Circle one) YES NO

Planning Review by/Date [Signature] 11-7-00

A list of items that must be reviewed by Planning is provided on the reverse side of this form.

MICROFILM AFTER FINAL

This Plot Plan is for the purpose of showing the house to be constructed on the lot and may not represent the final as-built configuration of the property or improvements thereon. Setbacks, other than minimum ordinance, are approximate only and must not be assumed to be precise.

M/M BAUMANN
 1848 NORTH BEND DR
 SACRAMENTO, CA 95835
 PH. (916) 419-1920

ISSUED

NOV 11 2000

CITY OF SACRAMENTO
 DEVELOPMENT SERVICES DIV.

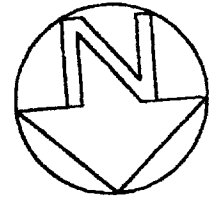

SCALE: 1"=20'

58.00'

PROPOSED 8'x10'

PATIO COVER

This set of plans and specifications must be kept on the job at all times and it is unlawful to make any changes or alterations from the same without written permission from the Building Inspection Division.
 The approval of this plan and specification SHALL NOT be held to permit or approve the violation of any City Ordinance or State Law.

REVIT WED 11/15/00

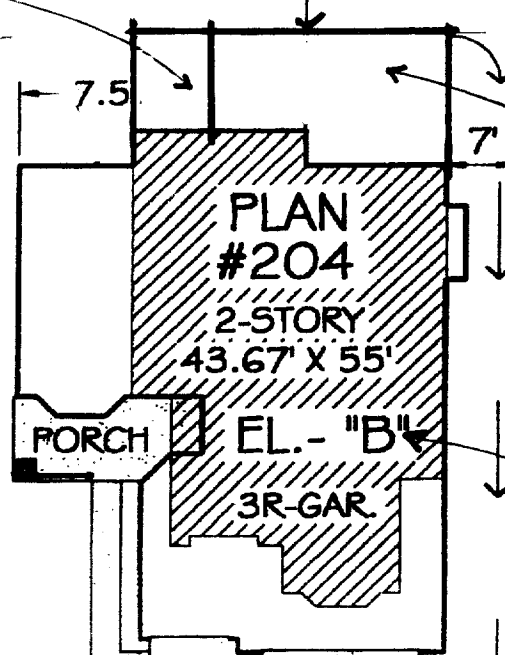

PROPOSED 24'x14'
 PATIO ENCLOSURE

115.00'

EX. RESIDENCE

PORCH

EL. - "B"

3R-GAR

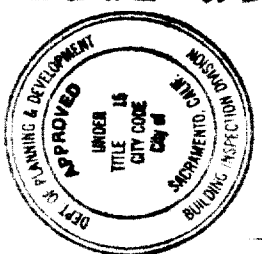

12.5' P.U.E.

20'

4.5' S.W.

60'

58.00'

5' PLANTER

3' C&G

INDICATES UPPER STORY LEVEL.

1848 NORTH BEND DRIVE

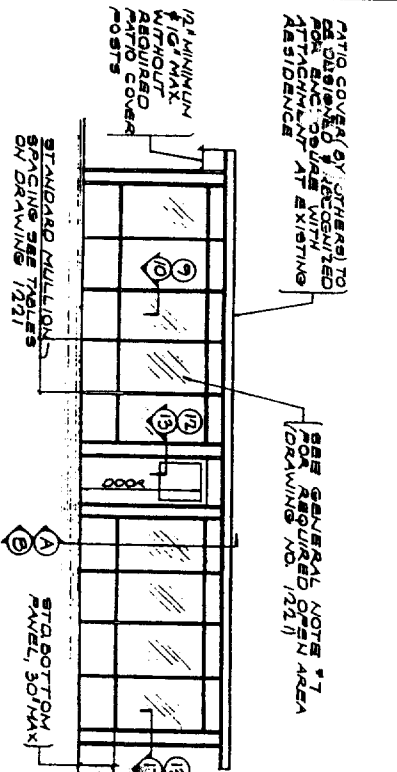

FRONT ELEVATION

EXISTING RESIDENCE

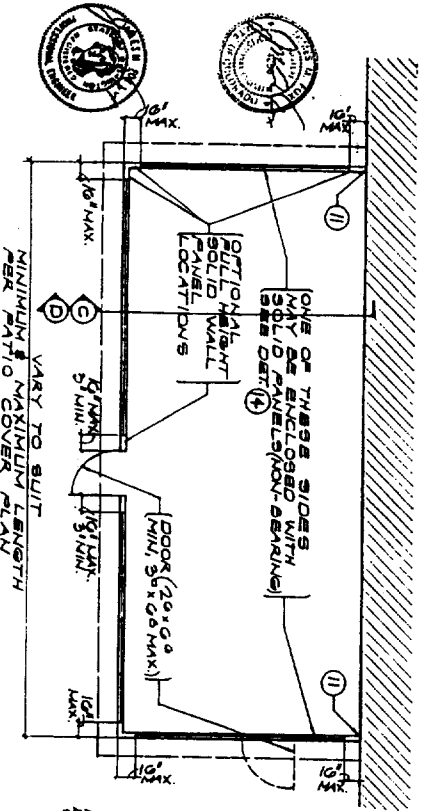

TYPICAL FLOOR PLAN

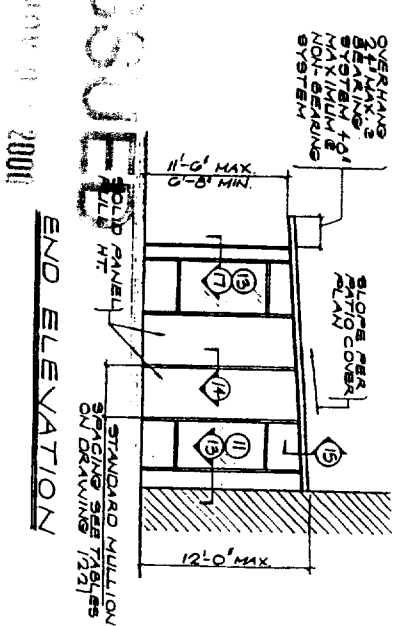

END ELEVATION

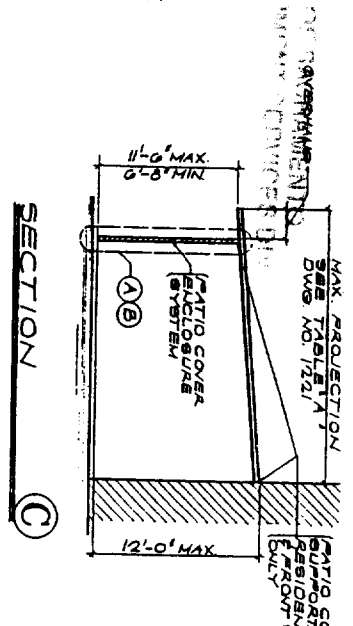

SECTION C

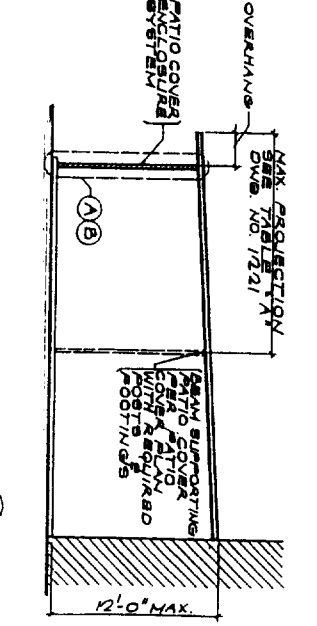

SECTION D

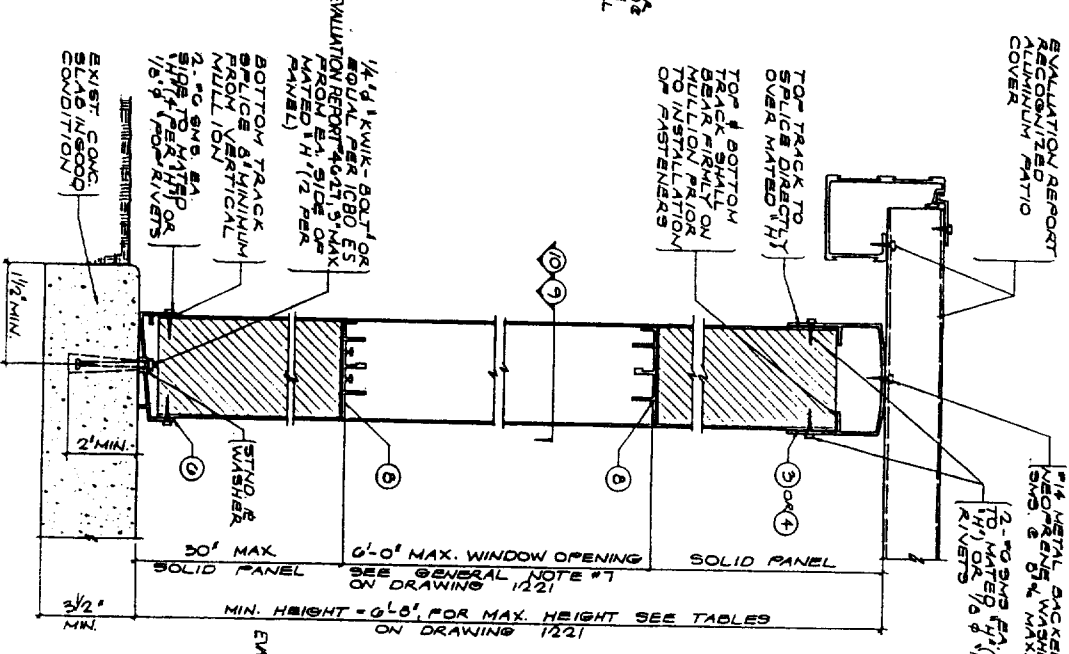

BEARING SYSTEM A

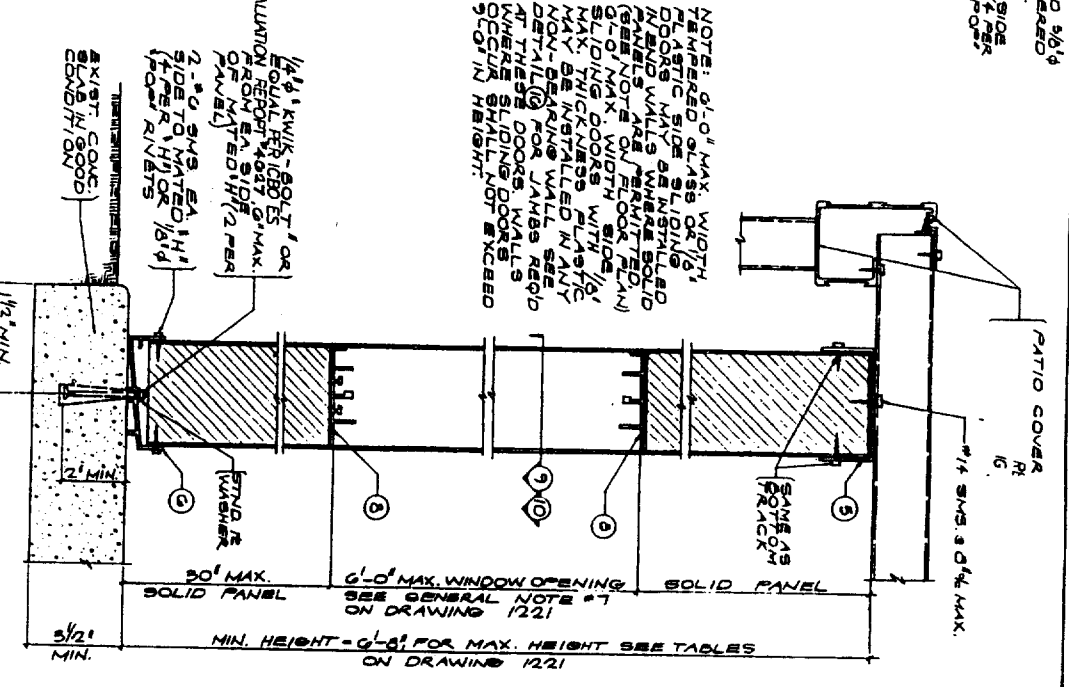

BEARING SYSTEM B

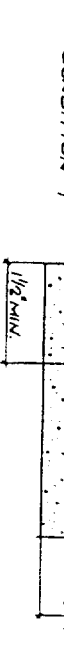

NON-BEARING SYSTEM A

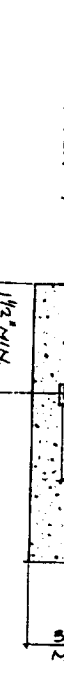

NON-BEARING SYSTEM B

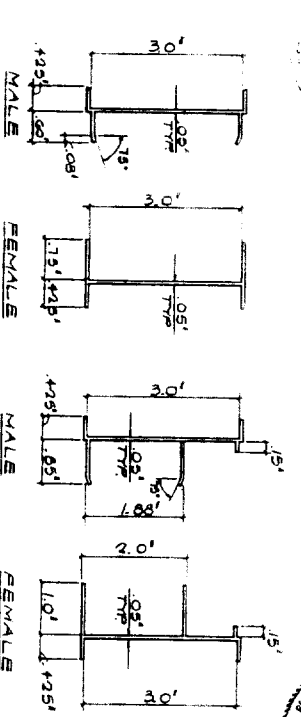

MATING H-TYPE NE 1

MATING H-TYPE NE 2

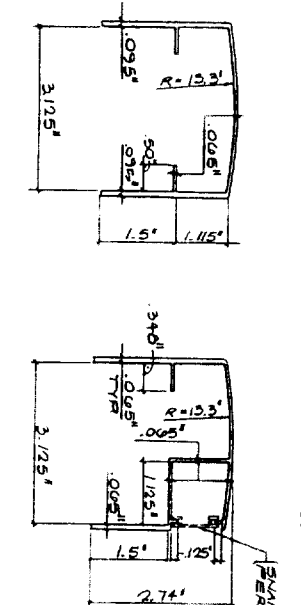

BEARING-TYPE TOP NE 3

BEARING-TYPE TOP NE 4

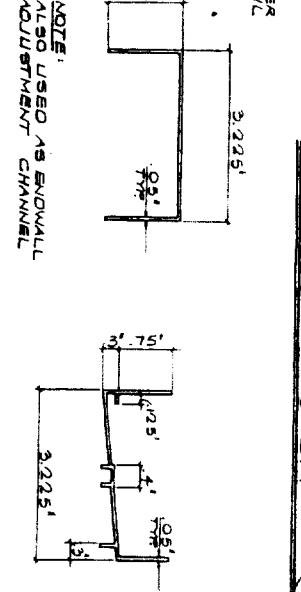

NON-BEARING TOP TRACK 5

BOTTOM TRACK 6

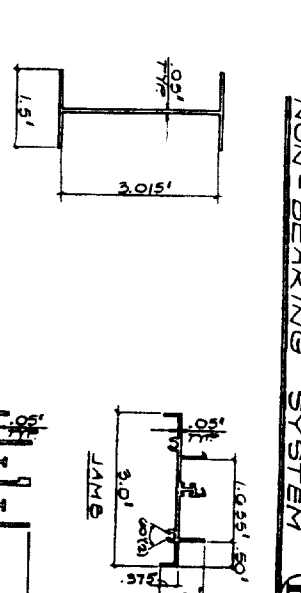

STANDARD H-TYPE 7



SILL

JAMB

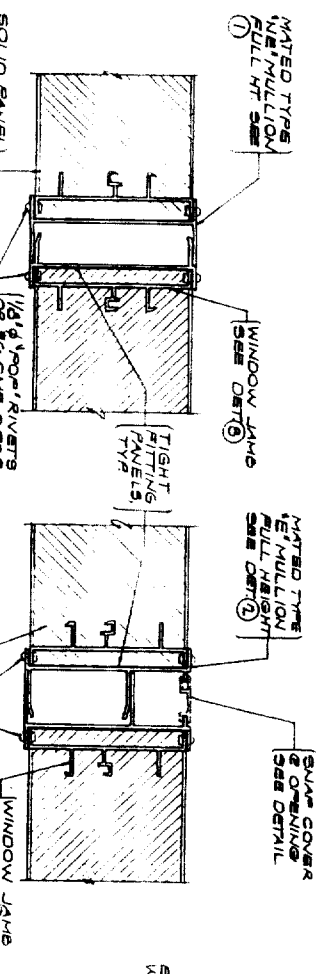

MATED TYPES NE 1

MATED TYPES NE 2

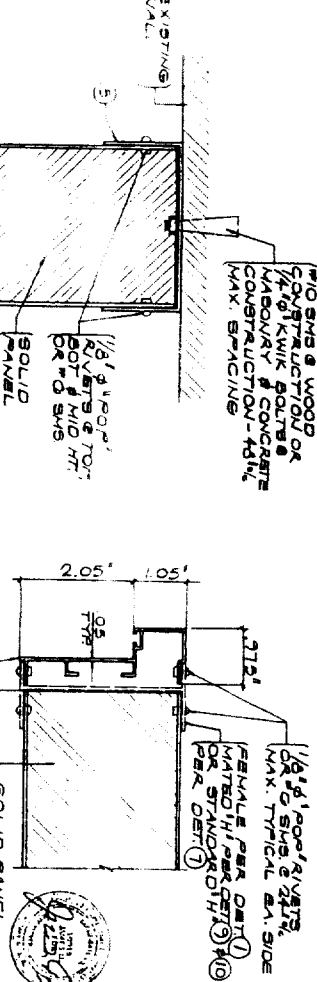

EXISTING WALL CONNECTION 11

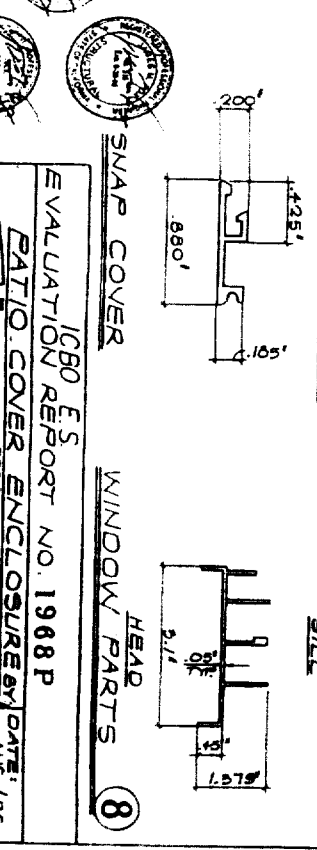

DOOR JAMB 12

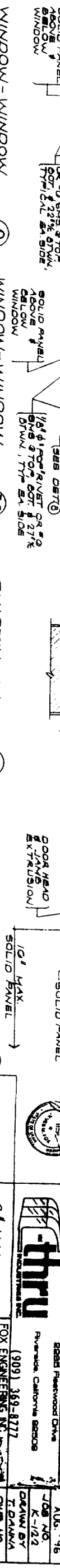

SWAP COVER 8

EVALUATION REPORT NO. 1968 P

PATIO COVER ENCLOSURE thru

ICB0 ES

3" WALL SYSTEM

DATE: '96
AUG. '96
K-12/2
DRAWN BY: T. DAMA
CHK. NO. 1220
10/6

FOX ENGINEERING INC.
8060 TELEGRAPH RD.
DOWNEY, CA 90240
30.905.4337
(909) 389-8277
FAX: 30.927.2509

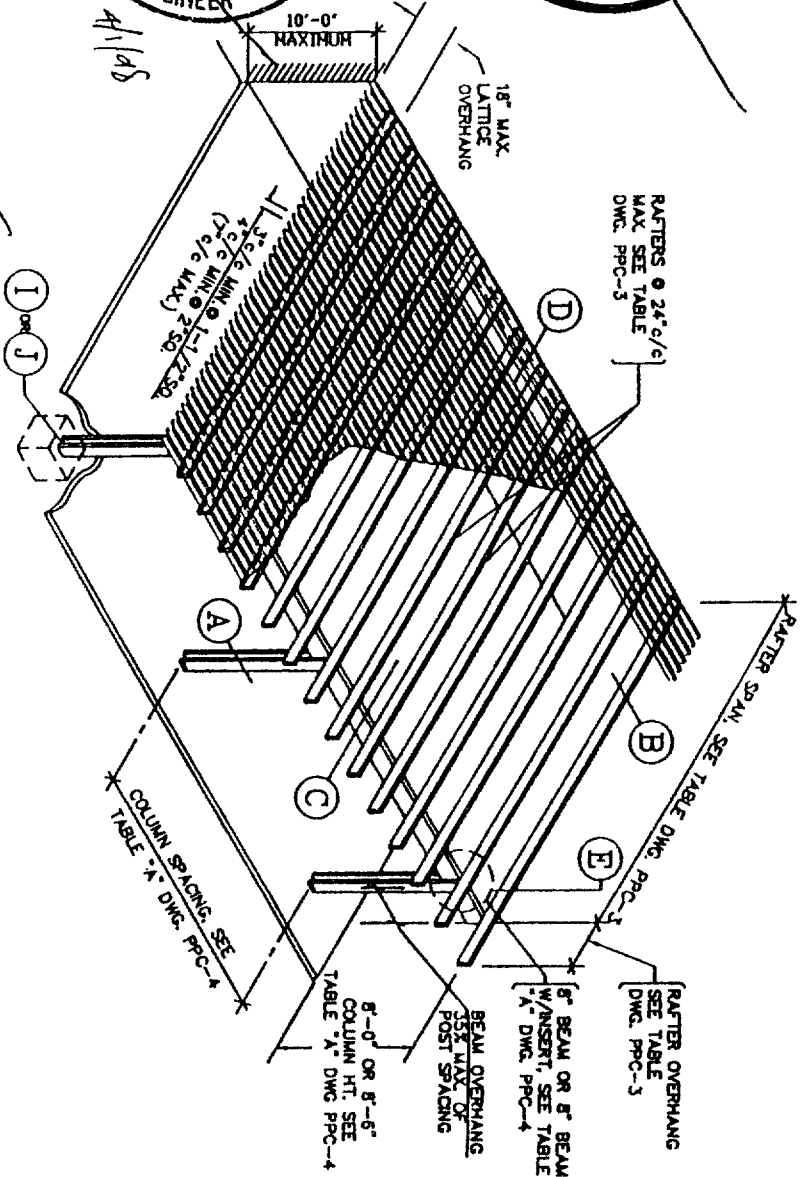
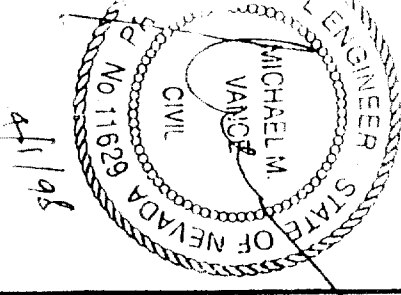
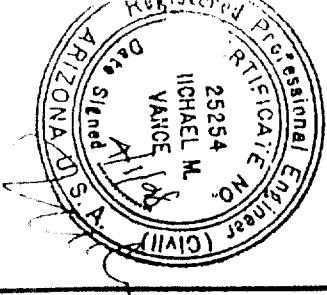
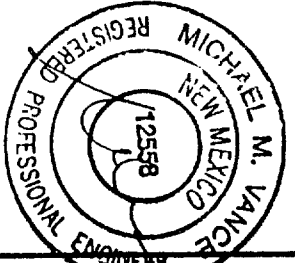
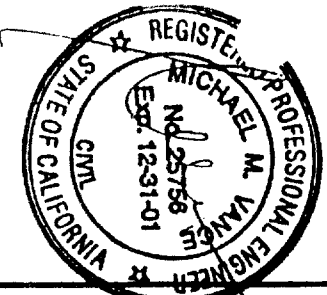

**ATTACHED PERGOLA PATIO COVER
(WITH LATTICE COVERING)**

GENERAL NOTES & SPECIFICATIONS

1. ALUMINUM DESIGN STRESSES ARE PER THE LATEST EDITION OF THE UNIFORM BUILDING CODE AND THE ALUMINUM CONSTRUCTION MANUAL.
2. ALTERNATE ALUMINUM ALLOYS MAY BE SUBSTITUTED FOR THOSE SHOWN, PROVIDED THEY ARE REGISTERED WITH THE ALUMINUM ASSOCIATION AND HAVE EQUAL OR GREATER YIELD AND ULTIMATE STRENGTHS.
3. ALL CONCRETE SHALL HAVE A MINIMUM 28 DAY COMPRESSIVE STRENGTH OF 2000 PSI. CONCRETE SLAB SHALL HAVE 3 1/2" MINIMUM THICKNESS AND SHALL BE IN GOOD CONDITION.
4. ALL FOOTINGS SHALL BEAR ON FIRM, NATURAL, UNDISTURBED SOIL OR CERTIFIED FILL. DESIGN VERTICAL SOIL BEARING PRESSURE = 1000 PSF.
5. ALL STEEL MEMBERS SHALL BE HOT DIP GALVANIZED OR ELECTROPLATED AND CONFORM TO ASTM SPEC. A-446 GRADE "C" UNLESS NOTED OTHERWISE.
6. ALUMINUM FASTENERS SHALL BE 2024-T4, ALL OTHER FASTENERS SHALL BE GALVANIZED, STAINLESS STEEL OR CADMIUM PLATED. ALL BOLTS SHALL CONFORM TO ASTM SPEC. A-307 AND HAVE STANDARD CUT PLATE WASHERS. HOLES FOR BOLTS SHALL BE BOLT DIAMETER PLUS 1/16 IN. MAXIMUM. EXPANSION ANCHORS INTO CONCRETE SHALL BE ICBO EVALUATION SERVICE, INC., RECOGNIZED AND SHALL HAVE THE MINIMUM VALUES INDICATED IN TABLE "C", MINIMUM CONCRETE EDGE DISTANCE IS SIX (6) INCHES.
8. EACH INSTALLATION SHALL BEAR AN IDENTIFYING TAG GIVING THE NAME AND ADDRESS OF THE MANUFACTURER, DESIGN LOADS AND ENCLOSIBILITY.
9. ALL ITEMS PERTAINING TO EACH PARTICULAR INSTALLATION SHALL BE CIRCLED (i.e. PROJECTION, POST SPACING, FOOTING DETAIL, ETC.).
10. LATTICE TYPE COVERS SHALL NOT BE ENCLOSED. FREESTANDING COVERS OF ALL TYPES SHALL NOT BE ENCLOSED.
11. THE LATTICE TYPE STRUCTURES SHALL NOT BE COVERED WITH ANY TYPE OF SOLID MATERIAL AS THE DESIGN LOADS HAVE ONLY BEEN APPLIED TO THE HORIZONTAL PROJECTED AREA OF THE LATTICE, RAFTERS, BEAMS, ETC., PER I.C.B.O. CRITERIA.

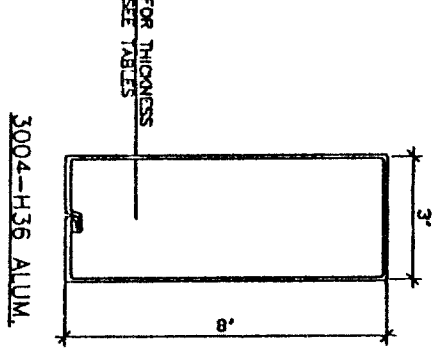

1 BEAM/RAFTER

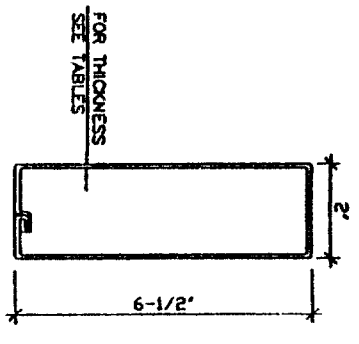

2 RAFTER/SIDEPLATE

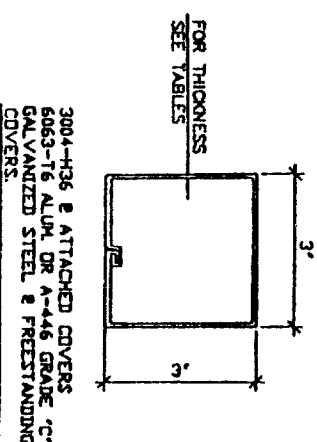

3 COLUMN/POST

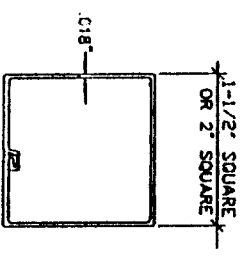

4 LATTICE

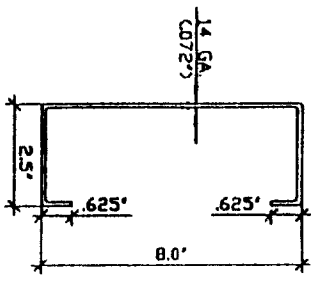

5 BEAM INSERT

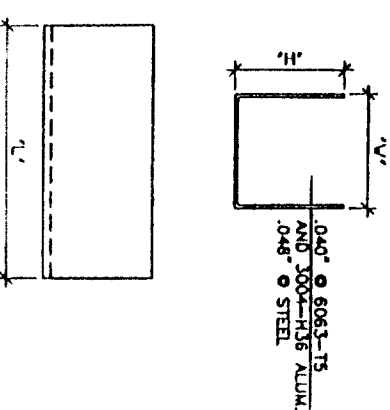

6 TYPICAL "U" BRACKET

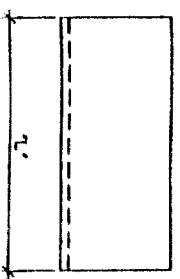

7 TYPICAL "A" BRACKET

Distributed by:

Viking Builders, Inc. - Viking Aluminum, Inc. - Viking-Ajax Supply
 5421 E. Cheyenne 1440 S. Balboa Ave. 11385 Sunrise Park Drive #200
 Las Vegas, NV 89115 Ontario, CA 91761 Rancho Cordova, CA 95742
 702-644-0301 909-930-1541 916-635-2245

Manufactured by: **Texas Aluminum Industries, Inc.**
 2900 Patio Drive
 Houston, Texas 77017

Sun Country™ Deluxe Lattice System

ADDENDUM TO ICBO EVALUATION SERVICE INC. REPORT 1841P

DRAWN BY: CMV	SCALE: NONE
DATE: MAR. 31, 1998	

ASTON VANCE & ASSOC., INC.

DRAWING DESCRIPTION: GENERAL NOTES, ISOMETRIC AND PART DETAILS (STEEL INSERT)

DRAWING NUMBER: PPC-1

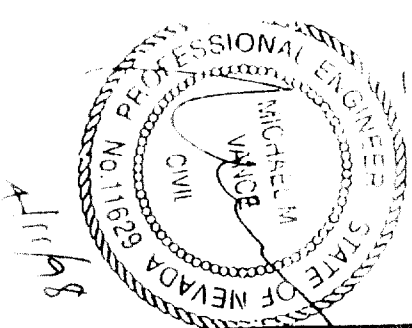
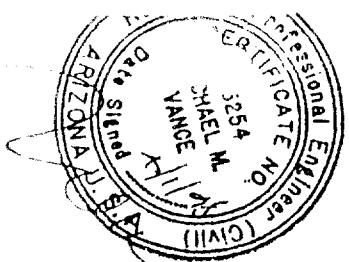
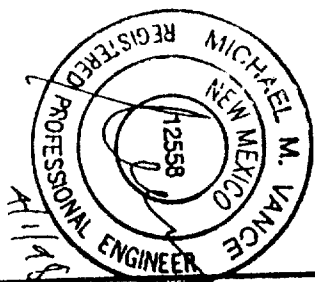
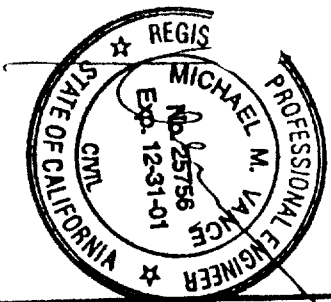

RAFTER SPAN TABLE

DESIGN LOAD	RAFTER TYPE: 2" X 6 1/2" X .024" THICK			
	24" SPACING	22" SPACING	20" SPACING	18" SPACING
	SPAN	O'HANG	SPAN	O'HANG
10 PSF L.L.	12'-5"	4'-6"	13'-0"	4'-6"
20 PSF L.L./S.L.	9'-3"	3'-6"	9'-8"	3'-8"
30 PSF S.L.	7'-8"	3'-0"	8'-0"	3'-0"
70 MPH THRU * 110 MPH WIND *	12'-5"	4'-6"	13'-0"	4'-6"
	RAFTER TYPE: 2" X 6 1/2" X .032" THICK			
10 PSF L.L.	16'-7"	4'-6"	17'-4"	4'-6"
20 PSF L.L./S.L.	12'-4"	4'-6"	12'-10"	4'-6"
30 PSF S.L.	10'-3"	4'-0"	10'-8"	4'-0"
70 MPH THRU * 110 MPH WIND *	16'-7"	4'-6"	17'-4"	4'-6"
	RAFTER TYPE: 2" X 6 1/2" X .040" THICK			
10 PSF L.L.	20'-9"	4'-6"	21'-8"	4'-6"
20 PSF L.L./S.L.	15'-5"	4'-6"	16'-1"	4'-6"
30 PSF S.L.	12'-10"	4'-0"	13'-4"	4'-0"
70 MPH THRU * 110 MPH WIND *	16'-7"	4'-6"	21'-8"	4'-6"
	RAFTER TYPE: 3" X 8" X .030" THICK			
10 PSF L.L.	17'-1"	4'-6"	17'-10"	4'-6"
20 PSF L.L./S.L.	12'-8"	4'-6"	13'-3"	4'-6"
30 PSF S.L.	10'-6"	4'-0"	11'-0"	4'-0"
70 MPH THRU * 110 MPH WIND *	17'-1"	4'-6"	17'-10"	4'-6"
	RAFTER TYPE: 3" X 8" X .036" THICK			
10 PSF L.L.	20'-8"	4'-6"	21'-7"	4'-6"
20 PSF L.L./S.L.	15'-4"	4'-6"	16'-0"	4'-6"
30 PSF S.L.	12'-9"	4'-0"	13'-4"	4'-0"
70 MPH THRU * 110 MPH WIND *	20'-8"	4'-6"	21'-7"	4'-6"
	RAFTER TYPE: 3" X 8" X .042" THICK			
10 PSF L.L.	23'-10"	4'-6"	25'-0"	4'-6"
20 PSF L.L./S.L.	17'-9"	4'-6"	18'-6"	4'-6"
30 PSF S.L.	14'-9"	4'-0"	15'-5"	4'-0"
70 MPH THRU * 110 MPH WIND *	23'-10"	4'-6"	25'-0"	4'-6"

* FOR PATIO COVERS THAT ARE 10'-0" OR LESS IN HEIGHT.

TRIBUTARY WIDTH TABLE

MAXIMUM RAFTER OR ROOF PANEL SPAN	MAXIMUM RAFTER OR ROOF PANEL OVERHANG							
	0'-6"	1'-0"	1'-6"	2'-0"	2'-6"	3'-0"	3'-6"	4'-0"
6'-0"	3'-6"	4'-0"	5'-0"	5'-6"	—	—	—	—
7'-0"	4'-0"	4'-6"	5'-6"	6'-0"	6'-6"	—	—	—
8'-0"	4'-6"	5'-0"	6'-0"	6'-6"	7'-0"	7'-6"	—	—
9'-0"	5'-0"	5'-6"	6'-6"	7'-0"	7'-6"	8'-0"	9'-0"	—
10'-0"	5'-6"	6'-0"	7'-0"	7'-6"	8'-0"	8'-6"	9'-0"	10'-0"
11'-0"	6'-0"	6'-6"	7'-6"	8'-0"	8'-6"	9'-0"	9'-6"	10'-6"
12'-0"	6'-6"	7'-0"	8'-0"	8'-6"	9'-0"	9'-6"	10'-0"	11'-6"
13'-0"	7'-0"	7'-6"	8'-6"	9'-0"	9'-6"	10'-0"	10'-6"	11'-6"
14'-0"	7'-6"	8'-0"	8'-6"	9'-6"	10'-0"	10'-6"	11'-0"	11'-6"
15'-0"	8'-0"	8'-6"	9'-0"	10'-0"	10'-6"	11'-0"	11'-6"	12'-0"
16'-0"	8'-6"	9'-0"	9'-6"	10'-6"	11'-0"	11'-6"	12'-0"	—
17'-0"	9'-0"	9'-6"	10'-0"	11'-0"	11'-6"	12'-0"	—	—
18'-0"	9'-6"	10'-0"	10'-6"	11'-6"	12'-0"	—	—	—
19'-0"	10'-0"	10'-6"	11'-0"	12'-0"	—	—	—	—
20'-0"	10'-6"	11'-0"	11'-6"	12'-0"	—	—	—	—
21'-0"	11'-0"	11'-6"	12'-0"	—	—	—	—	—
22'-0"	11'-6"	12'-0"	—	—	—	—	—	—
23'-0"	12'-0"	—	—	—	—	—	—	—

Distributed by:

Viking Builders, Inc. - Viking Aluminum Inc. - Viking Ajax Supply
 5421 E. Cheyenne 1440 S Balboa Ave 11385 Sunrise Park Drive #701
 Las Vegas, NV 89115 Ontario, CA 91761 Rancho Cordova, CA 95741
 702-644-0301 909-930-1541 916-635-2245

Manufactured by: Texas Aluminum Industries, Inc.
 2900 Patio Drive
 Houston, Texas 77017

ADDENDUM TO ICBO EVALUATION SERVICE INC. REPORT 1841P

Sun Country™ Deluxe Lattice System

DRAWN BY: cmv	SCALE: NONE	ASHTON VANCE & ASSOC. INC.	DRAWING DESCRIPTION: RAFTER SPANS AND TRIBUTARY WIDTH TABLES	DRAWING NUMBER: PPC-3
DATE: MAR. 31, 1998				

GENERAL NOTES FOR DRAWING PPC-7

SOLID ROOF PANEL SPANS

1. INSULATED ROOF PANELS
A.) THE PANEL FABRICS CONSIST OF .025" OR .032" THICK ALUMINUM SKINS OF 3004-H16 ALLOY.
B.) THE ADHESIVE SHALL BE MOR AD M-434, A PROPRIETARY ADHESIVE MANUFACTURED BY MORTON CHEMICAL AND CONFORMING TO THE REQUIREMENTS OF A TYPE II, CLASS 2 ADHESIVE.
C.) CORE SHALL BE PRE-FORMED 1.5#/FT³ DENSITY EXPANDED POLYSTYRENE FOAM BY HOUSTON FOAM PLASTICS HAVING A FLAME SPREAD INDEX OF 5 WITH A SMOKE DENSITY OF 50-130 FOR THICKNESSES BETWEEN 2" AND 4".
D.) THE MANUFACTURER OF ANY COMPONENT CITED IN ITEMS A.) THROUGH C.) ABOVE, SHALL CERTIFY TO THE COMPLIANCE OF EACH SHIPMENT OF THAT COMPONENT WITH APPLICABLE SPECIFICATION(S).
E.) PANELS SHALL BE CONTINUOUS IN THE DIRECTION OF SLOPE WITH NO TRANSVERSE JOINTS.
F.) MAXIMUM ALLOWABLE SPANS ARE AS SHOWN IN TABLE DWG. PPC-7.

2. WALL FASTENERS:
A.) AT 10 PSF LIVE LOAD USE 1- #12 WOOD SCREW AT 16" C/C EMBEDDED 1 1/2" MINIMUM INTO GROUP 2 OR BETTER LUMBER.
B.) AT 20 PSF AND 30 PSF LIVE/SNOW LOAD USE 2- #12 WOOD SCREWS AT 16" C/C EMBEDDED 1 1/2" MINIMUM INTO GROUP 2 OR BETTER LUMBER.
3. ENCLOSABILITY THESE UNITS MAY BE ENCLOSURED WITH CURRENTLY RECOGNIZED ICBO EVALUATION SERVICE, INC. PATIO COVER ENCLOSURE WALLS.
4. SEE DRAWING PPC-1 FOR ADDITIONAL NOTES.

PANEL TYPE	PANEL THICKNESS	DESIGN LOADS						
		10 PSF LL	20 PSF LL/S.L	30 PSF S.L	70 MPH WIND	90 MPH WIND	100 MPH WIND	110 MPH WIND
MAXIMUM PANEL SPAN (MINIMUM SLOPE)								
2 3/8" X 6" ROLLFORM	.020"	12'-6" (.4°/FT.)	8'-11" (.4°/FT.)	7'-4" (.4°/FT.)	12'-6" (.4°/FT.)	11'-8" (.4°/FT.)	—	—
	.025"	14'-8" (.4°/FT.)	10'-7" (.4°/FT.)	8'-8" (.4°/FT.)	14'-8" (.4°/FT.)	14'-8" (.4°/FT.)	—	—
	.032"	17'-5" (.4°/FT.)	12'-7" (.4°/FT.)	10'-4" (.4°/FT.)	17'-5" (.4°/FT.)	17'-5" (.4°/FT.)	—	—
2 1/2" X 6" ROLLFORM	.018"	13'-8" (.4°/FT.)	7'-5" (.4°/FT.)	4'-11" (.4°/FT.)	13'-8" (.4°/FT.)	11'-1" (.4°/FT.)	—	—
	.024"	18'-5" (.4°/FT.)	12'-5" (.4°/FT.)	8'-5" (.4°/FT.)	18'-5" (.4°/FT.)	14'-9" (.4°/FT.)	—	—
	.032"	20'-0" (.4°/FT.)	16'-0" (.4°/FT.)	14'-0" (.4°/FT.)	20'-0" (.4°/FT.)	19'-4" (.4°/FT.)	—	—
	.040"	21'-5" (.4°/FT.)	17'-2" (.4°/FT.)	15'-1" (.4°/FT.)	21'-5" (.4°/FT.)	21'-5" (.4°/FT.)	—	—
3" INSULATED	.025"	16'-8" (.5°/FT.)	10'-10" (.5°/FT.)	8'-11" (.5°/FT.)	16'-8" (.5°/FT.)	16'-8" (.5°/FT.)	—	—
	.032"	18'-0" (.5°/FT.)	12'-5" (.5°/FT.)	10'-1" (.5°/FT.)	18'-0" (.5°/FT.)	18'-0" (.5°/FT.)	—	—

* OR SKIN THICKNESS AT 3" INSULATED PANEL
** FROM ICBO ER 4244P. BRUCE CHALLMAN ENGINEER OF RECORD.
*** FROM TEST DATA PROVIDED BY C.I. PROFESSIONAL SERVICES. WARREN CAVANAUUGH ENGINEER OF RECORD.
**** HEIGHT LESS THAN 10'-0"

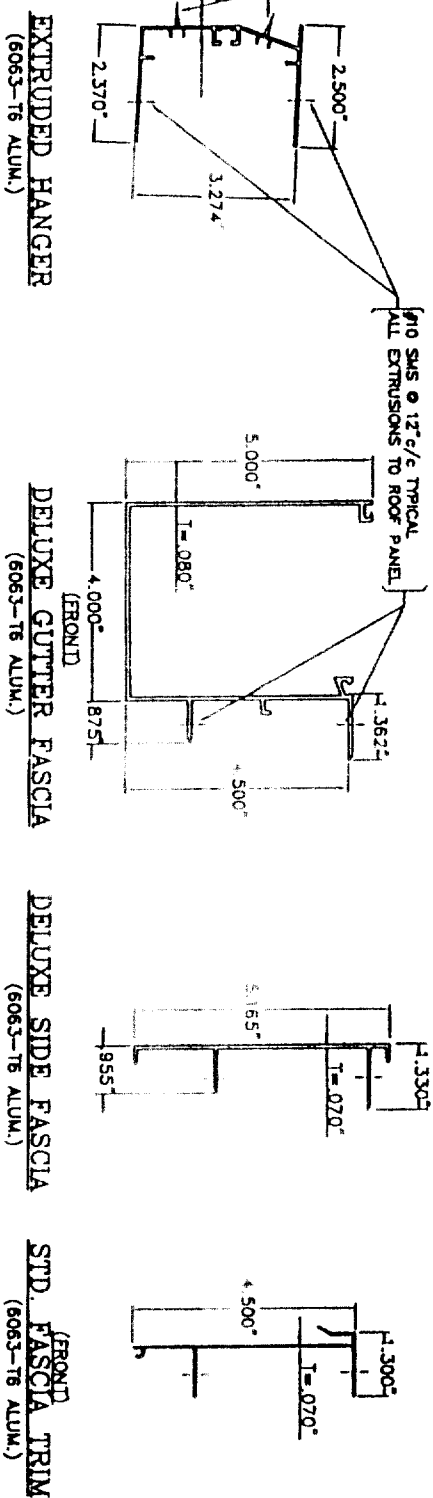
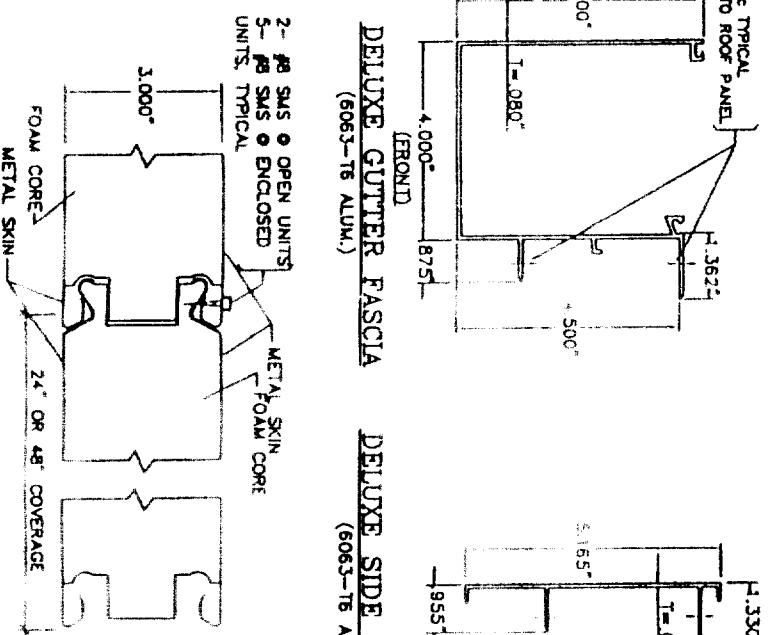
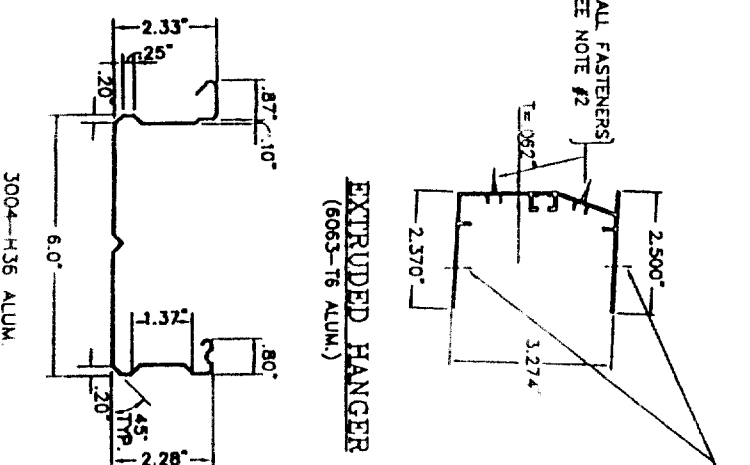
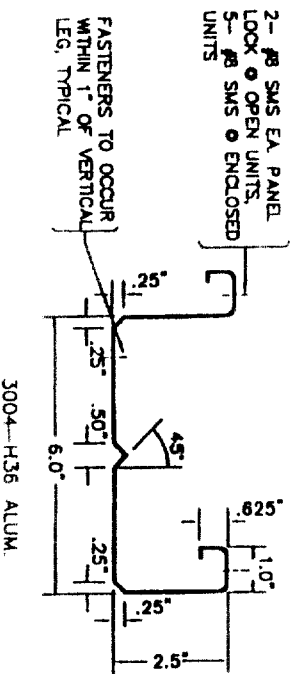
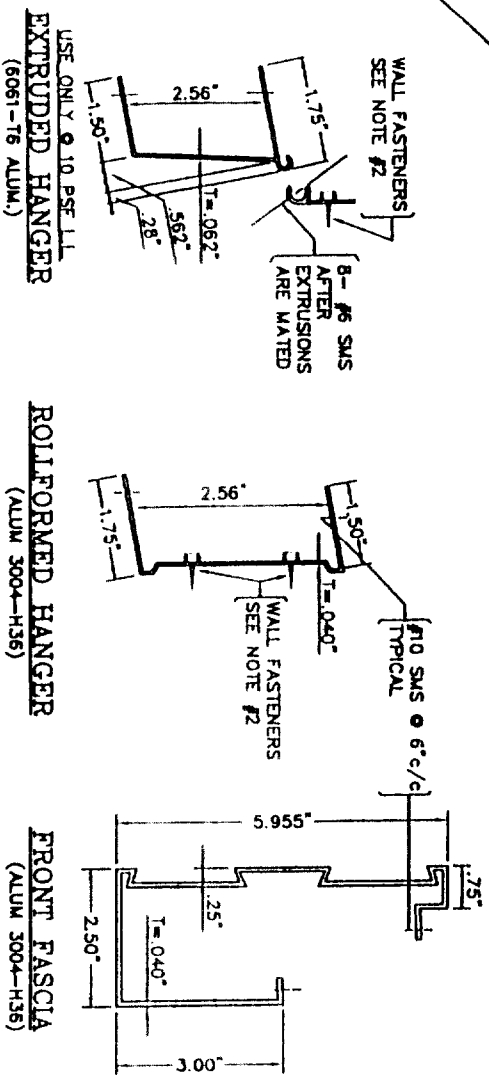

2-1/2" X 6" FLAT PANEL & ACCESSORIES

2-3/8" X 6" FLAT PANEL

3" INSULATED PANEL & ACCESSORIES

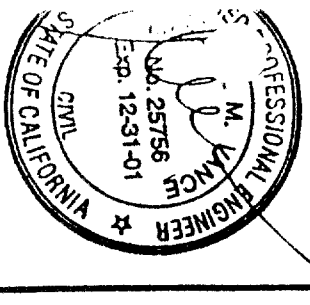
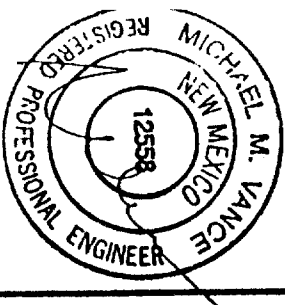
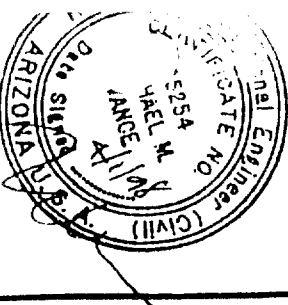
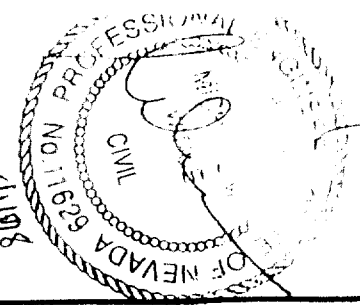

Distributed by:

Viking Builders, Inc., Viking Aluminum, Inc., Viking-Alfax Supply
5421 E. Cheyenne
Las Vegas, NV 89115
702-644-0301

1440 S. Balboa Ave.
Ontario, CA 91761
909-930-1541

11385 Sunrise Park Drive #200
Rancho Cordova, CA 95742
916-635-2245

Sun Country™ Deluxe Lattice System

ADDENDUM TO ICBO EVALUATION SERVICE INC. REPORT 1841P

Manufactured by:

Texas Aluminum Industries, Inc.
2900 Patio Drive
Houston, Texas 77017

DRAWN BY: gmv SCALE: NONE ASHTON VANCE & ASSOC. INC. DRAWING DESCRIPTION: SOLID ROOF PANELS DRAWING NUMBER: PPC-7
DATE: MAR. 31, 1998

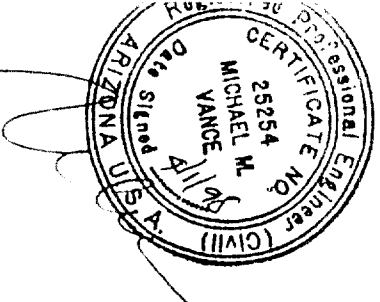
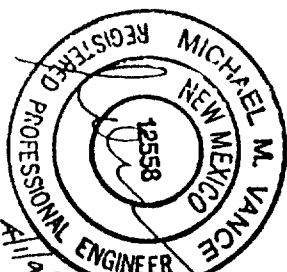
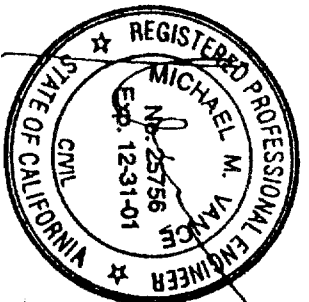

TABLE "A": MAXIMUM COLUMN SPACING

MAXIMUM TRIBUTARY WIDTH*	10 PSF LIVE LOAD, 70 MPH WIND LOAD		
	5" X 8" X .042" BEAM AT SLAB	5" X 8" BEAM W/INSERT AT SLAB	5" X 8" BEAM W/INSERT AT FTG.
4'-0"	9'-7"	10'-5" (18")	9'-7"
5'-0"	9'-7"	10'-5" (18")	9'-7"
6'-0"	8'-5"	9'-7" (18")	8'-5"
7'-0"	7'-2"	9'-0" (18")	7'-2"
8'-0"	6'-5"	8'-6" (19")	6'-5"
9'-0"	5'-9"	8'-1" (19")	5'-9"
10'-0"	5'-3"	7'-8" (19")	5'-3"
11'-0"	4'-9"	7'-4" (20")	4'-9"
12'-0"	4'-0"	7'-0" (20")	4'-0"

MAXIMUM TRIBUTARY WIDTH*	10 PSF LIVE LOAD, 90 MPH WIND LOAD		
	5" X 8" X .042" BEAM AT SLAB	5" X 8" BEAM W/INSERT AT SLAB	5" X 8" BEAM W/INSERT AT FTG.
4'-0"	9'-7"	10'-5" (20")	9'-7"
5'-0"	9'-7"	10'-5" (20")	9'-7"
6'-0"	8'-5"	9'-7" (21")	8'-5"
7'-0"	7'-2"	9'-0" (21")	7'-2"
8'-0"	6'-5"	8'-6" (22")	6'-5"
9'-0"	5'-9"	8'-1" (22")	5'-9"
10'-0"	5'-3"	7'-8" (22")	5'-3"
11'-0"	4'-9"	7'-4" (23")	4'-9"
12'-0"	4'-0"	7'-0" (23")	4'-0"

MAXIMUM TRIBUTARY WIDTH*	10 PSF LIVE LOAD, 100 MPH WIND LOAD		
	5" X 8" X .042" BEAM AT SLAB	5" X 8" BEAM W/INSERT AT SLAB	5" X 8" BEAM W/INSERT AT FTG.
4'-0"	9'-1"	10'-5" (22")	9'-1"
5'-0"	7'-9"	9'-7" (23")	7'-9"
6'-0"	6'-9"	9'-0" (23")	6'-9"
7'-0"	6'-0"	8'-6" (24")	6'-0"
8'-0"	5'-5"	8'-1" (24")	5'-5"
9'-0"	4'-11"	7'-8" (24")	4'-11"
10'-0"	4'-6"	7'-4" (25")	4'-6"
11'-0"	4'-0"	7'-0" (25")	4'-0"
12'-0"	3'-6"	6'-6" (26")	3'-6"

TABLE "A": MAXIMUM COLUMN SPACING

MAXIMUM TRIBUTARY WIDTH*	20 PSF LIVE/SNOW LOAD, 70 MPH WIND LOAD		
	5" X 8" X .042" BEAM AT SLAB	5" X 8" BEAM W/INSERT AT SLAB	5" X 8" BEAM W/INSERT AT FTG.
4'-0"	6'-6"	8'-7" (18")	6'-6"
5'-0"	5'-5"	7'-10" (18")	5'-5"
6'-0"	4'-8"	7'-5" (18")	4'-8"
7'-0"	4'-0"	6'-9" (19")	4'-0"
8'-0"	3'-6"	6'-4" (17")	3'-6"
9'-0"	3'-0"	6'-0" (17")	3'-0"
10'-0"	2'-6"	5'-6" (17")	2'-6"
11'-0"	2'-2"	5'-2" (17")	2'-2"
12'-0"	1'-10"	4'-10" (18")	1'-10"

MAXIMUM TRIBUTARY WIDTH*	20 PSF LIVE/SNOW LOAD, 90 MPH WIND LOAD		
	5" X 8" X .042" BEAM AT SLAB	5" X 8" BEAM W/INSERT AT SLAB	5" X 8" BEAM W/INSERT AT FTG.
4'-0"	6'-6"	8'-7" (18")	6'-6"
5'-0"	5'-5"	7'-10" (18")	5'-5"
6'-0"	4'-8"	7'-5" (19")	4'-8"
7'-0"	4'-0"	6'-9" (19")	4'-0"
8'-0"	3'-6"	6'-4" (20")	3'-6"
9'-0"	3'-0"	6'-0" (20")	3'-0"
10'-0"	2'-6"	5'-6" (20")	2'-6"
11'-0"	2'-2"	5'-2" (20")	2'-2"
12'-0"	1'-10"	4'-10" (21")	1'-10"

MAXIMUM TRIBUTARY WIDTH*	20 PSF LIVE/SNOW LOAD, 100 MPH WIND LOAD		
	5" X 8" X .042" BEAM AT SLAB	5" X 8" BEAM W/INSERT AT SLAB	5" X 8" BEAM W/INSERT AT FTG.
4'-0"	6'-6"	8'-7" (19")	6'-6"
5'-0"	5'-5"	7'-10" (20")	5'-5"
6'-0"	4'-8"	7'-5" (21")	4'-8"
7'-0"	4'-0"	6'-9" (21")	4'-0"
8'-0"	3'-6"	6'-4" (21")	3'-6"
9'-0"	3'-0"	6'-0" (21")	3'-0"
10'-0"	2'-6"	5'-6" (22")	2'-6"
11'-0"	2'-2"	5'-2" (22")	2'-2"
12'-0"	1'-10"	4'-10" (23")	1'-10"

TABLE "A": MAXIMUM COLUMN SPACING

MAXIMUM TRIBUTARY WIDTH*	30 PSF SNOW LOAD, 70 MPH WIND LOAD		
	5" X 8" X .042" BEAM AT SLAB	5" X 8" BEAM W/INSERT AT SLAB	5" X 8" BEAM W/INSERT AT FTG.
4'-0"	7'-2" (15")	8'-7" (15")	7'-2" (15")
5'-0"	6'-5" (15")	7'-10" (15")	6'-5" (15")
6'-0"	6'-0" (16")	7'-5" (16")	6'-0" (16")
7'-0"	5'-8" (16")	7'-0" (16")	5'-8" (16")
8'-0"	5'-4" (16")	6'-4" (17")	5'-4" (16")
9'-0"	5'-0" (16")	6'-0" (17")	5'-0" (16")
10'-0"	4'-6" (17")	5'-6" (17")	4'-6" (17")
11'-0"	4'-2" (17")	5'-2" (17")	4'-2" (17")
12'-0"	3'-8" (17")	4'-8" (18")	3'-8" (17")

MAXIMUM TRIBUTARY WIDTH*	30 PSF SNOW LOAD, 90 MPH WIND LOAD		
	5" X 8" X .042" BEAM AT SLAB	5" X 8" BEAM W/INSERT AT SLAB	5" X 8" BEAM W/INSERT AT FTG.
4'-0"	7'-2" (17")	8'-7" (17")	7'-2" (17")
5'-0"	6'-5" (17")	7'-10" (17")	6'-5" (17")
6'-0"	6'-0" (18")	7'-5" (18")	6'-0" (18")
7'-0"	5'-8" (18")	7'-0" (18")	5'-8" (18")
8'-0"	5'-4" (19")	6'-4" (19")	5'-4" (19")
9'-0"	5'-0" (19")	6'-0" (19")	5'-0" (19")
10'-0"	4'-6" (19")	5'-6" (19")	4'-6" (19")
11'-0"	4'-2" (19")	5'-2" (19")	4'-2" (19")
12'-0"	3'-8" (19")	4'-8" (20")	3'-8" (19")

MAXIMUM TRIBUTARY WIDTH*	30 PSF SNOW LOAD, 100 MPH WIND LOAD		
	5" X 8" X .042" BEAM AT SLAB	5" X 8" BEAM W/INSERT AT SLAB	5" X 8" BEAM W/INSERT AT FTG.
4'-0"	7'-2" (18")	8'-7" (18")	7'-2" (18")
5'-0"	6'-5" (19")	7'-10" (19")	6'-5" (19")
6'-0"	6'-0" (19")	7'-5" (20")	6'-0" (19")
7'-0"	5'-8" (20")	7'-0" (20")	5'-8" (20")
8'-0"	5'-4" (20")	6'-4" (20")	5'-4" (20")
9'-0"	5'-0" (20")	6'-0" (20")	5'-0" (20")
10'-0"	4'-6" (20")	5'-6" (20")	4'-6" (20")
11'-0"	4'-2" (20")	5'-2" (20")	4'-2" (20")
12'-0"	3'-8" (20")	4'-8" (21")	3'-8" (20")

TABLE "B": MINIMUM ATTACHMENT LENGTH (L) TO PANEL SPAN (P.S.) RATIO

WIND LOAD	MINIMUM L/P.S. RATIO			
	70 MPH	90 MPH	100 MPH	110 MPH
OPEN OR ENCLOSED*	1.0	1.0	1.0	1.0
ENCLOSED	1.25	1.50	1.75	2.0

* SEE NOTE A3, DRAWING PPC-7.

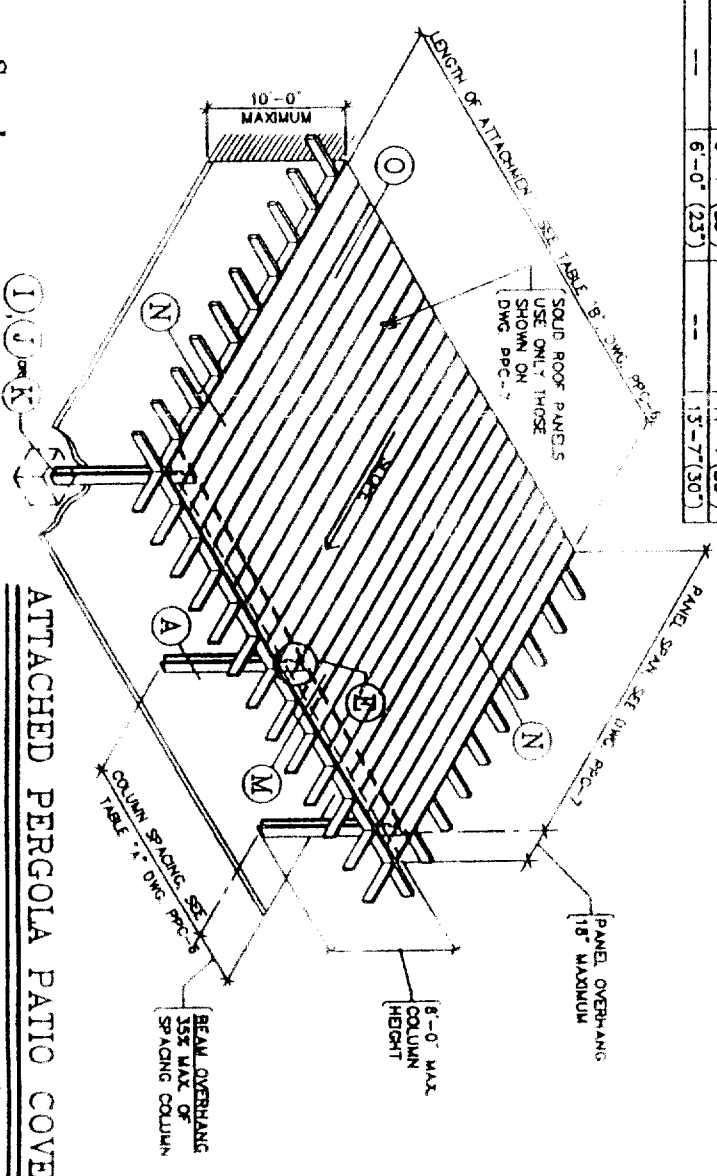
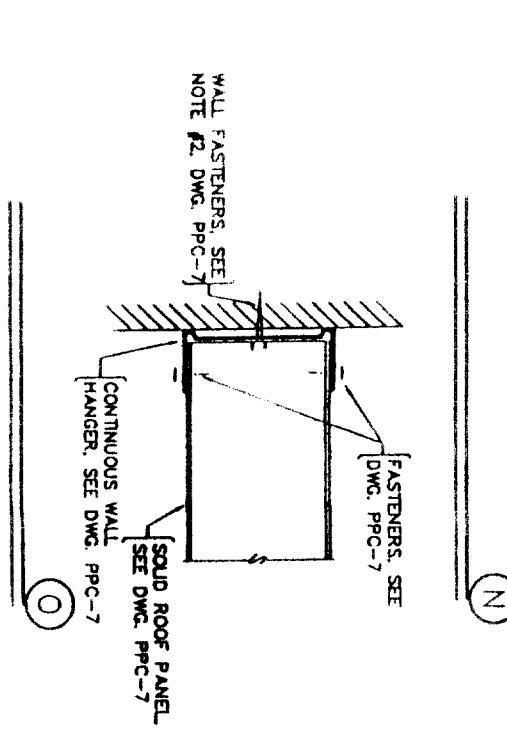
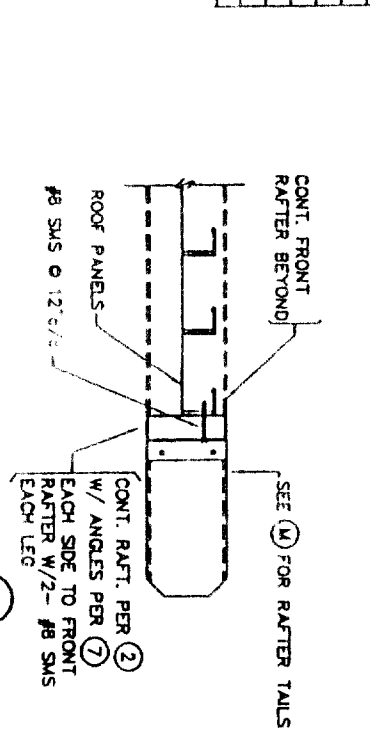
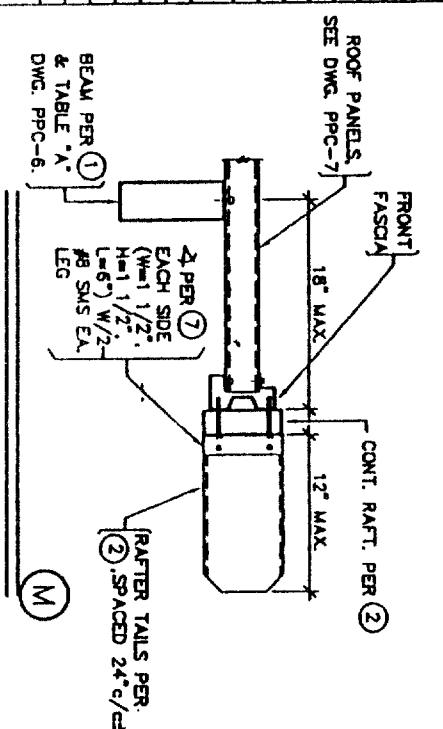

ATTACHED PERGOLA PATIO COVER (WITH SOLID COVERING)

Viking Builders, Inc. - Viking Aluminum, Inc. - Viking-Ajaxx Supply
 5421 E. Cheyenne 1440 S Balboa Ave
 Las Vegas, NV 89115 Ontario, CA 91761
 702-644-0301 909-930-1541

11385 Sunrise Park Drive #200
 Rancho Cordova, CA 95742
 916-635-2245

ADDENDUM TO ICBO EVALUATION SERVICE INC. REPORT 1841P

Manufactured by:
 Texas Aluminum Industries, Inc
 2900 Patio Drive
 Houston, Texas 77017

Sun Country™ Deluxe Lattice System

DRAWN BY: cmv SCALE: NONE
 DATE: MAR. 31, 1996

ASHTON VANCE & ASSOC., INC.

DRIVING DESCRIPTION: ATTACHED COVER TABLES WITH SOLID COVERING (STEEL INSERT)
 DRAWING NUMBER: PPC-6

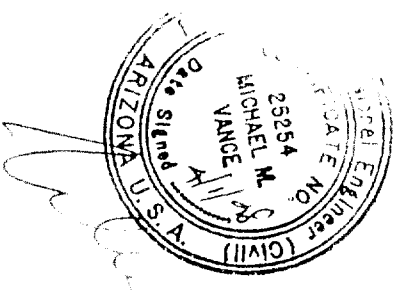
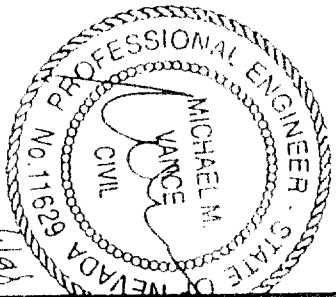
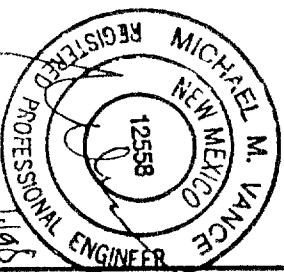

TABLE "A" MAXIMUM COLUMN SPACING

MAXIMUM TRIBUTARY WIDTH	10 PSF LIVE LOAD, 70 MPH WIND LOAD			10 PSF LIVE LOAD, 90 MPH WIND LOAD			10 PSF LIVE LOAD, 100 MPH WIND LOAD		
	MAXIMUM COLUMN SPACING	MIN. NUMBER OF COLUMNS	COLUMN TYPE	MAXIMUM COLUMN SPACING	MIN. NUMBER OF COLUMNS	COLUMN TYPE	MAXIMUM COLUMN SPACING	MIN. NUMBER OF COLUMNS	COLUMN TYPE
4'-0"	16'-9" (15')	2 (2)	1	16'-9" (17')	2 (2)	1	16'-9" (19')	2 (2)	1
5'-0"	15'-0" (15')	2 (2)	2	15'-0" (18')	2 (2)	2	15'-0" (20')	2 (2)	2
6'-0"	13'-7" (16')	2 (2)	2	13'-7" (19')	2 (2)	2	13'-7" (21')	2 (2)	2
7'-0"	12'-7" (16')	2 (2)	2	12'-7" (19')	2 (2)	2	12'-7" (21')	2 (2)	2
8'-0"	11'-10" (17')	2 (2)	2	11'-10" (19')	2 (2)	2	11'-10" (21')	2 (2)	2
9'-0"	11'-1" (17')	2 (2)	2	11'-1" (19')	2 (2)	2	11'-1" (21')	2 (2)	2
10'-0"	10'-7" (17')	2 (2)	2	10'-7" (19')	2 (2)	2	10'-7" (21')	2 (2)	2
12'-0"	8'-4" (18')	2 (2)	2	8'-4" (21')	2 (2)	2	8'-4" (23')	2 (2)	2

TABLE "A" MAXIMUM COLUMN SPACING

MAXIMUM TRIBUTARY WIDTH	20 PSF LIVE/SNOW LOAD, 70 MPH WIND LOAD			20 PSF LIVE/SNOW LOAD, 90 MPH WIND LOAD			20 PSF LIVE/SNOW LOAD, 100 MPH WIND LOAD		
	MAXIMUM COLUMN SPACING	MIN. NUMBER OF COLUMNS	COLUMN TYPE	MAXIMUM COLUMN SPACING	MIN. NUMBER OF COLUMNS	COLUMN TYPE	MAXIMUM COLUMN SPACING	MIN. NUMBER OF COLUMNS	COLUMN TYPE
4'-0"	12'-6" (14')	2 (2)	1	12'-6" (16')	2 (2)	1	12'-6" (17')	2 (2)	1
5'-0"	11'-2" (14')	2 (2)	2	11'-2" (17')	2 (2)	2	11'-2" (18')	2 (2)	2
6'-0"	9'-3" (15')	2 (2)	2	9'-3" (18')	2 (2)	2	9'-3" (20')	2 (2)	2
7'-0"	8'-11" (15')	2 (2)	2	8'-11" (18')	2 (2)	2	8'-11" (20')	2 (2)	2
8'-0"	8'-2" (16')	2 (2)	2	8'-2" (19')	2 (2)	2	8'-2" (21')	2 (2)	2
9'-0"	7'-11" (16')	2 (2)	2	7'-11" (19')	2 (2)	2	7'-11" (21')	2 (2)	2
10'-0"	5'-6" (17')	2 (2)	2	5'-6" (20')	2 (2)	2	5'-6" (22')	2 (2)	2

TABLE "A" MAXIMUM COLUMN SPACING

MAXIMUM TRIBUTARY WIDTH	30 PSF SNOW LOAD, 70 MPH WIND LOAD			30 PSF SNOW LOAD, 90 MPH WIND LOAD			30 PSF SNOW LOAD, 100 MPH WIND LOAD		
	MAXIMUM COLUMN SPACING	MIN. NUMBER OF COLUMNS	COLUMN TYPE	MAXIMUM COLUMN SPACING	MIN. NUMBER OF COLUMNS	COLUMN TYPE	MAXIMUM COLUMN SPACING	MIN. NUMBER OF COLUMNS	COLUMN TYPE
4'-0"	9'-7" (10'-5" (15'))	2 (2)	1	9'-7" (10'-5" (17'))	2 (2)	1	9'-7" (10'-5" (19'))	2 (2)	1
5'-0"	7'-8" (10'-4" (15'))	2 (2)	2	7'-8" (10'-4" (17'))	2 (2)	2	7'-8" (10'-4" (19'))	2 (2)	2
6'-0"	6'-5" (10'-1" (15'))	2 (2)	2	6'-5" (10'-1" (17'))	2 (2)	2	6'-5" (10'-1" (19'))	2 (2)	2
7'-0"	5'-8" (10'-1" (14'))	2 (2)	2	5'-8" (10'-1" (16'))	2 (2)	2	5'-8" (10'-1" (18'))	2 (2)	2
8'-0"	4'-9" (10'-1" (14'))	2 (2)	2	4'-9" (10'-1" (16'))	2 (2)	2	4'-9" (10'-1" (18'))	2 (2)	2
9'-0"	4'-3" (10'-1" (15'))	2 (2)	2	4'-3" (10'-1" (17'))	2 (2)	2	4'-3" (10'-1" (19'))	2 (2)	2

* NUMBER IN PARENTHESES IS SIZE OF CONCRETE CUBE FOOTING IN INCHES. WHERE FOOTING SIZE EXCEEDS 28" USE FOOTING DETAIL (C) ONLY.
 ** SEE TABLE "B" BELOW FOR DESCRIPTION. THE FIRST NUMBER IS FOR POSTS AND THE SECOND MAXIMUM IN HEIGHT. THE NUMBER IN PARENTHESES IS FOR COLUMNS 8'-6" MAXIMUM IN HEIGHT.
 *** SEE TRIBUTARY WIDTH TABLE DRAWING PCC-3

TABLE "B" COLUMN SCHEDULE

COLUMN TYPE	COLUMN DESCRIPTION
1	3" SQ. X .024" CENTER COLUMN W/ 2" X 6 1/2" X .024" SIDEPLATES *
2	3" SQ. X .024" CENTER COLUMN W/ 2" X 6 1/2" X .032" SIDEPLATES *
3	3" SQ. X .046" CENTER COLUMN W/ 2" X 6 1/2" X .024" SIDEPLATES **
4	3" SQ. X .046" CENTER COLUMN W/ 2" X 6 1/2" X .032" SIDEPLATES **

TABLE "C" ANCHORAGE TO FOOTING

MAXIMUM FOOTING SIZE	ANCHOR DESCRIPTION *
20"	5/8" EXPANSION BOLT EMBEDDED 2-3/4 INCHES MINIMUM (750 LB. TENSION)
25"	5/8" EXPANSION BOLT EMBEDDED 4 INCHES MINIMUM (1125 LB. TENSION)
28"	5/8" EXPANSION BOLT EMBEDDED 7 INCHES MINIMUM (1500 LB. TENSION)
31"	5/8" DEFORMED HEAD BOLT (HEX. SQUARE HEAD OR ANCHOR BOLT) EMBEDDED 6 INCHES MINIMUM **

EXPANSION BOLTS SHALL BE A193 B8-11 CARBON STEEL PER ASTM A490 OR A307 OR A308 OR A309 OR A310 OR A311 OR A312 OR A313 OR A314 OR A315 OR A316 OR A317 OR A318 OR A319 OR A320 OR A321 OR A322 OR A323 OR A324 OR A325 OR A326 OR A327 OR A328 OR A329 OR A330 OR A331 OR A332 OR A333 OR A334 OR A335 OR A336 OR A337 OR A338 OR A339 OR A340 OR A341 OR A342 OR A343 OR A344 OR A345 OR A346 OR A347 OR A348 OR A349 OR A350 OR A351 OR A352 OR A353 OR A354 OR A355 OR A356 OR A357 OR A358 OR A359 OR A360 OR A361 OR A362 OR A363 OR A364 OR A365 OR A366 OR A367 OR A368 OR A369 OR A370 OR A371 OR A372 OR A373 OR A374 OR A375 OR A376 OR A377 OR A378 OR A379 OR A380 OR A381 OR A382 OR A383 OR A384 OR A385 OR A386 OR A387 OR A388 OR A389 OR A390 OR A391 OR A392 OR A393 OR A394 OR A395 OR A396 OR A397 OR A398 OR A399 OR A400 OR A401 OR A402 OR A403 OR A404 OR A405 OR A406 OR A407 OR A408 OR A409 OR A410 OR A411 OR A412 OR A413 OR A414 OR A415 OR A416 OR A417 OR A418 OR A419 OR A420 OR A421 OR A422 OR A423 OR A424 OR A425 OR A426 OR A427 OR A428 OR A429 OR A430 OR A431 OR A432 OR A433 OR A434 OR A435 OR A436 OR A437 OR A438 OR A439 OR A440 OR A441 OR A442 OR A443 OR A444 OR A445 OR A446 OR A447 OR A448 OR A449 OR A450 OR A451 OR A452 OR A453 OR A454 OR A455 OR A456 OR A457 OR A458 OR A459 OR A460 OR A461 OR A462 OR A463 OR A464 OR A465 OR A466 OR A467 OR A468 OR A469 OR A470 OR A471 OR A472 OR A473 OR A474 OR A475 OR A476 OR A477 OR A478 OR A479 OR A480 OR A481 OR A482 OR A483 OR A484 OR A485 OR A486 OR A487 OR A488 OR A489 OR A490 OR A491 OR A492 OR A493 OR A494 OR A495 OR A496 OR A497 OR A498 OR A499 OR A500 OR A501 OR A502 OR A503 OR A504 OR A505 OR A506 OR A507 OR A508 OR A509 OR A510 OR A511 OR A512 OR A513 OR A514 OR A515 OR A516 OR A517 OR A518 OR A519 OR A520 OR A521 OR A522 OR A523 OR A524 OR A525 OR A526 OR A527 OR A528 OR A529 OR A530 OR A531 OR A532 OR A533 OR A534 OR A535 OR A536 OR A537 OR A538 OR A539 OR A540 OR A541 OR A542 OR A543 OR A544 OR A545 OR A546 OR A547 OR A548 OR A549 OR A550 OR A551 OR A552 OR A553 OR A554 OR A555 OR A556 OR A557 OR A558 OR A559 OR A560 OR A561 OR A562 OR A563 OR A564 OR A565 OR A566 OR A567 OR A568 OR A569 OR A570 OR A571 OR A572 OR A573 OR A574 OR A575 OR A576 OR A577 OR A578 OR A579 OR A580 OR A581 OR A582 OR A583 OR A584 OR A585 OR A586 OR A587 OR A588 OR A589 OR A590 OR A591 OR A592 OR A593 OR A594 OR A595 OR A596 OR A597 OR A598 OR A599 OR A600 OR A601 OR A602 OR A603 OR A604 OR A605 OR A606 OR A607 OR A608 OR A609 OR A610 OR A611 OR A612 OR A613 OR A614 OR A615 OR A616 OR A617 OR A618 OR A619 OR A620 OR A621 OR A622 OR A623 OR A624 OR A625 OR A626 OR A627 OR A628 OR A629 OR A630 OR A631 OR A632 OR A633 OR A634 OR A635 OR A636 OR A637 OR A638 OR A639 OR A640 OR A641 OR A642 OR A643 OR A644 OR A645 OR A646 OR A647 OR A648 OR A649 OR A650 OR A651 OR A652 OR A653 OR A654 OR A655 OR A656 OR A657 OR A658 OR A659 OR A660 OR A661 OR A662 OR A663 OR A664 OR A665 OR A666 OR A667 OR A668 OR A669 OR A670 OR A671 OR A672 OR A673 OR A674 OR A675 OR A676 OR A677 OR A678 OR A679 OR A680 OR A681 OR A682 OR A683 OR A684 OR A685 OR A686 OR A687 OR A688 OR A689 OR A690 OR A691 OR A692 OR A693 OR A694 OR A695 OR A696 OR A697 OR A698 OR A699 OR A700 OR A701 OR A702 OR A703 OR A704 OR A705 OR A706 OR A707 OR A708 OR A709 OR A710 OR A711 OR A712 OR A713 OR A714 OR A715 OR A716 OR A717 OR A718 OR A719 OR A720 OR A721 OR A722 OR A723 OR A724 OR A725 OR A726 OR A727 OR A728 OR A729 OR A730 OR A731 OR A732 OR A733 OR A734 OR A735 OR A736 OR A737 OR A738 OR A739 OR A740 OR A741 OR A742 OR A743 OR A744 OR A745 OR A746 OR A747 OR A748 OR A749 OR A750 OR A751 OR A752 OR A753 OR A754 OR A755 OR A756 OR A757 OR A758 OR A759 OR A760 OR A761 OR A762 OR A763 OR A764 OR A765 OR A766 OR A767 OR A768 OR A769 OR A770 OR A771 OR A772 OR A773 OR A774 OR A775 OR A776 OR A777 OR A778 OR A779 OR A780 OR A781 OR A782 OR A783 OR A784 OR A785 OR A786 OR A787 OR A788 OR A789 OR A790 OR A791 OR A792 OR A793 OR A794 OR A795 OR A796 OR A797 OR A798 OR A799 OR A800 OR A801 OR A802 OR A803 OR A804 OR A805 OR A806 OR A807 OR A808 OR A809 OR A810 OR A811 OR A812 OR A813 OR A814 OR A815 OR A816 OR A817 OR A818 OR A819 OR A820 OR A821 OR A822 OR A823 OR A824 OR A825 OR A826 OR A827 OR A828 OR A829 OR A830 OR A831 OR A832 OR A833 OR A834 OR A835 OR A836 OR A837 OR A838 OR A839 OR A840 OR A841 OR A842 OR A843 OR A844 OR A845 OR A846 OR A847 OR A848 OR A849 OR A850 OR A851 OR A852 OR A853 OR A854 OR A855 OR A856 OR A857 OR A858 OR A859 OR A860 OR A861 OR A862 OR A863 OR A864 OR A865 OR A866 OR A867 OR A868 OR A869 OR A870 OR A871 OR A872 OR A873 OR A874 OR A875 OR A876 OR A877 OR A878 OR A879 OR A880 OR A881 OR A882 OR A883 OR A884 OR A885 OR A886 OR A887 OR A888 OR A889 OR A890 OR A891 OR A892 OR A893 OR A894 OR A895 OR A896 OR A897 OR A898 OR A899 OR A900 OR A901 OR A902 OR A903 OR A904 OR A905 OR A906 OR A907 OR A908 OR A909 OR A910 OR A911 OR A912 OR A913 OR A914 OR A915 OR A916 OR A917 OR A918 OR A919 OR A920 OR A921 OR A922 OR A923 OR A924 OR A925 OR A926 OR A927 OR A928 OR A929 OR A930 OR A931 OR A932 OR A933 OR A934 OR A935 OR A936 OR A937 OR A938 OR A939 OR A940 OR A941 OR A942 OR A943 OR A944 OR A945 OR A946 OR A947 OR A948 OR A949 OR A950 OR A951 OR A952 OR A953 OR A954 OR A955 OR A956 OR A957 OR A958 OR A959 OR A960 OR A961 OR A962 OR A963 OR A964 OR A965 OR A966 OR A967 OR A968 OR A969 OR A970 OR A971 OR A972 OR A973 OR A974 OR A975 OR A976 OR A977 OR A978 OR A979 OR A980 OR A981 OR A982 OR A983 OR A984 OR A985 OR A986 OR A987 OR A988 OR A989 OR A990 OR A991 OR A992 OR A993 OR A994 OR A995 OR A996 OR A997 OR A998 OR A999 OR A1000

Distributed by:

Viking Builders, Inc.-Viking Aluminum, Inc.-Viking-Ajax Supply
 5421 E. Cheyenne
 Las Vegas, NV 89115
 702-644-0301

1440 S Balboa Ave
 Ontario, CA 91761
 909-930-1541

11385 Sunrise Park Drive #206
 Rancho Cordova, CA 95742
 916-695-2245

Manufactured by: Texas Aluminum Industries, Inc.
 2900 Pato Drive
 Houston, Texas 77017

Sun Country™ Deluxe Lattice System

ADDENDUM TO ICBO EVALUATION SERVICE INC REPORT 1841P

ATTACHED COVER TABLES WITH LATTICE COVERING STEEL INSERT

PC-4

SECTION 2402 - IDENTIFICATION

EACH LIGHT SHALL BEAR THE MANUFACTURER'S LABEL DESIGNATING THE TYPE AND THICKNESS OF GLASS. WHEN APPROVED BY THE BUILDING OFFICIAL, THESE LABELS MAY BE OMITTED, PROVIDED AN AFFIDAVIT IS FURNISHED BY THE GLAZING CONTRACTOR CERTIFYING THAT EACH LIGHT IS GLAZED IN ACCORDANCE WITH APPROVED PLANS AND SPECIFICATIONS.

SECTION 2406.2 - IDENTIFICATION

EACH LIGHT OF SAFETY GLAZING MATERIAL INSTALLED IN HAZARDOUS LOCATIONS AS DEFINED IN SECTION 2406.1 SHALL BE IDENTIFIED BY A PERMANENT LABEL WHICH SPECIFIES THE LABELER, WHETHER THE MANUFACTURER OR INSTALLER, AND STATE THAT SAFETY GLAZING MATERIAL HAS BEEN UTILIZED IN SUCH INSTALLATION.

EACH UNIT OF TEMPERED GLASS SHALL BE PERMANENTLY IDENTIFIED BY THE MANUFACTURER. THE IDENTIFICATION SHALL BE ETCHED OR ENGRAVED, TYPED ON THE GLASS OR SHALL BE VISIBLE WHEN PERMANENT GLAZED. TEMPERED SPANREL GLASS IS EXEMPTED FROM PERMANENT LABELING BUT SUCH GLASS SHALL BE IDENTIFIED BY THE MANUFACTURER WITH A REMOVABLE PAPER LABEL.

24.203

THE CATEGORY CLASS AS NOTED IN TABLE 24-2-A, SHALL BE SPECIFIED AS PART OF A PERMANENT LABEL. VOLUME 3, 1994 U.B.C.

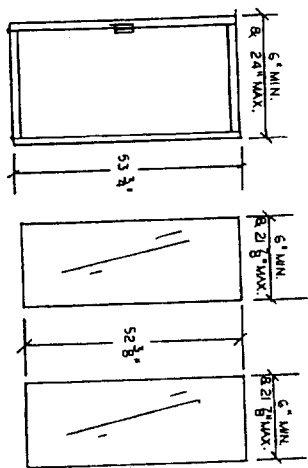
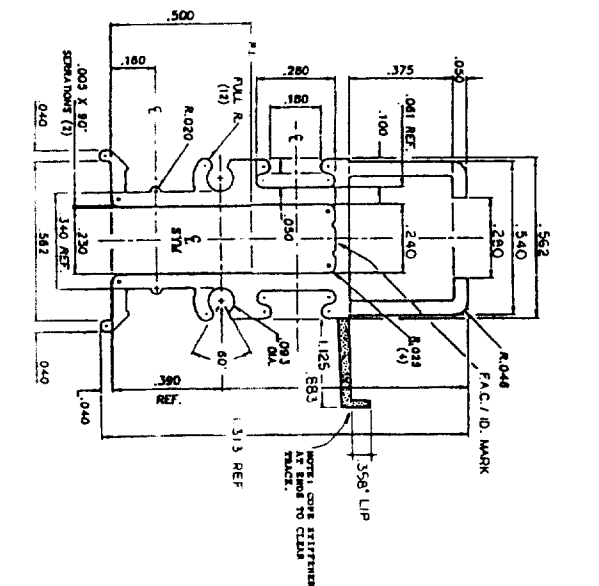
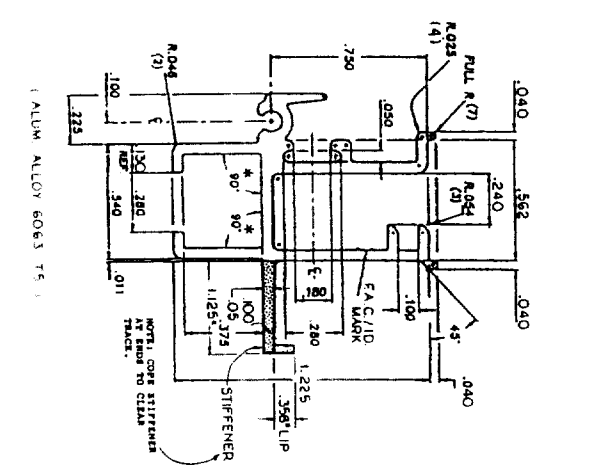
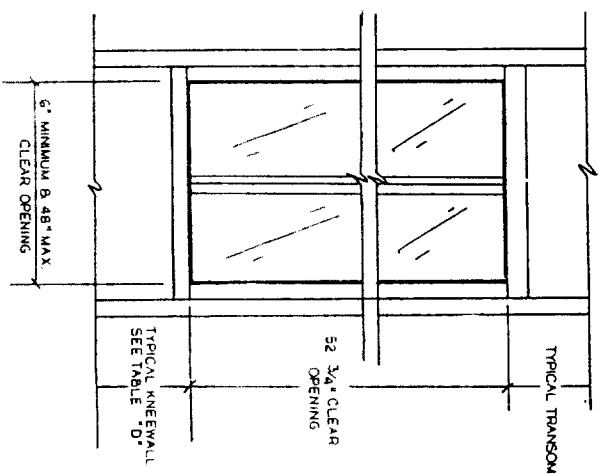
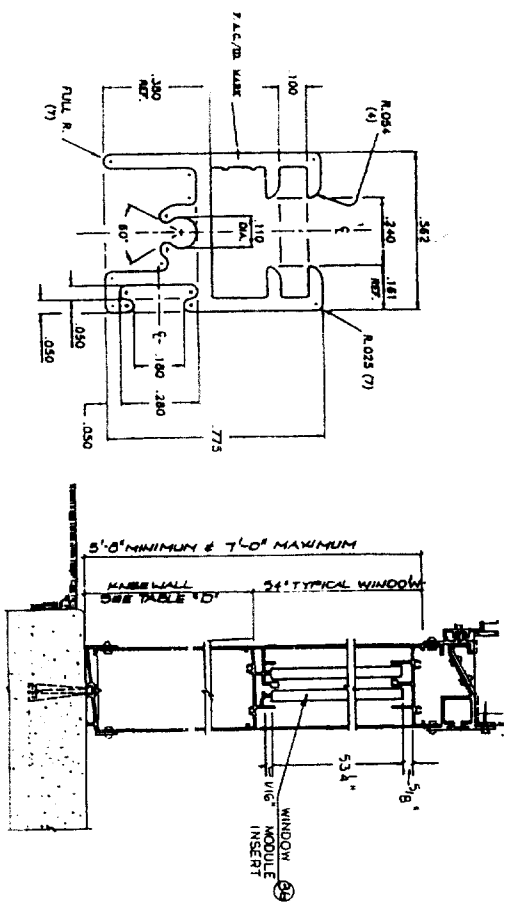

* ASSEMBLED WINDOW MODULE INSERT
NET WT: 1121-LBS.
W/ GLASS: 1163-LBS.
W/ PLASTIC: 191-LBS.

* 1/25 TEMPERED GLASS
NET WT: 1.87 RSF
MAX.

* 1/25 TRANSPARENT PLASTIC
NET WT: 0.77 RSF
MAX.

WINDOW MODULE /INSERT 3b

WINDOW INSERT HANDLE 3c

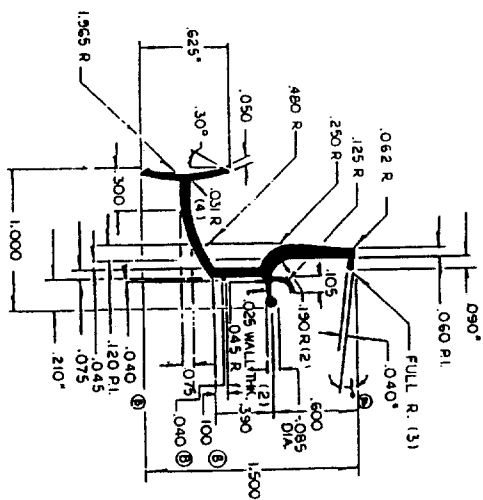

INSERT SIDE RAIL NO.	USE
1	FOR 70 MPH 1/8\"/>
2	FOR 80 & 90 MPH 1/8\"/>

WINDOW INSERT TOP & BOTTOM RAIL 3b

WINDOW MODULE SECTION C

WINDOW MODULE ELEVATION

WINDOW INSERT INTERLOCKING RAIL 3b

WINDOW INSERT SIDE RAIL 3b

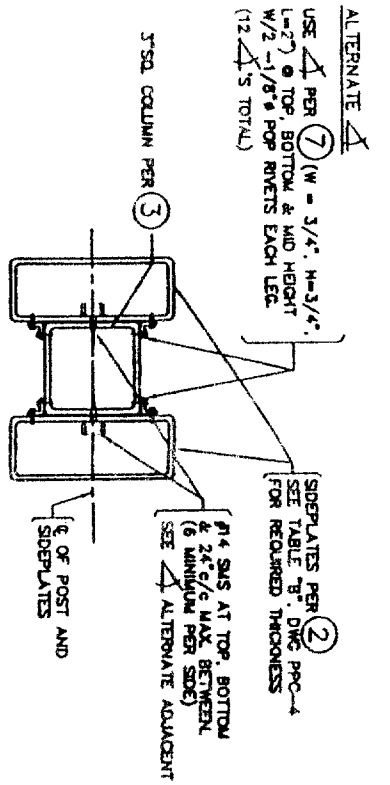
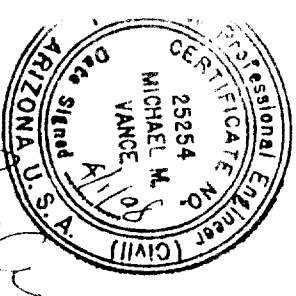
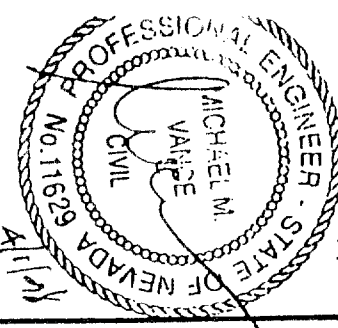
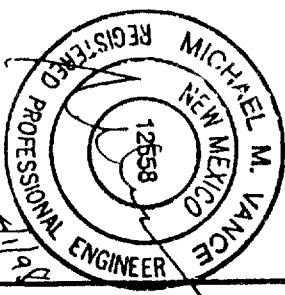
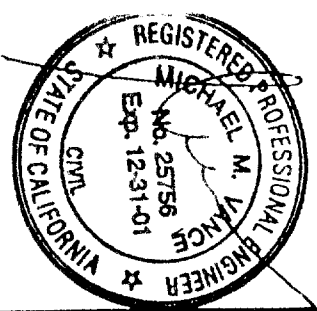

TYPICAL POST/COLUMN A

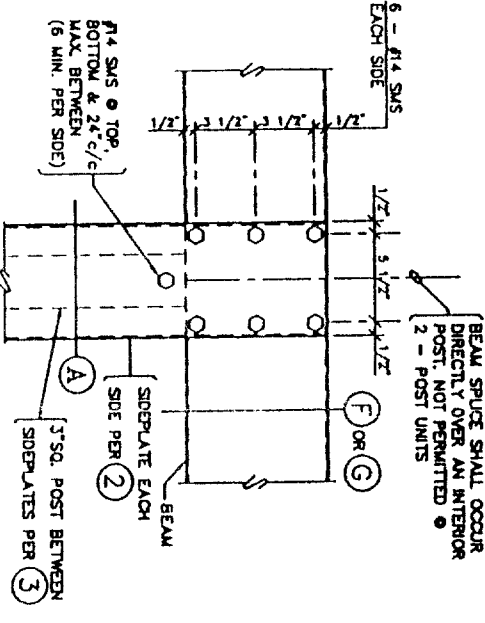

BEAM TO POST CONN. E

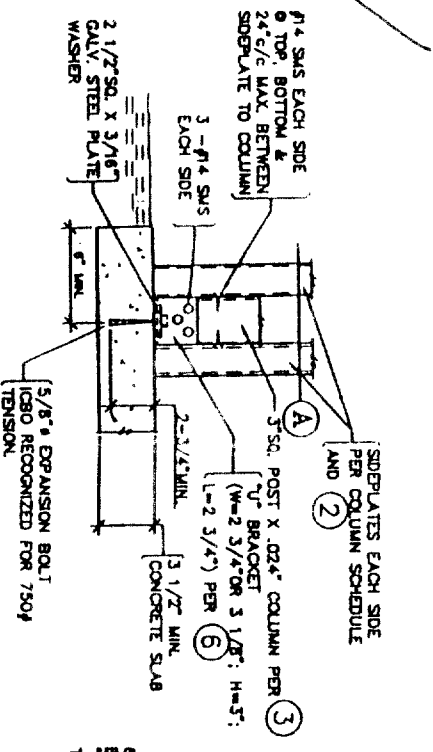

ATTACHED UNIT POST AT SLAB CONN. I

(FOR ALTERNATE ATTACHMENT, SEE DWG. PPC-8)

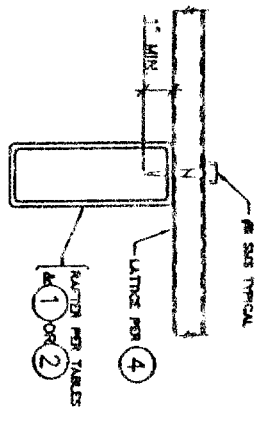

LATTICE TO RAFTER B

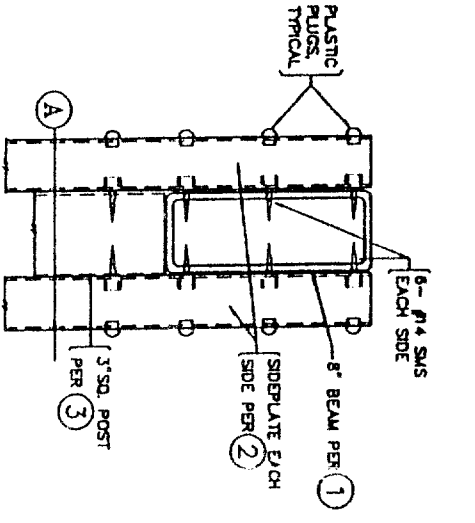

8" BEAM CONNECTION F

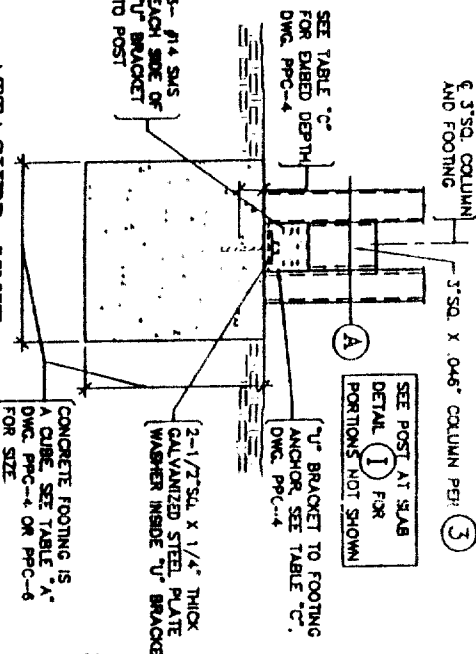

ATTACHED UNIT POST AT FOOTING CONN. J

ADDENDUM TO ICBO EVALUATION SERVICE INC. REPORT 1841P

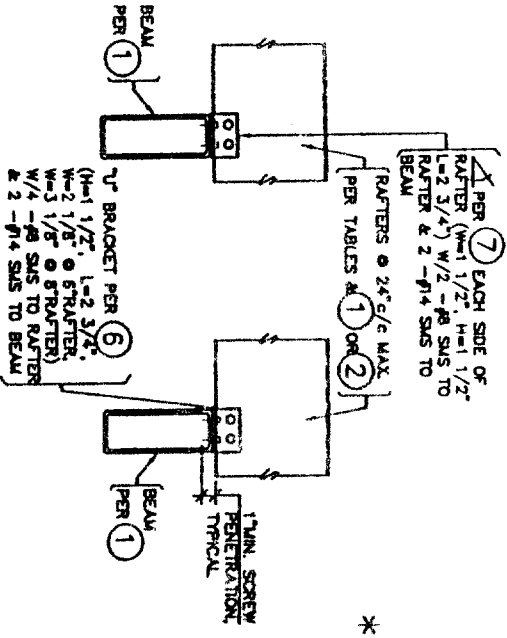

RAFTER TO BEAM CONNECTION C

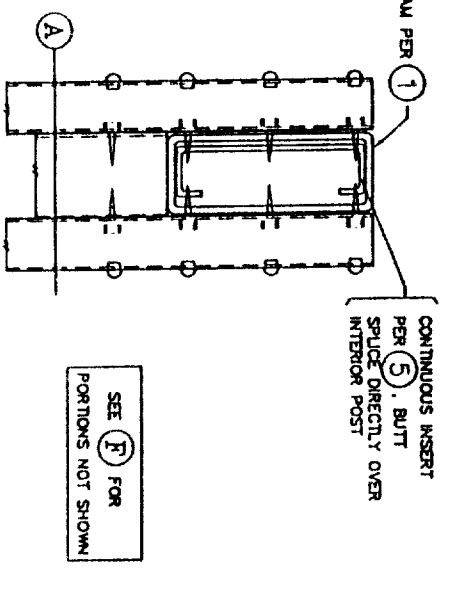

8" BEAM WITH INSERT CONNECTION G

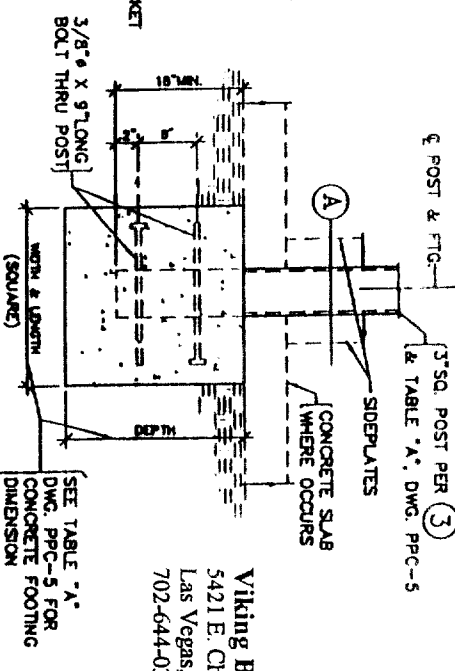

PRESTANDING TYPE POST AT FOOTING CONN. K

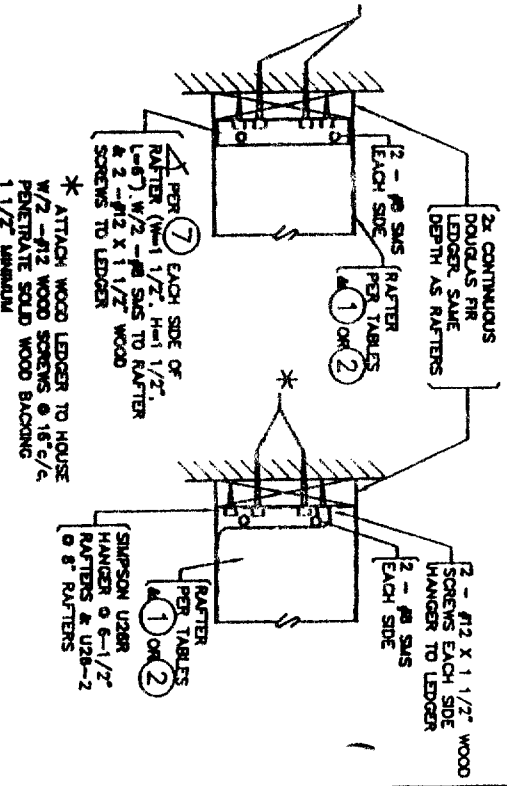

WALL CONNECTION D

(FOR EAVE ATTACHMENT, SEE DWG. PPC-8)

Distributed by:

Viking Builders, Inc. - Viking Aluminum, Inc. - Viking-Ajaxx Supply
 5421 E. Cheyenne 1440 S. Balboa Ave. 11385 Sunrise Park Drive #200
 Las Vegas, NV 89115 Ontario, CA 91761 Rancho Cordova, CA 95742
 702-644-0301 909-930-1541 916-635-2245

Manufactured by: Texas Aluminum Industries, Inc.
 2900 Patio Drive
 Houston, Texas 77017

Sun Country™ Deluxe Lattice System

DRAWN BY:	SCALE:
GMV	NONE
DATE:	
MAR. 31, 1998	

ASHTON, VANCE & ASSOC., INC.

DRAWING DESCRIPTION
 DETAILS
 (STEEL INSERT)

DRAWING NUMBER
 PPC-2

GENERAL NOTES & SPECIFICATIONS

- THIS ENCLOSURE SYSTEM IS LIMITED TO RECREATION AND OUTDOOR LIVING SURFACES AND IS NOT TO BE USED AS GARAGE STORAGE, OR HABITABLE ROOM.
- THIS ENCLOSURE SYSTEM TO BE INSTALLED UNDER ANY PATIO COVER WHICH IS RECOGNIZED FOR ENCLOSURE PER CHAPTER 191 (APPROX) OF THE UNIFORM BUILDING CODE, 1994 EDITION.
- DESIGN LOADS: SEE TABLES FOR DESIGN LOADS SHEETS 1221 & 1224.
- FASTENERS: 1/2" DIA. RIVETS, WHERE SHOWN, SHALL BE 5082 ALUMINUM RIVET WITH CARBON STEEL PLATED WAREHOUSE AS MANUFACTURED BY THE U.S. AIR FORCE METAL WORKS DIVISION, STEEL OR 6061-T6 ALUMINUM.
- ALL STRUCTURAL COMPONENTS OF THIS ENCLOSURE SYSTEM (EXCEPT SOLID PANELS) ARE OF ALLOY & TEMPER 6063-T6 UNLESS SPECIFICALLY NOTED OTHERWISE.
- THE SOLID WALL PANELS SHOWN SHALL COMPLY WITH AN EVALUATION REPORT OF THE CURRENTLY RECOGNIZED BY IBC. EVALUATION SERVICE INC. ALL EXTERIOR PORTIONS OF THE SOLID WALL PANEL WHICH ARE SUBJECT TO WATER INTRUSION SHALL BE FULLY CALKED.
- REMOVABLE GLASS INSTALLED IN AREAS REQUIRED TO BE OPEN: THE LONGER WALL AND ONE ADDITIONAL WALL SHALL BE AT LEAST 65 PERCENT OPEN AND BE A MINIMUM HEIGHT OF 6'-8" MEASURED FROM THE FLOOR. THIS 65 PERCENT OPEN AREA MAY BE ENCLOSED WITH INSECT SCREENING AND/OR REMOVABLE 1/2" THICK TRANSPARENT OR TRANSLUCENT PLASTIC OR GLASS. REMAINING PORTIONS OF THE WALLS MAY BE SOLID PANEL PER NOTE # 6. FIXED PLASTIC OR GLASS COMPLYING WITH CHAPTER 24 OF THE 1994 U.B.C. ANY SLIDING OR FIXED DOORS SHALL NOT BE USED AS PART OF THE 65 PERCENT WALL REQUIREMENT. SLIDING OR FIXED DOORS SHALL BE 1 1/8" THICK PLASTIC OR GLASS.
- EACH ENCLOSURE SYSTEM SHALL HAVE PERMANENT AFFIXED IDENTIFICATION TAG GIVING THE NAME AND ADDRESS OF THE MANUFACTURER, DESIGN LOADS AND EVALUATION REPORT NUMBER.
- THE BEARING SYSTEM MULLIONS HAVE BEEN DESIGNED FOR LOAD COMBINATIONS AS DESIGNATED IN CHAPTER 16 OF THE U.B.C.
- THE PATIO COVER FOR NON-BEARING SYSTEM SHALL BE DESIGNED TO RESIST LATERAL WIND LOADS AS APPROVED BY THE LOCAL BUILDING OFFICIAL. THE COVER MAY BE CONSTRUCTED OF ANY MATERIAL PERMITTED BY THE UNIFORM BUILDING CODE.
- ALUMINUM PARTS IN CONTACT WITH STEEL SHALL BE PAINTED WITH ONE COAT OF ZINC CHROMATE PRIMER IN ACCORDANCE WITH FEDERAL SPECIFICATION TT-P-545 OR EQUIVALENT. ALUMINUM IN CONTACT WITH WOOD, CONCRETE OR MASONRY SHALL BE GIVEN A HEAVY COAT OF ALKALI-RESISTANT BITUMINOUS PAINT. ALL PAINT AND APPLICATION SHALL CONFORM TO SECTION 2004.3, 1994 U.B.C.
- ALUMINUM PARTS SHALL BE STAINLESS STEEL ALLOY SELF-TAPPING HEX-HEAD CADMIUM PLATED SCREWS WITH COMPPOSITE ALUMINUM-NEOPRENE WASHERS. THE ALUMINUM PORTION OF THE WASHER HAS MINIMUM DIMENSIONS OF .050 INCH THICKNESS AND 5/8 INCH O.D. THE MINIMUM ROOF PANEL THICKNESS AT THESE SCREW LOCATIONS IS 5/8 INCHES. SCREW SHALL BE LOCATED NO CLOSER THAN 5/8 INCHES FROM THE END OF ANY ROOF PANEL.
- THESE GENERAL NOTES & SPECIFICATIONS APPLY TO 2" & 3" WALL SYSTEMS.

TABLE 'A'- BEARING SYSTEM MULLIONS - SEE SECTION 'A'

MAXIMUM MULLION SPACING	MAX. MULLION HEIGHT TYPE 'E'	TYPE	MAXIMUM RATIO COVER DIMENSIONS PROJECTION OVERHANG	20" SNOW LOAD, 10" WIND, 10" WIND, 10" WIND, 15" WIND, 15" WIND, 15" WIND UPLIFT		MAXIMUM RATIO COVER DIMENSIONS PROJECTION OVERHANG	MAX. MULLION HEIGHT TYPE 'E'	TYPE	MAXIMUM RATIO COVER DIMENSIONS PROJECTION OVERHANG	30" SNOW LOAD, 15" WIND, 15" WIND, 15" WIND UPLIFT		MAXIMUM RATIO COVER DIMENSIONS PROJECTION OVERHANG	MAX. MULLION HEIGHT TYPE 'E'	TYPE	MAXIMUM RATIO COVER DIMENSIONS PROJECTION OVERHANG	40" SNOW LOAD, 15" WIND, 15" WIND UPLIFT	
				MAXIMUM MULLION SPACING	MAX. MULLION HEIGHT TYPE 'E'					MAXIMUM RATIO COVER DIMENSIONS PROJECTION OVERHANG	MAXIMUM MULLION SPACING					MAX. MULLION HEIGHT TYPE 'E'	MAXIMUM RATIO COVER DIMENSIONS PROJECTION OVERHANG
48 1/4"	11'-0"	9'-0"	20'-0"	20'-0"	20'-0"	20'-0"	9'-0"	9'-0"	20'-0"	20'-0"	20'-0"	20'-0"	9'-0"	9'-0"	20'-0"	20'-0"	20'-0"
42 1/4"	11'-0"	10'-0"	20'-0"	20'-0"	20'-0"	20'-0"	9'-0"	9'-0"	20'-0"	20'-0"	20'-0"	20'-0"	9'-0"	9'-0"	20'-0"	20'-0"	20'-0"
36 1/4"	11'-0"	10'-9"	20'-0"	20'-0"	20'-0"	20'-0"	9'-0"	9'-0"	20'-0"	20'-0"	20'-0"	20'-0"	9'-0"	9'-0"	20'-0"	20'-0"	20'-0"
30 1/4"	7'-1"	7'-9"	17'-0"	17'-0"	17'-0"	17'-0"	7'-1"	7'-9"	17'-0"	17'-0"	17'-0"	17'-0"	7'-1"	7'-9"	17'-0"	17'-0"	17'-0"

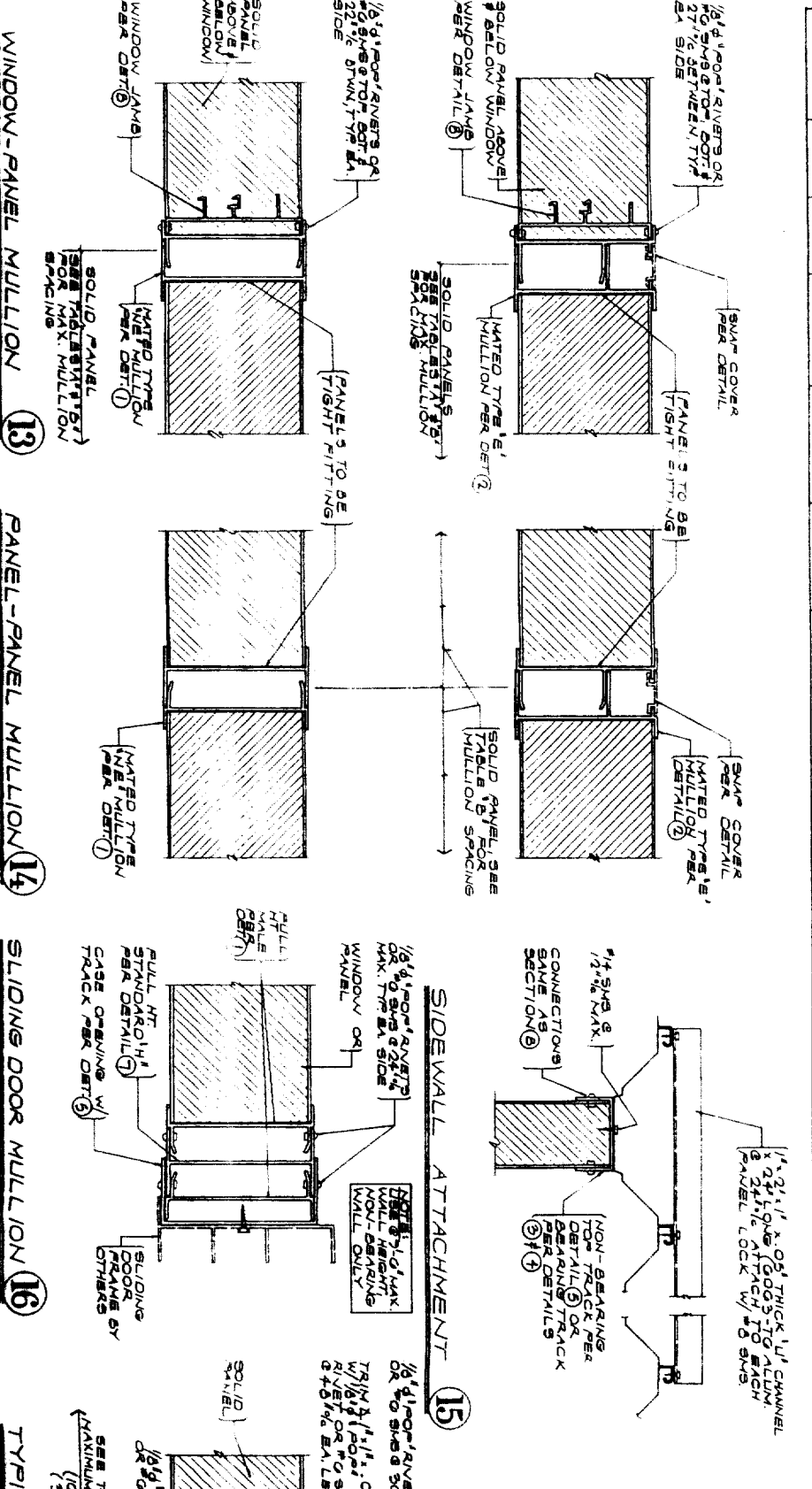
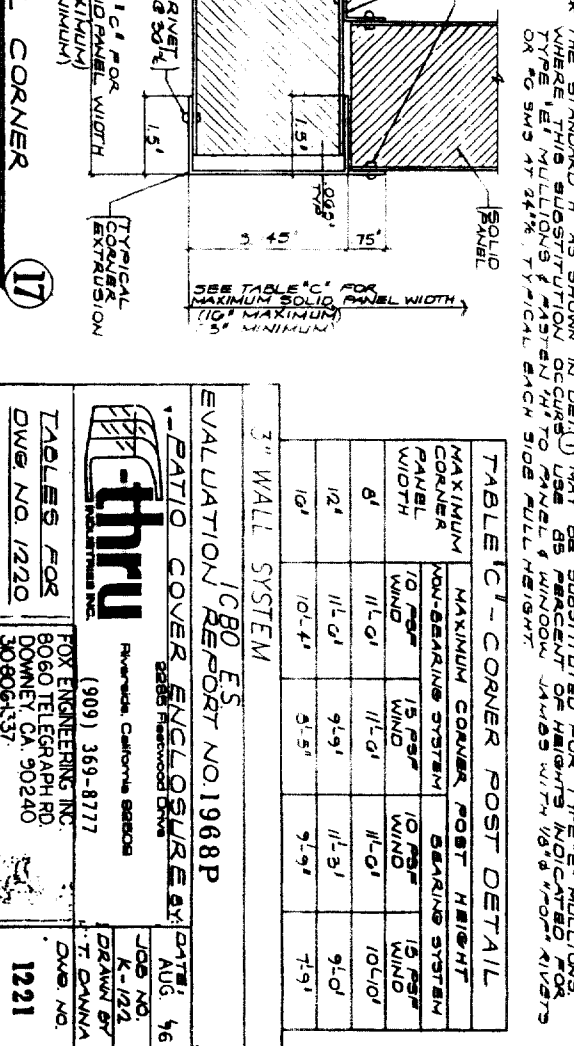

TABLE 'B'- NON BEARING SYSTEM MULLIONS-SEE SECTION 'B'

MULLION TYPE	MAXIMUM MULLION SPACING	MAXIMUM MULLION HEIGHT		
		WINDOW-SOLID PANEL ARRANGEMENT	WINDOW-PANEL SEE DETAIL (9) & (10)	PANEL-PANEL SEE DETAIL (11)
TYPE 'NE'	48"	12'-0"	12'-0"	12'-0"
	30"	12'-0"	11'-3"	12'-0"
TYPE 'E'	48"	12'-0"	12'-0"	12'-0"
	30"	12'-0"	11'-0"	12'-0"



3" WALL SYSTEM

ICBO E'S REPORT NO. 1968P

EVALUATION REPORT NO. 1968P

PATIO COVER ENCLOSURE BY

thru

FOX ENGINEERING INC. (909) 369-8777

8060 TELEGRAPH RD. DONNER CA. 90240

TABLES FOR DWE NO. 1220

1221