

CITY OF SACRAMENTO
1231 I Street, Sacramento, CA 95814

Permit No: 9907497
Insp Area: 4

Site Address: 3405 DELTA QUEEN AV SAC
Parcel No: 274-0480-023 RIVERGATE LOT 21

Sub-Type: NSFR
Housing (Y/N): N

CONTRACTOR
WARMINGTON HOMES
8265 SIERRA COLLEGE BL #312
ROSEVILLE CA 95661

OWNER

ARCHITECT
HEZMALHLACH WILLIAM ARCH INC
17875 VON KARMAN AV #404
IRVINE CA 92614

Nature of Work: NEW HOME, MP2059 (W/DEN OPTION), 8 ROOMS

CONSTRUCTION LENDING AGENCY: I hereby affirm under penalty of perjury that there is a construction lending agency for the performance of the work for which this permit is issued (Sec. 3097, Civ. C).

Lender's Name _____ Lender's Address _____

LICENSED CONTRACTORS DECLARATION: I hereby affirm under penalty of perjury that I am licensed under provisions of Chapter 9 commencing with section 7000) of Division 3 of the Business and Professions Code and my license is in full force and effect.

License Class _____ License Number _____ Date _____ Contractor Signature _____

OWNER-BUILDER DECLARATION: I hereby affirm under penalty of perjury that I am exempt from the contractors License Law for the following reason (Sec. 7031.5, Business and Professions Code; any city or county which requires a permit to construct, alter, improve, demolish, or repair any structure, prior to its issuance, also requires the applicant for such permit to file a signed statement that he or she is licensed pursuant to the provisions of the Contractors License Law (Chapter 9 commencing with Section 7000) of Division 8 of the Business and Professions Code) or that he or she is exempt therefrom and the basis for the alleged exemption. Any violation of Section 7031.5 by any applicant for a permit subjects the applicant to a civil penalty of not more than five hundred dollars (\$500.00).

_____, as a owner of the property, or my employees with wages as their sole compensation, will do the work, and the structure is not intended or offered for sale (Sec. 7044, Business and Professional Code). The Contractors License Law does not apply to an owner of property who builds or improves thereon, and who does such work himself or herself or through his/her own employees, provided that such improvements are not intended or offered for sale. If, however, the building or improvement is sold within one year of completion, the owner-builder will have the burden of proving that he/she did not build or improve for the purpose of sale.)

_____, I, as owner of the property, am exclusively contracting with licensed contractors to construct the project (Sec. 7044, Business and Professions Code). The Contractors License Law does not apply to an owner of property who builds or improves thereon, and who contracts for such projects with a contractor(s) licensed pursuant to the Contractors License Law).

I am exempt under Sec. _____ B & PC for this reason: _____

Date _____ Owner Signature _____

IN ISSUING THIS BUILDING PERMIT, the applicant represents, and the city relies on the representation of the applicant, that the applicant verified all measurements and locations shown on the application or accompanying drawings and that the improvement to be constructed does not violate any law or private agreement relating to permissible or prohibited locations for such improvements. This building permit does not authorize any illegal location of any improvement or the violation of any private agreement relating to location of improvements.

I certify that I have read this application and state that all information is correct. I agree to comply with all city and county ordinances and state laws relating to building construction and hereby authorize representative(s) of this city to enter upon the abovementioned property for inspection purposes.

Date _____ Applicant/Agent Signature _____

WORKER'S COMPENSATION DECLARATION: I hereby affirm under penalty of perjury one of the following declarations:
_____, I have and will maintain a certificate of consent to self-insure for workers' compensation as provided for by Section 3700 of the Labor Code, for the performance of work for which the permit is issued.

_____, I have and will maintain workers' compensation insurance, as required by Section 3700 of the Labor Code, for the performance of the work for which this permit is issued. My workers' compensation insurance carrier and policy number are:

Carrier REPUBLIC INDEM CO OF AMERICA Policy Number 00779320 Exp Date 07/01/1999

(This section need not be completed if the permit is for \$100 or less) I certify that in the performance of the work for which this permit is issued, I shall not employ any person in any manner so as to become subject to the workers' compensation laws of California and agree that if I should become subject to the workers' compensation provisions of Section 3700 of the Labor Code, I shall forthwith comply with those provisions.

Date _____ Applicant Signature *Ten Steen Klein*

WARNING: FAILURE TO SECURE WORKER'S COMPENSATION COVERAGE IS UNLAWFUL AND SHALL SUBJECT AN EMPLOYER TO CRIMINAL PENALTIES AND CIVIL FINES UP TO ONE HUNDRED THOUSAND DOLLARS (\$100,000) IN ADDITION TO THE COST OF COMPENSATION, DAMAGES AS PROVIDED FOR IN SECTION 3706 OF THE LABOR CODE, INTEREST AND ATTORNEY'S FEE.

THIS PERMIT SHALL EXPIRE BY LIMITATION IF WORK IS NOT COMMENCED WITHIN 180 DAYS.



No 18816

INSTALLATION CARD

Job Address

Warmington Runbend
10t 21 3105 Delta Queen
Stucco

Stucco System Trade Name: KWIK KOTE
Name Stucco Manufacturer: KWIK KOTE CORP.

ICBO Evaluation Service, Inc.
Report No. 3607
Date of Job Completion _____

Stucco Contractor Kenyon Construction
Name John W Kenyon, III
Address P.O. Box 2077
North Highlands, CA 95660
Telephone Number (916) 349-8191
Approved Contractor Number as issued by the Stucco Manufacturer: 1

This is to certify that the stucco system on the building exterior at the above address had been installed in accordance with the evaluation report specified above and the manufacturer's instructions.

Signature of authorized representative of stucco contractor

Date

10/21/89

CERTIFICATION OF COMPLIANCE
SCHOOL DISTRICT DEVELOPMENT FEES

Property Owner's Name <u>William J. & Helen</u>	
Owner's Address <u>37700 ... 200 ... CA 95661</u>	
Project Address <u>3405 DELTA QUEEN AVE LOT 21</u>	
Parcel Number <u>...</u>	
Subdivision Name <u>...</u>	
Number of Units <u>...</u>	
Print Applicant's Name <u>...</u>	Applicant's Signature <u>[Signature]</u>
Title of Applicant <u>Ms.</u>	Telephone Number <u>222-791-7200</u>
Date <u>7/13/99</u>	
PART II: TO BE COMPLETED BY BUILDING DEPARTMENT	
Plan Identification Number <u>2059/0</u>	
Building Type (Check One) <input checked="" type="checkbox"/> Residential <input type="checkbox"/> Apartment/Condominium <input type="checkbox"/> Commercial/Industrial	
Square Feet of Chargeable Building Area <u>2280</u> <u>2059</u> <small>(The Building Area is 7/13/99)</small>	
Signature <u>[Signature]</u>	Date <u>7-13-99</u>
PART III: TO BE COMPLETED BY NATOMAS UNIFIED SCHOOL DISTRICT	
District Certification Number <u>...</u>	
Fees Collected: <u>3973.87</u>	
Residential: <u>2059</u> Sq. Ft. X \$ <u>1.93</u>	= \$ <u>[Amount]</u>
Apartment/Condominium: Sq. Ft. X \$	= \$
Commercial/Industrial: Sq. Ft. X \$	= \$
NOTICE TO APPLICANT: Pursuant to government code section 66020 (d), this will serve to notify you that the 90-day approval period in which you may protest the fees, or other payment identified above, will begin to run on the date in which the building or installation permit for this project is issued, or on which they are paid to the District, or to another public entity authorized to collect them on behalf of the District, whichever is earlier.	
Applicant Signature: <u>Tom Truckle</u>	Date: <u>7/20/99</u>

This certification covers only the amount of square footage indicated above. Any additions or corrections to the square footage for this project will require an amendment to the Certificate of Compliance.

As the authorize Natomas Unified School District official, I hereby certify that the requirements of Government Code Section 95995 have been complied with by the above signed applicant.

SIGNATURE: [Signature] DATE: 7/20/99
 TITLE: [Title]

CERTIFICATION OF INSULATION

PART I GENERAL PART II AREAS INSULATED

ADDRESS OR TRACT LOT # 21 RIVIERA	SACRAMENTO INSULATION CONTRACTORS <input checked="" type="checkbox"/> P.O. BOX 854, WEST SACRAMENTO, CA 95691 LIC. #202026 <input type="checkbox"/> 1309 MELODY ROAD, MARYSVILLE, CA 95901 LIC. #202026 <input type="checkbox"/> P.O. BOX 9651, FRESNO, CA 93793-9651 LIC. #202026 <input type="checkbox"/> P.O. BOX 1631, RENO, NV 89505 LIC. #10675 <input type="checkbox"/> 3326 A PONDEROSA WAY, LAS VEGAS, NV 89118 LIC. #10675 DATE INSULATION COMPLETED
---	--

WALLS		CEILINGS			FLOORS	
SQUARE FEET)		SQUARE FEET)			(SQUARE FEET)	
TYPE OF INSULATION		TYPE OF INSULATION			TYPE OF INSULATION	
MATERIAL	FIBERGLASS	MATERIAL	FIBERGLASS		MATERIAL	FIBERGLASS
FORM	BATTS	FORM	BATTS & BLOW		FORM	BATTS
MANUFACTURER'S PRODUCT I D		MANUFACTURER'S PRODUCT I D			MANUFACTURER'S PRODUCT I D	
MANUFACTURER		MANUFACTURER			MANUFACTURER	
OCF		OCF			OCF	
R - VALUE INSTALLED		APPLIED THICKNESS		MIN. INSTALLED WEIGHT PER SQUARE FOOT	R - VALUE INSTALLED	
APPLIED THICKNESS		R - VALUE INSTALLED		APPLIED THICKNESS		
13	3 5/8"	30	9"			
		30	12"			

KNEE WALLS IF R-VALUE IS OTHER THAN WALLS ABOVE

MATERIAL:	FORM	R VALUE	MANUFACTURER
FIBERGLASS	BATTS		OCF

AIR INFILTRATION SEALANT

MATERIAL:	MANUFACTURER
FOAM	W R GRACE

THIS IS TO CERTIFY THAT INSULATION AND/OR SEALANT HAS BEEN INSTALLED IN CONFORMANCE WITH APPLICABLE CODES, MATERIAL STANDARDS AND REGULATIONS.

SIGNATURE - INSULATION CONTRACTOR	TITLE	DATE
	MANAGER	11-3-99
SIGNATURE - GENERAL CONTRACTOR	TITLE	DATE

REMARKS

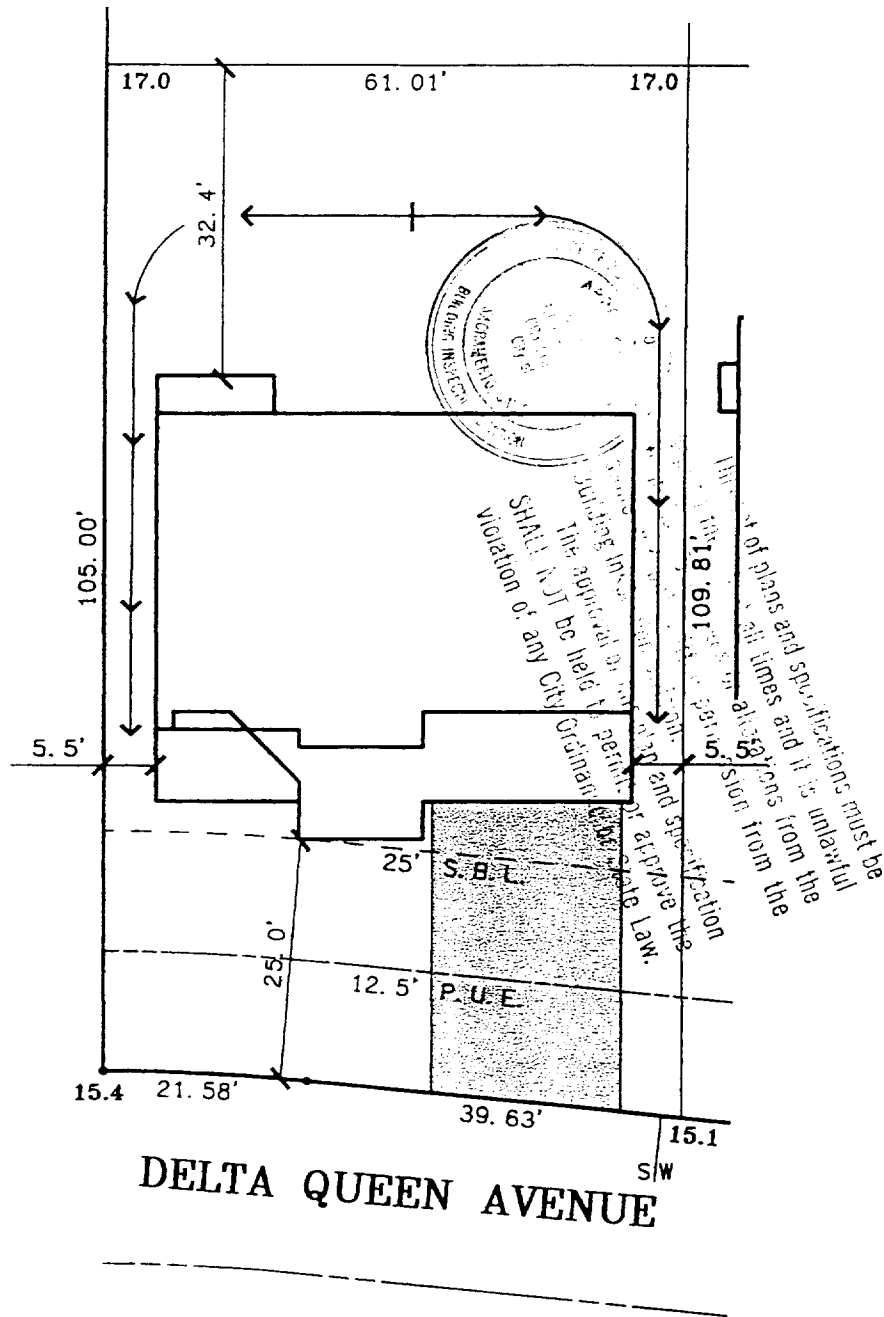

A.P.N.: 274-048-023
 ADDRESS: 3405 DELTA QUEEN AVENUE

DATE: 6-14-99

The Spink Corporation
 2590 VENTURE OAKS WAY
 SACRAMENTO, CA. 95833
 PH:(916)925-5550 FAX:(916)921-9274

RIVERGATE
 LOT 21
 PLAN 2059A

RIVERBEND CLASSICS
 CITY OF SACRAMENTO, CA.
 CLIENT: WARMINGTON HOMES
 JOB NO.: 9342-001