

ARCHITECTURAL REVIEW BOARD

APPLICANT Mike Hewitt, 1526 Barnett Court, Carmichael, California
OWNER Mike and Patricia Hewitt, 1526 Barnett Court, Carmichael, California
PLANS BY Nacht and Lewis, Architects
FILING DATE _____ 50 DAY ARB ACTION DATE _____ REPORT BY: RBH:jb
NEGATIVE DEC. _____ EIR _____ ASSESSOR'S PCL. NO. 007-051-06

PROPOSAL: Sign and landscape review

LOCATION: 800 Alhambra Boulevard

PROJECT INFORMATION:

Zoning of Property:	C-2
Land Use of Property:	Commercial building
Surrounding Land Uses:	
North:	Vacant and single family
South:	Office
East :	Single family and office
West :	Single family
Square Footage of Building:	6,000 square feet
Parking Provided:	23
Parking Required:	15
Materials:	Stucco and wood
Colors:	Brown and white
Sign Materials:	Redwood and white formica
Sign Height:	10' 6" above top of mound 12' 6" above ground level

The applicant has returned to the Architectural Review Board with revised landscaping plans and revised monument sign plans and elevation, as required by the Board at its August 6, 1980 meeting.

BACKGROUND INFORMATION:

Staff has submitted landscaping plans to Board member Art Camacho for review. Mr. Camacho's comments to landscaping treatment will be available at the meeting.

STAFF EVALUATION:

Staff finds that the redesign of the sign conforms with the instructions from the Architectural Review Board at its previous meeting. The sign meets the square footage requirements of the City Sign Ordinance. Evaluation of landscaping treatment will be provided by Art Camacho.

APPLC. NO. 80-67

MEETING DATE October 15, 1980

CPC ITEM NO. 1

STAFF RECOMMENDATIONS:

Staff recommends approval of the redesigned monument sign and approval of the landscaping plans, as submitted, or with the addition of any conditions acceptable to the Board which may be recommended by Mr. Camacho.

Findings of Fact:

1. The design treatment of the building complies with the standards and criteria of the Old City Design Guidelines in that the design of the structure is compatible in color and material with surrounding properties.
2. The subject project conforms to the Old City Review District Goal: "To encourage architecture which is integrated and compatible with the existing development in the neighborhood."

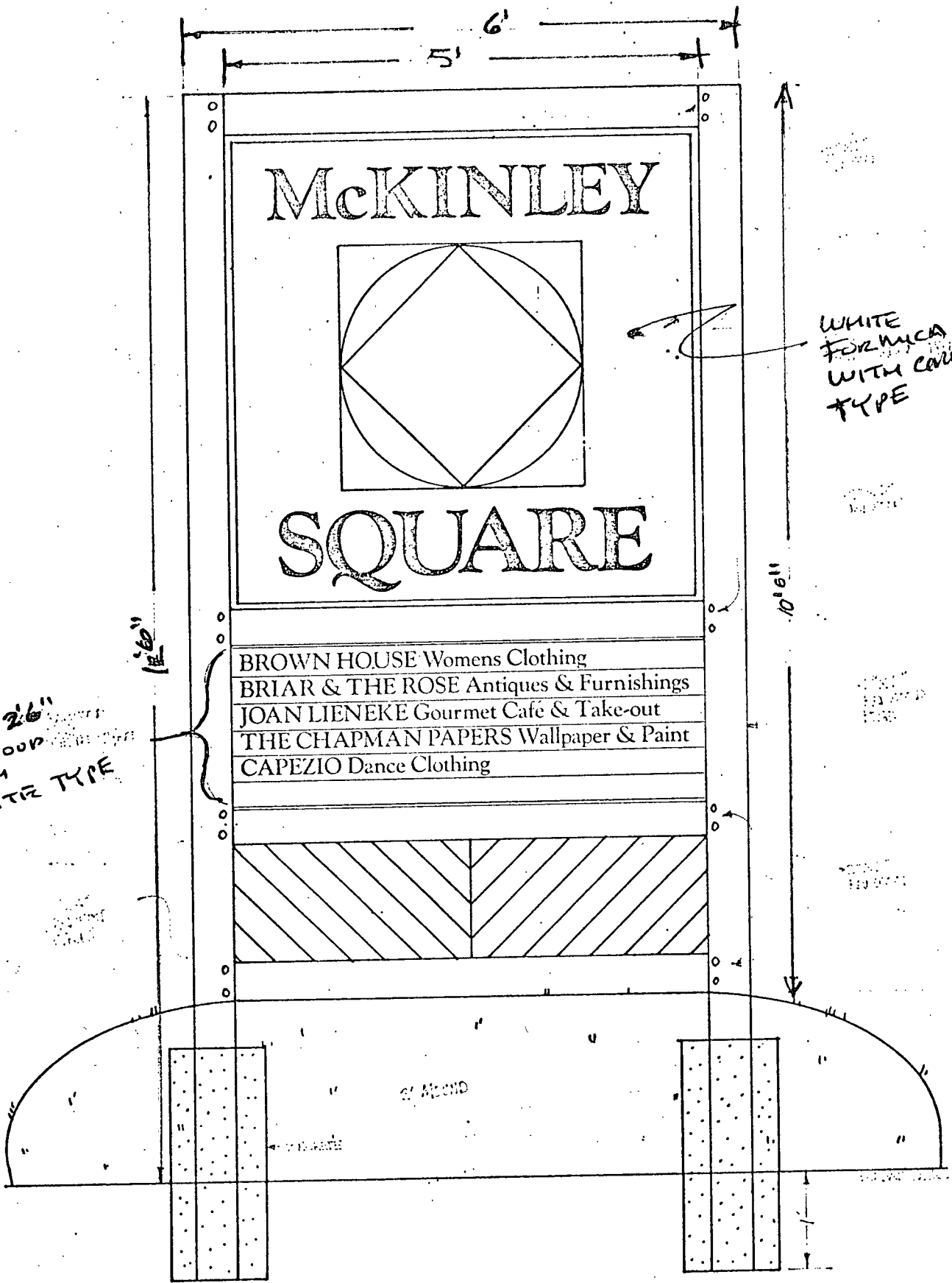

2'6"
 BEDWOOD
 WITH
 WHITE TYPE

WHITE
 FORMICA
 WITH CONFORM
 TYPE

FOUR SIDED MONUMENT SIGN

2'

- H STREET -

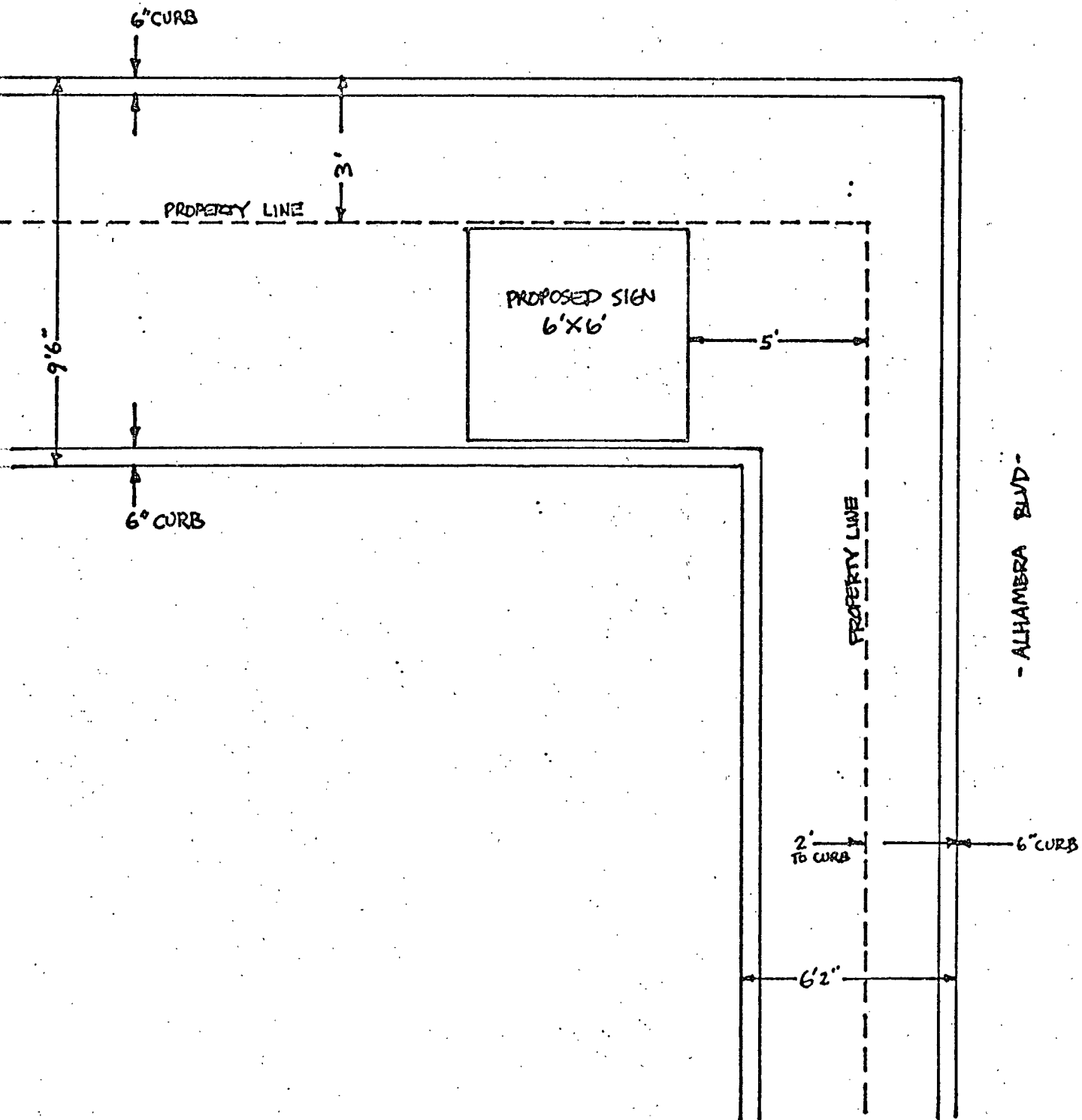

800 ALHAMBRA BLVD
ARB 80-67