

CONSTRUCTION LENDING AGENCY

I hereby affirm under penalty of perjury that there is a construction lending agency for the performance of the work for which this permit is issued (Sec. 3097, Civ. C).

Lenders Name _____
Lenders Address _____

LICENSED CONTRACTORS DECLARATION

I hereby affirm under penalty of perjury that I am licensed under provisions of Chapter 9 (commencing with Section 70030) of Division 3 of the Business and Professions Code and my license is in full force and effect.

License Class CEVT Lic. Number 6698634
Date 10-17-03 Contractor [Signature]
(Signature)

OWNER - BUILDER DECLARATION

I hereby affirm under penalty of perjury that I am exempt from the Contractors License Law for the following reason (Sec. 7031.5, Business and Professions Code: Any city or county which requires a permit to construct, alter, improve, demolish, or repair any structure, prior to its issuance, also requires the applicant for such permit to file a signed statement that he or she is licensed pursuant to the provisions of the Contractors License Law (Chapter 9 (commencing with Section 7000) of Division 8 of the Business and Professions Code) or that he or she is exempt therefrom and the basis for the alleged exemption. Any violation of Section 7031.5 by any applicant for a permit subjects the applicant to a civil penalty of not more than five hundred dollars (\$500.00):

I, as owner of the property, or my employees with wages as their sole compensation, will do the work, and the structure is not intended or offered for sale (Sec. 7044, Business and Professions Code: The Contractors License Law does not apply to an owner of property who builds or improves thereon, and who does such work himself or herself or through his or her own employees, provided that such improvements are not intended or offered for sale. If, however, the building or improvement is sold within one year of completion, the owner-builder will have the burden of proving that he or she did not build or improve for the purpose of sale.)

I, as owner of the property, am exclusively contracting with licensed contractors to construct the project (Sec. 7044, Business and Professions Code: The Contractors License Law does not apply to an owner of property who builds or improves thereon, and who contracts for such projects with a contractor(s) licensed pursuant to the Contractors License Law).

I am exempt under Sec. _____ B & P C for this reason _____

Date _____ Owner _____ (Signature)

In issuing this building permit, the applicant represents, and the City relies on the representation of the applicant, that the applicant verified all measurements and locations shown on the application or accompanying drawings and that the improvement to be constructed does not violate any law or private agreement relating to permissible or prohibited locations for such improvements. This building permit does not authorize any illegal location of any improvement or the violation of any private agreement relating to location of improvements.

I certify that I have read this application and state that all information is correct. I agree to comply with all city and county ordinances and state laws relating to building construction and hereby authorize representative of this city to enter upon the abovementioned property for inspection purposes.

Date 10-17-03 Signature of Applicant or Agent [Signature]

SITE ADDRESS: 3615 North Gate Blvd SUITE 4

ASSESSOR PARCEL NO. 262-3010-105 PERMIT NO. 0212002

LICENSED CONTRACTOR NAME OF APPLICANT: Capitol News ADDRESS: S920 Rossford ZIP CODE: 95841 PHONE NO.: 349-1800

BUSINESS OWNER: Playless Shoes SIGNER AS SITE: 51838

ATTACHED: INTERIOR / ELECT. SINGLE FACED BILLBOARD / SUBDIVISION
 ILLUMINATED NON-ILLUMINATED PAINTED ON BUILDING LOGO
 INDIVIDUAL LETTERS POLE DOUBLE FACED
 METAL MONUMENT VINYL/GATOR FOAM
 PLASTIC PROJECTING RE-FACE
 WOODEN

SIGN COPY: Playless Shoe Source (B)

CITY OF SACRAMENTO PERMIT SERVICES
BUILDING INSPECTION DIVISION 264-7619

WORKER'S COMPENSATION DECLARATION

I hereby affirm under penalty of perjury one of the following declarations:

I have and will maintain a certificate of consent to self-insure for workers' compensation as provided for by Section 3700 of the Labor Code, for the performance of work for which the permit is issued.

I have and will maintain workers' compensation insurance, as required by Section 3700 of the Labor Code, for the performance of the work for which this permit is issued. My workers' compensation insurance carrier and policy number are:

Carrier: State Paid
Policy Number: 1767055AQBAD517E
NOV 17 2003

(This section need not be completed if the permit is for one hundred dollars (\$100) or less) I certify that in the performance of the work for which this permit is issued, I shall not employ any person in any manner so as to become subject to the workers' compensation laws of California and agree that if I should become subject to the workers' compensation provisions of Section 3700 of the Labor Code, I shall forthwith comply with those provisions.

Date: 11-17-03 Applicant: [Signature]

WARNING: FAILURE TO SECURE WORKERS' COMPENSATION COVERAGE IS UNLAWFUL AND SHALL SUBJECT AN EMPLOYER TO CRIMINAL PENALTIES AND CIVIL FINES UP TO ONE HUNDRED THOUSAND DOLLARS (\$100,000) IN ADDITION TO THE COST OF COMPENSATION. DAMAGES AS PROVIDED FOR IN SECTION 3706 OF THE LABOR CODE. INTEREST AND ATTORNEY'S FEES.

THIS PERMIT SHALL EXPIRE BY LIMITATION IF WORK AUTHORIZED IS NOT COMMENCED WITHIN 180 DAYS.

SIGN INFORMATION		(A) HEIGHT <u>16"</u>	(B) LENGTH <u>15'4"</u>
		(A X B) SIGN AREA _____	<u>211 SFT</u>
		POLE SIZE _____	FOOTING SIZE _____
STREET FRONTAGE (FT) _____		OCCUPANCY FRONTAGE (FT) <u>42'</u>	
OFFICE USE ONLY			
ENGINEERING REQUIRED? YES NO APPROVED BY _____		DESIGN REVIEW REQUIRED? YES NO APPROVED BY _____	
SPECIAL PERMIT REQUIRED? YES NO # _____		VARIANCE REQUIRED? YES NO # _____	
LOCATED IN PUD? YES NO WHICH PUD? _____		SIGN VALUATION	
A. TYPE OF SIGN _____		SIGN VALUATION	
B. \$ _____ PER SQ. FT. X _____ SQ. FT. = \$ _____		APPROVED BY <u>[Signature]</u> DATE <u>11/17/03</u>	
DENIED BY _____ DATE _____		DATE <u>12-9-03</u>	
BUILDING INSPECTOR <u>[Signature]</u> DATE <u>12-15-03</u>		ELECTRICAL INSPECTOR <u>[Signature]</u> DATE <u>12-15-03</u>	
FEES:		RECEIVED	
SIGN APPLICATION FEE _____		DATE _____ AMOUNT _____	
ELECTRICAL SIGN FEE _____			
CITY BUSINESS LICENSE _____			
OTHER _____			
TOTAL FEES \$ _____			

CONSTRUCTION LENDING AGENCY

I hereby affirm under penalty of perjury that there is a construction lending agency for the performance of the work for which this permit is issued (Sec. 3097, Civ.C.).

Lenders Name _____
Lenders Address _____

LICENSED CONTRACTORS DECLARATION

I hereby affirm under penalty of perjury that I am licensed under provisions of Chapter 9 (commencing with Section 7000) of Division 3 of the Business and Professions Code and my license is in full force and effect.

License Class C45 Lic. Number 698634
Date 10-16-03 Contractor R. Delaney
(Signature)

OWNER - BUILDER DECLARATION

I hereby affirm under penalty of perjury that I am exempt from the Contractors License Law for the following reason (Sec. 7031.5, Business and Professions Code: Any city or county which requires a permit to construct, alter, improve, demolish, or repair any structure, prior to its issuance, also requires the applicant for such permit to file a signed statement that he or she is licensed pursuant to the provisions of the Contractors License Law (Chapter 9 (commencing with Section 7000) of Division 3 of the Business and Professions Code) or that he or she is exempt therefrom and the basis for the alleged exemption. Any violation of Section 7031.5 by any applicant for a permit subjects the applicant to a civil penalty of not more than five hundred dollars (\$500.00):

I, as owner of the property, or my employees with wages as their sole compensation, will do the work, and the structure is not intended or offered for sale (Sec. 7044, Business and Professions Code: The Contractors License Law does not apply to an owner of property who builds or improves thereon, and who does such work himself or herself or through his or her own employees, provided that such improvements are not intended or offered for sale. If, however, the building or improvement is sold within one year of completion, the owner-builder will have the burden of proving that he or she did not build or improve for the purpose of sale.)

I, as owner of the property, an exclusively contracting with licensed contractors to construct the project (Sec. 7044, Business and Professions Code: The Contractors License Law does not apply to an owner of property who builds or improves thereon, and who contracts for such projects with a contractor(s) licensed pursuant to the Contractors License Law).

I am exempt under Sec. _____ B & P C for this reason _____

Date _____ Owner _____ (Signature)

In issuing this building permit, the applicant represents, and the City relies on the representation of the applicant, that the applicant verified all measurements and locations shown on the application or accompanying drawings and that the improvement to be constructed does not violate any law or private agreement relating to permissible or prohibited locations for such improvements. This building permit does not authorize any illegal location of any improvement or the violation of any private agreement relating to location of improvements.

I certify that I have read this application and state that all information is correct. I agree to comply with all city and county ordinances and state laws relating to building construction and hereby authorize representative of this city to enter upon the abovementioned property for inspection purposes.

Date 10-16-03 Signature of Applicant or Agent R. Delaney

SITE ADDRESS

3645 Northgate Blvd

SUITE

4

ASSESSOR PARCEL NO.

250-0010-105

PERMIT NO. 0316193

NAME OF APPLICANT

Capitol Woods

ADDRESS

5920 Rosdorb

ZIP CODE

95841

PHONE NO.

349-1800

LICENSED CONTRACTOR

Payless Signs

SIGN INFORMATION

PERMIT NO.

95838

ATTACHED

ILLUMINATED

INDIVIDUAL LETTERS

METAL

WOODEN

SIGN COPY

Payless Signs

Slawe

AT

Payless Signs

Sarves

AT

Payless Signs

Sarves

AT

Payless Signs

Sarves

AT

Payless Signs

Sarves

AT

Payless Signs

Sarves

AT

Payless Signs

Sarves

AT

Payless Signs

Sarves

AT

Payless Signs

Sarves

AT

Payless Signs

Sarves

AT

Payless Signs

Sarves

AT

Payless Signs

Sarves

AT

Payless Signs

Sarves

AT

Payless Signs

Sarves

AT

Payless Signs

Sarves

AT

Payless Signs

Sarves

AT

Payless Signs

CITY OF SACRAMENTO PERMIT SERVICES
BUILDING INSPECTION DIVISION 264-7619

WORKER'S COMPENSATION DECLARATION

I hereby affirm under penalty of perjury one of the following declarations:

I have and will maintain a certificate of consent to self-insure for workers' compensation as provided for by Section 3700 of the Labor Code, for the performance of work for which the permit is issued.

I have and will maintain workers' compensation insurance, as required by Section 3700 of the Labor Code, for the performance of the work for which this permit is issued. My workers' compensation insurance carrier and policy number are:
Strada Paid
107705 SACRAMENTO

Carrier: Strada Paid
Policy Number: 107705 SACRAMENTO
NDV 17 2003

(This section need not be completed if the permit is for one hundred dollars (\$100) or less.) I shall not be liable for the performance of the work for which this permit is issued. I shall not be liable for any person in any manner so as to become, subject to the workers' compensation laws of California and agree that if I should become subject to the workers' compensation provisions of Section 3700 of the Labor Code, I shall forthwith comply with those provisions.

Date: 10-16-03 Applicant: R. Delaney
(Signature)

WARNING: FAILURE TO SECURE WORKERS' COMPENSATION COVERAGE IS UNLAWFUL AND SHALL SUBJECT AN EMPLOYER TO CRIMINAL PENALTIES AND CIVIL FINES UP TO ONE HUNDRED THOUSAND DOLLARS (\$100,000) IN ADDITION TO THE COST OF COVERAGE. DAMAGES AS PROVIDED FOR IN SECTION 3706 OF THE LABOR CODE, INTEREST AND ATTORNEY'S FEES.

THIS PERMIT SHALL EXPIRE BY LIMITATION IF WORK AUTHORIZED IS NOT COMMENCED WITHIN 180 DAYS.

(A) HEIGHT	<u>22'</u>	(B) LENGTH	<u>22'</u>
(A X B) SIGN AREA	<u>484</u>	<u>42.01</u>	
POLE SIZE		FOOTING SIZE	
STREET FRONTAGE (FT)			
OCCUPANCY FRONTAGE (FT)	<u>42'-10"</u>		

ENGINEERING REQUIRED?	YES	NO	APPROVED BY
DESIGN REVIEW REQUIRED?	YES	NO	APPROVED BY
SPECIAL PERMIT REQUIRED?	YES	NO	APPROVED BY
VARIANCE REQUIRED?	YES	NO	APPROVED BY
LOCATED IN PUD?	YES	NO	WHICH PUD?

SIGN EVALUATOR	<u>Shelley</u>	DATE	<u>12/2/03</u>
APPROVED BY	<u>Myra</u>	DATE	<u>11/2/03</u>
DENIED BY		DATE	

BUILDING INSPECTOR	<u>DB</u>	DATE	<u>12-9-03</u>
ELECTRICAL INSPECTOR	<u>Wickley</u>	DATE	<u>12-15-03</u>
SIGN INSPECTOR		DATE	

FEES:	RECEIVED
SIGN APPLICATION FEE	<u>10/17/03 75-</u>
SIGN PERMIT FEE	
ELECTRICAL SIGN FEE	
CITY BUSINESS LICENSE	
OTHER	
TOTAL \$	

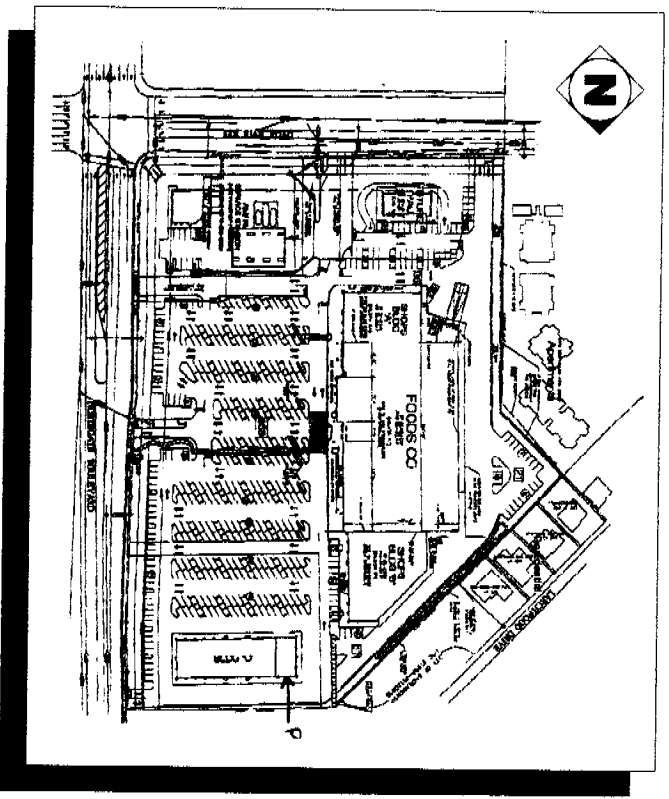

UNIVERSITY AVENUE
 DEPARTMENT OF PLANNING & DEVELOPMENT
 APPROVED
 OFFICIAL SEAL
 SACRAMENTO, CALIFORNIA
 LOCAL AGENCY
 CITY ENGINEER



This set of plans and specifications must be kept on the job at all times and it is unlawful to make any changes or alterations from the same without written permission from the City of Sacramento Sign Section.

The approval of this plan and specification SHALL NOT be held to permit or approve the violation of any City Ordinance or State Law.

All electrical work must be U.L. labeled or be of equivalent storage as per E.C. Sec. 50-6/and comply with chapter 14, DIV. 2 of Sacramento City Code.
 EQUIPMENT MUST BE USED AS DESIGN INTENDED
 ALL INSTALLATIONS ARE SUBJECT TO FIELD INSPECTIONS

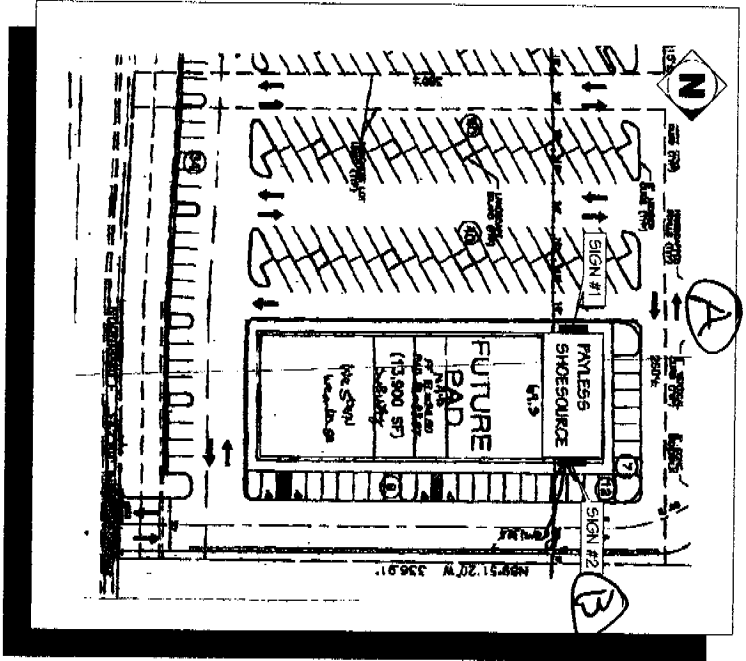

UNIVERSITY AVENUE
 DEPARTMENT OF PLANNING & DEVELOPMENT
 APPROVED
 OFFICIAL SEAL
 SACRAMENTO, CALIFORNIA
 LOCAL AGENCY
 CITY ENGINEER

<p>Loren Hecchi Sign Company</p>	<p>Client: Payless ShoeSource</p> <p>Product Address: LANDINGS GARDENS 3648 KORTMAYR BLVD SACRAMENTO, CA</p>	<p>Drawn by: SCZSFKL</p> <p>Check by: VIDUYN MAP & SITE PLAN</p> <p>Scale: NOTED</p> <p>Comments: REV. TOWNSON</p> <p>Phone No.: Fax No.: E-Mail: Salesman: DAN LORENZEN</p>	<p>Designer: ADDE SCRD</p> <p>Revised by: OS-07-07783</p> <p>Release Date: 07/29/03</p> <p>Revisions: 10/3/03 - AS</p>	<p>Page: 3 of 3</p>	<p>Customer Approval: DATE: _____</p>
---	---	---	--	----------------------------	---

CITY COPY

Payless Shoesource

APPROVED PER 1999
NATIONAL ELECTRICAL CODE
AND CITY OF SACRAMENTO
REQUIREMENTS
0-29-07
Loyce
ELECTRICAL DIVISION

PS-16 - 16" SINGLE LINE ILLUMINATED CHANNEL LETTERS
SIGN #1
07/1
TOWN AREA 2153.FT

SCALE: 1/2" = 1'-0"

SPECIFICATIONS:
FABRICATION - 7" DEEP 240 PREPARED BLACK ALUMINUM RETURN, LETTER BACKS TO BE .009 ALUMINUM PREPARED WHITE SIGN BACK TO BE .009 ALUMINUM PAINTED WHITE BLACK TO BE PAINTED WHITE BLACK
FACES - 5/8" #2016 YELLOW ACRYLIC LETTERS, 5/8" #2119 ORANGE ACRYLIC CIRCLES (2 EA),
TRIM/CAPS - 7" BLACK SQA TRIM
ILLUMINATION - 50 MA REMOTE TRANSFORMERS - HOUSED IN WEATHERROOF ELECTRICAL ENCLOSURE

* ALL SPECIFICATION IS IN CONFORMANCE WITH UL STANDARDS AND TO BE LABELED AS SUCH *

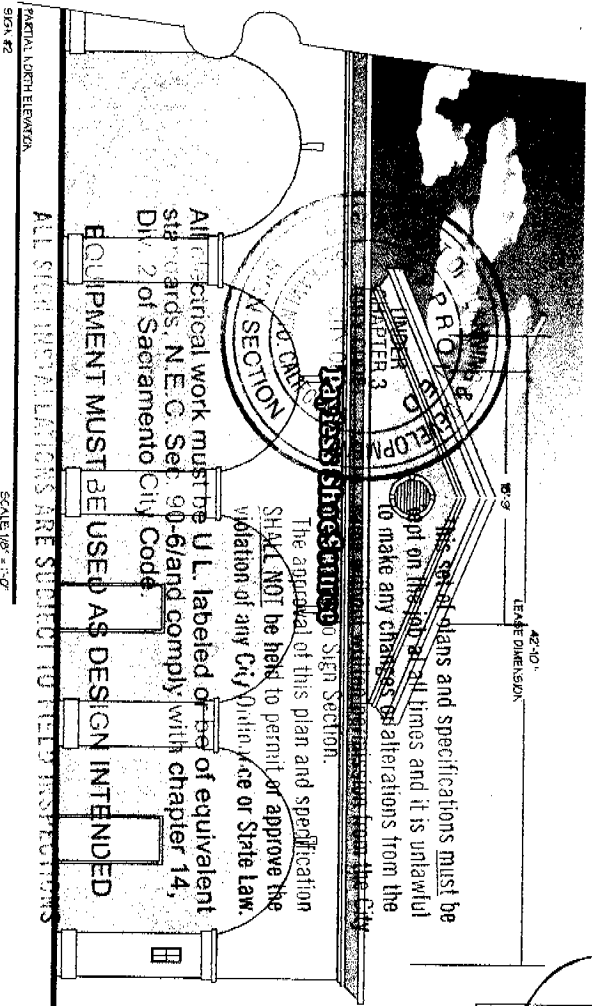

ALL ELECTRICAL WORK MUST BE U.L. LABELED OF EQUIVALENT STANDARDS, N.E.C. Sec. 90-6 and comply with chapter 14, Div. 2 of Sacramento City Code.
EQUIPMENT MUST BE USED AS DESIGN INTENDED

ALL SIGN INSTALLATIONS ARE SUBJECT TO FIELD INSPECTIONS

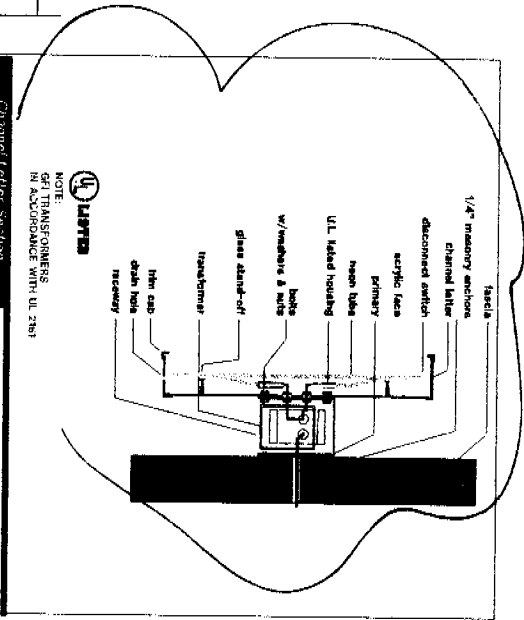

Electric Requirements
One (1) Circuit
120 Volts/ 10.76 Amps
w/ Ground Wire

*NO exposed wiring
see previous markings
detail. MP*



Payless Shoesource
PRODUCT ADDRESS:
NADINE GARDENS
3645 KORTSGATE BLVD
SACRAMENTO, CA

ORDER NUMBER: 302681
SIGN TYPE: T-16/24 - ILLUMINATED CHANNEL LETTERS
SCALE: NOTED
CONTACT: KEVIN TOWNSON
PHONE NO.:
FAX NO.:
E-MAIL:
DATE: 02/11/2005

DESIGNER: ASSE SOFTU
DESIGN NO.: 03-07-07293
DESIGN DATE: 07/28/05
REVISIONS: 10/21/05 - AS

Page: 2 of 3
CUSTOMER APPROVAL
DATE: