



## REPORT TO COUNCIL City of Sacramento

915 I Street, Sacramento, CA 95814-2604  
www. CityofSacramento.org

STAFF REPORT  
September 5, 2006

Honorable Mayor and  
Members of the City Council

**Title:** 2006 "Renaissance Park" Program Projects

**Location/Council District:** Hopkins Park, Council District 8, Johnston Park, Council District 2, Richardson Village Park, Council District 2, and Valley Hi Park, Council District 7.

**Recommendation:** Receive and File.

**Contact:** Janet Baker, Operations Manager, 808-8234; Jonathan Rewers, Parks and Recreation Analyst, 808-7590

**Presenters:** Janet Baker, Operations Manager; Jonathan Rewers, Parks and Recreation Analyst

**Department:** Parks and Recreation

**Division:** Administration and Park Planning, Design & Development

**Organization No:** 4511/4525

### Description/Analysis

**Issue:** While the City of Sacramento's parks and recreation system continues to see a significant amount of growth, there are a number of facilities in the system that are aged that need to be revitalized. The City has a dynamic and varied park system with some facilities that are more than 150 years old. Many of the City's older facilities tend to be in areas of the City that are older and built-out. As a result, these areas do not generate significant Quimby Act, "In-Lieu," or Park Development Impact Fees and the limited amount of resources that are generated need to be devoted to providing new parks in those areas that are being developed.



Limited resources for improvements have resulted in parks that need major upgrades, renovations or complete park redesign. In some cases, these parks may no longer meet the needs of the neighborhood or greater community. Because of their physical appearance or dated design, they are non-inviting, low-use facilities.

**Policy Considerations:** The *Renaissance Park Program* is consistent with the policies City Council adopted the *City of Sacramento Parks and Recreation Master Plan 2005-2010* including:

Policy 1.6: Ensure both physical and psychological safety in design, management and use of all Department facilities and programs.

Policy 7.2: Implement an assessment program based on life cycle information to regularly evaluate the physical condition of all key City parks and recreation system infrastructure elements to guide development of improvement/repair and financing strategies, deferred maintenance schedules, and establishing priorities for capital improvements, staffing and maintenance practices.

Policy 13.25: Emphasize unique and innovative designs and promote individual character in park design. Sites, facilities, structures or landscapes of historic, cultural or environmental significance will be identified and influence site design.

Policy 13.36: Redesign parks and recreation facilities for reuse as interests and needs change.

In addition, the *Renaissance Park Program* is an element of the **Implementation Strategies** that the City Council adopted in the *City of Sacramento Parks and Recreation Master Plan 2005-2010* which states:

Implementation 13.4: Retrofit Program: Develop a program to redesign and retrofit underutilized existing facilities to reflect current recreational trends.

**Committee/Commission Action:** The Parks and Recreation Commission reviewed and scored the *Renaissance Park Program* Projects at the July 6, 2006 meeting.

**Environmental Considerations:** Not applicable.

**Rationale for Recommendation:** Limited resources for improvements, especially in areas without development funding sources, have resulted in parks

that need major upgrades, renovations or complete park redesign. The *Renaissance Park Program* is meant to highlight the park facilities in neighborhoods that need an innovative approach to park rehabilitation. Each year, the Landscape Architecture section hires a number of interns to support the Department's professional Landscape Architecture staff in project development, community outreach, design, and some elements of project management. To take advantage of their talents and provide them with a development opportunity, each intern was assigned a park to redesign and a Landscape Architect, or mentor, throughout the design process. Each intern was asked to prepare a conceptual design for their assigned park, an informational board with project elements and other information, and a recommendation for development of a first phase (not to exceed \$500,000).

The parks selected for the 2006 *Renaissance Park Program* include: **Hopkins Park, Johnston Park, Richardson Village Park, and Valley Hi Park**. Each intern presented his/her project and master plan (Attachment 1, pages 5-8) to a group of departmental staff and the Parks and Recreation Commission. Projects were scored based on innovation of the design, sustainability, addressing community needs, and the overall presentation of the materials. The top scoring project as part of the 2006 *Renaissance Park Program* was **Johnston Park**.

**Financial Considerations:** Parks identified for the *Renaissance Park Program* are typically in areas of the City that are built-out and have limited or no funding available even for basic master planning. As part of the *Park Development Process*, a project is identified through the Parks and Recreation Programming Guide, and is prioritized for funding.

The project selected through the *Renaissance Park Program* (**Johnston Park**) will be identified as an "opportunity" project for funding – as the initial design work has made the project more "ready" for upcoming funding opportunities. The Department's Fiscal & Resource Development Section will work to identify funding through partnerships with groups such as the Sacramento Housing and Redevelopment Agency or through competitive grant programs such as the annual Land and Water Conservation Fund Grant Program.

**Emerging Small Business Development (ESBD):** Not applicable.

Respectfully Submitted by:

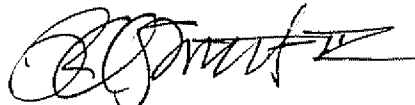

ROBERT G. OVERSTREET II  
Director of Parks and Recreation

Recommendation Approved:

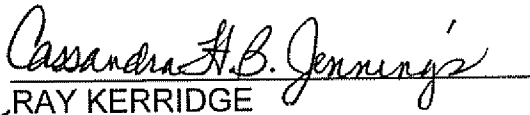
  
RAY KERRIDGE  
City Manager

**Table of Contents:**

	Pg	1	Report
<b>Attachments</b>			
1	Pg	5	Renaissance Park Master Plans (Hopkins, Johnston, Richardson, and Valley Hi)
2	Pg	9	PowerPoint Presentation

Norte Del Rio  
Jr. Highschool

D.G. Walking Trail

Natural Area  
(Enhanced Drainage  
Overflow Area)

Observation Deck  
& Interpretive Area

Habitat Pond

FAIRFIELD ST

Open Turf Area  
(seasonal detention basin)

Basin  
Demarcation

Interpretive  
Area

Community  
Garden

SONOMA AVE.

ACACIA AVE

Borch

ALTOS AVE.

Existing  
Playground

ACACIA AVE.

Shaded Picnic  
Area

Curvilinear  
Paved Pathway

Meandering  
Drainage Canal

Legend

Shade Trees

Accent Trees

Proposed Phase I

Norwalk  
Elementary School

RICHARDSON VILLAGE PARK REDEVELOPMENT

SACRAMENTO, CA 95811

CANFIELD SITE BY ENGINEER MARK ANDERSON/ENR 1/17/2008



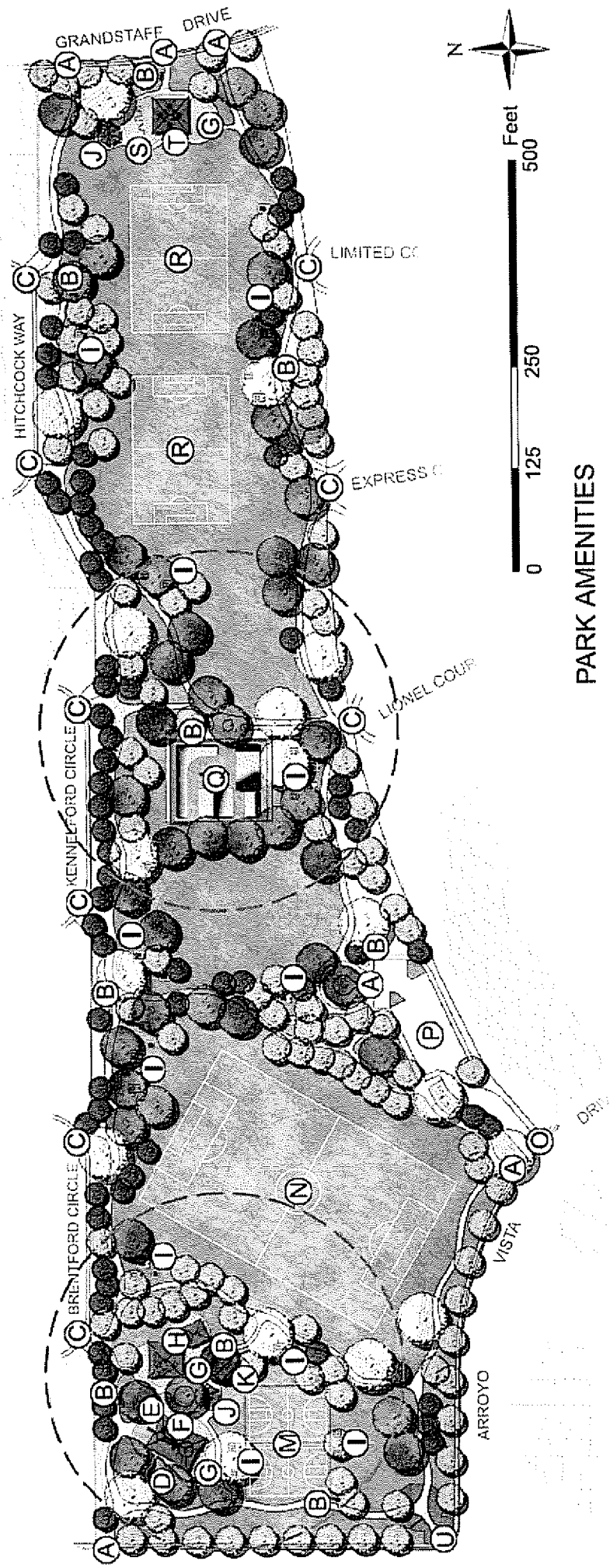

**PARK AMENITIES**

- N - HIGH SCHOOL REGULATION SOCCER FIELD WITH LIGHTING
- O - VEHICLE ACCESS
- P - PARKING (28 SPACES) WITH TURNABOUT
- Q - SKATE PARK WITH LIGHTING
- R - BANTAM SOCCER FIELD
- S - CLIMBING WALL
- T - COVERED NET CLIMBING STRUCTURE
- U - DECORATIVE PARK ENTRANCE WITH SIGN
- NS - SENIOR FITNESS CIRCUIT
- NS - SAFETY LIGHTING
- NS - TRASH AND RECYCLE RECEPTACLES
- NS - SEATING

- A - PEDESTRIAN PARK ACCESS
- B - BIKE RACK
- C - NEIGHBORHOOD ACCESS
- D - CUSTOM HILL SLIDE
- E - WATER SPRAY FEATURE
- F - COVERED ADVENTURE PLAY AREA
- G - RUBBERIZED SURFACE
- H - COVERED TOT LOT PLAY AREA
- I - PICNIC AREA
- J - COVERED PICNIC AREA
- K - RESTROOM WITH OUTDOOR SHOWERS
- M - BASKETBALL COURTS

**LEGEND**

- TURF
- LOW MAINTENANCE GROUND COVER AND SCREENING
- CONTOURS
- FREE WIRELESS INTERNET

NS = NOT SHOWN

16.39 ACRES

# LOCATION MAP

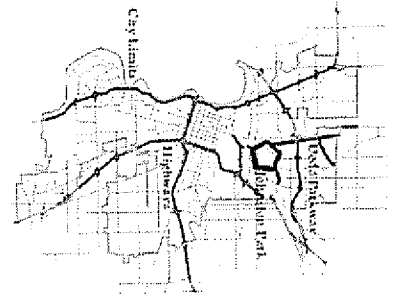

# KEY

- A Existing Clubhouse and Pool
- B Basketball Courts
- C Softball, T-Ball, and Bantam Soccer Fields
- D Picnic Areas
- E Community Garden
- F Adventure Play Areas
- G Tot Lot
- H DG Jogging Path
- I Perennial Wetland with Path and Signs
- J New Parking
- K New Street Access
- L Bike Trail Connection to Ueda Parkway
- M Ueda Parkway Directional Sign
- N Park Entry Sign
- O Existing and New Solar Lights
- P Existing Trees
- Q New Trees
- R Native Planting Areas

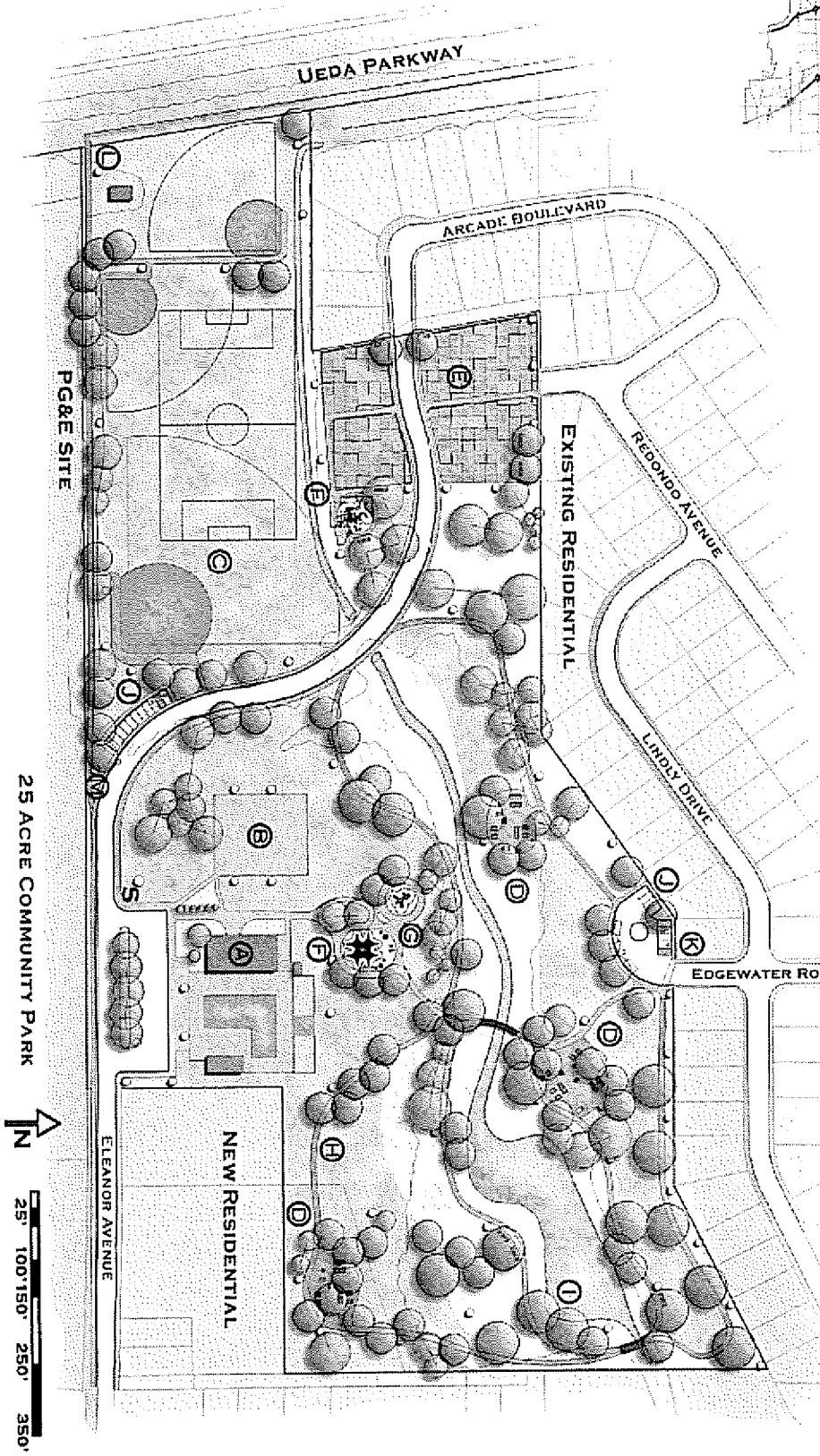

25 ACRE COMMUNITY PARK



## JOHNSTON PARK MASTER PLAN

**CITY OF SACRAMENTO**  
Parks and Recreation Department  
Landscape Architecture Section  
915 I Street, 5th Floor, Sacramento, CA 95814

1 of 3  
 DATE: 11/15/11  
 DRAWN BY: [Name]  
 CHECKED BY: [Name]  
 DESIGNED BY: [Name]  
 PROJECT NO.: [Number]  
 SHEET NO.: [Number]

**HOPKINS PARK AMENITIES:**

- A** ART IN PUBLIC PLACES TRAIN SCULPTURE
- B** ADDITIONAL CONCRETE WALKWAYS
- C** PICNIC AREA INCLUDING:  
SHADE STRUCTURE  
(5) EIGHT PICNIC BENCHES  
(4) FOUR BARBEQUE GRILLS
- D** BLOSSOMING PARK PLAZA
- E** (2) TWO VOLLEYBALL COURTS
- F** DRY CREEK BED
- G** TIKE TRACK
- H** ADDITIONAL LANDSCAPING
- I** RIPARIAN AND NATIVE LANDSCAPING
- J** PLAYGROUND AMENITIES:
- K** ADDITIONAL SWINGS
- L** MEGA STRUCTURE W/ TALL SLIDES AND NET STRUCTURE
- M** RAILROAD AND TRAIN THEMED ADVENTURE AREA
- N** HOP-SCOTCH AND FOUR SQUARE

**HOPKINS PARK LEGEND:**

- CONIFER
- DECIDUOUS
- OAK
- FLOWERING TREE
- EXISTING TREES
- BENCH
- PICNIC TABLE
- NATIVE GRASSES
- PROPERTY LINE
- HANDICAP RAMP
- EXISTING LIGHT
- EXISTING BACKFLOW PREVENTOR

MARK HOPKINS  
SCHOOL PROPERTY

PRIVATE  
PROPERTY

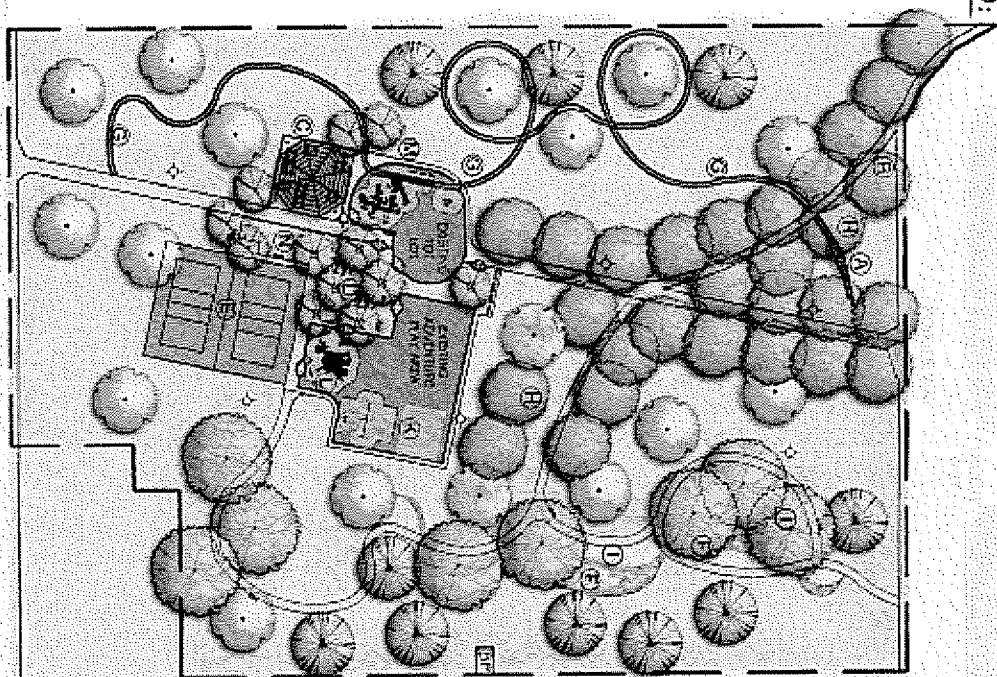

DATE	BY

CITY OF SACRAMENTO  
PARKS AND RECREATION DEPARTMENT  
PARK PLANNING, DESIGN AND DEVELOPMENT  
LANDSCAPE ARCHITECTURE SECTION



**HOPKINS PARK (6.30 AC)**

CITY OF SACRAMENTO  
DEPARTMENT OF PARKS AND RECREATION

2006

"RENAISSANCE PARK PROGRAM"  
PROJECTS

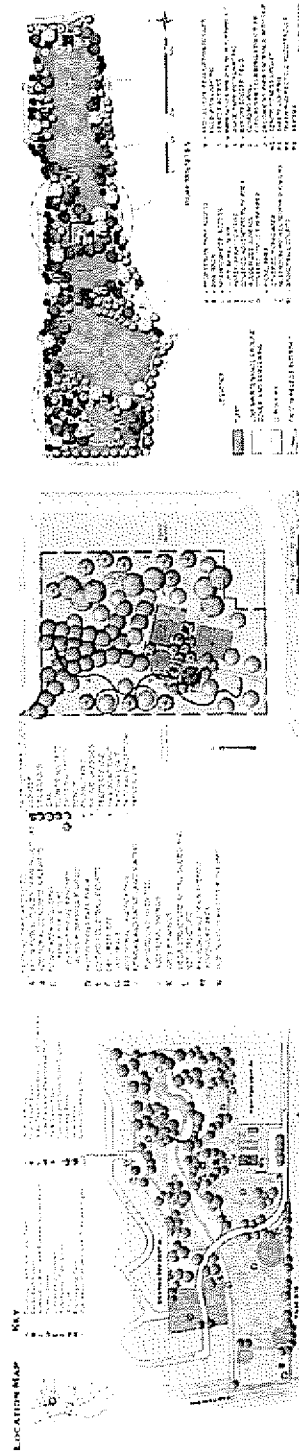

 *Optimize the Experience of Living!*

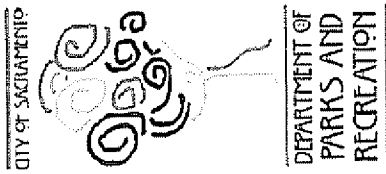

## **2006 RENAISSANCE PARK PROGRAM**

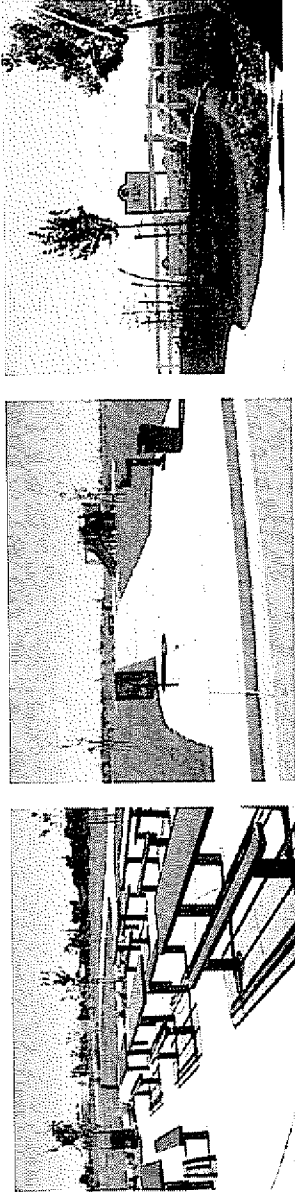

- The City's park and recreation system is varied and diverse.
- Some facilities have become aged.
- Most of the City's older park and recreation facilities are in built-out areas of the City.
- Current park financing is largely reliant on development impact fees in new growth areas.



## **2006 RENAISSANCE PARK PROGRAM**

Limited resources in some areas of the City have resulted in some park facilities that are:

1. In need of major renovation,
2. In need of major upgrades, or
3. In need of complete redesign.

These parks may no longer meet the needs of the neighborhood or greater community. Because of their physical appearance or dated design, they are non-inviting, low-use facilities.

CITY OF SACRAMENTO



DEPARTMENT OF  
PARKS AND  
RECREATION

## **2006 RENAISSANCE PARK PROGRAM**

The Renaissance Park Program is meant to highlight park facilities in neighborhoods that need a fresh look.

The program is consistent with City Council policies:

### **Parks and Recreation Master Plan**

Ensuring Safety in Design, Implementing an Assessment Program, Emphasizing Unique and Innovative Design, Redesigning Parks as Interests Change.

### **City Council Strategic Plan FY 06/07**

*Sustainability and Livability*: Pursue efforts to enhance the appearance of the City; provide and protect open space for its recreational values.

CITY OF SACRAMENTO



DEPARTMENT OF  
PARKS AND  
RECREATION

**2006 RENAISSANCE PARK PROGRAM**

**IMPLEMENTING THE MASTER PLAN:**

Develop a program to redesign and retrofit underutilized existing facilities to reflect current recreational needs.

**2006 Renaissance Park Program Sites:**

HOPKINS PARK – COUNCIL DISTRICT 8

JOHNSTON PARK – COUNCIL DISTRICT 2

RICHARDSON VILLAGE PARK – COUNCIL DISTRICT 2

VALLEY HI PARK – COUNCIL DISTRICT 7



## **2006 RENAISSANCE PARK PROGRAM**

### **CRITERIA FOR PARK SELECTION:**

- 1) Facility is underutilized – park with potential.
- 2) Facility is in need of or due for major renovation.
- 3) The facility needs to be “updated” to meet the current recreational needs of the community.

CITY OF SACRAMENTO



DEPARTMENT OF  
PARKS AND  
RECREATION

## **2006 RENAISSANCE PARK PROGRAM**

### **STAFF:**

Landscape Architecture Intern – LEAD

Landscape Architect – Coach & Support

### **JUDGES:**

Parks and Recreation Department Staff

Parks and Recreation Commission

### **Judging Criteria**

Innovative Design

Sustainable Design Elements

Identification & Resolution of Community Needs

Overall Presentation

# 2006 RENAISSANCE PARK PROGRAM

## HOPKINS PARK

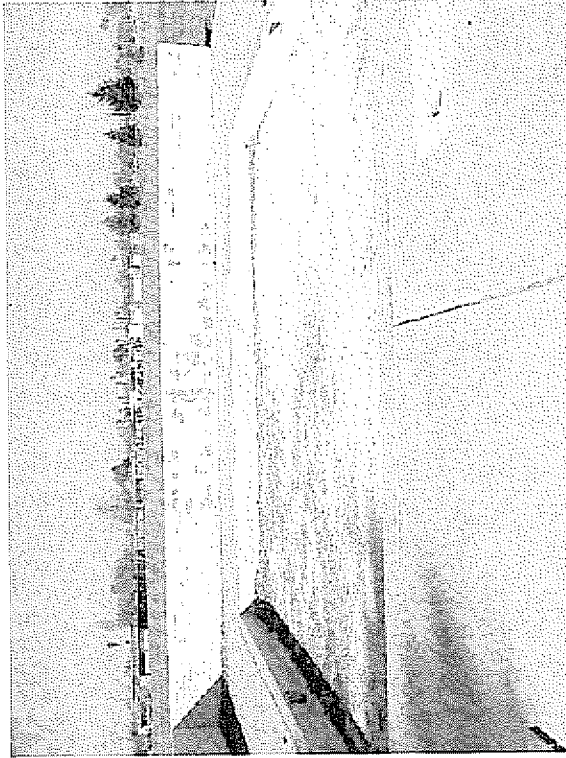
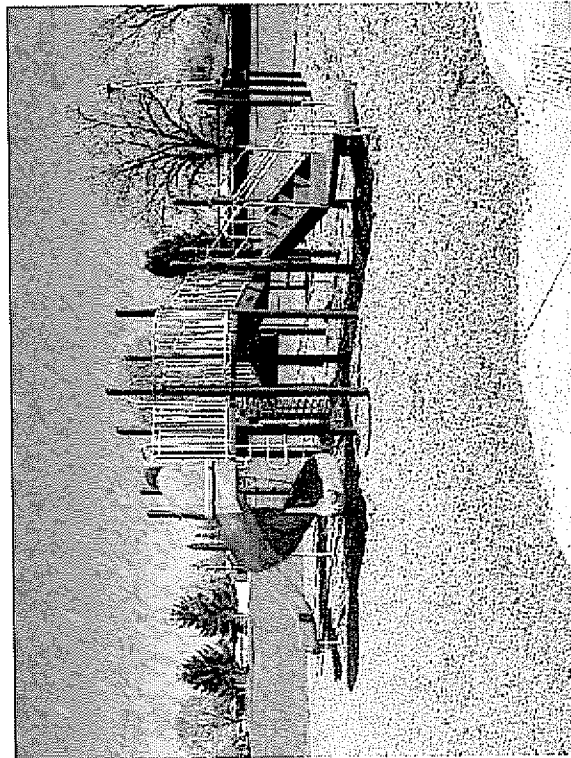

# 2006 RENAISSANCE PARK PROGRAM

## HOPKINS PARK

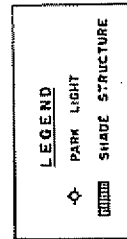
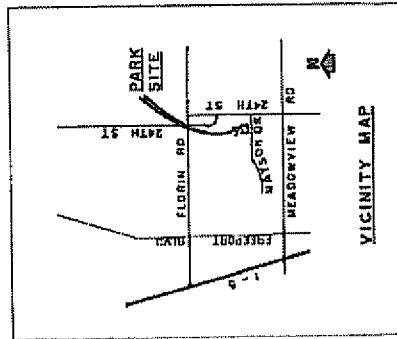
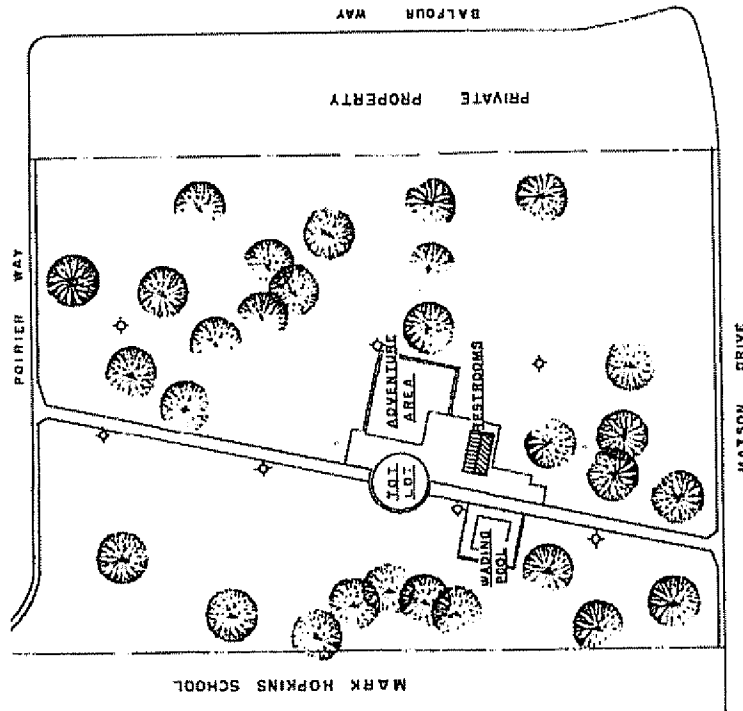

# 2006 RENAISSANCE PARK PROGRAM



## HOPKINS PARK

<p><b>HOPKINS PARK AMENITIES:</b></p> <p>(A) ART IN PUBLIC PLACES TRAIN SCULPTURE</p> <p>(B) ADDITIONAL CONCRETE WALKWAYS</p> <p>(C) PICNIC AREA INCLUDING: SHADE STRUCTURE (8) EIGHT PICNIC BENCHES (1) FOUR BARBEQUE GRILLS</p> <p>(D) BLOSSOMING PARK PLAZA</p> <p>(E) (2) TWO VOLLEYBALL COURTS</p> <p>(F) DRY CREEK BED</p> <p>(G) TIKI TRACK</p> <p>(H) ADDITIONAL LANDSCAPING</p> <p>(I) RIFARIAN AND NATIVE LANDSCAPING</p>	<p><b>HOPKINS PARK LEGEND:</b></p> <p>CONIFER</p> <p>DECIDUOUS</p> <p>OAK</p> <p>FLOWERING TREE</p> <p>EXISTING TREES</p> <p>BENCH</p> <p>PICNIC TABLE</p> <p>NATIVE GRASSES</p> <p>PROPERTY LINE</p> <p>HANDICAP RAMP</p> <p>EXISTING LIGHT</p> <p>EXISTING BACKFLOW PREVENTOR</p>	<p><b>PLAYGROUND AMENITIES:</b></p> <p>(J) ADDITIONAL SWINGS</p> <p>(K) GROUP SWINGS</p> <p>(L) MEGA STRUCTURE W/ TALL SLIDES AND NET STRUCTURE</p> <p>(M) RAILROAD AND TRAIN THEMED ADVENTURE AREA</p> <p>(N) POP SCOTCH AND FOUR SQUARE</p>
---	---	---

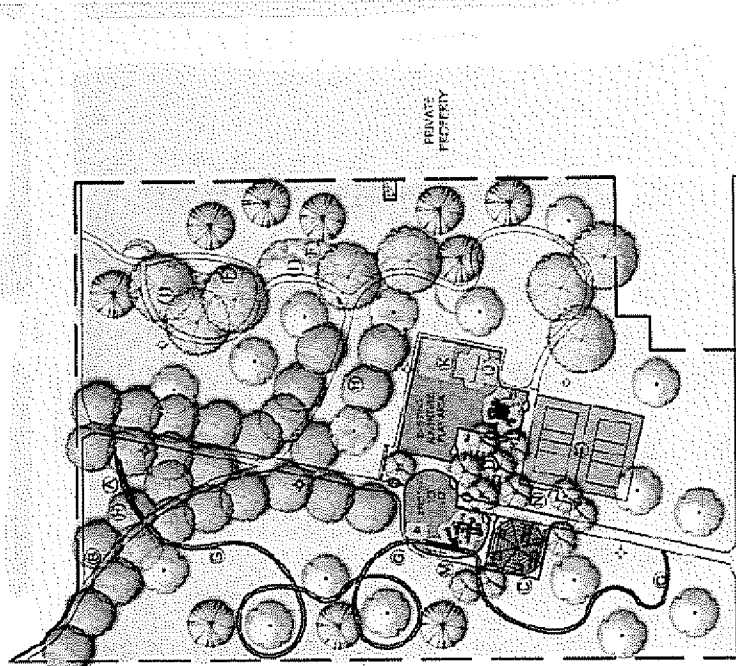

0 40 80 120 160 SCALE: 1"=40'

# 2006 RENAISSANCE PARK PROGRAM

## RICHARDSON VILLAGE PARK

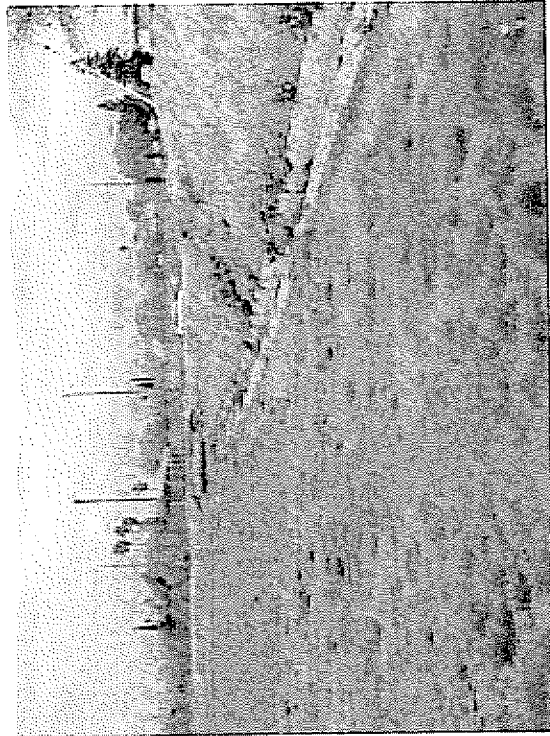
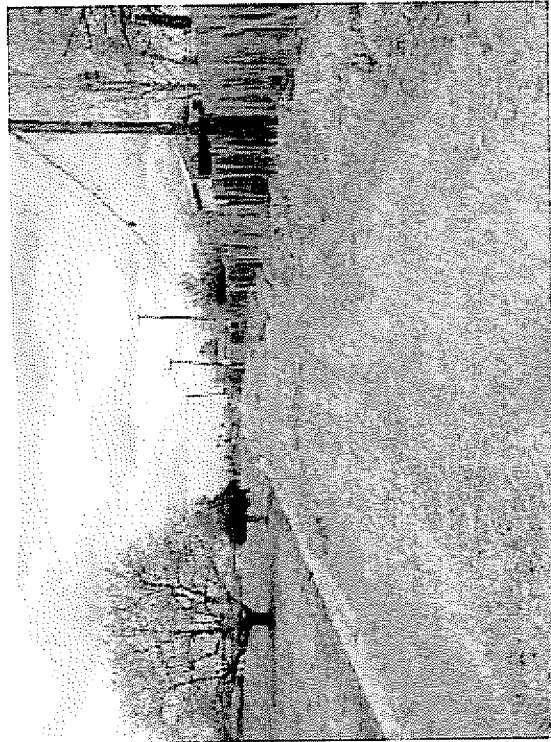

# 2006 RENAISSANCE PARK PROGRAM

## RICHARDSON VILLAGE PARK

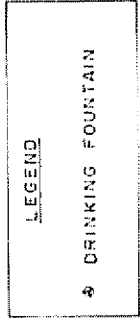
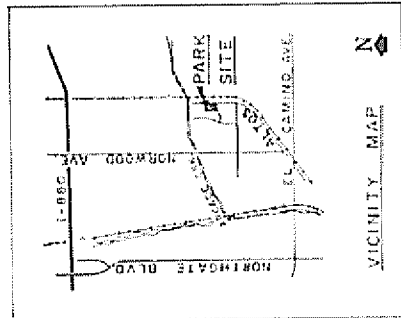
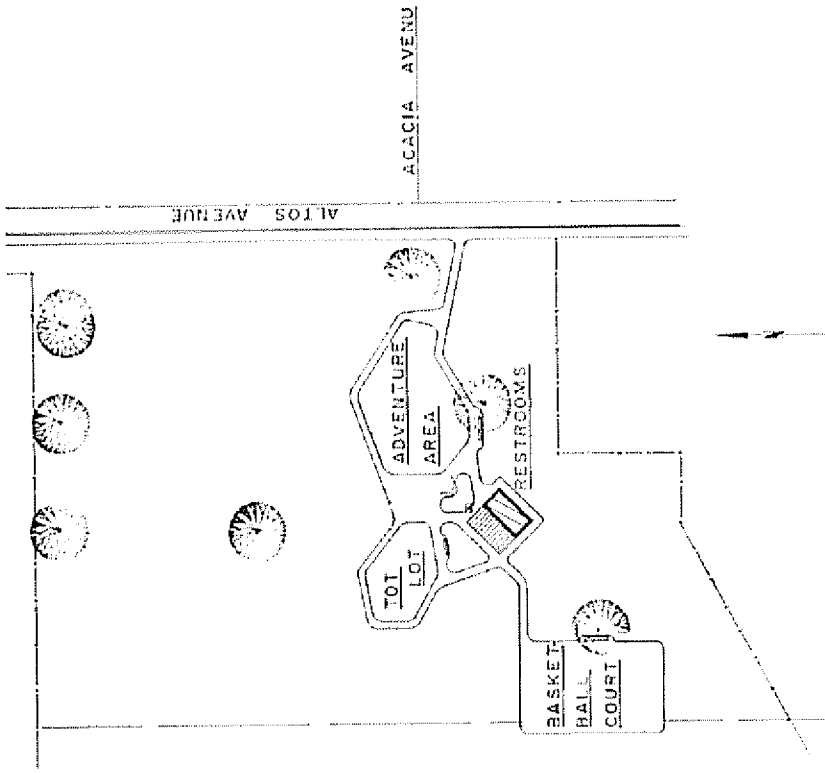

# 2006 RENAISSANCE PARK PROGRAM

## RICHARDSON VILLAGE PARK



Norte Del Rio  
Jr. High School

SONOMA AVE.

- D.G. Walking Trail
- Natural Area  
(Enhanced Drainage  
Overflow Area)
- Observation Deck  
& Interpretive Area
- Fabricat Pond

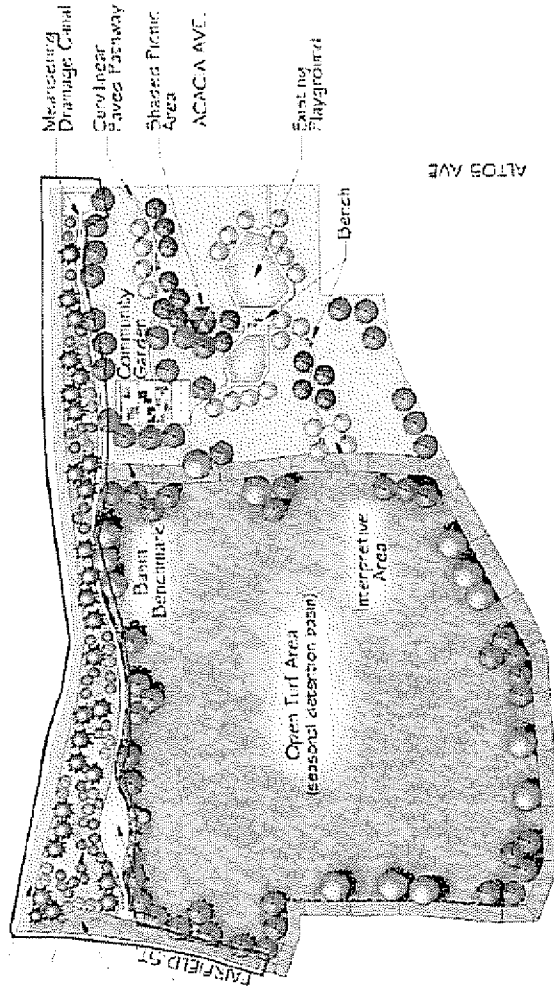

- Legends
- Shade Trees
  - Accent Trees
  - Proposed Phase I

Norrato  
Elementary School

SAGEHEN

RICHARDSON VILLAGE PARK REDEVELOPMENT  
SACRAMENTO, CA 95822



SCALE BAR: 1" = 100 FEET

**2006 RENAISSANCE PARK PROGRAM**

**VALLEY HI PARK**



# 2006 RENAISSANCE PARK PROGRAM

## VALLEY HI PARK

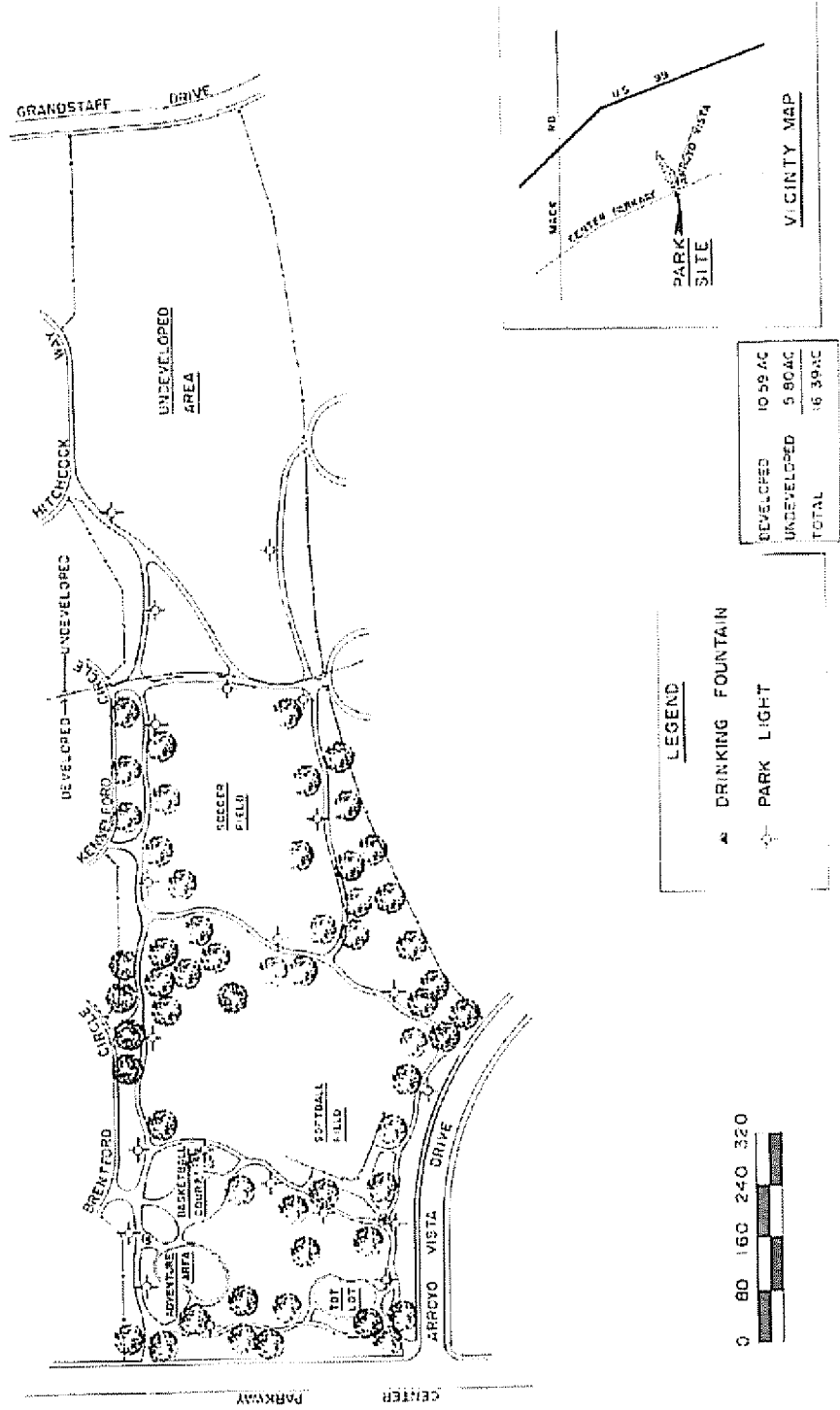

# 2006 RENAISSANCE PARK PROGRAM

## VALLEY HI PARK

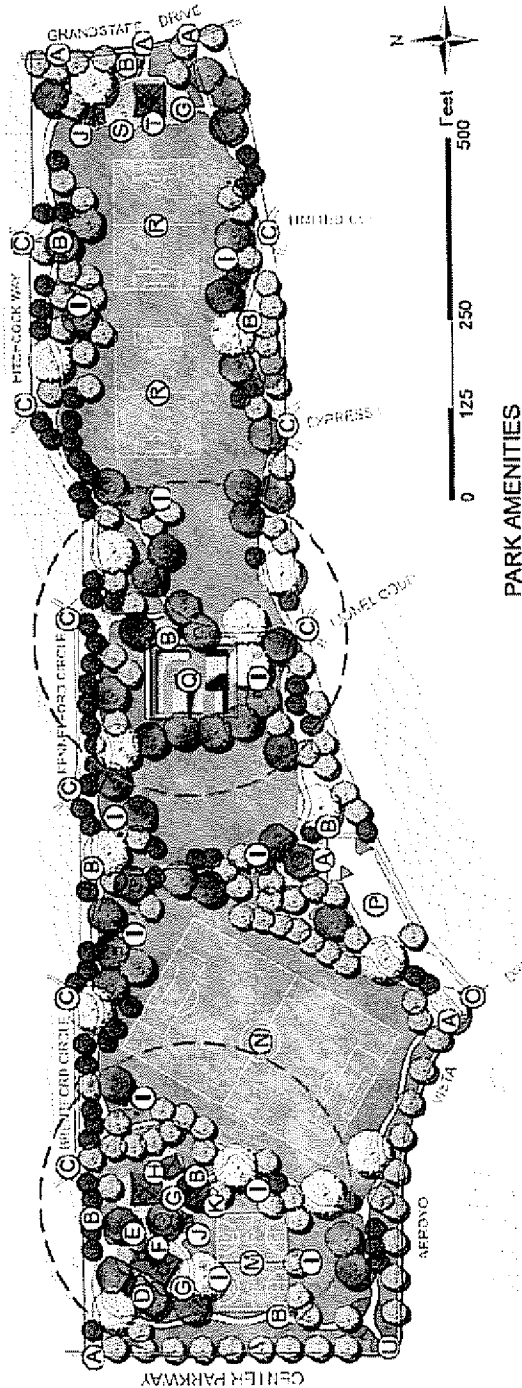

### PARK AMENITIES

- A - PEDESTRIAN PARK ACCESS
- B - BIKE RACK
- C - NEIGHBORHOOD ACCESS
- D - CUSTOM HILL SLIDE
- E - WATER SPRAY FEATURE
- F - COVERED ADVENTURE PLAY AREA
- G - RUBBERIZED SURFACE
- H - COVERED TOT LOT PLAY AREA
- I - PICNIC AREA
- J - COVERED PICNIC AREA
- K - RESTROOM WITH OUTDOOR SHOWERS
- M - BASKETBALL COURTS
- N - HIGH SCHOOL REGULATION SOCCER FIELD WITH LIGHTING
- O - VEHICLE ACCESS
- P - PARKING (28 SPACES) WITH TURNABOUT
- Q - SKATE PARK WITH LIGHTING
- R - BANTAM SOCCER FIELD
- S - CLIMBING WALL
- T - COVERED NET CLIMBING STRUCTURE
- U - DECORATIVE PARK ENTRANCE WITH SIGN
- NS - SENIOR FITNESS CIRCUIT
- NS - SAFETY LIGHTING
- NS - TRASH AND RECYCLE RECEPTACLES
- NS - SEATING
- NS - NOT SHOW

### LEGEND

- TURF
- LOW MAINTENANCE GROUND COVER AND SCREENING
- CONTOURS
- FREE WIRELESS INTERNET

16.39 ACRES

**2006 RENAISSANCE PARK PROGRAM**

**JOHNSTON PARK**



# 2006 RENAISSANCE PARK PROGRAM

## JOHNSTON PARK

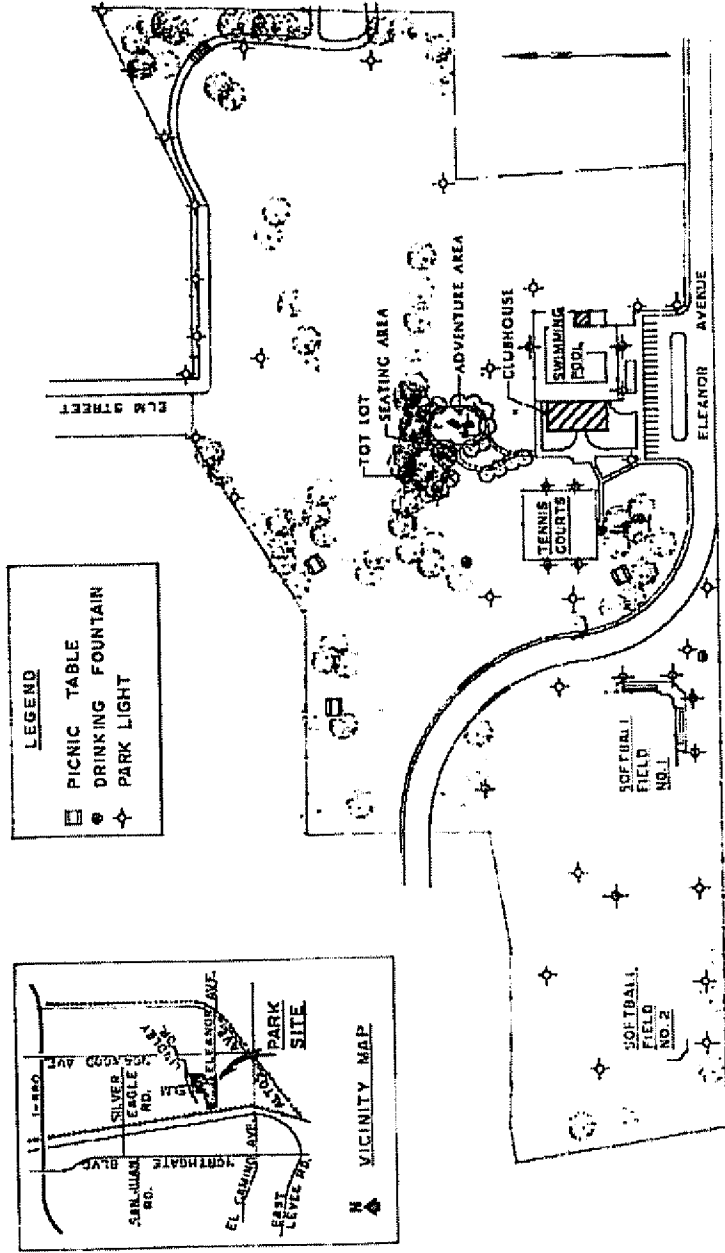

# 2006 RENAISSANCE PARK PROGRAM

## JOHNSTON PARK



### LOCATION MAP

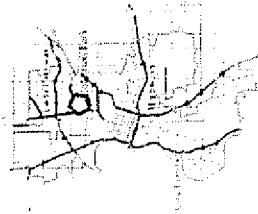

### KEY

- |   |  |
|---|--|
| <b>A</b> Existing Clubhouse and Pool                | <b>J</b> New Parking                           |
| <b>B</b> Basketball Courts                          | <b>K</b> New Street Access                     |
| <b>C</b> Softball, T-Hall, and Bantam Soccer Fields | <b>L</b> Bike Trail Connection to Ueda Parkway |
| <b>D</b> Picnic Areas                               | <b>M</b> Ueda Parkway Directional Sign         |
| <b>E</b> Community Garden                           | <b>S</b> Park Entry Sign                       |
| <b>F</b> Adventure Play Areas                       | Existing and New Solar Lights                  |
| <b>G</b> Tot Lot                                    | Existing Trees                                 |
| <b>H</b> Dog Jogging Path                           | New Trees                                      |
| <b>I</b> Perennial Wetland with Path and Signs      | Native Planting Areas                          |

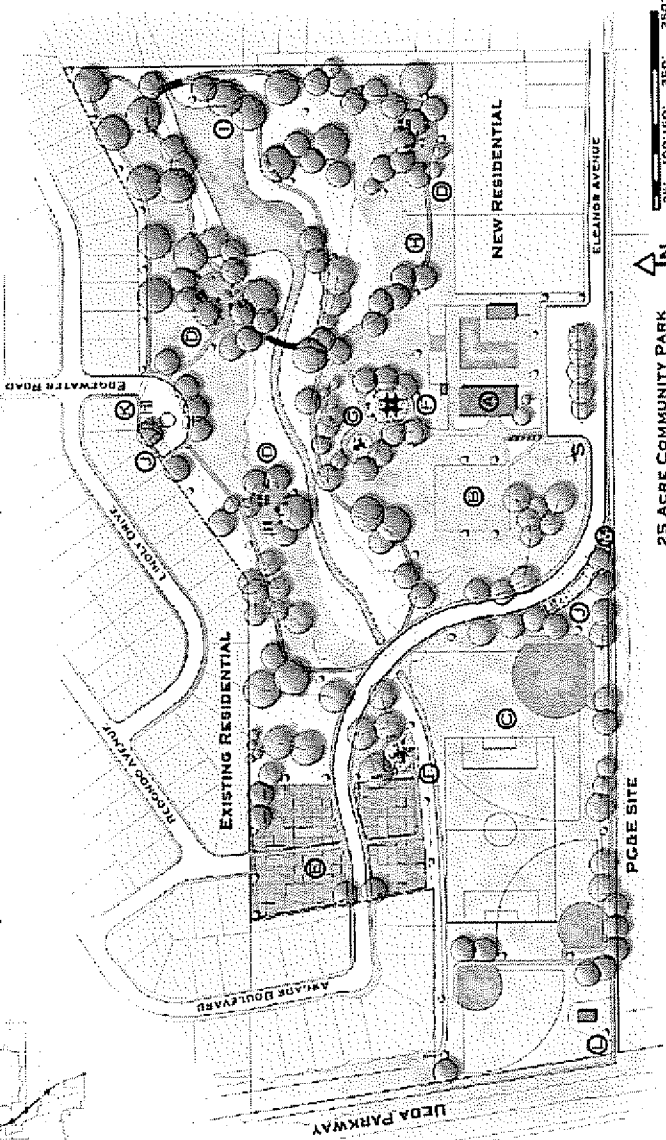



**2006 RENAISSANCE PARK PROGRAM**

**2006 RENAISSANCE PARK TOP PROJECT**

**JOHNSTON PARK**

**2006 Project Leads (LAS Interns):**

***Johnston Park – Julia Cox***

***Hopkins Park – Linsey Payne***

***Richardson Village Park – Chris Eng***

***Valley Hi Park – Andrew Haskin***

CITY OF SACRAMENTO



DEPARTMENT OF  
PARKS AND  
RECREATION

## **2006 RENAISSANCE PARK PROGRAM**

### **GOALS:**

- 1) Highlight underutilized facilities.**
- 2) Get new fresh "ideas" & updated plans.**
- 3) Provide for staff/intern development.**
- 4) Develop a "ready-made" master plan.**
- 5) Prepare for funding opportunities.**

**2006 RENAISSANCE PARK PROGRAM**

**Next Steps (Conceptual Plan Complete):**

**IDENTIFY FUNDING FOR THE FOLLOWING:**

- 1) Completion of the master plan.**
- 2) Assess available resources/feasibility.**
- 3) Attempt to find funding for projects:**
  - a) Capital Grant Opportunities**
  - b) Future Bond Funding (State or Local)**
  - c) Redevelopment Agency Funding**
  - d) Park Impact Fees or Quimby-In Lieu**



CITY OF SACRAMENTO

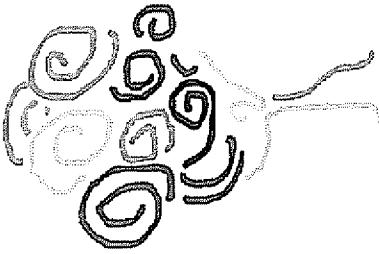

DEPARTMENT OF  
PARKS AND  
RECREATION

**2006**

# **RENAISSANCE PARK PROGRAM**