

**CITY OF SACRAMENTO**  
1231 I Street, Sacramento, CA 95814

**Permit No: 0013575**  
**Insp Area: 4**

**Site Address: 3745 BROADLAND ST SAC**  
Parcel No: 225-1430-015  
N

**NATOMAS CROSSING UNIT 22 LOT 15**  
Sub-Type: NSFR  
Housing (Y/N):

CONTRACTOR  
RYLAND HOMES  
1380 LEAD HILL BLVD. STE 108  
ROSEVILLE CA. 95661

OWNER

ARCHITECT

**Nature of Work: MP 2179 2 STORY 9 ROOM SFR**

**CONSTRUCTION LENDING AGENCY:** I hereby affirm under penalty of perjury that there is a construction lending agency for the performance of the work for which this permit is issued (Sec. 3097, Civ. C).

Lender's Name \_\_\_\_\_ Lender's Address \_\_\_\_\_

**LICENSED CONTRACTORS DECLARATION:** I hereby affirm under penalty of perjury that I am licensed under provisions of Chapter 9 (commencing with section 7000) of Division 3 of the Business and Professions Code and my license is in full force and effect.

License Class B License Number 54648 Date 11-17-00 Contractor Signature [Signature]

**OWNER-BUILDER DECLARATION:** I hereby affirm under penalty of perjury that I am exempt from the contractors License Law for the following reason (Sec. 7031.5, Business and Professions Code, any city or county which requires a permit to construct, alter, improve, demolish, or repair any structure, prior to its issuance, also requires the applicant for such permit to file a signed statement that he or she is licensed pursuant to the provisions of the Contractors License Law (Chapter 9 (commencing with Section 7000) of Division 8 of the Business and Professions Code) or that he or she is exempt therefrom and the basis for the alleged exemption. Any violation of Section 7031.5 by any applicant for a permit subjects the applicant to a civil penalty of not more than five hundred dollars (\$500.00):

I, as a owner of the property, or my employees with wages as their sole compensation, will do the work, and the structure is not intended or offered for sale (Sec. 7044, Business and Professional Code. The Contractors License Law does not apply to an owner of property who builds or improves thereon, and who does such work himself or herself or through his/her own employees, provided that such improvements are not intended or offered for sale. If, however, the building or improvement is sold within one year of completion, the owner-builder will have the burden of proving that he/she did not build or improve for the purpose of sale.)

I, as owner of the property, am exclusively contracting with licensed contractors to complete this project (Sec. 7044, Business and Professions Code). The Contractors License Law does not apply to an owner of property who builds or improves thereon, and who contracts for such projects with a contractor(s) licensed pursuant to the Contractors License Law.

I am exempt under Sec. \_\_\_\_\_ B & PC for this reason: \_\_\_\_\_

Date \_\_\_\_\_ Owner Signature [Signature]

**IN ISSUING THIS BUILDING PERMIT,** the applicant represents, and the city relies on the representation of the applicant, that the applicant verified all measurements and locations shown on the application or accompanying drawings and that the improvement to be constructed does not violate any law or private agreement relating to permissible or prohibited locations for such improvements. This building permit does not authorize any illegal location of any improvement or the violation of any private agreement relating to location of improvements.

I certify that I have read this application and state that all information is correct. I agree to comply with all city and county ordinances and state laws relating to building construction and hereby authorize representative(s) of this city to enter upon the abovementioned property for inspection purposes.

Date 11-17-00 Applicant/Agent Signature [Signature]

**WORKER'S COMPENSATION DECLARATION:** I hereby affirm under penalty of perjury one of the following declarations:

I have and will maintain a certificate of consent to self-insure for workers' compensation as provided for by Section 3700 of the Labor Code, for the performance of work for which the permit is issued

I have and will maintain workers' compensation insurance, as required by Section 3700 of the Labor Code, for the performance of the work for which this permit is issued. My workers' compensation insurance carrier and policy number are:

Carrier AMERICAN PROTECTION Policy Number 4BR003219-01 Exp Date 06/01/2001

(This section need not be completed if the permit is for \$100 or less) I certify that in the performance of the work for which this permit is issued, I shall not employ any person in any manner so as to become subject to the workers' compensation laws of California and agree that if I should become subject to the workers' compensation provisions of Section 3700 of the Labor Code, I shall forthwith comply with those provisions.

Date 11-17-00 Applicant Signature [Signature]

**WARNING: FAILURE TO SECURE WORKER'S COMPENSATION COVERAGE IS UNLAWFUL AND SHALL SUBJECT AN EMPLOYER TO CRIMINAL PENALTIES AND CIVIL FINES UP TO ONE HUNDRED THOUSAND DOLLARS (\$100,000) IN ADDITION TO THE COST OF COMPENSATION, DAMAGES AS PROVIDED FOR IN SECTION 3706 OF THE LABOR CODE, INTEREST AND ATTORNEY'S FEE.**

**THIS PERMIT SHALL EXPIRE BY LIMITATION IF WORK IS NOT COMMENCED WITHIN 180 DAYS.**

RESIDENTIAL SUBDIVISION BUILDING PERMIT 13575 117

Project Address: 3745 BROADLAND ST. Assessor Parcel # \_\_\_\_\_  
Lot Number: 115 Subdivision Natomas Crossing Unit# 22

**OWNER INFORMATION:**

Legal Property Owner: Ryland Homes Phone# 784-1330#14  
Owner Address: 1380 Lead Hill Rd. City Roseville State CA Zip 95661

**CONTRACTOR INFORMATION:**

Contractor: Ryland Homes Lic. # 54648 Phone # 784-1330#14 Fax 784-9805

**PROJECT INFORMATION:** Plan Three MP 2179

Land Use Zone RIA Occupancy Group R3 Construction Type VN Fed Code 1A  
No. of Stories: 2 No. of Rooms: 10 Street Width: 41'  
1<sup>st</sup> Floor Area 1097 2<sup>nd</sup> Floor Area 1082 Basement \_\_\_\_\_ Roof Material Tile  
AREA IN SQUARE FOOT OF:  
Dwelling/Living 2179  
Garage/Storage 581  
Decks/Balconies \_\_\_\_\_  
Carports \_\_\_\_\_

SCOPE OF WORK: SFD.

FOR OFFICE USE ONLY

- Information Above Complete
- Violation Files Checked
- Standard Setbacks
- County Sewer
- AR Flood Waiver Required
- Flood Elevation Certificate Required
- Water Development Infill Area
- Planning Approval
- Design Review Approval
- Special Fee Districts Apply:

**~THE FOLLOWING MUST BE PROVIDED IN ORDER TO SUBMIT FOR PERMIT~**

- 2 COMPLETE PLOT PLANS, LEGIBLE & DRAWN TO SCALE
- 11 X 17 COPY OF FLOOR PLAN WITH FOLLOWING INFORMATION
  - a) Assessor's Parcel Number
  - b) New Floor Area
  - c) Owners Name
  - d) Project Address

Date: \_\_\_\_\_ Received by: (staff) \_\_\_\_\_ Permit # \_\_\_\_\_



# WesPac

## insulation

— MASCO Company



809 North Market Blvd. Ste. 11 • Sacramento, CA 95834

916) 927-7149 • Fax (916) 927-4257

Lic. #487478

### Installed Insulation Certificate

We certify that the building insulation listed herein is installed in conformance with current energy conservation regulations, California Administrative Code, Title 24, State of California

RECTOR	AREA	TYPE	INCHES/BAGS (BLOWN)
--------	------	------	---------------------

Certified by

Address or Lot Number

Title

SECRETARY

Date Installed

115

Natomas Unified School District  
1515 Sports Drive, #1 • Sacramento, CA 95834-1905  
Phone 916/641-3300 • Fax 916/928-1629

**CERTIFICATION OF COMPLIANCE**  
**SCHOOL DISTRICT DEVELOPMENT FEES**

**PART I: TO BE COMPLETED BY APPLICANT**

Property Owner's Name	Ryland Homes		
Owner's Address	1380 Lead Hill Rd #108 Roseville, CA 95661		
Project Address	3745 BROADLAND ST		
Parcel Number			
Subdivision Name	Natomas Crossing Unit# 22		
Number of Units	ONE		
Print Applicant's Name	Linda Steinfeldt	Applicant's Signature	
Title of Applicant	Subdivision Manager		
Date	11-8-00	Telephone Number	916-764-1330 X14

**PART II: TO BE COMPLETED BY BUILDING DEPARTMENT**

Plan Identification Number	2179		
Building Type (Check One)	<input checked="" type="checkbox"/> Residential <input type="checkbox"/> Apartment/Condominium <input type="checkbox"/> Commercial/Industrial		
Square Feet of Chargeable Building Area	2179		
Signature			
Title	Contractor	Date	11/15/00

**PART III: TO BE COMPLETED BY NATOMAS UNIFIED SCHOOL DISTRICT**

District Certification Number	01-762				
Fees Collected:					
Residential:	2179	Sq. Ft. X \$	3.25	= \$	7081.75
Apartment/Condominium:		Sq. Ft. X \$		= \$	
Commercial/Industrial:		Sq. Ft. X \$		= \$	

**NOTICE TO APPLICANT:** Pursuant to government code section 66020 (d), this will serve to notify you that the 90-day approval period in which you may protest the fees, or other payment identified above, will begin to run on the date in which the building or installation permit for this project is issued, or on which they are paid to the District, or to another public entity authorized to collect them on behalf of the District, whichever is earlier.

Applicant Signature: Date: 11-16-00

This certification covers only the amount of square footage indicated above. Any additions or corrections to the square footage for this project will require an amendment to the Certificate of Compliance.

As the authorize Natomas Unified School District official, I hereby certify that the requirements of Government Code Section 95995 have been complied with by the above signed applicant.

SIGNATURE: DATE: 11/15/00  
TITLE: A.T.R.

COUNTY SANITATION DISTRICT NO. 1  
 SACRAMENTO REGIONAL COUNTY SANITATION DISTRICT  
**SEWER IMPACT FEE** *EFB*  
 PERMIT AND CALCULATION SHEET *11-14-00*

APPLICATION NO:  
 GENERAL INFORMATION

BLDG PERMIT NO: *0177*

THIS PERMIT GOOD ONLY WHEN  
 VALIDATED BY THE CASHIER

*265017 EFB*

*11-14-00*

THIS PERMIT TO CONNECT EXPIRES  
 ONE YEAR FROM DATE OF ISSUANCE

FEE CALCULATION

BUILDING USE

INSPECTION	RESIDENTIAL	SF	MF	UNITS
CSD-1		473	<input checked="" type="checkbox"/>	
SRCSD		2404	<input type="checkbox"/>	
CONSTRUCTION				
IN-LIEU				
<b>TOTAL FEE</b>		<b>2877</b>		

APN: 225-1250-023

DESCRIPTION/  
 SUBDIVISION: Natomas Crossing Unit 22, LOT *115*

PROPERTY ADDRESS: *3745 Goodwood St*  
 OWNER: Ryland Homes

MAILING ADDRESS: 1380 Lead Hill Rd. #108

CITY/STATE/ZIP: Roseville, CA PHONE: 6-784-1330#14

ADDITIONAL FEES MAY BE DUE IF CHANGES IN USE INCREASE SEWER IMPACT

APPLICANT SIGNATURE: Linda Steinfeldt

*[Signature]*

CONSOLIDATED UTILITY BILLING USE ONLY

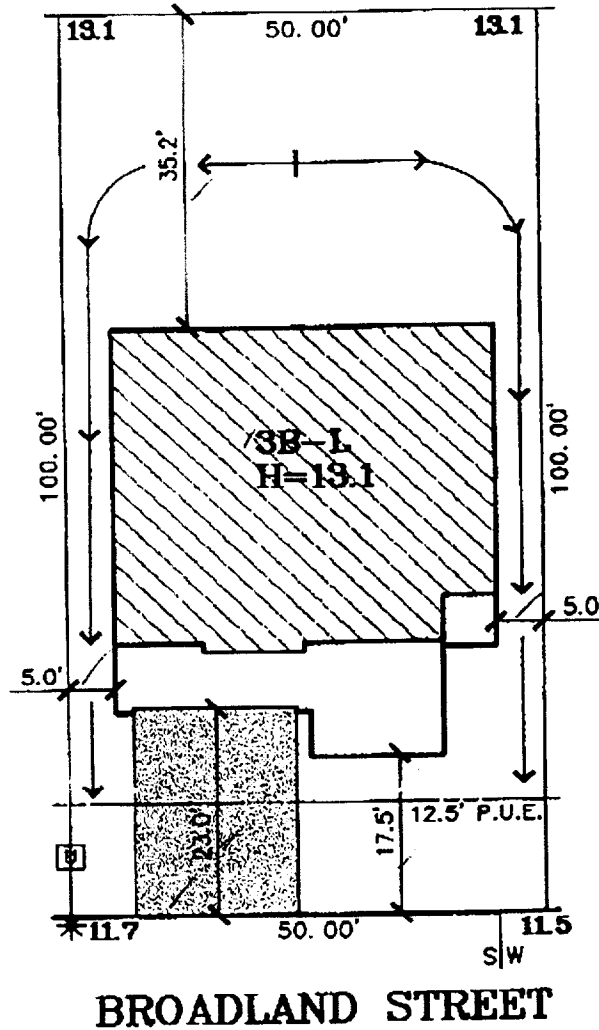

This set of plans and specifications shall be kept on the job at all times and shall be subject to inspection by the City Engineer to make any corrections.

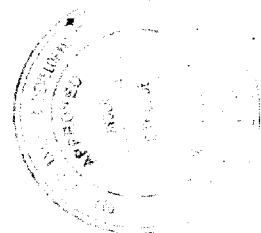

**LEGEND**

- PUBLIC UTILITY EASEMENT
- S SEWER SERVICE
- W WATER SERVICE
- U UTILITY BOX
- \* STREET LIGHT
- I DRAIN INLET
- H FIRE HYDRANT

DATE: 11-2-00  
 LOT AREA: 5,000 SF  
 LOT COVERAGE: 28%

THIS PLAN IS PREPARED TO SHOW THE DIMENSIONAL RELATIONSHIP FROM BUILDING FOUNDATION TO PROPERTY LINE, DESIGN DRAINAGE CONTROL ELEVATIONS, AND DIRECTION OF DRAINAGE FLOW TO CONFORM WITH LOCAL ORDINANCES FOR THE PURPOSE OF BUILDING PERMIT ISSUANCE. INFORMATION SHOWN IS APPROXIMATE EXCEPT FOR THOSE SETBACKS WHICH ARE MINIMUMS REQUIRED BY ORDINANCE. THIS PLOT PLAN DOES NOT REFLECT AS BUILT CONDITIONS WHICH WILL LIKELY VARY FROM THIS PLAN.

**The Splink Corporation**  
 2590 VENTURE OAKS WAY  
 SACRAMENTO, CA 95833  
 PH: (916) 925-5550 FAX: (916) 921-9274

**NATOMAS CROSSING  
 VILLAGE 22**  
 3745 BROADLAND ST.  
 A.P.N.:  
 LOT 15  
 PLAN 3B

**RYLAND HERITAGE**  
 CITY OF SACRAMENTO, CA.  
 CLIENT: RYLAND HOMES  
 CONTACT: LINDA STEINFELDT  
 PHONE: 916-784-1330  
 JOB NO.: 7684-003