



3.24

**DEPARTMENT OF PARKS  
AND COMMUNITY SERVICES**

ROBERT P. THOMAS  
DIRECTOR

G. ERLING LINGGI  
ASSISTANT DIRECTOR

WALTER S. UEDA  
DEPUTY DIRECTOR

City Council  
Sacramento, California

Honorable Members in Session:

**SUBJECT: Ratification of the Negative Declaration for Mesa Grande Park Phase II (LG56)**

**CITY OF SACRAMENTO**  
CALIFORNIA

February 26, 1991

**APPROVED**  
BY THE CITY COUNCIL

FEB 26 1991

OFFICE OF THE  
CITY CLERK

1231 I STREET  
SUITE 400  
SACRAMENTO, CA  
95814-2977

916-449-5200  
FAX 916-449-8584

DIVISIONS:  
GOLF  
CROCKER ART MUSEUM  
HISTORY AND SCIENCE  
METROPOLITAN ARTS  
SACRAMENTO ZOO  
PARKS AND RECREATION  
• NORTH  
• SOUTH  
• CITY-WIDE

**SUMMARY**

This report recommends ratification of the Negative Declaration, approval of the project, and authorization to file a Notice of Determination for construction of Mesa Grande Park Phase II, located in the Valley Hi area of South Sacramento, at the intersection of Valley Hi Drive and La Coruna Drive.

**BACKGROUND**

The project site is an existing six acre neighborhood park constructed in the summer/fall of 1989, in accordance with the 1989 Parks Master Plan and the 1986-2006 City General Plan. Park amenities constructed during the first phase of development in 1989 include an adventure playground, a jogging trail, a seating plaza, concrete entry walks, and landscaping of the entire site (Exhibit A). Following two community meetings held in April and October of 1990, the proposed development for Phase II construction was decided upon. The proposed development for Phase II construction consists of the following: the construction of a tot lot, a loop concrete walk, fitness course stations, picnic tables, and an earth mound sculpture, as well as the planting of additional trees, and performing irrigation and drainage modifications (Exhibit A).

In accordance with the State Guidelines for implementation of the California Environmental Quality Act of 1970, an Initial Study was performed dated December 3, 1990. As a result of this study, it was determined that the construction of Mesa Grande Park Phase II would not have a significant adverse effect on the physical environment, and a Draft Negative Declaration was prepared.

On December 28, 1990, a notice of intent to prepare the Negative Declaration was filed with the County Clerk. A Notice of Opportunity for public review of the Draft Negative Declaration (Exhibit B) was published in a local newspaper. The appropriate length of time has elapsed for comments regarding the Negative Declaration with no comments having been received.

FINANCIAL DATA

Funding in the amount of \$150,000 for the Mesa Grande Park Phase II project (LG56) was appropriated in the FY 1989-90 Capital Improvement Program from the Quimby Fund.

POLICY CONSIDERATIONS

Environmental assessment and review for this project was conducted consistent with CEQA requirements.

MBE/WBE EFFORTS

Every effort is made to support the City's MBE/WBE goals.

RECOMMENDATION

The Environmental Services Manager and the Parks and Community Services Director recommend that City Council approve the attached resolution to:

1. Determine that the proposed project will not have a significant adverse effect on the environment.
2. Ratify the Negative Declaration;
3. Approve the Mesa Grande Park Phase II project design; and
4. Authorize the Environmental Services Manager to file a Notice of Determination with the County Clerk.

Respectfully submitted,



Robert P. Thomas, Director  
Parks and Community Services

Recommendation Approved:

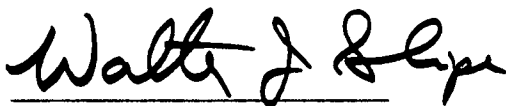

Walter J. Slipe  
City Manager

Contact Person: Michele Rudek, Landscape Architect - 449-8254

February 26, 1991  
District No. 7

RPT:mm:ja

K:Council/mmr Mesa2.dox

**RESOLUTION NO. 91-154**

ADOPTED BY THE SACRAMENTO CITY COUNCIL

ON DATE OF \_\_\_\_\_

RESOLUTION RATIFYING A NEGATIVE DECLARATION AND APPROVING PROJECT FOR MESA GRANDE PARK PHASE II (LG56)

**APPROVED**  
BY THE CITY COUNCIL  
FEB 26 1991  
OFFICE OF THE  
CITY CLERK

WHEREAS, the prescribed time for receiving appeals on the Negative Declaration has elapsed, and no appeals were received.

NOW, THEREFORE, BE IT RESOLVED BY THE COUNCIL OF THE CITY OF SACRAMENTO:

1. That the proposed project, construction of Mesa Grande Park Phase II, will not have a significant adverse effect on the environment;
2. That the Negative Declaration for the above referenced project is hereby approved;
3. That the Mesa Grande Park Phase II project design is approved; and
4. That the Environmental Services Manager is authorized to file with the County Clerk a Notice of Determination for said project.

\_\_\_\_\_  
MAYOR

ATTEST:

\_\_\_\_\_  
CITY CLERK

**FOR CITY CLERK USE ONLY**

RESOLUTION NO.: \_\_\_\_\_

DATE ADOPTED: \_\_\_\_\_ 3

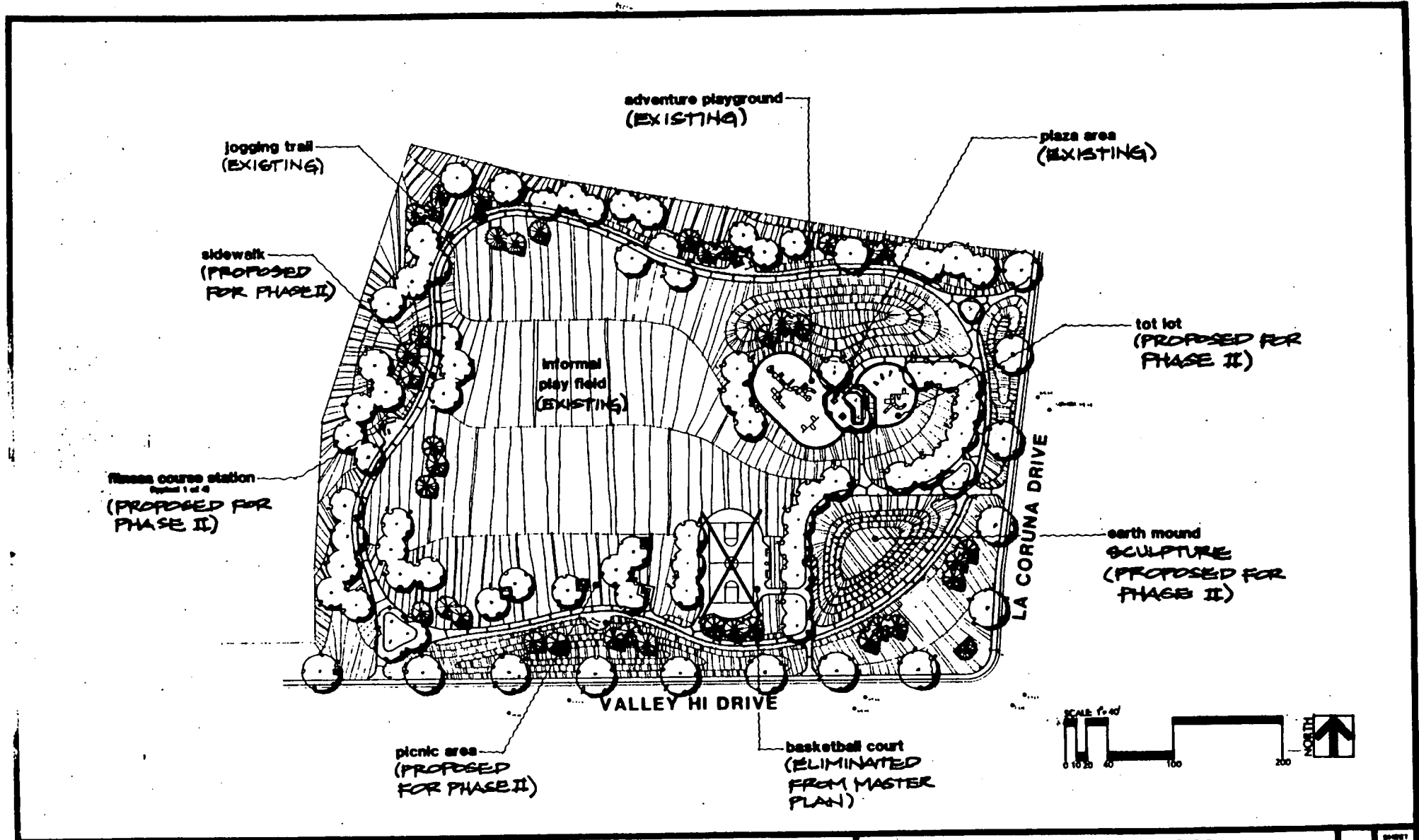

EXHIBIT A

REVISIONS	NO	DESCRIPTION	DATE BY

DRAWN BY G.M.L. MOR  
 DESIGNED BY G.M.L. MOR  
 LANDSCAPE ARCHITECT MOR  
 DATE 2-18-88  
 FIELD BOOK \_\_\_\_\_ SCALE 1"=40'

**CITY OF SACRAMENTO**  
 DEPARTMENT OF PARKS & COMMUNITY SERVICES



**MASTER PLAN**  
**MESA GRANDE PARK**

SHEET  
 1/1  
 SHEETS





DEPARTMENT OF  
PLANNING AND DEVELOPMENT

CITY OF SACRAMENTO  
CALIFORNIA

1231 I STREET  
ROOM 200  
SACRAMENTO, CA  
95814-2998

BUILDING INSPECTIONS  
916-449-5716

PLANNING  
916-449-5604

**NEGATIVE DECLARATION**

The Environmental Services Manager of the City of Sacramento, California, a municipal corporation, does prepare, make, declare, and publish this Negative Declaration for the following described project:

The City of Sacramento, Department of Planning and Development, Environmental Services Division has reviewed the proposed project and has determined that the project as proposed will not have a significant effect on the environment. This conclusion is based on information contained in the attached Initial Study.

An Environmental Impact Report is not required pursuant to the Environmental Quality Act of 1970 (Division 13 of the Public Resources Code of the State of California).

This environmental review process and Negative Declaration filing is pursuant to Title 14, Division 6, Chapter 3, Article 6, Section 15070 of the California Administrative Code and pursuant to the Sacramento Local Environmental Regulations (Resolution 78-171) adopted by the City of Sacramento and pursuant to Sacramento City Code, Chapter 63.

A copy of this document may be reviewed/obtained at the City of Sacramento, Department of Planning and Development, Environmental Services Division, 1231 I Street, 3rd Floor, Sacramento, California 95814.

Environmental Services Manager of the  
City of Sacramento, California,  
a municipal corporation

By: Carol Z. Branan

attachment  
rev. 1/90  
form.7

LG56



# CITY OF SACRAMENTO

## INITIAL STUDY

This Initial Study has been required and prepared by the Department of Planning and Development, Planning Division, Environmental Section, 1231 I Street, Suite 300, Sacramento, CA 95814, (916)449-2037, pursuant to CEQA Guidelines Section 15063 (August 1, 1983).

File No. and/or Project Name: CIP-LG56 - Mesa Grande Park (Phase II)  
Applicant - Name: City of Sacramento - Parks & Comm. Services  
Address: 1231 I Street, Rm 400  
Sacto CA 95814

Answer the following questions to determine if the proposed project may have potentially adverse significant impacts on the environment.

- |   | <u>Yes or No</u> |
|---|------------------|
| 1. <u>Earth</u> . Will the proposal result in:  |                  |
| a. Unstable earth conditions or in changes in geologic substructures?   | <u>NO</u>        |
| b. Disruptions, displacements, compaction or overcovering of the soil?  | <u>NO</u>        |
| c. Change in topography or ground surface relief features?  | <u>NO</u>        |
| d. The destruction, covering or modification of any unique geologic or physical features?   | <u>NO</u>        |
| e. Any increase in wind or water erosion of soils, either on or off the site?   | <u>NO</u>        |
| f. Changes in deposition or erosion of beach sands, or changes in siltation, deposition or erosion which may modify the channel of a river, stream, bay, inlet or lake? | <u>NO</u>        |
| g. Exposure of people or property to geologic hazards such as earthquakes, ground failure, or similar hazards?  | <u>NO</u>        |
| 2. <u>Air</u> . Will the proposal result in:  |                  |
| a. Substantial air emissions or deterioration of ambient air quality?   | <u>NO</u>        |
| b. The creation of objectionable odors?   | <u>NO</u>        |
| c. Alteration of air movement, moisture or temperature, or any change in climate, either locally or regionally?   | <u>NO</u>        |
| 3. <u>Water</u> . Will the proposal result in:  |                  |
| a. Changes in currents, or the course of direction movements, in either marine or fresh waters?   | <u>NO</u>        |
| b. Changes in absorption rates, drainage patterns, or the rate and amount of surface runoff?  | <u>NO</u>        |
| c. Alterations to the course of flow of flood waters?   | <u>NO</u>        |
| d. Change in the amount of surface water in any water body?   | <u>NO</u>        |
| e. Discharge into surface waters, or in any alteration of surface water quality, including but not limited to temperature, dissolved oxygen or turbidity?               | <u>NO</u>        |
| f. Alteration of the direction or rate of flow of ground waters?  | <u>NO</u>        |
| g. Change in the quantity of ground waters, either through direct additions or withdrawals, or through interception of an aquifer by cuts or excavations?               | <u>NO</u>        |
| h. Substantial reduction in the amount of water otherwise available for public water supplies?  | <u>NO</u>        |
| i. Exposure of people or property to water related hazards such as flooding?  | <u>YES</u>       |
| 4. <u>Plant Life</u> . Will the proposal result in:   |                  |
| a. Change in the diversity of species, or number of any species of plants?  | <u>NO</u>        |
| b. Reduction of the numbers of any unique, rare or endangered species of plants?  | <u>NO</u>        |
| c. Introduction of new species of plants into an area, or in a barrier to the normal replenishment of existing species?   | <u>NO</u>        |
| d. Reduction in acreage of any agricultural crop?   | <u>NO</u>        |
| 5. <u>Animal Life</u> . Will the proposal result in:  |                  |
| a. Change in the diversity of species, or number of any species of animals?   | <u>NO</u>        |
| b. Reduction of the numbers of any unique, rare or endangered species of animals?   | <u>NO</u>        |
| c. Introduction of new species of animals into an area, or result in a barrier to the migration or movement of animals?   | <u>NO</u>        |
| d. Deterioration of existing fish or wildlife habitat?  | <u>NO</u>        |

Yes or No

6. Noise. Will the proposal result in:
  - a. Increases in existing noise levels? NO
  - b. Exposure of people to severe noise levels? NO
7. Light and Glare. Will the proposal produce new light or glare? NO
8. Land Use. Will the proposal result in a substantial alteration of the present or planned land use of an area? YES
9. Natural Resources. Will the proposal result in:
  - a. Increase in the rate of use of any natural resources? NO
  - b. Substantial depletion of any nonrenewable natural resource? NO
10. Risk of Upset. Does the proposal involve:
  - a. A risk of an explosion or the release of hazardous substances (including, but not limited to, oil, pesticides, chemicals or radiation) in the event of an accident or upset conditions? NO
  - b. Possible interference with an emergency response plan or an emergency evacuation plan? NO
11. Population. Will the proposal alter the location, distribution, density, or growth rate of the human population of an area? NO
12. Housing. Will the proposal affect existing housing, or create a demand for additional housing? NO
13. Transportation/Circulation. Will the proposal result in:
  - a. Generation of substantial additional vehicular movement? NO
  - b. Effects on existing parking facilities, or demand for new parking? NO
  - c. Substantial impact upon existing transportation systems? NO
  - d. Alterations to present patterns of circulation or movement of people and/or goods? NO
  - e. Alterations to waterborne, rail or air traffic? NO
  - f. Increase in traffic hazards to motor vehicles, bicyclists or pedestrians? NO
14. Public Services. Will the proposal have an effect upon, or result in need for new or altered governmental services in any of the following areas:
  - a. Fire protection? NO
  - b. Police protection? NO
  - c. Schools? NO
  - d. Parks or other recreational facilities? NO
  - e. Maintenance of public facilities, including roads? NO
  - f. Other governmental services? NO
15. Energy. Will the proposal result in:
  - a. Use of substantial amounts of fuel or energy? NO
  - b. Substantial increase in demand upon existing sources of energy or require the development of new sources of energy? NO
16. Utilities. Will the proposal result in a need for new system, or substantial alterations to the following utilities:
  - a. Power or natural gas? NO
  - b. Communications systems? NO
  - c. Water? NO
  - d. Sewer or septic tanks? NO
  - e. Storm water drainage? NO
  - f. Solid waste and disposal? NO

Yes or No

- 17. Human Health. Will the proposal result in:
  - a. Creation of any health hazard or potential health hazard (excluding mental health)? NO
  - b. Exposure of people to potential health hazards? NO
  
- 18. Aesthetics. Will the proposal result in the obstruction of any scenic or view open to the public, or will the proposal result in the creation of an aesthetically offensive site open to public view? NO
  
- 19. Recreation. Will the proposal result in an impact upon the quality or quantity of existing recreational opportunities? NO
  
- 20. Cultural Resources.
  - a. Will the proposal result in the alteration or destruction of a prehistoric or historic archaeological site? NO
  - b. Will the proposal result in adverse physical or aesthetic effects to a prehistoric or historic building, structure or object? NO
  - c. Does the proposal have the potential to cause a physical change which would affect unique ethnic cultural values? NO
  - d. Will the proposal restrict existing religious or sacred uses within the potential impact area? NO
  
- 21. Mandatory Findings of Significance.
  - a. Does the project have the potential to degrade the quality to the environment, substantially reduce the habitat of a fish or wildlife population to drop below self-sustaining levels, threaten to eliminate a plant or animal community, reduce the number or restrict the range of a rare or endangered plant or animal or eliminate important examples of the major periods of California history or prehistory? NO
  - b. Does the project have the potential to achieve short-term, to the disadvantage of long-term, environmental goals? (A short-term impact on the environment is one which occurs in a relatively brief, definitive period of time while long-term impacts will endure well into the future.) NO
  - c. Does the project have impacts which are individually limited, but cumulatively considerable? (A project may impact on two or more separate resources where the impact on each resource is relatively small, but where the effect of the total of those impacts on the environment is significant.) NO
  - d. Does the project have environment effects which will cause substantial adverse effects on human beings, either directly or indirectly? NO

MITIGATION MEASURES

- None required.
- The following mitigation measures shall become conditions of approval for the subject proposal:



CONCLUSION

The proposed project will not have a significant adverse effect on the environment for the following reasons:

1. Will have only temporary or short-term construction impacts such as dust and equipment emissions, noise and truck traffic.
2. Will not generate a significant amount of additional vehicles, noise or emission levels.
3. Will not affect rare or endangered species of animal or plant, or habitat of such species.
4. Will not eliminate important examples of major periods of California history or prehistory.
5. Will not result in a significant effect on air, water quality or ambient noise levels for adjoining areas.
6. Will not be subjected to floodplains or major geologic hazards.
7. Will not have a substantial aesthetic affect.
8. Will not breach any published national, State or local standards relating to solid waste.
9. Will not involve the possibility of contaminating public water supply or adversely affect groundwater.
10. Will not result in or add to a violation of the waste discharge requirements applicable to local sewer systems as prescribed by California Regional Water Quality Control Board.
11. Will not occur to the disadvantage of long-term environmental goals.
12. Will not result in the adverse cumulative impacts.
13. Will not result in adverse growth inducing impacts.
14. Will not result in substantial adverse effects on human beings either directly or indirectly.
15. Will not be in conflict with the City's General and Community Plans.

REFERENCES

Sacramento City General Plan and EIR, 1988	Sacramento City Zoning Ordinance, July 1987
South Sacramento Community Plan and EIR, 1986	Renaissance Tower EIR, 1986
North Natomas Community Plan and EIR, 1986	Laguna Creek Floodplain Study and EIR, 1985
South Natomas Community Plan and EIR, 1987	Creekside Oaks and Gateway Centre EIR, 1984
Airport-Meadowview Community Plan and EIR, 1984	Delta Shores Village PUD EIR, 1983
North Sacramento Community Plan and EIR, 1984	Greenhaven Executive Office Park EIR, 1982
Sacramento South Pocket Specific Plan & EIR, 1977	Executive Airport Master Plan and EIR, 1981
Sacto. Central City Comprehensive Plan & EIR, 1977	Sacto. City Amer River Pkwy Plan & Neg. Dec. 1985
Downtown Redevelopment Plan Update & EIR, 1985	Northgate Station EIR, 1986
	Willow Creek EIR, 1985

- o At the Crossroads, A Report on California Endangered and Rare Fish and Wildlife. California Resources Agency and Department of Fish and Game, 1972
- o Soils of Sacramento County, California. Walter Weir, Division of Soils, U.C. Berkeley, 1950
- o Fifteenth Progress Report on Trip Ends Generation Research Counts. CalTrans 1983.
- o Native Oaks: Our Valley Heritage, Sacramento County Office of Education, 1976.
- o The applicant's environmental questionnaire and submitted plans are considered part of this Initial Study.

DETERMINATION

On the basis of this initial evaluation:

- I find the proposed project **COULD NOT** have a significant effect on the environment, and a **NEGATIVE DECLARATION** will be prepared.
- I find that although the proposed project could have a significant effect on the environment, there will not be a significant effect on this case because the mitigation measures described in this Initial Study has been added to the project. A **NEGATIVE DECLARATION WILL BE PREPARED.**
- I find the proposed project **MAY** have a significant effect on the environment, and an **ENVIRONMENTAL IMPACT REPORT** is required.

DATE: December 3, 1990

SIGNATURE: Laura Matteoli

PREPARED BY: Laura Matteoli

PHONE: (916) 449-2037

**ATTACHMENT A  
DISCUSSION OF INITIAL STUDY**

**Mesa Grande Park (Phase II) CIP-LG56**

**Project Description**

An application has been made by the City of Sacramento, Parks and Community Services to complete the proposed Master Plan for Mesa Grande Park Phase II by providing park improvements and further development. The project site is located on the northwest corner of Valley Hi and La Coruna Drive's (APN #119-0390-070) and is within the South Sacramento Community Plan (SSCP) area (see Attachment B, locator map). Both the Sacramento General Plan Update (SGPU) and the SSCP land use designations are parks, recreation, and open space. Presently, the site is partially developed with a play yard, plaza area, sidewalks and trees (site visit, 12-3-90). A Negative Declaration has been prepared for phase I of the proposed project. However, Parks and Community Services is requesting the development of new facilities (not covered in the previous Negative Declaration) and the expansion of existing facilities. New facilities include the tot lot, fitness station, picnic area and mound with sculpture while existing facility expansion includes the sidewalks and jogging trails.

**Environmental Effects**

Development of the site for the intensity and type of recreational use proposed has been evaluated under the City of Sacramento's 1986-2006 SGPU Draft Environmental Impact Report. This application does not propose to change the use or intensity of development previously evaluated.

1. **Earth**

The subject site is designated for park, recreation, and open space uses in both the SGPU and SSCP. The site contains holocene basin deposits of moderate to high permeability, but no unique geologic features exist (SGPU DEIR, T-1-2). The proposed project will result in some changes in topography, such as the compaction and overcovering of soil to provide proper drainage, building foundation, parking and vehicular maneuvering area. Development within the SGPU area is subject to potential damage from earthquake groundshaking at a maximum intensity of VIII of the Modified Mercalli Scale (SGPU DEIR, T-16). Currently, the City requires that all new structures be designed to withstand this

intensity level, since the City is within Zone 3 of the UBC's Seismic Risk Map of the United States (SGPU DEIR, T-20). No significant impact is anticipated because of the required building standards.

## 2. Air

Pollutant emissions from increased traffic as a result of park use will not have a significant impact on air quality because this project does not change the use or intensity of development and the resultant environmental effects previously evaluated in the 1986-2006 SGPU DEIR. Regionally, ozone impacts resulting from circulation, associated with SGPU build out, represents an unavoidable significant adverse impact (SGPU DEIR, Z-60.) Violations of CO standards are expected in a few other areas within South Sacramento near congested intersections of major arterials (SGPU DEIR, Z-69). Localized carbon monoxide increases associated with the SGPU build out of the SSCP present unavoidable significant adverse impacts (SGPU DEIR, Z-70). These impacts were overridden with the adoption of the 1986-2006 SGPU. The project proposes to develop within the density level that is allowed, thereby keeping the impact at a level that has been identified in the SGPU EIR. This project will contribute to the air quality impacts identified in the SGPU DEIR however, it will not contribute pollutants beyond those identified.

## 3. Water

The proposed project is located in an area of the City determined to have less than 100-year flood protection. The project site is within the Flood Zone A-H. The Flood Zone A-H has areas of different coastal base flood elevations within special flood hazard zones. Implementation of the project will therefore expose people and/or property to the risk of injury and damage in the event of a 100-year or lesser flood. These risks are considered significant adverse impacts under CEQA. The City Council has evaluated these impacts in the Environmental Impact Report (EIR) prepared in connection with the Land Use Planning Policy Within the 100-Year Floodplain (M89-054) adopted by the City Council on February 6, 1990. The EIR is available through the Department of Planning and Development, 1231 I Street, Room 300, Sacramento, California. This document serves as a Program EIR addressing the flood-related risks to people and property created by new development in the 100-year floodplain in the City. The flood-related risks created by the proposed project fall within the scope of the Program EIR. Accordingly, the findings adopted by the Council in connection with its certification of the Program EIR and its adoption of the Policy are applicable to the proposed project. These findings are set forth in the Findings of Fact/Statement of Overriding Considerations for the Land Use Planning Policy Within the 100-Year Floodplain in the City of Sacramento. This document is appended to the Program EIR available through the Department of Planning and Development.

4/5. Plant/Animal Life

The subject site is located in an Urban Land Habitat. Much of this habitat is not vegetated. When present, the dominant vegetation consists of artificially irrigated ornamental plantings (SGPU DEIR, U-14). The proposed project does not propose to remove or endanger any trees located on site; therefore, the project is anticipated to have a less-than-significant impact on plant and animal life.

6. Noise

Noise for the site is not expected to exceed the 60 dB Ldn in 2006 as identified in the SGPU (1986-2006 SGPU DEIR, AA-47). However, construction equipment may increase existing noise levels. Therefore, the applicant has agreed to restrict park construction to normal daylight working hours and all construction shall be properly muffled. The SGPU states that recreational uses are "normally acceptable" between 70 and 75 dB Ldn (SGPU DEIR, AA-27). Therefore, development of the park site will not have a significant impact on park users' exposure to severe noise levels.

7. Light and Glare

The site is surrounded by residential uses. Lighting for the proposed project will be consistent with the City Standards. Lighting is not expected to impact surrounding residential land uses, nor will it impact cars using local arterials. Therefore, a less-than-significant impact on light and glare is expected.

8. Land Use

The proposed project is consistent with the SGPU and NSCP land use designations of park, recreation, and open space. The proposed project is not expected to result in a substantial alteration of the present or proposed land use in the area.

9. Natural Resources

Future development at the site will result in the loss of those natural resources associated with the construction of the project. Development of the site is not anticipated to significantly accelerate the use of natural resources or deplete non-renewable resources.

10. Risk of Upset

Storage of toxics or chemicals in large quantities is not an acceptable activity in recreational areas. Therefore, the proposed project will result in a less-than-significant risk of upset.

11/12. Population/Housing

The project is consistent with both the SGPU and SSCP land use designations and therefore, it is not anticipated to alter the location, distribution, density or growth rate of the human population or generate any additional demand for housing. Thus, the proposed project will result in a less-than-significant impact on housing and population.

13. Transportation/Circulation

Valley Hi and La Coruna Drives are not expected to reach unacceptable levels of service (LOS) at SGPU build out. However, the major arterial serving the project site is Franklin Boulevard. The segment of Franklin Boulevard serving the project site is expected to have a level of service (LOS) of "C" at SGPU build out (SGPU DEIR, Y-89). An LOS of "C" is light congestion with occasional backups on critical approaches (SGPU DEIR, Y-3). The SGPU DEIR concludes that traffic deficiencies in the SSCP, for this roadway segment, cannot be fully mitigated through physical roadway improvements (SGPU DEIR, Y-89). Traffic resulting from development of this site was anticipated in the DEIR and will not generate any unanticipated impacts and therefore, is considered to have a less-than-significant impact.

14-16. Public Services/Energy/Utilities

The proposed project is consistent with land use designations in the SGPU and SSCP upon which projections for public services, energy and utilities are made. The proposed project will have a less-than-significant impact on these services.

17. Human Health

The proposed project is not expected to result in the creation of health hazards, potential health hazards or expose people to potential health hazards. Therefore, a less-than-significant human health impact is anticipated.

18. Aesthetics

The site has been evaluated and designated for urbanized uses within the SGPU and 1986 SSCP. In addition, the proposal is required to conform with applicable design and performance criteria identified in the City's Comprehensive Zoning Ordinance; therefore, a less than significant impact is expected to occur with regard to aesthetics.

19. Recreation

Recreational projects are anticipated to result in a beneficial impact to recreational facilities.

20. Cultural Resources

The subject site is not located in a Primary Impact Area as defined by the SGPU (DEIR, V-5). The proposed project is expected to result in less-than-significant impacts on cultural resources.

## FINDINGS REGARDING FLOOD-RELATED IMPACTS

1. *The project, CIP LG56 (the "Project"), is located in the area of the City determined to have less than 100-year flood protection. Implementation of the Project will therefore expose people and property to the risk of injury and damage in the event of a 100-year or lesser flood. These risks are considered significant adverse impacts under CEQA.*
  
2. *The City Council has evaluated these impacts in the Environmental Impact Report (EIR) prepared in connection with the Land Use Planning Policy Within the 100-Year Floodplain (M89-054) adopted by the Council on February 6, 1990. The EIR is available through the Department of Planning and Development, 1231 I Street, Room 300, Sacramento, California. This document serves as a program EIR addressing the flood-related risks to people and property created by new development in the 100-year floodplain in the City.*
  
3. *The flood-related risks created by the Project fall within the scope of the program EIR. Accordingly, the findings adopted by the Council in connection with its certification of the program EIR and its adoption of the Policy are applicable to and are hereby adopted in connection with the Project. These findings are set forth in the Findings of Fact/Statement of Overriding Considerations for the Land Use Planning Policy Within the 100-Year Floodplain in the City of Sacramento ("Findings"). This document is appended to the program EIR available through the Department of Planning and Development.*







APPLICATION AND ENVIRONMENTAL QUESTIONNAIRE  
(COMPLETE FIVE COPIES)

This document will assist the Planning Division in evaluating the proposed project and its potential environmental impacts. Complete and accurate information is required for environmental review and will minimize future requests for additional information. Please contact Environmental Services Division; 1231 I Street, Room 300, Sacramento, CA 95814 (916) 449-2037 if there are any questions concerning environmental issues. Contact the Current Planning Section, Room 200 at the address listed above, (916) 449-5604 for zoning interpretations.

SUBDIVISION NAME OR PROPOSED COMMON NAME FOR PROJECT: MEGA LEAHIDE PARK

PROPERTY OWNER'S NAME: CITY OF SACRAMENTO, PARKS & COMM. SERVICE  
Mailing Address: 1231 I ST. STE 400, SACTO. CA. Zip Code 95814  
Telephone: Business (916) 449-5200 Home ( ) \_\_\_\_\_

APPLICANT'S/AGENT'S NAME: CITY OF SACRAMENTO, PARKS & COMM. SERVICE  
Mailing Address: 1231 I ST. STE 400, SACTO. CA. Zip Code 95814  
Telephone: Business (916) 449-5200 Home ( ) \_\_\_\_\_  
Contact Person's Name: STARR SCHULKE Phone ( ) \_\_\_\_\_

PROJECT SITE INFORMATION LEGAL DESCRIPTION MUST BE ATTACHED  
Property Address or Location NORTHWEST CORNER OF VALLEY HI & LA CORUNA  
Property Assessor Parcel Number(s) 1190390070  
Property Dimensions: IRREGULAR x \_\_\_\_\_  
Property Area: Square Footage (gross) 282,575 (net) \_\_\_\_\_  
Acreage (gross) 6.4 (net) \_\_\_\_\_  
Land Use: Undeveloped/Vacant \_\_\_\_\_ Developed (give bldg.sq.ft.) X  
Existing Zoning of Project Site: \_\_\_\_\_ Proposed Zoning: \_\_\_\_\_

DESCRIBE ADJACENT ZONING AND EXISTING LAND USE WITHIN 300 FEET OF PROJECT SITE:

	ZONE	EXISTING LAND USE (i.e., residential, commercial, industrial)
North	<u>R1</u>	<u>RESIDENTIAL</u>
South	<u>R1</u>	<u>"</u>
East	<u>R1</u>	<u>"</u>
West	<u>R1</u>	<u>"</u>

FOR OFFICE USE ONLY

P No.:	_____	Date Rec'd:	_____	By:	_____
General Plan Design:	_____	Rezone	_____		
Amend To:	_____	Tent. Map	_____		
Com. Plan Area:	_____	Spec. Permit	_____		
Existing Design:	_____	Variance	_____		
Amend To:	_____	Sub. Mod.	_____		
Other Plan Design:	_____	LLA	_____		
Amend To:	_____	Other	_____		

Environmental Determination: Exempt: SA : Neg. Dec X ; EIR \_\_\_\_\_  
By: SA Date 12/3/90

\*PLEASE MARK ON THIS MAP THE APPROXIMATE LOCATION OF YOUR PROJECT

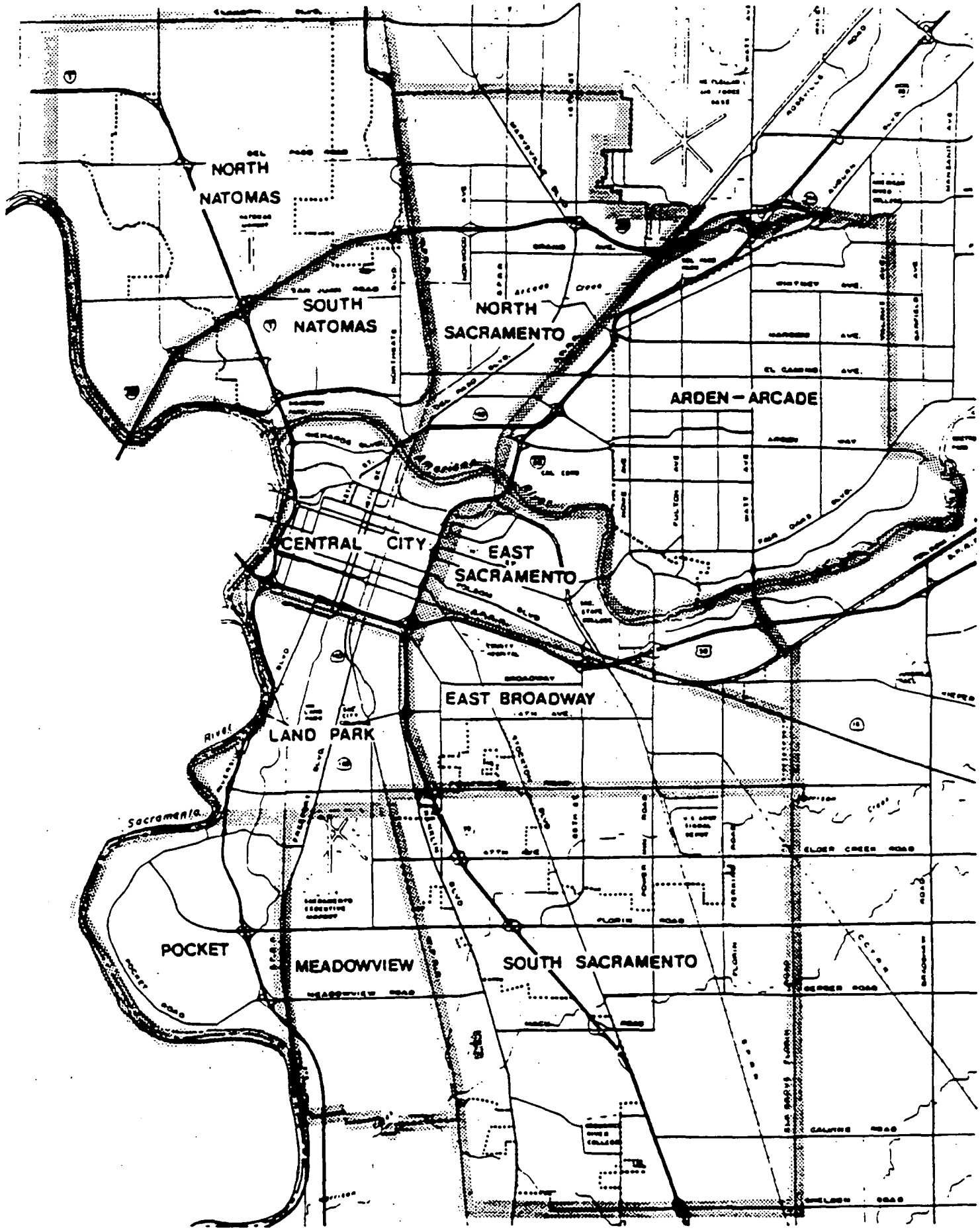

APPLICANT'S STATEMENT OF INTENT: This is a 3-part statement to be provided in the spaces below and shall contain the following:

- a. A description of what it is you propose to do. This description should include the entitlements being requested (i.e., rezone, tentative map, special permit, etc.)
- b. Information pertinent to the application, such as the number of units, size of buildings, number of off-street parking spaces, height of fence and any other pertinent information not shown on the submitted plans.
- c. Information and reasoning justifying your request.

STATEMENT OF INTENT: ① COMPLETE PROPOSED MASTER PLAN FOR MESA GRANDE PARK. (SEE ATTACHMENT '1')

② IMPROVEMENTS INCLUDE: ① COMPLETE PROPOSED CONCRETE SIDEWALK. ② COMPLETE PROPOSED JOGGING TRAIL. ③ INSTALL PROPOSED FITNESS STATIONS. ④ INSTALL PROPOSED PICNIC AREAS. ⑤ INSTALL PROPOSED TOT LOT. ⑥ INSTALL PROPOSED EARTH MOUND & SCULPTURE. (SEE ATTACHMENT '1')

⑦ THIS PROJECT IS IN COMPLIANCE WITH THE SITE-SPECIFIC MASTER PLAN FOR MESA GRANDE PARK (1988, AMMENDED NOV, 1990) AND WITH THE CITY OF SACRAMENTO 'MASTER PLAN OF PARKS'. THIS PROJECT WILL INCREASE THE AMOUNT OF RECREATION, FITNESS, PICNIC & AESTHETIC AREAS OF THE PARK.

**PREVIOUS LAND USE**

Explain existing and previous land use(s) of site for last ten years:

PARK : PLAYGROUND, PLAY FIELD, JOGGING TRAIL.

**PREVIOUS ENVIRONMENTAL DOCUMENTS**

If this project is part of a larger project for which a Negative Declaration or Environmental Impact Report has been prepared, reference the document below (include date and project number if applicable):

NEGATIVE DECLARATION C.C.# L081, ENDORSED JAN. 1, 1989

**NO PREVIOUS ENVIRONMENTAL DOCUMENTS**

Is this project part of a larger project for which no environmental review has been prepared? H/A yes \_\_\_\_\_ no \_\_\_\_\_

**SITE CHARACTERISTICS**

Are there any Trees/Shrubs on the Project Site? YES  
Are any to be removed? NO

Are any to be transplanted? NO If so, state location of transplant site. \_\_\_\_\_

Plot on Site Plan by Size and Type all trees to be removed and/or transplanted.

Is the site part of an Airport Overlay Zone? Explain: \_\_\_\_\_

Will the proposed use involve any toxic or hazardous materials or waste? Explain: \_\_\_\_\_

**DEMOLITION OF STRUCTURES**

Are there any structures on the project site? YES

Present Use of Existing Structure(s): PLAY

Proposed Use of Existing Structure(s): PLAY

Are any Structures Occupied: NO

Describe the type of occupancy (number of residents, type of use)

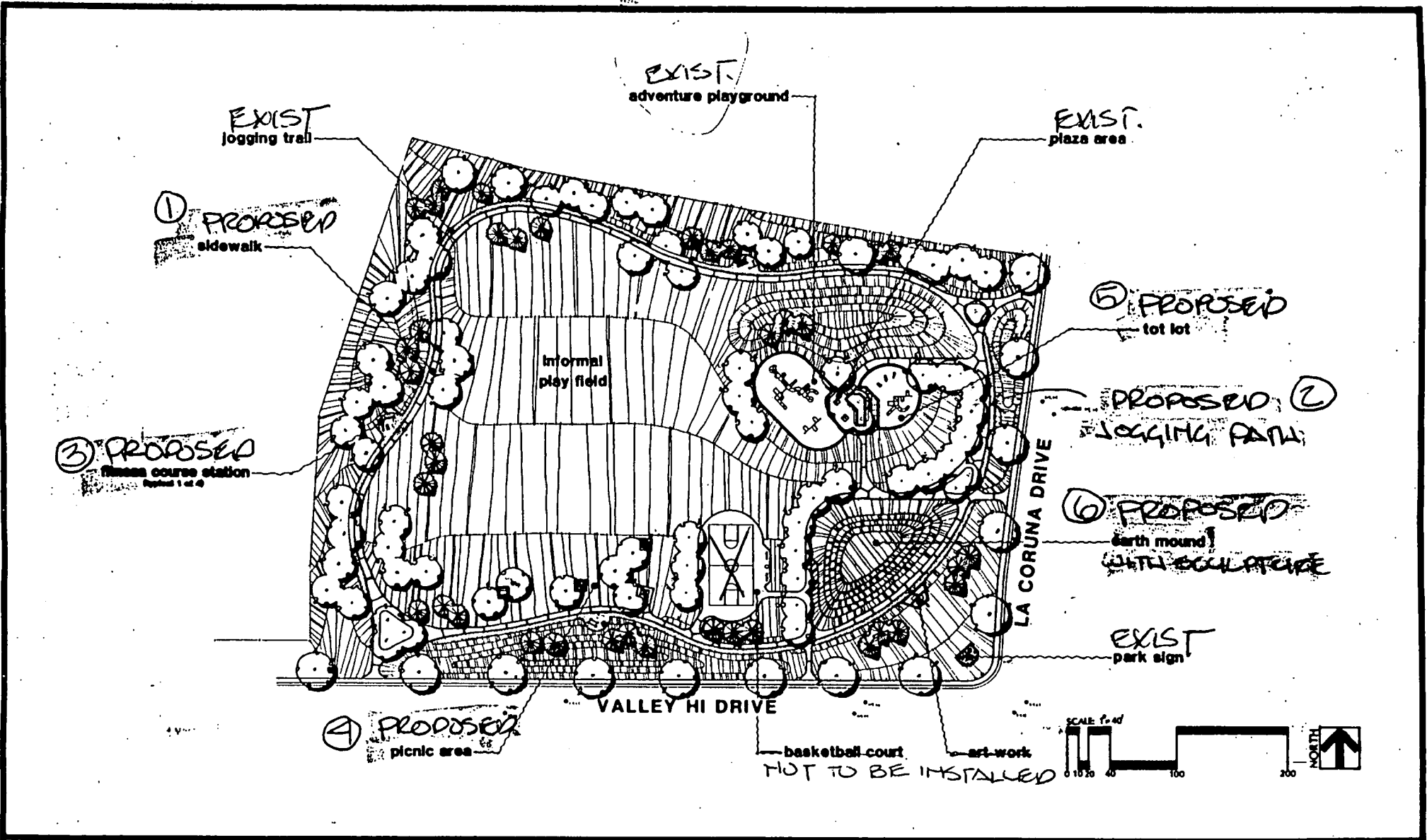

REVISIONS NO.	DESCRIPTION	DATE	BY

DRAWN BY G.M.M. HAE  
 DESIGNED BY G.M.M. HAE  
 LANDSCAPE ARCHITECT M.A.E.  
 DATE 2-18-00  
 FIELD BOOK \_\_\_\_\_ SCALE 1"=40'

**CITY OF SACRAMENTO**  
 DEPARTMENT OF PARKS & COMMUNITY SERVICES



**MASTER PLAN**  
**MESA GRANDE PARK**

SHEET \_\_\_\_\_  
 OF \_\_\_\_\_ SHEETS

ATTACHMENT # 1

Structures to be Demolished: NONE  
 Structures to be Moved: NONE  
 Describe age, condition, size, and architectural style of all existing on-site structures (include photos): TIMBER FORM PLAY STRUCTURE NEW!

**RETAIL, COMMERCIAL, INDUSTRIAL, INSTITUTIONAL, OR OTHER PROJECT  
 (IF PROJECT IS ONLY RESIDENTIAL, DO NOT ANSWER THIS SECTION)**

Type of Use(s): PLAY, RECREATION, PICNIC, FITNESS.  
 Oriented to: Regional \_\_\_\_\_ City \_\_\_\_\_ Neighborhood X  
 Hours of Operation: DAYLIGHT HOURS  
 Total Occupancy/Capacity of Building(s): -  
 Total Number of Fixed Seats: 50  
 Square Footage of: Warehouse Area: -  
 Office Area: - Loading Area: -  
 Sales Area: - Storage Area: -  
 Total Number of Employees: -  
 Anticipated Number of Employees Per Shift: -  
 Total Number of Visitors/Customers on site at any one time: -  
 Other Occupants (specify): -

**RESIDENTIAL PROJECTS**

Total Lots: N/A Total Dwelling Units: \_\_\_\_\_  
 Total Acreage: \_\_\_\_\_ Net Density/Acre: \_\_\_\_\_ Gross Density/Acre: \_\_\_\_\_

	Single Family	Two Family Duplex/Halfplex	Multi-Family (Apartments)	Multi-Family (Condominiums)
Number of Units	_____	_____	_____	_____
Acreage	_____	_____	_____	_____
Square Feet per Unit	_____	_____	_____	_____
For Sale or Rent	_____	_____	_____	_____
Price Range	_____	_____	_____	_____
Type of Unit:				
Studio	_____	_____	_____	_____
1 Bedroom	_____	_____	_____	_____
2 Bedroom	_____	_____	_____	_____
3 Bedroom	_____	_____	_____	_____
4+ Bedroom	_____	_____	_____	_____

Are any of these units proposed to be subsidised? \_\_\_\_\_  
 If yes, describe the type and source of the subsidy.  
 \_\_\_\_\_  
 \_\_\_\_\_

PROPOSED BUILDING(S) CHARACTERISTICS  
FOR ENTIRE PROJECT

Size of New Structure(s) or Building Addition(s): NONE Gross Sq. Ft.

Building Height (Measured from Ground to Highest Point):

N/A Ft. No. of Floors \_\_\_\_\_

Height of Other Appurtenances (Excluding Buildings) Measured from Ground to Highest Point (e.g., Antennas, Microwave Equipment, Solar Energy Equipment, Light Pole Standards, etc.)

PLAY STRUCTURE 10' TALL, ART SCULPTURE 10' TALL

Project Site Coverage:	Building Coverage:	_____	Sq. Ft.	_____	%
	Landscaped Area:	_____	Sq. Ft.	_____	%
	Paved Surfaced Area:	_____	Sq. Ft.	_____	%
	Total:	_____	Sq. Ft.	100	%

Exterior Building Materials: N/A Roof Materials: \_\_\_\_\_

Exterior Building Colors: N/A

Describe the need and demand for child care services generated by the proposed project and indicate any plans for providing such services in conjunction with the project:

NONE

Total Number of Off-Street Parking Spaces:  
On-Site Required 0 On-Site Proposed: 0

Total Number of Proposed Off-Site Parking: 0  
(Include a Signed Lease Agreement or Letter of Agency)

Total Number of Bicycle Locker Facilities Proposed: 0 Required: 0

Describe the Type of Exterior Lighting Proposed for the Project (Height, Intensity): Building: NONE Parking: NONE

Estimate Total Construction Cost for Project: \$ 1091,000

Construction Starting Date: JULY, 91 Estimated Completion Date: NOV. 91

Does this Proposal include Signage? NO If yes, explain the following:  
Height: \_\_\_\_\_ Illumination: \_\_\_\_\_  
Area: \_\_\_\_\_ Type: \_\_\_\_\_  
Dimensions: \_\_\_\_\_ Colors/Materials: \_\_\_\_\_  
Locations (On/Off-Site): \_\_\_\_\_

NOTE: IF THE PROJECT SITE IS ON OR NEAR A HISTORICAL SITE, ARCHAEOLOGICAL SITE, LANDFILL SITE, RIVER, FLOODPLAIN, FREEWAY, RAILROAD, OR AIRPORT, THEN SPECIFIC TECHNICAL STUDIES MAY BE REQUIRED. APPLICANTS ARE ENCOURAGED TO CONTACT THE ENVIRONMENTAL SECTION AT THE EARLIEST OPPORTUNITY TO DETERMINE THE POSSIBLE NEED AND SCOPE OF SUCH STUDIES.

**OTHER PERMITS OR APPROVALS**

List any and all other public approvals required for this project. Specify type of permit or approval, agency/department, address, person to contact, and their telephone number.

<u>Permit or Approval</u>	<u>Agency</u>	<u>Address</u>	<u>Contact Person</u>	<u>Phone Number</u>
NONE				

AS THE APPLICANT/AGENT FOR THIS PROPOSAL, I HEREBY STATE THAT TO THE BEST OF MY KNOWLEDGE, THE ABOVE ANSWERS AND STATEMENTS ARE TRUE AND COMPLETE. I CERTIFY THAT THE PROPOSAL DESCRIBED IN THIS APPLICATION IS NOT A PART OF A LARGER PROJECT OR A PHASE OF A LARGER PROJECT.

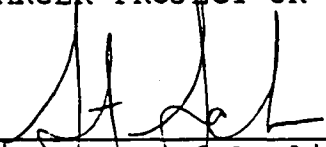
  
\_\_\_\_\_  
Signature of Applicant/Agent

11-27-90  
\_\_\_\_\_  
Date

MIKE MATSUOKA L.AECH. TECHNIUM  
STAFF SCHULKE / STUDENT TRAINER  
\_\_\_\_\_  
Print Name and Title of Applicant/Agent

449-5326  
\_\_\_\_\_  
Phone

BECAUSE THE TIME REQUIRED FOR ENVIRONMENTAL OR STAFF REVIEW MAY VARY ACCORDING TO THE COMPLEXITY OF THE PROJECT, THE PLANNING DIVISION WILL NOTIFY YOU OF THE SCHEDULED HEARING DATE ON YOUR PROJECT ONCE IT HAS BEEN RELEASED FROM THE ENVIRONMENTAL SERVICES DIVISION.

03/90:dth