

CITY OF SACRAMENTO

1231 I Street, Sacramento, CA 95814

Permit No: 9905822

Insp Area: 4

Site Address: 2842 CHATEAU MONTELENA WY SAC

Parcel No: 225-1160-042

LOT 115

Sub-Type: NSFR

Housing (Y/N): N

CONTRACTOR

BEAZER HOMES
3009 DOUGLAS BL #150
ROSEVILLE CA 95661

OWNER

ARCHITECT

Nature of Work: MP 1874 2 STORY 9 ROOM SFR

CONSTRUCTION LENDING AGENCY : I hereby affirm under penalty of perjury that there is a construction lending agency for the performance of the work for which this permit is issued (Sec. 3097, Civ. C).

Lender's Name _____ Lender's Address _____

LICENSED CONTRACTORS DECLARATION: I hereby affirm under penalty of perjury that I am licensed under provisions of Chapter 9 (commencing with section 7000) of Division 3 of the Business and Professions Code and my license is in full force and effect.

License Class 1 License Number 724121 Date 11/11/99 Contractor Signature M. Collins

OWNER-BUILDER DECLARATION: I hereby affirm under penalty of perjury that I am exempt from the contractors License Law for the following reason (Sec. 7031.5, Business and Professions Code: any city or county which requires a permit to construct, alter, improve, demolish, or repair any structure, prior to its issuance, also requires the applicant for such permit to file a signed statement that he or she is licensed pursuant to the provisions of the Contractors License Law (Chapter 9 (commencing with Section 7000) of Division 8 of the Business and Professions Code) or that he or she is exempt therefrom and the basis for the alleged exemption. Any violation of Section 7031.5 by any applicant for a permit subjects the applicant to a civil penalty of not more than five hundred dollars (\$500.00):

____ I, as a owner of the property, or my employees with wages as their sole compensation, will do the work, and the structure is not intended or offered for sale (Sec. 7044, Business and Professional Code: The Contractors License Law does not apply to an owner of property who builds or improves thereon, and who does such work himself or herself or through his/her own employees, provided that such improvements are not intended or offered for sale. If, however, the building or improvement is sold within one year of completion, the owner-builder will have the burden of proving that he/she did not build or improve for the purpose of sale.)

____ I, as owner of the property, am exclusively contracting with licensed contractors to construct the project (Sec. 7044, Business and Professions Code: The Contractors License Law does not apply to an owner of property who builds or improves thereon, and who contracts for such projects with a contractor(s) licensed pursuant to the Contractors License Law).

____ I am exempt under Sec. _____ B & PC for this reason: _____

Date _____ Owner Signature _____

IN ISSUING THIS BUILDING PERMIT, the applicant represents, and the city relies on the representation of the applicant, that the applicant verified all measurements and locations shown on the application or accompanying drawings and that the improvement to be constructed does not violate any law or private agreement relating to permissible or prohibited locations for such improvements. This building permit does not authorize any illegal location of any improvement or the violation of any private agreement relating to location of improvements.

I certify that I have read this application and state that all information is correct. I agree to comply with all city and county ordinances and state laws relating to building construction and hereby authorize representative(s) of this city to enter upon the abovementioned property for inspection purposes.

Date 11/11/99 Applicant/Agent Signature M. Collins

WORKER'S COMPENSATION DECLARATION: I hereby affirm under penalty of perjury one of the following declarations:

____ I have and will maintain a certificate of consent to self-insure for workers' compensation as provided for by Section 3700 of the Labor Code, for the performance of work for which the permit is issued.

____ I have and will maintain workers' compensation insurance, as required by Section 3700 of the Labor Code, for the performance of the work for which this permit is issued. My workers' compensation insurance carrier and policy number are:

Carrier LIBERTY MUTUAL INS CO. Policy Number WA2-65D-004147-059 Exp Date 04/01/2000

____ (This section need not be completed if the permit is for \$100 or less) I certify that in the performance of the work for which this permit is issued, I shall not employ any person in any manner so as to become subject to the workers' compensation laws of California and agree that if I should become subject to the workers' compensation provisions of Section 3700 of the Labor Code, I shall forthwith comply with those provisions.

Date 11/11/99 Applicant Signature M. Collins

WARNING: FAILURE TO SECURE WORKER'S COMPENSATION COVERAGE IS UNLAWFUL AND SHALL SUBJECT AN EMPLOYER TO CRIMINAL PENALTIES AND CIVIL FINES UP TO ONE HUNDRED THOUSAND DOLLARS (\$100,000) IN ADDITION TO THE COST OF COMPENSATION, DAMAGES AS PROVIDED FOR IN SECTION 3706 OF THE LABOR CODE, INTEREST AND ATTORNEY'S FEE.

THIS PERMIT SHALL EXPIRE BY LIMITATION IF WORK IS NOT COMMENCED WITHIN 180 DAYS.

COUNTY SANITATION DISTRICT NO. 1
 SACRAMENTO REGIONAL COUNTY SANITATION DISTRICT
SEWER IMPACT FEE
 PERMIT AND CALCULATION SHEET

APPLICATION NO: _____

BLDG PERMIT NO: _____

GENERAL INFORMATION

THIS PERMIT GOOD ONLY WHEN
 VALIDATED BY THE CASHIER

THIS PERMIT TO CONNECT EXPIRES
 ONE YEAR FROM DATE OF ISSUANCE

FEE CALCULATION		BUILDING USE	
INSPECTION		RESIDENTIAL	SF <input type="checkbox"/> MF <input type="checkbox"/>
CSD-1		COMMERCIAL USE	UNITS
SRCSO	1444		
CONSTRUCTION			
IN-LIEU			
TOTAL FEE			

APN: _____

DESCRIPTION
SUBDIVISION

LOT

PROPERTY ADDRESS

OWNER

MAILING ADDRESS

CITY STATE ZIP

PERMIT

APPLICANT'S NAME

PROJECT NAME

ADDRESS

APN

DATE

STATE

THIS PLAN IS PREPARED TO SHOW THE DIMENSIONAL RELATIONSHIP FROM BUILDING FOUNDATION TO PROPERTY LINE, DESIGN DRAINAGE CONTROL ELEVATIONS, AND DIRECTION OF DRAINAGE FLOW TO CONFORM WITH LOCAL ORDINANCES FOR THE PURPOSE OF BUILDING PERMIT ISSUANCE. INFORMATION SHOWN IS APPROXIMATE EXCEPT FOR THOSE SETBACKS WHICH ARE MINIMUMS REQUIRED BY ORDINANCE. THIS PLOT DOES NOT REFLECT AS BUILT CONDITIONS WHICH WILL LIKELY VARY FROM THIS PLAN.

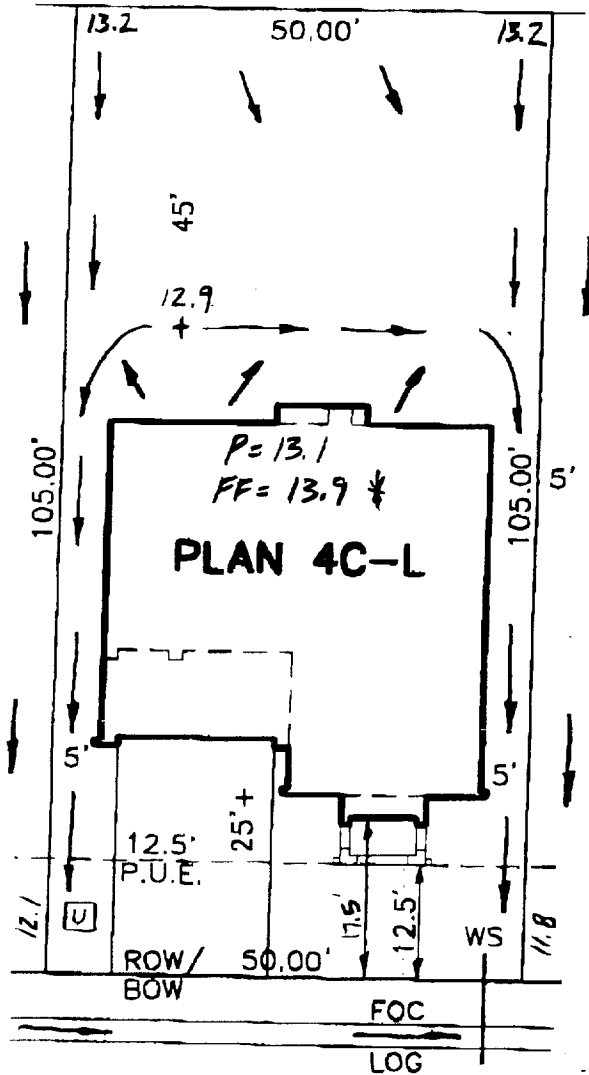

ROUTING/APPROVAL		
	✓	INITIALS
President		
Project Development		
Construction	✓	<i>[Signature]</i>
Marketing	✓	<i>[Signature]</i>

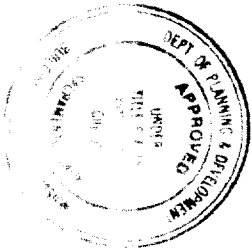

This set of plans and specifications must be kept on the job at all times and it is unlawful to make any changes or alterations on the same without the approval of the City of Sacramento.

CHATEAU MONTELENA WAY

PLOT PLAN
LOT 115
GATEWAY WEST-VILLAGE NO. 1
FOR
BEAZER HOMES
SACRAMENTO CALIFORNIA

WOOD-RODGERS INC.

DATE: MAY, 1999	DRAWN: PDM	CHECKED: SJA 5-29-99	PROJECT NO: 98BEZ-009
--------------------	---------------	----------------------------	--------------------------

*ADDITIONAL 0.1' FOUNDATION HEIGHT REQUIRED

☐ = UTILITY SERVICE BOX

LOT COVERAGE = 23%
2842 CHATEAU MONTELENA WAY

CERTIFICATION OF COMPLIANCE

SCHOOL DISTRICT DEVELOPMENT FEES

PART I: TO BE COMPLETED BY APPLICANT			
Property Owner's Name _____			
Owner's Address _____			
Project Address _____			
Parcel Number _____			
Subdivision Name _____			
Number of Units _____			
Print Applicant's Name _____		Applicant's Signature _____	
Title of Applicant _____		Telephone Number _____	
Date _____			
PART II: TO BE COMPLETED BY BUILDING DEPARTMENT			
Plan Identification Number _____			
Building Type (Check One)			
<input type="checkbox"/> Residential		<input type="checkbox"/> Apartment/Condominium	
<input type="checkbox"/> Commercial/Industrial			
Square Feet of Chargeable Building Area _____			
Signature _____		Date _____	
Title _____			
PART III: TO BE COMPLETED BY NATOMAS UNIFIED SCHOOL DISTRICT			
District Identification Number _____			
Fees Collected:			
Residential:	Sq. Ft. X \$	= \$	_____
Apartment/Condominium:	Sq. Ft. X \$	= \$	_____
Commercial/Industrial:	Sq. Ft. X \$	= \$	_____
NOTICE TO APPLICANT: Pursuant to government code section 66020 (d), this will serve to notify you that the 90-day approval period in which you may protest the fees, or other payment identified above, will begin to run on the date in which the building or installation permit for this project is issued, or on which they are paid to the District or to another public entity authorized to collect them on behalf of the District, whichever is earlier.			
Applicant Signature: _____		Date: _____	

This certification covers only the amount of square footage indicated above. Any additions or corrections to the square footage for this project will require an amendment to the Certificate of Compliance.

As the authorize Natomas Unified School District official, I hereby certify that the requirements of Government Code Section 95995 have been complied with by the above signed applicant.

SIGNATURE: _____ DATE: _____



No 18535

INSTALLATION CARD

Job Address:

21228 Refinery's Lot 115
3848 Industrial Avenue
Rd 42

Stucco System Trade Name: KWIK KOTE
Name Stucco Manufacturer: KWIK KOTE CORP.

ICBO Evaluation Service, Inc.
Report No. 3607
Date of Job Completion

Stucco Contractor Kenyon Construction
Name John W. Kenyon, III
Address P.O. Box 2077
North Highlands, CA 95660
Telephone Number (916) 349-8191
Approved Contractor Number as issued by the Stucco Manufacturer: 1

This is to certify that the stucco system on the building exterior at the above address had been installed in accordance with the evaluation report specified above and the manufacturer's instructions.

Signature of authorized representative of stucco contractor:

Date

8/24/85