

**CITY OF SACRAMENTO**  
1231 I Street, Sacramento, CA 95814

Permit No: 9906429

Insp Area: 4

Site Address: 15 CLOE CT SAC

Parcel No: 225-0114-010

PARKWAY PLAZA UNIT 1 LOT 20

Sub-Type:

NSFR

Housing (Y/N):

N

**CONTRACTOR**

LENNAR RENAISSANCE INC.  
2240 DOUGLAS BL  
ROSEVILLE CA 95661

**OWNER**

**ARCHITECT**

**Nature of Work:** MP2550 WITH 201 SQ FT OPTION 2 STORY 10 RM SFR

**CONSTRUCTION LENDING AGENCY :** I hereby affirm under penalty of perjury that there is a construction lending agency for the performance of the work for which this permit is issued (Sec. 3097, Civ. C).

Lender's Name

Lender's Address

**LICENSED CONTRACTORS DECLARATION:** I hereby affirm under penalty of perjury that I am licensed under provisions of Chapter 9 (commencing with section 7000) of Division 3 of the Business and Professions Code and my license is in full force and effect.

License Class

B

License Number

732348

Date

5-12-99

Contractor Signature

*[Signature]*

**OWNER-BUILDER DECLARATION:** I hereby affirm under penalty of perjury that I am exempt from the contractors License Law for the following reason: (Sec. 7031.5, Business and Professions Code; any city or county which requires a permit to construct, alter, improve, demolish, or repair any structure, prior to its issuance, also requires the applicant for such permit to file a signed statement that he or she is licensed pursuant to the provisions of the Contractors License Law (Chapter 9 (commencing with Section 7000) of Division 8 of the Business and Professions Code) or that he or she is exempt therefrom and the basis for the alleged exemption. Any violation of Section 7031.5 by any applicant for a permit subjects the applicant to a civil penalty of not more than five hundred dollars (\$500.00):

I, as a owner of the property, or my employees with wages as their sole compensation, will do the work, and the structure is not intended or offered for sale (Sec. 7044, Business and Professional Code: The Contractors License Law does not apply to an owner of property who builds or improves thereon, and who does such work himself or herself or through his/her own employees, provided that such improvements are not intended or offered for sale. If, however, the building or improvement is sold within one year of completion, the owner-builder will have the burden of proving that he/she did not build or improve for the purpose of sale.)

I, as owner of the property, am exclusively contracting with licensed contractors to construct the project (Sec. 7044, Business and Professions Code: The Contractors License Law does not apply to an owner of property who builds or improves thereon, and who contracts for such projects with a contractor(s) licensed pursuant to the Contractors License Law).

I am exempt under Sec. \_\_\_\_\_ B & PC for this reason: \_\_\_\_\_

Date

Owner Signature

**IN ISSUING THIS BUILDING PERMIT,** the applicant represents, and the city relies on the representation of the applicant, that the applicant verified all measurements and locations shown on the application or accompanying drawings and that the improvement to be constructed does not violate any law or private agreement relating to permissible or prohibited locations for such improvements. This building permit does not authorize any illegal location of any improvement or the violation of any private agreement relating to location of improvements.

I certify that I have read this application and state that all information is correct. I agree to comply with all city and county ordinances and state laws relating to building construction and hereby authorize representative(s) of this city to enter upon the abovementioned property for inspection purposes.

Date

5-12-99

Applicant/Agent Signature

*[Signature]*

**WORKER'S COMPENSATION DECLARATION:** I hereby affirm under penalty of perjury one of the following declarations:

I have and will maintain a certificate of consent to self-insure for workers' compensation as provided for by Section 3700 of the Labor Code, for the performance of work for which the permit is issued.

I have and will maintain workers' compensation insurance, as required by Section 3700 of the Labor Code, for the performance of the work for which this permit is issued. My workers' compensation insurance carrier and policy number are:

Carrier CONTINENTAL CAS, INC.

Policy Number WC166792277

Exp Date 06/01/2000

(This section need not be completed if the permit is for \$100 or less) I certify that in the performance of the work for which this permit is issued, I shall not employ any person in any manner so as to become subject to the workers' compensation laws of California and agree that if I should become subject to the workers' compensation provisions of Section 3700 of the Labor Code, I shall forthwith comply with those provisions.

Date

5-12-99

Applicant Signature

*[Signature]*

**WARNING:** FAILURE TO SECURE WORKER'S COMPENSATION COVERAGE IS UNLAWFUL AND SHALL SUBJECT AN EMPLOYER TO CRIMINAL PENALTIES AND CIVIL FINES UP TO ONE HUNDRED THOUSAND DOLLARS (\$100,000) IN ADDITION TO THE COST OF COMPENSATION, DAMAGES AS PROVIDED FOR IN SECTION 3706 OF THE LABOR CODE, INTEREST AND ATTORNEY'S FEE.

**THIS PERMIT SHALL EXPIRE BY LIMITATION IF WORK IS NOT COMMENCED WITHIN 180 DAYS.**

Lot # 20

# OMEGA PRODUCTS INTERNATIONAL, INC.

DIAMOND WALL INSULATING STUCCO SYSTEM

JOB ADDRESS:

ICBO Report #4004

WINNEBEST. HOMES  
THE WILLOWS

Date of Job Completion 12-29-99

PLASTERING CONTRACTOR:

Name: STUCCO WORKS INC

Address: 5900 WAREHOUSE WPKY SACRAMENTO CA 95820

Telephone No: (916) 382 66 99

Contractor Number of Diamond Wall System 2175

This is to certify that the exterior coating system on the building exterior at the above address has been installed in accordance with the evaluation report specified above and the manufacturer's instructions.

2-20-00

Date

Michael R.

Signature of authorized representative of  
Plastering Contractor

This installation card must be presented to the building inspector after completion of work and before final inspection.

# CERTIFICATION OF INSULATION

PART GENERAL

PART AREAS

INSULATED

PART

|   |   |
|---|---|
| <b>ADDRESS OR TRACT</b><br><div style="font-size: 1.5em; margin-top: 10px;"> <span style="margin-right: 100px;">WINDCREST</span> <span>LOT # 20</span> </div> <div style="margin-top: 20px;"> <span style="font-size: 1.5em;">The Willows</span> </div> | <b>SACRAMENTO INSULATION CONTRACTORS</b><br><input checked="" type="checkbox"/> P.O. BOX 854, WEST SACRAMENTO, CA 95691 LIC. #202026<br><input type="checkbox"/> 1309 MELODY ROAD, MARYSVILLE, CA 95901 LIC. #202026<br><input type="checkbox"/> P.O. BOX 9651, FRESNO, CA 93793-9651 LIC. #202026<br><input type="checkbox"/> P.O. BOX 1631, RENO, NV 89505 LIC. #10675<br><input type="checkbox"/> 3326 A PONDEROSA WAY, LAS VEGAS, NV 89118 LIC. #10675<br><br>DATE INSULATION COMPLETED |
|---|---|

| WALLS                      |                   | CEILINGS                   |                         |                                       | FLOORS                     |                   |
|----------------------------|-------------------|----------------------------|-------------------------|---------------------------------------|----------------------------|-------------------|
| SQUARE FEET)               |                   | SQUARE FEET)               |                         |                                       | ( SQUARE FEET)             |                   |
| TYPE OF INSULATION         |                   | TYPE OF INSULATION         |                         |                                       | TYPE OF INSULATION         |                   |
| MATERIAL                   | <b>FIBERGLASS</b> | MATERIAL                   | <b>FIBERGLASS</b>       |                                       | MATERIAL                   | <b>FIBERGLASS</b> |
| FORM                       | <b>BATTS</b>      | FORM                       | <b>BATTS &amp; BLOW</b> |                                       | FORM                       | <b>BATTS</b>      |
| MANUFACTURER'S PRODUCT I D |                   | MANUFACTURER'S PRODUCT I D |                         |                                       | MANUFACTURER'S PRODUCT I D |                   |
| MANUFACTURER               |                   | MANUFACTURER               |                         |                                       | MANUFACTURER               |                   |
| OCF                        |                   | OCF                        |                         |                                       | OCF                        |                   |
|                            |                   | BAGS                       |                         |                                       |                            |                   |
| R-VALUE INSTALLED          | APPLIED THICKNESS | R-VALUE INSTALLED          | APPLIED THICKNESS       | MIN. INSTALLED WEIGHT PER SQUARE FOOT | R-VALUE INSTALLED          | APPLIED THICKNESS |
| 13<br>19                   | 3 5/8"<br>5 1/2"  | 38<br>38                   | 12 1/4"<br>14 3/4"      |                                       |                            |                   |

KNEE WALLS IF R-VALUE IS OTHER THAN WALLS ABOVE

|                   |              |         |              |
|-------------------|--------------|---------|--------------|
| MATERIAL          | FORM         | R-VALUE | MANUFACTURER |
| <b>FIBERGLASS</b> | <b>BATTS</b> |         | <b>OCF</b>   |

AIR INFILTRATION SEALANT

|             |                  |
|-------------|------------------|
| MATERIAL    | MANUFACTURER     |
| <b>FOAM</b> | <b>W R GRACE</b> |

THIS IS TO CERTIFY THAT INSULATION AND/OR SEALANT HAS BEEN INSTALLED IN CONFORMANCE WITH APPLICABLE CODES, MATERIAL STANDARDS AND REGULATIONS.

|                                   |         |          |
|-----------------------------------|---------|----------|
| SIGNATURE - INSULATION CONTRACTOR | TITLE   | DATE     |
|                                   | MANAGER | 12-27-99 |
| SIGNATURE - GENERAL CONTRACTOR    | TITLE   | DATE     |
|                                   |         |          |

REMARKS

---

This Plot Plan is for the purpose of showing the house to be constructed on the lot and may not represent the final as-built configuration of the property or improvements thereon. Setbacks, other than minimum ordinance, are approximate only and must not be assumed to be precise.

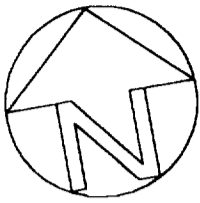

SCALE: 1"=20'

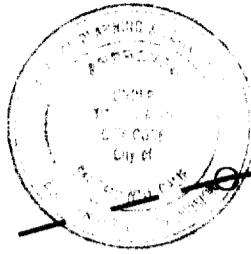

This set of plans and specifications must be kept on the job at all times and it is unlawful to make any changes or alterations from the same without written permission from the Building Inspector **2970**.

The approval of this plan and specification SHALL NOT be held to permit or approve the violation of any City Ordinance or State Law.

**ISSUED**

JUN 17 1999

CITY OF SACRAMENTO  
DEVELOPMENT SERVICES DIV.

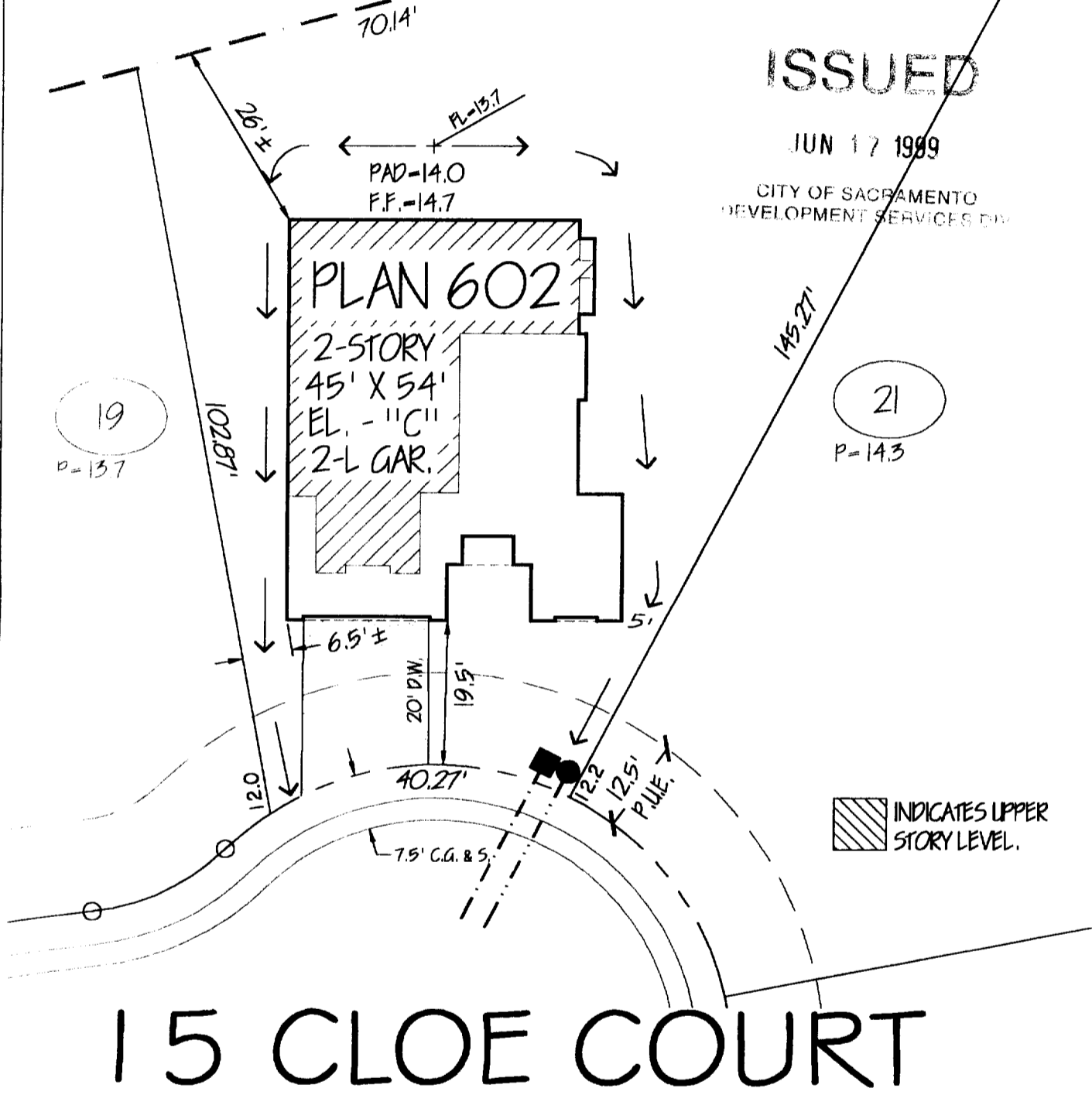

# 15 CLOE COURT

INDICATES UPPER STORY LEVEL.

| LOT COVERAGE           |           |
|------------------------|-----------|
| Lot Area:              | 9185 s.f. |
| Building:              | 2081 s.f. |
| Building/<br>Lot Area: | 23 %      |

| RETAINING WALL         |       |
|------------------------|-------|
| Height:                | _____ |
| Length:                | _____ |
| Distance<br>From P.L.: | _____ |

| SYMBOLS          |  |
|------------------|--|
| Drainage Inlet:  |  |
| Fire Hydrant:    |  |
| Street Light:    |  |
| Sewer:           |  |
| Sign:            |  |
| Water:           |  |
| Transformer Pad: |  |

**NOTES**  
1. MEASUREMENTS ALONG CURVED LINES ARE CHORD LENGTHS, U.O.N.

|          |        |          |      |
|----------|--------|----------|------|
| BCB      | 6/4/99 | GRS      |      |
| DRAWN BY | DATE   | CHK'D BY | DATE |

1" = 20'  
DRWG SCALE

**Winncrest Homes**  
A Lennar Company

**The Willows**  
A Parkway Plaza Community

**Home Site 20**  
@  
PARKWAY PLAZA | CITY OF SACRAMENTO  
UNIT No. 1 | CALIFORNIA  
A.P.N.: 225-0114-010