



10

**DEPARTMENT OF
PUBLIC WORKS**

ENGINEERING DIVISION

THOMAS M. FINLEY
ENGINEERING DIVISION MANAGER

CITY OF SACRAMENTO
CALIFORNIA

927 TENTH STREET
ROOM 200
SACRAMENTO, CA
95814-2705

916-449-8220

CONSTRUCTION SECTION
640 BERGUT DRIVE
SUITE B
SACRAMENTO, CA
95814-0131

916-449-5282

August 30, 1988

AUG 24 1988

City Council
Sacramento, California

Honorable Members In Session:

**SUBJECT: Village Park Unit No. 5 (P-85139) - Approval of Final
Subdivision Map and Agreement**

SUMMARY

Adoption of a resolution approving a Final Subdivision Map and Agreement for Village Park Unit No. 5, located at the north side of intersection of Meadowview Road and Brookfield Drive, is recommended.

BACKGROUND

On November 18, 1986, the City Council approved a Tentative Subdivision Map by adopting Resolution No. 86-878.

All conditions in the staff subdivision report have been met and the Final Subdivision Map is presented for approval.

FINANCIAL

All subdivision costs are being paid by the subdivider, Sunrise Village Park, a California limited partnership.

APPROVED
BY THE CITY COUNCIL

AUG 30 1988

OFFICE OF THE
CITY CLERK

AG 88039

1950

1951

1952

1953

1954

1955

1956

1957

1958

1959

1960

City Council
Village Park Unit No. 5 (P-85139)
August 30, 1988
Page 2

RECOMMENDATION

It is recommended that the attached resolution approving the Final Subdivision Map and Agreement be adopted.

Respectfully submitted,



THOMAS M. FINLEY
Engineering Division Manager

Recommendation Approved:



WALTER J. SLIPE
City Manager

Approved:



MELVIN H. JOHNSON
Director of Public Works

JL:vr
DE4-11.F42
08.1688.1

August 30, 1988
District No. 7

Attachment

RESOLUTION NO. 88-753

ADOPTED BY THE SACRAMENTO CITY COUNCIL ON DATE OF

APPROVING FINAL SUBDIVISION MAP AND AGREEMENT FOR VILLAGE PARK (P-85139)

WHEREAS, THE COUNCIL OF THE CITY OF SACRAMENTO FINDS AND DETERMINES AS
FOLLOWS:

- A. The Final Subdivision Map for Village Park Unit No. 5, located at the north side of the intersection of Meadowview Road and Brookfield Drive, with provisions for its design and improvement, is consistent with the 1965 Southgate Community Plan.
- B. The Final Subdivision Map is in substantial compliance with the previously approved tentative map.

NOW, THEREFORE, BE IT RESOLVED BY THE COUNCIL OF THE CITY OF SACRAMENTO AS
FOLLOWS:

- 1. The Final Subdivision Map for Village Park Unit No. 5, located at the north side of the intersection of Meadowview Road and Brookfield Drive, be, and the same is hereby approved subject to the execution by all parties of the Subdivision Improvement Agreement for that subdivision.
- 2. All offers of dedication shown on said map are hereby accepted subject to the improvement thereof required by the Subdivision Agreement.
- 3. The City Manager and City Clerk be authorized and directed to execute on behalf of the City of Sacramento that certain Subdivision Improvement Agreement, and Abstract thereof, between the City and Sunrise Village Park, a California limited partnership, to provide for the subdivision improvements required by the Subdivision Map Act and Chapter 40 (Subdivision Regulations) of the Sacramento City Code.

APPROVED
BY THE CITY COUNCIL

AUG 30 1988

OFFICE OF THE
CITY CLERK

UNITED STATES DEPARTMENT OF JUSTICE
FEDERAL BUREAU OF INVESTIGATION

MEMORANDUM FOR THE DIRECTOR, FBI

RE: [Illegible]

[Illegible]

[Illegible]

[Illegible]

[Illegible]

[Illegible]

4. The Real Estate Supervisor is authorized and directed to record the above-mentioned agreement in the official records of Sacramento County.

MAYOR

ATTEST:

CITY CLERK

THE UNIVERSITY OF CHICAGO
DEPARTMENT OF CHEMISTRY

1954

1954

TENTATIVE MAP OF
VILLAGE PARK
UNIT NO. 5
 CITY OF SACRAMENTO, CALIFORNIA

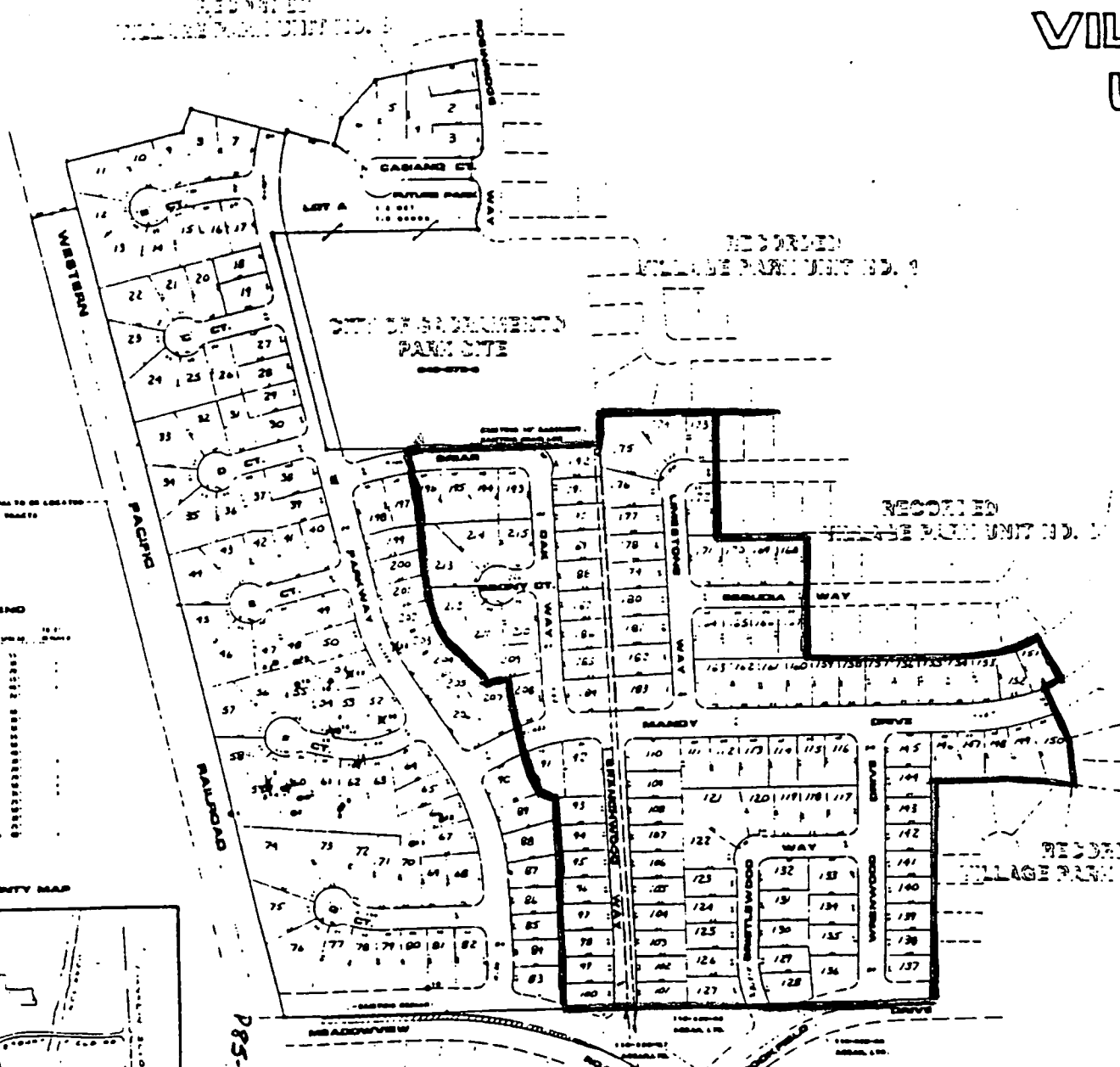

RECORDING & EXEMPTION
 RECORDING VILLAGE PARK, A CALIFORNIA LIMITED PARTNERSHIP
 2007 PACIFIC BOULEVARD
 SACRAMENTO, CALIF. 95825

EDUCATION:
 THE SPINK CORPORATION
 P.O. BOX 2211
 SACRAMENTO, CALIF. 95825

A.P.N.
 000-020-0-10 000-020-0-2 000-020-0-3 000-020-0-4

EXISTING USE & ZONING:
 RESIDENT, OFFICE

PROPOSED USE & ZONING:
 S.F.S. SINGLE-FAMILY LOTS, S.F.S.
 LOT 1 - 10000 SQ. FT.
 AVERAGE & DEPTH:

AREA ACROSS:
 1.16 AC (2007), 1.15 AC (2008)

AVERAGE LOT SIZE:
 6000 SQ. FT. & 100'-100'
 10000 SQ. FT. & 100'-100'

WATER SUPPLY:
 PUBLIC UTILITY

SEWER DISPOSAL:
 PUBLIC SEWER

PROPOSED IMPROVEMENTS:
 SACRAMENTO CITY STREETS

SCHOOL DISTRICT:
 SACRAMENTO UNIFIED SCHOOL DISTRICT
 LOS ANGELES COUNTY COLLEGE DISTRICT

THIS LEGEND

NO.	DESCRIPTION	NO.	DESCRIPTION
1	Lot	11	Proposed Right-of-Way
2	Proposed Lot	12	Proposed Right-of-Way
3	Proposed Lot	13	Proposed Right-of-Way
4	Proposed Lot	14	Proposed Right-of-Way
5	Proposed Lot	15	Proposed Right-of-Way
6	Proposed Lot	16	Proposed Right-of-Way
7	Proposed Lot	17	Proposed Right-of-Way
8	Proposed Lot	18	Proposed Right-of-Way
9	Proposed Lot	19	Proposed Right-of-Way
10	Proposed Lot	20	Proposed Right-of-Way
11	Proposed Lot	21	Proposed Right-of-Way
12	Proposed Lot	22	Proposed Right-of-Way
13	Proposed Lot	23	Proposed Right-of-Way
14	Proposed Lot	24	Proposed Right-of-Way
15	Proposed Lot	25	Proposed Right-of-Way
16	Proposed Lot	26	Proposed Right-of-Way
17	Proposed Lot	27	Proposed Right-of-Way
18	Proposed Lot	28	Proposed Right-of-Way
19	Proposed Lot	29	Proposed Right-of-Way
20	Proposed Lot	30	Proposed Right-of-Way
21	Proposed Lot	31	Proposed Right-of-Way
22	Proposed Lot	32	Proposed Right-of-Way
23	Proposed Lot	33	Proposed Right-of-Way
24	Proposed Lot	34	Proposed Right-of-Way
25	Proposed Lot	35	Proposed Right-of-Way
26	Proposed Lot	36	Proposed Right-of-Way
27	Proposed Lot	37	Proposed Right-of-Way
28	Proposed Lot	38	Proposed Right-of-Way
29	Proposed Lot	39	Proposed Right-of-Way
30	Proposed Lot	40	Proposed Right-of-Way
31	Proposed Lot	41	Proposed Right-of-Way
32	Proposed Lot	42	Proposed Right-of-Way
33	Proposed Lot	43	Proposed Right-of-Way
34	Proposed Lot	44	Proposed Right-of-Way
35	Proposed Lot	45	Proposed Right-of-Way
36	Proposed Lot	46	Proposed Right-of-Way
37	Proposed Lot	47	Proposed Right-of-Way
38	Proposed Lot	48	Proposed Right-of-Way
39	Proposed Lot	49	Proposed Right-of-Way
40	Proposed Lot	50	Proposed Right-of-Way
41	Proposed Lot	51	Proposed Right-of-Way
42	Proposed Lot	52	Proposed Right-of-Way
43	Proposed Lot	53	Proposed Right-of-Way
44	Proposed Lot	54	Proposed Right-of-Way
45	Proposed Lot	55	Proposed Right-of-Way
46	Proposed Lot	56	Proposed Right-of-Way
47	Proposed Lot	57	Proposed Right-of-Way
48	Proposed Lot	58	Proposed Right-of-Way
49	Proposed Lot	59	Proposed Right-of-Way
50	Proposed Lot	60	Proposed Right-of-Way
51	Proposed Lot	61	Proposed Right-of-Way
52	Proposed Lot	62	Proposed Right-of-Way
53	Proposed Lot	63	Proposed Right-of-Way
54	Proposed Lot	64	Proposed Right-of-Way
55	Proposed Lot	65	Proposed Right-of-Way
56	Proposed Lot	66	Proposed Right-of-Way
57	Proposed Lot	67	Proposed Right-of-Way
58	Proposed Lot	68	Proposed Right-of-Way
59	Proposed Lot	69	Proposed Right-of-Way
60	Proposed Lot	70	Proposed Right-of-Way
61	Proposed Lot	71	Proposed Right-of-Way
62	Proposed Lot	72	Proposed Right-of-Way
63	Proposed Lot	73	Proposed Right-of-Way
64	Proposed Lot	74	Proposed Right-of-Way
65	Proposed Lot	75	Proposed Right-of-Way
66	Proposed Lot	76	Proposed Right-of-Way
67	Proposed Lot	77	Proposed Right-of-Way
68	Proposed Lot	78	Proposed Right-of-Way
69	Proposed Lot	79	Proposed Right-of-Way
70	Proposed Lot	80	Proposed Right-of-Way
71	Proposed Lot	81	Proposed Right-of-Way
72	Proposed Lot	82	Proposed Right-of-Way
73	Proposed Lot	83	Proposed Right-of-Way
74	Proposed Lot	84	Proposed Right-of-Way
75	Proposed Lot	85	Proposed Right-of-Way
76	Proposed Lot	86	Proposed Right-of-Way
77	Proposed Lot	87	Proposed Right-of-Way
78	Proposed Lot	88	Proposed Right-of-Way
79	Proposed Lot	89	Proposed Right-of-Way
80	Proposed Lot	90	Proposed Right-of-Way
81	Proposed Lot	91	Proposed Right-of-Way
82	Proposed Lot	92	Proposed Right-of-Way
83	Proposed Lot	93	Proposed Right-of-Way
84	Proposed Lot	94	Proposed Right-of-Way
85	Proposed Lot	95	Proposed Right-of-Way
86	Proposed Lot	96	Proposed Right-of-Way
87	Proposed Lot	97	Proposed Right-of-Way
88	Proposed Lot	98	Proposed Right-of-Way
89	Proposed Lot	99	Proposed Right-of-Way
90	Proposed Lot	100	Proposed Right-of-Way
91	Proposed Lot	101	Proposed Right-of-Way
92	Proposed Lot	102	Proposed Right-of-Way
93	Proposed Lot	103	Proposed Right-of-Way
94	Proposed Lot	104	Proposed Right-of-Way
95	Proposed Lot	105	Proposed Right-of-Way
96	Proposed Lot	106	Proposed Right-of-Way
97	Proposed Lot	107	Proposed Right-of-Way
98	Proposed Lot	108	Proposed Right-of-Way
99	Proposed Lot	109	Proposed Right-of-Way
100	Proposed Lot	110	Proposed Right-of-Way
101	Proposed Lot	111	Proposed Right-of-Way
102	Proposed Lot	112	Proposed Right-of-Way
103	Proposed Lot	113	Proposed Right-of-Way
104	Proposed Lot	114	Proposed Right-of-Way
105	Proposed Lot	115	Proposed Right-of-Way
106	Proposed Lot	116	Proposed Right-of-Way
107	Proposed Lot	117	Proposed Right-of-Way
108	Proposed Lot	118	Proposed Right-of-Way
109	Proposed Lot	119	Proposed Right-of-Way
110	Proposed Lot	120	Proposed Right-of-Way
111	Proposed Lot	121	Proposed Right-of-Way
112	Proposed Lot	122	Proposed Right-of-Way
113	Proposed Lot	123	Proposed Right-of-Way
114	Proposed Lot	124	Proposed Right-of-Way
115	Proposed Lot	125	Proposed Right-of-Way
116	Proposed Lot	126	Proposed Right-of-Way
117	Proposed Lot	127	Proposed Right-of-Way
118	Proposed Lot	128	Proposed Right-of-Way
119	Proposed Lot	129	Proposed Right-of-Way
120	Proposed Lot	130	Proposed Right-of-Way
121	Proposed Lot	131	Proposed Right-of-Way
122	Proposed Lot	132	Proposed Right-of-Way
123	Proposed Lot	133	Proposed Right-of-Way
124	Proposed Lot	134	Proposed Right-of-Way
125	Proposed Lot	135	Proposed Right-of-Way
126	Proposed Lot	136	Proposed Right-of-Way
127	Proposed Lot	137	Proposed Right-of-Way
128	Proposed Lot	138	Proposed Right-of-Way
129	Proposed Lot	139	Proposed Right-of-Way
130	Proposed Lot	140	Proposed Right-of-Way
131	Proposed Lot	141	Proposed Right-of-Way
132	Proposed Lot	142	Proposed Right-of-Way
133	Proposed Lot	143	Proposed Right-of-Way
134	Proposed Lot	144	Proposed Right-of-Way
135	Proposed Lot	145	Proposed Right-of-Way
136	Proposed Lot	146	Proposed Right-of-Way
137	Proposed Lot	147	Proposed Right-of-Way
138	Proposed Lot	148	Proposed Right-of-Way
139	Proposed Lot	149	Proposed Right-of-Way
140	Proposed Lot	150	Proposed Right-of-Way
141	Proposed Lot	151	Proposed Right-of-Way
142	Proposed Lot	152	Proposed Right-of-Way
143	Proposed Lot	153	Proposed Right-of-Way
144	Proposed Lot	154	Proposed Right-of-Way
145	Proposed Lot	155	Proposed Right-of-Way
146	Proposed Lot	156	Proposed Right-of-Way
147	Proposed Lot	157	Proposed Right-of-Way
148	Proposed Lot	158	Proposed Right-of-Way
149	Proposed Lot	159	Proposed Right-of-Way
150	Proposed Lot	160	Proposed Right-of-Way
151	Proposed Lot	161	Proposed Right-of-Way
152	Proposed Lot	162	Proposed Right-of-Way
153	Proposed Lot	163	Proposed Right-of-Way
154	Proposed Lot	164	Proposed Right-of-Way
155	Proposed Lot	165	Proposed Right-of-Way
156	Proposed Lot	166	Proposed Right-of-Way
157	Proposed Lot	167	Proposed Right-of-Way
158	Proposed Lot	168	Proposed Right-of-Way
159	Proposed Lot	169	Proposed Right-of-Way
160	Proposed Lot	170	Proposed Right-of-Way
161	Proposed Lot	171	Proposed Right-of-Way
162	Proposed Lot	172	Proposed Right-of-Way
163	Proposed Lot	173	Proposed Right-of-Way
164	Proposed Lot	174	Proposed Right-of-Way
165	Proposed Lot	175	Proposed Right-of-Way
166	Proposed Lot	176	Proposed Right-of-Way
167	Proposed Lot	177	Proposed Right-of-Way
168	Proposed Lot	178	Proposed Right-of-Way
169	Proposed Lot	179	Proposed Right-of-Way
170	Proposed Lot	180	Proposed Right-of-Way
171	Proposed Lot	181	Proposed Right-of-Way
172	Proposed Lot	182	Proposed Right-of-Way
173	Proposed Lot	183	Proposed Right-of-Way
174	Proposed Lot	184	Proposed Right-of-Way
175	Proposed Lot	185	Proposed Right-of-Way
176	Proposed Lot	186	Proposed Right-of-Way
177	Proposed Lot	187	Proposed Right-of-Way
178	Proposed Lot	188	Proposed Right-of-Way
179	Proposed Lot	189	Proposed Right-of-Way
180	Proposed Lot	190	Proposed Right-of-Way
181	Proposed Lot	191	Proposed Right-of-Way
182	Proposed Lot	192	Proposed Right-of-Way
183	Proposed Lot	193	Proposed Right-of-Way
184	Proposed Lot	194	Proposed Right-of-Way
185	Proposed Lot	195	Proposed Right-of-Way
186	Proposed Lot	196	Proposed Right-of-Way
187	Proposed Lot	197	Proposed Right-of-Way
188	Proposed Lot	198	Proposed Right-of-Way
189	Proposed Lot	199	Proposed Right-of-Way
190	Proposed Lot	200	Proposed Right-of-Way

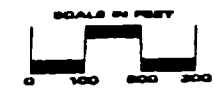
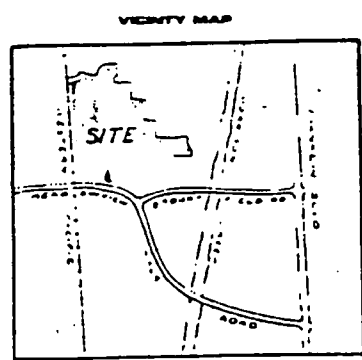

THE SPINK CORPORATION
 CIVIL ENGINEERING & ARCHITECTURE
 1000 J STREET, SACRAMENTO, CALIF. 95811

MARCH, 1988

RESOLUTION No. _____

September 9, 1988

Sunrise Village Park, A California
Limited Partnership
2150 Professional Drive, Suite 150
Roseville, CA 95661

Dear Gentlemen:

On August 30, 1988, the Sacramento City Council adopted Resolution No. 88-753 authorizing the execution of City Agreement #88039, Subdivision Improvements for Village Park Unit No. 5.

Enclosed, for your records, is one fully certified copy of said agreement and authorizing resolution.

Sincerely,

LORRAINE MAGANA, CITY CLERK

JANICE BEAMAN
Acting Assistant City Clerk

JB/cc/10
Enclosure

cc: Public Works
Risk Management

1947

1948

1949

1950

1951

1952

1953

1954

1955

1956

1957

1958

1959

1960

1961

1962

1963

1964

1965

1966

1967

1968

1969

1970

1971

1972

1973

1974

1975

1976

1977

1978

1979

1980

1981

1982

1983

1984

1985

1986

1987

1988

1989

1990

1991

1992

1993

1994

1995

1996

1997

1998

1999

2000

2001

2002

2003

2004

2005

2006

2007

2008

2009

2010

2011

2012

2013

2014

2015

2016

2017

2018

2019

2020

2021

2022

2023

2024

2025