

CITY OF SACRAMENTO
1231 I Street, Sacramento, CA 95814

Permit No: 0204758

Insp Area: 4

Thos Bros:

Sub-Type: NSFR

Housing (Y/N): N

Site Address: 3218 SWEET MAPLE WY SAC

Parcel No: 274-0590-006

RIVERWALK II LOT 54

CONTRACTOR

MYERS HOMES INC.
3300 FITZGERALD RD.
RANCHO CORDOVA CA. 95742

OWNER

ARCHITECT

Nature of Work: NSFR MP2655 2 STORY 9 RMS

CONSTRUCTION LENDING AGENCY : I hereby affirm under penalty of perjury that there is a construction lending agency for the performance of the work for which this permit is issued (Sec. 3097, Civ. C).

Lender's Name _____ Lender's Address _____

LICENSED CONTRACTORS DECLARATION: I hereby affirm under penalty of perjury that I am licensed under provisions of Chapter 9 (commencing with section 7000) of Division 3 of the Business and Professions Code and my license is in full force and effect.

License Class B License Number 744473 Date 4/19/02 Contractor Signature [Signature]

OWNER-BUILDER DECLARATION: I hereby affirm under penalty of perjury that I am exempt from the contractors License Law for the following reason (Sec. 7031.5, Business and Professions Code; any city or county which requires a permit to construct, alter, improve, demolish, or repair any structure, prior to its issuance, also requires the applicant for such permit to file a signed statement that he or she is licensed pursuant to the provisions of the Contractors License Law (Chapter 9 (commencing with Section 7000) of Division 8 of the Business and Professions Code) or that he or she is exempt therefrom and the basis for the alleged exemption. Any violation of Section 7031.5 by any applicant for a permit subjects the applicant to a civil penalty of not more than five hundred dollars (\$500.00);

_____, I, as a owner of the property, or my employees with wages as their sole compensation, will do the work, and the structure is not intended or offered for sale (Sec. 7044, Business and Professional Code: The Contractors License Law does not apply to an owner of property who builds or improves thereon, and who does such work himself or herself or through his/her own employees, provided that such improvements are not intended or offered for sale. If, however, the building or improvement is sold within one year of completion, the owner-builder will have the burden of proving that he/she did not build or improve for the purpose of sale.)

_____, I, as owner of the property, am exclusively contracting with licensed contractors to construct the project (Sec. 7044, Business and Professions Code: The Contractors License Law does not apply to an owner of property who builds or improves thereon, and who contracts for such projects with a contractor(s) licensed pursuant to the Contractors License Law).

_____ I am exempt under Sec. _____ B & PC for this reason: _____

Date _____ Owner Signature _____

IN ISSUING THIS BUILDING PERMIT, the applicant represents, and the city relies on the representation of the applicant, that the applicant verified all measurements and locations shown on the application or accompanying drawings and that the improvement to be constructed does not violate any law or private agreement relating to permissible or prohibited locations for such improvements. This building permit does not authorize any illegal location of any improvement or the violation of any private agreement relating to location of improvements.

I certify that I have read this application and state that all information is correct. I agree to comply with all city and county ordinances and state laws relating to building construction and hereby authorize representative(s) of this city to enter upon the above mentioned property for inspection purposes.

Date 4/19/02 Applicant/Agent Signature [Signature]

WORKER'S COMPENSATION DECLARATION: I hereby affirm under penalty of perjury one of the following declarations:
_____ I have and will maintain a certificate of consent to self-insure for workers' compensation as provided for by Section 3700 of the Labor Code, for the performance of work for which the permit is issued.

[Signature] I have and will maintain workers' compensation insurance, as required by Section 3700 of the Labor Code, for the performance of the work for which this permit is issued. My workers' compensation insurance carrier and policy number are:

Carrier RELANCE NAT INS CO Policy Number NWAO154613-01 Exp Date 04/01/2002

_____, (This section need not be completed if the permit is for \$100 or less) I certify that in the performance of the work for which this permit is issued, I shall not employ any person in any manner so as to become subject to the workers' compensation laws of California and agree that if I should become subject to the workers' compensation provisions of Section 3700 of the Labor Code, I shall forthwith comply with those provisions.

Date 4/19/02 Applicant Signature [Signature]

WARNING: FAILURE TO SECURE WORKERS COMPENSATION COVERAGE IS UNLAWFUL AND SHALL SUBJECT AN EMPLOYER TO CRIMINAL PENALTIES AND CIVIL FINES UP TO ONE HUNDRED THOUSAND DOLLARS (\$100,000) IN ADDITION TO THE COST OF COMPENSATION, DAMAGES AS PROVIDED FOR IN SECTION 3706 OF THE LABOR CODE, INTEREST AND ATTORNEY'S FEE.

THIS PERMIT SHALL EXPIRE BY LIMITATION IF WORK IS NOT COMMENCED WITHIN 180 DAYS.

6 Lot 55

RESIDENTIAL BUILDING PERMIT APPLICATION

- [X] New Construction [] Addition [] Remodels [] Other

Project Address: 3212 Sweet Maple Way Sacramento, CA 95833 Assessor Parcel #: 274-059-007

OWNER INFORMATION:

Legal Property Owner: MYERS HOMES OF CALIFORNIA, LLC Phone # 916-851-0530 Owner Address: 3480 Sunrise Blvd, #200 City RANCHO CORDONA State CA Zip 95142

CONTRACTOR INFORMATION:

Contractor: MYERS HOMES, INC. Lic. # 744473 Phone # 916-851-0530 Fax # 916-851-0535

PROJECT INFORMATION:

Land Use Zone R-1A PUD Occupancy Group R3 Construction Type VN - Fed Code 1A No. of stories: 2 No. of rooms: 13 Street width: 50 FT 1st Floor Area 1611 2nd Floor Area 1044 Basement N/A Roof Material TILE AREA IN SQUARE FOOT OF: EXISTING NEW Dwelling/Living 2655 Garage/Storage 660 Decks/Balconies 118 COVERED FRONT PORCH Carports

SCOPE OF WORK: NEW CONSTRUCTION OF SINGLE FAMILY RESIDENCE; RIVERWALK SERIES II, PLAN G/2655 IN MASTER PLAN COMMUNITY P99-075 P97-005 AMENDED

FOR OFFICE USE ONLY:

- [] Information above complete [] AR Flood Waiver required [] Planning Approval [] Violation files checked [] Flood Elevation Certificate Required [] Design Review Approval [] Standard setbacks [] Water Development Infill Area [] Special Fee Districts Apply [] County Sewer

NEW STRUCTURES & ADDITIONS

*THE FOLLOWING MUST BE PROVIDED IN ORDER TO SUBMIT FOR PLAN REVIEW

- [] 2 COMPLETE PLANS, LEGIBLE & DRAWN TO SCALE (PLAT 8.5" x 11" DRAINAGE INFO) Plans to include: site plan, floor plan, elevations, roof/ceiling plan, foundation and structural framing details, and structural calculations for non-conforming structures. [] 3 SETS IF PROJECT IS IN A DESIGN REVIEW AREA [X] Title 24 Energy Compliance documentation [] 11" x 17" copy of floor plan for County Assessor [] Grading and Erosion Control Questionnaire [] Plan Review Fees

Date: Received by: (staff)

ACTIVITY/PERMIT #

LOT 55

OMEGA PRODUCTS CORP.

DIAMOND WALL INSULATING STUCCO SYSTEM

JOB ADDRESS:

ICBO Report #4004

3212 Sweet Maple Wy

Date of Job Completion 10/8/02

PLASTERING CONTRACTOR:

Name: Norcal Plastering

Address: Box 355 Lincoln Ca 95648

Telephone No: (716) 645-7337

Contractor Number of Diamond Wall System 2130

This is to certify that the exterior coating system on the building exterior at the above address has been installed in accordance with the evaluation report specified above and the manufacturer's instructions.

Date _____

Jim Huerton
Signature of authorized representative of
Plastering Contractor

This installation card must be presented to the building inspector after completion of work and before final inspection.

CERTIFICATION OF INSULATION

PART I GENERAL
PART II AREAS INSULATED
PART III CERTIFICATION

ADDRESS OF PROJECT MEYERS HOMES LOT # 55 3212 Sweet Maple RIVERWALK SERIES II	SACRAMENTO BUILDING PRODUCTS <input checked="" type="checkbox"/> P.O. BOX 854, WEST SACRAMENTO, CA 95691 LIC. #202026 <input type="checkbox"/> 1309 MELODY ROAD, MARYSVILLE, CA 95901 LIC. #202026 <input type="checkbox"/> P.O. BOX 9651, FRESNO, CA 93793-9651 LIC. #202026 <input type="checkbox"/> P.O. BOX 1631, RENO, NV 89505 LIC. #10675 <input type="checkbox"/> 3326 A PONDEROSA WAY, LAS VEGAS, NV 89118 LIC. #10675 DATE INSULATION COMPLETED
---	---

WALLS			CEILINGS			FLOORS		
SQUARE FEET)			SQUARE FEET)			SQUARE FEET)		
TYPE OF INSULATION			TYPE OF INSULATION			TYPE OF INSULATION		
MATERIAL FIBERGLASS			MATERIAL FIBERGLASS			MATERIAL FIBERGLASS		
FORM BATTS			FORM BATTS & BLOW			FORM BATTS		
MANUFACTURER'S PRODUCT I.D.			MANUFACTURER'S PRODUCT I.D.			MANUFACTURER'S PRODUCT I.D.		
MANUFACTURER			MANUFACTURER			MANUFACTURER		
CT	OC	JM	CT	OC	JM	CT	OC	JM
BAGS								
R-VALUE INSTALLED	APPLIED THICKNESS	R-VALUE INSTALLED	APPLIED THICKNESS	MIN. INSTALLED WEIGHT PER SQUARE FOOT	R-VALUE INSTALLED	APPLIED THICKNESS		
13	3 1/2"	30 30	7" 12"					

R-VALUE IS OTHER THAN WALLS ABOVE

MATERIAL FIBERGLASS	FORM BATTS	R VALUE	MANUFACTURER		
			CT	OC	JM
MATERIAL FOAM			MANUFACTURER		
			HILTI	HANDY FOAM	

THIS IS TO CERTIFY THAT INSULATION INSTALLMENT HAS BEEN INSTALLED IN ACCORDANCE WITH APPLICABLE CODES, MATERIAL STANDARDS AND MANUFACTURER'S INSTRUCTIONS.

SIGNATURE — INSULATION CONTRACTOR <i>Jeff Cable</i>	TITLE MANAGER	DATE 10/1/02
SIGNATURE — GENERAL CONTRACTOR	TITLE	DATE

REMARKS

LEGEND

→ SWALE
* STREET LIGHT

⊕ TRANSFORMER
99.9 BOLD ELEVATION (FT)

SS SEWER SERVICE
WS WATER SERVICE
◆ FIRE HYDRANT

☐ UTILITY SERVICE
☒ DRAIN INLET

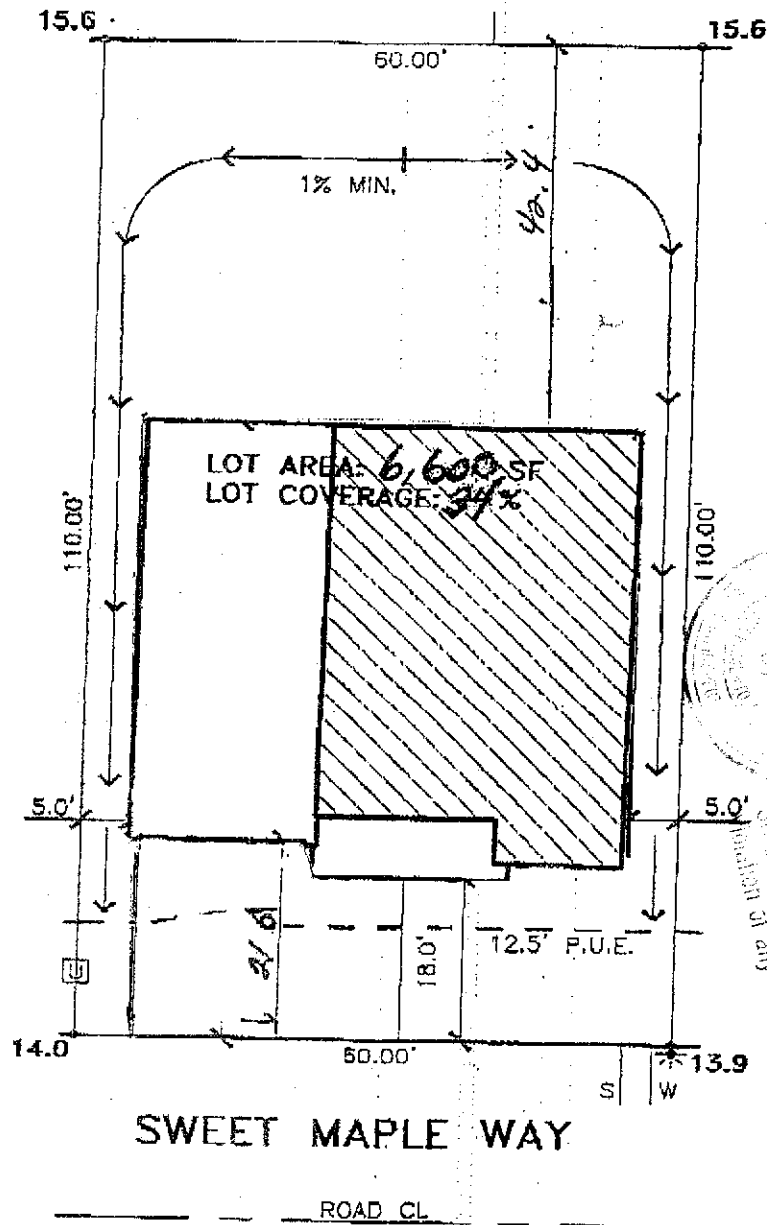

DATE: 12-MARCH-2002 REV

A.P.N.:

ADDRESS: SWEET MAPLE WAY

LOT AREA: 6,600 SF
LOT COVERAGE: 34%



Stantec

Stantec Consulting Inc.
2590 Venture Oaks Way
Sacramento, CA 95833-3288
Tel. 916.925.5550
Fax. 916.921.9274
www.stantec.com

RIVERWALK
UNIT NO. 2

LOT 55
PLAN 2655 C

RIVERWALK

CITY OF SACRAMENTO, CA.
CLIENT: MYERS HOMES
JOB NO.: 843-00072