

CITY OF SACRAMENTO
1231 I Street, Sacramento, CA 95814

Permit No: 0519331
Insp Area: 3
Thos Bros: 318B4

Site Address: 7291 DESI WY SAC
Parcel No: BELLEVIEW ESTATES LOT 6

Sub-Type: NSFR
Housing (Y/N): N

CONTRACTOR
KAT CONSTRUCTION
2947 FULTON AVE
SAC CA 95821

OWNER

ARCHITECT

Nature of Work: MP 2479 2 STORY 9 ROOM SFR

CONSTRUCTION LENDING AGENCY: I hereby affirm under penalty of perjury that there is a construction lending agency for the performance of the work for which this permit is issued (Sec. 3097, Civ. C).

Lender's Name _____ Lender's Address _____

LICENSED CONTRACTORS DECLARATION: I hereby affirm under penalty of perjury that I am licensed under provisions of Chapter 9 (commencing with section 7000) of Division 3 of the Business and Professions Code and my license is in full force and effect.

License Class _____ License Number 809667 Date _____ Contractor Signature _____

OWNER-BUILDER DECLARATION: I hereby affirm under penalty of perjury that I am exempt from the contractors License Law for the following reason (Sec. 7031.5, Business and Professions Code; any city or county which requires a permit to construct, alter, improve, demolish, or repair any structure, prior to its issuance, also requires the applicant for such permit to file a signed statement that he or she is licensed pursuant to the provisions of the Contractors License Law (Chapter 9 (commencing with Section 7000) of Division 8 of the Business and Professions Code) or that he or she is exempt therefrom and the basis for the alleged exemption. Any violation of Section 7031.5 by any applicant for a permit subjects the applicant to a civil penalty of not more than five hundred dollars (\$500.00);

____ I, as a owner of the property, or my employees with wages as their sole compensation, will do the work, and the structure is not intended or offered for sale (Sec. 7044, Business and Professional Code: The Contractors License Law does not apply to an owner of property who builds or improves thereon, and who does such work himself or herself or through his/her own employees, provided that such improvements are not intended or offered for sale. If, however, the building or improvement is sold within one year of completion, the owner-builder will have the burden of proving that he/she did not build or improve for the purpose of sale.)

____ I, as owner of the property, am exclusively contracting with licensed contractors to construct the project (Sec. 7044, Business and Professions Code: The Contractors License Law does not apply to an owner of property who builds or improves thereon, and who contracts for such projects with a contractor(s) licensed pursuant to the Contractors License Law).

____ I am exempt under Sec. _____ B & PC for this reason: _____

Date 12/12/05 Owner Signature Ken M...

IN ISSUING THIS BUILDING PERMIT, the applicant represents, and the city relies on the representation of the applicant, that the applicant verified all measurements and locations shown on the application or accompanying drawings and that the improvement to be constructed does not violate any law or private agreement relating to permissible or prohibited locations for such improvements. This building permit does not authorize any illegal location of a any improvement or the violation of any private agreement relating to location of improvements.

I certify that I have read this application and state that all information is correct. I agree to comply with all city and county ordinances and state laws relating to building construction and hereby authorize representative(s) of this city to enter upon the abovementioned property for inspection purposes.

Date 12/12/05 Applicant/Agent Signature Ken M...

WORKER'S COMPENSATION DECLARATION: I hereby affirm under penalty of perjury one of the following declarations:

____ I have and will maintain a certificate of consent to self-insure for workers' compensation as provided for by Section 3700 of the Labor Code, for the performance of work for which the permit is issued.

____ I have and will maintain workers' compensation insurance, as required by Section 3700 of the Labor Code, for the performance of the work for which this permit is issued. My workers' compensation insurance carrier and policy number are:

Carrier STATE FUND Policy Number 1697162 Exp Date 01/01/2006

____ (This section need not be completed if the permit is for \$100 or less) I certify that in the performance of the work for which this permit is issued, I shall not employ any person in any manner so as to become subject to the workers' compensation laws of California and agree that if I should become subject to the workers' compensation provisions of Section 3700 of the Labor Code, I shall forthwith comply with those provisions.

Date 12/12/05 Applicant Signature Ken M...

WARNING: FAILURE TO SECURE WORKER'S COMPENSATION COVERAGE IS UNLAWFUL AND SHALL SUBJECT AN EMPLOYER TO CRIMINAL PENALTIES AND CIVIL FINES UP TO ONE HUNDRED THOUSAND DOLLARS (\$100,000) IN ADDITION TO THE COST OF COMPENSATION, DAMAGES AS PROVIDED FOR IN SECTION 3706 OF THE LABOR CODE, INTEREST AND ATTORNEY'S FEE.

THIS PERMIT SHALL EXPIRE BY LIMITATION IF WORK IS NOT COMMENCED WITHIN 180 DAYS.

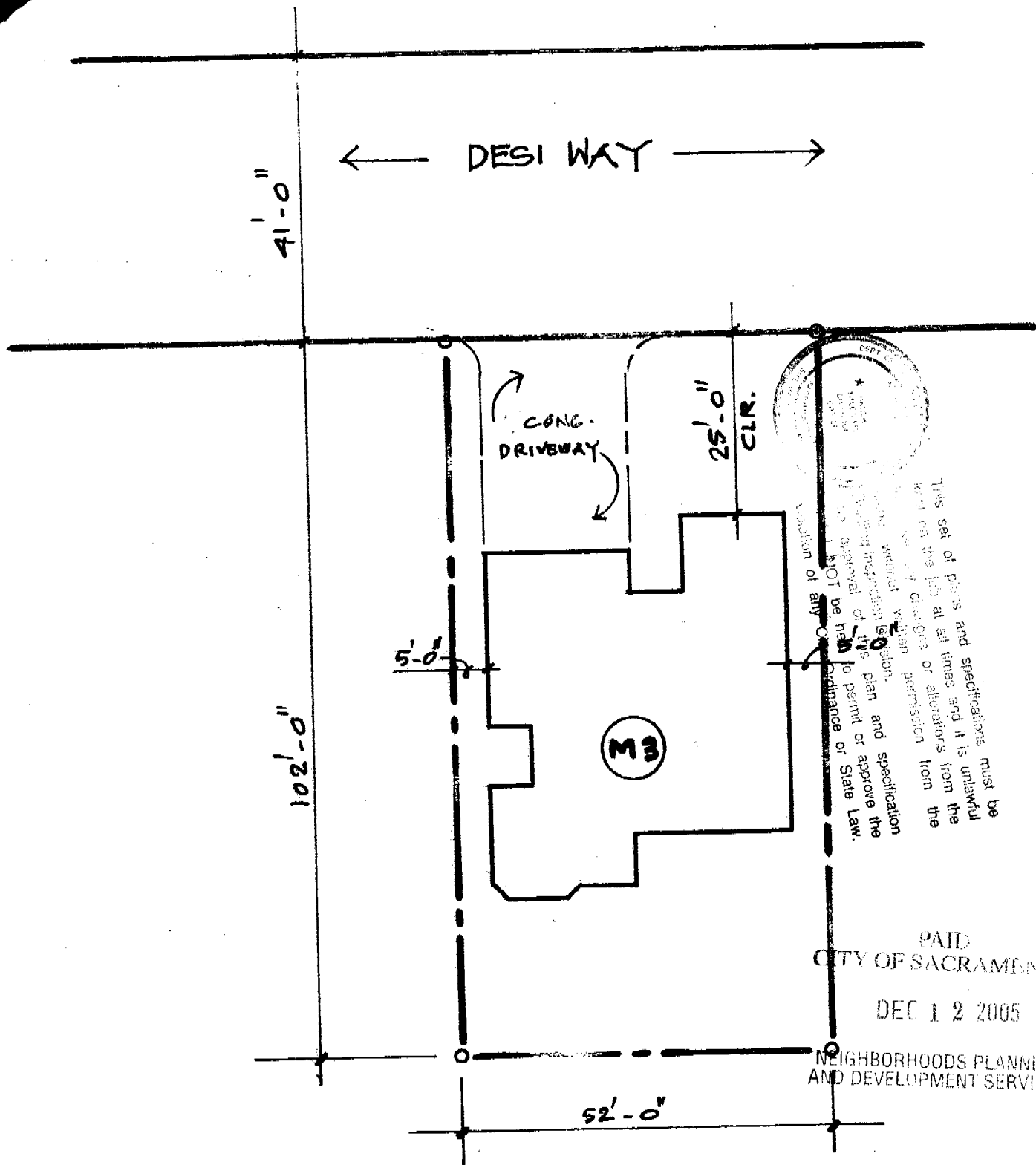

This set of plans and specifications must be based on the lot at all times and it is unlawful to make any changes or alterations from the original plan without written permission of the City of Sacramento. Any variation of any of the above conditions shall be subject to the approval of the City of Sacramento. This plan and specification shall be void if not approved by the City of Sacramento or the State Law.

PAID
CITY OF SACRAMENTO
DEC 12 2005
NEIGHBORHOODS PLANNING
AND DEVELOPMENT SERVICES

SITE PLAN M-3
 50' = 20'-0"
 LOT #6

059331

INSULATION CERTIFICATE

THIS IS TO CERTIFY THAT INSULATION HAS BEEN INSTALLED IN CONFORMANCE WITH THE CURRENT ENERGY REGULATIONS, CALIFORNIA ADMINISTRATION CODE, TITLE 24, STATE OF CALIFORNIA, IN THE BUILDING LOCATED AT:

7291 Del' Wy

SITE ADDRESS LOT 6 BELLVIEW SACRAMENTO CA
NUMBER CITY STATE

CEILING:

BLOW: MANUFACTURER GREENFIBER THICKNESS 10.5" R-VALUE 35
MANUFACTURER GREENFIBER THICKNESS R-VALUE

BATTS: MANUFACTURER KNAUF THICKNESS 15" R-VALUE 35
KNAUF THICKNESS 6.25" R-VALUE 39 FD

EXTERIOR WALLS:

MANUFACTURER KNAUF THICKNESS 3.5" R-VALUE 15
KNAUF THICKNESS R-VALUE

FLOOR INSULATION:

MANUFACTURER KNAUF THICKNESS 6" R-VALUE 19
KNAUF THICKNESS R-VALUE

AIR INfiltration: (TITLE 24)
YES XXX NO

OTHER: _____

GENERAL CONTRACTOR: KAT CONSTRUCTION LICENSE # _____

BY: _____ TITLE _____ DATE _____

INSULATION CONTRACTOR: WESTERN INSULATION LP LICENSE # 794494

BY: Becky Guyherz TITLE AUTH. AGENT DATE 8/23/2006
BECKY GUYHERZ

INSTALLATION CERTIFICATE

(Page 3 of 12) CF-6R

Site Address

7291 Desi Way

Permit Number

An installation certificate is required to be posted at the building site or made available for all appropriate inspections. (The information provided on this form is required) After completion of final inspection, a copy must be provided to the building department (upon request) and the building owner at occupancy, per Section 10-103(a).

HVAC SYSTEMS:

Heating Equipment

Equip Type (pkg, heat pump)	CEC Certified Mfr. Name and Model Number	# of Identical Systems	Efficiency (AFUE, etc.) ¹ (≥CF-1R value)	Duct Location (attic, etc.)	Duct or Fiping R-value	Heating Load (Btu/hr)	Heating Capacity (Btu/hr)
Attic Furnace	S16052108308	1	90%	attic	R-1.2	45,000	48,000

Cooling Equipment

Equip Type (pkg, heat pump)	CEC Certified Mfr. Name and Model Number	# of Identical Systems	Efficiency (SEER or EER) ¹ (≥CF-1R value)	Duct Location (attic, etc.)	Duct R-value	Cooling Load (Btu/hr)	Cooling Capacity (Btu/hr)
Outside Condensor	SS3BC- 048KA	1	12SEER	attic	R-1.2	45,000	48,000

1. ≥ symbol reads greater than or equal to what is indicated on the CF-1R value.
Include both SEER and EER if compliance credit for high EER air conditioner is claimed.

✓ I, the undersigned, verify that equipment listed above is: 1) is the actual equipment installed, 2) equivalent to or more efficient than that specified in the certificate of compliance (Form CF-1R) submitted for compliance with the *Energy Efficiency Standards* for residential buildings, and 3) equipment that meets or exceeds the appropriate requirements for manufactured devices (from the *Appliance Efficiency Regulations* or Part 6), where applicable.

Installing Subcontractor (Co. Name) OR General Contractor (Co. Name) OR Owner	
Signature: 	Date: 8/30/06

Copies to: BUILDING DEPARTMENT, HERS RATER (IF APPLICABLE) BUILDING OWNER AT OCCUPANCY

OMEGA PRODUCTS INTERNATIONAL, INC.
DIAMOND WALL INSULATING STUCCO SYSTEM

ICBO Report # 4004

Builder: **KAT CONSTRUCTION**

Project Name: **BELLVIEW ESTATES**

Lot Numbers: _____

6

Date of Job Completion: June 18, 2006

7291 Desi Wy

PLASTERING CONTRACTOR:

Name: STUCCO WORKS, INC.

Address: 5900 WAREHOUSE WAY - SACRAMENTO, CALIFORNIA 95826

Telephone No: (916) 383-6667

Contractor Number of Diamond Wall System: 2175

This is to certify that the exterior coating system on the building exterior at the above address has been installed in accordance with the evaluation report specified above and the manufacturer's inspections.

August 30, 2006
Date

Signature of authorized representative of Plastering Contractor

This installation card must be presented to the building inspector after completion of work and before final inspection